

# Self-Collect - HPV Specimen Collection for the Cervical Screening Program

**As of July 1st 2022 any individual who is eligible for cervical screening, as a primary screen or follow up test (after an intermediate risk test 12 months earlier), will be eligible for a self-collect in place of a clinician collected sample.**

Until July 1st, these were restricted to never-screened, or significantly under screened patients. This is a significant change to eligibility of this test.

There remain patients who are not eligible. Specifically anyone who requires a co-test (cervical cytology). This includes:

- Symptomatic patients
- Patients attending for a test of cure (after histologically confirmed HSIL).
- Patients who have had previous AIS (endocervical adenocarcinoma in situ).
- DES exposed patients.
- Pregnant women.
- Patients who have previously had gynaecologic cancer.

These patients still require a clinician collected cervical sample as they require both HPV testing (testing for the virus) and cytology co-testing (looking at the cells).

The laboratories cannot do any reflex liquid based cytology (LBC) on the sample if it is required.

If the HPV test is positive for HPV 16/18 the patient will need to be referred to a specialist.

If the HPV test is positive for other oncogenic HPV, the patient will need to return to their GP to have a (clinician collected) sample for LBC.

Request form must clearly state: **Self collect, cervical screening test.**

## MATERIALS REQUIRED

For self-collect the following materials are required:

1. Western Diagnostic Pathology request form
2. Copan Floq swab (Red Top COPAN552C.80) - available from Western Diagnostic Pathology
3. Self-collect - HPV Specimen Collection of the Cervical Screening Program instructions (overleaf)
4. ThinPrep® vial

Self collect kits can be ordered from our website. Visit [wdp.com.au/clinicians/order-consumables](http://wdp.com.au/clinicians/order-consumables).

## MEDICARE REBATE

Cervical screening requests that follow the National prescribed clinical guidelines will be bulk billed subject to Medicare guidelines and criteria.

>>> CONTINUED OVERLEAF

# Self-Collect - HPV Specimen Collection for the Cervical Screening Program

>>> CONTINUED FROM OVERLEAF

## SELF-COLLECTION

1. Use a Copan Floq swab (Red Top) - do not use any lubricant.
2. Insert the Copan Floq swab (Red Top) deep into vagina, not just the entrance.
3. Move around in a circular motion for about 10 rotations and then move around other areas deep in the vagina.
4. Immediately place the Copan Floq swab (Red Top) back into the container and secure the cap.
5. Hand to your healthcare provider as soon as possible.

Copan Floq swab (Red Top)

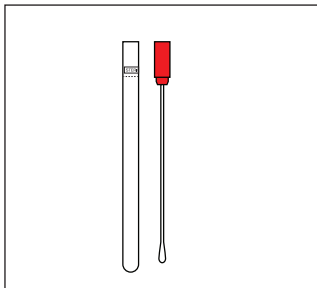
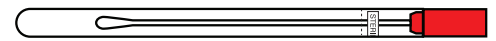

Step 1

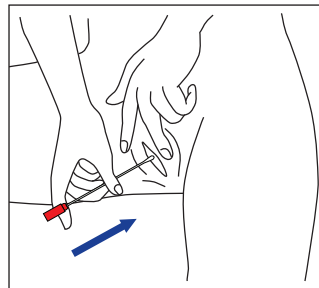

Step 2

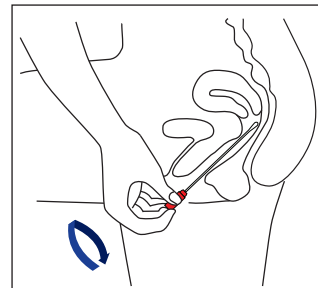

Step 3

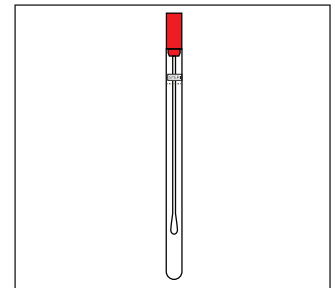

Step 4

## THE DOCTOR OR HEALTHCARE PROVIDER MUST THEN

1. Slowly pull the swab cap off to remove the swab from the tube
2. Check that the ThinPrep® vial has not exceeded its expiry date.
3. Fully immerse the tip of the swab into the solution of the ThinPrep® vial
4. Swirl the swab for 20 seconds
5. Hold the tip against the inner vial wall to drain fluid from the swab
6. Place the swab back into the tube
7. Re-cap the ThinPrep® vial
8. Record the patient's full name and date of birth on the ThinPrep® vial and the swab.
9. Complete the patient's details on the request form with all relevant information
10. Ensure **SELF COLLECTION, CERVICAL SCREENING TEST** is on the request form
11. Send the ThinPrep® vial and the original swab to the laboratory in the usual manner.