

CAUTION

Don't pull the cord to unplug, when you would like to retract the cable, hold the plug and then press the rewinder button.

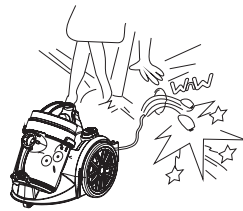

Keep off from ovens and stoves, etc.



Don't suck at large fragments or sharp objects.



Don't wrest, tramp and haul the hose.



Warning: Never use this machine when the suction power becomes very weak. When this happens, please check if the dust container is full. Then check both filters if they are dirty (see **MAINTENANCE**). At last check the floor brush, tube, hose if any part is jammed.

Don't use this machine until it operates at a standard level. If the problem remains, please submit to Repairing Center.

If the supply cord becomes damaged, it must be replaced by the manufacturer or its service agent or similarly qualified person in order to avoid a hazard.

Nero®

Nero Cyclonic Bagless Vacuum Cleaner INSTRUCTION MANUAL

Product Code: 360218

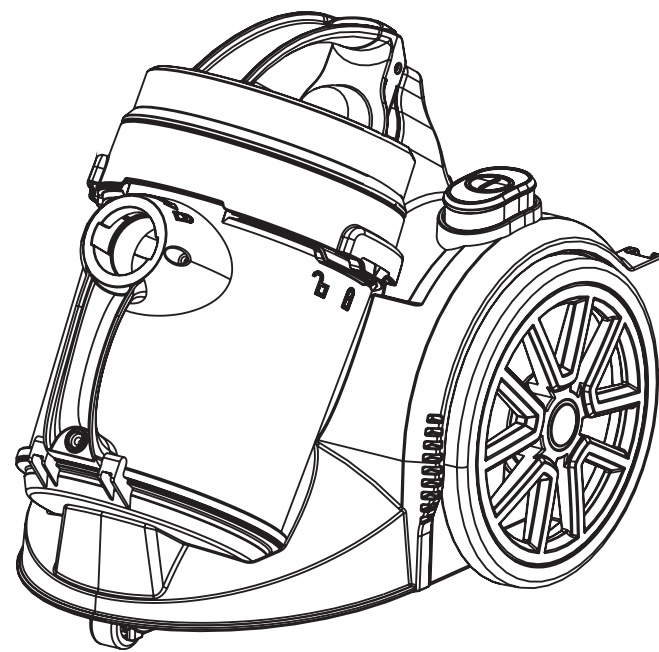

Backed by the Nero 1 Year Warranty | Imported By R. Weatherdon & Co P Ltd
www.weatherdon.com.au | Made in China

Images in this manual are for illustrative purposes only.
Due to constant improvements, we advise that changes to the design, material, specifications and product configuration may occur at any time without notice.

Thanks for purchasing this product. Please read the instruction manual carefully before operation and keep for future reference.

SAFETY DIRECTIONS

Check before operation that the local power supply is the same as the specifications on the rating plate.

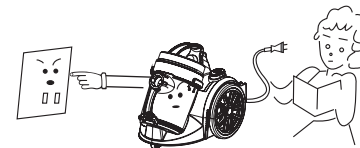

Do not use the vacuum cleaner to suck glowing ash, glowing cigarettes or matches, water, damp dust, etc.

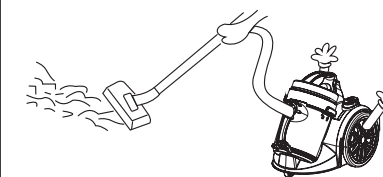

Don't let children play with this machine.

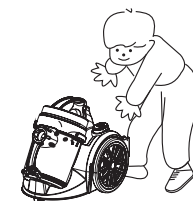

Please unplug the cleaner from the supply before cleaning it.

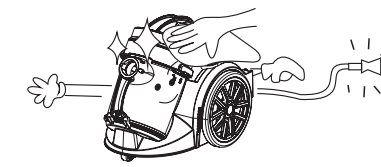

MAINTENANCE

Filter maintenance

1

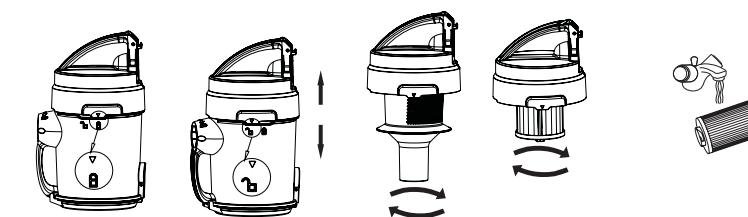

Rotate the cover as shown until the symbol(♦) lines up with the unlocked symbol(★)

Take off the cyclon cover and wash HEPA by running water, just as above picture shows.

2

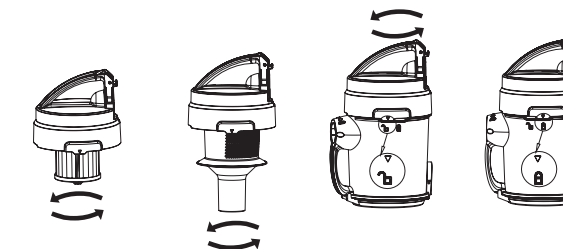

Assemble the dried accessories as picture shows.

Rotate the cover as shown until the symbol(♦) lines up with the locked symbol(▲)

3

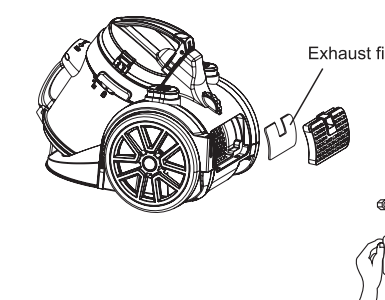

Take out the air inlet filter and exhaust filter, tap them or wash them by running water and then put them back after drying them by air

Warning: This machine is a cyclonic design, no dust bag provided if the filters are clogged you can follow MAINTENANCE instruction to resolve this problem

MAINTENANCE

Dust cup maintenance: Please always keep the dust cup clean before each operation. You can wash the cup in water whenever necessary.

1

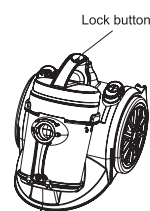

Press the locking block then push front to open the dust compartment

2

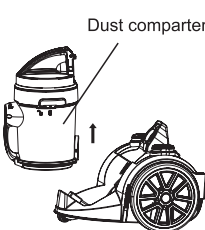

Take up the dust compartment

3

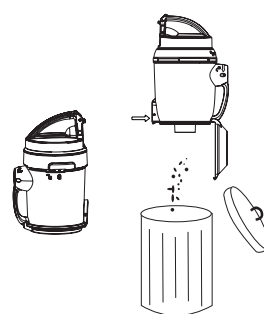

Press the automatic release button to empty the dust into dust container.

4

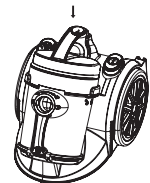

Place the dust container properly and make sure the button is locked

5

PARTS NAME

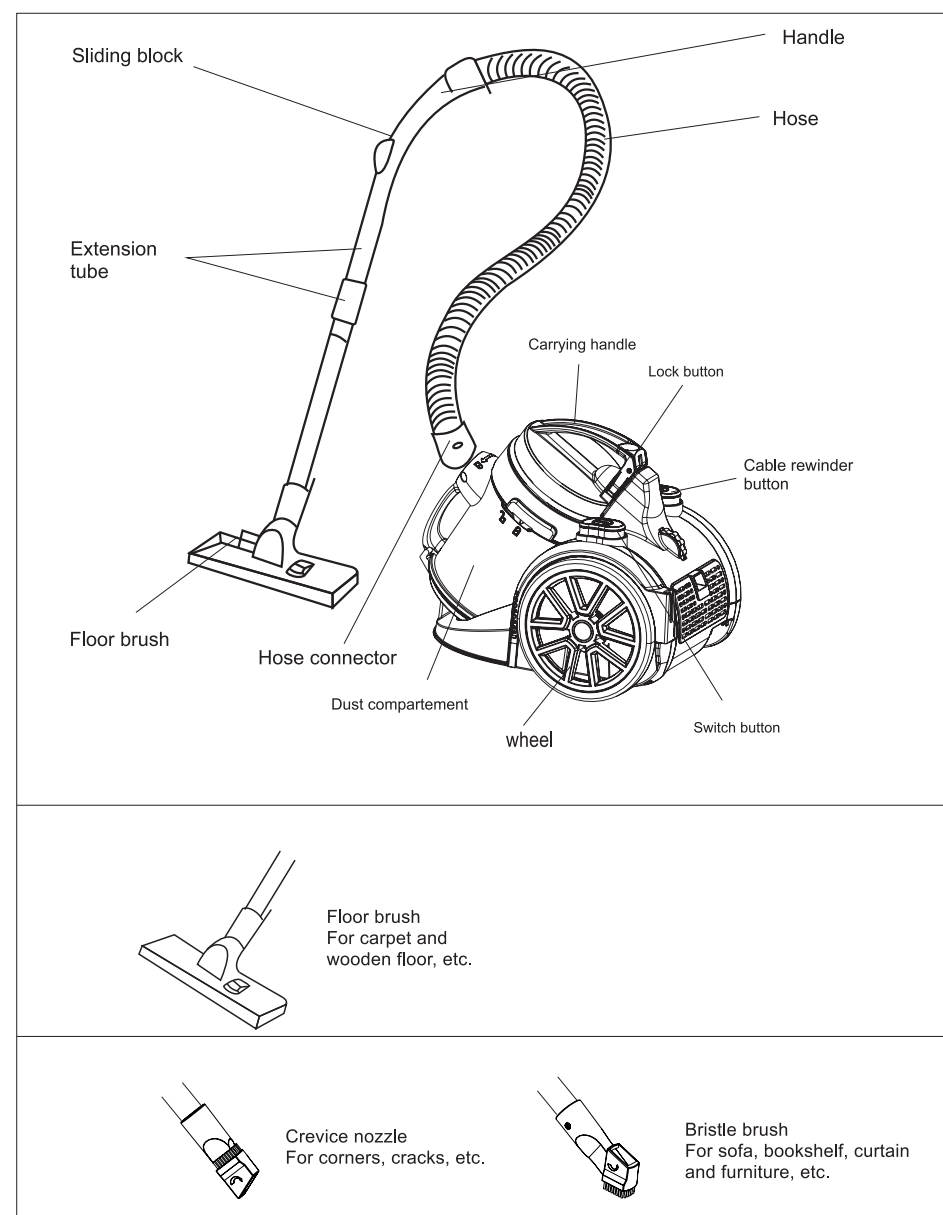

2

OPERATION METHOD

1

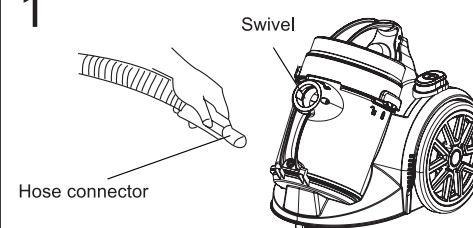

Insert the hose connector into the swivel of the vacuum cleaner and twist clockwise to fix it (twist anti-clockwise to unfix it)

2

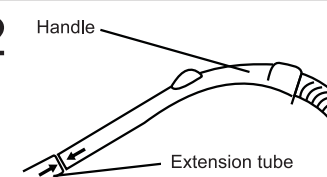

Insert the handle into the tube with a twisting force.

3

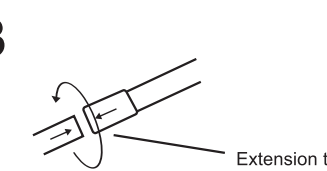

Same as above.

4

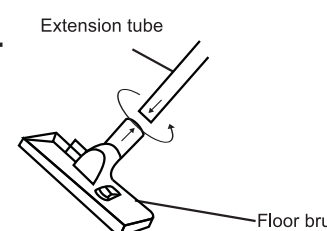

Same as above.

5

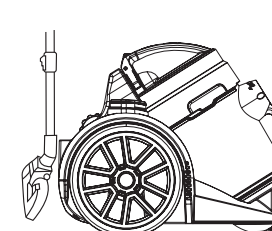

Standing position
Put the fixing block into the hole on the body.

3

OPERATION METHOD

1

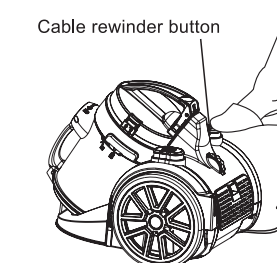

(1) Pull out the cord as long as you need, but do not exceed the mark of red and yellow.
(2) Hold the plug when rewinding, you can press the button with your foot to retract the cable into the machine.

2

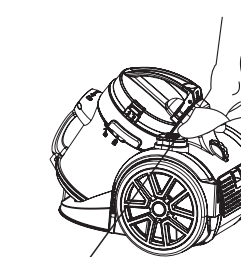

Press the switch button to turn on/off the cleaner.

3

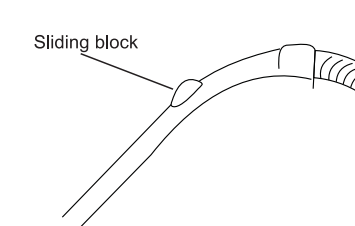

You can adjust the airflow by push the sliding block up and down.

4