

NOTES:

1. Overlay new asphalt on Taylors Beach Road causeway from CH 2120 to CH 2370 for a nominal width of 7.2m.
2. Horizontal and vertical alignments are to be confirmed onsite following the existing as best as practical. Any discrepancies or major variations are to be approved by Council's IOS Manager.
3. Check existing surface to ensure there are no existing potholes, soft spots, height discrepancies or major pavement defects prior to sealing and repair as required.
4. Top dress all new asphalt surfaces with an approved material to ensure no edge drop-offs are present.
5. Relinemark Taylors Beach Road as per existing and in accordance with the MUTCD.
6. Reinstall any disturbed guide posts and flood height indicator signs as required and as per existing. Re-use existing posts and signs where possible and ensure are evenly spaced.
7. All chainages are to be confirmed onsite to ensure works are positioned correctly.
8. Locate all existing services and ensure depths to these are sufficient prior to commencing any construction works.
9. Locate and protect any survey pins or marks prior to commencing any works.
10. All works are to be undertaken in accordance with the MUTCD Part 3: Works on Roads.

LEGEND:



New Asphalt Overlay
(approx. area 1800m²)

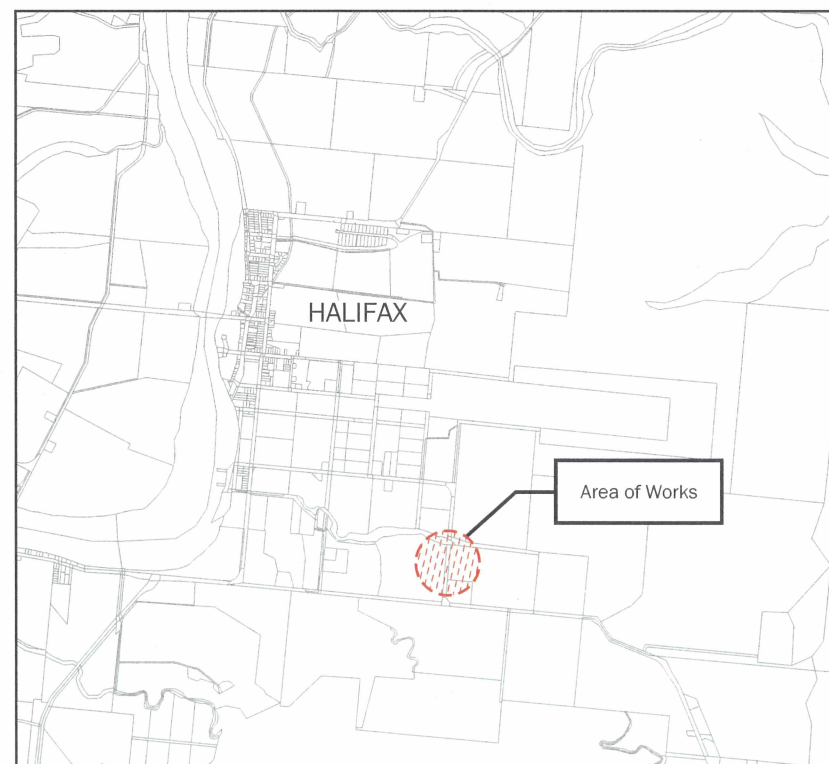
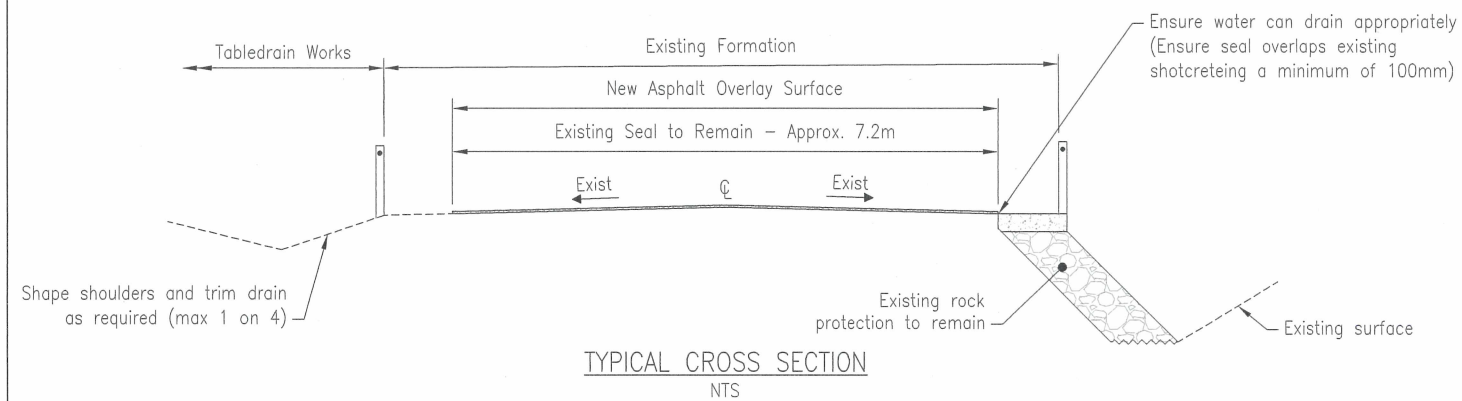

LOCALITY PLAN
NTS

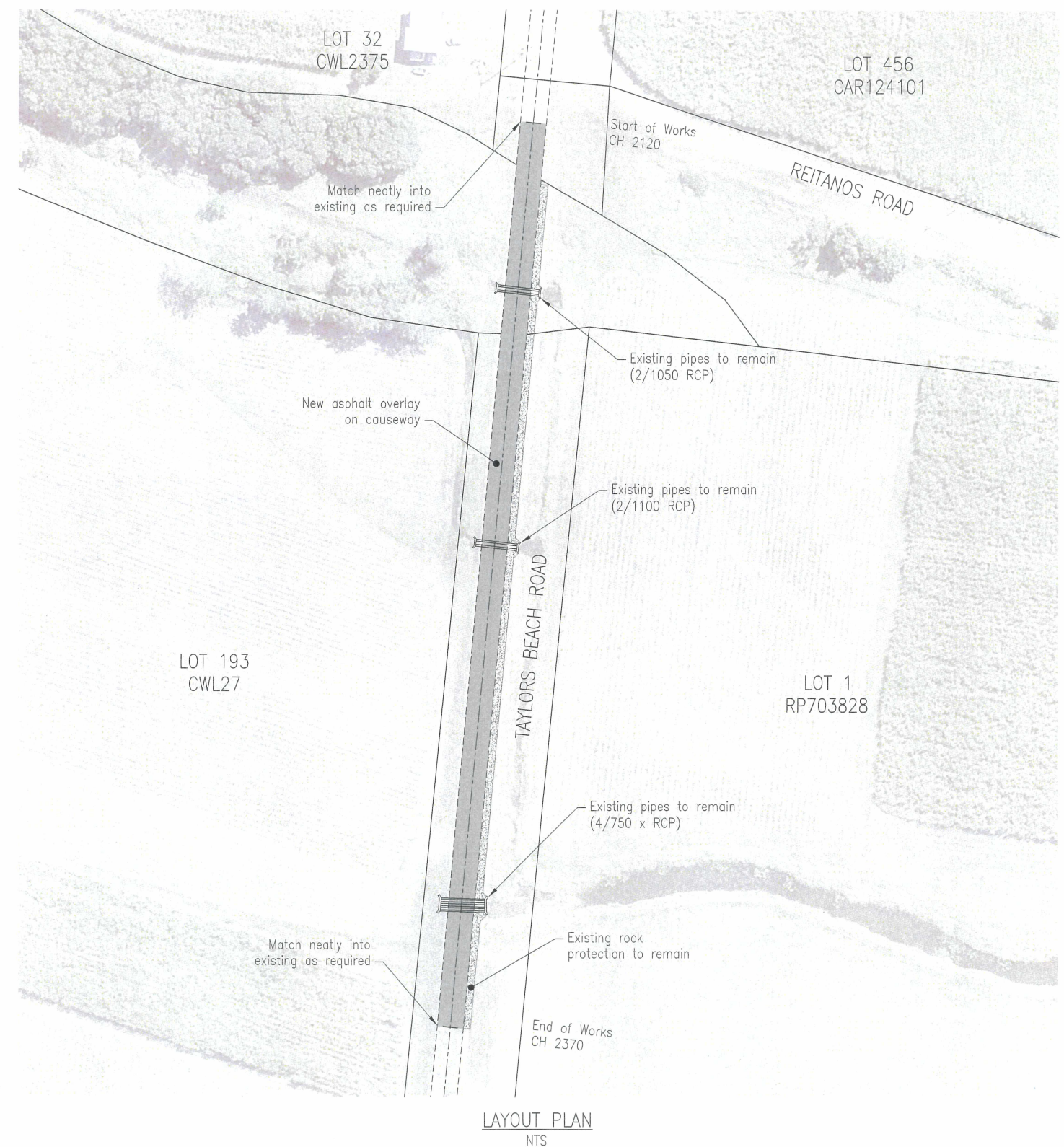

LAYOUT PLAN
NTS

[illegible]