

**Button specification**

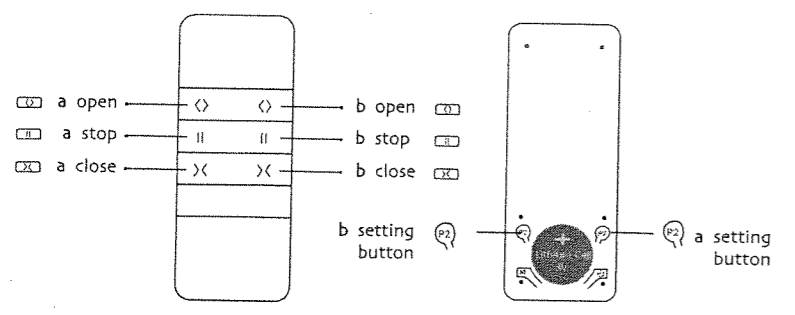

Note: the following instructions all take the "a" as an example.

**1 Setting up**

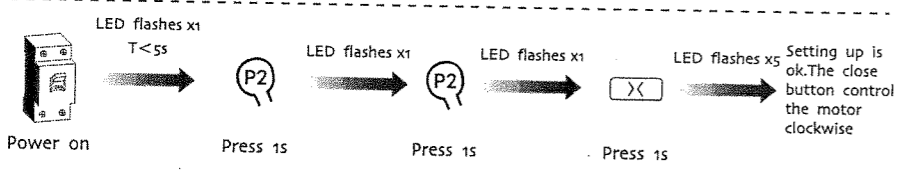
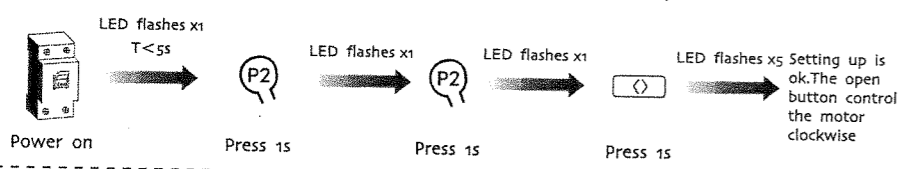

Note: Motor has been matched the code, don't use this method; Press the open button, if the curtain closed, please perform the reverse of direction setting.

**2 The reverse of direction setting**

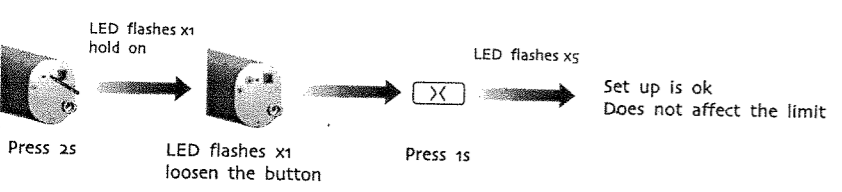

**3 Add emitter**

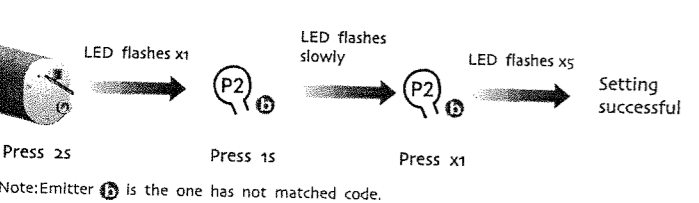

Note: Emitter ① is the one has not matched code.

**4 Touch-start**

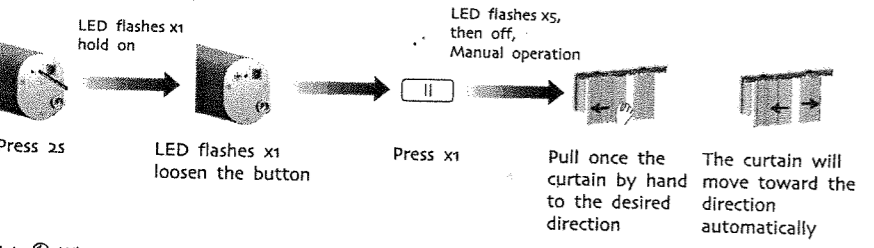

Note: ① When operate the curtain by hand, never force to pull the curtain, which will damage the track and the fabric; ② If need to close manual function, please repeat above operation; ③ Manual operation is default.

**5 Set limit position**

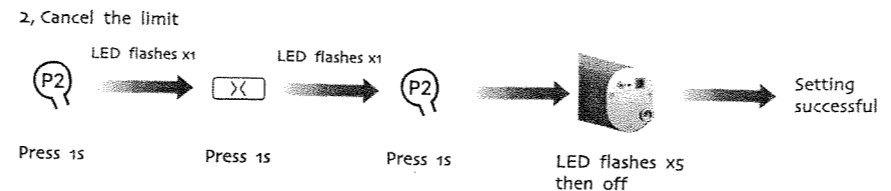
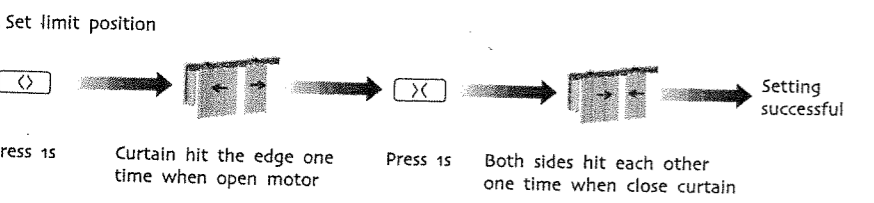

**6 Manually set limit**

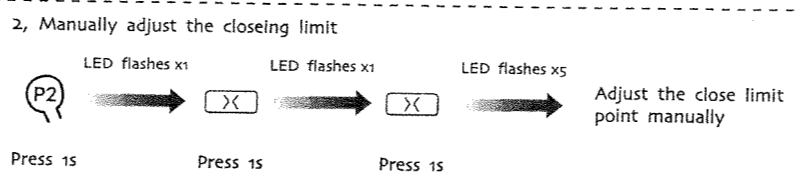
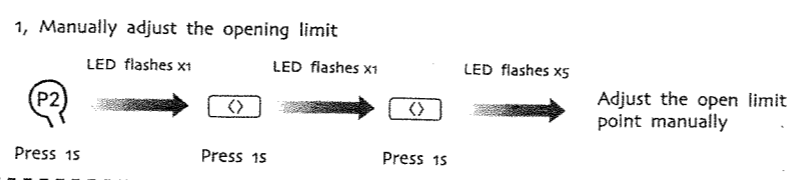

Note: The manual set limit should be with in the range of the the auto-set limit . If the manual set limit is faulty , you can repeat the setting procedure to delete it, then reset.

**7 The third limit setting**

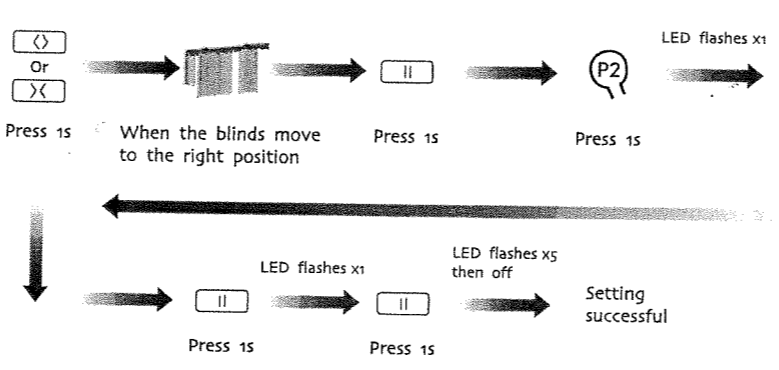

Note: Clear third limit point method and set the limit point; Long press the stop button for 2s, the blind moves to the third limit automatically;

**8 Weak Electric Switch Mode Selection**

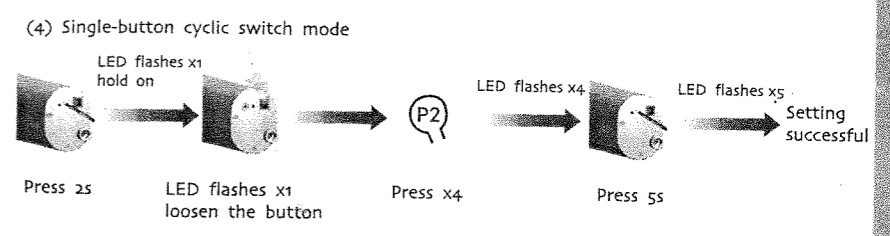
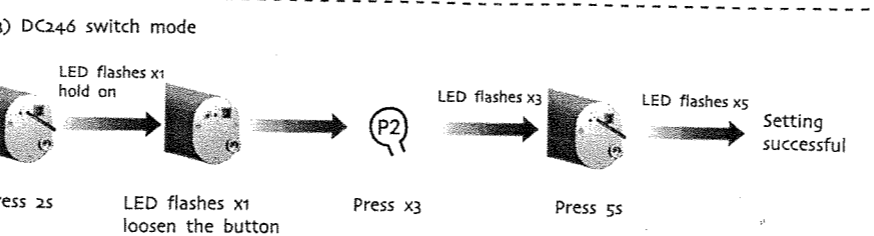
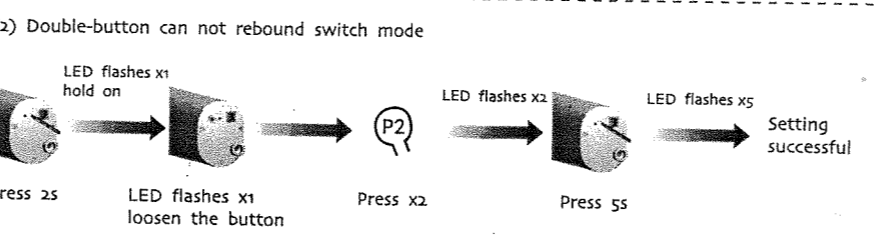
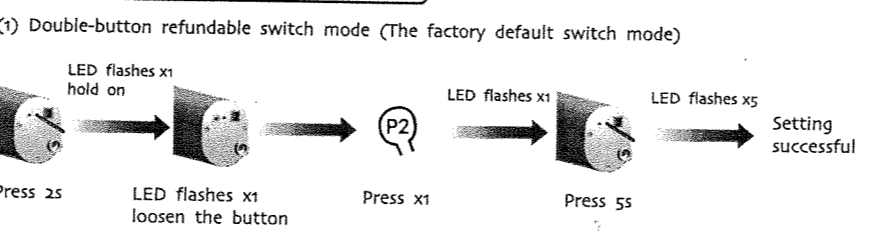

**9 Restore factory settings**

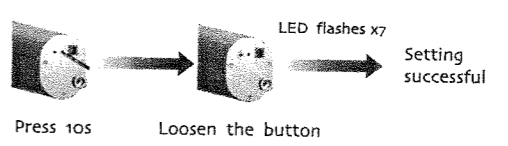

**FAULT AND SOLUTION**

NUMBER	COMMON FAULTS	CAUSE ANALYSIS AND TREATMENT METHOD
1	The motor is not running	Check whether the batteries are charged
2	Unable to control remote controller	Replace emitter
3	Remote control on the contrary	Replacement the reverse of direction setting
4	Remote switch on the contrary	Replacement switches line order
5	Cannot close	1, Check emitter's open button to ensure if it works with open function, if not, please change direction firstly; 2, Check limit position;
6	Always hit or couldn't get to the edge	Cancel the limit, setting again
7	With the hand to pull, feeling stuck	Set the limit of the trip
8	Encounter obstacles will not stop	Check the screw used to fixed orbital