

# Born.

## ASSEMBLY INSTRUCTIONS

PROFESSIONAL TABLE EASEL

JBA13109

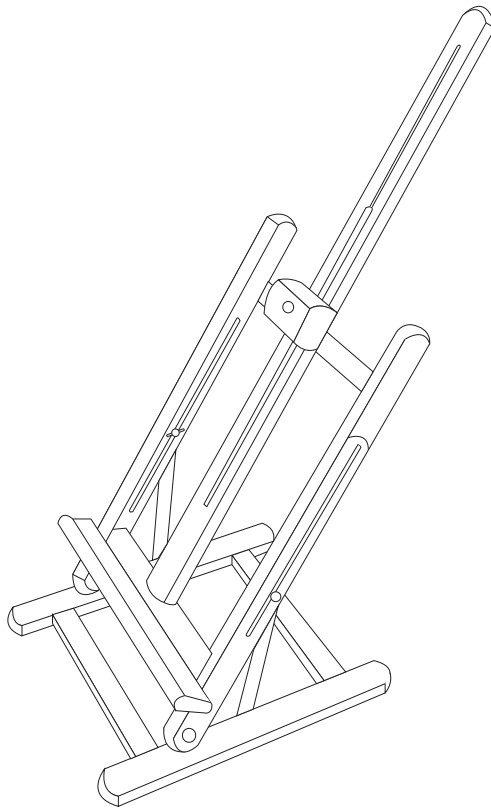

Assembled easel size: 28W x 32D x 96H cm

Fits maximum canvas size: 22" (55cm)

Material: Beechwood

## Assembly

### Step1

Unscrew A. Take out the wooden centre beam first.

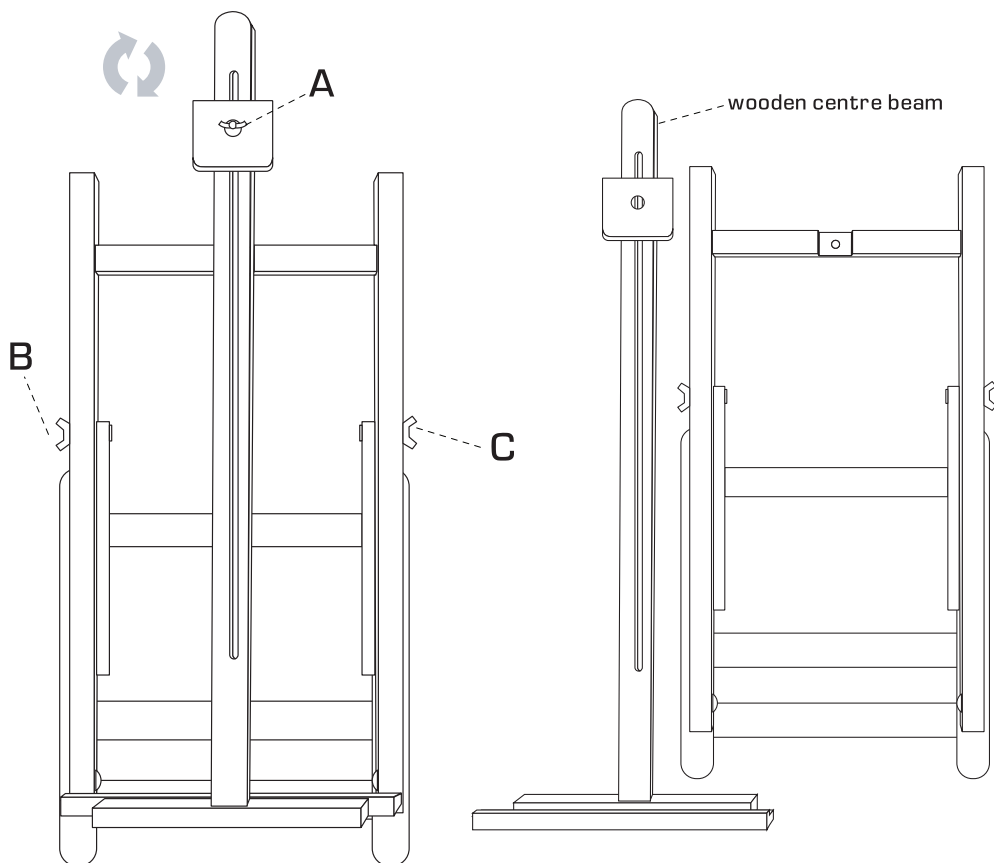

## Assembly

### Step2

Please put the wooden centre beam into, and unscrew B and C to adjust the easel inclination and then tighten the 2 nuts.

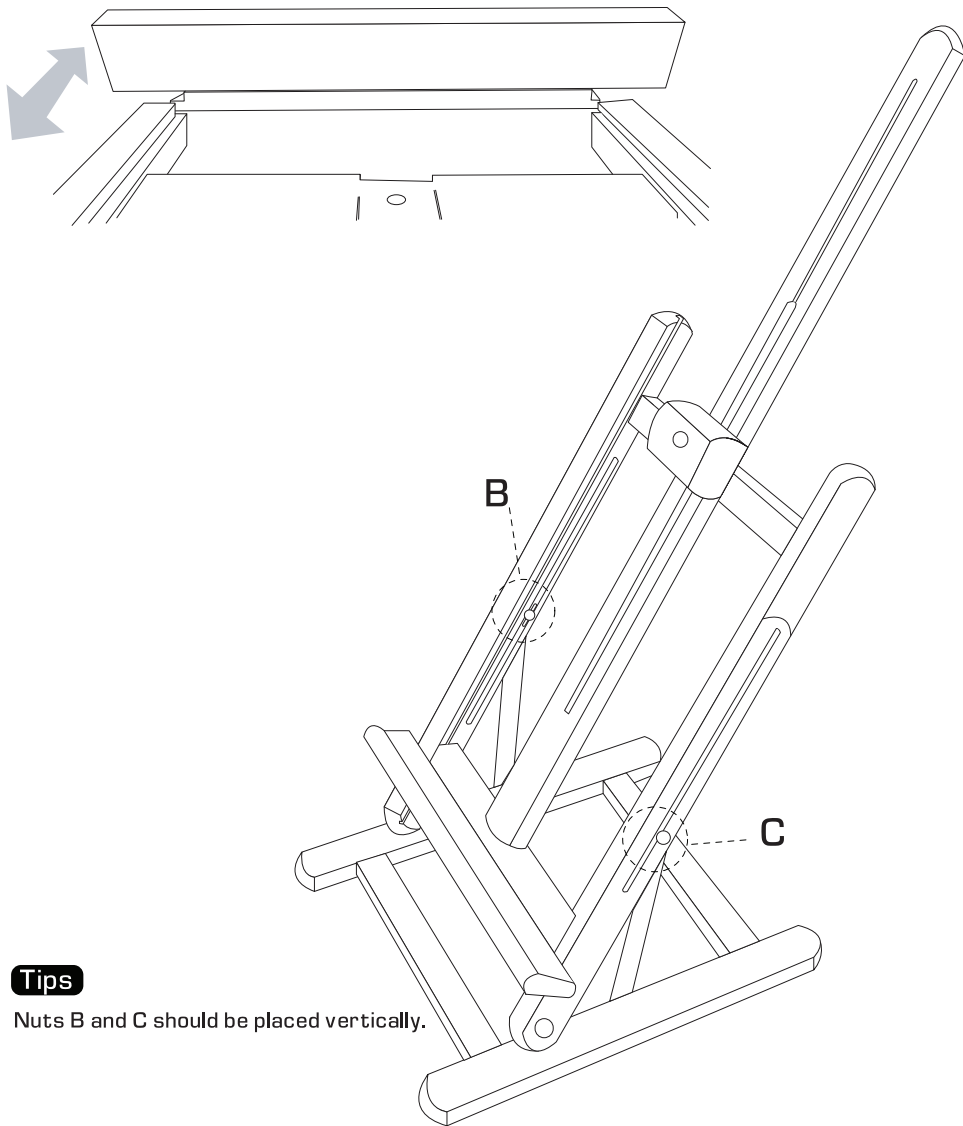

### Tips

Nuts B and C should be placed vertically.

## Assembly

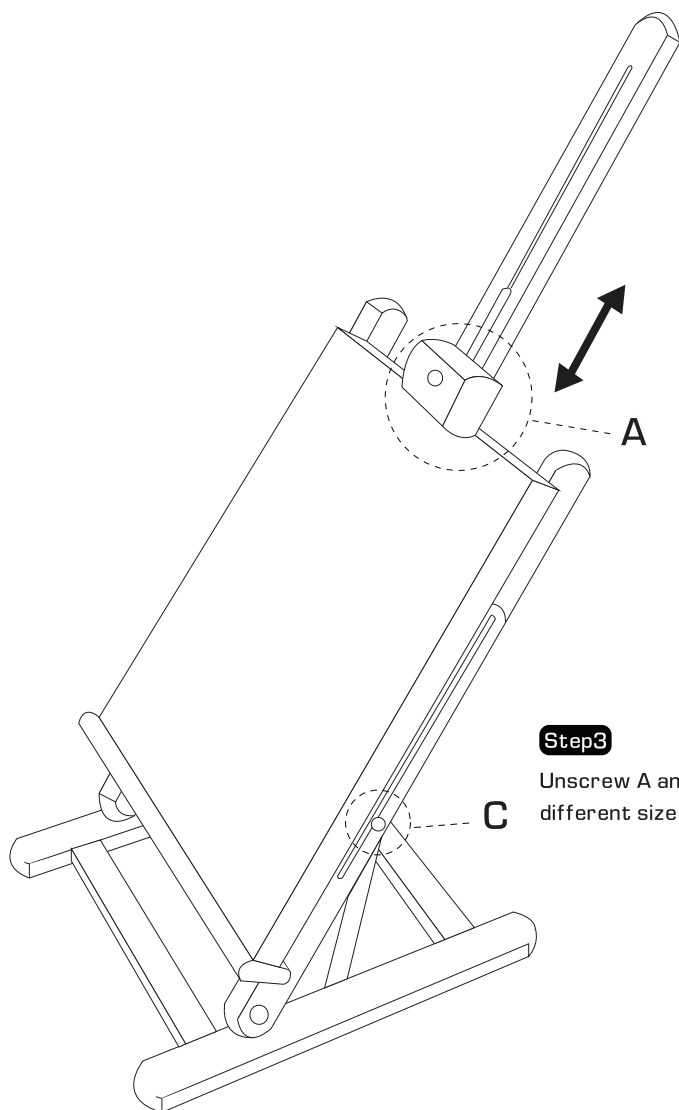

### Step3

Unscrew A and lift the wooden block to fit different size canvas, then tighten the nuts.

## **Product Warranty – Valid for Australian Customers Only**

Officeworks Ltd warrants that this product will be free from defects and work as intended for 3 years from the date of purchase by the original customer.

If the product has any defects or does not work as specified during the Warranty Period, Officeworks will, at its election and at its expense, repair or replace the product.

This warranty does not apply:

- to cosmetic damage;
- to damage caused by consumables used in connection with the product;
- where the product has not been used in accordance with all provided instructions;
- to damage arising from fair wear and tear;
- where the product has not been subject to reasonable use;
- where the product has been intentionally or negligently damaged; and/or
- if the customer has attempted to repair the product.

To make a claim under this warranty, please return your product with your receipt or proof of purchase to your nearest Officeworks store or contact 1300 633 423.

This warranty is provided in addition to any rights you may be entitled to under the Competition & Consumer Act 2010. Our goods come with guarantees that cannot be excluded under the Australian Consumer Law. You are entitled to a replacement or refund for a major failure and compensation for any other reasonably foreseeable loss or damage. You are also entitled to have the goods repaired or replaced if the goods fail to be of acceptable quality and the failure does not amount to a major failure.

OFFICEWORKS LTD



Thank you for your purchase. Please retain your receipt to validate warranty.

If you would like to know more about our Born art range, please visit [www.officeworks.com.au](http://www.officeworks.com.au)