

LiteWORKS™

INSTALLATION INSTRUCTIONS

Product Name: Clarke

Model No.: AUL1027

Description: 1Lt Floor Lamp

Rated Voltage: 220-240V~, 50Hz,

Max Wattage: MAX 28W

Globe Type: E27

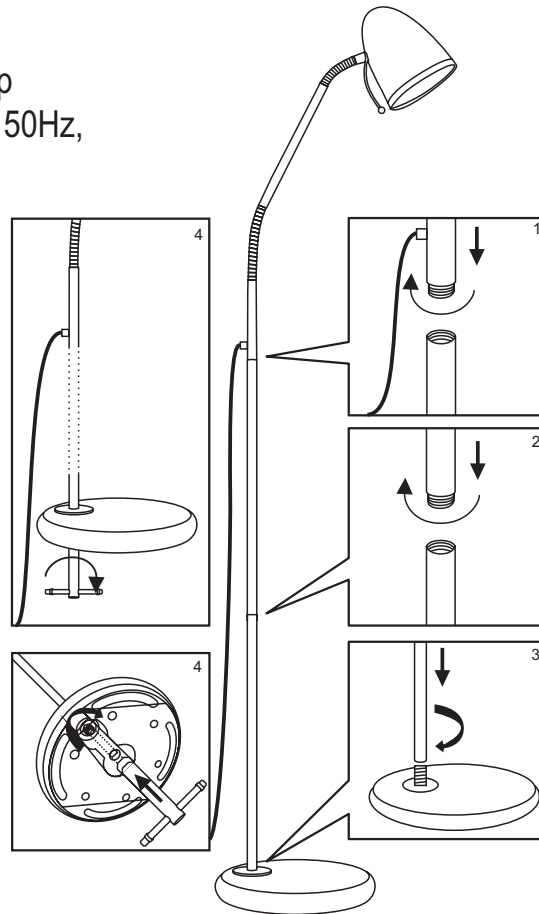

- This appliance is not intended for use by young children or infirm persons unless they have been adequately supervised by a responsible person to ensure that they can use the appliance safely. Young children should be supervised to ensure that they do not play with the appliance.
- If the supply cord is damaged, it must be replaced by the manufacturer, its service agent or similarly qualified persons in order to avoid a hazard.
- The bulb, lamp holder or shade may get hot when the lamp is operating, do not touch them to avoid a hazard.
- To prevent damage to the appliance do not use alkaline cleaning agents when cleaning. Use a soft cloth and a mild detergent. Always switch off before cleaning.
- Failure to maintain the lamp in a clean condition could lead to deterioration of the surface that could adversely affect the life of the appliance and possibly result in a hazardous situation



WARNING: FIRE RISK EXISTS IF THE LAMP IS COVERED BY OR POSITIONED CLOSE TO CURTAINS OR OTHER COMBUSTIBLE MATERIALS