



Assembly Instructions
Velocity Desk
1500 wide & 1800 wide
2 CARTONS



MANUFACTURER CODES: VD157 & VD189
OW CODES: CPVELDSKGB, CPVELD15BW,
CPVELDSKGR, CPVELDSKWH, CPVELD15WI,
CPVELDKLGB, CPVELD18BW, CPVELDKLGR,
CPVELDKLWH, CPVELD18WI



manufactured by designtec
www.designtec.com.au

10
YEAR
WARRANTY

NOTE

Please check you have all hardware before assembling.

If you are missing any hardware, please contact the store of purchase.

Please ensure you have the name of the item, required hardware part and quantity.

Please retain your receipt as proof of purchase to validate your warranty.

CAUTION

Do not tighten screws before all screws are in the right place.

Do not use this product unless all bolts, screw and knobs are firmly secured.

Check that all bolts, screws and knobs are securely tightened at least every 4 months.

WARNING

If parts are missing, broken, damaged or worn stop using the product until all repairs are made using manufacturer authorised parts.

Failure to follow these warnings could result in serious injury.

TOOLS REQUIRED FOR ASSEMBLY

1 x Philips Head Screwdriver

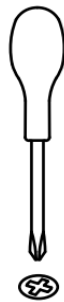

HARDWARE INCLUDED

Note - Individual hardware images are not to scale.

A - ADJUSTABLE FOOT



x 4

B - PIN



x 12

PRE-INSERTED HARDWARE

CAM HOUSING

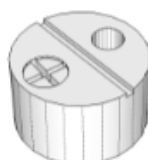

STEP 1

Insert six (6) PINS (B) into pre-drilled holes on end panels using your screwdriver.

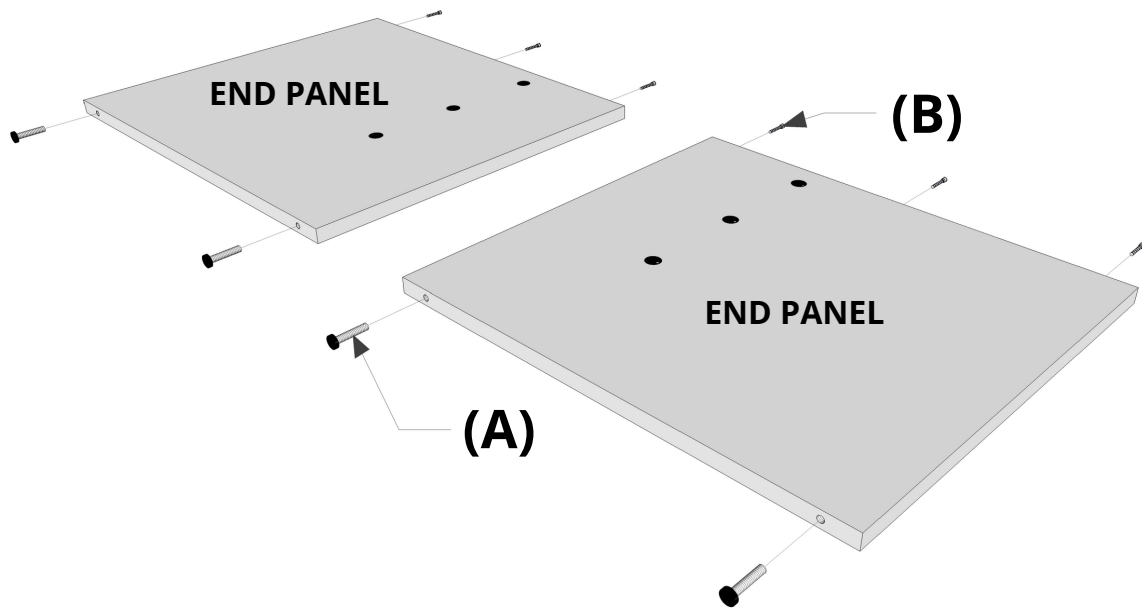

STEP 2

Insert four (4) ADJUSTABLE FEET (A) into pre-inserted threaded sleeve.

STEP 3

Insert six (6) PINS (B) into pre-drilled holed on each end of your modesty panel using your screwdriver.

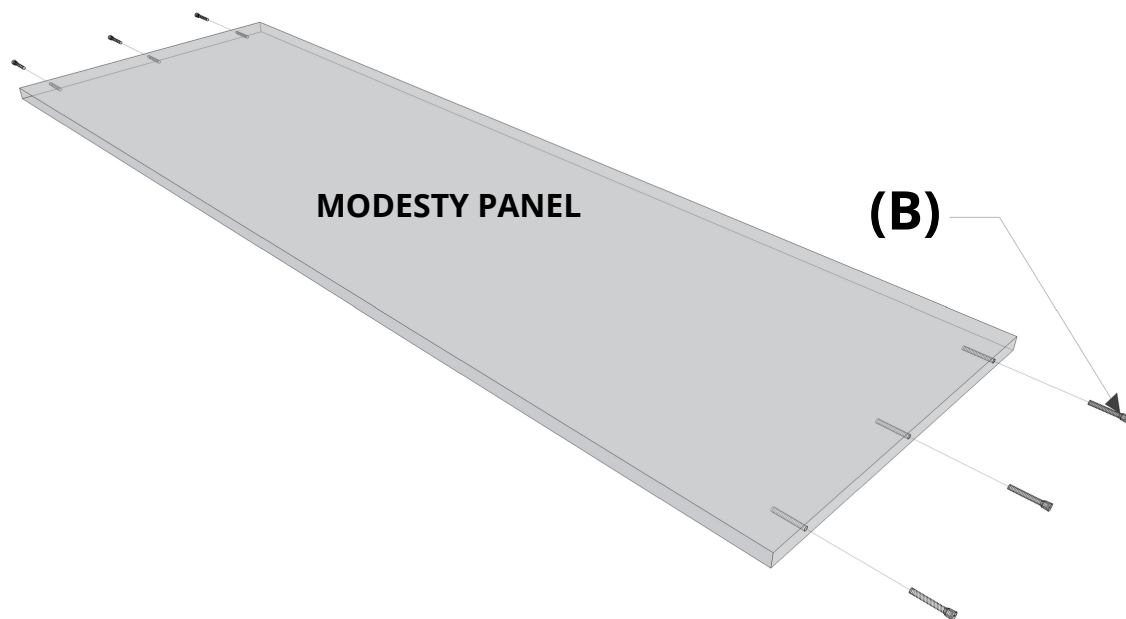

STEP 4

Aligns the PINS (B) on the modesty panel with the pre-inserted CAM HOUSING on the end panels and tighten with your screw driver by rotating screw to the right.

IMPORTANT NOTE: The offset pins need to be facing in front/inside of the desk. If you cannot access the CAM HOUSING screw for tightening then you need to rotate the modesty panel.

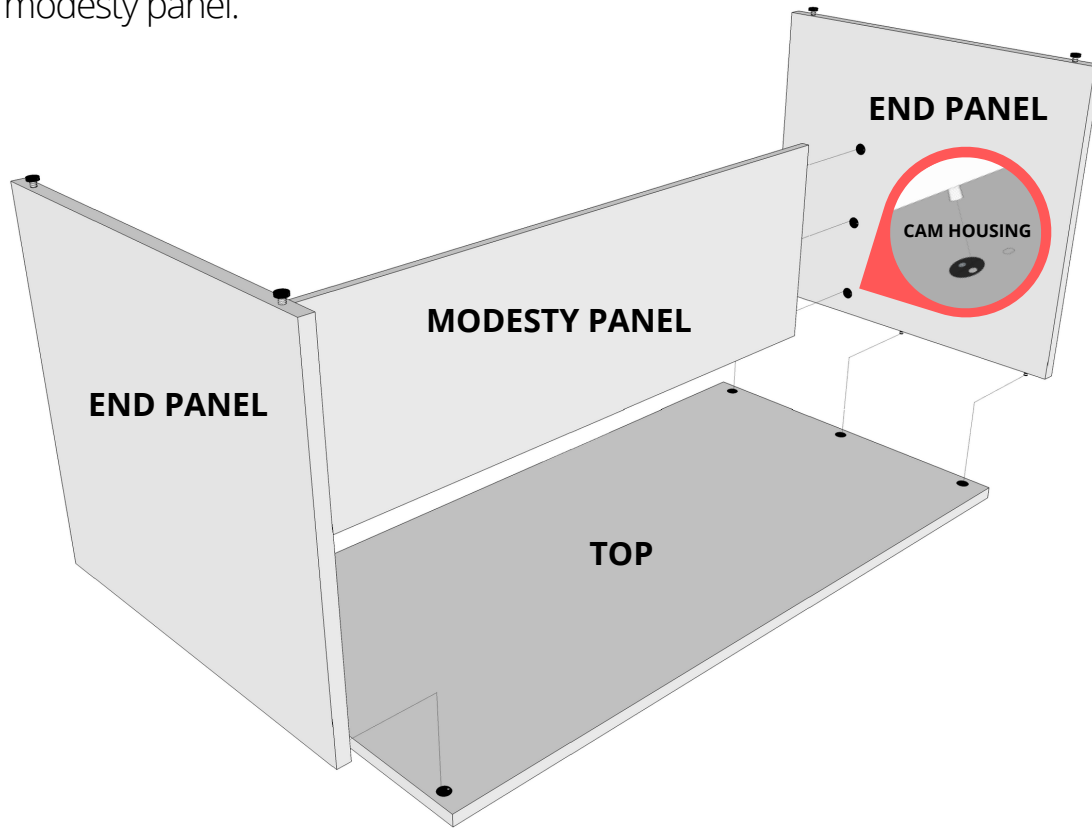

STEP 5

Aligns the PINS (B) on the end panels with the CAM HOUSING on the underside of the top and tighten with your screw driver by rotating screw to the RHS.

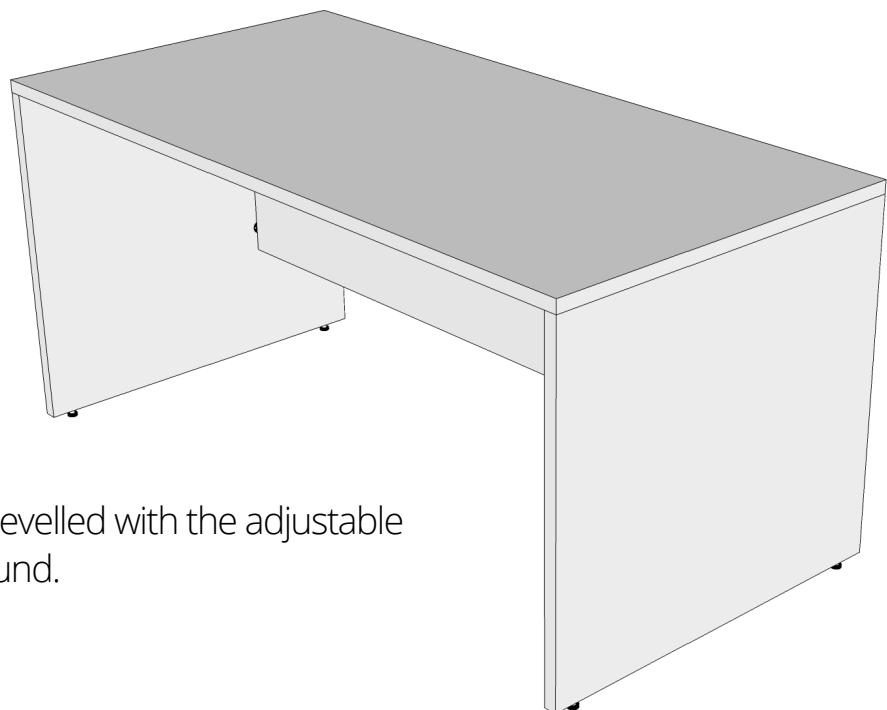

TIP: The desk can be levelled with the adjustable feet if on un-even ground.