



Assembly Instructions Velocity Round Table

1 CARTON



MANUFACTURER CODE: VRT9X
OW CODES: CPVELRT90B, CPVELRTGR, CPVELRTWH,
CPVELRT90W

manufactured by designtec
www.designtec.com.au

10
YEAR
WARRANTY

NOTE

Please check you have all hardware before assembling.

If you are missing any hardware, please contact the store of purchase.

Please ensure you have the name of the item, required hardware part and quantity.

Please retain your receipt as proof of purchase to validate your warranty.

CAUTION

Do not tighten screws before all screws are in the right place.

Do not use this product unless all bolts, screw and knobs are firmly secured.

Check that all bolts, screws and knobs are securely tightened at least every 4 months.

WARNING

If parts are missing, broken, damaged or worn stop using the product until all repairs are made using manufacturer authorised parts.

Failure to follow these warnings could result in serious injury.

TOOLS REQUIRED FOR ASSEMBLY

1 x Philips Head Screwdriver

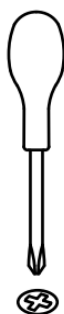

HARDWARE INCLUDED

Note - Individual hardware images are not to scale.

A - ADJUSTABLE FOOT



x4

B - PIN



x6

C - CONFIRMAT SCREW



x2

PRE-INSERTED HARDWARE

CAM HOUSING

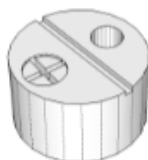

STEP 1

Take one HALF LEG panel and align the central pre-drilled hole with the pre-drilled holes on the FULL LEG. Insert two (2) CONRIFMAT SCREWS (C) through the face of FULL LEG and tighten with your screwdriver until the HALF LEG panel is secure.

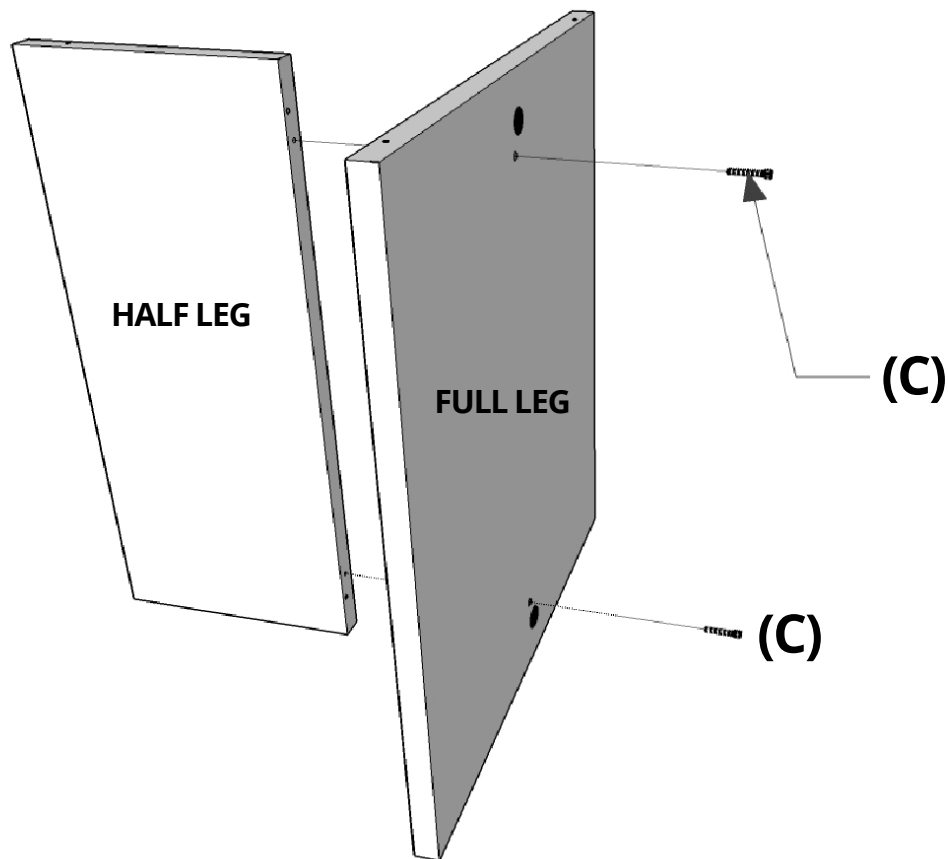

STEP 2

Insert two (2) PINS (B) into the offset pre-drilled holes with your screwdriver.

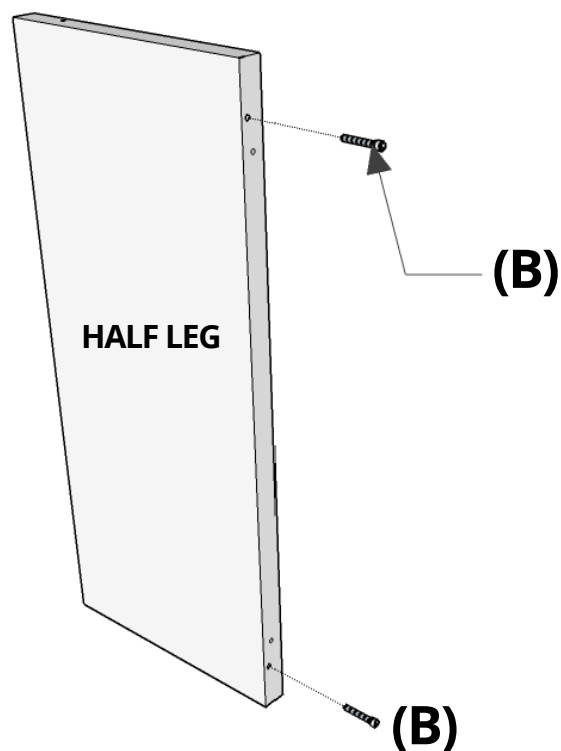

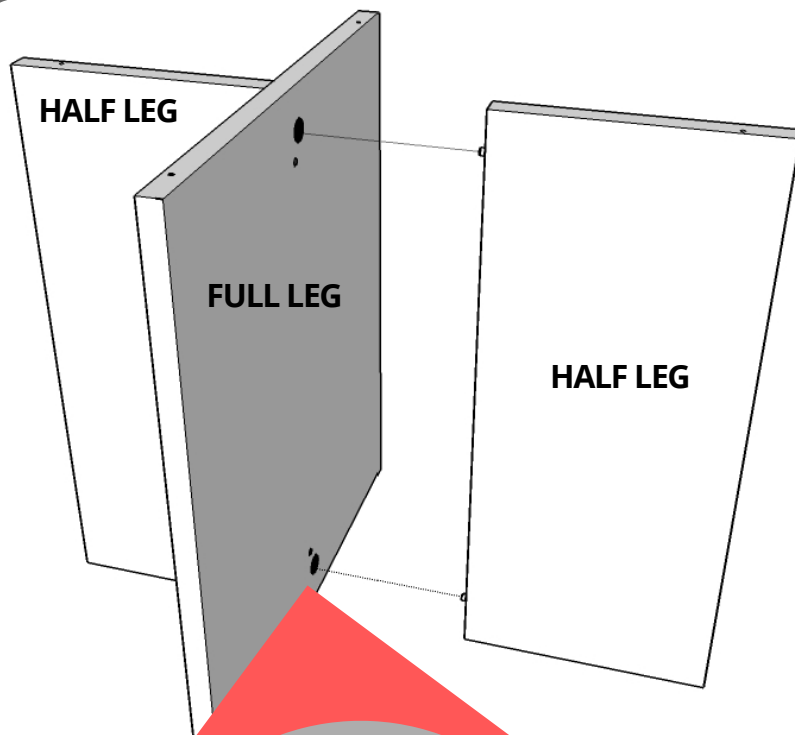

STEP 3

Align PINS (B) with the pre-inserted CAM HOUSING on the full leg. Tighten CAM HOUSING by rotating the screw to the right hand side with your screwdriver. Forming your table base.

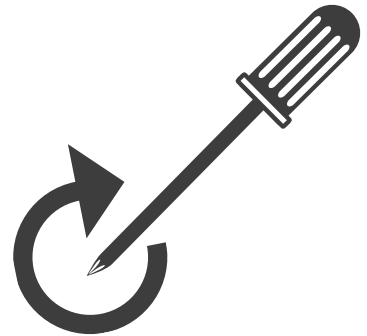

STEP 4

Insert four (4) PINS (B) into pre-drilled holes as shown on drawing.

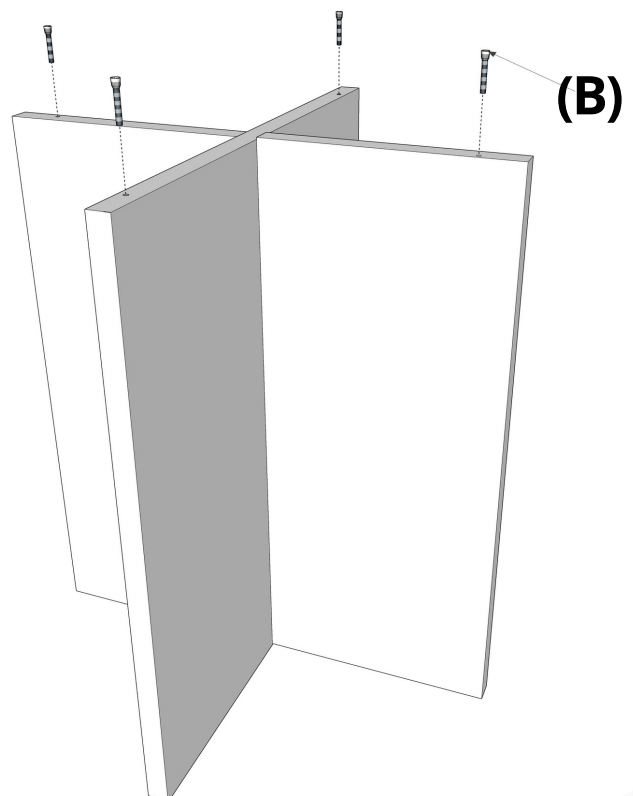

STEP 5

Rotate base around and align the PINS (B) with pre-inserted CAM HOUSING on the underside of the top. Tighten by rotating the cam screw to right hand side with your screw driver. Then insert four (4) ADJUSTABLE FOOT (A) into pre-inserted threaded sleeve on base. Once complete turn table upside down so it is now upright.

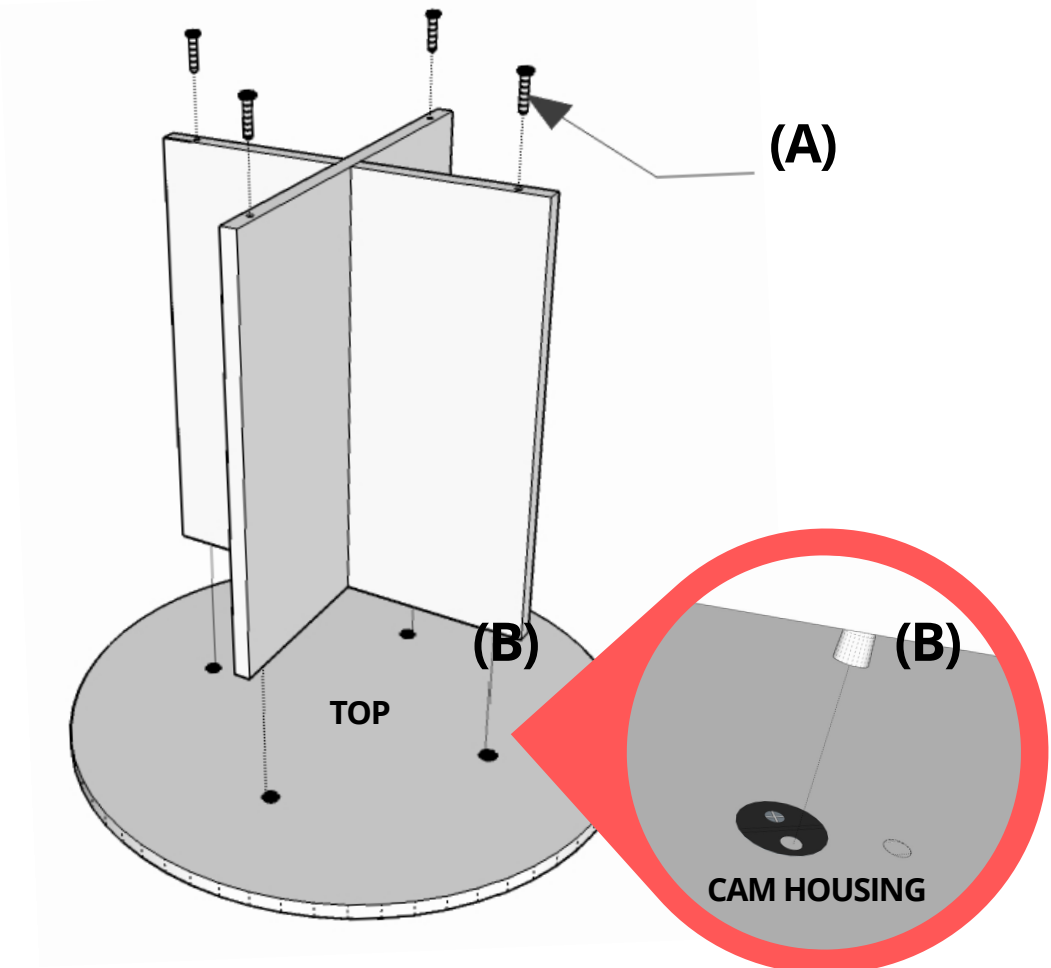

TIP: Feet can be adjusted to level the table on un-even floor.

