

Product Alignment

Window Opener/Vent Handle Orientation

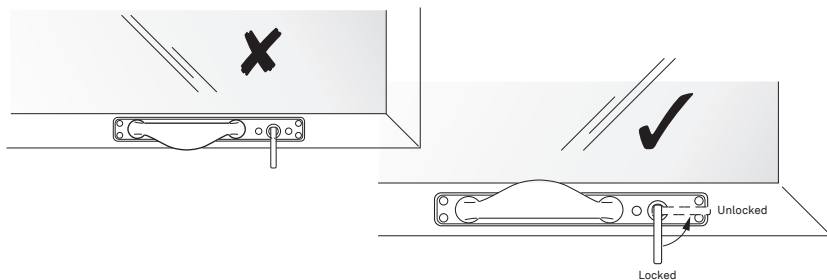

NOTE: The drive rose is always biased towards the outer frame, transom or mullion (not the glass).

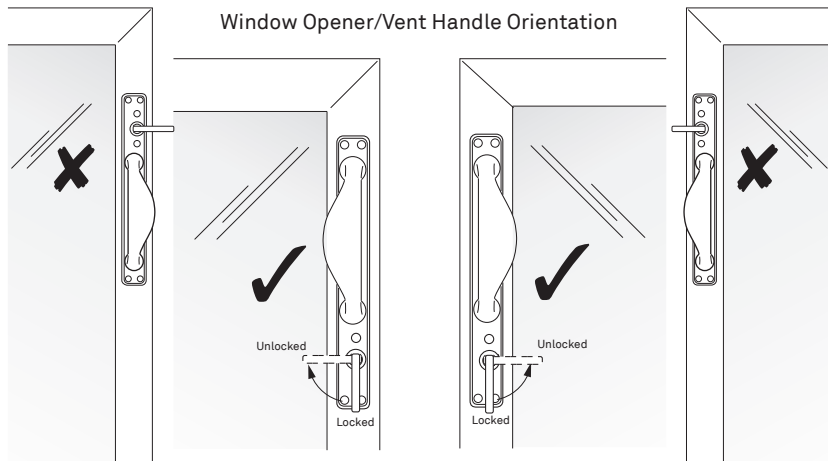
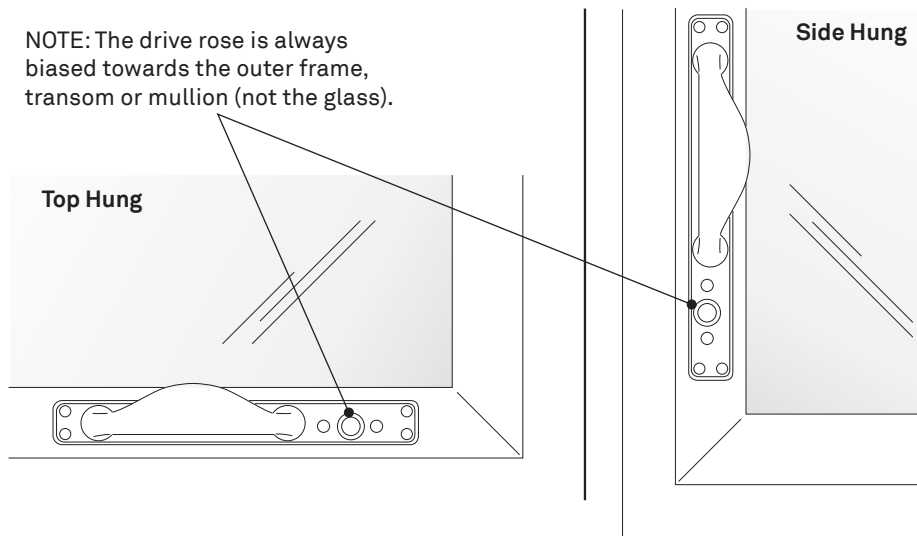

SAFEHINGE PRIMERA

SOP092 Revision (1)

Anti-ligature Window Handle Fitting Instructions

Primera anti-ligature window handles are not a DIY product. Installation should be carried out by a qualified trade person suitably equipped to facilitate a professional installation. These guidelines serve only to provide additional guidance on some of the more specific issues relating to the installation of these products.

Only use the anti-tamper screws provided. Do not use impact drivers.

Window Handling Table Viewed Internally (From Inside)

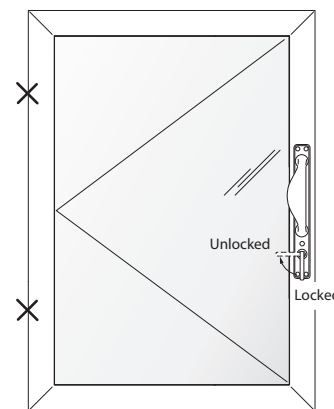

Side Hung Fig 4

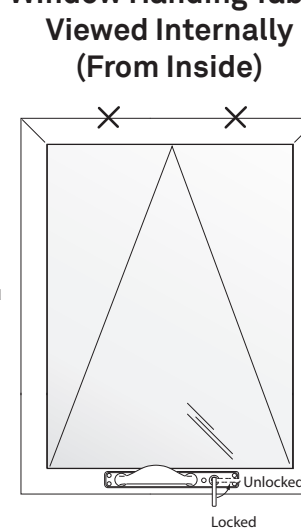

Top Hung Fig 3

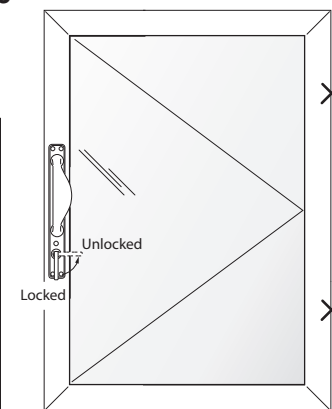

Side Hung Fig 3

Part Number	Supplied	Page	Part Number	Supplied	Page
PR-8PHSO	<input type="checkbox"/>	2	PR-8PHS6-CESP BKR	<input type="checkbox"/> <input type="checkbox"/>	4
PR-8PHS1-STD	<input type="checkbox"/>	2	PR-8PHS6-LL	<input type="checkbox"/>	5
PR-8PHS2-SKA	<input type="checkbox"/>	3	PR-8PHS4-CAM	<input type="checkbox"/>	6
			PR-8PHS5-CML	<input type="checkbox"/>	7

Note: See page 8 for correct orientation of anti-ligature window handles & correct orientation of the drive rose.

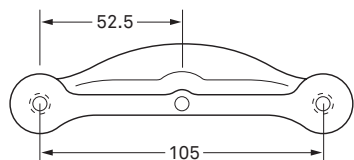

Fig A

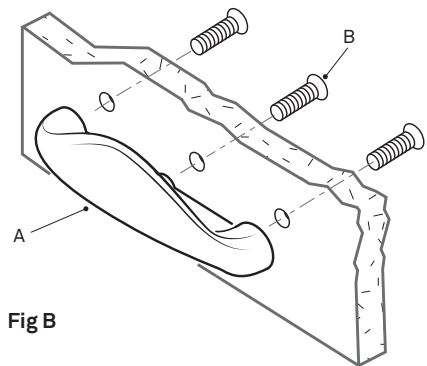

Fig B

PR-8PHSO

- Using the size guide shown at Fig A, carefully mark out the three fixing positions and drill through holes using a 6.5mm drill bit. When drilling ensure horizontal drill alignment and take care to avoid splashing.
- Using the M6 x 25mm c/s machine screws provided marked 'B', tighten handle 'A' firmly and securely into position as shown in Fig B.

Item	Qty
A Anti-ligature pull handle	1
B M6 x 25mm c/s machine screws	3

PR-8PHS5-CML

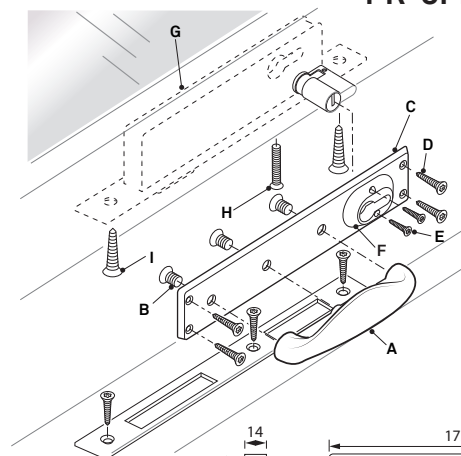

Fig A

Fig B

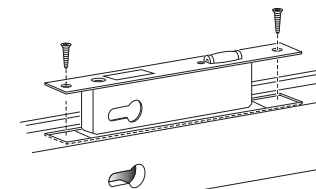

Fig C

Showing bottom rail of vent inverted

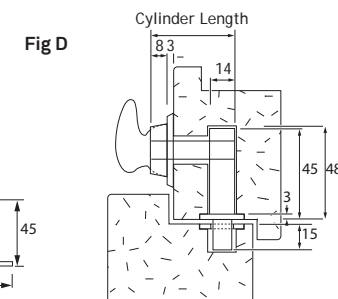

Fig D

Warning: Before beginning to install this product please ensure that the vent rail is of sufficient proportion to adequately accommodate the roller-bolt sash-lock without breaking through into the glazing chamber. Failure to do so may result in damage to the glass. **Note:** It is recommended that the vent be removed from the outer frame before commencing work on the installation of this product.

- Carefully align the fixing holes of back-plate 'C' with the tapped holes in handle 'A' and firmly secure together using the three M6 x 10mm c/s machine screws marked 'B' supplied Fig A.
- Align escutcheon 'F' to back-plate 'C' and secure in position with the two screws provided.
- Calculate optimum position on vent for handle assembly. Using the cylinder position as a datum, mark out on the outer rebate of the vent for a mortise pocket 175mmL x 14mmW x 48mmD. The optimum position for the mortise from the face of the vent will be governed by the length of cylinder. The installer should calculate that the face of the cylinder does not protrude too far beyond the escutcheon.
- Offer the lock into the mortise and mark out for the face-plate. Create a recess for the face-plate so that the lock sits flush. Remove the lock.

Item	Qty
A Anti-ligature pull handle	1
B M6 x 10mm c/s machine screws	3
C Back-plate 225mm x 38mm x 3mm	1
D No 6 x 3/4" anti-tamper fixing screws	4
E No 4 x 3/8" anti-tamper fixing screws	2
F Narrow escutcheon	1

- Again, using the cylinder position as the datum create a recess of sufficient proportion to accommodate the cylinder body. This will break into the mortise pocket. Remove all debris and any loose timber.
- Fasten the roller-bolt sash-lock into position with the screws provided. See Fig C. Install the cylinder (not supplied) using the M5 cylinder retaining machine screw. Using the key supplied with the cylinder check the lock functions properly.
- Offer the handle, back-plate and escutcheon assembly over the cylinder protrusion and mark out the screw positions in the four corners of the plate. Use a small bit and drill four pilot holes before fastening the assembly firmly back to the vent with the screws provided. 'D'
- Check that there are no gaps between the back-plate and vent and that the assembly is secure.

Item	Qty
G Roller-bolt lockcase	1
H M5 x 40mm c/s machine screws	1
I No 8 x 1 1/4" anti-tamper fixing screws	2
J No 6 x 1" c/s machine screws	3
K Faceplate 174mm x 25mm	1
Cylinder not included	

PR-8PHS1-STD

- Carefully align the fixing holes of back-plate 'C' with the tapped holes in handle 'A' and firmly secure together using the three M6 x 10mm c/s machine screws marked 'B'. 2. After checking the correct orientation of the handle (See Page 8) offer the assembly onto the window vent and use a pencil to mark the four fixing positions in each corner.
- Set aside the handle assembly and use an appropriate sized drill bit* to create four pilot holes.
- Firmly secure the handle into place using the four No 6 x 3/4" c/s anti-tamper screws provided.

* The size of the drill bit will be governed by the type (Wood, PVCu or Aluminium) and wall thickness of material being fastened into.

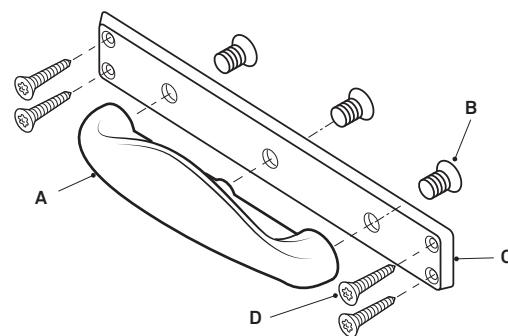

Item	Qty
A Anti-ligature pull handle	1
B M6 x 10mm c/s machine screws	3
C Back-plate 200mm x 26mm x 3	1
D No 6 x 3/4" anti-tamper fixing screws	4

PR-8PHS4-CAM

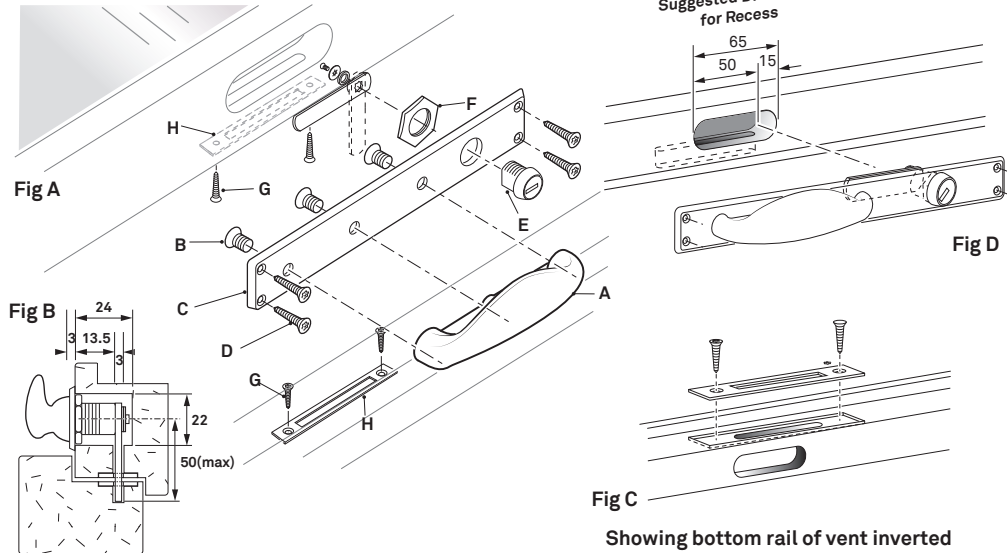

Note: It is recommended that the vent be removed from the outer frame before commencing work on the installation of this product.

1. Decide the optimum fixing position for the handle assembly on the vent ensuring that there is sufficient clearance to avoid damage to the glass.
2. Carefully align the fixing holes of back-plate 'C' with the tapped holes in handle 'A' and firmly secure both components together using the three M6 x 10mm c/s machine screws marked 'B' provided.
3. Install the cam-lock assembly into the back-plate as illustrated at Fig A. Leave the cam-arm in the horizontal position (in line with the back-plate).
4. With the vent removed and laid flat, calculate the optimum position for the centre of the cam-lock on the vent and create a blind recess: 65mmL x 22mmH x 24mmD as shown at Fig B & C. The position of the cam-lock from the edge of the vent will largely be dictated by how much free space there is.
5. Mark a pencil line indicating the centre-point of the cam-lock on the edge of the vent (outer rebate) and create a 6mm x 50mm slot breaking into the recess created earlier on the face of the vent. Remove all debris and any loose timber.

6. Offer the handle assembly onto the vent and use the key to check the free movement of the cam-arm. With the cam-arm in the locked position (at right angles to the back-plate) mark out for the metal cam-arm guide plate and recess into the frame using two of the No 4 x ½" screws provided.
7. Check alignment and fasten the handle assembly onto the face of the vent using the four No 6 x ¾" screws provided.
8. Re-install the vent back into the outer frame
9. Mark out for the strike plate in the rebate of the outer frame and recess in accordingly. Secure in place using two No 4 x ½" screws provided.
10. Check function of lock and that the key can be removed in both locked and unlocked positions. If not adjust accordingly.
11. Ensure that there are no gaps between the back-plate and surface of the vent and that the assembly is securely fastened in place.

Item	Qty	Item	Qty
A Anti-ligature pull handle	1	E Cam-lock complete	1
B M6 x 10mm c/s machine screws	3	F Lock nut	1
C Back-plate 225mm x 30mm x 3mm	1	G No 4 x ½" anti-tamper fixing screws	4
D No 6 x ¾" anti-tamper fixing screws	4	H Strike plate 105 x 15mm	2

PR-8PHS2-SKA (For espagnolette mechanisms)

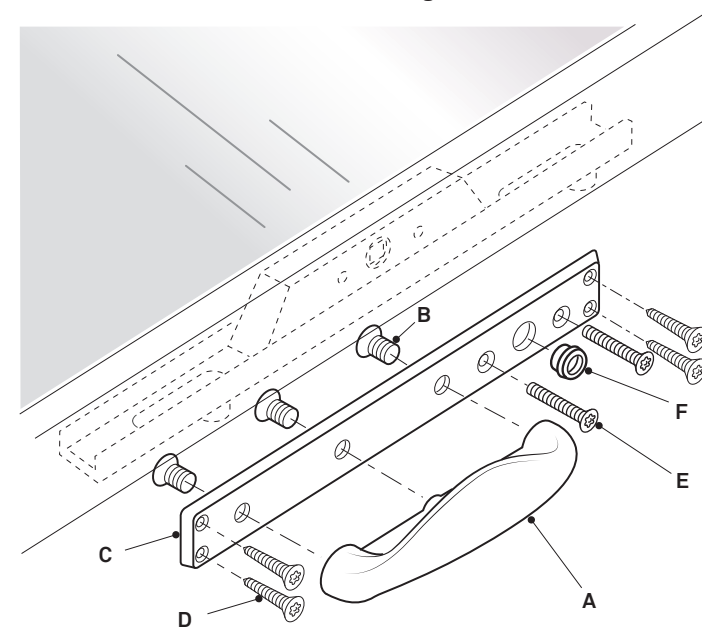
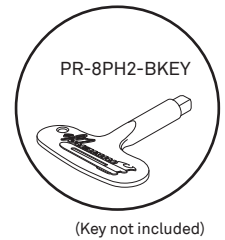

Fig A



1. Carefully align the fixing holes of back-plate 'C' with the tapped holes in handle 'A' and firmly secure together using the three M6 x 10mm c/s machine screws marked 'B' provided.
2. Press fit the black nylon insert 'F' into the hole in the face of plate 'C'.
3. After checking the correct orientation of the handle (See Page 8) offer the assembly onto the window vent and align the nylon bush directly over the square follower of the espagnolette mechanism.
4. Initially secure the plate into position using the two M5 x 40mm machine screws 'E' (pre-cut to length) fastened into the screw ports of the espagnolette mechanism. **Do not overtighten as this will introduce unnecessary friction.**

5. Use an appropriate sized drill bit* to pilot the holes in each corner and use the four No 6 x ¾" anti-tamper fixing screws provided to conclude the installation.
 6. Check that the handle assembly is firmly and securely fastened to the vent and that the square PH2-BKEY (not included) operates the lock without excess force.
- * The size of the drill bit will be governed by the type (Wood, PVCu or Aluminium) and wall thickness of material being fastened into.

Item	Qty	Item	Qty
A Anti-ligature pull handle	1	D 6 x ¾" anti-tamper fixing screws	4
B M6 x 10mm c/s machine screws	3	E M5 x 40mm c/s machine screws	2
C Back-plate 225mm x 26mm x 3	1	F Black nylon insert	1

PR-8PHS6-CESP

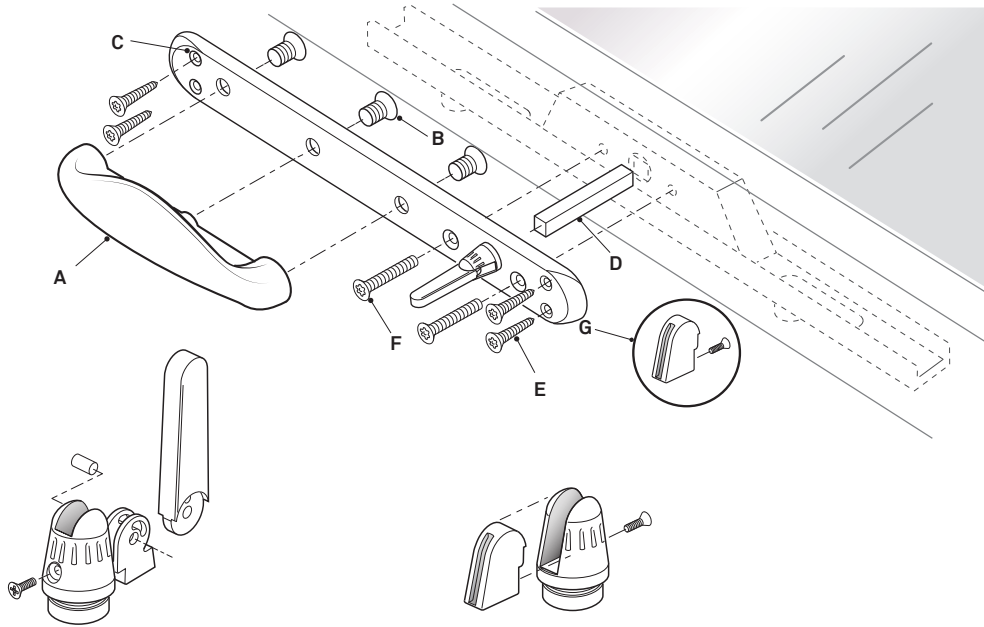

Lever being removed

Blanking insert being installed

- Carefully align the fixing holes of back-plate 'C' with the tapped holes in handle 'A' and firmly secure both components together using the three M6 x 10mm c/s machine screws 'B' provided.
- Cut spindle 'D' to the required length and insert it into the square follower of the espagnolette mechanism.
- After checking the correct orientation of the handle (**See Page 8**) and with the window already in the locked position, offer the assembly onto the vent sliding the star shaped socket on the back of the rose over spindle 'D'. The optimum position for the lever when the vent is locked is pointing downwards. It may be necessary to reposition the keep plates in the outer frame rebate to enable this.
- Secure the plate into position using two M5 x 40mm machine screws 'F' (pre-cut to length) fastened into the screw ports of the espagnolette mechanism.

- Check horizontal alignment and use an appropriate sized drill bit* to create pilot holes in each corner. Use the four No 6 x 3/4" anti-tamper fixing screws provided to conclude the installation.
- Check that the handle assembly is firmly and securely fastened to the vent and that the lever will operate the lock freely. Note: If the leverage required to lock the vent is more than can be achieved with the lever adjust the eccentric cams on the espagnolette bolt mechanism to reduce the force needed to lock the window. This product is supplied as standard with a lever handle but can be converted to key operation. Please ensure that the blanking insert is passed to an appropriate person when the installation is complete.

* The size of the drill bit will be governed by the type (Wood, PVCu or Aluminium) and wall thickness of material being fastened into.

Item	Qty	Item	Qty
A Anti-ligature pull handle	1	D 7mm spindle	1
B M6 x 10mm c/s machine screws	3	E No 6 x 3/4" anti-tamper fixing screws	4
C Back-plate 250mm x 25mm x 6mm c/w lever turn	1	F M5 x 40mm c/s machine screws	2
		G Blanking insert	1

PR-8PHS6-LL

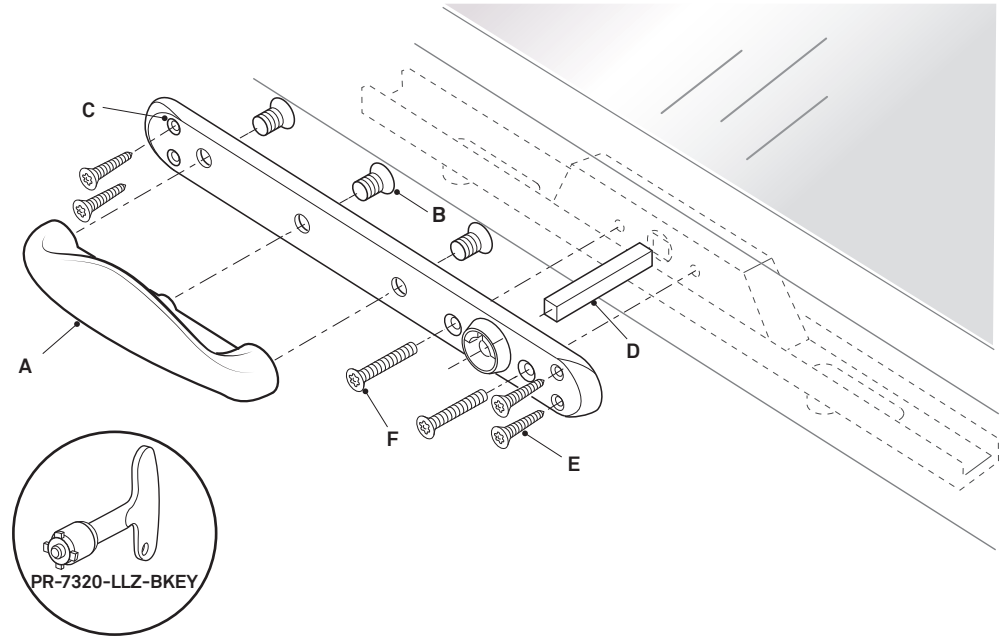

(Key not included)

- Carefully align the fixing holes of back-plate 'C' with the tapped holes in handle 'A' and firmly secure both components together using the three M6 x 10mm c/s machine screws 'B' provided.
- Cut spindle 'D' to the required length and insert it into the square follower of the espagnolette mechanism.
- After checking the correct orientation of the handle (**See Page 8**) and with the window already in the locked position, offer the assembly onto the vent sliding the star shaped socket on the back of the rose over spindle 'D'. The optimum position for the lever when the vent is locked is pointing downwards. It may be necessary to reposition the keep plates in the outer frame rebate to enable this.

- Secure the plate into position using two M5 x 40mm machine screws 'F' (pre-cut to length) fastened into the screw ports of the espagnolette mechanism.
- Check horizontal alignment and use an appropriate sized drill bit* to create pilot holes in each corner. Use the four No 6 x 3/4" anti-tamper fixing screws provided to conclude the installation.

* The size of the drill bit will be governed by the type (Wood, PVCu or Aluminium) and wall thickness of material being fastened into.

Item	Qty	Item	Qty
A Anti-ligature pull handle	1	D 7mm spindle	1
B M6 x 10mm c/s machine screws	3	E No 6 x 3/4" anti-tamper fixing screws	4
C Back-plate 250mm x 25mm x 6mm c/w life-line mechanism.	1	F M5 x 40mm c/s machine screws	2