



363 GEORGE STREET, DUNEDIN CENTRAL, DUNEDIN, 9016

🏠 - 🚗 2 🔄 - 📏 - 📐 150 m²

Property Type:	Commercial: Multiple/unknown	Sale Price:	\$655,000
Dev Zoning:	Commercial Zone A	Sale Date:	09 May 2023
Land Use:	Commercial	Sale Type:	Whole
First Published:	-	Capital Value:	\$610,000
DOM:	-	Valuation Date:	01 Jul 2022
Agent:		Agency:	
Year Built:	1983		

Legal Description: Unit B and Accessory Unit B1 and B2 Deposited Plan 18336 & Lot 1 Deposited Plan 18284



63 HANOVER STREET, DUNEDIN CENTRAL, DUNEDIN, 9016

🏠 - 🚗 3 🔄 - 📏 - 📐 405 m² 📐 760 m²

Property Type:	Commercial: Multiple/unknown	Sale Price:	\$1,689,000
Dev Zoning:	Commercial Zone A	Sale Date:	17 Apr 2023
Land Use:	Commercial	Sale Type:	Whole
First Published:	-	Capital Value:	\$1,630,000
DOM:	-	Valuation Date:	01 Jul 2022
Agent:		Agency:	
Year Built:	1910		

Legal Description: Lot 1 Deposited Plan 26877



426 MORAY PLACE, DUNEDIN CENTRAL, DUNEDIN, 9016

🏠 - 🚗 2 🔄 3 📏 - 📐 637 m² 📐 1,600 m²

Property Type:	Commercial: Other	Sale Price:	\$1,850,000
Dev Zoning:	Commercial Zone A	Sale Date:	01 Mar 2023
Land Use:	Offices	Sale Type:	Whole
First Published:	-	Capital Value:	\$2,550,000
DOM:	-	Valuation Date:	01 Jul 2022
Agent:	-	Agency:	-
Year Built:	1976		

Legal Description: Lot 1 Deposited Plan 15817 & Lot 2 Deposited Plan 3322

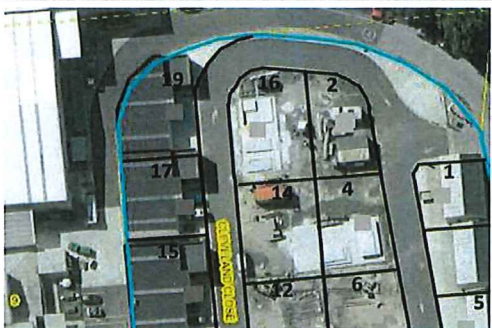

19 CLEVELAND CLOSE, FAIRFIELD, DUNEDIN, 9018

🏠 - 🚗 1 🔄 2 📏 - 📐 293 m² 📐 187 m²

Property Type:	Industrial: Light manufacturing	Sale Price:	\$545,000
Dev Zoning:	Multi-use or Reserve Land Zone X	Sale Date:	28 Apr 2023
Land Use:	Vacant Industrial	Sale Type:	Whole
First Published:	-	Capital Value:	\$460,000
DOM:	-	Valuation Date:	01 Jul 2022
Agent:		Agency:	
Year Built:	2017		

Legal Description: Lot 19 Deposited Plan 499588 & Lot 6 Deposited Plan 499588

**150F KAIKORAI VALLEY ROAD, GLENROSS,
DUNEDIN, 9011**
 -  1  4  -  460 m²

Property Type: Industrial: Service
Dev Zoning: Industrial Zone A
Land Use: Services
First Published: -
DOM: -
Agent:
Year Built: 2000

Sale Price: \$600,000
Sale Date: 24 May 2023
Sale Type: Whole
Capital Value: \$380,000
Valuation Date: 01 Jul 2022
Agency:

Legal Description: Lot 2 Deposited Plan 21461 & Unit F and Accessory Unit F1 and 1/3 share of Accessory Unit FGH Deposited Plan 25875

RECENT SALE

**1/152 KAIKORAI VALLEY ROAD, GLENROSS,
DUNEDIN, 9011**
 -  1  -  700 m²  -

Property Type: Industrial: Vacant
Dev Zoning: Industrial Zone A
Land Use: Vacant Industrial
First Published: -
DOM: -
Agent:
Year Built: -

Sale Price: \$550,000
Sale Date: 26 Jan 2023
Sale Type: Whole
Capital Value: \$490,000
Valuation Date: 01 Jul 2022
Agency:

Legal Description: Lot 1 Deposited Plan 542730

**533 KAIKORAI VALLEY ROAD, KENMURE,
DUNEDIN, 9011**
 -  1  -  1,714 m²  114 m²

Property Type: Commercial: Motor vehicles
Dev Zoning: Industrial Zone A
Land Use: Retail
First Published: -
DOM: -
Agent:
Year Built: -

Sale Price: \$1,500,000
Sale Date: 17 Jan 2023
Sale Type: Whole
Capital Value: \$920,000
Valuation Date: 01 Jul 2022
Agency: -

Legal Description: Lot 2 Deposited Plan 315988

26C MCNAB STREET, KENMURE, DUNEDIN, 9011
 -  1  -  568 m²  248 m²

Property Type: Industrial: Light manufacturing
Dev Zoning: Industrial Zone A
Land Use: Depots and Yards
First Published: -
DOM: -
Agent:
Year Built: 2006

Sale Price: \$600,000
Sale Date: 21 Feb 2023
Sale Type: Whole
Capital Value: \$590,000
Valuation Date: 01 Jul 2022
Agency:

Legal Description: Lot 3 Deposited Plan 374307

126 GORDON ROAD, MOSGIEL, 9024

 - 1 - 932 m² 910 m²

Property Type:	Commercial: Retail use	Sale Price:	\$1,088,000
Dev Zoning:	Commercial Zone G	Sale Date:	03 Mar 2023
Land Use:	Retail	Sale Type:	Whole
First Published:	-	Capital Value:	\$1,430,000
DOM:	-	Valuation Date:	01 Jul 2022
Agent:		Agency:	
Year Built:	1938		

Legal Description: Lot 3 Block IV Deposited Plan 471 and Part Lot 8 Block IV Deposited Plan 471

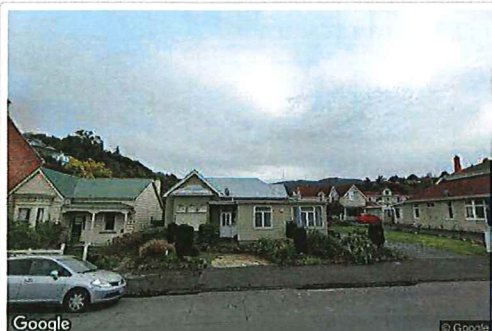
1027 GEORGE STREET, NORTH DUNEDIN, DUNEDIN, 9016

 - 1 - 5 - 3,710 m² 2,240 m²

Property Type:	Commercial: Elderly	Sale Price:	\$5,325,000
Dev Zoning:	Residential Zone F	Sale Date:	13 Feb 2023
Land Use:	Special Accommodation	Sale Type:	Whole
First Published:	-	Capital Value:	\$5,520,000
DOM:	-	Valuation Date:	01 Jul 2022
Agent:		Agency:	
Year Built:	-		

Legal Description: Part Section 79 Block XXXII Town of Dunedin, Lot 1 and Part Lot 10 Deposited Plan 1406, Lot 2 Deposited Plan 1406, Lot 1 and Lot 2 Deposited Plan 8919, Part Lot 10 Deposited Plan 1406, & Part Section 76-79 Block XXXII Town of Dunedin

8 FOX STREET, SOUTH DUNEDIN, DUNEDIN, 9012

 - 2 - 7 - 829 m² 530 m²

Property Type:	Industrial: Warehousing	Sale Price:	\$820,000
Dev Zoning:	Industrial Zone A	Sale Date:	01 Mar 2023
Land Use:	Wholesale	Sale Type:	Whole
First Published:	-	Capital Value:	\$940,000
DOM:	-	Valuation Date:	01 Jul 2022
Agent:		Agency:	
Year Built:	1970		

Legal Description: Lot 3 Deposited Plan 12160

183 KING EDWARD STREET, SOUTH DUNEDIN, DUNEDIN, 9012

 - 1 - 2 - 243 m² 180 m²

Property Type:	Commercial: Other	Sale Price:	\$260,000
Dev Zoning:	Commercial Zone G	Sale Date:	10 Mar 2023
Land Use:	Medical and Allied	Sale Type:	Whole
First Published:	-	Capital Value:	\$375,000
DOM:	-	Valuation Date:	01 Jul 2022
Agent:		Agency:	
Year Built:	1967		

Legal Description: Lot 1 Deposited Plan 11510



14 NEVILLE STREET, SOUTH DUNEDIN, DUNEDIN, 9012

🏠 - 🚗 1 🔄 36 📏 8,300 m² 📏 4,180 m²

Property Type:	Industrial: Heavy manufacturing	Sale Price:	\$11,000,000
Dev Zoning:	Industrial Zone A	Sale Date:	21 Feb 2023
Land Use:	Engineering, Metalworking, Appliances and Machinery	Sale Type:	Whole
First Published:	-	Capital Value:	\$10,900,000
DOM:	-	Valuation Date:	01 Jul 2022
Agent:	-	Agency:	-
Year Built:	2017		

Legal Description: Lot 1 Deposited Plan 516273