

5/43/2/1

AUSTRALIAN ARCHIVES  
ACCESS STATUS

OPEN

OCTOBER TO  
DECEMBER 1943

ORIGINAL

12 WATER TRANSPORT  
OPERATION COMPANY

# WAR DIARY or INTELLIGENCE SUMMARY

Army Form C. 218  
(adapted.)

(Erase heading not required).

H. 100M

Unit 12 Aust Water Transport Op Coy  
(Small Craft) R.A.E. A.I.F.

0001 hours (L)

Date and Time.—From 1 OCTOBER 1943 at 10 31 OCTOBER 1943 2400 hrs (L)

Place	Date	Hour	Summary of Events and Information	Remarks and references to Appendices, Diaries, &c.
PORT MORESBY	1 OCT'43	0001	<p><u>FORMATION OF 12 AUST WATER TRANSPORT OPERATING COMPANY (SMALL CRAFT) RAE AIF</u></p> <p>Following issue of W.E. IV/15K/2 (Provisional) the above Company came into being as from this date with the following HQ Personnel:-</p> <p>Officer Commanding - Capt. W.R. EGAN. Second in Command - Capt. W.H. WESTERN. Adjutant - Lieut. G. FRENCH.</p> <p>No 1 Section Commander and O.C. PORT MORESBY Detachment - Lieut. M.L. BRADFORD. No 2 Section Commander and O.C. MILNE BAY Detachment - Lieut. E.W. STEWART.</p> <p>The nucleus of the Company was the PORT MORESBY DETACHMENT of the original Operating Company of 1 AUST WATER TRANSPORT GROUP (SC) RAE AIF, and the Company HQ were set up in the building occupied by that Detachment together with the PORT MORESBY Detachment of the 31 Aust Water Transport Maintenance Company. Milne Bay Detachment of the original Operating Company also formed part of the New Company.</p> <p>Broadly, the Area initially the scene of the Company's activities is the Easterly and South Westerly coast line from and inclusive of MILNE BAY to and inclusive of PORT ROMILLY together with all adjacent waters and Islands. On the North Coast a liaison is kept with 11 Aust Water Tpt Op Coy (SC) RAE AIF which operates ORO BAY and Northerly, and on the Southerly Coast with 41 Aust Water Transport Op Coy (LC) RAE AIF which operates from TERAPO to BULLDOG on the LAKEKAMU River.</p>	<p><u>ATTACHED ARE:-</u></p> <p>(1) Copy of WE IV/15K/2 (Prov)</p> <p>(2) Casualty Return showing all ranks of company as initially formed.</p> <p>(3) List of Craft and main details initially allocated to Company.</p>
	2 OCT'43	1000	<p><u>TOUR OF NORTH COAST:-</u></p> <p>O.C. Capt. W.R. EGAN returned from tour of Area Operations of 11 Aust Water Transport Op Coy covering from BUNA to LAE along NORTH COAST.</p> <p><u>STANDING ORDERS FOR VESSELS</u> issued to all craft</p>	<p>Report herein dated 4 Oct'43 forwarded to Group HQ</p> <p>(4) Copy of Standing Orders attached.</p>
	4 OCT'43	1300	<p><u>BILLETS AND CAMP:-</u></p> <p>The existing PORT MORESBY Billeets and Camp were, upon its formation, made the responsibility of the Company as Company Quarters. Subject to Company Control Group HQ personnel and various personnel of Water Transport Companies in transit from time to time are accommodated.</p>	



## WAR DIARY or INTELLIGENCE SUMMARY

Army Form C. 2118

(adapted.)

(Erase heading not required).

H. 1009

1st Aust Water Transport Op Coy (SC) RAR AIF.

Unit

Date and Time.—From To

Place	Date	Hour	Summary of Events and Information	Remarks and references to Appendices, Diaries, &c.
			(Cont) The billets are old and dilapidated houses and the steep and rough terrain does not lend itself to the establishment of an efficient camp. Discussions and reconnaissance in conjunction with Town Major are being followed up in an endeavour to secure an adequate and more suitably situated position.	
	5 OCT'43		<u>M.V. "MULIAMA"</u> Gross tonnage 690 commenced under articles the PORT MORESBY TERAPO run.	
	7 OCT'43		<u>CAMP STANDING ORDERS</u> issued by Company	(5) Copy of Camp Standing Orders
	9 OCT'43		<u>ADJUTANT</u> Lieut. C. FRENCH relinquished command of MILNE BAY Detachment and took up duty as Adjutant to the Company	
<u>MILNE BAY</u>	9 OCT'43		<u>MILNE BAY DETACHMENT</u> Lieut. E. W. STEWART took up duty as O.C. Detachment.	
<u>PORT MORESBY</u>	15 OCT'43		<u>COMPANY 2 i/c</u> Capt. W. H. WESTERN released from duty as Adjutant to 1st Aust Water Transport Group and taken on strength of Company as from 15 Oct'43.	
<u>MILNE BAY</u>	13 OCT'43		<u>INSPECTION OF MILNE BAY DETACHMENT</u> O.C. of the Company travelled by Air to MILNE BAY and returned by sea in A856	Report herein dated 23 Oct'43 forwarded Group HQ
<u>PORT MORESBY</u>	19 OCT'43	1930	<u>CARRIER PIGEON SERVICE</u> Capt. A. CORNISH, O.C. 1st Aust Pigeon Service gave an interesting and instructive lecture on the history and work of this Service. Practical application in connection with our craft is anticipated early in November.	
<u>PORT MORESBY</u>	19 OCT'43	1010	<u>LAUNCH "KAROA" AM98</u> As AM98 moved out from ANGAU Wharf an explosion occurred aboard and fire broke out, by 1025 hours the flames were subdued. The craft was badly damaged	Investigating Officers report with statements attached forwarded to Group HQ on 22 Oct'43.
		1025		

## WAR DIARY or INTELLIGENCE SUMMARY

Army Form C. 2118  
(adapted.)

(Erase heading not required).

12 Aust Water Transport Op Coy (SC) RAE AIF.

H. 100W

Unit

Date and Time.—From

To

Place	Date	Hour	Summary of Events and Information	Remarks and references to Appendices, Diaries, &c.
			(Cont). <u>VX138417 Lance Corporal DAVIES, W. J.</u> was Master of AM98 and was at the time the only occupant of the Launch. He was injured and conveyed to RAP and thence to 2/5 A.G.H.	
			<u>INVESTIGATING OFFICER</u> Capt. W. H. WESTERN appointed as Investigating Officer in connection with the above occurrences. <u>L/Cpl. DAVIES, W. J.</u> Died late in the day. Medical report showed injuries to consist of 60% surface burns and severe shock.	
<u>PORT MORESBY</u>	23 OCT'43		<u>BURIAL</u> Took place at BOMANA War Cemetery Commanding Officer, Officers and Men of 1 Aust Water Transport Group attended voluntarily and in strength. A fine tribute to the dead man's qualities was paid by the officiating Padre Capt. VICKERY. The C.O. led those present in repeating the Returned Soldiers Vow.	
<u>PORT MORESBY</u>	25 OCT'43	1700	<u>MV "MULIAMA"</u> Proceeded TERAPO PORT ROMILLY for timber from ANGAU Mill.	
	26 OCT'43		<u>NATIVE PERSONNEL</u> 18 Native reinforcements received from ANGAU for craft duties.	
<u>MANNU MANNU</u>	27 OCT'43		<u>BIRI SEWU ROOFING</u> AS56 under orders proceeded to MANNA MANNU and investigated possibility of shipments of BIRI, 1000 6-foot sheets were brought back	(6) Report from ANGAU representative is attached
<u>PORT MORESBY</u>	29 OCT'43		<u>AM1436</u> Launch forwarded per S. S. MERRIMONE from D. W. T. to Group and allocated this Company. <u>MAIN SPECIFICATIONS</u> 40'    12' 10"    6' 6"    10 KPH    40 Length    Beam    Draft    Speed    Cruising    HP. <u>ALCM's MEI (44 ft)</u> A test showed that 2 Ford "Tip" trucks or 1 Ford "Tip" Truck and 1 Chev "Winch" Truck could be carried on these craft.	(7) Report herein attached.



**SECURITY**

THIS DOCUMENT IS THE PROPERTY OF THE AUSTRALIAN COMMONWEALTH GOVERNMENT, and is issued for the information of Officers and responsible officials.

The officer or official in possession of this document will be responsible for its safe custody and that its contents are not disclosed to any unauthorised person.

The document will be kept under lock and key when not in actual use.

Officers commanding Units and establishments etc, are responsible that appropriate circulation is given to this document.

**A WATER TRANSPORT OPERATING COMPANY (SMALL CRAFT)****RAE**

Consisting of:-

Headquarters

Three Operating Sections.

Designed to operate four 300 ton vessels four trawlers two 300 h p sea going tugs two 60 h p harbour tugs four patrol launches thirteen launches (including one water carrying) two 300 ton powered lighters two 100 ton powered lighters and four landing craft.

**WAR ESTABLISHMENT PROVISIONAL**

(This establishment supersedes No IV/15K/I.)



## A WATER TRANSPORT OPERATING COMPANY (SMALL CRAFT) R.A.E.

## (1) SUMMARY OF RANKS

DETAIL	HEADQUARTERS	SECTION OP.	NO 1 OPERATING SECTION	NO 2 OPERATING SECTION	NO 3 OPERATING SECTION	TOTAL WATER TFT OP COY (8C)
MAJOR	1	1	1	1	1	4
Captains	1	1	1	1	1	4
Captains (Masters)	1	1	1	1	1	4
Lieutenants	1	1	1	1	1	4
Adjts	1	1	1	1	1	4
Chief Engineer	1	1	1	1	1	4
Mates	1	1	1	1	1	4
Quarter Master	1	1	1	1	1	4
TOTAL OFFICERS	4	19	7	1	1	31
WARRANT OFFICERS CLASS I						
Masters	-	-	2	-	-	2
Second Engineers	-	6	2	-	-	8
Second Mates	-	6	-	-	-	6
WARRANT OFFICERS CLASS II						
Chief Engineer	-	-	2	-	-	2
Company Sgt Major	1	-	-	-	-	1
Masters	-	-	4	2	-	6
Mates	-	-	2	-	-	2
Native Administration	1	-	-	-	-	1
Third Engineers	-	6	-	-	-	6
TOTAL WARRANT OFFICERS	2	18	12	2	-	34
Company Quartermaster Sgt	-	-	-	-	-	1
Sergeants	-	-	-	-	-	-
Boatswains	-	6	-	-	-	6
Clerk	1	-	-	-	-	1
Engineer	-	-	6	2	-	8
Masters	-	-	-	21	-	21
TOTAL STAFF SERGEANTS AND SERGEANTS	2	6	6	23	-	37
Corporals	2	5	1	22	-	30
Sappers	11	15	19	7	-	52
Native personnel	17	72	20	48	-	157
TOTAL RANK AND FILE	30	92	40	77	(a) 239	
TOTAL OTHER RANKS	34	116	58	102	-	310
TOTAL ALL RANKS	38	135	65	103	-	341
ATTACHED						
A.A.M.C.	1	-	-	-	-	1
Corporal	1	-	-	-	-	1
A.A.C.C.	1	-	-	-	-	1
Sergeant	1	-	-	-	-	1
Corporal	1	-	-	-	-	1
Privates (TO II)	2	-	-	-	-	2
TOTAL ALL RANKS INCLUDING ATTACHED AND NATIVE PERSONNEL	43	135	65	103	-	346

(3)

IV/15K/2 (W.E. PROVISIONAL)

A WATER TRANSPORT OPERATING COMPANY  
(SMALL CRAFT) R.A.E.

**14 DISTRIBUTION OF RANK AND FILE BY TRADES AND DUTIES**

DETAIL	HEADQUARTERS	No 1 Op SECTION	No 2 Op SECTION	No 3 Op SECTION	TOTAL WATER TRANSPORT OPERATING COMPANY (80) RAE
<b>AUSTRALIAN PERSONNEL</b>					
<b>TRADE GROUP II</b>					
Carpenter	1	-	-	-	1
Driver Mechanic	2	-	-	-	2
Painter	1	-	-	-	1
<b>TRADE GROUP III</b>					
Clerks	(b) 2	(b) 1	(b) 1	(b) 1	5
Engine Hands IG	-	-	-	(a) 21	21
Tailor	1	-	-	-	1
Technical Storeman	1	-	-	-	1
<b>NON SPECIALISTS</b>					
Deckhands	-	-	2	4	6
Drivers MT	1	1	1	1	4
Helmsman	-	(a) 18	16	2	36
Hygiene Duties.	(b) 1	-	-	-	1
Orderlies	2	-	-	-	2
Storeman	1	-	-	-	1
<b>TOTAL AUSTRALIAN PERSONNEL.</b>	<b>13</b>	<b>20</b>	<b>20</b>	<b>29</b>	<b>82</b>
<b>NATIVE PERSONNEL</b>					
<b>NON SPECIALISTS</b>					
Batman	4	-	-	-	4
Cooks	-	6	-	-	6
Deckhands	-	36	20	48	104
Engine Hands	-	18	-	-	18
General dutyman	10	-	-	-	10
Hygiene dutyman	3	-	-	-	3
Stewards	-	12	-	-	12
<b>TOTAL RANK AND FILE INCLUDING NATIVE PERSONNEL</b>	<b>30</b>	<b>92</b>	<b>60</b>	<b>77</b>	<b>239</b>

**144 TRANSPORT**

TRUCKS 15 cwt G.S.	2	1	1	1	5
TRUCKS 3 ton water	1	-	-	-	1

**145 TABLE OF WEAPONS AND AMMUNITION**

DETAIL	NUMBER	ON MAN OR WITH GUN	RESERVE	TOTAL
PISTOLS .30 inch	65	12	390	1170
RIFLES .303 inch	119	50	6000	11950
RIFLE .303 inch for attached pers.	4	20	-	80
SUB MACHINE GUNS HMG 20 mm	(e) 47	200	18000	23200
or				
BROWNING Cal .50	(f) 53	4500	79000	159000

one man will be trained to repair boats as a part time employment.

Includes or is a corporal.

Corporals.

includes or is a corporal

Allotted as follows:-

Two each for.  
four 300 ton vessels two 300 h p sea going tugs  
two 300 ton and two 100 ton powered lighters

one each for  
four trawlers two 60 hp harbour tugs  
seventeen launches and four landing craft

(f) With AA mounting Naval pattern and allotted as follows

two each for  
Headquarters four 300 ton vessel four trawlers two 300 h p sea going tugs two 300 ton and two 100 ton powered lighters  
one each for  
two 60 h p harbour tugs seventeen launches and four landing craft.

NOTE

Except in operational areas all ranks on this establishment may be provided from personnel classified medically fit Class B.

# FIELD RETURN OF OFFICERS

Army Form W.3008  
(Adapted) (Page 1)  
(Revised Jan., 1943)

At 0600 Hrs. Saturday 30/10/1943 (Small Craft) R. (Unit)

W.E. IV/15K/2. OFFRS. 31 O.R's. 153 + OFFRS. - O.R's. 5 ATT. BY W.E. (H)

## PART A.—POSTED STRENGTH, SURPLUS OR REINFORCEMENTS REQUIRED.

1	2	3	4	5	6	7	8	9	10										
W.E. EXCLUDING ATTACHED.				DETAIL.	ATTACHED ALLOWED BY W.E.														
Retn'ts Required.	Deficient W.E.	Surplus to W.E.	Posted Strength.		Arm or Corps.	Posted Strength.	Surplus to W.E.	Deficient W.E.	Retn'ts Required.										
				.															
				.															
				Lieut.-Colonels															
	1	-	-	Majors															
	9	-	3	Captains															
	7	-	10	Lieutenants															
	1	-	-	Quarter-masters															
				A.A.N.S. and															
				A.A.M.W.S. Offrs.															
				Civilians Counting															
				as Offrs.															
	18	-	13																
<p>Analysis of Part A to be shown here by ALL units. Only units notified in para. 12 of instructions for compilation of form will complete Part E(1) &amp; E(2).</p>					DETAIL		A.I.P.	C.M.P.	A.W.A.S.	A.A.N.S.	A.A.M.W.S.	CIVIL.	R.A.N.	R.A.A.P.	**	TOTAL.			
					A.		9	4											13
					E(1)														
					E(2)														

Analysis of Part A to be shown here by ALL units. Only units notified in para. 12 of instructions for compilation of form will complete Part E(1) & E(2).

\* Insert detail of higher ranks as necessary.

\*\* Personnel belonging to a category not provided for in the analysis will be shown in this Col. Particulars will be shown, e.g., 20 U.K. Forces; 10 N.E. Forces.

## PART B.—PARTICULARS OF OFFICERS JOINED OR QUITTED DURING WEEK.

### OFFICERS JOINED DURING WEEK

Army No.	Rank.	Name and Initials.	Unit From.	Date.	CAUSE.
EX2883	Capt	WESTERN, W.H.	1 Aust Water Tpt Group (SC) M&E	15/10/43	Transferred in and Taken O &

### OFFICERS QUITTED DURING WEEK.

Army No.	RANK.	Name and Initials.	Unit To.	Date.	CAUSE.

## PART C.—DESCRIPTION OF OFFICERS WHOSE RETURN TO (Unit) IS

### PARTICULARLY REQUESTED. /194

Army No.	RANK.	Name and Initials.	REMARKS (e.g., present whereabouts if known).







## PART E. Detail of Present Strength and Reinforcements required as shown in

## Part A of Army Form W.3009 at 0600 Hours Saturday 30 / 10 / 1943

Details of Tradesmen. GROUP I.	W.E.	Peised Strength.	Reinforcements Required.	Details of Tradesmen. GROUP I. (cont.)	W.E.	Peised Strength.	Reinforcements Required.	Details of Tradesmen. GROUP II. (cont.)	W.E.	Peised Strength.	Reinforcements Required.	Details of Tradesmen. GROUP III. (cont.)	W.E.	Peised Strength.	Reinforcements Required.
Ammunition Examiners				Surveyors, Engineering				Operating Room Assts.				G.P.O. Assistants			
Armament Artificer Fitter				Surveyors, R.A.A.				Operator, Keyboard				Hammermen			
Armament Artificer Fitter (Electrical)				Surveyors, Topographical				Operator, Line				Leather Stitchers			
Armament Artificer Fitter (M.V.)				Surveyors, Teleradiological				Operator, Signal				Orderlies, Nursing			
Armament Artificer Fitter (A.V.)				Toolmakers				Operator, Switchboard				Orderlies, Nursing Mental			
Armament Artificer Instrument				Turners				Operator, Wireless				Plate Layers			
Armament Artificer Radio				Watchmakers				Opticians				Rangefinders			
Armament Artificer Signals				Welders				Painters				Riveters			
Armament Artificer Wireless								Panel Beaters				Roughriders			
Artillery, Artillery								Photographers, Dry Plate				Saddlers			
Artillery, Engine								Predictor Numbers				Saddletree makers			
Blacksmiths								Printers				Shoemaker and Boot Repairer			
Bricklayers								Radiographers				Stewards			
Computers								Riggers				Stokers, Staty, Engine			
Cooks, Hospital				GROUP II.				Sawyers				Shermen, Technical			
Coppersmiths				Armourers				Signalers				Tailors			
Dispensers				Assenens				Signwriters				Textile Refitters			
Draughtsmen				Bakers				Telescope Identif. Numbers				Tinsmiths			
Draughtsmen (Architectural)				Blr. Comd's Asst.				Well Bores				Vulcanizers			
Draughtsmen (Engineering)				Ballroomers				Wheeler				Wagon Erectors			
Draughtsmen (Mechanical)				Carpenters				Winchman				Whitesmiths			
Draughtsmen (Topographical)				Carpenters and Joiners				Wireman							
Electricians				Cooks				Woodturners							
Electricians (M.V.)				Dental Mechanics											
Electricians (Signals)				Driver-Mech. (Eng. and Med.)											
Fitters				Driver-Operator											
Fitters (Cycle)				Drainers											
Fitters (Electrical)				Electricians											
Fitters (Gun)				Electricians (Engineers)											
Fitters (Instrument)				Fire Control Operators				GROUP III.							
Fitters (M.V.)				Gun Operator				Battery Surveyors							
Fitters, Railway Signal				Halfman				Butchers							
Fitters, Signals				Height Taker				Clerks							
Grinder, Precision				Hollo Operator				Clerks, Supply							
Mechanics, Instrument				Instrument Operator				Clerks, Technical							
Mechanics, Instrument (Signal)				Intelligence Duties				Coach Trimmers							
Mechanics, Instrument (Surgical)				Joiners				Concrete							
Mechanics, Radio				Linemans				Cooks							
Mechanics, Typewriter				Linemans, Signals				Dental Clerk Orderlies							
Mechanics, Wireless				Lithographers				Despatch Riders							
Millwrights				Machinists, Metal				Draughtsmen, Signals							
Operators, Excavator				Machinists, Wood				Drivers, H.T.							
Pattern Maker				Masons				Driver Mechanics							
Pharmacist				Masons				Driver Typ. Plant							
Photographer, Wet Plate				Mechanics, M.T.				Engine Hands, I.C.							
Photewriter				Mines				Equipment Repairers							
Plumber				Moulders				Farriers							
Saw Doctors				Nurses, Trained				Fitters' Mates							
Serveress				Observation Post Assts.				Gun Layers							
CARRIED FORWARD	3			CARRIED FORWARD	3	7		CARRIED FORWARD	5	17		Totals of columns marked * to agree with columns 4 and 7, and 1 and 10 of Part A. respectively.	158	150	

NOTE.—(a) If rank other than private is involved give details on back.

(b) Authorized trades or specialties not included in list will be added as required in spaces provided.

(c) Where A.W.A.S. and/or A.A.M.W.S. personnel are desired show details on back.

(d) Where replacement not desired note accordingly on return by insertion of "N.R." in col. "Reinforcements Required."

(e) Where any request or notation is made on back of form, the words "See Back" should be written in one of the blank spaces on this page.

Date of Despatch

Signature of Commander

Lieut.

Adj. 12 ARTCO (SO) RAB

12 AUST WATER TRANSPORT OPERATING COMPANY (SMALL CRAFT) RAE ATT

(11)

TYPE	LENGTH	BEAM	MAX DRAUGHT	MAKE	ENGINE TYPE	HP	CRUISING SPEED RPM K.P.H. CUBIC CAP.		D.W. TON	MAX CREW PASSENGER
<u>LAUNCHES:-</u>										
AM3 GUNAMATTA	38'	11'	4' 3"	KELVIN	PETROL	40	600	6 360	5	10 30
AM8 DOROTHEA	30'	10'	3'	LISTER	DIESEL	18	1000	6½	2	6 10
AM19 COOBOO	26'	9'	3' 6"	CLAE	PETROL	30	1000	7 185	1	4 10
AM89 QUEEN MARY	43' 6"	10' 6"	4' 9"	THORNYCROFT	PETROL	42	1000	7 400	4	15 60
AM90 THORN	41'	11'	4' 6"	THORNYCROFT	PETROL	42	1000	6 360	3	10 40
AM104 2 T & L	30'	9'	3'	GRAY	PETROL	32	1100	6	1	4 12
AM52 DIXIANA	36'	10' 2"	4' 6"	FORDSON "T"	PETROL	30	1500	7½	3	6 12
AM40 VIKING	37' 6"	12' 9"	3' 6"	WISCONSIN	PETROL	30/35	1000	6 180	5	8 12
AM98 KAROA	32	10' 9"	3' 6"	TWIN GRAY	PETROL	22	1100	8	1	4 10
<u>TRAWLERS</u>										
AS30 MACARTHUR	52' 9"	15' 9"	6'	INTERNATIONAL	DIESEL	43/56	1100	6 1120	23	8
AS56 CRANWIN	57'	14' 9"	5' 6"	KELVIN	PETROL	66	750	7	25	12
AS141 TWO BROTHERS	61' 6"	16'	7' 3"	NATIONAL	DIESEL	80	800	6	30	15
<u>KETCHES</u>										
AK94 ABEL TASMAN	98'	25'	8' 8"	GARDINER	DIESEL	68	800	7	120	50
<u>BARGES</u>										
AS581 HIGGINS U.S.	50' 4"	14'	4' 6"	GRAY MARINE	DIESEL				25	
<u>LAUNCHES</u>										
AM5 GLORIA	57' 6"	14' 9"	6'	M.A.N.	DIESEL	60	600	8 528	9.12	15 60
AM12 HOWARD	23' 3"	8' 2"	3'	CLAE	PETROL	24	1200	8	1	4 10
AM32 IWANA	26'	8' 6"	2' 6"	GRAY	PETROL	22	1500	8	1	4 10
AM53 MOLLY BROWN	25'	8' 6"	2' 6"	FORD V8	PETROL	40	2000	7	1	4 10
AM37 MACAID	25'	8' 10"	2' 9"	FORD V8	PETROL	40	2000	6	1	4 10
AM46 WHIMBRELL	39'	12' 6"	3' 6"	RUSKIN	DIESEL	36	800	6	3	8 20
AM43 IREX	49'	11' 3"	4' 4"	KELVIN		22	800	6½ 370	5	8 12
<u>TRAWLER</u>										
AS22 WALSON	41' 6"	12' 6"	6' 6"	LISTER	DIESEL	31/35	1000	6	7	6 18
AS23 AMIRIYA	42'	12'	7'	RUSKIN LISTER	DIESEL	27	960	6	7	6 18
AS26 BALMAIN	51'	14'	7'	GARDINER D	DIESEL	66		7	18	12 40
<u>LUGGERS</u>										
AL240 TEAL	58'	12'	7' 6"	PALMER	PETROL	24	750	6 520	10/15	8 30
AL265 SEDNEY	45'	12' 6"	8'	NO AUX				520	10/15	8 30
<u>TUG</u>										
AT83	35'	10'	6'	GARDINER	DIESEL	50	600	7	5	
				BUYACOTT	PETROL	3				



## -:No 12 OPERATING COMPANY:-

I. AUST. WATER TRANSPORT GROUP (SMALL CRAFT). R.A.E. A.I.F.  
STANDING ORDERS FOR VESSELS

BY

Captain. W.R. EGAN, Officer Commanding 12 Operating Company.

-:2 October 1943:-

MASTERSAUTHORITY:-

Masters have the sole authority to decide the conditions of loading and of anything relative to the Navigation and Handling of their Vessels.

REPORTING:-

Immediately upon arrival in Port, Masters will report in person to the Shipping Master I AUST WATER TRANSPORT GROUP, and present to him:-

- (a) A copy of the Ships Log for the voyage just completed.
- (b) The Ships Manifest.
- (c) A proper requisition for Chandlery, POL, Rations Water, replenishment of expendable Stores, and for any other requirements (including Medical Stores)
- (d) Copy of Engineers log for such Voyage.
- (e) A report on all matters dealing with Native Crew.

INSPECTION:-

When in Port the Ship will be inspected by the Coy Commander or his representative. Masters will ensure that their Vessel is in inspection order with particular attention to:-

- (a) Navigation Instruments.
- (b) Armament.
- (c) Rigging and ground tackle.
- (d) Engine Room.

RESPONSIBILITIES:-

Masters are responsible to Company Commander for:-

- (a) The safe navigation of their Vessel.
- (b) The Seaworthiness of their Vessel.
- (c) The vessel being adequately equipped and provisioned including rations for Native Personnel.
- (d) Having in their possession the requisite signals required by N.O.I.C.
- (e) Being in possession of their sailing orders in writing prior to departure.
- (f) The vessel carrying adequate fire fighting equipment and sufficient life saving equipment for each member of their crew. Responsibility for provision of Life Saving Equipment for any passengers is accepted by Movement Control and is not the responsibility of M.T.

## -:CHIEF ENGINEER:-

RESPONSIBILITIES:-

The Chief Engineer is responsible to the MASTER for:-

- (a) The good order and safe running of the engine, steering, propelling and pumping gear, and refrigerating plant of the vessel.
- (b) Control and discipline of all engine room hands.
- (c) Carrying out of routine maintenance as prescribed for the particular engine gear and plant in his charge.
- (d) Replenishment of P.O.L. and expendable stores.

## -:CHIEF MATE:-

RESPONSIBILITIES:-

The Chief Mate will be responsible to the MASTER for:-

- (a) The correct stowage of the cargo having regard for the safety of the vessel.
- (b) The internal economy of the Vessel.
- (c) The control and discipline of all deck hands of the crew.
- (d) The good order and condition of the vessel.

*W. Bradford Lt.*  
 Adjutant.  
 12 Operating Company.  
 I Aust Water Transport Group.  
 (Small Craft) R.A.E. A.I.F.

I. DAILY ROUTINE:-

REVEILLE	0630	MESS PARADE	1305
MESS PARADE	0700	RESUME DUTIES	1330
SICK PARADE	0730	DISMISSAL	1700
KIT STAND TO		MESS PARADE	1730
INSPECTION AND DUTY		RETREAT	1800
PARADE	0800	LIGHTS OUT	2230
LUNCHEON	1200 - 1230		

-----000-----

2. DRESS:-

- (I) Personnel at all times will be neat and clean in appearance.
- (II) Sand shoes will ~~NOT~~ be worn ashore.
- (III) By 1800 hrs of each day shirts will be buttoned up to the second button, sleeves will be buttoned at wrist, long trousers and gaiters will be donned.

3. HYGIENE:-MALARIAL CONTROL

- (I) Dress regulations will be strictly observed.
- (II) Mosquito repellants as prescribed will be used.
- (III) Mosquito nets will be kept in good repair, will be sprayed at least once daily and will be used.
- (IV) Atobrin tablets will be taken every second day as prescribed.

DYSENTERY

- (I) Any symptoms indicating dysentery will be reported immediately to R.A.F.

GENERAL.

- (I) Lids of Latrines MUST be replaced immediately after use.
- (II) All rubbish and garbage will be placed in receptacles provided.
- (III) Moss Gear will be scrubbed thoroughly immediately after every meal.
- (IV) The water provided within the camp is fit for drinking without further treatment but extreme care will be exercised in use of water from other sources.

4. INSPECTION

The Camp and Craft will be inspected daily. All Tents, living quarters and Craft will be in inspection order from 0800 until 2700 hrs daily. No equipment, personal gear or washing will be hung on tent ropes. Kit Layout will be standardised as indicated in sketch:-

HEAD

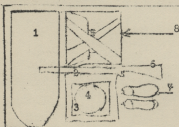

Universal Kit Bag.

- 2 Haversack
- 3 Respirator.
- 4 Helmet Steel.
- 5 Pack and Webbing
- 6 Rifle.
- 7 Spare Boots
- 8 Blankets.

5. "CQ" STORE

- (I) Issues and change of clothing will be on TUESDAY of each week only.
- (II) Boots for repairs will be cleaned and handed into "CQMS Store". Leases will be removed and Boots will be clearly marked with Name and Number.

6. DISCIPLINE

Compliments will be paid to ALL OFFICERS at ALL times.  
Upon an OFFICER coming aboard craft Masters will stand their crews to.

*[Signature]*  
Capt.  
O.C.

12. AUST WATER TRANSPORT OPERATING COMPANY.

7/10/43

(COPIES FOR WAR DIARY)

6/5/43  
MANULANU STATION  
30th OCT'43

12 Aust Water Transport Operating  
Company  
FORT MORESBY

BIRI PRODUCTION

With reference to your request for details of BIRI shipments from this Area, I tender the following:-

- a. The approximate minimum output of this area is 2,000 sheets per week. 800 bundles per week. The average output is around 3,000 sheets.
- b. All details of stock available, loads shipped etc are regularly supplied by Sgt Garrod, in charge "biri" production, to Major Baldwin, Production Control Board A.N.G.A.U. It is suggested that Major Baldwin be contacted before ships proceed here for loads.
- c. We should appreciate it if all requests for "biri" are authorised by Major Baldwin.

Signed. G.Baskett F/O  
Moresby District.

(Copies sent to Movement Control  
Received 1430 31/10/43)

VII

REPORT ON SAGO AND BIRI PRODUCTION AT KIKORI, ROMILLY  
AND KEREMA

SAGO:-

Capt.FOLEY. D.O. KIKORI informed me that practically unlimited quantities of SAGO could be produced at KIKORI and WAROI CAMP ( two miles beyond ROMILLY Timber Mill) at which two places drying kilns are erected.

To effect this Capt FOLEY requires:-

- (i) Supply of sacks of 200 lbs capacity.
- (ii) Trade tobacco for purchase of wet sago.
- (iii) Total quantity of Sago required per week
- (iv ) Guaranteed shipping space.

Capt.HEALY. DO KEREMA could produce about 10 tons of sago weekly under the same conditions.

BIRI:-

A BIRI Camp is established at VIESARA ,five miles from ROMILLY Timber Mill. 3000 sheets in 10' and 12' l nghts are on hand and daily production is 300 sheets, I did not enquire at KEREMA about BIRI but as Sago palm also grow there doubtless BIRI could also be made. etc.

DISTANCES:-

LAKEKAMU RIVER	TO	KERESINA	35 Miles.
"	"	WAROI	105 Miles.
"	"	VIESARA	100 Miles.
"	"	KIKORI	165 Miles.

Signed H.MULLEE.WO.I .  
(Mate AS141)



VIII

12 AUST WATER TRANSPORT OPERATING COMPANY (SC)RAE

PORT MORESBY

ORDERS FOR SUPPRESSION AND PREVENTION OF FIRE ON CRAFT OR ALONG WATERFRONT:-

1. FIRE FIGHTING PARTY:-

- (i) Company C.S.M. is appointed i/c of permanent fire fighting party which will consist by day of personnel stationed at Company Headquarters and "Q" Store. Other available personnel may be detailed by C.S.M. daily as occasion requires.
- (ii) On outbreak of fire senior Officer of Coy present in vicinity will assume command and direct operations in dealing with the outbreak.

2. PROCEDURE ON OUTBREAK OF FIRE:-

- (i) On outbreak of fire either ashore or on a craft, fire gong situated at front of Company Headquarters, will be sounded by personnel noticing the fire.
- (ii) The Company Headquarters and other Stations listed hereunder will be advised by telephone or other available means in the shortest possible time:-
- | <u>STATION</u>                            | <u>PHONE</u> |
|---|--------------|
| Company Headquarters<br>(Waterfront Road) | Bell 229     |
| American Fire Brigade                     | Bell 264     |
| Town Major                                | Bell 207     |
| HQ 1 A.W.T.G. (SC) RAE                    | Bell 354     |
| Ambulance                                 | Bell 35      |
- (iii) Fire fighting party will obtain fire extinguishers and other appliances and proceed at once to scene of fire and place themselves under command of Senior Officer for Directions in extinguishing and limiting extent of outbreak, locating actual seat of fire and dealing with the outbreak.

3. The danger of fire occurring on craft cannot be over stressed. It is likely to occur at any time. Instructions for prevention of and dealing with outbreaks of fire on craft will be observed at all times.

4. DRESS RESTRICTIONS:-

These will be observed and footwear worn at all times by all ranks thus minimising the effect of fire on exposed parts of the body.

*A. Egan* Capt.  
O.C 12 AUST. WATER TRANSPORT OP. COY. (SC) RAE.

30 OCT '43.

DISTRIBUTION HQ 1 Aust Water Tpt Op. (SC) RAE  
Port Moresby Detachment  
Port Moresby Maintenance Detch.  
Q.M. Store. - Town Major.  
Wharf Office  
Milne Bay Detach (for inform)  
War Diary (2)  
Outside Orderly Room  
FILE  
Sparos.

:- FIRE FIGHTING APPLIANCES LOCATION:-

Chemical and Foam Type Fire Extinguishers and appliances are located as follows:-  
ON ALL CRAFT. In readily discernible positions as directed by notices aboard.

ON SHORE:-

- At "QM" Store (4 Gall.)  
At Company Orderly Room. (4 Gall.)  
At Office on Duty Wharf (4 Gall.)  
At Waterfront near Power Station (20 Gall.)  
At Water front near Docks Operating Company (20 Gall.)

IX  
RE/GB/29  
In reply quote  
WR/203.

MS/9.  
12 Aust Water Transport Op Coy.  
(Small Craft) R.A.E. X

To:-  
C.O.  
1 Aust Water Transport Group  
(Small Craft) R.A.E.

Subject:- ALCM-Mark I  
LOADING WITH (I) FORD 3 Tn WOODEN "TIP" TRUCKS  
(II) CHEV 3 Tn STEEL "WINCH" TRUCKS

1. As instructed test loading of barge AB1140 with above types of trucks was carried out around time of High Tide 0930 hours on 29/10/43., at Fort Commanders ramp.
2. Relevant Specifications are:-

<u>(I) FORD " TIP " TRUCK</u>	<u>Length</u>	<u>Overall Width</u>	<u>Overall width of Tyres</u>
	18' 6"	7' 4"	6' 8"
<u>(II) CHEV " WINCH " TRUCK</u>	20' 6"	7' 4"	6' 8"
3. Test showed that two of the Ford "Tip" Trucks can be loaded and carried without undue interference with navigation or running repairs.
- 3a. In this case trucks to be backed on to barge. The truck placed aft to be kept forward of the petrol tank plugs.
4. Loading one of each type, Ford "Tip" Truck must be backed in first and back wheels taken aft and clear of Petrol Tank Plugs.
5. Navigation and maintenance in this case are interfered with but are still practicable.
6. I am advised that proportion of trucks going forward will be approximately 20 Ford "Tip" Trucks to 1 Chev "Winch" Truck.
7. It is suggested that movement of the latter be made to coincide with the availability of ALCM's - Mk II (54 feet) two of which namely AB61 and AB62 operate on the LAKEKAMU RIVER and are available from time to time for MORESBY - BULLDOG run.

  
Capt.  
O.C. 12 AUST WATER TRANSPORT OP COY (SC) R.A.E

28 OCT'43

Copies

11 Aust Water Transport Op Coy (SC) RAE  
41 Aust Water Transport Op Coy (LC) RAE  
M.C. Port Moresby Sub Area  
WAR DIARY (2) ✓  
Port Moresby Detachment  
Milne Bay Detachment.  
FILE

# WAR DIARY or INTELLIGENCE SUMMARY

(Erase heading not required).

Army Form C.2118  
(adapted.)

Unit: 1st. WATER. TPT. CO. COY. (SG). RAR. AIR Date and Time.—From 1 NOV 43 To 30 NOV 43

Place	Date	Hour	Summary of Events and Information	Remarks and references to Appendices, Diaries, &c.
PORT MORESBY	2 NOV 43	2200 hrs	AS20 arrived from YULE ISLAND with 5 tons of fruit for A.G. Hospitals.	
PORT MORESBY	5 NOV 43		Verbal instruction from C.O. that HQ this Company will move to BUNA.	
PORT MORESBY	3 NOV 43		MY "Mulliana" arrived from PORT ROMILLY with 171,000 feet timber approx (350 tons.)	Master reported river is negotiable to Mill with care
PORT MORESBY	6 NOV 43	0800 hrs	ASB went on slip at NAFFA for complete overhaul of hull and engine.	
PORT MORESBY	8 NOV 43	1630 hrs	AK94 arrived from ROMILLY with 70 ton capacity timber and 13 ton capacity of BIRI palm roofing.	
MILNE BAY	9 NOV 43		C.O. visited MILNE BAY Detachment. Favourable comment was made on the greatly improved camp facilities.	
PORT MORESBY	10 NOV 43	0700 hrs	ALCM Mk I AB1140 departed on task of assisting in laying telegraph cable across REDSCAR AND CAUTION BAYS' being the final leg of the Australian New Guinea transocean cable. Carrier Fidegon Service on Coy Craft was inaugurated today messages were received from AB582 en route TERAFO stating position weather and progress.	
BUNA	11 NOV 43	0700 hrs	C.O. Company visited BUNA by AIR on reconnaissance for site of proposed Company HQ.	
	13 NOV 43		Lieut. M. Le. BRADFORD. C.O. PORT MORESBY Detachment detached for duty and departed by AIR to MILNE BAY Detachment to relieve Lieut. E. STEWART proceeding on recreational leave.	
	14 NOV 43	0700 hrs	ALCMs Mk I AB285 AB1139 loaded 12 horses in each and departed for Remount Detachment at DELENA.	Bottom of barges filled with 3 inches sawdust horses in lines of 4 facing forward and closed haltered.
MILNE BAY	15 NOV 43		264 L.A.D. departed 1st line repairs now done by 217 L.A.D. Detachment 3 miles GILLI	
PORT MORESBY	16 NOV 43	0700 hrs	Main party 15 personnel 5 natives 16 tons of stores of this HQ departed on AS20 for BUNA	
		1200 hrs	Ford V 15 cwt truck placed on strength of Company	
		1930 hrs	AB1139 AB285 returned from DELENA Logs show uneventful trip with horses which behaved well.	
		1200 hrs	Made contact with 127 Fd W/Shops and 267 L.A.D. on question of Craft repairs.	

*Leonard*  
Port Adfo.  
1st. Water Transport Coy

# WAR DIARY or INTELLIGENCE SUMMARY

(Erase heading not required).

Army Form C.2118  
(adapted.)

Unit... 12. AUST. WATER TET. OP. COY. (S.G.) BAE AID Date and Time.—From... 1. NOV. 43..... To... 30. NOV. 43.....

Place	Date	Hour	Summary of Events and Information	Remarks and references to Appendices, Diaries, &c.
BUNA	17 NOV 43	0630 hrs	O.C. 1 Officer and 10 other ranks as advance party this HQ departed by AIR to BUNA	
MORESBY		1800 hrs	A Fisheries Section for supply of fish for A.G. Hospitals inaugurated with M.G.F. AS30 attached thereto as trawler.	
BUNA		1800 hrs	Advanced party arrived BUNA tentage and rations arranged by BUNA Detachment 11 Op Coy.	
		1400 hrs	Work commenced on clearing of site layout and erection of this HQ and BUNA Det camp and orderly rooms.	
PORT MORESBY	18 NOV 43	1100 hrs	MSI "AMMA B" arrived as deck cargo from Mainland delivery taken on behalf of Group	
BUNA		0730 hrs	Construction commenced of kitchens latrines and QM Store and of BUNA Detachment Orderly room O.C. paid his respects to Col. HITCHFIELD A.A.Q.M.G. 11 AUST DIV	
PORT MORESBY	19 NOV 43	1630 hrs	Newly constructed stone ramps were used for loading barges and expedited the work considerably	
BUNA	20 NOV 43	0730 hrs	Construction of HQ continued	
PORT MORESBY	21 NOV 43	1100 hrs	Advise from NOYG that MK95 "STR JOHN FRANKLIN" departed Townsville enroute PORT MORESBY ETA PORT MORESBY 30 NOV 43	
		2359 hrs	Took over PORT Duties from 11 Op Coy Buna Detachment	
BUNA	22 NOV 43	0730 hrs	Completed kitchen mess and Sgts Mess	
		1100 hrs	3 ton FORD Truck C26815 from D.A.Q.M.G. 11 Div placed on HQ Strength.	
BUNA	23 NOV 43	0730 hrs	Construction of camp	
PORT MORESBY		1700 hrs	AS15 CAMBERNARA arrived from mainland Trip BRISBANE to Port Moresby SEPT 42 to NOV 43 AS30 commenced operations with Fisheries Sect.	
BUNA	24 NOV 43	1500 hrs	AS56 arrived with HQ Coy main party and stores	
PORT MORESBY		2359 hrs	HQ this Company transferred BUNA	
		2359 hrs	HQ Company closed WO.I. MENZELL placed in charge P.M. Detachment AS15 placed on tri-weekly service to YULE ISLAND procuring fruit for A.G. Hospitals.	
WILHELM BAY			ALCM Mk I Nos 1135 1153 1154 and ALCV Mk II 1012 1021 unloaded from "William Desmond".	



## WAR DIARY or INTELLIGENCE SUMMARY

(Erase heading not required).

Unit 12 AUST WATER TPT OF COV (SC) RAE AIF Date and Time.—From 1 NOV 43 To 30 NOV 43

Army Form C.2118  
(adapted.)

[illegible]

AUSTRALIAN MILITARY FORCESCAMP STANDING ORDERS

BY  
Capt. W.R. EGAN.

12 AUST WATER TRANSPORT OPERATING COMPANY (SMALL CRAFT) RAE AIF

1. DAILY ROUTINE:-

REVEILLE	0630	MESS PARADE	1230
MESS PARADE	0715	RESUME DUTIES	1330
SICK PARADE	0730	AFTERNOON BREAK	1500 - 1510
KIT STAND TO		DISMISSAL	1700
INSPECTION AND DUTY		MESS PARADE	1730
PARADE	0800	RETREAT	1800
MORNING BREAK	1000 - 1010	LIGHTS OUT	2230
LUNCHEON	1200 - 1330		

ABOVE TIMES WILL BE GIVEN BY DISTINCT SIGNAL AND WILL BE STRICTLY ADHERED TO.

oOo

2. DRESS:-

- (i) Personnel at all times will be neat and clean in appearance.
- (ii) Sand shoes will NOT be worn ashore. Boots, gaiters and long trousers will be worn at all times.
- (iii) By 1800 hrs of each day shirts will be buttoned up to second button sleeves will be buttoned at wrist.
- (iv) By specific direction of an officer, shirts may be removed for a particular task.

3. LEAVE:-

- (i) No person shall leave camp precincts without written permission signed by an officer.

4. HYGIENE:-MALARIAL CONTROL:-

- (i) Dress regulations will be strictly observed.
- (ii) Mosquito repellants as prescribed will be used.
- (iii) Mosquito nets will be kept in good repair, will be sprayed at least once daily and will be used.
- (iv) Atebrin tablets will be taken every day save SUNDAY as prescribed.

DYSENTERY:-

- (i) Any symptoms indicating dysentery will be reported immediately to R.A.P.

TYPHUS:-

- (i) Typhus has been found in this locality. Personnel will NOT lie or sit on ground, nor walk with bare feet. Those using showers will remain on concrete floor.

GENERAL:-

- (i) No dirty water will be thrown on ground.
- (ii) All rubbish and garbage will be placed in receptacles provided.
- (iii) Mess Gear will be scrubbed thoroughly immediately after every meal.
- (iv) The water provided within the camp from TANKS is fit for drinking, without further treatment but extreme care will be exercised in use of water from other sources. Water bottles will be filled from TANK at "Q" STORE.
- (v) No green standing trees will be damaged or felled without permission.

5. INSPECTION:-

The Camp and Craft will be inspected daily. All Tents, surroundings and Craft will be in inspection order from 0800 until 1700 hours daily. No equipment, personal gear or washing will be hung on tent ropes. Kit layout will be standardised as indicated in sketch, Only clothes lines provided will be used.

"Q" STORE:-

- (i) Issues and change of Clothing will be on TUESDAY of each week only.  
 (ii) Boots for repairs will be cleaned and handed into "Q" STORE. Laces will be removed and Boots will be clearly marked with Name and Number.

7. DISCIPLINE:-

Compliments will be paid to ALL OFFICERS at ALL times upon an OFFICER coming aboard Craft Masters will stand their crews to. When a visiting or inspecting Officer approaches an instructional or working party the Officer or N.C.O. in charge will report to the Officer and state the work he is carrying out. Unless ordered for a special occasion the party will NOT be brought to attention and work will NOT be interrupted.

*R. E. ...* Capt.  
O.C. 12 AMST WATER TRANSPORT OF COY (SC) RAE AIF

30 NOV 43

SKETCH

HEAD

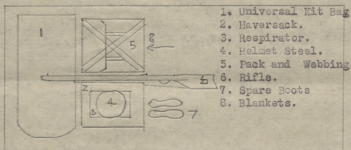

1. Universal Kit Bag
2. Haversack.
3. Respirator.
4. Helmet Steel.
5. Pack and Webbing
6. Rifle.
7. Spare Boots
8. Blankets.

DISTRIBUTION

Notice Board ✓  
 Group HQ ✓  
 File ✓  
 Fort Moresby Detach ✓  
 Milne Bay Detach ✓  
 War Diary.(2) ✓

## FIELD RETURN OF OTHER RANKS

At 0600 Hrs. Saturday 27 / 11 / 1963 12 Aust Water Tpt Op Coy (Small Craft) (Unit 12)

W.E. ~~20~~ 158/2 OFFRS. 31 O.R's 153 + OFFRS. -O.R's. 5 ATT. BY W.E.  
Native 157.

## Part A. Posted Strength, Surplus or Reinforcements Required.

1				2				3				4				5				6				7				8				9				10			
W.E. EXCLUDING ATTACHED.																DETAIL.				ATTACHED ALLOWED BY W.E.																			
Reinfs. Required.	Deficient W.E.	Surplus to W.E.	Posted Strength.					Arm or Corps.	Posted Strength.	Surplus to W.E.	Deficient W.E.	Reinfs. Required.																											
	5		8					W.Os. Class I.																															
	9		9					W.Os. Class II.																															
	1							Squadron or Company Quartermaster Serts.																															
								Staff Sergeants																															
	14		22					Sergeants	AAGC																1														
		7	37					Corporals	AAGC AAGC				1 AAGC				AAGC 1																						
		14	66					Troopers, Privates, etc.	AAGC																2														
								Civilians counting as O.R.																															
	32	21	242					Totals of cols, marked * should agree with details shown in Part E on Page 2.	5				1								4				NR.														

Analysis of Part A to be shown here by ALL units. Only units notified in para. 7 of instructions for compilation of this return will complete analysis of Part B(1) and B(2).

Detail	A.I.F.	C.M.P.		A.W.A.S.	A.A.M.W.S.	CIVIL	R.A.N.	R.A.A.F.	** Natives	TOTAL.
		Under 18 Years.	19 Years and over.							
A	126		16						87	229
B(1)										
B(2)										

\* Personnel belonging to a category not provided for in the analysis will be shown in this Col. Particulars will be shown, e.g., 20 U.K. Forces, 10 N.E. Force.

## Part B. Other Ranks Attached from Other Units.

### Part C. Other Ranks Included in Part A Detached to Other Units.

[illegible]

Part D. Description of Other Ranks Whose Return To\_\_\_\_\_ (Unit) is Particularly Requested. \_\_\_\_\_/\_\_\_\_\_/194

[illegible]



## PART E. Detail of Present Strength and Reinforcements required as shown in

Part A of Army Form W.3009 at 0600 Hours Saturday 27/11/1943.

Details of Tradesmen. GROUP I.	W.E.	Posted Strength.	Reliefs Required.	Details of Tradesmen. GROUP I. (cont.)	W.E.	Posted Strength.	Reliefs Required.	Details of Tradesmen. GROUP II. (cont.)	W.E.	Posted Strength.	Reliefs Required.	Details of Tradesmen. GROUP III. (cont.)	W.E.	Posted Strength.	Reliefs Required.		
Ammunition Exambers			NR	Surveyors, Engineering			NR	Operating Room Assist.			NR	G.P.O. Assistants			NR		
Armament Artificer Fitter				Surveyors, R.A.A.				Operator, Keyboard				Hammermen					
Armament Artificer Fitter (Electrical)				Surveyors, Topographical				Operator, Line				Leather Stitchers					
Armament Artificer Fitter (M.V.)				Surveyors, Tygonometrical				Operator, Signal				Orderlies, Nursing					
Armament Artificer Fitter (A.F.V.)				Toolmakers				Operator, Switchboard				Orderlies, Nursing Mental					
Armament Artificer Instrument				Turners				Operator, Wireless				Plate Layers					
Armament Artificer Radio				Watchmakers				Opticians				Rangefinders					
Armament Artificer Signals				Welders				Painters				Riveters					
Armament Artificer Wireless								Panel Beaters				Roughriders					
Artificer, Artillery								Photographer, Dry Plate				Saddlers					
Artificer, Engine								Predictor Numbers				Saddletree makers					
Blacksmiths								Printers				Shoemaker and Boot Repairer					
Bricklayers		1						Radioographers				Stewards					
Computers								Riggers				Stokers, Staty. Engine					
Cooks, Hospital				GROUP II.				Sawyers				Stonemason, Technical	1	1			
Coppersmiths				Armourers				Signallers				Tailors	1				
Dispensers				Assen				Signwriters				Textile Refitters					
Dranghtsmen				Bakers				Telescope Identia. Numbers				Tinsmiths					
Dranghtsmen (Architectural)				By. Conf's. Asst.				Well Rovers				Vulcanizers					
Dranghtsmen (Engineering)				Boilermakers				Whealers				Wagon Erectors					
Dranghtsmen (Mechanical)				Carpenters		1		Winchman				Whitesmiths					
Dranghtsmen (Typographical)				Carpenters and Joiners				Wireman				Master WO 1	2	1			
Electricians				Cooks				Woodturners				Engineers	8	6			
Electricians (M.V.)				Dental Mechanics								Master WO 1	6	1			
Electricians (Signals)				Driver-Mech. (Eng. and Med.)		2	1					Master WO 2	6	3			
Filters				Driver-Operator								Master WO 1	2	1			
Filters (Cyde)				Drummers								Engineers	2	1			
Filters (Electrical)				Electricians								Cts. M.	1	1			
Filters (Gas)				Electricians (Enginers)								Engineers	6	1			
Filters (Instrument)				Fire Control Operators				GROUP III.				Master WO 1	1	-			
Filters (M.V.)				Gun Operator				Battery Surveyors				C.O.S.	1	-			
Filters, Railway Signal				Headman				Beitchers				Master WO 1	21	13			
Filters, Signals				Height Taker				Clerks		1	2	Master WO 1	6	3			
Grinder, Precision				Hitlo Operator				Clerks, Supply				Engineers	8	6			
Mechanics, Instrument				Instrument Operator				Clerks, Technical				Clerks WO 1	1	1			
Mechanics, Instrument (Signals)				Intelligence Duties				Cook Trimmers				Helman WO 1	6	13			
Mechanics, Instrument (Surgical)				Joiners				Concreters				Engine WO 1	26	19			
Mechanics, Radio				Linsman				Cooks		2		Clerks WO 1	4	4			
Mechanics, Typewriter				Linsman, Signals				Dental Clerk Orderlies				Engine WO 1	1	1			
Mechanics, Wireless				Lithographers				Despatch Riders				Engine WO 1	22	22			
Millwrights				Machinists, Metal				Dranghtmen, Signals				Engine WO 1	6	11			
Operators, Excavator				Machinists, Wood				Drivers, H.T.		2		Engine WO 1	4	3			
Pattern Maker				Masons				Driver Mechanics				Engine WO 1	2	2			
Pharmacist				Masons				Driver Typ. Plant				Engine WO 1	1	1			
Photographer, Wet Plate				Mechanics, M.T.		2		Engine Bands, I.C.		5		Engine WO 1	1	-			
Photewriter				Mines				Equipment Repairs		2		Engine WO 1	4	1			
Plumber				Molders				Farriers				Engine WO 1	1	-			
Saw Doctors				Nurses, Trained				Fitters' Mates				Engine WO 1	1	-			
Surveyors				Observation Post Asst.				Gun Layers				Engine WO 1	4	1			
CARRIED FORWARD		4	NR	CARRIED FORWARD		3	6	NR	CARRIED FORWARD		5	16	NR	Totals of columns marked * to agree with columns 4 and 7, and 1 and 10 of Part A. respectively.	159	103	NR.

NOTES:-(a) If rank other than private is involved give details on back.

(b) Authorized trades or specialists not included in list will be added as required in spaces provided.

(c) Where A.W.A.S. and/or A.A.M.W.S. personnel are desired show details on back.

(d) Where replacement not desired note accordingly on return by insertion of "Not to be Replaced".

(e) Where any request or notation is made on back of form, the words "See Back" should be written on one of the blank spaces on this page.

27/11/43

Date of Despatch

O.C. 12 AUST WATER TPT OF COY (93) RAE AIF.  
Signature of Commander

# FIELD RETURN OF OFFICERS

Army Form W.3005  
(Adapted) (Page 1)  
(Revised Jan., 1943)  
43.0 (Serial No.)

At 0600 Hrs. Saturday 27 / 11 / 1943 12 Aust Water Tpt Coy (SC) RAS AIF (Unit)

W.E. 14 / 15 2 OFFRS. 31 O.R.'s 153 OFFRS. = O.R.'s 5 ATT. BY W.E.

## PART A.—POSTED STRENGTH, SURPLUS OR REINFORCEMENTS REQUIRED.

1	2	3	4	5	6	7	8	9	10				
W.E. EXCLUDING ATTACHED.				DETAIL.	ATTACHED ALLOWED BY W.E.								
Rein'ts Required.	Deficient W.E.	Surplus to W.E.	Posted Strength.		Arm or Corps.	Posted Strength.	Surplus to W.E.	Deficient W.E.	Rein'ts Required.				
	2 2 26 2		- 3 30-11 -	Lieut.-Colonels Majors Captains Lieutenants Quartermasters A.A.N.S. and A.A.M.W.S. Offrs. Civilians Counting as Offrs.									
	27		214										
DETAIL.				A.I.F.	C.M.F.	A.W.A.S.	A.A.N.S.	A.A.M.W.S.	CIVIL.	R.A.N.	R.A.A.F.	* *	TOTAL.
Analysis of Part A to be shown here by A.I.F. units. Only units notified in para. 10 of Instructions for completion of form will complete Part B (1) & E (2).				A.	10	4							14 22
				E.(1)									
				E.(2)									

Analysis of Part A to be shown here by ALL units. Only units notified in para. 10 of Instructions for completion of form will complete Part B (1) & B (2).

\* Insert detail of higher ranks as necessary.

\* \* Personnel belonging to a category not provided for in the analysis will be shown in this Col. Particulars will be shown, e.g., 20 U.K. Forces; 10 N.Z. Forces.

## PART B.—PARTICULARS OF OFFICERS JOINED OR QUITTED DURING WEEK.

### OFFICERS JOINED DURING WEEK

Army No.	Rank.	Name and Initials.	Unit From.	Date.	CAUSE.
<u>NY 18862</u>	<u>LIEUT</u>	<u>CHRISTOPHER R.S.</u>	<u>12 Aust Water Tpt Coy</u>	<u>22 Nov</u>	<u>Inter-bay Transfer</u>
			<u>Small Boat</u>	<u>13</u>	
			<u>R.A.E.-AIF</u>		

### OFFICERS QUITTED DURING WEEK.

Army No.	Rank.	Name and Initials.	Unit To.	Date.	CAUSE.

## PART C.—DESCRIPTION OF OFFICERS WHOSE RETURN TO (Unit) IS

### PARTICULARLY REQUESTED. /194

Army No.	Rank.	Name and Initials.	REMARKS (e.g., present whereabouts if known).

## PART D.—NOMINAL ROLL OF OFFICERS ON POSTED STRENGTH

At 0000 Hrs. Saturday 27/11/1943 (Total to agree with Columns 4 and 7 of Part A.)

1	2	3	4	5	6	7	8
Substantive Rank and Higher Temporary Rank if Held.	Army Number.	Surname.	Initials.	Posting.	Whether present with Unit (Insert Yes or No)	If not present with Unit, state how employed.	Date of Detachment.
Lieut. A/Capt.	MX166078	NEWMAN, W. R.	✓	W. R.	C. C.	YES	
Lieut. A/Capt.	MX2333	WESTON, J.	✓	W. R.	2 1/2	NO	Detached to mainland for rec leave and duty.
Lieut.	MX152905	FRENCH, J.	✓	G.	Adj't	YES	
Lieut.	YB24796	BRADFORD, J.	✓	H. L.	Section Officer	YES	
Lieut.	MX47984	STEWART, J.	✓	E. W.	Section Officer	YES	
Lieut. A/Capt.	MX174992	FORBES, J.	✓	W. A. D.	Master AB20	NO	Detached to Mainland.
Lieut.	M429592	WAINWRIGHT, J.	✓	C. L.	MASTER	YES	
Lieut.	MX49821	HUGH, J.	✓	H. A.	Master	NO	Detached to Mainland.
Lieut.	MX78186	ANGUS, J.	✓	H. D.	Master	NO	Detached to Mainland.
Lieut.	MX56702	BRASSICK, J.	✓	H. J.	Master	NO	" "
Lieut.	M442853	MOODIE, J.	✓	E. F.	Master	NO	" "
Lieut.	2212806	SWINER, J.	✓	E. G.	Master	NO	" "
Lieut.	M429650	VIDER, J.	✓	E. G.	Master	NO	" "
Lieut	MX78163	CHESNIN, J.	✓	R. S.	DO	YES	

## PART E.—NOMINAL ROLL OF OFFICERS ATTACHED FROM OTHER UNITS.

Substantive Rank and Higher Temporary Rank if Held.	Army Number.	Name and Initials.	Unit.	Date of Attachment.	Nature of Attachment.

27 Nov '43.

Date of Despatch

C.C. 12 Aust Water Tpt Co Coy (SG) RAN/AF.

Capt.

# **FIELD RETURN OF OFFICERS**

Army Form W.3008  
(Adapted) (Page 1)  
(Revised Jan., 1943)  
(Serial No.)

At 0600 Hrs. Saturday 10 / 11 / 1943 (Unit) 43 7

W.E. 17 / 154 2 OFFRS. 31 O.R's. 153 + OFFRS. 2 O.R's. 2 ATT. BY W.E.

## **PART A.—POSTED STRENGTH, SURPLUS OR REINFORCEMENTS REQUIRED.**

1	2	3	4	5	6	7	8	9	10
W.E. EXCLUDING ATTACHED.				DETAIL.	ATTACHED ALLOWED BY W.E.				
Rein'ts Required.	Deficient W.E.	Surplus to W.E.	Posted Strength.		Arm or Corps.	Posted Strength.	Surplus to W.E.	Deficient W.E.	Rein'ts Required.
				Lieut.-Colonels					
				Majors					
				Captains					
				Lieutenants					
				Quarter-masters					
				A.A.N.S. and					
				A.A.M.W.S. Offrs.					
				Civilians Counting as Offrs.					
<u>10</u>	<u>1</u> <u>9</u> <u>7</u> <u>1</u>		<u>3</u> <u>10</u> <u>1</u>						

DETAIL.	A.I.P.	C.M.P.	A.W.A.S.	A.A.N.S.	A.A.M.W.S.	CIVIL.	R.A.N.	R.A.A.P.	**	TOTAL.
A.	<u>9</u>	<u>4</u>								<u>13</u>
E. (1)										
E. (2)										

Analysis of Part A to be shown here by ALL units. Only units notified in para. 10 of Instructions for completion of form will complete Part E(1) & E(2).

\* Insert detail of higher ranks as necessary.

\*\* Personnel belonging to a category not provided for in the analysis will be shown in this Col. Particulars will be shown, e.g., 20 U.K. Forces; 10 N.Z. Forces

## **PART B.—PARTICULARS OF OFFICERS JOINED OR QUITTED DURING WEEK.**

### **OFFICERS JOINED DURING WEEK.**

Army No.	Rank.	Name and Initials.	Unit From.	Date.	CAUSE.

### **OFFICERS QUITTED DURING WEEK.**

Army No.	Rank.	Name and Initials.	Unit To.	Date.	CAUSE.

## **PART C.—DESCRIPTION OF OFFICERS WHOSE RETURN TO (Unit) IS**

### **PARTICULARLY REQUESTED. / 194**

Army No.	Rank.	Name and Initials.	REMARKS (e.g., present whereabouts if known).



12 4200(80) NAR AIR

## 7

At 0600 Hrs. Saturday...../...../194..... (Total to agree with Columns 4 and 7 of Part A.)

1	2	3	4	5	6	7	8
Substantive Rank and Higher Temporary Rank if Held.	Army Number.	Surname.	Initials.	Posting.	Whether present with Unit (Insert Yes or No)	If not present with Unit, state how employed.	Date of Detachment.
Lieut A/Capt	HX186072	HEAN	W.H.	C.O.	Yes		
Lieut A/Capt	HX2883	Western	W.H.	24/8	No	Detached to mainland for rec leave and duty	
Lieut	HX182705	French	G.	27/4	Yes		
Lieut	VX14795	Bradford	H.L.	See Off.	Yes		
Lieut	HX47086	Stewart	H.E.	See Off.	Yes		
Lieut Capt	HX174998	Forsman	W.A.D.	A.D.C.	No	Detached to mainland	
Lieut	HX28692	Wainwright	G.L.	A.D.C.	Yes		
Lieut	HX40421	Hage	H.H.	A.P.	No	Detached to 41 ANZOC(L) RAN AIF.	
Lieut	HX78184	Ingus	H.D.	Master	No	Detached to mainland	
Lieut	HX56408	Grassick	H.F.	Master	No	" " "	
Lieut	H 46885	Woodle	G.F.	"	"	" " "	
Lieut	CH27006	Pandora	E.C.	"	"	" " "	
Lieut	HX26640	Vicor	H.D.	"	"	" " "	

**PART E.—NOMINAL ROLL OF OFFICERS ATTACHED FROM OTHER UNITS.**

[illegible]

*Date of Despatch*

Signature of Commander

Truth—1/48



**PART E. Detail of Present Strength and Reinforcements required as shown in**

Part A of Army Form W.3009 at 0600 Hours Saturday

Details of Tradesmen. GROUP I.			Details of Tradesmen. GROUP I. (cont.)			Details of Tradesmen. GROUP II. (cont.)			Details of Tradesmen. GROUP II. (cont.)		
W.E.	Posed Strength.	Skills Required.	W.E.	Posed Strength.	Skills Required.	W.E.	Posed Strength.	Skills Required.	W.E.	Posed Strength.	Skills Required.
Armament Examiners			Surveyors, Engineering			Operating Room Assts.			G.P.O. Assistants		
Armament Artificer Filter			Surveyors, E.S.A.			Operator, Keyboard			Hammermen		
Armament Artificer Filter (Electrical)			Surveyors, Topographical			Operator, Lins			Leather Stitches		
Armament Artificer Filter (M.V.)			Surveyors, Tigmotometrical			Operator, Signal			Orderlies, Nursing		
Armament Artificer Filter (A.P.T.)			Toolmakers			Operator, Switchboard			Orderlies, Nursing Mental		
Armament Artificer Instrument			Turners			Operator, Wirelens			Plate Layers		
Armament Artificer Radio			Watchmakers			Opticians			Rangefinders		
Armament Artificer Signals			Welders			Painters			Riveters		
Armament Artificer Wirelens						Panel Beaters			Roughriders		
Artificer, Artillery						Photographer, Dry Plate			Saddlers		
Artificer, Engine						Predictor Numbers			Saddletree makers		
Blacksmiths						Printers			Shoemaker and Boot Repairer		
Bricklayers						Radiographers			Stereos		
Computers						Riggers			Stokers, Stat. Engine		
Cooks, Hospital			GROUP II.			Sawyers			Storemen, Technical		
Coppersmiths			Armourers			Signallers			Tailors		
Dispensers			Assenon			Signwriters			Textile Reriters		
Draughtsmen			Bakers			Telescope Ident. Numbers			Tinsmiths		
Draughtsmen (Architectural)			Bly, Comd's. Asst.			Well Rovers			Vulcanizers		
Draughtsmen (Engineering)			Boilermakers			Whodlers			Wagon Builders		
Draughtsmen (Mechanical)			Carpenters			Winchman			Whitewashers		
Draughtsmen (Topographical)			Carpenters and Joiners			Wireman					
Electricians			Cooks			Woodturners					
Electricians (M.V.)			Dental Mechanics								
Electricians (Signal)			Driver-Mech. (Eng. and Med.)								
Fitters			Driver-Operator								
Fitters (Cycle)			Drainers								
Fitters (Electrical)			Electricians								
Fitters (Gun)			Electricians (Engineers)								
Fitters (Instrument)			Fire Control Operators			GROUP III.					
Fitters (M.V.)			Gun Operator			Battery Surveyors					
Fitters, Railway Signal			Hatchman			Butchers					
Fitters, Signals			Height Taker			Clerks					
Grinder, Precision			Holla Operator			Clerks, Supply					
Mechanics, Instrument			Instrument Operator			Clerks, Technical					
Mechanics, Instrument (Signals)			Intelligence Duties			Coach Trimmers					
Mechanics, Instrument (Surgical)			Joiners			Concretors					
Mechanics, Radio			Lineman			Cooks					
Mechanics, Typewriter			Linemans, Signals			Dental Clerk Orderlies					
Mechanics, Wirelens			Lithographers			Despatch Riders					
Millwrights			Machinists, Metal			Draughtsmen, Signals					
Operators, Extrator			Machinists, Wood			Drivers, E.T.					
Pattern Maker			Masons			Driver Mechanics					
Pharmacists			Measurs			Driver Typis. Plant					
Photographer, Wet Plate			Mechanics, M.T.			Engine Hands, I.C.					
Photewriter			Mixers			Equipment Repairers					
Plumber			Moulders			Farriers					
Saw Doctors			Nurses, Trained			Filters' Males					
Surveyors			Observation Post Assts.			Gun Layers					
CARRIED FORWARD			CARRIED FORWARD			CARRIED FORWARD					

NOTES.—(a) If rank other than private is involved give details on back.  
(b) Authorized trades or specialties not included in list will be added as required in spaces provided.  
(c) Where A.W.A. and/or A.A.M.W.S. personnel are desired show details on back.  
(d) Where replacement not desired note accordingly on return by insertion of N.R. in col. "Reints. Required."  
(e) Where any request or notation is made on back of form, the words "See Back" should be written in one of the blank spaces on this page.

Date of Despatch

ADATT

Signature of Commander **1Aout**

# FIELD RETURN OF OFFICERS

Army Form W.3008  
(Adapted) (Page 1)  
(Revised Jan. 1949)

At 0600 Hrs. Saturday

19 11 / 194

(Unit)

W.E. IV / 15K / 2 OFFRS. 21 O.R.'s. 153 + OFFRS. 111 O.R.'s. 5 ATT. BY W.E.

## PART A.—POSTED STRENGTH, SURPLUS OR REINFORCEMENTS REQUIRED.

1	2	3	4	5	6	7	8	9	10
W.E. EXCLUDING ATTACHED.				DETAIL.	ATTACHED ALLOWED BY W.E.				
Rein'ts Required.	Deficient W.E.	Surplus to W.E.	Posted Strength.		Arm or Corps.	Posted Strength.	Surplus to W.E.	Deficient W.E.	Rein'ts Required.
	1	-	-	Lieut.-Colonels					
	9	-	3	Majors					
	7	-	10	Captains					
	1	-	-	Lieutenants					
				Quarter-masters					
				A.A.N.S. and A.A.M.W.S. Offrs.					
				Civilians Counting as Offrs.					
15	-		13						

DETAIL.	A.I.P.	C.M.P.	A.W.A.S.	A.A.N.S.	A.A.M.W.S.	CIVIL.	R.A.N.	R.A.A.F.	**	TOTAL.
A.	9	4								13
E (1)										
E (2)										

\* Insert detail of higher ranks as necessary.  
\*\* Personnel belonging to a category not provided for in the analysis will be shown in this Col. Particulars will be shown, e.g., 20 U.K. Forces; 10 N.Z. Forces

## PART B.—PARTICULARS OF OFFICERS JOINED OR QUITTED DURING WEEK.

### OFFICERS JOINED DURING WEEK.

Army No.	RANK.	Name and Initials.	Unit From.	Date.	CAUSE.
		NIL			

### OFFICERS QUITTED DURING WEEK.

Army No.	RANK.	Name and Initials.	Unit To.	Date.	CAUSE.
		NIL			

## PART C.—DESCRIPTION OF OFFICERS WHOSE RETURN TO (Unit) IS

### PARTICULARLY REQUESTED. / 194

Army No.	RANK.	Name and Initials.	REMARKS (e.g., present whereabouts if known).
		NIL	







**PART E. Detail of Present Strength and Reinforcements required as shown in  
Part A of Army Form W.3009 at 0600 Hours Saturday 13/11/1943.**

Details of Tradesmen. GROUP I.	W.E.	Posted Strength.	Reinfs. Required.	Details of Tradesmen. GROUP I. (cont.)	W.E.	Posted Strength.	Reinfs. Required.	Details of Tradesmen. GROUP II. (cont.)	W.E.	Posted Strength.	Reinfs. Required.	Details of Tradesmen. GROUP III. (cont.)	W.E.	Posted Strength.	Reinfs. Required.
Ammunition Examiners				Surveyors, Engineering				Operating Room Aids.				G.P.O. Assistants			
Armament Artificer Fitter				Surveyors, R.A.A.				Operator, Keyboard				Hammermen			
Armament Artificer Fitter (Electrical)				Surveyors, Topographical				Operator, Line				Leather Stitchers			
Armament Artificer Fitter (M.V.)				Surveyors, Trenchmedical				Operator, Signal				Orderlies, Nursing			
Armament Artificer Fitter (A.F.V.)				Toolmakers				Operator, Switchboard				Orderlies, Nursing Mental			
Armament Artificer Instrument				Turners				Operator, Wireless				Plate Layers			
Armament Artificer Radio				Watchmakers				Opticians				Range-takers			
Armament Artificer Signals				Welders				Painters				Riveters			
Armament Artificer Wireless								Panel Beaters				Roughriders			
Artificer, Artillery								Photographer, Dry Plate				Saddlers			
Artificer, Engine								Predictor Numbers				Saddle-tree makers			
Blacksmiths								Printers				Shoemaker and Boot Repairer			
Bricklayers								Radiographers				Stevordors			
Computers								Signers				Stokers, Staly, Engine			
Cooks, Hospital				GROUP II.				Sawyers				Storemen, Technical			
Coppersmiths				Armourers				Signalers				Tailors			
Dispensers				Axemen				Signwriters				Textile Redditors			
Dranghtsmen				Bakers				Telescope Identfn. Numbers				Tinsmiths			
Dranghtsmen (Architectural)				Blz. Comd'g. Asst.				Well Borers				Volunteers			
Dranghtsmen (Engineering)				Bellmakers				Wheelers				Wagon Erectors			
Dranghtsmen (Mechanical)				Carpenters				Winchman				Whitesmiths			
Dranghtsmen (Topographical)				Carpenters and Joiners				Wireman							
Electricians				Cooks				Woodturners							
Electricians (M.V.)				Dental Mechanics											
Electricians (Signals)				Driver-Mech. (Eng. and Med.)											
Fitters				Driver-Operator											
Fitters (Cycle)				Drainers											
Fitters (Electrical)				Electricians											
Fitters (Gun)				Electricians (Engineers)											
Fitters (Instrument)				Fire Control Operators				GROUP III.							
Fitters (M.V.)				Gun Operator				Battery Surveyors							
Fitters, Railway Signal				Halchman				Butchers							
Fitters, Signals				Height Taker				Clerks							
Grinder, Precision				Hells Operator				Clerks, Supply							
Mechanics, Instrument				Instrument Operator				Clerks, Technical							
Mechanics, Instrument (Signals)				Intelligence Duties				Coach Trimmers							
Mechanics, Instrument (Surficial)				Joiners				Concretors							
Mechanics, Radio				Lineman				Cooks							
Mechanics, Typewriter				Lineman, Signals				Dental Clerk Orderlies							
Mechanics, Wireless				Lithographers				Despatch Riders							
Millwrights				Machinists, Metal				Dranghtsmen, Signals							
Operators, Excavator				Machinists, Wood				Drivers, H.T.							
Pattern Maker				Masons				Driver Mechanics							
Pharmacist				Masons				Driver Tynt. Plant							
Photographer, Wet Plate				Mechanics, M.T.				Engine Hands, I.C.							
Plasterer				Miters				Equipment Repairers							
Plumber				Shedders				Farriers							
Saw Doctors				Nurses, Trained				Fitters' Mates							
Surveyors				Observation Post Aids.				Gun Layers							
CARRIED FORWARD				CARRIED FORWARD				CARRIED FORWARD				Totals of columns marked * to agree with columns 4 and 7, and 1 and 10 of Part A, respectively.			

NOTES—(a) If rank other than private is involved give details on back.  
(b) Authorised trades or specialties not included in list will be added as required in spaces provided.  
(c) Where A.W.A.B. and/or A.A.M.W.B. personnel are desired show details on back.  
(d) Where replacement not desired note accordingly on return by inserting of N.E. in col. "Reinfs. Required."  
(e) Where any request or notation is made on back of form, the words "See Back" should be written in one of the blank spaces on this page.

Date 13/11/43

Signature of Commander

11 Oct.

# **FIELD RETURN OF OFFICERS**

Army Form W.3008  
(Adapted) (Page 1)  
(Revised Jan., 1943)  
(Serial No.)

At 0600 Hrs. Saturday 18/12/1943 <sup>12/43</sup> (Unit)

W.E. 14/167 1. OFFRS. 7 O.R.'s 20 + OFFRS. 1 O.R.'s ATT. BY W.E.

## **PART A.—POSTED STRENGTH, SURPLUS OR REINFORCEMENTS REQUIRED.**

1	2	3	4	5	6	7	8	9	10				
W.E. EXCLUDING ATTACHED.				DETAIL	ATTACHED ALLOWED BY W.E.								
Rein'ts Required.	Deficient W.E.	Surplus to W.E.	Posted Strength.		Arm or Corps.	Posted Strength.	Surplus to W.E.	Deficient W.E.	Rein'ts Required.				
1/3	2	2	1/3	Lieut.-Colonels Majors Captains Lieutenants Quarter-masters A.A.N.S. and A.A.M.W.S. Offrs. Civilians Counting as Offrs.	AANIC			1	1				
1	2	2	5					1	1				
DETAIL.				A.T.P.	C.M.P.	A.W.A.S.	A.A.N.S.	A.A.M.W.S.	CIVIL.	R.A.N.	R.A.A.F.	**	TOTAL.
A.				5									5
E. (1)													
E. (2)													

Analysis of Part A to be shown here by ALL units. Only units notified in para. 10 of Instructions for completion of form will complete Part E(1) & E(2).

\* Insert detail of higher ranks as necessary.

\*\* Personnel belonging to a category not provided for in the analysis will be shown in this Col. Particulars will be shown, e.g., 20 U.K. Forces; 10 N.Z. Forces

## **PART B.—PARTICULARS OF OFFICERS JOINED OR QUITTED DURING WEEK.**

### **OFFICERS JOINED DURING WEEK.**

Army No.	Rank.	Name and Initials	Unit From.	Date.	CAUSE
NY 27664	LIEUT	17 CHIT MARSHALL L H	AACC	19/12/43	Posted as Quarter-master (Auth. AMIS 9158 of 8/12/43)

### **OFFICERS QUITTED DURING WEEK.**

Army No.	Rank.	Name and Initials	Unit To.	Date.	CAUSE

## **PART C.—DESCRIPTION OF OFFICERS WHOSE RETURN TO (Unit) IS PARTICULARLY REQUESTED. .... / ..... / 194.....**

Army No.	Rank.	Name and Initials	REMARKS (e.g., present whereabouts if known).



At 0600 Hrs. Saturday 18/12/1943.... (Total to agree with Columns 4 and 7 of Part A.)

**PART E.—NOMINAL ROLL OF OFFICERS ATTACHED FROM OTHER UNITS.**

Date of Despatch

Signature of Commander

Truth--1/42.

12 43

At 0600 Hrs. Saturday 18/12/1943

W.E. 14/1541 OFFRS. 7 O.R's. 20 OFFRS. 1541 O.R's. 7 ATT. BY W.E.

1	2	3	4	5	6	7	8	9	10
W.E. EXCLUDING ATTACHED.				DETAIL.	ATTACHED ALLOWED BY W.E.				
Reinfa. Required.	Deficient W.E.	Surplus to W.E.	Posted Strength.		Arm or Corps.	Posted Strength.	Surplus to W.E.	Deficient W.E.	Reinfa. Required.
			1	W.Cs. Class I.					
			2	W.Cs. Class II.					
			-	Squadron or Company Quartermaster Sigs.				1	1
			-	Staff Sergeants	AAMC				
		4	6	Sergeants	AAPC	1			
		2	7	Corporals	AAPS	1			
N.R.	1		7	Troopers, Privates, etc.	AAPC	1		1	-
			-	Civilians counting as O.R.	AAPC	2			
-	1	6	25	Totals of cols. marked * should agree with details shown in Part E on Page 2.		5	-	2	1

\* \* Personnel belonging to a category not provided for in the analysis will be shown in this Col. Particulars will be shown, e.g., 20 U.K. Forces, 10 N.Z. Forces.

[illegible]

**Part C. Other Ranks Included in Part A Detached to Other Units.**

[illegible]

## Part D. Description of Other Ranks Whose Return To.....(Unit) is Particularly Requested. .... / .... / 194.....

[illegible]

**PART E. Detail of Present Strength and Reinforcements required as shown in**

Part A of Army Form W.3009 at 0600 Hours Saturday 18/12/1943.

[illegible]

NOTES.—(a) If rank other than private is involved give details on back.

(b) Authorized trades or specialists not included in list will be added as required as provided.

(d) Where replacement not desired note accordingly on letter by insertion of "RE" in col. "Reins. Required".

(e) Where any request or notation is made on back of form, the words "See Back" should be written in one of the blank spaces on this page.

(e) Write any request or information on back of page, 1200 words. Do not exceed 1200 words on this page.

Date of Despatch

a.w. dim hls 3/43

Signature of Commander

## WAR DIARY or INTELLIGENCE SUMMARY.

(Erase heading not required.)

Army Form C. 118.  
(adapted.)

Unit 12 AUST WATER TPT CP COY (SC) RAE Date and Time.—From 1 DEC 43 To 31 DEC 43

Place.	Date.	Hour.	Summary of Events and Information.	Remarks and references to Appendices, Diaries, &c.
BUNA	1 DEC 43		Wireless <del>Re</del> al re-aligned at right angles to direction from Port Moresby Control Station and raised to 40 feet above surface of lagoon. Sigs report greatly improved reception.	
BUNA	2 DEC 43		AK95 "Sir John Franklin to this Company Strength. Buna harbour crowded with shipping including 31 Landing Craft Tanks.	
BUNA	5 DEC 43		Red alert at 2200 hours E/A understood to have approached within 13 miles and then turned northward.	
BUNA	6 DEC 43		T/Capt H.R. RICH reported to this HQ and took up duty as A/C.G.M.	
BUNA	7 DEC 43		3 A.L.C.V.'s and 4 A.L.C.M.'s MKI and 14 personnel 42 Aust Water Tpt Op Coy (LC) RAE ex "R.F. WARDER" for maintenance and forward movement to LAE	
BUNA	8 DEC 43		AK95 arrived 47 days out from Hobart via Brisbane and Port Moresby Master	
BUNA	10 DEC 43		Lieut. MARLEY, R.N.	
			Group Instructs that as from this date that craft as shown on T188 of 10 DEC 43 be regarded as on strength of this Company, irrespective of location and/or duty. Surplus of certain craft e.g. KITCHES, TRAILERS, LUGGERS, and BARGES LAUNCHES over W.E. together with retention of so big a percentage of personnel on mainland more than out weights any shortage of other types of craft and renders necessary manning of craft below requirements and enlistment of personnel in excess of W.E.	
BUNA	13 DEC 43		AL212 "WATER" arrived 17 days out from GILLI with considerable quantity of fruit from Spear Island. Attempts to pass some to A.S.N.'s in locality were unsuccessful but the position for future consignments is now being investigated.	
BUNA	15 DEC 43	0930 hours	AS56 left to convey 1 ALCM MKII 3 ALCM MKI 2 ALCV's MKII BUNA-LAE via TALEU BAY. O.C. Company in charge of Convey 5 breakdowns (mechanical) occurred but in every case delay was negated by placing a barge on each side and completing repairs while under way.	
BUNA	16 DEC 43		2 ALCM MK II 1 ALCM MK I 1 ALCM MKIX departed BUNA-LAE via TALEU BAY.	
MORCBE	17 DEC 43		O.C. inspected MORCBE Detachment.	
TALEU BAY	17 DEC 43		ALCM MKI and ALCM MKII loaded with 1/155 m.m. Flia piece each nett tonnage 15 tons conveyed to LAE without difficulty	
LAE	18 DEC 43		All barges and AS56 to LAE at 1800 hours under own cover	

L.

By Authority: L. F. JOHNSON, Commonwealth Government Printer, Canberra.



## WAR DIARY or INTELLIGENCE SUMMARY.

(Erase heading not required.)

Army Form 118.  
(adapted.)

Unit: AUST WATER TPT OF COY (SG) RAE AL Date and Time.—From 1 DEC 43 To 31 DEC 43

Place.	Date.	Hour.	Summary of Events and Information.	Remarks and references to Appendices, Diaries, &c.
BUNA	19 DEC 43		Lieuts NEAVE G. and Gairns reported for duty this Company. Lieut NEAVE posted Acting Assistant Adjutant. Lieut Gairns acting O.C.—BUNA Detachment.	
BUNA	21 DEC 43		O.C. departed by air Dobo-Dura - Port Moresby and Milne Bay for inspection of Detachments.	
BUNA	22 DEC 43		Signal received that AL12 had gone aground in a squall near ABASI. Full report by Lieut. NEAVE Investigating Officer together with statements of various persons concerned is going forward to Group H.Q. AL12 was damaged and has been passed to A.E.M.E.	
MILNE BAY	22 DEC 43		O.C. Coy arrived 1400 hours per plane and inspected Office Camp and Craft and expressed satisfaction at the general condition of the Detachment.	
BUNA	23 DEC 43		AL12 together with salvage vessel AS22 under Lieut FARMON arrived BUNA.	
MILNE BAY			O.C. Coy to KUTARA - HQ 31 Maintenance Coy gave E.T.C. of craft under maintenance as follows:- AM5        " REQUIRES New Engine    E.T.C. indefinite AM40       " Timber and Engine    " 23 JAN 44 AM43       " Engine                " 30 DEC 43 AM105      " Mech. ETC 3 days after receipt of parts AL240      " Bearings        ETC 27/28 DEC 43 AM12       " Timber                " 7 JAN 44	
PORT MORESBY	24 DEC 43		217 L.A.D. AM1439 Clutch shaft 7 JAN 44 O.C. arrived by air from MILNE BAY Inspected Billets Offices and Craft.	
BUNA	25 DEC 43		Christmas Day was commemorated here at Detachment HQ at PORT MORESBY MILNE BAY and on all craft by a Service, A.C.F. and individual Hampers were augmented at the rate of 8/- per man from Regimental Funds. A total of about £57/-/- Seasonal Greetings were exchanged with Detachments, Group and Company HQ.	
PORT MORESBY	26 DEC 43		Deep regret is felt throughout the Company on departure of Lt Col.	

L.

By Authority: L. F. JONES, Commonwealth Government Printer, Canberra.

LEDERWOOD Commanding Officer of Group. It is understood he will be returning to this area as C.R.E. DOCK and it is anticipated that his kindly interest in Small Ships personnel will continue.

## WAR DIARY or INTELLIGENCE SUMMARY.

(Erase heading not required.)

Army Form C.27/8.  
(adapted.)

Unit 12 AUSTRALIAN TROPICAL COY (SC) RAE AIF. Date and Time.—From 1 DEC 43 To 31 DEC 43

Place.	Date.	Hour.	Summary of Events and Information.	Remarks and references to Appendices, Diaries, &c.
Moresby				
MTINE BAY	27 DEC 43		AK94 departed via BALASANA - BUNA to LAE and will be attached BUNA for duty.	
BUNA	28 DEC 43		Following formation of a sandbank, serious erosion of foreshore adjacent to Company Camp a series of groins was commenced and appear to be acting efficiently. Recreation Hut 40' x 20' with Canteen and Ration Store attached is under construction in Native Timber and Bird thatching A.C.F. and Salvation Army have volunteered assistance in furnishings and fittings. AM53 departed conveying 8 barges with final destination LAE. AM53 on completion of task will be stationed BUNA for duty.	
PORT MORESBY	29 DEC 43		3/ALCV's Mk II and 4/ALCM MKI ex "William Burnham" together with 14 Barge personnel were received here by Ordnance today. All are under A.E.M.S. for necessary maintenance. Upon being received from Ordnance and under instruction from Group HQ 1/ALCV and 1/ALCM will be taken on strength this Coy together with 4 barge personnel. Remaining barges will be sent forward MM in convey to LAE.	
BUNA	30 DEC 43			
BUNA	31 DEC 43		Capt WESTERN 2 i/c Coy returned from recreational leave and will combine with normal duties those of A/Adjt during absence of Lieut FRENCH as from 2 JAN 44 initially at 3 weeks Transportation and Movement School N.O.F. and subsequently on Recreational Leave. Since commencement of Operations on 1 OCT 43 the Company has experienced material changes. Posted strength has increased materially i.e.	
			As at 1 OCT 43	
			OFFICERS	
			11	
			30	
			96	
			TOTAL	
			187	
			As at 31 DEC 43	
			18	
			112	
			106	
			236	
			CRAFT ON ACTIVE LIST NEW GUINEA	
			TRAILERS Allocated 1 OCT 43	
			43.6	
			CN HAND 31 DEC 43	
			6	
			LAUNCHES	
			15	
			23	
			LANDING CRAFT	
			2	
			5	
			KETCHES	
			1	
			2	
			TUGS	
			1	
			2	
			LUGGERS	
			10	
			10	

By Authority: L. F. JOHNSON, Commonwealth Government Printer, Canberra.

DINCHIES

LIGHTERS

4

4

## WAR DIARY or INTELLIGENCE SUMMARY.

(Erase heading not required.)

Army Form C. 118.  
(adapted)Unit 12 AUST WATER TPT COY (SC) RAE AIF Date and Time.—From 1 DEC 43 To 31 DEC 43

Place.	Date.	Hour.	Summary of Events and Information.	Remarks and references to Appendices, Diaries, &c.
			<u>OPERATIONAL RESULTS</u>	
			<u>GRAND TOTAL</u> From 1 OCT 43 to 31 DEC 43 15,425. <u>PASSENGERS</u> 9424	
			<u>TOTAL MILEAGE</u> From 1 OCT 43 to 31 DEC 43 33,456.	
	31 DEC 43		Initially Company was formed with HQ Port Moresby Controlling Detachments at PORT MORESBY and GILLI (MILNE BAY) operating over an extreme range of coast line from MILNE BAY to TERAFO. As from 24 NOV 43 HQ Coy have been located at BUNA with Detachments at MOREBE, BUNA, GILLI, PORT MORESBY, and TULE ISLAND extending from PORT ROSSLY to FINSCHAVEN - a total of 900 miles of coastline. Experience shows the following discrepancies in W.E.T.	
			(1) Urgent necessity for addition thereto of ARMOURER and 2 RIGGERS	
			(2) Necessity for recognition of the fact that craft of various types are and will be carried in excess of W.E. and official consent obtained for excess personnel to be carried.	
			<u>W.E.T.</u> The continually deferred issue of even a provisional W.E.T. for Company is a continual embarrassment to G.M. and renders it virtually impossible to furnish and keep vessels supplied with correct stores, to render Inventories and Store lists as required.	
			An excellent spirit of keenness and initiative is evident throughout the Company and confidence is expressed that all personnel will be found more than capable of any tasks called for in the coming year.	
			 Capt.	
			C.O. 12 AUST WATER TRANSPORT OPERATING COY (SC) RAE AIF.	
			7 JAN 44.	