

5/50/3

AUSTRALIAN ARCHIVES
ACCESS STATUS

OPEN

JANUARY TO
MAY 1945

ORIGINAL

H.Q. 3 DOCKS GROUP
R.A.E.

WAR DIARY or INTELLIGENCE SUMMARY.

(Erase heading not required.)

Army Form C.2118.
(Adap ed.)

Unit. HQ 3 AUST DOCKS GROUP RAS Date and Time.—From _____ To _____

Place.	Date.	Hour.	Summary of Events and Information.	Remarks and references to Appendices, Diaries, &c.
NEW GUINEA.	1 Jan 45		Report on Port Facilities, Port of LAE forwarded to higher formation	See Appendix A
	1 Jan 45		Report on Port Facilities, Port of JACQUINOT BAY submitted to higher formation	See Appendix B
	1 Jan 45		Report on Port Facilities, TOROKINA submitted to higher formation	See Appendix C
	2 Jan 45		VX58005 Lt-T/Capt R.H.E. McDONALD promoted Capt.	
	3 Jan 45		VX20762 Lt. G.M. SALTHOUSE 2/31 Aust Docks Op Coy promoted Capt.	
	3 Jan 45		QX30162 Spr TYSALL, G.J. 2/2 Aust Docks Op Coy recommended for MID.	
	4 Jan 45		VX31583 Major E.B. THURMAN, marched in and taken on strength HQ 3 AUST DOCKS GROUP	
	5 Jan 45		TX4702 Lt. P. CARTLEDGE } TX8485 Lt. L.A. GAUNT } Posted to 6 Aust Docks Op Coy	

WAR DIARY or INTELLIGENCE SUMMARY.

(Erase heading not required.)

Army Form C.2118.
(Adap ed.)

Unit. HQ 3 AUST DOCKS GROUP RA Date and Time.—From _____ To _____

Place.	Date.	Hour.	Summary of Events and Information.	Remarks and references to Appendices, Diaries, &c.
	7 Jan 45		NX25345 Capt. M.M. MILLER, arrived HQ ex 6 Aust Docks Op Coy for onward movement	
	9 Jan 45		NX254345 Capt. M.M. MILLER, emplaned ex LAE for mainland	
	11 Jan 45		VX11582 Lt. E.P. MARTYN, transferred to 7 Aust Docks Op Coy	
	14 Jan 45		Diver despatched LAE - AITAPE for salvage operations	
	18 Jan 45		2/31 Aust Docks Op Coy det MADANG- re-organised to operate 5 hatch ship by incl native winchmen and hatchmen.	
	18 Jan 45		2/31 Aust Docks Op Coy, MADANG instructed to det 6 gangs incl 2 offrs for operations under direction Docks Supt. AITAPE.	
	20 Jan 45		8 Aust Docks Op Coy classified AIF Unit.	
	22 Jan 45		HQ 3 Aust Docks Group classified AIF Unit.	
	27 Jan 45		WX35083 Lt. J.J. GLANCE, posted to 4 Aust Docks Op Coy	
	28 Jan 45		VX15664 Capt. L.F. WOODS, 6 Aust Docks Op Coy promoted to T/Major to dat 24.1.45 Authority First Aust Army MS 407	

SECRET

HQ 3 Aust Docks Gp,
NEW GUINEA.

10 FEB. '45

Col (Mov & Tn)
FIRST AUST ARMY(AIF)

MONTHLY REPORT - JANUARY 1945

Part 1. - ADMINISTRATION

(a) Dis position of Staff

PORT	UNIT	TYPE	OFFRS	ORs
LAE	HQ 3 Aust Docks Group	Group HQ.	5	22
	2/2 Aust Docks Op Coy	Type "C"	7	284
	2/31 Aust Docks Op Coy	Type "D"	1	23
	6 Pl 1 Aust Port Maint Coy	Pl	1	39

PORT MORESBY	32 Aust Docks Op Coy	Type "D"	4	102

FINSCHHAFEN	Det 7 Aust Docks Op Coy (Transferred to AITAPE)	Type "C"	-	3
	Det 2/2 Aust Docks Op Coy	Type "C"		3

MADANG	2/31 Aust Docks Op Coy	Type "D"	1	51

HOSKINS	Voyage only personnel			

AITAPE	7 Aust Docks Op Coy	Type "C"	7	302
	2/31 Aust Docks Op Coy	Type "D"	2	36
	6 Pl 1 Aust Port Maint Coy	Pl	-	29

JACQUINOT BAY	33 Aust Docks Op Coy	Type "D"	4	108
	4 Pl 1 Aust Port Maint Coy	Pl	-	22

TOROKINA	6 Aust Docks Op Coy	Type "C"	7	296
	3 Pl 1 Aust Port Maint Coy	Pl	1	33

(b) General Remarks

NIL

MONTHLY REPORT - JANUARY 1945Part 11. - OPERATIONS(a) SUMMARY OF TONNAGES HANDLED

PORT	UNIT	No of ships handled incl. Small Craft	Tonnage Loaded		Tonnage Discharged		TOTAL Tonnage
LAE	2/2 Aust Docks Op Coy	36 incl. 15 Small Craft	Meas.T. DWT	5,047 2,997	Meas.T. DWT	6,504 2,124	Meas.T. DWT 11,551 5,121
	2/31 Aust Docks Op Coy	NIL		-		-	-

PORT MORESBY	32 Aust Docks Op Coy	8 Ships	Meas.T. DWT	7,610 2,500	Meas.T. DWT	2,310 770	Meas.T. DWT 9,920 3,270

FINSCHHAFEN	Det 7 Aust Docks Op Coy	15 Small Craft	Meas.T. DWT	871 192	Meas.T. DWT	58 11	Meas.T. DWT 929 203
	Det 2/2 Aust Docks Op Coy	6 Incl. 5 Small Craft	Meas.T. DWT	84 57	Meas.T. DWT	9 6	Meas.T. DWT 93 63

MADANG	7 Aust Docks Op Coy	4		-	Meas.T. DWT	1,114 350	Meas.T. DWT 1,114 350
	2/31 Aust Docks Op Coy	33 incl. 18 Small Craft	Meas.T.	3,560	Meas.T.	3,560	Meas.T. 10,060
					DWT	2,083	DWT 3,865

PORT	UNIT	No of ships handled incl. Small Craft	Tonnage Loaded		Tonnage Discharged		Total Tonnage	
HOSKINS	2/31 Aust Docks Op Coy	1	Meas.T. DWT	371 286	Meas.T. DWT	140 92	Meas.T. DWT	511 378
NAMTAMBU	2/31 Aust Docks Op Coy (Voyage Only)	1	Nil		Meas.T. DWT	342 317	Meas.T. DWT	342 317
AITAPE	7 Aust Docks Op Coy	28 incl. 13 Small Craft	Meas.T. DWT	20,742 6,183	Meas.T. DWT	20,108 8,652	Meas.T. DWT	40,850 14,835
JACQUINOT BAY	33 Aust Docks Op Coy	17 incl. 9 Small Craft	Meas.T. DWT	77 17	Meas.T. DWT	22,663 10,101	Meas.T. DWT	22,740 10,118
TOROKINA	6 Aust Docks Op Coy	16 incl. 2 Small Craft	Meas.T. DWT	5,585 1,688	Meas.T. DWT	33,489 17,700	Meas.T. DWT	39,074 19,388
TOTAL		165 incl. 77 Small Craft	Meas.T. DWT	46,867 15,693	Meas.T. DWT	90,317 42,206	Meas.T. DWT	137,184 57,899

20 Nov' 44

PORT FACILITIES - PORT OF RAE

Ref Map - 2022 HUON GULF SPECIAL, 4 Miles to 1 inch.

1. CONTROLLING AUTHORITY

U.S. Harbour Control

2. MAXIMUM DRAFT VESSEL TO ENTER PORT

(a) Wharves and Berths - Liberty type

(b) Anchorages - unlimited

3. ANCHORAGES

Vicinity (L)R 6737, off LABU NO.1, LABU NO.2, LABU NO.3

Good anchorage, workable in fine weather by barges etc. Carry of up to $4\frac{1}{2}$ miles maximum. Accommodation for forty vessels.

MILFORD HAVEN Anchorage (L) R 6638, close in shore workable practically allweather. Accommodation for three vessels.

4. TIDE VARIATION

(a) Mean 3 ft

(b) Maximum 4 ft.

5. BERTHING AND MOORING DANGERS

(a) T head jetty and No.2 Dock. Strong set southward makes berthing of single screw vessels difficult.

(b) No particular hazards at other berths.

(c) Unchartered reef vicinity Fuel jetty, for location see Appx "B"

6. WHARVES AND BERTHS

For full detail see Appx "A"

7. HEAVY LIFT EQUIPMENT (U.S. CONTROLLED)

One 30 ton floating crane, mounted on 141' x 44' steel barge.

Three 15 ton tracked full revolving mobile crane.

No static installations.

8. WATER SUPPLY

- (a) SOURCE - BUTIBUM RIVER
- (b) Location and capacity of Storage Tank - Situated at S.W. end of MT. LUNAMAN.
Capacity - 225,000 gals.
- (c) Pump Details - (i) Three CHRYSLER 8 cyl engines and 3" pumps, delivering 350 gals per minute . each at 463 ft head.
(ii) One CHRYSLER 6 cyl engine and 3" pump, delivering 480 gals per minute at 500 ft head.

With four pumps working 50,000 to 60,000 gals per hour delivery can be maintained.

- (d) Location of ships water points

T head jetty	4" main
No.2 Dock	4" main
Hospital jetty	4" main

NB: gravity feed to ships water points from Storage Tank

For reticulation details of Area see Appx "B"

9. ELECTRICITY SUPPLY (240 V A.C.)

- (a) No.1 Power House

- (i) Three BUDA Diesel 30 KW 100 amp direct coupled generating sets.
(ii) One MURPHY Diesel 105 KW 370 amp direct coupled generating set.

- (b) No. 2 POWER HOUSE

- (i) Two BUDA Diesel 30 KW 100 amp direct coupled generating sets.
(ii) Two INTERNATIONAL Semi-Diesel 30 KW 100 amp belt driven generating sets.

For location of Power Houses and lines see Appx "B"

American Dock and Transit Area well lighted, no floodlights used.

- (c) Aust Area MILFORD HAVEN

Two 25 KVA generating sets provide lighting facilities to MILFORD HAVEN Docks and proposed transit Area.

New Aust Wharf now in course of being wired.

No light on Can Dock.

10. BULK FUEL INSTALLATION

(a) Location of Tanks - See Appx "E"

(b) Total capacity

- (i) Petroleum 80 and 100 octane - 1,405,800 gals
- (ii) Diesel Fuel 369,600 gals

11. SLIPWAYS

Limited facilities for small craft only at Water Tpt Area situated at mouth of lagoon at LAEU NO.1 (L)R 6437. No permanent installations.

12. STORAGE SHEDS

No case is known of it being necessary for a ship to leave berth on account of stress of weather, but S.E. swell occasionally prevents working of barges at anchorages.

Prevailing winds, S.E. and N.W. principally S.E.

Report compiled by HQ 3 Aust Docks Op RAE by personal reconnaissance and collation of all data procurable from U.S. and Aust Engineer and Transportation Services.

APPENDICES (4)

- "A" Particulars of Wharves and Berths, Port of LAE
- "B" Dwg. 3 DG-4 Port facilities - MUON GULF
- "C" Dwg. 3 DG-4B Port of LAE - American Area
- "D" Dwg. 3 DG-4A MILFORD HAVEN Docks Area (showing proposed Transit Area)

.....Lt.Col
(S.E. PATTERSON)
C.R.E. 3 AUST DOCKS OP RAE

DISTRIBUTION

DIRECTORATE OF DOCKS, HQ	(2)
COL MOV & TN FIRST AUST ARMY	(1)
CE, FIRST AUST ARMY	(1)
FILE	(1)

HQ 3 AUST DOCKS GP RAE

APPENDIX "A"
(Report - Port of LAE)

PARTICULARS OF WHARVES AND BERTHS PORT OF LAE
NEW GUINEA

16 Nov. '44

NAME OF Wharf	Length & Width (Bthge)	Approach(es) length & Width	Construct-ion	Height above LOWST	Depth water along side	Water facilit-ies	Lighting facilit-ies	Contr. Auth.	State of repair	Remarks
"T" Jetty	100' x 32'	80' x 25'	"T" Head (Mangrove)	6'	25' N. end 20' S. end (Siltng up)	4" main	Yes	U.S. Army	Good	Nos 1 & 2 hatches only - remainder lighterage.
No. 2 Dock	340' x 30'	110' x 22' 120' x 22'	"U" Type Liberty Dock (Oregon)	8'	26' E. end 53' centre 30' W. end	4" main	Yes	U.S. Army	Good	-
Hospital Jetty	416' x 23'	-	Pier (Mangrove)	5' 6"	6 1/2' x 13' E. Side 13 1/2' x 13 1/2' W. Side	4" main	No.	US Army	Good	Used for small craft
"Can" Wharf MILFORD HAVEN	310' x 30'	74' x 22' 146' x 22'	Floating NL - Pontoon Liberty Dock	3' constant	30' Mean	No	No.	US Army	Damaged by bombing but still serviceable	-
Aust Wharf MILFORD HAVEN	360' x 42'	165' x 20' 161' x 20'	"U" Type LIBERTY Dock (Mangrove)	6' 6"	30' - 32'	No	Yes	Aust Army	-	Not yet completed. EDC 30 Nov. '44
Barge Ramp	147' x 27'	-	Mangrove	-	9'	No	No	Aust Army	-	50% complete work held up owing higher priority eng. projects.

APPENDIX "A"
(Report - Port of LAE)

16 Nov. '44

Name of Wharf	Length & Approaches) Width (bthge)	Length & Width	Construct ion	Height above LWOST	Depth water along side	Water facil- ities	Lighting facilities	Constr Auth.	State of repair	Remarks
Malahang	174' x 12'	-	Pier (mangrove Wire mesh Decking)	4'	14' Head 12' Side	No	No	Aust Army	Good	Small Craft only

For location of above structures, see APPX "B"

Good hardstanding beach situated between Aust Wharf and Barge Ramp (See Appx "D") suitable for all types of landing craft, DUWKS etc.

20 DEC. '44

HQ. 3 AUST DOCKS OF RAE

PRELIMINARY REPORT ON PORT FACILITIES - JACQUINOT BAY

BY

MAJOR L.E. CRISPE

PORT ENGINEER, HQ. 3 AUST DOCKS OF RAE

OBJECT :- To determine existing facilities, Port of JACQUINOT BAY, NEW BRITAIN.

Ref. Maps:- DRINA S530 - E.15115/15 1" - Mile
JACQUINOT BAY S530 - E.15130/15 1" - Mile

1. CONTROLLING AUTHORITY

R.A.N.

2. MAXIMUM DRAFT VESSEL TO USE PORT

Vessels of unlimited draft can enter harbour and be accommodated at anchorages.

First Liberty Ship anchored in 38 fathoms, $\frac{1}{2}$ mile off shore.

3. NUMBER OF ANCHORAGES

Locations 1, 2, 3, and 4 will take Liberty type vessels, locations 5, 6, and 7, small ships to 600 tons.
See Appx "A".

Accurate soundings not yet available.

4. AVERAGE RISE AND FALL IN TIDE

Unpredictable from present information. Variations up to 3 ft 6 ins have been observed.

5. BERTHING AND MOORING DANGERS

Reef as shown in Appx "A" visible at high water, not considered a serious hazard.

6. HEAVY LIFT FACILITIES

N I L

7. BEACHES

Barges ex ship's side are routed direct to separate Services dumps at present. (For location see Appx "A")

Sufficient barge accommodation at all beaches to handle turn round from ship.

No Docks Area has been declared to date.

Good hardstanding beaches for vehicles, workable through full tide variations.

8. WATER SUPPLY

No ship watering installations intended.

Adequate local supply at 8 ft watertable.

9. ELECTRICITY SUPPLY

No general lighting scheme yet available.

Plans in hand for Base supply which will be reticulated through Docks Area.

10. BULK FUEL INSTALLATIONS

N I L

11. SLIPWAY

N I L

12. STORAGE SHEDS

N I L

13. HARBOUR

(a) Within limits OBSERVATION POINT (DRINA 030845) and GAFE CUNNINGHAM (JACQUINOT BAY 990821).

(b) Well sheltered harbour. Calm working weather can be expected throughout anchorages.

(c) Berthage accommodation at present:-

(i) Floating pier consisting of two TOBRUK lighters, in poor condition.

(ii) Two small coral jetties suitable for discharging small craft.

(d) Construction of Liberty wharf approved, ETC 15 Feb. '45

Small ships jetty under consideration

14. REMARKS

(a) Weather

Seasons do not affect the Port itself. Heavy rains occur during Jul and Aug (45 ins per month). Average rainfall for remainder of year 12 ins per month.

(b) ROADS

Good roads in Base Area and to RAAF Airstrip and dispersal area.

Anticipated that with roads and drainage maintained in present condition, 30,000 Tons per month intake can be carried in addition to local traffic.

(c) DEVELOPMENT

Base Area development is such that, projected commitments can be handled and that maintenance and movement of Div up the coast will present no great difficulty.

(d) LABOUR

Ample labour available to supplement Docks Coy and to men dumps on 24 hour basis.

Appendix "A" attached



3 AUST DOCKS GP R.A.E.	SCALE 1:10560	DATE 22 DEC 44
PORT FACILITIES	DRAWN 10/1/45	FILE NO TR/8
JACQUINOT BAY	CHECKED 10/1/45	QUOTE ONLY
	PASSED 10/1/45	3DG-13B
	APPROVED	SUPERVISOR'S SIGNATURE

BAY

JACQUINOT

Battery H.E. Manning P.O.

SS Port Craft Co (H-E.S.B. Coy)

Mal Mal

Port Liberty Dock

Small Ships Jetty

3 Min. Craft Docks

3 Min. Craft Docks

3 Min. Craft Docks

3 Min. Craft Docks

3 Min. Craft Docks

3 Min. Craft Docks

3 Min. Craft Docks

3 Min. Craft Docks

3 Min. Craft Docks

3 Min. Craft Docks

3 Min. Craft Docks

3 Min. Craft Docks

3 Min. Craft Docks

3 Min. Craft Docks

3 Min. Craft Docks

3 Min. Craft Docks

3 Min. Craft Docks

3 Min. Craft Docks

3 Min. Craft Docks

3 Min. Craft Docks

3 Min. Craft Docks

3 Min. Craft Docks

3 Min. Craft Docks

3 Min. Craft Docks

3 Min. Craft Docks

3 Min. Craft Docks

3 Min. Craft Docks

3 Min. Craft Docks

3 Min. Craft Docks

3 Min. Craft Docks

3 Min. Craft Docks

3 Min. Craft Docks

3 Min. Craft Docks

3 Min. Craft Docks

3 Min. Craft Docks

3 Min. Craft Docks

3 Min. Craft Docks

3 Min. Craft Docks

3 Min. Craft Docks

3 Min. Craft Docks

3 Min. Craft Docks

3 Min. Craft Docks

3 Min. Craft Docks

3 Min. Craft Docks

3 Min. Craft Docks

3 Min. Craft Docks

3 Min. Craft Docks

3 Min. Craft Docks

Scale of Yards

Scale of Yards

3 AUSTRALIAN DOKS GP. RAE

SCALE APPROX 1"=100'

22 Dec 44

DRAWN

CHECKED

PASSED

APPROVED

Quarry Only

3 DG-13 A

SUPERSEDES 3 DG-6

JACQUINOT BAY-PLAN OF
WATERFRONT & UNIT LOCATIONS

12 Oct '44

REPORT OF TOROKINA

REPORT ON PORT AND FACILITIES FOR HANDLING SUPPLIES.

LOCATION

Map Ref. No. 0465 BOUGAINVILLE ISLAND SOUTH,
4 Mile series.

On the West Coast of BOUGAINVILLE ISLAND, and within
the sheltered area on the East side of CAPE TOROKINA.

Further limited protection from S.E. Monsoons is
provided by TOROKINA and PURUAPA ISLANDS, slightly
North of TOROKINA CAPE.

ACCOMODATION
FOR VESSELS AT
ANCHOR

The accomodation of the protected anchorage to provide
a suitable swinging basin where the discharge of
vessels can be carried out in reasonably smooth
water, is at present limited to three large vessels
of 10,000 Tons each. Additional vessels are thus
forced to anchor in unprotected waters, from 2 to 3
miles from landing Beaches.

The long draw of cargo by L.C.T.s or L.C.M.s, coupled
with the loss of time, through adverse conditions,
mainly rough seas, and torrential rains, cause
unavoidable stoppages, with the result that the
average working time over the period of 24 hours has
been no more than 8 hours.

PILOTAGE

No Pilotage is available in any form, and Ship Masters
are reluctant to bring vessels reasonably close
inshore.

CONTROL OF PORT

Previously under South Pacific Command, but now in
process of passing to South West Pacific Command,
however vessels of former Command are still using the
Port.

PORT SUPT.

Major MORGAN of A.T.S. is posted as Port Superintendent
and controls and allocates all Landing Craft used in
the discharge of vessels.

PRIORITIES OF
VESSELS.

To date there does not appear to be any set policy
or method laid down for the declaration of priorities
of vessels to be worked - South Pacific Command,
South West Pacific Command, and 14 Corp USA. each
exercise some control, with the result that a certain
amount of confusion exists.

DOCKS AREA

Is limited to the area of CAPE TOROKINA approx.
800 yds x 800 yds.

Is enclosed by high steel mesh fence. Control posts
are sited at both IN and OUT Roads.

Admin Building for Port Supt., Oil Storage Tank, and
Gear Sheds are within the area.

LANDING BEACHES. Divided into 4 Areas known as Nos. 1, 2, 3, and 4
beaches.

Heavy surf and steeply shelving black sand beaches,
make Nos. 1, 2, and 3 beaches quite unsuitable for
use by Landing Craft, during S.E. Monsoons.

North End of No. 4 beach abuts No.1 N.Z. Air Force
Fighter Strip, and is declared a prohibited area.

No.4 Beach is used by all Landing Craft, and is
situated within the Dock Area. The composition of
No.4 beach is apparently Crushed Coral, Pumice, and
Black Sand. Is very firm and carries heavy loads
with no apparent sign of cutting up or becoming
boggy. Estimated capacity of this beach at the one
time, considered to be 6 L.C.Ts and 10 L.C.Ms.

PONTOON JETTY

A Pontoon Jetty 125 ft x 45 ft is positioned at the
North End of No. 4 beach, is capable of taking a
vessel of 200 tons on either side.

Three L.C.Ts usually beach on either side of this
Jetty, and Mooring Bollards to secure same have been
driven at waters edge.

HEAVY LIFT
EQUIPMENT

No heavy lift equipment other than ships gear is
available at this port.

MOBILE CRANES

Six Mobile Cranes of the Quickway Track Type,
capacity 5 tons, also 4 wheel type, 5 Tons capacity
(make unknown)

These cranes are available at all times for both
beach and Barge work, the mobility of the Quickway
Type allows them to move on board L.C.Ts and expedite
the work of discharge.

BEACH LIGHTING. Three pairs of powerful floodlights on three separate
20 ft high stagings, give ample light for beach
operations.

Power is generated locally.

Labour
SHIP TASKS

U.S.A. have one stevedore Coy of Fijians which is used
entirely for ship board tasks, strength 300.

Also two Port Coys, each of 150 O/rs which are used
for beach and barge work

Aust. Army - 1 Docks Op Coy RAE "C" Type
Strength 7 Offrs and 287 O/Rs.

Aust. Army units are supplying labour for beach and
barge work for Aust. Army cargoes only.

METHOD.

Shift work is practiced 6 hours on, 12 hours off. Work commences 0600 hrs, finishes 2400 hrs - 18 hours per day for U.S.A.

Aust Army 6 hours on, 12 hours off, around the clock when barges are available.

LANDING CRAFT.

U.S. Army has available 21 L.C.Ts. 30 L.C.Ms, and an unknown number of D.W.Ks used to shuttle cargo from ship to shore.

M.T.

Ample U.S.A. Transport is available for transfer of supplies from beachhead to dump.

TOROKINA ISLAND.

Situated approx. 400 yds NORTH of CAPE TOROKINA, is low lying, of Coral and Pumice formation, and has an area approx 400 yds long by 300 yds wide.

Occupied at present by U.S. Navy, and used on the EAST side, as a harbour for L.C.Ms.

A fairly deep channel separates this island from CAPE TOROKINA.

PURUAPA ISLAND

Approx. length 1800 yds, width 800 yds.

Lies immediately NORTH of TOROKINA ISLAND, a narrow shallow channel separating same.

Occupied by U.S. Navy and used on the EAST side as a harbour for L.C.Ts, L.C.Ms, and all small Harbour craft.

Camp accomodation ashore is provided for the admin Staff and Crews, operating all Landing Craft in the Port. U.S. Navy supply all crews.

(owing to the difficulties prevailing at the time, no launch was avail able to make a thorough inspection of the Islands)

REFRIGERATION.

U.S. Army has a refrigeration capacity of 60 Tons, (not within the Docks area)

ROADS

All roads throughout the Beachhead area are built from the material found in the vicinity of same.

The material is of a Pumice substance, easily graded into formation; sets well and provides a good hard road, capable of carrying heavy loads.

Owing to the extremely heavy rainfall to which the area is subject, all roads are subject to a great deal of erosion, and require daily maintenance, as many as 8 Power Graders, (4 on each side of the road) were observed to be operating at the one time.

Deep water courses flank all roads, these are also subject to erosion and alteration of course, according to amount of flood waters to be carried. Bridges and crossings over these water courses, appear to be of a temporary nature, and are constantly subsiding.

WATER

The water table has an average depth of 4 ft through the beachhead area.

Ample domestic supplies are available by sinking - but water needs treating before use.

The foregoing information was obtained mainly by observation, and interviews with responsible Officers of the U.S.A. who have had periods of service up to nine months in the area.

Further and more detailed information will be compiled, based on the experience and knowledge gained from active operational duties in the Port.

APPENDIX "A" Sketch plan of Dock Area and Installation.

Lt.Col

.....
(S.L. PATTERSON)
C.R.E. 3 AUST DOCKS GP RAE.

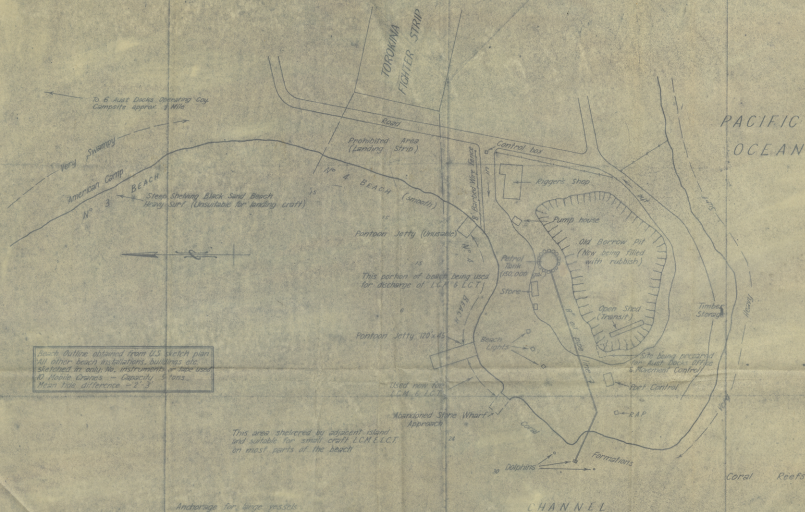

3 AUST DOCKS GP	SCALE 1:100,000	DATE 6 OCT 44
R.A.E.	DRAWN C.G.D.	FILE N° 78/2
TOROKINA DOCKS AREA	TRACED W.A.B.	QUOTE ONLY
PLAN OF EXISTING INSTALLATIONS	CHECKED	
ON BEACH No. 4	PASSED	3DG-1
	APPROVED	

WAR DIARY or INTELLIGENCE SUMMARY.

(Erase heading not required.)

Army Form G.2118.

(Adapted)

Unit HQ 3 AUST DOCKS GROUP ~~Regt~~ Date and Time.—From _____ To _____

Place.	Date.	Hour.	Summary of Events and Information.	Remarks and references to Appendices, Diaries, &c.
NEW GUINEA.	1 Feb 45		Director of Docks advised work Boat AM1831 urgently required TOROKINA.	
			First Aust Army request LANDOPS for movement 41 Aust Docks Op Coy	
			from mainland less Mechanical Equipment	
	4 Feb 45		2 Offrs 36 ORs 2/31 Aust Docks Op Coy embarked SS "MAIWARA"	
			ex MADNAG for AITAPE.	
	6 Feb 45		WXL6289 Capt. V.T. EDWARDS enplaned ex LAE for mainland	
			Philippine Lighter Tow AB1280 AB1282 left SYDNEY	
	7 Feb 45		Director of Docks advises 12 cases DDS Stores shipped per	
			"GEORGE M. EMBIRICOS" to 7 Aust Docks Op Coy	
	8 Feb 45		Director of Docks advised insufficient spare parts available	
			HD7 Cranes.	
	9 Feb 45		Coys notified reallocation of work boats AM 1603 - 6 Aust Docks Op Coy	
			AM 1831 - 7 Aust Docks Op Coy	
	10 Feb 45		32 Aust Docks Op Coy advised to transfer two SB Barges to ANGAU	
			Authority First Aust Army QM 1137	

WAR DIARY or INTELLIGENCE SUMMARY.

(Erase heading not required.)

Army Form C.2118.
(Adap ed.)

Unit HQ 3 AUST DOCKS GROUP RA Date and Time.—From _____ To _____

Place.	Date.	Hour.	Summary of Events and Information.	Remarks and references to Appendices, Diaries, &c.
NEW GUINEA.	9 Feb 45		2 HD7 Cranes consigned to 33 Aust Docks Op Coy ex SYDNEY	
	10 Feb 45		Director of Docks advises 8 Aust Docks Op Coy available embarkation at end of March.	
	12 Feb 45		Application made to First Aust Army for addition Port Supt staff - AITAPE	
	16 Feb 45		VX31583 Major E.B. THURMAN enplanes ex LAE for mainland.	
	17 Feb 45		Philippine Lighter tow departed TOWNSVILLE	
	24 Feb 45		Capt SALTHOUSE 2/31 Aust Docks Op Coy enplanes AITAPE for LAE	
	25 Feb 45		Lighters AB.1280 - 1292 arrived in tow at LAE in good condition	
	27 Feb 45		6 Aust Docks Op Coy advised work boat AM 1831 and 1 Peters Crane No WCB1481 consigned 6 Aust Docks Op Coy ex SYDNEY 23.2.45	
	28 Feb 45		Approved granted vide First Aust Army A 13981 of 26.2.45 for additional Docks Supt Staff - TCROKINA.	

SECRET

HQ 3 Aust Docks Gp, RAE (AIF)
NEW GUINEA

10 MAR. '45

MONTHLY REPORT - FEBURARY 1945

Part 1. - ADMINISTRATION

(a) Disposition of Staff

PORT	UNIT	Type	OFFRS	ORs
LAE	HQ 3 Aust Docks Gp	Group HQ.	6	21
	2/2 Aust Docks Op Coy	Type "C"	7	265
	2/31 Aust Docks Op Coy	Type "D"	1	21
	6 Pl 1 Aust Port Maint Coy	Pl	1	38
PORT MORESBY	32 Aust Docks Op Coy	Type "D"	4	90
FINSCHHAFEN	Det 2/2 Aust Docks Op Coy	Type "C"	-	4
MADANG	2/31 Aust Docks Op Coy	Type "D"	1	51
AITAPE	7 Aust Docks Op Coy	Type "C"	7	319
	2/31 Aust Docks Op Coy	Type "D"	2	33
	5 Pl 1 Aust Port Maint Coy	Pl	-	29
JACQUINOT BAY	33 Aust Docks Op Coy	Type "D"	4	107
	4 Pl 1 Aust Port Maint Coy	Pl	-	23
TOROKINA	6 Aust Docks Op Coy	Type "C"	7	285
	3 Pl 1 Aust Docks Op Coy	Pl	1	32

(b) General Remarks

N41

S E C R E T

HQ 3 Aust Docks Gp RAE (AIF)

MONTHLY REPORT - FEBRUARY 1945Part 11. - OPERATIONS(a) Summary of Tonnages Handled

PORT	UNIT	No of ships handled incl. Small Craft	Tonnage Loaded	Tonnage Dis- charged	Total Tonnage
LAE	2/2 Aust Docks Op Coy	17 incl. 10 Small Craft	Meas.T. 6,055	Meas.T. 21,944	Meas.T. 27,999
			DWT 3,828	DWT 10,339	DWT 14,167
		(No of Vehs 457	Meas.T. 7,304)		
	2/31 Aust Docks Op Coy	NIL	-	-	-
PORT MORESBY	32 Aust Docks Op Coy		Meas.T. 12,254	Meas.T. 3,774	Meas.T. 16,028
			DWT 3,600	DWT 1,044	DWT 4,644
		(No of Vehs 204	Meas.T. 4,695)		
PINSCHHAPEN	Det 2/2 Aust Docks Op Coy	11 incl. 8 Small Craft	Meas.T. 375	Meas.T. 74	Meas.T. 449
			DWT 263	DWT 27	DWT 290
		(No of Vehs 2	Meas.T. 5)		
MADANG	2/31 Aust Docks Op Coy	14 incl. 7 Small Craft	Meas.T. 3,603	Meas.T. 2,373	Meas.T. 5,976
			DWT 1,542	DWT 1,882	DWT 3,124
		(No of Vehs 1	Meas.T. 5)		
HOSKINS	Det 2/31 Aust Docks Op Coy	1	Meas.T. 57	Meas.T. 248	Meas.T. 305
			DWT 43	DWT 191	DWT 234
NANTAMBU	Det 2/31 Aust Docks Op Coy	1	-	Meas.T. 633	Meas.T. 633
				DWT 432	DWT 432

PORT	UNIT	No of ships handled incl. Small Craft	Tonnage loaded	Tonnage Dis- charged	Total Tonnage
CAPE GLOUCESTER	Det 2/31 Aust Docks Op Coy	1	Meas.T. 35 DWT 32	Meas.T. - DWT -	Meas.T. 35 DWT 32
AITAPE	7 Aust Docks Op Coy	32 incl. 6 Small Craft	Meas.T. 14,416 DWT 5,604 (No of Vehs 530	Meas.T. 13,333 DWT 8,110 Meas.T. 11,136)	Meas.T. 27,749 DWT 13,714
JACQUINOT BAY	33 Aust Docks Op Coy	13 incl. 8 Small Craft	Meas.T. 1,775 DWT 276 (No of Vehs 228	Meas.T. 12,209 DWT 6,530 Meas.T. 2,709)	Meas.T. 13,984 DWT 6,806
TOROKINA	6 Aust Docks Op Coy	15 incl. 3 Small Craft	Meas.T. 9,144 DWT 3,502 (No of Vehs 440	Meas.T. 20,116 DWT 8,862 Meas.T. 10,681)	Meas.T. 29,260 DWT 12,364
TOTALS		97 incl. 39 Small Craft	Meas.T. 47,714 DWT 19,690 (No of Vehs 1,862	Meas.T. 74,704 DWT 37,117 Meas.T. 36,535)	Meas.T. 122,418 DWT 55,807

WAR DIARY or INTELLIGENCE SUMMARY.

(Erase heading not required.)

Army Form C.2118.

(Adap 6-1)

Unit HQ 3 AUST DOCKS GROUP RA Date and Time. — From _____ To _____

Place.	Date.	Hour.	Summary of Events and Information.	Remarks and references to Appendices, Diaries, &c.
NEW GUINEA.	2 Mar 45		Docks Supt. AITAPE instructed to move det 2/31 Aust Docks Op Coy for concentration at MADANG.	
	12 Mar 45		Report on Port Facilities MADANG, submitted to Director of Docks, CE, First Aust Army - Col (Mov & Tn) First Aust Army see Appendix A	
	14 Mar 45		Movt Control - FINSCHHAFEN advised to move det 2/2 Aust Docks Op Coy to LAE ex FINSCHHAFEN.	
	15 Mar 45		4 Aust Docks Op Coy - 7 Offrs 256 ORs arrived LAE - also 9 Pl 1 Aust Port Maint Coy - 1 Offr 38 ORs	
	19 Mar 45		2/31 Aust Docks Op Coy instructed to move det 1 Sgt 2 ORs from MADANG to FINSCHHAFEN.	
	20 Mar '45		2/2 Aust Docks Op Coy and 6 Pl 1 Aust Port Maint Coy embarked LAE for mainland.	
	22 Mar 45		Concurrence given Docks Supt. AITAPE for dismantling 2 HD7 Cranes for use as Tractors.	

WAR DIARY or INTELLIGENCE SUMMARY.

(Erase heading not required.)

Army Form C.2118.

(Adapted.)

Unit HQ 3 AUST DOCKS GROUP RAE Date and Time.—From _____ To _____

Place.	Date.	Hour.	Summary of Events and Information.	Remarks and references to Appendices, Diaries, &c.
NEW GUINEA.	22 Mar 45		SX24948 Capt. L.H. THRING 7 Aust Docks Op Coy recommended for Mention In Despatches.	
	23 Mar 45		Philippine Lighter Tow departed LAE - JACQUINOT BAY - per SS "WAYANNA" Major L.E. CRISPE in charge of tow.	
	27 Mar 45		NXL36360 Major R.C. NEVILLE 4 Aust Docks Op Coy placed on RSL AMF List No 82 with draws the above notification.	
	28 Mar 45		Philippine Lighter Tow arrived JACQUINOT BAY - Pick-a-back Lighter launched successfully.	
	29 Mar 45		12 Barges on charge 32 Aust Docks Op Coy transferred to 10 AOD	

6 APRIL '45

MONTHLY REPORT - MARCH 1945Part 1. - ADMINISTRATION(a) Disposition of Staff

PORT	UNIT	TYPE	OFFRS	ORs
LAE	HQ 3 Aust Docks Gp	Group HQ.	6	21
	4 Aust Docks Op Coy	Type "C"	7	286
	2/31 Aust Docks Op Coy	Type "D"	1	21
	9 Pl 1 Aust Port Maint Coy	Pl	1	32
PORT MORESBY	32 Aust Docks Op Coy	Type "D"	4	90
FINSCHHAFEN	Det 2/31 Aust Docks Op Coy	Type "D"	-	3
MADANG	2/31 Aust Docks Op Coy	Type "D"	3	84
AITAPE	7 Aust Docks Op Coy	Type "C"	7	319
	5 Pl 1 Aust Port Maint Coy	Pl	-	28
JACQUINOT BAY	33 Aust Docks Op Coy	Type "D"	4	112
	4 Pl 1 Aust Port Maint Coy	Pl	-	23
TOROKINA	6 Aust Docks Op Coy	Type "C"	7	286
	3 Pl 1 Aust Port Maint Coy	Pl	1	33

(b) General Remarks

Nil.

S E C R E T

HQ 3 Aust Docks Gp. RAE (AIF)

MONTHLY REPORT - MARCH 1945

Part 11. - OPERATIONS

(a) Summary of Tonnages Handled

Port	Unit	No of ships handled incl. Small Craft	Tonnage Loaded	Tonnage Dis- charged	Total Tonnage
=====					
LAE	4 Aust Docks Op Coy	15 incl. 7 Small Craft (No of Vehs 434)	Meas.T. 11,436	Meas.T. 8,713	Meas.T. 20,149
			DWT 4,709	DWT 3,304	DWT 8,013
			Meas.T. 8,428		
	2/2 Aust Docks Op Coy	16 incl. 6 Small Craft (No of Vehs 232)	Meas.T. 2,636	Meas.T. 16,567	Meas.T. 19,203
			DWT 1,360	DWT 6,406	DWT 7,766
Meas.T. 5,430					
2/31 Aust Docks Op Coy	NIL	-	-	-	

PORT MORESBY	32 Aust Docks Op Coy	6 (No of Vehs 150)	Meas.T. 4,964	Meas.T. 3,817	Meas.T. 8,781
			DWT 1,654	DWT 1,239	DWT 2,893
			Meas.T. 3,187		

FINSCHHAFEN	Det 2/2 Aust Docks Op Coy	3 Small Craft	Meas.T. 73	Meas.T. -	Meas.T. 73
			DWT 58	DWT -	DWT 58
	Det 2/31 Aust Docks Op Coy	4 incl. 2 Small Craft (No of Vehs 1)	Meas.T. 206	Meas.T. 18	Meas.T. 224
			DWT 83	DWT 10	DWT 93
			Meas.T. 7		

MADANG	2/31 Aust Docks Op Coy	8 (No of Vehs 218)	Meas.T. 7,023	Meas.T. 1,181	Meas.T. 8,204
			DWT 1,310	DWT 767	DWT 2,077
			Meas.T. 4,679		

Port	Unit	No of ships handled incl. Small Craft	Tonnage Loaded	Tonnage Dis- charged	Total Tonnage
=====					
AITAPE	7 Aust Docks Op Coy	19 incl. 6 Small Craft	Meas.T. 3,693 DWT 3,087	Meas.T. 10,978 DWT 7,400	Meas.T. 14,671 DWT 10,487
		(No of Vehs 50	Meas.T. 955)		

JACQUINOT BAY	33 Aust Docks Op Coy	10 incl 3 Small Craft	Meas.T. 230 DWT 84	Meas.T. 25,869 DWT 12,313	Meas.T. 26,099 DWT 12,397
		(No of Vehs 590	Meas.T. 8,719)		

TOROKINA	6 Aust Docks Op Coy	27 incl 4 Small Craft	Meas.T. 14,705 DWT 5,266	Meas.T. 26,819 DWT 14,618	Meas.T. 41,524 DWT 19,884
		(No of Vehs 590	Meas.T. 11,894)		

TOTALS		105 incl 31 Small Craft	Meas.T. 44,966 DWT 17,611	Meas.T. 93,962 DWT 46,057	Meas.T. 138,928 DWT 63,668
		(No of Vehs 2,265	Meas.T. 43,299)		

REPORT ON PORT FACILITIES - MADANG

BY

MAJOR L.B. CRISPE - PORT ENGINEER

HQ 3 AUST DOCKS GP, RAE

12 Mar.'45

Ref. Map : US ARMY SHEET, MADANG EAST S500 - E14545/15
Chart : AUS F033 of 1944 (RAN) 1" = 1 Mile.

1. CONTROLLING AUTHORITY

Royal Australian Navy

2. GENERAL

(a) Approaches

MADANG HARBOUR is approached via DALLMAN PASSAGE of between one and two cables width, and depth upwards of 24 fathoms in channel.

Good harbour for deepsea vessels, small ships, small craft etc.

NO dredging necessary to maintain depths.

3. TIDES & CURRENTS

Tidal streams scarcely perceptible, usually one tide every 24 hours, with variation of 3-ft. Flood tide sets to SW, ebb tide to NE. Tides affected by prevailing winds.

4. WEATHER

Prevailing winds NW, Sep to May, SE May to Sep.

Lighterage from anchorage can be maintained in all weather.

Wharves and jetties in sheltered locations.

5. ANCHORAGES (Refer Appx "A")

(a) Situated between BELIAU and KRANKET Islands, two all weather anchorages suitable for vessels of "Liberty" class. Minimum depth 11 fathoms, 900-ft swinging space.

(b) Further accommodation for 24 vessels at TAB anchorage (Refer RAN Chart F033)

6. DESCRIPTION OF HARBOUR

- (a) For general depths see Appx "A"
- (b) Docks Area situated in town of MADANG, Map ref 735246.
- (c) Naval workshop (HMAS "WHANG PU") situated in BINNEN HARBOUR, Map ref 736240.
- (d) Discharge normally to wharves, but lighterage can be carried out from anchorages. Average distance 1400-yds.
- (e) Docks Area - (Refer Appx "B").

Berths Nos 1, 2, and 3, totally enclosed by security fence.

Combined Docks and Movement Control Offices, situated on boundary of Docks Area near No 3 berth.

7. WHARFAGE AND CRANAGE

- (a) Wharfage - For detail see Appx "C".
- (b) Cranage
 - (i) No fixed installations
 - (ii) No mobile cranes at present in Area.
- (c) Lighting
 - Wharf, Docks Area, and Movement Control Office, supplied by 5 KVA set.
 - Town supply by 25 KVA set with emergency hook-up to Docks Area.
- (d) Water Supply
 - Storage capacity 110,000 galls - 3" main to No 2 Dock.
- (e) Bulk Fuel Supply - NIL.

8. ACCOMMODATION

- (a) Anchorage (refer Appx "A")
- (b) Berths :
 - No 1 Dock 300-ton small ships.
 - No 2 Dock "Liberty" type ships
 - No 3 Dock Small craft
 - No 4 Dock Smallcraft with ramp for vessels of "PEATE" class.
- (c) Hardstanding beach for landing craft, situated SOUTH of No 3 Dock.
- (d) Ships can be worked direct to MT at all berths.

10. LANDING OF PERSONNEL, STORES, AND EQUIPMENT BY WATER TPT

10. LANDING OF PERSONNEL, STORES, AND EQUIPMENT BY WATER TPT
Good hardstanding beach, length 50-ft, situated SOUTH of
No 3 Dock.

- (a) Naval Storage Shed, timber and iron construction, 105-ft x 58-ft, 1500 tons capacity (M).
- (b) NGPCB Storage Shed, 100-ft x 40-ft native construction. Capacity 600 tons (M) (To be replaced by Sydney Williams hut).

12. COAL, OIL AND WATER

- (a) Coal - Small storage in hulk for RAN purposes only.
(b) Oil - Nil.
(c) Water - See para 7(d)

(Sgd) L E Crispe
.....MAJOR.
(L.E. CRISPE)
PORT ENG. 3 AUST DOCKS GP RAE.

DESCRIPTION OF WHARFAGE - M A D A N G

HQ 3 AUST DOCKS GROUP RAE

Appendix "C" to Report on Port Facilities - MADANG

Structure	Type	Length		Width		Depth LNOST	Height above LNOST	Construction Details	Light- ing	Remarks
		Bthge	Appch	Wharf	Appch					
No 1 DOCK (Small ships jetty/or ships to 300-tons)	T Head	130'	60'	30'	30'	22'6"	6'6"	Douglas Fir pile construction One set triple pile spring SOUTH end. Twin pile springs at 30ft centres. Dolphins in line with end and continued from wharf. Cantilever platform for Small Craft at SOUTH end.	Docks Supply (Elec)	Constructed by 2/4 Fd Sqn RAE, completed Aug 44. Load classification at present Class 4
No 2 DOCK	Wharf	330'	-	40'	-	32'	12'	Douglas Fir pile construction at 10-ft centre, mostly driven to refusal. Min bearing 9-tons per pile. Two sets triple spring piles, one each end of dock. Four sets twin piles at 80-ft centres.	Docks Supply	Constructed by 2/4 Fd Sqn RAE, completed July 44. Now undergoing repair chiefly superstruct- ure and decking. Load classification at present Class 4.
No 3 DOCK (Small Craft Wharf)	T Head	45'	20'	20'	15'- 25'	13'6"	6'	Pile structure	-	Load classification at present Class 3.
No 4 DOCK	Wharf	40'	-	16'	-	11'6"	3'6"	Pile structure with ramp for vessels of "PEATE" class.	-	Load classification at present Class 4.

NOTE :- No facilities other than above for discharging lighters

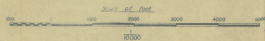

Copied from naval chart of coast from Madang to Alotau
Surveyed by "H.M.A.S. Moresby", 1942.

3 AUST. DOCKS GP.		SCALE: 633 to 1 nautical mile	DATE: 17-4-1945
R.A.E.		DRAWN: H.A.B.	FILE NO.
HARBOUR		TRACED: H.A.B.	QUOTE ONLY
MADANG		CHECKED: H.A.B.	3DG-24
		APPROVED:	

APPENDIX B.



NOTE:-

Soundings in feet.

Berths 1,2 & 3 require redecking - When redecked Berth 1 will be Class 10, Berth 2 Class 10, Berth 3, Class 5. - Redecking to commence when timber is available.

From a compass survey by W.B. Baxter.

3 AUST. DOCKS GP.		SCALE 100' TO 1"	DATE 16.4.1945
R.A.E.		DRAWN W.B.	FILE N°
DOCKS AREA		TRACED W.B.	QUOTE ONLY
MADANG		CHECKED <i>[Signature]</i>	3DG-23
		PASSED <i>[Signature]</i>	
		APPROVED <i>[Signature]</i>	

WAR DIARY or INTELLIGENCE SUMMARY.

(Erase heading not required.)

Army Form C.2118.

(Adap. -)

Unit HQ 3 AUST DOCKS GROUP RAE Date and Time. — From _____ To _____

Place.	Date.	Hour.	Summary of Events and Information.	Remarks and references to Appendices, Diaries, &c.
NEW GUINEA.	2 Apr 45		NX132548 Lt. R.J. BURNHAM, reposted to 33 Aust Docks Op Coy ex 7 Aust Docks Op Coy	Authority:- First Aust Army AMS 3297
	2 Apr 45		QX7001 Lt. C.E. BARRELL, reposted to 7 Aust Docks Op Coy ex 33 Aust Docks Op Coy	of 5.4.45
	2 Apr 45		23 ORs, 7 Aust Docks Op Coy transferred to 4 Aust Docks Op Coy embarked AITAPE for LAE	
	6 Apr 45		VX10166 Major R.C. BALLANTYNE, reposted to HQ 1 Aust Docks Gp to date 2. 4. 45	
	12 Apr 45		NX132548 Lt. R.J. BURNHAM, enplaned AITAPE for JACQUINOT BAY	
	16 Apr 45		QX8734 Lt. G.H. PYNE posted 4 Pl 1 Aust Port Maint Coy	
	18 Apr 45		Barges AB 194 and AB 196 transferred from 7 Aust Docks Op Coy to ANGAU.	
	20 Apr 45		41 Aust Docks Op Coy disembarked MORESBY ex mainland - 2 Offrs 38 ORs.	

WAR DIARY or INTELLIGENCE SUMMARY.

(Erase heading not required.)

Army Form C.2118.

(Adap. )Unit HQ 3 AUST DOCKS GROUP RAB Date and Time.—From _____ To _____[illegible]

28 Apr.'45

REPORT ON PORT FACILITIES - B U T

Ref. Map : US ARMY SHEET S315 - E14300/15
Scale 1 : 63,600

Chart : AUST NAVAL CHART 056

1. CONTROLLING AUTHORITY.

Port : Royal Aust Navy.

Beach head : Forward Movement Control, 6 Div.

2. GENERAL.

(a) Approaches :-

The approaches are navigable by vessels of all drafts, to within a cable and a half of the beach. There is shelter from NW Monsoonal storms for large vessels, but Small Craft and Small Ships would be slightly sheltered in the lee of the beach from the entrance to BUT CREEK, NNW of the landing beach.

NO dredging is necessary.

3. TIDES & CURRENTS.

Tidal data for this area is meagre and not very reliable as Navy has not carried out an extensive survey. An analysis by Naval Authority gives a maximum range of 3-ft approximately, with one high and one low tide daily, and a normal tide variation of 2-ft.

The current evidently conforms to usual $1\frac{1}{2}$ knots, and sets to the NW in these localities for the greater part of the year.

4. WEATHER.

Prevailing winds NW, Sep to May, SE May to Sep.

Landing Craft could operate, it is thought, in any weather, as the beach is slightly sheltered by the general direction of the beach to the NNW.

5. ANCHORAGES (Refer Appendix "A")

Anchorage for all types of vessels exist within two cables length of the beach, but only for fair weather.

6. DESCRIPTION OF HARBOUR.

- (a) For general depths, see Appendix "A".
- (b) Landing beach at Map ref. 877262, is suitable for the operation of all types of ALCs.
- (c) Lighterage can be carried out from anchorages.
- (d) Docks Area (Refer Appendix "B").

Stores are transported on off loading direct to the DID Area adjacent to the landing beach.

This Area will be totally enclosed by an eight foot security fence, construction of which is in progress. Engineer supplies are transported to a dump 250 yds from the beach. (Refer Appendix "B").

Forward Movement Control Office is situated 200 yds WEST of the landing beach area.

7. WHARFAGE AND CRANAGE.

- (a) Wharfage
 - No wharves, piers or jetties exist, but the Japanese had constructed a pier which is now useless.
 - It would be possible to build a pier for operation of Small Craft.
- (b) Cranage
 - (i) No fixed installation.
 - (ii) No mobile cranes at present in area.
 - It is necessary here, as in AITAPE, to use tractors for holding the LCTs and LCMs in to the beach. For this purpose Div HQ has given Forward Movement Control, first priority on tractors in area.
 - The tractor requirements are, 2 DSs per LCT or 1 DS and 2 TD9s per LCT. In very calm weather 2 TD9s are all that is necessary.
 - Three LCTs are handled to-gether with a normal off loading time of four to five hours each.
- (c) Lighting
 - Beach Area and DID lighting is supplied by a 5 KVA set, adjacent to beach.
 - This cannot be regarded as a permanent fixture as it is subject to the demands of the workshop.
- (d) Water Supply
 - No facilities exist, LCTs are supplies from Army water trucks if necessary.
- (e) Bulk Fuel Supply
 - NIL.

8. ACCOMMODATION.

- (a) Anchorage (Refer Appendix "A").
- (b) No berths exist.
- (c) The beach is ideally suited for all operations with LCTs and ALCMs, although the vehicles have a tendency to bog in the sand - this is overcome with the laying of arc mesh.
- (d) All Craft other than landing Craft could only be worked by lighterage. The foreshores are not suitable for the operation of lighters.

9. HARBOUR CRAFT (AUST)

NO Craft based in area.

10. LANDING OF PERSONNEL, STORES, AND EQUIPMENT BY WATER TPT.

Refer para 8(c).

11. WAREHOUSES, STACKING SPACE AND TRANSIT AREAS.

The only sheds are those within the DID Area, which consist of timber uprights supporting Sisal or Sac Sac roofs. They are of a very temporary nature.

NO Docks Transit Shed exists.

12. COAL, OIL AND WATER.

- (a) Coal - No facilities.
(b) Oil - Nil.
(c) Water - See para 7(d)

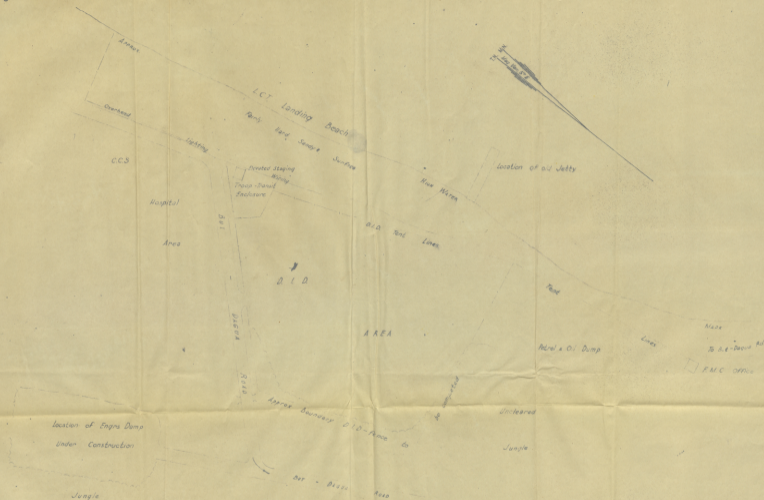

3 AUST DOCKS GP R.A.E.		SCALE 500 FT	DATE 1-5-45
DRAWN	FILED	FILE NO TA 12	
TRACED	DATE	QUOTE ONLY	
CHANGED	FILED	3DG 26 B	
BUT - BARGE LANDING DOCK FROM COMPASS TRAVELER 14-45 BY WD BERTON 3 DOCKS GROUP		APPROVED	DATE

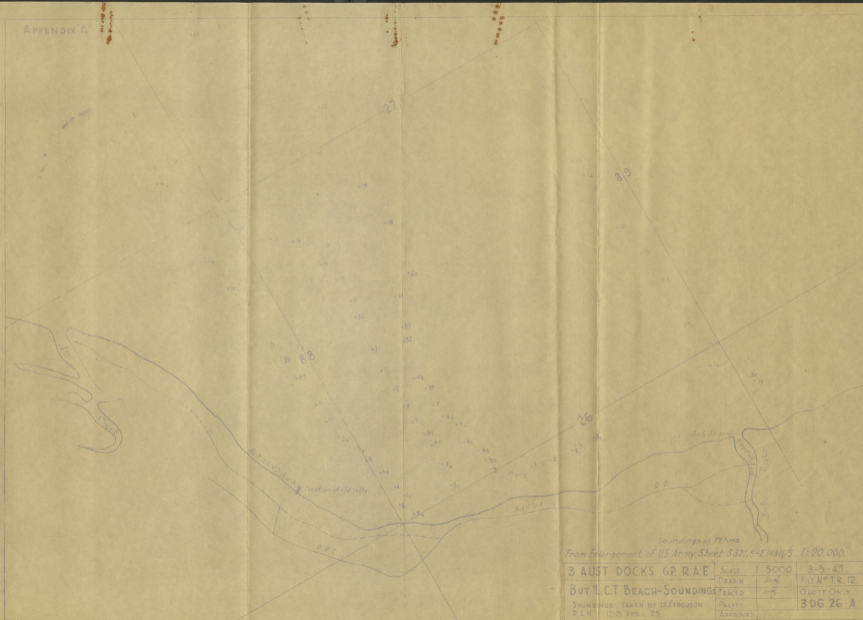

WAR DIARY or INTELLIGENCE SUMMARY.

(Erase heading not required.)

Army Form C.2118.
(Adap ed.)

Unit HQ 3 AUST DOCKS GROUP RAB Date and Time.—From _____ To _____

Place.	Date.	Hour.	Summary of Events and Information.	Remarks and references to Appendices, Diaries, &c.
NEW GUINEA.	1 May 45		SX20830 Major L.E. CRISPE enplaned LAE for BRISBANE	
	3 May 45		Det 2/31 Aust Docks Op Coy - 1 Offr 20 ORs embarked SS "SUVA" for MADANG ex LAE.	
	5 May 45		Warning Order to 2/31 Aust Docks Op Coy to embark SS "DORIS" for WEWAK.	
	6 May 45		Salvage operations of LCM JACQUINOT BAY completed.	
	11 May 45		Report on Port Facilities - AITAPE - submitted to higher formation - See appendix A	
	12 May 45		Report on Port Facilities - BUT - submitted to higher formation - see appendix B	
	12 May 45		Warning Order issued to 7 Aust Docks Op Coy for movement - no movement prior to 8.6.45	
	12 May 45		Det. 2/31 Aust Docks Op Coy FINSCHHAFEN moved to MADANG.	
			Det. 4 Aust Docks Op Coy 3 ORs moved LAE to FINSCHHAFEN	

WAR DIARY or INTELLIGENCE SUMMARY.

(Erase heading not required.)

Army Form C.2118.
(Adap ed.)

Unit HQ 3 AUST DOCKS GROUP RAE Date and Time.—From _____ To _____

Place.	Date.	Hour.	Summary of Events and Information.	Remarks and references to Appendices, Diaries, &c.
NEW GUINEA.	12 May 45		2/31 Aust Docks Op Coy Warning Order issued, move from MADANG to WEWAK.	
	19 May 45		Recommendation submitted First Aust Army for change of location of 5 Pl 1 Aust Port Maint Coy from AITAPE to WEWAK.	
	19 May 45		8 Aust Docks Op Coy embarked SYDNEY.	
	22 May 45		NGX102 Capt. D. O'FARRELL, OC, 41 Aust Docks Op Coy granted powers of CO in respect 41 Aust Docks Op Coy	Lae Base A16/12/2632 refers
	22 May 45		QX8794 Lt. G.H. PYNE, reposted to 5 Pl 1 Aust Port Maint Coy	
	25 May 45		WX16289 Capt V.T. EDWARDS emplaned LAE for TORCKINA and JACQUINOT BAY	
	28 May 45		8 Aust Docks Op Coy under command Major PURDUE arrived FINSCHHAFEN per SS "TARCONA" - staging.	
	29 May '45		2/31 Aust Docks Op Coy arrived WEWAK.	

WAR DIARY or INTELLIGENCE SUMMARY.

(Erase heading not required.)

Army Form C.2118.

(Adapted.)

Unit HQ 3 AUST DOCKS GROUP RAE Date and Time.—From _____ To _____[illegible]

7 APRIL '45.

MONTHLY REPORT - APRIL 1945Part 1. - ADMINISTRATION(a) Disposition of Staff

PORT	UNIT	TYPE	OFFRS	ORs
LAE	HQ 3 Aust Docks Gp	Group HQ.	6	22
	4 Aust Docks Op Coy	Type "C"	7	272
	9 Pl 1 Aust Port Maint Coy	Pl	1	36
PORT MORESBY	41 Aust Docks Op Coy	Type "E"	2	40
MADANG	2/31 Aust Docks Op Coy	Type "D"	4	101
AITAPE	7 Aust Docks Op Coy	Type "C"	6	294
	5 Pl 1 Aust Port Maint Coy	Pl	-	30
JACQUINOT BAY	33 Aust Docks Op Coy	Type "D"	4	108
	4 Pl 1 Aust Port Maint Coy	Pl	-	22
KORCKIMA	6 Aust Docks Op Coy	Type "C"	7	283
	3 Pl 1 Aust Port Maint Coy	Pl	1	31

(b) General Remarks

Nil

SECRETMONTHLY REPORT - APRIL 1945HQ 3 Aust Docks Group RAE (AIF)Part 11. - OPERATIONS(a) Summary of Tonnages Handled

Port	Unit	No of ships handled incl. Small Craft	Tonnage Loaded	Tonnage Dis- charged	Total Tonnage
=====					
LAE	4 Aust Docks Op Coy	15 incl 8 Small Craft (No of vehs 295)	Meas.T. 11,223	Meas.T. 12,802	Meas.T. 24,025
			DWT 6,941	DWT 6,718	DWT 13,659
	2/31 Aust Docks Op Coy	6 (No of Vehs 82)	Meas.T. 285	Meas.T. 1,207	Meas.T. 1,492
			DWT 154	DWT 181	DWT 335

PORT MORESBY	32 Aust Docks Op Coy	6 (No of vehs 206)	Meas.T. 7,265	Meas.T. 5,307	Meas.T. 12,572
			DWT 2,422	DWT 1,775	DWT 4,197
	41 Aust Docks Op Coy	2	Meas.T. 3,730	Meas.T. 819	Meas.T. 4,549
			DWT 1,454	DWT 295	DWT 1,749

FINSCHHAFEN	Det 2/31 Aust Docks Op Coy	4 incl 3 Small Craft	Meas.T. 485	Meas.T. 43	Meas.T. 528
			DWT 305	DWT 16	DWT 321

MADANG	2/31 Aust Docks Op Coy	36 incl 30 Small Craft (No of Vehs 21)	Meas.T. 4,132	Meas.T. 4,753	Meas.T. 8,885
			DWT 2,237	DWT 3,748	DWT 5,985
			Meas.T. 160		

Port	Unit	No of ships handled incl. Small Craft		Tonnage Loaded		Tonnage Dis- charged		Total Tonnage	
=====									
AITAPE	7 Aust Docks Op Coy	21 incl	12 Small Craft	Meas.T.	11,017	Meas.T.	18,954	Meas.T.	29,971
				DWT	4,466	DWT	10,774	DWT	15,240
				(No of Vehs 534		Meas.T.	8,164)		

JACQUINOT BAY	33 Aust Docks Op Coy	3 incl.	2 Small Craft	Meas.T.	406	Meas.T.	10,013	Meas.T.	10,419
				DWT	70	DWT	5,143	DWT	5,213
				(No of Vehs 101		Meas.T.	3,022)		

TOROKINA	6 Aust Docks Op Coy	30 incl	3 Small Craft	Meas.T.	21,525	Meas.T.	33,457	Meas.T.	54,982
				DWT	7,520	DWT	13,039	DWT	20,559
				(No of Vehs 1266		Meas.T.	22,965)		

TOTALS		128 incl	58 Small Craft	Meas.T.	60,068	Meas.T.	87,355	Meas.T.	147,423
				DWT	25,569	DWT	41,689	DWT	67,258
				(No of Vehs 2,505		Meas.T.	47,381)		

2 MAY '45

REPORT ON PORT FACILITIES - AITAPE

Ref. Map : US ARMY SHEET, AITAPE EAST S300 - E14215/15
SCALE 1 : 63600
Chart : AITAPE ROADS COMPILED BY HMA SURVEYING SHIP
"WARREGO" SEPT '44

1. CONTROLLING AUTHORITY

Port - Royal Australian Navy

Beach - 3 Aust Base Sub Area

2. GENERAL

(a) Approaches

AITAPE LANDING BEACH is approached through AITAPE ROADS south of TUMLEO ISLAND and TAMARA ROCK. The passage to the innerage anchorages is from 10 to 8 fathoms depth.

Good anchorages for deep sea vessels, small ships and Small Craft. In heavy weather during NW Monsoon period, deep sea vessels have occasionally to be moved to the lee of TUMLEO ISLAND, but for small ships and small craft, their normal anchorage between Jap Wreck (See Appendix "B") and ROHM POINT, is considered safe.

Dredging is NOT necessary as this is an open roadstead.

3. TIDES & CURRENTS

(a) Tide

The tidal data in this area is meagre but the following has been established. :-

Maximum rise and fall is 4', but normal tides vary between 2 and 3 feet. Flood tides set SE and ebb NW.

There is evidently only one low tide and one high tide daily.

Copy of tidal data for DEC '44 (Appendix "D") shows typical tide characteristics.

TIDES & CURRENTS (Cont)

(b) Currents

There is $1\frac{1}{2}$ knot current setting to the NW for the greater part of the year.

4. WEATHER

Prevailing winds from NW, Sept to May. Strong winds during this season often cause heavy surfs.

Prevailing winds from May to Oct are from the SE, and during this period no difficulty is experienced in Port Operations.

5. ANCHORAGES (Refer Appx "B")

- (a) The inner anchorage lying between the landing beach and the lee of TUMLEO island can be used for vessels of up to 30' draft, with swinging room for up to six Liberty type vessels.
- (b) In heavy weather vessels being worked by lighterage have occasionally to move to the lee of TUMLEO Island to facilitate operations.
- (c) The anchorage for small ships and small craft in the areas from the Jap Wreck, ROEM POINT and the South of STEIN REEF, is considered safe in all weathers.

6. DESCRIPTION OF HARBOUR

- (a) For general depths see Appx "B".
- (b) Docks Area is situated on Beach, Map Ref 897538. The Beach at this point is used for the bulk loading and off loading of LCT's. It is necessary, in consequence of surf conditions, to mobile load LCM's.
- (c) Owing to the nature of the Harbour, all load and off loading operations are carried out by LCT's., DUKW's., ALCM 20's and ALCM 40's. No landing stages, jetties, nor piers exist and the foreshores are such that the use of lighters is not possible.

Discharge of cargo on beach was formerly impeded by heavy surfs, which caused the LCT's to broach. This has been overcome by the use of tractors, which hold the LCT's up to the beach. Holdfasts have now been installed and are proving a success when used in conjunction with tractors (See Appx "C").

This makes it possible to operate with smaller tractors, and it has been found that the TD 9 tractors to each LCT are sufficient in fairweather.

- (d) Docks Area - (Refer Appx "A").

The Beach area in use for Docks Operations has been totally enclosed by a security fence.

The Docks and Movt. Control Offices are combined in one building located on the road, the outer boundary of the Docks Area.

7.

- (a) Wharfage
 - No wharves exist in the area. A coconut log jetty was attempted, but owing to surf conditions experienced, the decking could not be maintained.
- (b) Cranage
 - (i) No fixed installations.
 - (ii) Three Docks Service H.D.7 Tractor Cranes are in operation on the beach, two of which have been modified for mooring of LCT's by removal of jib and counterweights. Further tractor requirements are available from Engineer Sources on demand.
- (c) Lighting
 - 6 KVA lighting set situated within the Docks Enclosure supplies lights for Docks and Movt. Control Offices, the Beach and Transit Shed.
- (d) Water Supply
 - No storage facilities for watering ships. LCT's are watered by Army Water Trucks, but a watering point is to be on the Beach for the LCT and LCM's.
- (e)
 - NIL

8.

- (a) Anchorage (refer Appx "B")
- (b) Berths : NIL
- (c) Fairly hard sandy beach for landing craft within the Docks Area will accommodate between six and eight L.C.T's. The whole beach, however, is adaptable to this use

9.

The units are stationed on SELEO Island, 8 miles from the beach.

- | | | |
|-----|----------------------------------|-------------|
| (a) | Adv. Hq 43 Landing Craft Coy:- | 10 ALC 40's |
| | | 1 ALC 120 |
| (b) | Det 53 Port Craft Coy :- | 6 ALC 20's |
| | Detachment W.A.C. :- | 2 ALC 5's |
| (c) | 3 Aust Landing Craft Coy W/Shop. | |

between 70 and 75 per cent of above craft will be available daily when unit is functioning normally.

10

All types of cargo, including heavy M.T., Tanks, and Ambulance casualties can be handled from this Beach.

11. WAREHOUSES, STACKING SPACE AND TRANSIT AREA.

The Transit Shed within the area is of temporary nature, constructed of sisalcraft and are mesh with G.I roof. It is 80' x 20' and the flooring is raised to M.T. tray level.

12. COAL, OIL AND WATER.

- (a) Coal - No coaling facilities
- (b) Oil - No supply for refueling ships
- (c) Water - See para 7(d)

TIDE TABLES AITAPE - JANUARY 45

HQ 6 Aust Div

29 Dec 44

Ref No: GSI 344

The following Tide Table for January 1945 is issued subject to alteration and amendment. It is based however on the most accurate information available in the area.

Chart Datum Level 2.0 feet.

Date	Maximum		Maximum					
	High	Height	Low	Height	High	Height	Low	Height
1	1936	3.2	0248	0.3	0948	2.6	1406	2.1
2	2013	3.0	0308	0.6	1010	2.6	1447	2.1
3	1032	2.8	0328	0.6	2032	2.5	1527	2.1
4	1034	2.8	0346	0.6	2034	2.5	1612	2.1
5	1126	2.9	0421	0.6	2152	2.3	1720	1.9
6	1158	3.0	0451	0.4	2250	1.9	1824	1.7
7	1230	3.1	0506	0.5	2348	1.9	1936	1.5
8	1306	3.2	0526	0.7	0528	1.9	2032	1.2
9	1342	3.3	0546	0.9	0444	1.9	2128	0.9
10	1412	3.3	2212	0.8	0524	1.9	0696	1.8
11	1454	3.4	2258	0.6	0618	1.9	0703	1.9
12	1536	3.6	2332	0.4	0706	2.2	0754	2.0
13	1624	3.7	0018	0.2	0754	2.2	0842	2.1
14	1709	3.6	0058	0.2	0823	2.3	1022	2.1
15	1743	3.5	0138	0.1	0852	2.5	1202	2.1
16	1900	3.4	0212	0.1	0912	2.7	1320	2.1
17	1930	3.3	0244	0.2	0932	2.8	1430	2.0
18	1012	3.1	0316	0.4	2000	3.0	1530	1.9
19	1042	3.2	0348	0.6	2124	2.6	1636	1.8
20	1120	3.2	0424	0.9	2254	2.3	1742	1.4
21	1158	3.3	0502	1.3	0026	2.0	1846	1.2
22	1230	3.4	1956	1.1	0106	1.8	0512	1.5
23	1320	3.4	2102	0.9	0208	1.8	0616	1.6
24	1410	3.5	2208	0.7	0310	1.9	0720	1.8
25	1500	3.6	2312	0.4	0418	2.0	0824	1.9
26	1610	3.4	2351	0.6	0610	2.2	0946	1.8
27	1730	3.0	0030	0.9	0624	2.4	1108	1.6
28	1830	2.7	0056	1.2	0634	2.5	1236	1.5
29	1926	2.6	0146	1.4	0746	2.6	1329	1.4
30	0826	2.8	1418	0.9	2000	2.4	0226	1.6
31	0920	3.0	1508	0.6	2049	2.2	0320	1.7

- NOTES:
1. There is only one high and one low tide per day. The above table is arranged to indicate Maximum High and Low for each day.
 2. There is seldom more than 6 inches between the intermediate High and Low Tides. Because of only slight fluctuations at these times, the calculated times may vary considerably from observed tides but the difference is not significant.
 3. Maximum difference between High and Low Tide for the month is of the order of 4 feet. A heavy swell and surf or strong and persistent wind will cause differences in calculated heights and may even mask intermediate High and Low Tides.
 4. For heavy swell and surf add 1.0 to 2.0 feet to calculated heights. For moderate and persistent on shore winds add 6 inches. For strong off shore wind subtract 6 inches.

(Sgd) J.A. BISHOP Lt Col
GS 6 Aust Div.

APPENDIX A (PART C)

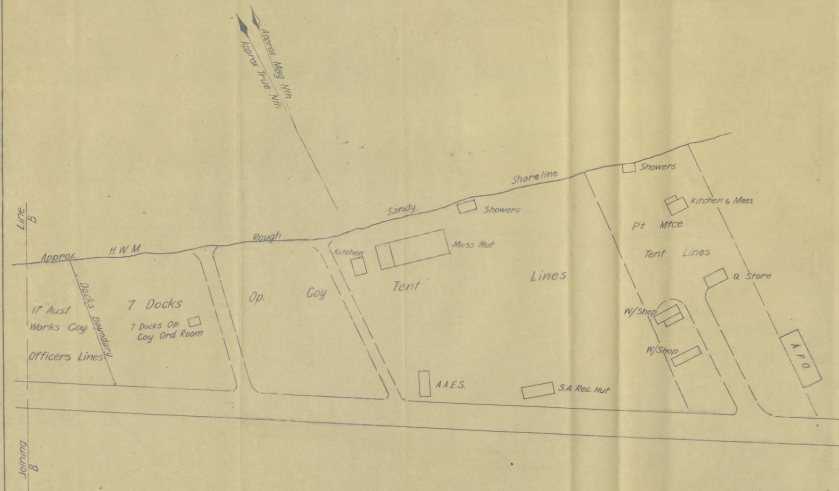

From a Compass Traverse by W.O.B. Bexton 29.3.45

3 AUST DOCKS GP. R.A.E.		SCALE	50' TO 1"	4 APRIL 45
DOCKS COY. & PORT MAINTENANCE AREAS AITAPE		DRAWN	W.B.	PASSED
		TRACED	W.A.B.	QUOTE ONLY
		CHECKED	W.B.	3DG-21c
		APPROVED	W.B.	

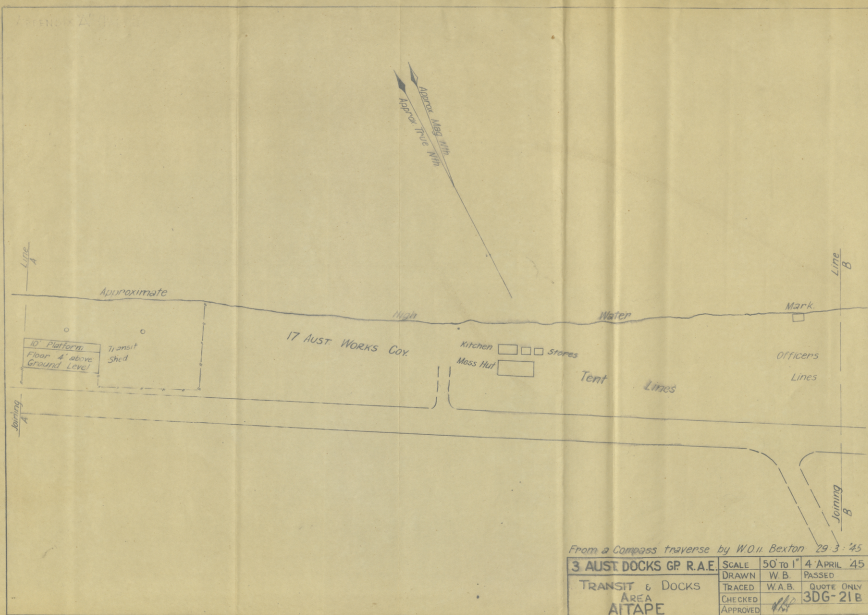

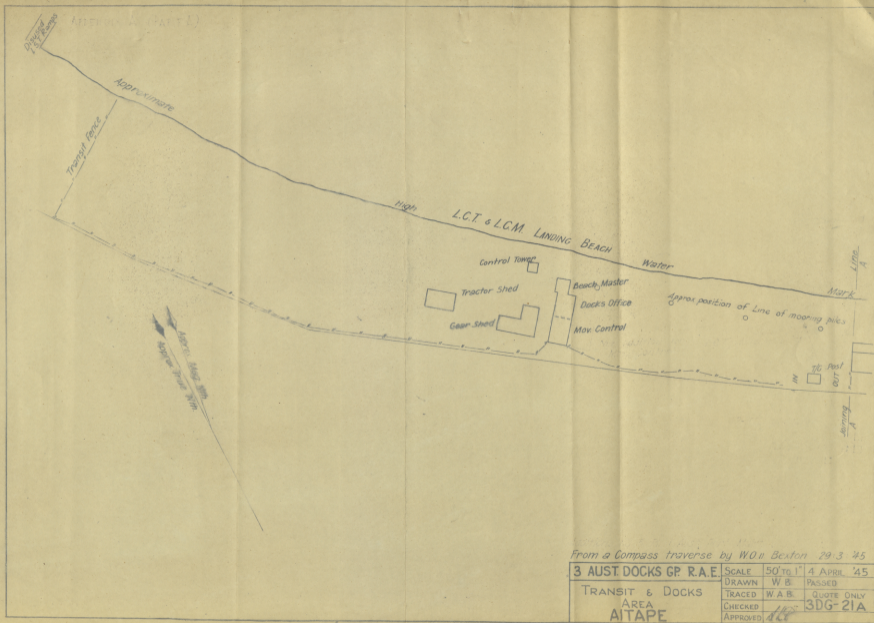

6 JUNE 1945

MONTHLY REPORT - MAY 1945Part 1. - ADMINISTRATION(a) Disposition of Staff

PORT	UNIT	TYPE	OFFRS	ORs
LALE	Hq 3 Aust Docks Gp	Group HQ	6	21
	4 Aust Docks Op Coy	Type "C"	7	285
	9 Pl 1 Aust Port Maint Coy	Pl	1	38
PORT MORESBY	41 Aust Docks Op Coy	Type "E"	2	41
MADANG	Det 8 Aust Docks Op Coy	-	-	5
WEWAK	2/31 Aust Docks Op Coy	Type "D"	4	104
AITAPE	7 Aust Docks Op Coy	Type "C"	6	296
	5 Pl 1 Aust Port Maint Coy	Pl	-	29
WEWAK	8 Aust Docks Op Coy	Type "C"	7	281
BOQUINOT BAY	33 Aust Docks Op Coy	Type "D"	4	102
	4 Pl 1 Aust Port Maint Coy	Pl	1	20
TOROKINA	6 Aust Docks Op Coy	Type "C"	6	287
	3 Pl 1 Aust Port Maint Coy	Pl	1	32
FINSCHHAFEN	Det 4 Aust Docks Op Coy	-	-	3

(b) General Remarks

Nil

S E C R E TMONTHLY REPORT - MAY 1945HQ 3 Aust Docks Group RAE (AIF)Part 11. - OPERATIONS(a) Summary of Tonnages Handled

PORT	UNIT	No of ships handled incl. Small Craft	Tonnage Loaded	Tonnage Dis- charged	Total Tonnage
=====					
LAE	4 Aust Docks Op Coy	41 incl. 25 Small Craft 400000 (No of Vehs 401	Meas.T. 10,895 DWT 4,743 Meas.T. 6,231)	Meas.T. 6,693 DWT 3,719	Meas.T. 17,588 DWT 8,462

PORT MORESBY	41 Aust Docks Op Coy	11 incl. 2 Small Craft (No of Vehs 66	Meas.T. 4,875 DWT 1,472 Meas.T. 630)	Meas.T. 3,155 DWT 815	Meas.T. 8,030 DWT 2,287

FINSCHAFEN	Det 4 Aust Docks Op Coy	3	Meas.T. 783 DWT 589	Meas.T. 14 DWT 3	Meas.T. 797 DWT 592

MADANG	2/31 Aust Docks Op Coy	11 incl. 5 Small Craft (No of Vehs 224	Meas.T. 5,563 DWT 1,987 Meas.T. 3,853)	Meas.T. 6,044 DWT 3,022	Meas.T. 11,607 DWT 5,009

AITAPE	7 Aust Docks Op Coy	24 incl. 14 Small Craft (No of Vehs 1212	Meas.T. 23,552 DWT 7,928 Meas.T. 16,517)	Meas.T. 14,011 DWT 8,770	Meas.T. 37,563 DWT 16,698

PORT	UNIT	No of ships handled incl. Small Ships		Tonnage Loaded		Tonnage Dis- charged		Total Tonnage	
JACQUINOT BAY	33 Aust Docks Op Coy	14 incl.	4 Small Craft	Meas.T.	4,921	Meas.T.	3,938	Meas.T.	8,859
		(DWT	1,792	DWT	1,919	DWT	3,711
		(No of Vehs	93	Meas.T.	1,220				
TOROKINA	6 Aust Docks Op Coy	39 incl.	12 Small Craft	Meas.T.	30,744	Meas.T.	25,215	Meas.T.	55,959
		(No of Vehs	366	DWT	12,497	DWT	11,192	DWT	23,689
				Meas.T.	22,185				
MOTUPENA	Det 6 Aust Docks Op Coy			Meas.T.	270	Meas.T.	3,940	Meas.T.	4,210
				DWT	207	DWT	2,619	DWT	2,826
TOTALS		143 incl	62 Small Craft	Meas.T.	81,603	Meas.T.	63,010	Meas.T.	144,613
				DWT	31,215	DWT	32,059	DWT	63,274
		(No of Vehs	3,362	Meas.T.	50,636				