

**AWM4**  
**Australian Imperial Force unit war diaries,**  
**1914-18 War**

Engineers

**Item number:** 14/21/41 Part 1

**Title:** 2nd Field Company, Australian  
Engineers

1 - 17 - May 1918



AWM4-14/21/41PART1



**CONFIDENTIAL.**

ORIGINAL.  
~~DUPLICATE.~~  
~~TRIPLICATE.~~

Australian Imperial Force.

**WAR DIARY**  
OF  
**2<sup>ND</sup> FIELD COY. ENGRS.**

FOR

**May 1918**

Signature of Officer compiling

*G. M. Croker Major*

Signature of Officer Commanding

*G. M. Croker Major*



# WAR DIARY

Army Form C. 2118.

Instructions regarding War Diaries and Intelligence Summaries are contained in F. S. Regs., Part II. and the Staff Manual respectively. Title pages will be prepared in manuscript.

## INTELLIGENCE SUMMARY.

2nd Field Co. Engrs. A.I.F.

(Erase heading not required.)

Place	Date	Hour	No. 1	Summary of Events and Information	Remarks and references to Appendices
	1.5.18.		Company Located as follows :-	Officers & No. 3 Section. Sheet. 27. W.13.b.1.1 H. G. & Nos. 1 & 2 Sections. W.13.a.3.6. No. 4 Section. W.13 d.0.5. Transport Lines. V.15.d.9.9.	
			Strength of Company.-	8 Officers 223 Other Ranks. 59 Horses. 12 Mules.	
			Disposition of Officers.	Major H.V. Gould O.C. detached at 2nd Infantry Brigade H.Q. as Liaison Officer Engineer Services. Captain D.A. Mackay, Officer in Charge of Company. Lieut. E.E. Dilworth "M.C." i/c No. 1 Section. Lieut. C.S. Bryan, i/c No. 2 Section. Lieut. G.C.L. Clark, i/c No. 3 Section. Lieut. H.E. Hammell, i/c No. 4 Section. Lieut. A.H. Heseltine, Supernumerary. 2/Lieut. Rosman, F.E.	@ Appendix No. 21.
			The work being carried out by this Company chiefly consists of the digging of Strong Points in the Support Line, which as time permits, are being linked up to form a continuous firing line.		
			Patches of Single apron fence are being erected and these are gradually being linked up to form a continuous line of fence.		
			At STRAZEELE STATION Sheet 36a E 3 & 4. a series of Strong posts are being constructed echeloned in depth and a single belt of single apron fence is under erection connecting with the Support Line at E 10 a on the left and E 4 b on the right, encircling the above posts.		
			The village of STRAZEELE is being encircled with the following defence works, (a) A continuous		



# WAR DIARY

Army Form C. 2118.

Instructions regarding War Diaries and Intelligence  
Summaries are contained in F. S. Regs., Part II.  
and the Staff Manual respectively. Title pages  
will be prepared in manuscript.

## INTELLIGENCE SUMMARY

2nd FIELD CO. ENGRS.

(Erase heading not required.)

Place	Date	Hour	No. 2.	Summary of Events and Information	Remarks and references to Appendices
STRAZEELE AREA. Right Sub-Sector. Locations. Billets W. 13 a.3.7. Transport Lines V.15.d.9.9.	1.5.18.			line of trench, (b) a continuous line of Single Apron Fence. Both of these lines are well under way. In addition to these Field works the miscellaneous works are.- The mining of all important cross roads in the area and the supervision of mines when completed, The erection of cupola dugouts and superstructure at W 23 a 4.7. for 2nd Inf. Bde. H.Q. (a) The construction of	(a) APPENDIX No. 25
		a.m. to 1 p.m.		gas proof doors and windows in dugouts and the fitting up of cellars and erection of stretcher racks for R. A. P's at W 22 c.1.6 & W 28.a.3.7.	
		p.m. to 4 a.m.		Transport has been employed drawing rations and stores and carting same from Q.M's Store at transport lines to Company's forward billets, also the carting of R.E. material from Coy. dump at W. 13 a 3.6. to forward R.E. dumps. (b)	(b) Appendix No. 2.
		Night work		Sections have been distributed on works as follows.-	
		Day		Night work. No. 1 Section on work on Right Section of Support Line and defence of STRAZEELE STATION.	
				" No. 3 Section. on work in Left Section of Support Line	
				" No. 4 Section on the defence of the village of STRAZEELE	
				Day work. No. 2 Section construction of cupola dugouts, erection of Gas doors, improvements to R.A.P's & laying & supervision of Road Mines.	
				" Lieut. Rosman & 3 Sappers on the defence of the village of BORRE.	
				Infantry parties were supplied by the 2nd. Infantry Brigade, who are at present holding the line. 1 O.R. accidentally wounded. Weather Fine & clear.	
	2.5.18			All works as per program of the 1st., inst., being continued. At X 25 b.7.8. a mine was exploded	

A6945. Wt. W11422/M1160 350,000 12/16 D. D. & L. Forms/C./2118/14.



# WAR DIARY

Army Form C. 2118:

Instructions regarding War Diaries and Intelligence Summaries are contained in F. S. Regs., Part II. and the Staff Manual respectively. Title pages will be prepared in manuscript.

## INTELLIGENCE SUMMARY.

(Erase heading not required.)

2nd Field Co. Engrs.

Place	Date	Hour	No. 3.	Summary of Events and Information	Remarks and references to Appendices
Works, STRAZEELE Right Sub-Sector. Location billets H.Q. W. 13 a. 3.7. Transport Line V. 15 d. 9.9.	2.5.18 (cont)			and crater formed to prevent the road being used by enemy armoured cars and Tanks.. (c) Orderly room held by Major Gould. Weather Fine.	(c) Appendix No. 26
	3.5.18.			At STRAZEELE station positions for V. M. G's have been commenced also a splinter proof shelter is being constructed for Right Battalion H. Q. All other works are in progress.	
	4.5.18	1 a.m. to 1 p.m. to 4 p.m. to 8 p.m.		1 O.R. evacuated sick, 2 Reinforcements on strength. Weather Fine.	
				During the evening a Brigade relief was carried out 2nd Inf. Bde being relieved by the 3rd Bde.	
				Parties from the 3rd Field Co. Engrs. were conducted over works being carried out by this unit & parties from this unit were conducted over works being carried out by the 3rd Field Co. Engrs.	
				on the LA COQ DE PAILLE - LA ROUKLOSHILLE → FLETRE switch, (d) STRAZEELE - COURTE CROIX Switch. " - ROUGE CROIX Switch. Defence of COURTE CROIX, All Mined roads and important roads in area for mining & supervision.	(d) Appendix No. 15.
				1 O.R. from Reinforcement Camp. Weather dull & cool. Major Gould rejoined from 2nd Bde. H.Q.	
	5.5.18	Night work Day		Relief referred to in entry of 4th., now completed. Company now responsible for works in Reserve Area. (e) Commencement was made on the wiring of switches. Sections being distributed as follows:- Night work No. 1 Section Strazeele - Courte Croix Switch. Day work 2 " Road mines. Night work 3 " Fletre - la Roukloshille - la Coc de Paille Switch do. 4 " Strazeele - Rouge Croix switch.	(e) Appendix No. 22.
				All work carried out by Sappers only, no Infantry parties being supplied.	
				A6945 Wt. W11422/M1160 330,000 12/16 D.D. & L. Forms/C.2118/14.	



# WAR DIARY

Army Form C. 2118.

Instructions regarding War Diaries and Intelligence  
Summaries are contained in F. S. Regs., Part II.  
and the Staff Manual respectively. Title pages  
will be prepared in manuscript.

## INTELLIGENCE SUMMARY.

2nd Field Co. Engrs.

(Erase heading not required.)

Place	Date	Hour	No. 4.	Summary of Events and Information	Remarks and references to Appendices
Works. Coc de Paille - La Roykloshille - Coutbe Croix - Strazeele & Rouge Croix Switches. Billet. H. Q. W. 13 a. 3.7. Transport V. 15 d. 9.9.	6.5.18.			At 5 a.m. Officers billet was subjected to a barrage of 4.2 Howitzer Shells. The last shell burst on thatching of billet roof just as the officers were preparing to vacate the billet, with the unfortunate result that five of the Officers were wounded and the three others were badly shaken. Officers wounded were.- Major H.V.Gould, Capt. D.A. Mackay, Lieut. E.E. Dilworth "M.C." Lieut. H. E. Hammell, Lieut. C/S. Bryan. Lieut. Dilworth "M.C." Died of wounds late in the afternoon.	
				At 11 a.m. Capt J.E.G. STEVENSON, acting under instructions from the C.R.E. moved from the 1st Field Co. Engrs. and took over command of the Company from Lieut. G.C.L. CLARK.	
				During the afternoon Lieut. HILL also reported from 1st Field Co. Engrs. and was taken on the strength.	
				Disposition of Company now is.- Capt. J.E.G. STEVENSON "M.C." in charge of Co. Lieut. Clark i/c No. 3 Section (which is to be employed on Day work) and Second in command. Lieut. Heselstine, i/c No. 4 Section & to work on Strazeele - Rouge-Croix switch. (Night work) Lieut. Hill i/c No. 2 Section and to work on Strazeele - Fletre La Coc de Paille Switch. (Night Work) 2/Lieut. Rosman, i/c No. 1 Section & to work on defence of Courte Croix. (Night work)	
				Working was carried out on the linking up of trenches and belts of single apron so as to form continuous switches. Parties were supplied by 2nd Inf. Bde. 6th B.R. as Reinforcements.	
				1 O.R. rejoined from D.H.Q. 1 O.R. from Wounded 1 O.R. " Hospital.	



# WAR DIARY

Army Form C. 2118.

Instructions regarding War Diaries and Intelligence  
Summaries are contained in F. S. Regs., Part II.  
and the Staff Manual respectively. Title pages  
will be prepared in manuscript.

## INTELLIGENCE-SUMMARY.

2nd Field Co. Engrs.

(Erase heading not required.)

Place	Date	Hour	No. 5	Summary of Events and Information	Remarks and references to Appendices
Coc de Paille - La Roukloshille - Coubre-Croix - Strazele and Rouge Croix - Strazele Switches  Works.	7.5.18.			Trench digging and wiring is being carried on at the switch lines by night and the laying and supervision of mines by day. Work has been hampered owing to rain. Parties were supplied by 2nd. Inf. Bde. During the evening No. 3 Section's billets were shelled, resulting in 1 O.R. being wounded. Weather. Showery.	
		1 a.m. to 4 p.m.		After work was finished No. 2 Section did not return to billets at W.13.c.3.7. but moved into shelters in W 6 b. packs and blankets having been sent there earlier in the evening.	
	8.5.18.	9 p.m. to 8 a.m.		No. 3 section working on road mining and erection of notice boards for bridges during the day. At 6 p.m. No. 1 Section under Lieut. Rosman moved to la Roukloshille and joined No. 2 Section in dugouts at W.6 b. Coy. H.Q. & Nos. 3 & 4 Sections moved to Farmhouse at W 19 b.2.9. and from those billets Sections went forward to work. Major H.V. GOULD "Died of Wounds" lat 15th C.C.S. During the morning the billet at W.13.a.3.7. was shelled but no damage was done.	
		Night work		1 O.R. to XVth Corps Musketry School. Weather Fine.	
	9.5.18.	Day work		All work north of Meteren Becque i.e. Fletre-La Roukloshille - Coc de Paille Switch. was handed over the 211th Field Co. R.E. of 31st. Division, as this Division was taking over frontage held by the left Brigade of the 1st. Australian Division. (F)	
				At 3 p.m. Nos. 3 & 4 Section and Company H.Q. left Farmhouse at W. 9 b.2.9. and proceeded to new billet at LA BREARDE ( V. 5 c.7.3.) After conducting relief parties over area North	



# WAR DIARY

Army Form C. 2118.

Instructions regarding War Diaries and Intelligence  
Summaries are contained in F. S. Regs., Part II.  
and the Staff Manual respectively. Title pages  
will be prepared in manuscript.

## INTELLIGENCE SUMMARY.

2nd Field Co. Engrs.

(Erase heading not required.)

Place	Date	Hour	No. 6	Summary of Events and Information	Remarks and references to Appendices
Work. "C" Line. Location. La Brearde V 5.c. 7.3. Transport Lines V. 15 d. 9.9.	9.5.18.			of Meteren Becque and handing over works that were controlled by this unit Lieuts. Hill & Rosman with Nos. 1 & 2 Section vacated dugouts at W 6 b. and proceeded to billet at LA BREARDE, reaching there about 5 p.m.	
				During the evening No. 1 Section went forward and erected double apron fence around Courte Croix.	
				No. 2 Section. also went forward & was employed on wiring on the Rouge Croix - Strazeele Switch.	
				No Infantry parties being supplied owing to change over, 2nd Infantry Brigade moving into Support Area and 1st Infantry Brigade moving from relieved left Brigade sector into Reserve.	
				Sub-sector <del>known</del> previously known as the Right Brigade sub-sector, is now the Divisional area, and is divided into three Zones. Front, Support and Reserve. This unit being attached to the 2nd Brigade is therefore in the Support Zone.	
	10.5.18.			Under instructions from C.R.E. Capt. STEVENSON, "M.C." and Lieut. Clark, proceeded to the 17th Northumberland Fusiliers (N.E.R. Pioneers) and received all papers in connection with "B" and "C" Lines of 2nd (Support) Zone defences.	
				Lieut. Clark then called upon the 3rd. Field Co. Engrs. and took over all documents in connection with the defended locality of PRADELLES, this Officer in company with an N.C.O. reconnoitred these defences.	
		9.30 a.m.		Lieut. Heseltine with No. 4 Section commenced work on "C" line, Building, thickening & camouflaging parapet & parados and cutting drains. Infantry being supplied by the 7th Battalion.	



# WAR DIARY

Army Form C. 2118.

Instructions regarding War Diaries and Intelligence Summaries are contained in F. S. Regs., Part II. and the Staff Manual respectively. Title pages will be prepared in manuscript.

## INTELLIGENCE SUMMARY.

2nd. Field Co. Engrs.

(Erase heading not required.)

Place	Date	Hour	No. 7.	Summary of Events and Information	Remarks and references to Appendices
Location. "B" Line. "C" Line Borre. Billets Sappers. V Transport Lines V	10.5.18.			During the morning the handing-over of all works on the Rouge-Croix - Strazeele & Courte - Croix - Strazeele Switches and the defence of Courte Croix were handed over to the 1st. pioneer Battalion, A.I.F. documents, plans etc., being handed over accordingly. (g)	(g) Appendix No. 17
				No. 3 Section under Lieut. Clark commenced work on the defences Pradelles at 9 p.m. and fatigue Party was supplied from the 5th Battalion for digging of trenches. Work ceased at 10.30 p.m. and section returned to <del>their</del> <sup>its</sup> billet. 1 O.R. from Hospital. Weather Dull & cold. <i>gmb</i>	
	11.5.18			In accordance with instructions issued by the C.R.E., all matter appertaining to the defended locality of PRADELLES was handed over to the 1st. Pioneer Battalion, who are to be responsible for this defence. This Handing-over was carried out by Lieut. Clark.	
				Lieut. Hill accompanied Lieut. Baker-Finch of the 3rd Machine Gun Co. over all M.G. emplacements in 2nd Zone trenches. No. 1 & 2 Sections carried out improvements to trenches in "C" line as commenced yesterday. No. 2 Section spelling. 5.O.R. to Hospital. Weather, - Fine.	
	12.5.18			In the afternoon Lieut Clark called upon the 3rd. Field Company Engrs. who handed over to him all documents, plans &c in connection with the defence of BORRE, which will now come under this unit for Engineer services. <i>gmb</i>	
	12.5.18.			Work now proceeding as follows :- Lieut. Rosman i/c No. 1. Section on "C" Line " Heseltine 4 " do " Hill 2 " on M.G. emplacements "B" Line " Clark, " 3 " Borre Defences.	
A6945 Wt. W11422/M1160 350,000 12/16 D. D. & J. Forms/C./2118/14.					



# WAR DIARY

Army Form C. 2118.

Instructions regarding War Diaries and Intelligence Summaries are contained in F. S. Regs., Part II. and the Staff Manual respectively. Title pages will be prepared in manuscript.

## INTELLIGENCE SUMMARY.

2nd Field Co. Engrs.

(Erase heading not required.)

Place	Date	Hour	No. 8.	Summary of Events and Information	Remarks and references to Appendices
"B" Line "C" Line "D" Line Work, Billets Sappers V. 5.0.7.3. Transport Lines W. 15.0.9.9.	12.5.18.			In-fantry parties were supplied by the 7th Battn. and Nucleus Battn. of the 3rd. Brigade. no Infantry were employed on M.G. emplacements in "B" Line. Work on "B" & "C" Line carried on from 9.30 a.m. to 2.30. p.m. No. 3 Section commenced work on Borre Defences, digging trenches, strengthening cellars and constructing M.G. positions. Weather .- Fine. 2 O.R. to Field Amb.	
	13.5.18.	9.30 a.m. to 2.30 p.m.		Brigade relief conducted. 2nd Brigade moving into the Front Line & 3rd Brigade moving into support area. Owing to the heavy casualties sustained amongst the Officers of this unit, it was arranged for the 3rd Field Co. Engrs. to continue its tour of duty in the Line with the 2nd Infantry Brigade instead of being relieved by the 2nd Field Co. Engrs., and for the latter unit to carry out works in the Support Zone. Relief was carried out during the evening. During the day this unit carried out the following works.- "C" Line.- Improving trench, parapet and parados, draining and wiring. "B" Line.- Erecting breastwork, draining trench and constructing M.G. Emplacements. BORRE.- Cleaning out trenches, digging drains, strengthening cellars and constructing M.G. emplacement Parties on "B" & "C" Line supplied by 2nd. Bde. & for work on Borre by Nucleus Battn. 3rd Bde. 1 O.R. Sick 2 O.R. Reinforcements.	
	14.5.18			During the day arrangements were made to hand over "D" Line from the 17th Northumberland Pioneer Battn. (N.E.R.) to this unit and this was duly carried out. Line coming under Lieut CLARK, No. 3 Section for necessary works. Weather dull and showery. Work on "D" will consist chiefly of Erection of Breastwork & construction of M.G. emplacements.	

A6945 Wt. 11,422/11160 350,000 12/16 D. D. & L. Forms/C/2118/14



# WAR DIARY

Army Form C. 2118.

Instructions regarding War Diaries and Intelligence Summaries are contained in F. S. Regs., Part II. and the Staff Manual respectively. Title pages will be prepared in manuscript.

## INTELLIGENCE SUMMARY.

2nd Field Co. Engrs.

(Erase heading not required.)

Place	Date	Hour	No. 9.	Summary of Events and Information	Remarks and references to Appendices
"B", "C" & "D" Lines. Defences of Borre. Coy. Billets. Le BREARDE V 5.c.7.3. Transport Lines, V.15.d.9.9.	14.5.18			All works proceeding. Parties for Line work being supplied by 3rd Brigade and for Borre defences supplied by Nucleus Battn, 2nd Brigade. Work commenced on "D" Line.	
				Owing to clearness of weather and enemy observation it has been necessary to work Infantry in parties of not more than 12 men and have them spread well over the works.	
				Weather Fine and clear. 1 O.R. sent to XVth Corps Gas School.	
	15.5.18	2.30 p.m.		O.C. (Capt. Stevenson) with B.M. and Staff Capt. of 3rd Infantry Brigade, inspected "B" & "C" Lines. No fresh works started, all other works in progress. Lieut. DEACON ex 6th Field Co. Eng. and 2/Lieut. WHITE, ex 5th Field Co. Engrs. reported and were taken on strength of Coy.	
	16.5.18	9.30 a.m.		In addition to improvements to and digging of trenches, wiring and construction of M.G. emplacements, Knife rests are being made for all roadways and Artillery Gaps and being placed in position. At Borre communication trenches are being dug from trenches encircling locality to M.G. positions in Houses and cellars. Weather. Very warm. 1 O.R. to Field Amb.	
	17.5.18	Hoursof work		Lieut. Deacon attached with Lieut. Hill to No. 1 Section. " White do Clark 3 "	
				No fresh works commenced. 1 O.R. to Field. Amb. Weather Very Hot.	
	18.5.18.			No work was carried out on "D" Line during the day, all of No. 3 Section and attached Inf. being concentrated on BORRE defences. Owing to Brigade relief no parties were supplied by 3rd Infantry Brigade for work on "B" "C" & "D" Lines, work on these lines being executed by	

A6945 Wt. W11422/M1160 350,000 12/16 D. D. & L. Forms/C.2118/14



# WAR DIARY

Army Form C. 2118.

Instructions regarding War Diaries and Intelligence Summaries are contained in F. S. Regs., Part II. and the Staff Manual respectively. Title pages will be prepared in manuscript.

## INTELLIGENCE SUMMARY.

2nd Field Co. Engrs.

(Erase heading not required.)

Place	Date	Hour	No. 10.	Summary of Events and Information	Remarks and references to Appendices
<p>WORK</p> <p>"B", "C" &amp; "D" LINES.</p> <p>Defence of Borre.</p> <p>Forward billets. LA BREARDE</p> <p>V.5.0.7.3.</p> <p>Transport Lines. V.15.d.9.9.</p> <p>LOCATIONS</p>	18.5.18	(cont)		Engineers only and consisted only of wiring and M.G. Emplacements. Parties for Borre were drawn from Nucleus Battn, 2nd Infantry Brigade.	
				During the afternoon bathing parade was held, also an inspection of rifles, ammunition and equipment. 2/Lieut. White proceeded to Transport Lines and took up command as Officer in Charge.	
				During the night Brigade relief was conducted. The 1st Brigade moved from Reserve into Support Zone whilst the 3rd Brigade took up position in Zone vacated by 1st Brigade.	
				2 O.R. rejoined unit from Hospital. Weather Very Hot.	
	19.5.18	9.30 a.m. to 2.30 p.m.		Temp. Major G.N. CROKER, "M.C." arrived from 1st. Army Troop Co. to take command of this unit and was taken on strength as from 16th inst. Work of wiring & M.G. emplacements only carried out on "B" & "C" Lines no party being supplied, again owing to Brigade relief. No. 3 Section continued work on BORRE defence parties being supplied from Nucleus Battn. of Bde. in line.	
				During the afternoon O.C. visited Coy. Transport Lines and Martyn R.E. Dump.	
				At night Brigade relief was carried out. 1st Brigade moving into Front Zone and 2nd Brigade becoming support Brigade. This unit therefore is now attached to the 2nd Infantry Brigade.	
				The Field Company in Line being relieved by Field Company of Brigade taking over.	
				2 O.R. from Hospital., 1 O.R. from D.H.Q., 1 O.R. from XVth Corps Gas School. Weather-Hot.	
	20.5.18			Owing to relief not being completed until early morning, no parties were supplied by the 2nd.	

A6945 Wt. W11422/M1160 350,000 12/16 D. D. & L. Forms/C./2118/14.

10



# WAR DIARY

Army Form C. 2118.

Instructions regarding War Diaries and Intelligence Summaries are contained in F. S. Regs., Part II. and the Staff Manual respectively. Title pages will be prepared in manuscript.

## INTELLIGENCE SUMMARY

2nd Field. Co. Engrs.

(Erase heading not required.)

LOCATION. WORKS "B", "C" & "D" LINES. Defences of PRADELLES AND BORRE. Forward Billets. La Brearde. V.5.c.7.3. Transport Lines. V.15.d.9.9.	Place	Date	Hour	No. 11	Summary of Events and Information	Remarks and references to Appendices
		20.5.18.			Infantry Brigade. Work carried out same as yesterday, but no start was made until 12.30 p.m.	
		(cont)			at which time it was ascertained that no parties from the Infantry would be supplied. Work completed at 5 p.m. Nucleus Battn. of 1st. Bde supplied parties for work at Borre working from 9.15 a.m. till 12.45 p.m. No. 3 Section being in charge.	
					During the day O.C. accompanied with Lieut. Clark, inspected all road mines in Support Zone, also Borre Defences and called upon Brig. Gen. Heane, G.O.C. 2nd. Inf. Bde.	
					Weather. Very warm. 1 O.R. to Hospital.	
		21.5.18.			Working was commenced at 7.30 a.m. on all Lines and Defences and was continued until 12.30 p.m. thus enabling all work to be done during the cooler part of the day.	
					Infantry parties were supplied by the 2nd. Bde. and Nucleus Battn. of Bde. in Line.	
					Work carried out on "B" & "C" Lines was, Improvements to and digging & draining of trenches	
					Wiring, M.G. emplacements, Knife rests for Artillery Gaps and erection of breastworks.	
					No work was executed on "D" Line. All work on M.G. emplacements in Borre is being carried out under supervision of Lieut. Clark and all work on trenches and wire encircling the village is controlled by Lieut. Deacon. Major Croker "M.C." and Capt. Stevenson "M.C." inspected "C" Line	
					Weather. Very warm.	
		22.5.18			Defence of PRADELLES was taken over from the 1st. Pioneer Battn. O.C. inspected same in company	

A6945 Wt. W11422/M1160 350,000 12/16 D. D. & L. Forms/C./2118/14



# WAR DIARY

Army Form C. 2118.

Instructions regarding War Diaries and Intelligence Summaries are contained in F. S. Regs., Part II. and the Staff Manual respectively. Title pages will be prepared in manuscript.

## INTELLIGENCE SUMMARY.

2nd Field Co. Engrs. A.I.F.

(Erase heading not required.)

Place	Date	Hour	No. 12.	Summary of Events and Information	Remarks and references to Appendices
LOCATION. WORKS "B" & "C" & "D" Lines. Defences of BORRE AND PRADELLES. Forward billets. Transport Lines	22.5.18 (cont)			with Capt. Townsend "M.C.". of the 1st Pioneer Battalion. O.C. also located new switch to be constructed between "C" & "B" Lines, South of Borre. PRADELLES DEFENCE has been allotted to Lieut. HILL, and BORRE SWITCH to Lieut. ROSMAN. All works on "B" & "C" Line and Borre are proceeding; no attention being paid to "D" Line. Sickness, which has been rife in the Coy. for the past week, is about its worst to-day. At forward billets 7 O.R. are exempt and 2 O.R. are on Light Duty. At transport Lines 3 O.R. are exempt and two are on Light Duty. Sickness is a species of Influenza. 1 O.R. from Hospital. Weather: Very Warm	
	23.5.18	0.0		O.C. went over works with C.R.E. and also over "D" Line with Capt. STEVENSON, "M.C."	
		7.30		At PRADELLES, wiring of double apron fence was proceeded with; Infantry parties being found by Nucleus Battn. Otherwise the program is the same as yesterday.	
				Work on "D" Line has been handed over from No. 3 Section and distributed as follows :- "D" Line running from apex at V.23b.Cent. to Northern Boundary i/c. Lieut. HESELTINE do. Southern Boundary " " ROSMAN.	
				4 O.R. from Hospital. 1 O.R. from Wounded. 1 O.R. from D.H.Q. 1 O.R. from XVth Corps School Weather : Cool and Breezy.	
	24.5.18			Owing to incessant rain in the morning, all working parties were recalled. By midday rain had ceased, and Infantry Parties were supplied from 2 p.m. until 5 p.m. works being carried out	
A6945 Wt. W11422/M1160 350,000 12/16 D.D. & L. Forms/C/2118/14. same as yesterday.					12



# WAR DIARY

Army Form C. 2118.

Instructions regarding War Diaries and Intelligence Summaries are contained in F. S. Regs., Part II. and the Staff Manual respectively. Title pages will be prepared in manuscript.

## INTELLIGENCE SUMMARY.

2nd Field Co. Engrs.

(Erase heading not required.)

Place	Date	Hour	No. 13.	Summary of Events and Information	Remarks and references to Appendices
	24.5.18.			O.C. inspected Roads and Bridge mines during afternoon. 1 O.R. to Div. Engrs. 1 O.R. to F.P. Compound. 1 O.R. from Sick Orderly Room Held. Weather Heavy rains in morning Dull and cold in afternoon.	
	25.5.18			Capt. Stevenson "M.C." took levels on South portion "B" & "D" Line with view to draining same. Work of wiring on "D" line was commenced by No. 4 Section. Works on "C" and "B" Line, 1 O.R. from Hosp. Weather. Borre switch and defences of Borre and Pradelles is proceeding. 1 O.R. " Wounded Dull & Cold.	
	26.5.18.			O.C. visited 3rd Field Co. Engrs. to arrange for taking over their billets on forthcoming relief. D.H.Q. objects to this unit occupying billets vacated by 3rd F.Co. as they are out of Reserve Brigade area. Lieut Deacon proceed to Sercus to arrange for billets, but reported that none were available. Parties from 1st Field Co. relieving unit, being shown over works in 2nd (SUPPORT) Zone. All work on other defences with the exception of "D" Line carried out. Weather Fine.	
	27.5.18.			Only 50% of Sappers employed on defence works. Remainder of Coy. employed on cleaning up of billets and general fatigues. Parties from 1st Field Co. Engrs. again shewn over works. Advance party left during morning to take over billets at V.8.d.2.6. At 2 p.m. Coy. moved out of billets at La Brearde and arrived at billets at V8.d.2.6 in the Reserve Zone., all works in Support Zone having been handed over to the 1st. Field Co. Engrs. (h) O.C. visited D.H.Q. with reference to obtaining billets in Reserve Brigade Area. Weather Fine and warm 1 O.R. to Field Amb.	(h) Appendix No. 18

A6945 Wt. W11422/M1160 350,000 12/16 D. D. & L. Forms/C./2118/14.



# WAR DIARY

Army Form C. 2118.

Instructions regarding War Diaries and Intelligence Summaries are contained in F. S. Regs., Part II. and the Staff Manual respectively. Title pages will be prepared in manuscript.

## INTELLIGENCE-SUMMARY.

2nd Field Co. Engrs.

(Erase heading not required.)

Place	Date	Hour	No. 14.	Summary of Events and Information	Remarks and references to Appendices
RESERVE BRIGADE AREA. Coy. H.Q. C 6 B.3.6. Nos 1 & 2 Sections. Locations. Nos 2 & 3 Sections. C 6 d 8.0.	28.5.18.	7 a.m.	Rifle inspection and inspection of gas helmets.		
		9 a.m.	Parade with rifles and side arms.	Inspection of Gas Helmets. Gas Drill. and competition between Sections on Gas alarms. Lieut. Deacon proceeded to locality of C.6. to arrange for billets.	(i) (i) Appendix No.20
			Afternoon devoted to Recreational Training.	Weather Fine.	
	29.5.18.	9 a.m.	Inspection of Rifles and Gas Helmets carried out.	Writing as per program.	
		2 p.m.	Company vacated billets and moved to billets at C. 6. Nos. 1 and 2 Sections & Coy. H.Q.		
			being located at C.6.b.3.7. & Nos. 3 & 4 at C.6.d.8.0.	Transport Lines are still at V.15.d.9.9.	
			2 O.R. from Hospital.	Weather Fine and Warm.	
	30.5.18.		Inspection of Rifles and Gas Helmets. M.G. Emplacements, as per program.	Afternoon. Coy. attended and took part in Brigade Sports. 1 O.R. to Field Amb. Weather.-Clear and Hot	
	31.5.18.	9 a.m.	Section Drill and inspection of Gas Helmets.		
		9.30 a.m.	Nos. 1 & 2 Sections on demolition schemes for bridges & No. 3 & 4 Sections on Schemes for Divisional Field Artillery Bridges over the STEEN BECQUE. Lunch was taken and Sections returned to billets about 3 p.m.	1 O.R. to Field Amb. Weather Fine.	
				O.C 2nd Field Co. Engrs.	Major.



# WAR DIARY

OF

2nd FIELD COMPANY ENGINEERS.

A. I. F.

FOR

M A Y

1918

## LIST OF APPENDICES.

No.	Subject.
✓1.	C. O's. Report.
✓2.	Transport Officer's Report
✓3.	Quarter Master's Report.
✓4.	List of Work carried out & Material used by unit for month
✓5.	Arrivals and Departures for May 1918.
✓6.	Graph. Shewing Daily Strength, (On strength & with unit)
✓7.	" " Strength of Sappers & Nos. on Field works
✓8.	" " Infantry & Engineer Working Parties.
✓9.	" " Man Hours Worked. Engineers & Infantry
✓10.	" " Daily Sick Parade.
✓11.	Demolition of Trees, Experiments carried out with Sabulite.
✓12.	"Handing-over" Report Hollebeke Sector. 3.4.18.
✓13.	do. La Motte Sector 18.4.18.
✓14.	do. Fletre - Strazeele Switch & Strazeele-Rouge Croix Switch 26.4.18.
✓15.	do. Strazeele Sector 4.5.18.
✓16.	do. Strazeele-Courte Croix-Fletre Switch
✓17.	do. Courte Croix Defences & Strazeele Rouge Croix Switch 11.5.18.
✓18.	do. 2nd Zone (Support) Defences 27.6.18. (Copy with Original War Diary only)
✓19.	do. Orders in connection with 2nd Zone Relief.
✓20.	do. Program of Training 28.5.18-2.6.18.
✓21.	Plan of "STRAZEELE" Sector.
✓22.	Plan of Switches - LaRoukloshille-La Coc de Paille -Courte Croix - Fletre - Strazeele - Rouge Croix & Defended Locality of Courte Croix.
✓23.	Plan of "B", "C" & "D" Lines Defended Localities of BORRE and PRADELLES. (2nd Zone (Support) Defences.
✓24.	Sketch of Bridge erected at La Motte at carry Field Guns " " Footbridge erected at La Motte.
✓25.	Sketch of Dugout & Superstructure erected for Bde.H.Q.
✓26.	Sketch of Road Mined for Anti Tank Defence
✓27.	Sketches of cellars strengthened in Borre.
✓28.	Types of M.G. Emplacements erected in defended localities.
✓29.	Plans do. do.



## WAR DIARY

Army Form C. 2118.

Instructions regarding War Diaries and Intelligence Summaries are contained in F. S. Regs., Part II, and the Staff Manual respectively. Title pages will be prepared in manuscript.

## INTELLIGENCE SUMMARY.

2nd Field Co. Engrs.

(Erase heading not required.)

Place	Date	Hour	No. 1	Summary of Events and Information	Remarks and references to Appendices
			<u>O.C.'s. REPORT.</u>		
<u>STRENGTH</u>				The unit for the month has been up to strength, except that it must be pointed out that there are 11 men on duty with the Australian Corps R.E. Yard i.e. not available as Divisional Troops and 6 on duty with the C.R.E.i.e. not available for Field Company duties. The Mounted Section of the unit is over strength and 2 over strength Drivers have been employed as Sappers.	
<u>MORAL.</u>				Good.	
<u>DISCIPLINE</u>				The discipline of the men of the unit has been good. Two cases have been dealt with, both old offenders, and it is strongly urged that men that cannot be relied on to take responsible positions with regard to working parties, should be transferred to a unit where individual responsibility is not so great	
<u>HEALTH.</u>				During the month a number, much exceeding a fair average have been off duty with sickness. The cause has not yet been explained and cases have not been diagnosed. The symptoms are high temperature, pains in the back and headaches. Cases are kept quiet and recover in a few days. Drinking water in this area has been tested and found fit for drinking. Latrines have been covered to keep down the fly nuisance. Men otherwise are in splendid health.	
<u>DENTAL.</u>				Total for the month.- 3.	
<u>GENERAL NOTES.</u>				It must be pointed out that a great improvement exists in Infantry Working Parties. The whole responsibility for work lies with the Infantry the Sappers providing Technical assistance and with the view of continuity of policy. Infantry parties are demanded on the basis.- 1 party is 1 Officer and 25 Other ranks the Infantry Officer accompanying the party. Task work is allotted throughout on a five hours basis. Tasks have been allotted as follows.- FRONT ZONE. <u>TRENCHES</u> 65 cub. feet excavation and camouflaged 3'6" x 3' x 6'. <u>WIRING.</u> 15 to 20 yards per man including carrying. <u>CLEARING TRENCHES.</u> 4 to 6 yards per man. <u>DUGOUTS.</u> as per sketch attached. 9 men one night. 2nd ZONE. <u>BREASTWORK.</u> 81 cubic feet per man.	

A6945 Wt. W11422/M1160 350,000 12/16 D. D. &amp; L. Forms/C./2118/14.

Major.  
O.C. 2nd Field Co. Engrs.



WAR DIARY

OR

INTELLIGENCE SUMMARY.

(Erase heading not required.)

Instructions regarding War Diaries and Intelligence Summaries are contained in F. S. Regs., Part II. and the Staff Manual respectively. Title pages will be prepared in manuscript.

Place	Date	Hour	Summary of Events and Information	Remarks and references to Appendices
			<u>TRANSPORT OFFICER'S REPORT.</u>	
<u>WORK.</u>			3 pontoons and four limbers have been employed daily carting R.E. Stores from Dumps to forward work, also back to MARTYN DUMP. One week was night work carting to FLETRE. Canteen cart daily. Mail cart & Water cart daily. Wagons moved Company four times during month	
<u>WAGONS.</u>			Are in good condition and fully equipped. They are washed and oiled twice weekly. 1 Limber returned. 1 Limber condemned, and one new limber supplied for condemned one. Trestle wagon repaired by wheelwright. At present all wagons are being painted.	
<u>HARNESS.</u>			At present all harness is in good condition.	
<u>STABLES &amp; LINE CONDITIONS</u>			Animals have not been under cover during the month. During the first week of month heavy rains were responsible for the bad condition of lines but as soon as weather cleared up lines were shifted and have since been good. Grooming is being carried out three times daily.	
<u>HORSES.</u>			During the month health has been fairly good, which is largely due to good weather, good standings and plenty of green feed.	
<u>STRENGTH</u>			5 Horses have been wounded 4 were evacuated and 2 are in M.V.S. 5 L.D. remounts have been drawn and 1 Riding Horse.	
<u>FODDER.</u>			Averages about 10 lbs. Oats and 10 lbs. of hay The quality of the oats is good but that of the hay is poor., several bundles being mouldy and could not be used. There has been a small amount	

Submitted. 2.  
17



## or

70

## INTELLIGENCE SUMMARY.

(Erase heading not required.)

Remarks and  
references to  
Appendices

O.C. 2nd Field Co. Engrs.

September 21  
18



Instructions regarding War Diaries and Intelligence Summaries are contained in F. S. Regs., Part II, and the Staff Manual respectively. Title pages will be prepared in manuscript.

## INTELLIGENCE SUMMARY.

(Erase heading not required.)

Place	Date	Hour	Summary of Events and Information	Remarks and references to Appendices
			<u>QUARTER MASTERS REPORT.</u>	
<u>RATIONS:-</u>			During the month the rations have been up to the standard. It has been necessary to keep a reserve of preserved meat on hand in consequence of the irregular delivery from Railhead.	
<u>FORAGE:-</u>			The forage ration has been good and when a stock accumulated it was necessary to underdraw from the Refilling Point. Green forage is now liberally issued three times a week.	
<u>CLOTHING:-</u>			Service dress has been rather difficult to obtain; although all clothing demanded has been supplied it has only been delivered in small quantities.	
<u>BOOTS:-</u>			Boots, ankle have been drawn for all mounted men for the purpose of exchanging Field Service Boots. Owing to leegings not yet being delivered the issue has been made to the dismounted men where absolutely necessary, and boots drawn for them will be issued to mounted men. 92 pairs of boots have been repaired during the month.	
<u>STORES:-</u>			All stores are complete on establishment, and unserviceable have been replaced by new.	
<u>AMMUNITION:-</u>			Each man is fully equipped with S.A.A. besides the reserve carried by the Company and the emergency reserve of 100 rounds per man.	
<u>SALVAGE:-</u>			All empties have been returned to railhead and unserviceable to Divisional Salvage Dump. Salvage returned is, - 120 lbs. paper, 150 lbs. cardboard & 100 lbs. Fat.- 200 Preserved Meat tins have been returned to the Div. Solder plant.	
<u>WAGONS:-</u>			Paint has been drawn and the wagons are now being painted.	
<u>HARNESS.</u>			A good supply of soft soap, dubbin, and oil has been supplied to the transport section for harness preservation, also new parts have been supplied to replace those unserviceable.	
			Major. O.C. 2nd Field Co. Engrs. A.I.F.	
			A6945 Wt. WH422/MH160 250,000 12/16 D.D.&L. Forms/C./2118/14.	



## WAR DIARY

or

## INTELLIGENCE SUMMARY.

(Erase heading not required.)

2nd Field Co. Engrs.

Instructions regarding War Diaries and Intelligence  
Summaries are contained in F. S. Regs., Part II.  
and the Staff Manual respectively. Title pages  
will be prepared in manuscript.

Place	Date	Hour	Summary of Events and Information				Remarks and references to Appendices
			<u>List of work carried out by and under supervision of 2nd Field Co. Engrs. during the Month of May 1918.</u>				
			<u>List of R.E. MATERIAL used by 2nd Field Co. Engrs. during the month of May 1918.</u>				
			TRENCHES. Excavating	5588 yards.	Stakes, wooden, long	3017	
			Widening and deepening	1421 "	" " short	5614	
			Building parapets & parapet	4499 "	Pickets, angle iron, long	628	
			Erecting breastwork	2218 "	do. short	1137	
			Cleaning out & camouflaging	1195 "	Wire, barbed, coils	1823	
			Draining.	1554 "	" plain, coils	2	
			WIRING. Single apron fence	5830 "	Iron, corrugated, sheets	93	
			Double apron Fence	9344 "	Sandbags,	10770	
			Driving pickets for wiring	780 "	Cupolas, large,	12	
			DRAINS. Excavated	890 "	small	191	
			Box drain made	86 "	Timber 6" x 2" feet	190	
			M. G. Emplacements	39 "	" 2" x 1" "	22	
			Loopholes	10 "	" 6" x 3" "	20	
			AUMMUNITION RECESSES.	4 "	" 4" x 3" "	50	
			CELLARS? Strengthening	6 "	" 3" x 3" "	12	
			KNIFE RESTS. for gaps in wire	31 "	" 8" x 1" "	124	
			CUPOLA DUGOUTS	17 "	" 9" x 1" "	28	
			and superstructure	1 "	" 7" x 2" "	17	
			Thinning hedges.		Wire, netting, rolls	1	
			Cutting stakes for wiring		Frames, dugout,	9	
			Erecting Notice boards		Pit props,	87	
			Gas proof doors and windows		Stakes, forest	16	
			R.A.P. providing additional cover		Sleepers,	20	
			Exploding mine.		Rails, steel	11	
			Erecting hand rails on bridges		Duckwalks,	12	
			Guarding and laying road and bridges	Mines.	Sabulite, lbs.	675	
			Erecting shelter for Battn. H.Q.				
A6945 Wt. W11422/M1160 350,000 12/16 D. D. & L. Forms/C./2118/14.							

Appendix 4

20



~~WAR DIARY~~

2nd Field Co. Engrs.

Army Form C. 2118.

Instructions regarding War Diaries and Intelligence  
Summaries are contained in F. S. Regs., Part II.  
and the Staff Manual respectively. Title pages  
will be prepared in manuscript.

OR  
**INTELLIGENCE SUMMARY.**

(Erase heading not required.)

Place	Date	Hour	Summary of Events and Information										Remarks and references to Appendices		
<u>Arrivals and Departures for Month of May 1918.</u>															
			Died of Wounds.		Wounded.		Hospital.		Transfers.		Reinfts.		Total.		
			O.	O.R.	O.	O.R.	O.	O.R.	O.	O.R.	O.	O.R.	O.	O.R.	
Arrivals.			-	-	-	5	-	14	4	-	-	11	4	30	
Departures.			3	-	3	3	-	17	-	-	-	-	5	20	
			Officers who have Died of Wounds during Month.										Major. H.V. GOULD.		
													Lieut. E.E. DILWORTH "M.C."		
													Lieut. H.E. HAMMELL.		
			Officers who have been wounded during the month										Capt. D. A. MacKay.		
													Lieut. C.S. Bryan.		
			Officers who have joined unit during month.										Major. G.N. CROKER "M.C."		
													Lieut. G.J. HILL		
													2/Lieut. E.C. WHITE.		
													LIEUT. F.J. DEACON.		
			OFFICERS who have been attached to unit during month										Capt. J.E.G. STEVENSON, "M.C."		
A6945 Wt. W11422/M1160 350,000 12/16 D.D. & L. Forms/C./2118/14															

Appendix 5. 21



DAILY STRENGTH.  
-----  
Effective Strength & actually with unit.

APPENDIX No. 6.  
2nd Field Co. Engrs. 20



Black line shews No. actually on strength of unit.  
Green Line shews No. actually with unit.

Appendix 6.  
22



## DAILY STRENGTH - WORKS.

May 1918.

2nd Field Co.

Engrs.

No. of Sappers with unit &amp; No. of Sappers employed on Field Works



Black Line No. actually with unit.

Red Line No. employed on Field Works.

*J. M. Croker*  
 Major  
 2nd Field Co. Engrs.

Appendix 7. 23



20

APPENDIX No. 8.

P1

WORKING PARTIES

ENGINEERS & INFANTRY.

2nd Field Co. Engrs.

appendix 8.

May 1918.

24

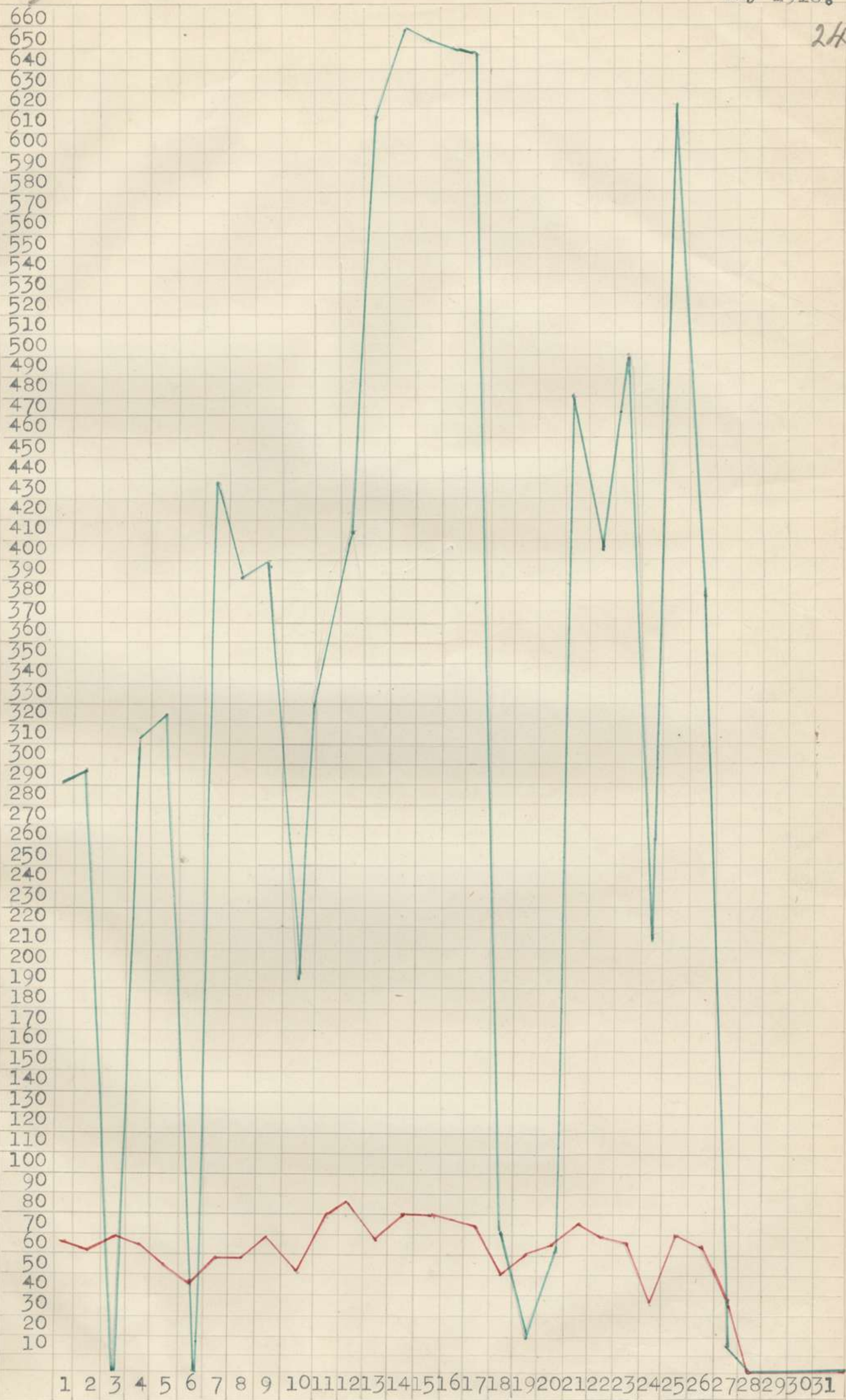

Red Line. Engineers.  
Green Line Infantry.



2nd Field Co. Engrs. A.I.F.

GRAPH - SHOWING WORKING HOURS. (Men).

Engineers & Infantry.

May 1918.

APPENDIX No. 9.

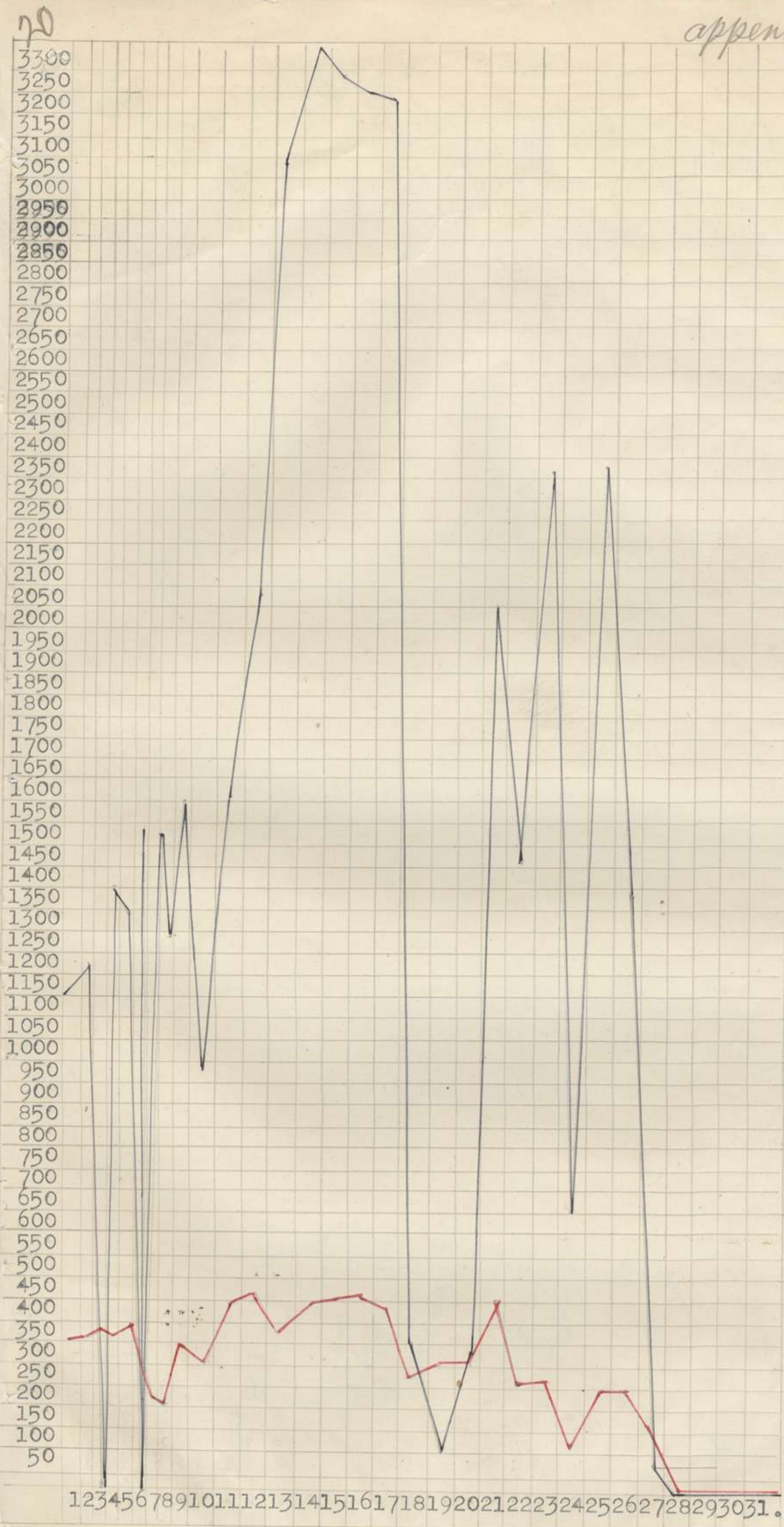

Working Hours. Engineers. Red Line.  
do. Infantry Blue Line.



2nd Field Co. Engrs. A.I.F.

May 1918.

APPENDIX No. 10

GRAPH SHEWING DAILY SICK PARADE.

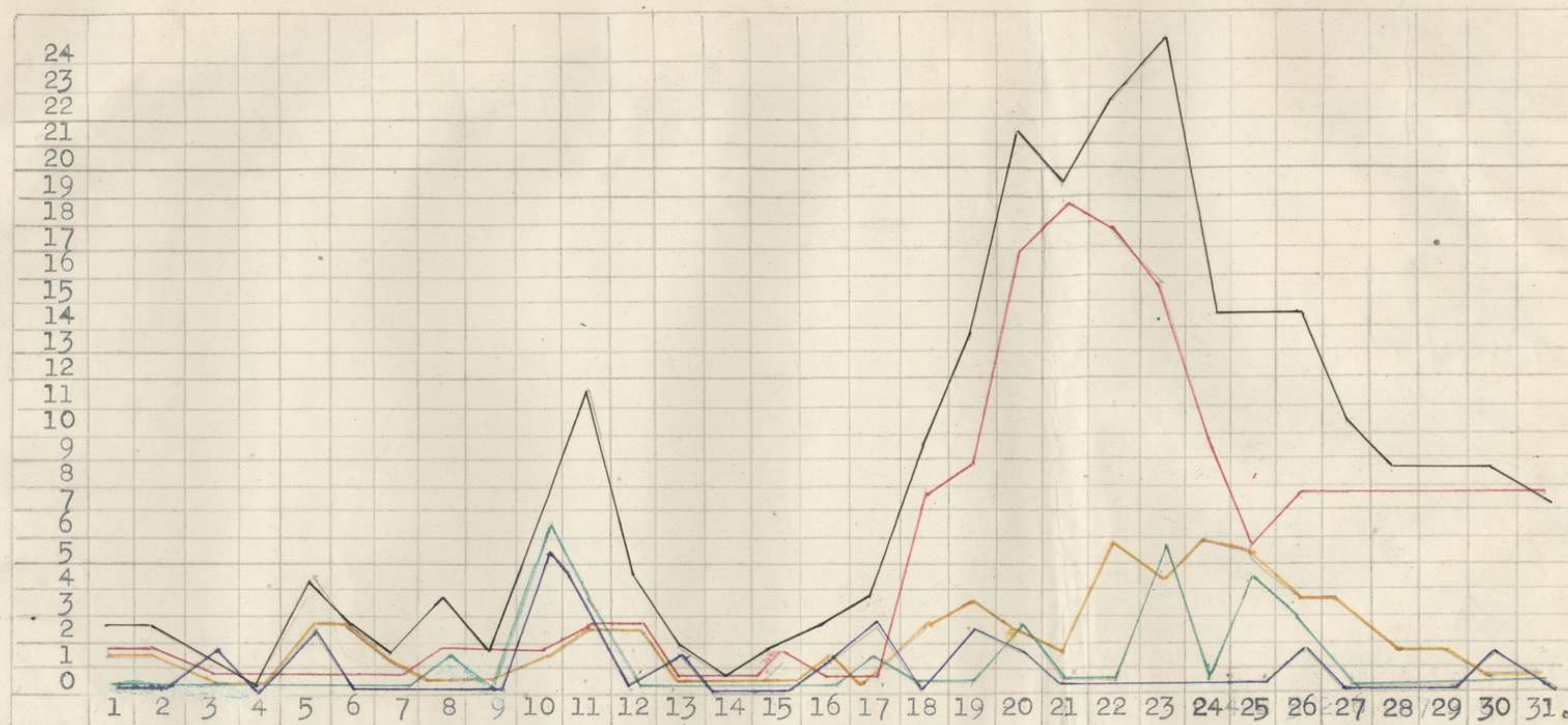

Number reporting sick in black  
" exempt in red.  
" Medicine and Light Duty in yellow  
" Medicine and duty in green  
" evacuated in blue.

J. W. Croker Major.

O.C. 2nd Field Co. Engrs.

Appendix 10, 26.



DEMOLITION OF TREES.

EXPERIMENTS CARRIED OUT WITH "SABULITE".

Tree	Diameter	Height	Charge	How placed	How fired	Result and Remarks.
Elm.	22"	50'	7 lbs. 4 ozs. Sabulite.	Necklace 3" dia. 6' long, around trunk 3' from ground.	No. 8. Detonator. Time fuze	The tree was completed cut through and fell towards side where charge was slightly larger and where detonator was placed.
Elm	22"	50'	2 lbs Sabulite	Partial necklace 18" long, 3' diameter, in canvas tube	No. 13 Det. Fired Electrically	Tree completely cut through and fell over to side on which charge was placed.
Elm	18"	44'	3 charges Each of 1 3/4 lb. Total 5 1/4 lbs.	Partial necklace 10" long. 2" diameter in canvas tube	No. 13 Det. Fired. Electrically	In order to determine minimum charge one of 1 3/4 lbs. was used. Result.- Hole 3" deep 10" long. The second charge enlarged hole to 6" deep and 14" long. The third charge completely shattered tree causing it to fall over to side on which charges were placed.
Elm.	24"	56"	2 charges 4 1/2 lbs. & 5 lbs 4 ozs Total 10 lbs. 5 ozs.	In two necklaces 6' long and 2" and 2 1/2" diameter in canvas tube	No. 13 Det. Fired Electrically.	First charge merely cut a gash 3" wide and 3" deep around tree. The second necklace placed 6" higher up on the tree made cut 10" long and 5" deep. After remaining unright for about two minutes the tree toppled over.

To ensure trees falling in prescribed direction when using complete necklace, the charge on this side should be slightly larger and detonator placed on this side. For small trees (less than 18" dia.) charge could be placed only on side to which tree is to fall.

The minimum charge required to demolish a tree 24" diameter is 8 lbs. Sabulite in necklace 3" diameter and 6' long.

Appendix 11.  
127



C O N T E N T S.

1. Report on Front Line
2. Report on Support Line
3. Report on Reserve Line
4. Report on Miscellaneous Works
5. Locations of Strong Points Dumps & Camps.
6. Sketch of Picquet post.
7. Sketch of shelters being erected.
8. Sketches of Strong Points.
9. Accomodation table.
10. Report on Plans of Tunnels in BUFF BANK, GASPAR'S CLIFF, and "A" CRATER.
11. Plan of area showing Field defences.

---oOo---





## FRONT LINE.

## POSTS.

These consist of three groups, BELGIAN WOOD, POTSDAM WOOD and HESSIAN WOOD.

At each group the platoon H. Qrs. exists in Pill Box. The posts consists of small trench works with a low revetment about 3' high with a trench 6' to 8' long and 3' wide. In each group a Lewis Gun post exists. In most posts the trenches are dry but shallow. The ground will not permit of deepening these posts as the positions border on very marshy country.

Left Front Line Coy. H. Q. is at the CHATEAU DUGOUTS I.36.d.4.1.

Right Front Line Coy. H. Q. is at the CLUSTERS I 36.d.9.5. ( on the right hand side of IMPERIAL AVENUE.

## WIRE.

A more or less continuous belt of wire runs the whole length of the Section.

Much wire exists but is not continuous, being runs of double apron.





SUPPORT LINE.CONDITION.

The Support Line worked by this Company runs from J.31.b.3.1. to J.31.a.7.6. (Jarrochs Farm) to J.31.c.6.7. (about 100 x to the left of Imperial Avenue) The line is good condition, being sandbagged, "A" Framed and duckwalked. Drainage is good. From J.31.c.6.7. to J.31.a.7.6. the Line is in poor condition as regards parapet and parados. This part of the Line is the new portion taken over, and only small "A" frames and duckwalks have been used. Behind GROENENBERG FARM (I.31.b.0.5) an Infantry post exists, but is not completed as regards shelters.

WIRE

2 belts of double apron exists in front. The Wiring of the Support Line is being done by the Brigade Mining Company.

MG. Posts

At the present time on the portion of the Support Line worked by this Company, 4 M.G. posts exist, with shelters for the crew of 4 men each.

SHELTERS FOR GARRISON.

Small shelters for 3 men each were made in the parados. All buildings of shelters in parados was stopped and these are being constructed off the trench. Number of shelter in the Line for four men each from J.31.b.3.1. to J.31.a.7.6. is 8 shelters in parapet and 12 shelters in parados. Three "L" shaped trenches exist for dugout saps. Two of these trenches have 2 dugouts in each. These dugouts hold 5 men each - Accomodation for 20. -





### RESERVE LINE.

TRENCHES. A continuous trench exists running from Left Brigade Boundary at I.36 b.4.8. to Imperial Avenue communication trench at I.36c.9.9. This trench is in good repair. It is revetted throughout.

Trench shelters have accommodation for 121 men.

A continuous trench runs from IMPERIAL AV. TO OLAF AV. from I.36 d.1.7. to I.36.c.2.9.. is revetted throughout and in good repair. Accommodation for 32 in trench shelters. In deep dugouts accommodation for 50 men.

The RIGHT FLANK is protected by five strong points, numbered 7, 8, 9, 10 and 11.

No. 11 S.P. I.36.c.8.2. Tis is 60% camouflaged & 30% revetted. It is in bad repair and has no accommodation.

No. 10 S.P. I.36.c.6.3. Post is 80% revetted. 60% camouflaged. Requires draining. No. accommodation. In bad repair.

No. 9 S.P. I.35.d.8.3. Post is .- 60% camouflaged. 50% revetted. Requires drain to be deepened. No. accommodation. and is generally in bad repair.

No. 8 S.P. I.35.d.0.3. Trench is revetted throughout and drained. Is roughly camouflaged and has accommodation for 3 men. It is in good repair.

No. 7 S.P. 0.5.a.6.8. Trench is revetted and drained throughout. Is roughly camouflaged and has accommodation for three men.

WIRE. Consists of two rows of double apron fence throughout from 0.5.a.8.2 to I.36.d.1.3. there are three rows of wire. In front of S.P.8. at 0.5 b. a fourth belt is being put out. In front of THE BUFF at 0.5.b.8.6. to in front of S.P. 9 four rows of apron fence exist.





MISCELLANEOUS.

CUPOLA SHELTERS. At I.35.b.0.6. (CATERPILLAR) Dressing Station under construction.

CONCRETE SHELTERS. All Pill Boxes in area in good condition and where possible to be drained and bunks constructed.

GAS PROOF DOORS. Kept in repair and reconstructed where necessary.

DDEP DUGOUTS. All in area are under Engineer supervision as regards Gas proof doors, drainage and ventilation.

DUCKWALK TRACK From OLAF AVENUE at 0.5.a.9.9. to DUCKWALK TRACK at 0.5.a95.65 to be constructed.

BATHS. At I.33.d.3.7. (NORFOLK BRIDGE) 3/4" pipe line to be connected to 2" water main in tunnel through entrance "C" and carried to heaters.





# LOCATION LIST.

## LOCATIONS of STRONG POINTS

STRONG POINT	No.	7	0. 5. a. 6. 8.
do		8	0. 5. b. 3. 9.
do		9	I. 35. d. 8. 2.
do		10	I. 36. c. 5. 3.
do		11	I. 36 c. 8. 2.

## LOCATIONS OF CAMPS.

REAR	
LA BRASSERIE	N. 6.a.1.2
FORWARD	
SPOILBANK	I. 33.d.2.6.

## LOCATIONS OF R.E. DUMPS.

RAILWAY DUMP.	I. 35. d.9.9.
ELZENWALLE DUMP	H. 36 c.8 9.
RODNEY DUMP	I. 33. b.6.8.





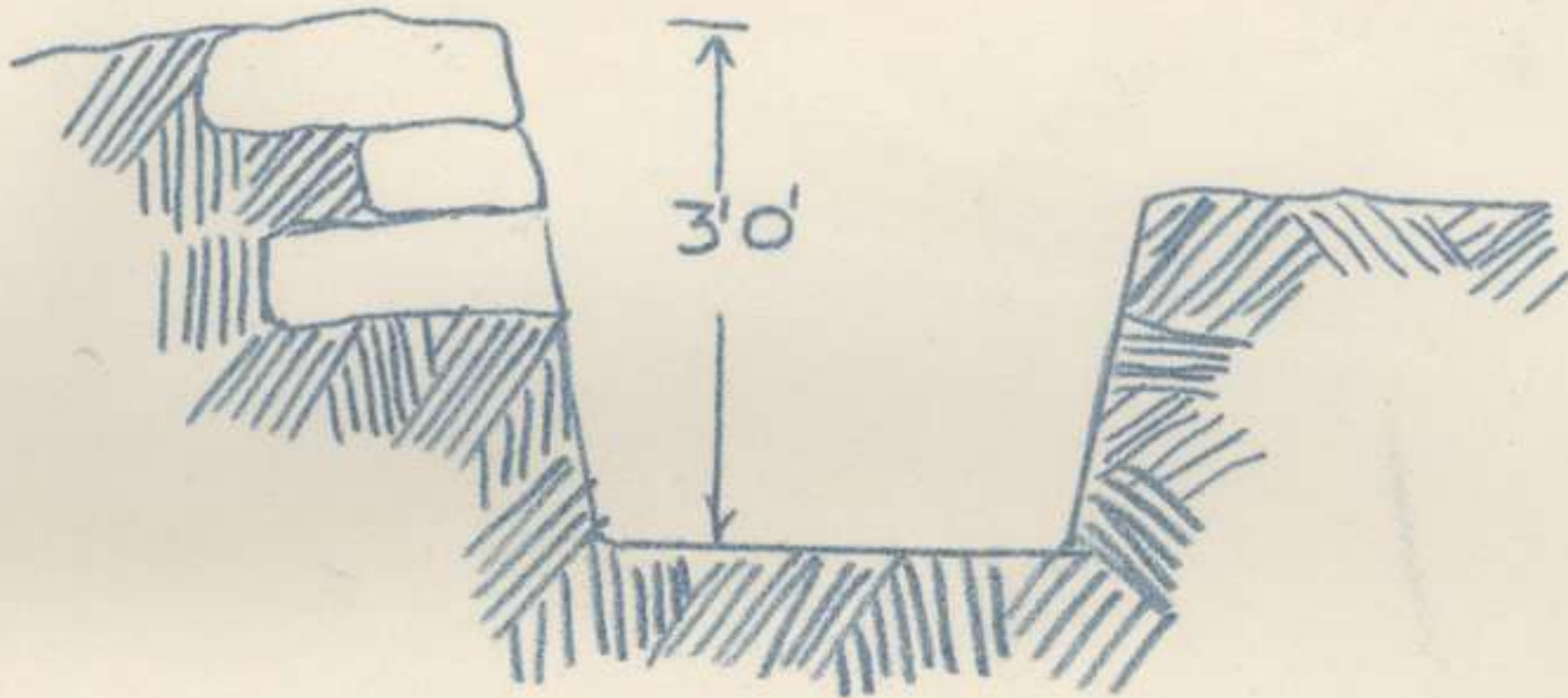

— SECTION —

SKETCH OF PICQUET  
POST





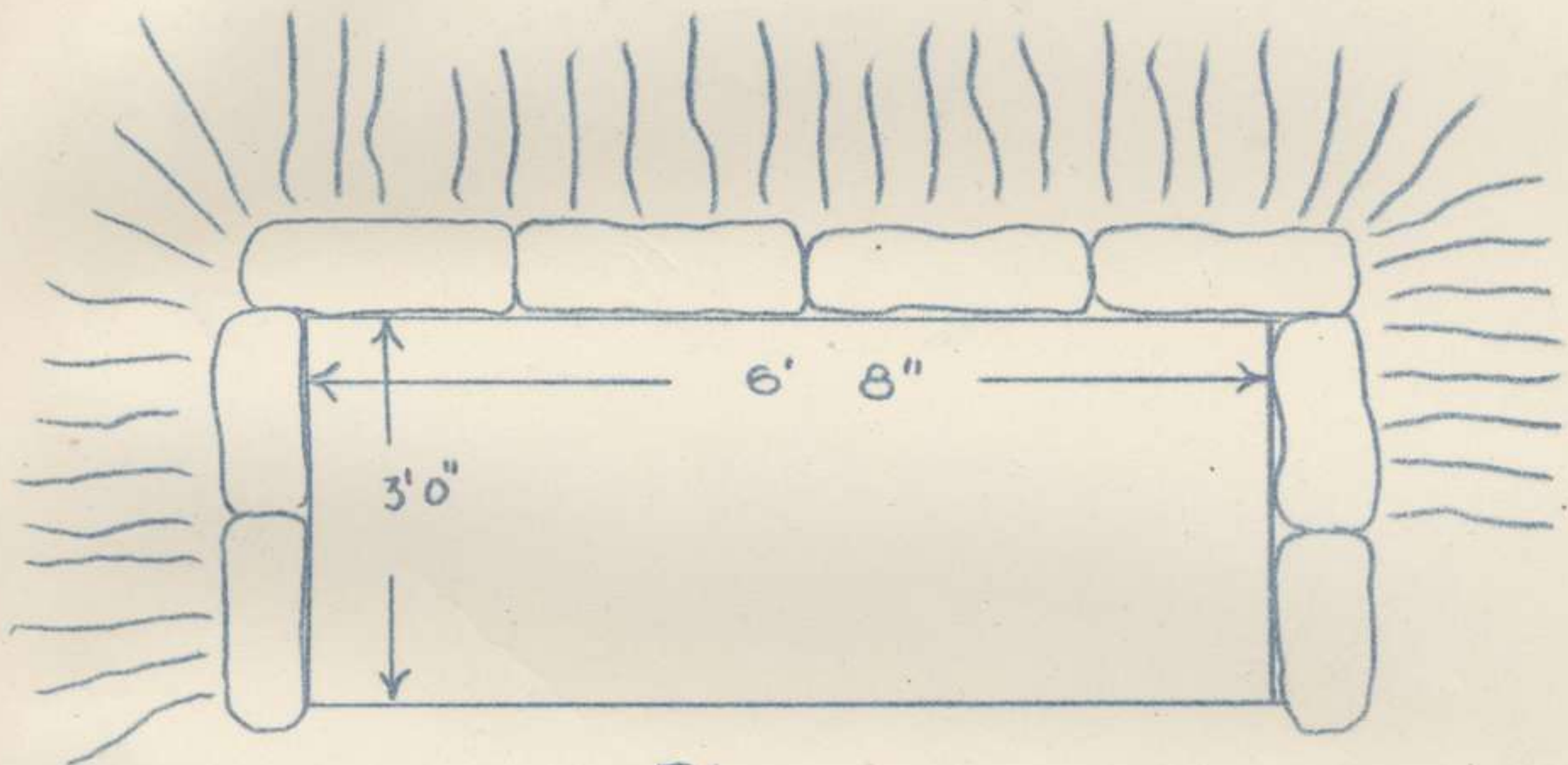

— PLAN —





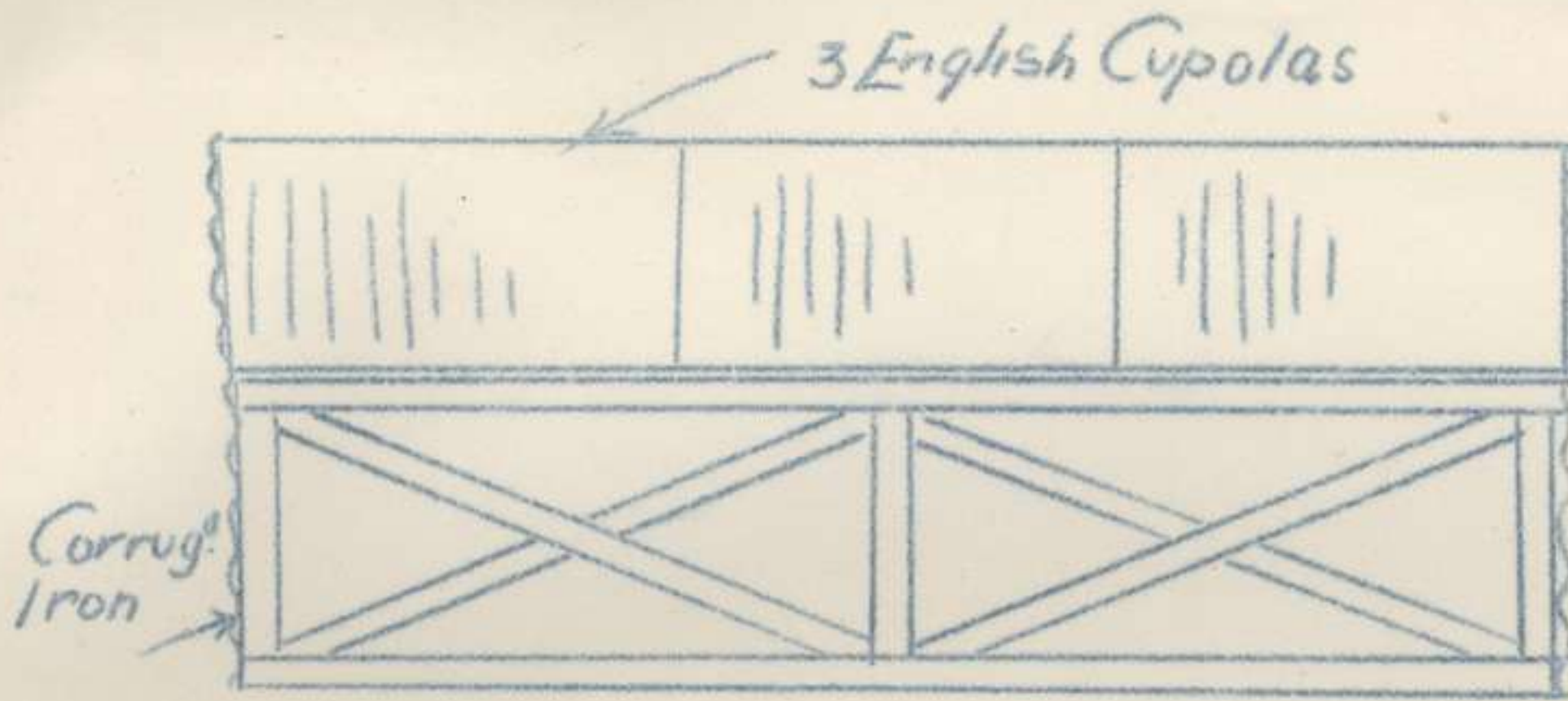

SIDE ELEVATION

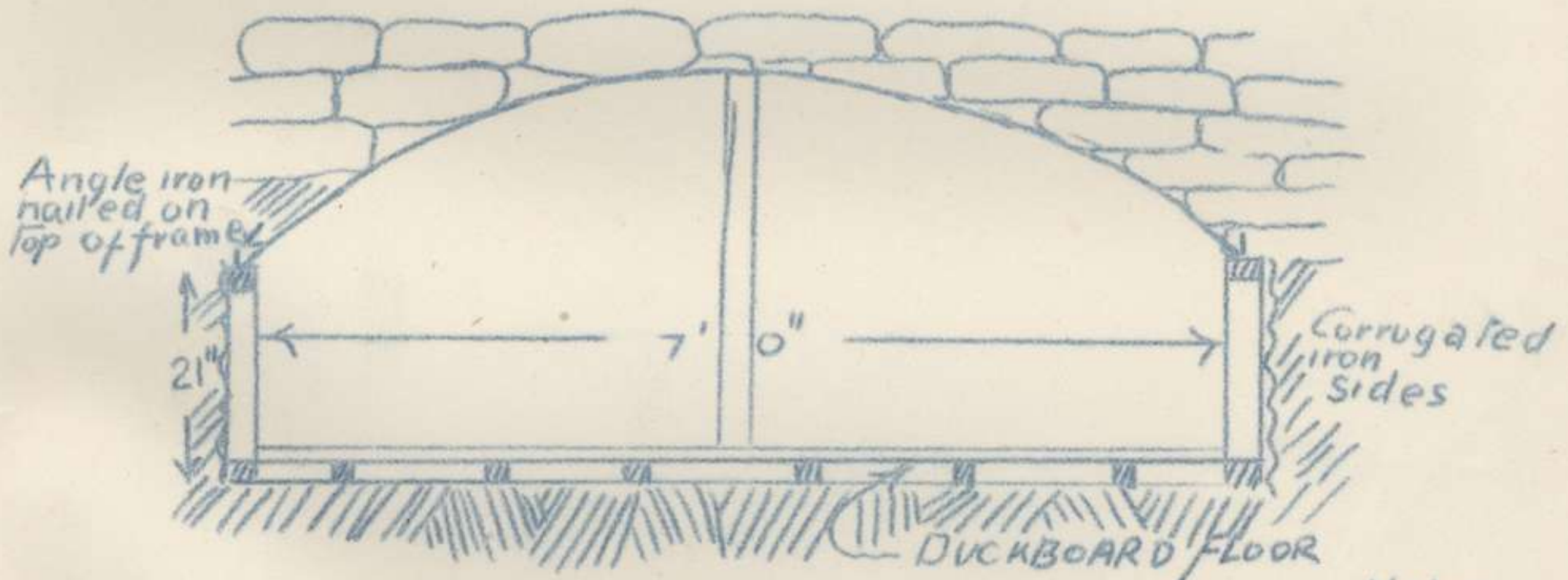

SECTION

Note: Not to scale





PI

# TYPE OF SHELTER

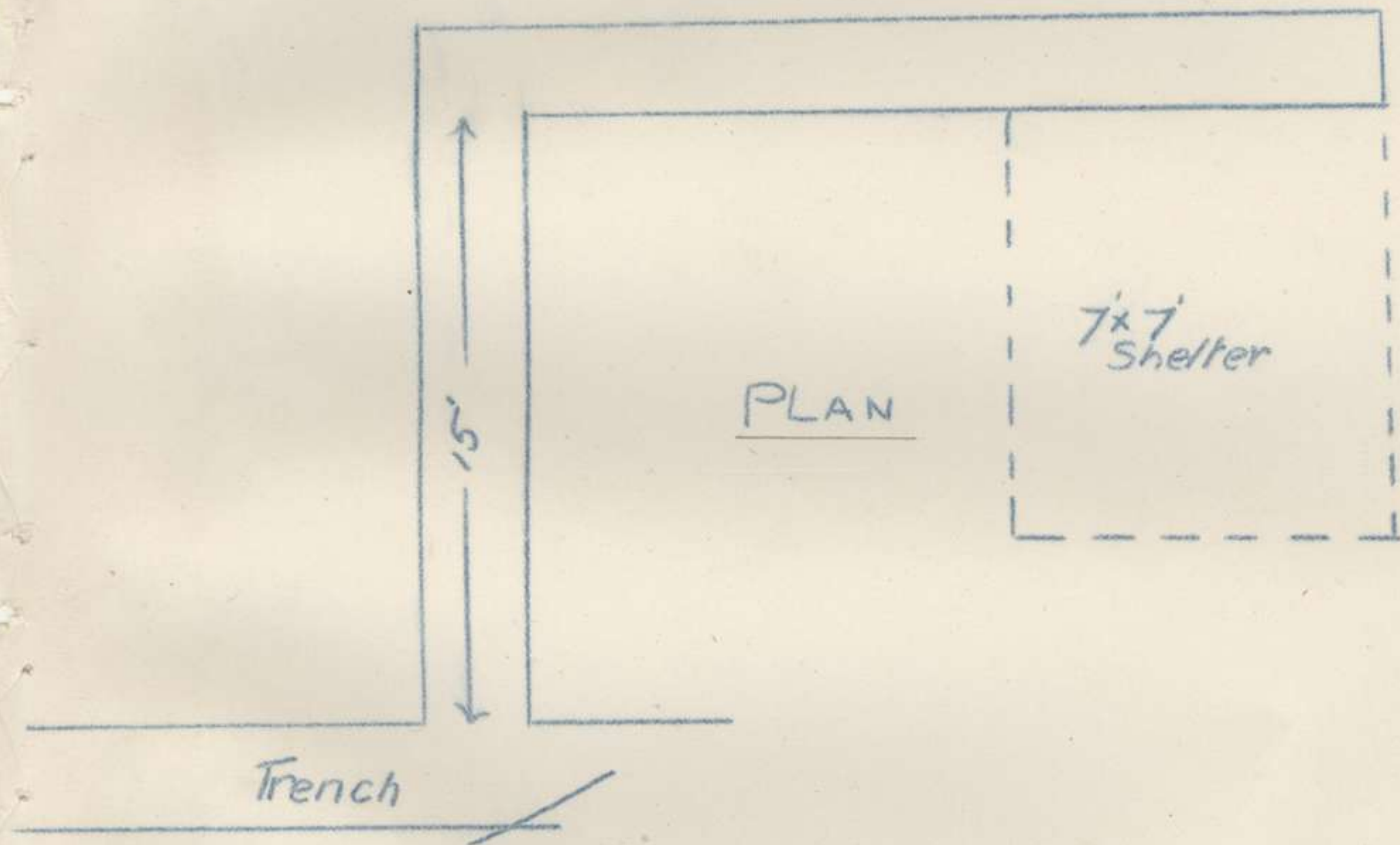



2nd Field Co. Engrs. A.I.F.

Trench Shelters.

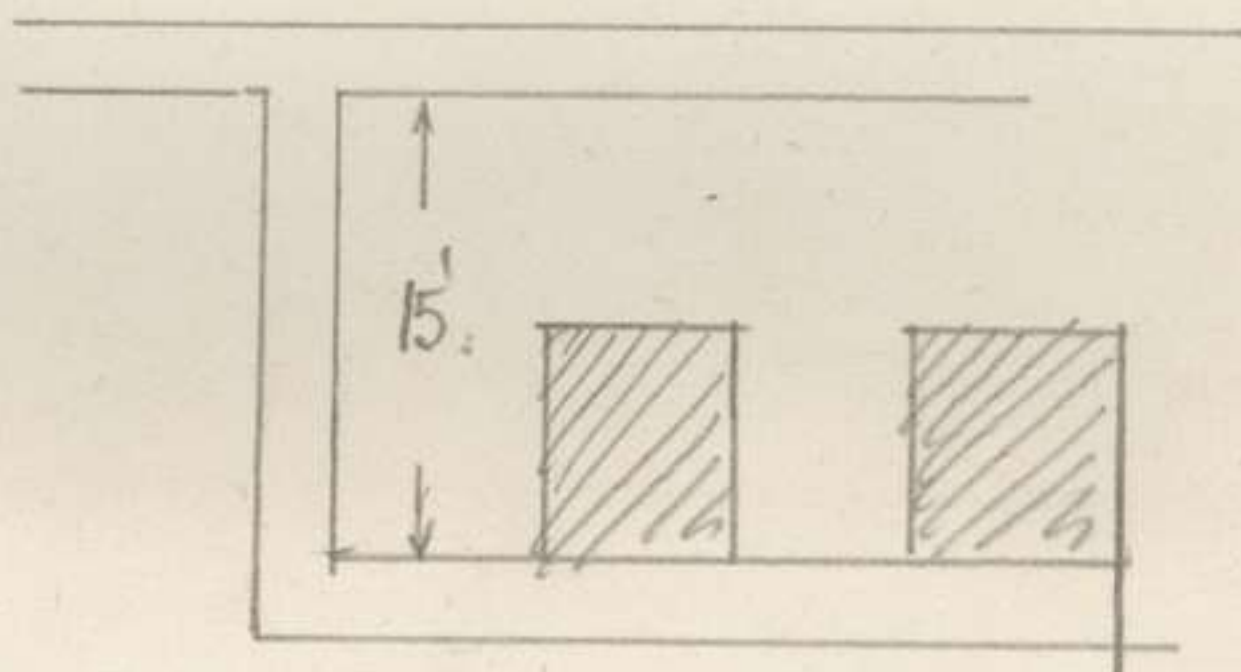
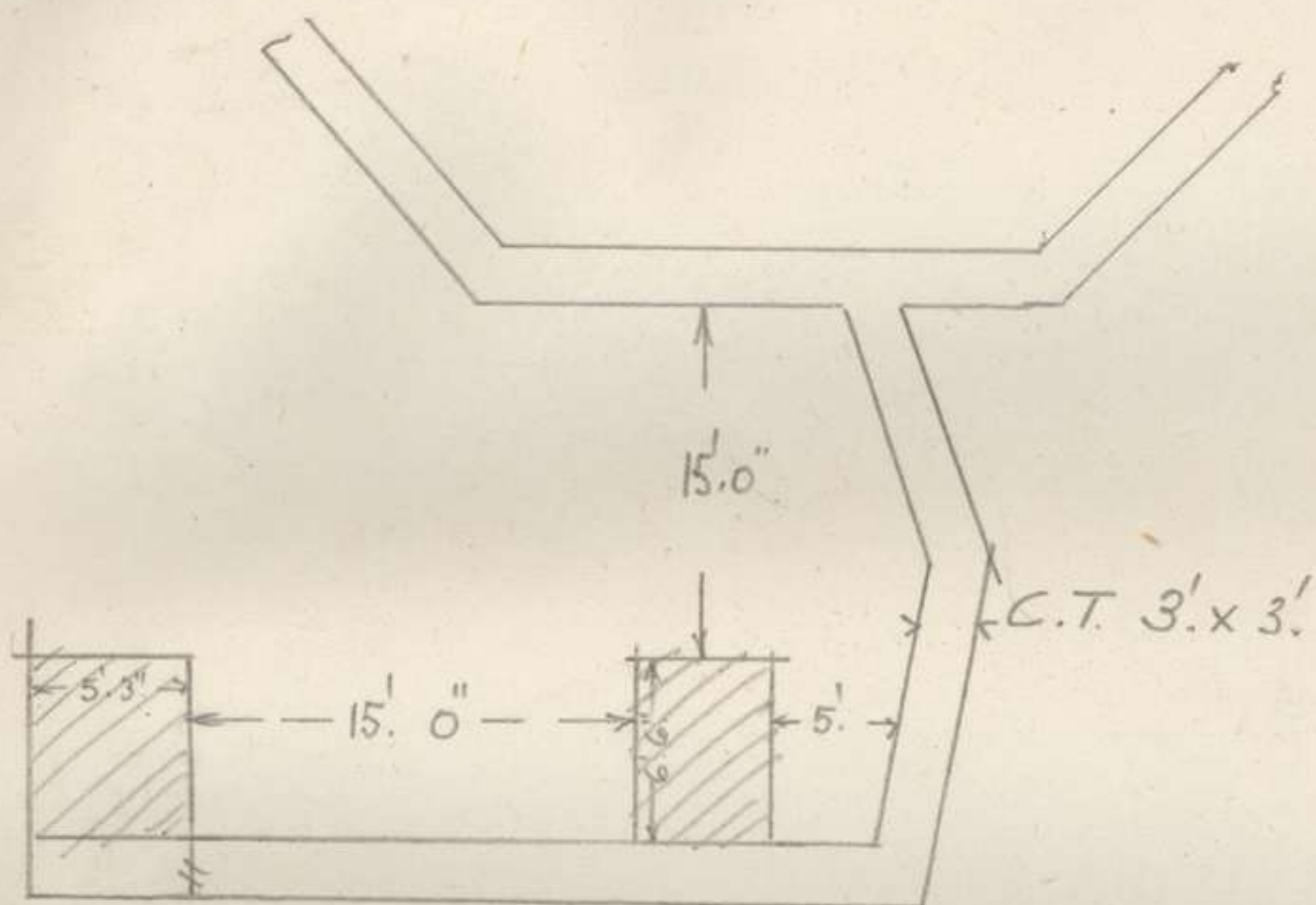

G. Brooker  
Major





ACCOMODATION TABLE.

Map No.	Ref. No.	Location	Accommodation	Remarks.
1	1	I.36a.95.50	12 men	Pill box, 3 rooms 12 bunks.
2	2	do	20 "	do 3 "
3	3	"	4 "	" damaged
4	4	O.6.b.9.5.	20 Officers & Men	Coy. H. Q.
5	5	I.36.d.3.2.	12 "	Pill box 2 rooms
6	6	"	8 "	" 1 room 4 bunks
7	7	"	"	P " Flooded
8	8	"	6 "	" Damaged
9	9	I.36.c.9.5.	6 "	" 5 bunks
10	10	"	Orderly Room	Battn. H.Q.
		"	Coy's Qrs.	
11	11	"	4 Officer	Tunnel, bunks erected
		"	70 men	
		Fusilier Way		
	12	I.36.c.9.4.	3 men	Small cupola shelters
	13	to c.9.7.	3 "	"
	14	"	3 "	"
	15	"	3 "	"
12	16	"	3 "	"
	17	"	3 "	"
	18	"	3 "	"
	19	"	8 "	"
13	20	"	6 "	"
	21	"	8 "	"
	22	I.36.c.2.7.	10 Officers & men.	Pill box, 3 rooms
	23	"		Elephant cupola shelter
	24	"		"
14	25	"	3 men	Small cupola shelter
	26	"	3 "	"
15	27	I.36.c.2.8.	8 "	Splinter proof shelter.





Accomodation table (cont)

Map No.	Ref. No.	Location	Accomodation.	Remarks.
16	31	I.36.c.2.9.	2 Officers & 10 men	Pill box, 2 chambers
29	29	0.6.a.4.4.	3 men	Splinter proof shelter
30	30	to	3 "	do
31	31	I.36.c.2.2	3 "	do
32	32	Railway	3 "	do
33	33	Trench	3 "	do
34	34	"	3 "	do
35	35	"	3 "	do
36	36	"	3 "	do
37	37	"	3 "	do
38	38	"	3 "	do
39	39	"	3 "	do
40	40	"	3 "	do
23	41	0.6 a.4.5.	M.G. H.Q.	Pill box, H.Q. Pill box 2 rooms
20	42	"	L.T.M.B. H.Q.	
43	43	0.6.a.4.4.	12 men	Dynamo - Appears to be in good order
44	44	I.36.c.2.2.	2 "	Splinter proof shelter
45	45	Railway	3 "	Small cupola shelter
46	46	Trench	1 "	Splinter proof shelter
47	47	"	3 "	Small cupola shelter
48	48	"	2 "	Splinter proof shelter
49	49	"	8 "	Large cupola shelter
26	50	I.36.c.3.0	7 "	do.
51	51	0.6.a.4.4.	Battn. H.Q.	Tunnel
52	52	I 36.c.2.2	2 men	Corr. Iron Shelter.
53	53	"	2 "	do
17	54	"	3 "	Cupola shelter
55	55	"	3 "	"
56	56	"	3 "	Cor. Iron shelter damaged
57	57	"	3 "	Small cupola shelter
				do.





Ref. Map No.	Map No.	Location	Accommodation	table (cont) Remarks
17	58	I.36.c.2.2	3 men	Small cupola Shelter
	59	"	3 "	do
21	60	"	2 "	Cor. Iron shelter
22	61	"	8 "	Pill box, S.A.A. store
	62	"	6 "	2 rooms damaged
	63	Reserve line	3 "	Trench shelter
24	64	I.36c & d	3 "	"
	65	"	3 "	"
	66	"	3 "	"
	67	"	3 "	"
	68	"	3 "	"
25	69	0.5.a.4.9.	4 men	Pill box, 3 rooms, R.A.P.
27	70	P.1.a.9.6.	Platoon H.Q.	"
28	71	I.35d.5.2	"	"
	72	"	"	"
	73	"	2 Officers	"
	74	"	20 O.R.	"
29	75	0.4.b.6.9.	"	Splinter proof shelters
	76	"	4 men	( Splinter proof cupola shelter
30	77	0.5.a.50.35	20 men	( Reserve 6" T.M. Position
	78	0.5.a.60.35	20 "	Bde. M.T.M. Pill Box 2 Chambers
31	79	J.31.c.35.90	"	Pill box. 9 double & 2 single bunks
	to	to	3 men each	Small cupola shelters.
123		0.6.b.7.6.		One for Ration dump & 1 for S.A.A.





List of Contents.

---

Front Line  
Support Line  
Reserve Line  
Bridges erected  
Mines - Bridges.  
Mines - Roads  
Trees - Mined and felled  
Tracks.





FRONT LINE

TRENCHES

This system consists of series of Platoon posts situated at approximate following locations.

Where possible they have been placed behind hedges.

WIRE.

Practically no wire entanglements.

Locationso of Posts.

K.4.c.5.6.	K.4.c.6.8.	K.4.a.5.2.	K.3.d.8.6.
K.4a.5.4.	K.4.a.4.8.	E.28.c.4.2.	K.3.d.8.8.
E.28.a.6.4.	E.28.a.4.0.	E.28.a.6.6.	E.28.a.6.8.
K.3d.4.4.	K.3.d.4.6.		

FIELD OF FIRE.

Extremely good in nearly every case.





RIGHT SECTION.

SUPPORT LINE.

The following posts are 3'6" deep including breastworks. They have no parados. Accommodation  $\frac{1}{2}$  Platoon.

E.21.c.5.4.	E.27.c.9.8.	E.21.c.6.1.	E.27.d.2.9.	E.21.d.5.3.
E.27.d.2.7.	E.27.a.9.8.	E.27.d.2.5.	E.27.a.7.6.	E.27.c.8.2.
E.27.b.2.4.	E.27.c.6.0.	E.27.b.2.1.		

E.27.b.2.0 M.G. posts for 1 gun and six men. Post 3'6" deep including breastworks. Has no parados.

WIRE E.21.d.5.2. 40 yards double apron fence exists.

LEFT SECTION.

SUPPORT LINE runs from E.21.d.6.5. to E.9.a.2.5. Strong posts at.-

E.21.d.5.8. E.21.b.3.5. E.15.c.7.5. E.9.d.2.1.  
The following have accommodation for 1 Platoon.  
E.21.a.8.7. E.15.d.4.8. E.15.b.2.5. E.15.a.8.8.

The following have accommodation for  $\frac{1}{2}$  Platoon.-  
E.15.d.5.6.

The following has accommodation for 1 $\frac{1}{2}$  Platoons. E.15.b.4.0.

The line consists of series of posts supporting each other in Echelon. In most cases full advantage has been taken of any hedges as most of the country in this sector is open. Works were camouflaged as well as could be expected by use of scattered straw. Majority of posts are well traversed and are 3'6" deep with parapet and parados of about 2'. Country will not permit of deep trenches as water is soon reached. All posts constructed have been made as comfortable and dry as possible by placing faggots and straw in bottom of trenches.





SUPPORT LINE (cont) .

Sketch of type of trench.-

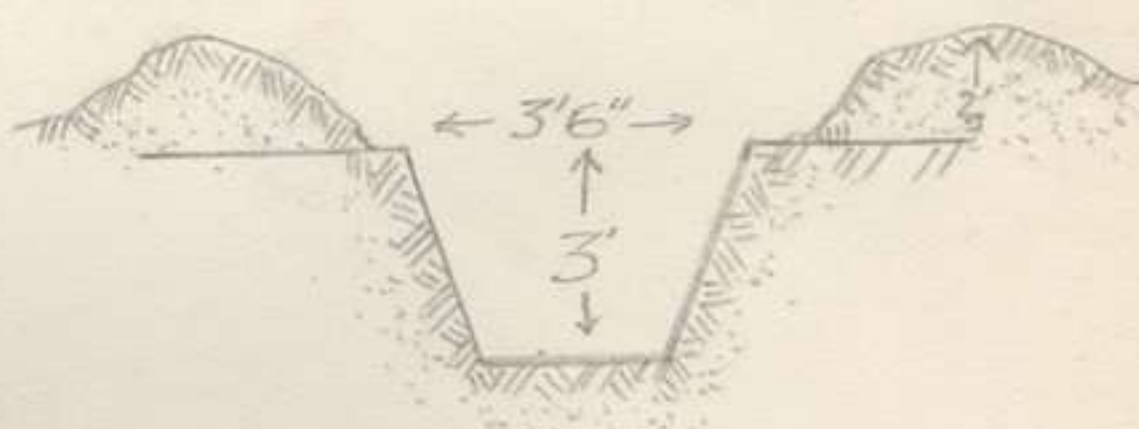

Wire. Double apron wire has been commenced from E.15.b.2.6. to E.15.b.4.7. thus.

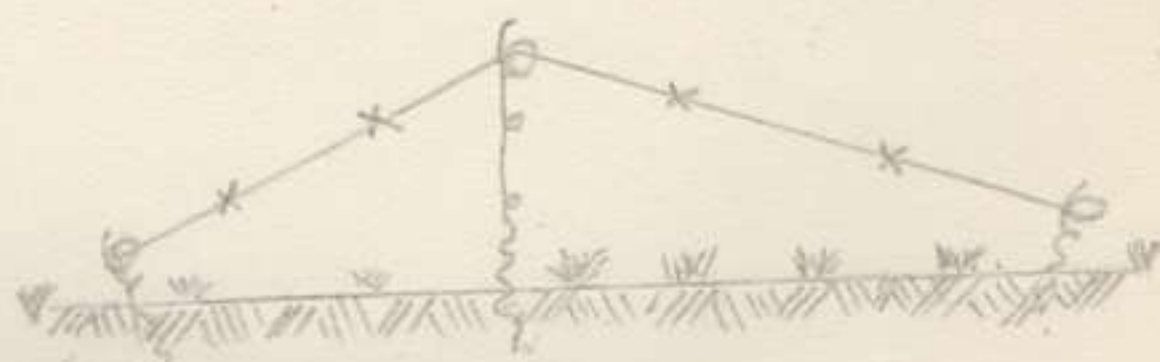

VICKERS M.G. POSITION.

2 V. M. G. positions exist at E21.a.6.6. and E.15.a.8.8.





RESERVE LINE.

This work is being carried out by the 17th Northumberland Fusiliers  
N. E. R. Battn. Pioneers.

E.8.a.2.6. to E.9.a.0.3. to E.14.a.5.1. 420 yards of trench has been  
dug.

E. 19. central to E 14c.5.9. 300 yards of trench has been dug.

D.30 b. to E.10. Central 80 yards of breastwork is 60% completed.

D. 30.b.5.2. 95 yards breastwork.

D.30.a.2.7. 100 " trench dug except for parados

D.30.d.4.3. 61 " trench dug

D.30.c.2.4 25 " semi breastwork.

D.30.c.2.6. 20 " trench dug.

D.30.a.1.1. 10 " breastwork  
30 " semi breastwork.





## BRIDGES ERECTED.

- D.24 a.7.7. Footbridge is 50% completed.
- D.24.c.6.3. Footbridge. Timber cut on one side. Decking may be obtained from Sawmill at K.19.c.1.2.
- D.18.c.6.2 Bridge to take Artillery to be erected over canal.
- K.2.a.2.2. Bridge of 42' span was constructed across Bourre Creek and will carry pack mule traffic.
- D. 24a6.0. Bridge across CANAL DE LA NIEPPE constructed. Will carry limbers. Width of wheel track 6'3". Has now been strengthened to take Artillery.





P1

## MINES - BRIDGES.

D.18.b.9.3.

This is a masonry Arch bridge and span of 12'.

Mined as per sketch.

Charges of 1 box guncotton is each hole as per sketch.

To be fired by fuse.



D.17.b.5.9.

This is a 5 girder bridge and has charge of eight slabs on each of outer girders

To be fired by fuze.



D.24a.2.1.

This is has three main girders and two outside channel beams. There is a case of guncotton in each of main girders and four slabs of guncotton on outer channel bearers.

These are to be fired by electricity.

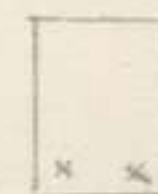

D.30.a.6.3.

Across canal. Swing bridge is pivotted on central pier of concrete. Bridge length 44'6". Width 11'. Thickness of girders 6". Charge is fixed on two main girders. about 3' from centre of bridge. Charge 6 slabs of guncotton against top and six against bottom flange of girder in each side of bridge and on each side of central pier making total charge of 48 slabs. Guncotton to be fired by time fuze 8 detonators linked in series of 4 used.

D.30.c.9.5.

Girder bridge. Two beams 18" deep with cross girders & concrete between. Bridge leads to Chateau. Charge 15 lbs. guncotton placed against centre of side girders. to be fired by time fuze. Length of bridge between abutments 16'. Width 13'6".





MINES - BRIDGES (cont)

-----

D.30.c.9.2

Bridge at Lock. Swing bridge pivoted on abutment on reight bank. Length over all 26'5". Width 5'7". Wooden decking resting on 3 girders 15" at pivot and tapering out to 8½ inches. Width of steel ½". Charge 3 slabs of guncotton placed against bottom flange of each girder and one against top one. To be fired by 6 detonators arranged in two series of three on time fize.

Lock Gates. 12' x 12'

D.30.c.9.3.

Wooden beam acting as cantilever to open gates has four slabs arranged in ½ collar around it, also two uprights supporting it. Each have two slabs. To be fired by 3 detonators arranged on one fuze.

Lock gates at far end.

The two screws which connect hinges to fastening in abutment have three slabs of guncotton arranged in between them to be fired by fuze. This gate is to be opened first.





TREES.- MINED & FALLEN.

---

D.25.a.2.9.

A scarfe has been cut in the tree and two auger holes bored and one primer placed in each hole.

D. 25.a.60.95

D.25.a.6.7.

D.19.d.4.1.

E.20.b.9.0

ditto.

E. 16.a.5.5

K.4.c.2.5.

E.10.d.9.0.

Trees have been fallen across roads to stop enemy armoured cars.





## T R A C K S.

D.21.a.7.1. to D.24.a.1.0.

Artillery track to be constructed from Bridge at D.21.a.7.1  
to road at D.24a.1.0

Fascines to be obtained at LA MOTTE station.

D.30.a.6.4. to K.2.a.2.2.

Pack Mule track cut from LA MOTTE station to Bridge.

Track could be used for limber or coookers.





Company has been disposed as follows.-

- a. 1 Section FLETRE - STRAZEELE SWITCH LINE.
- b. 1 " STRAZEELE-ROUGE CROIX SWITCH LINE.
- c. 1 " BRIDGING.
- d. 1 " HUTTING D.H.Q. St. Sylvester Cappel.





FLETRE - STRAZEELE SWITCH LINE.

This line consists of a series of posts running from W.23 d. to W.12. b. Posts and wiring are shewn on attached print. The line is to be link d up to a continuous line, protective and tactical wiring being put out in order named.

On right responsibility ceases at W. 29 b.5.8. and on left at windmill at W 12 b.5.2. where it links with another switch.line.

200 Infantry are employed nightly.

Rendezvous. Cross Roads at W 16 d.0.5. at 20.00

About 100 shovels are in existing posts.





STRAZEELE - ROUGE CROIX LINE.

The same general remarks as En Fletre-Strazeele Switch Line apply to this line.

Left of Sector W.10.a.0.0.

Right of Sector W. 29.b.4.9.

200 Infantry for work on this line. report nightly at Cross roads W. 17 c.4.0. at 8 p.m.

About 180 shovels are in posts.

The section employed on this line has also 2 Sappers employed supervising an Infantry Party wiring line running approximately from W. 9. Central to W.4 central to Q. 34 Central.

Party of 50 Infantry report nightly at Windmill W. 4 central at 8 p.m.





## LOCATIONS OF DUMPS.

W. 16. d 8.3.

Small dump a few sandbags and wire

W. 9. d. 1.6

Wire and pickets.

W. 18. b. 3.3

Wire, pickets and sandbags.





List of contents.

Disposition of Company

Support Line.

Strazeele Station Defences.

Defence of Strazeele

Borre Defences

Miscellaneous works

Schedule of Mines.

Locations - Dumps.





DISPOSITION OF COMPANY.

WORKS on which Company has been employed with distribution of Sections are as follows :-

RIGHT SUPPORT LINE	
STRAZEELE STATION DEFENCES.	
SHELL PROOF SHELTER at	1 Section.
Battn.H.Q.	
LEFT SUPPORT LINE.	1 Section.
STRAZEELE DEFENCE.	1 Section.
PREPARING ROAD MINES.	
BDE. H.Q. SHELL PROOF SHELTERS	1 Section.
R. A. P's.	
GAS DOORS.	
BORRE DEFENCES.	1 Officer.
	3 Sappers.





# SUPPORT LINE.

TRENCHES. This line consists of a continuous fire trench from X 19. b.2.9. to X.19.c.3.3. Thence to right flank at E.4.c.8.3. The Line consists of a series of posts at intervals of approximately 200 yards as shewn on print accompanying report. This line is to be linked up to a continuous fire trench as per attached instructions from C.R.E.

WIRE. This consists of a semi-continuous line of single apron. on relief belt will probably be completed except for one to two small gaps.

WORKING PARTIES have reported for this line as follows.-

<u>RIGHT SUPPORT.</u>	Rendezvous	Time	No. Battn.	
	E.4.c.3.8.	9.p.m.	2 Off.	5th Battn.
			110. O.R.	
	E.4.c.3.8	9.p.m.	1 Off.	
			40.O.R.	6th Battn
<u>LEFT SUPPORT.</u>	W.17.d.05.25	8.30	1 Off.	6th Battn.
		p.m.	40 O.R.	
	W.17.d.05.25	10.30	1 Off.	5th.Battn.
		p.m.	110 O.R.	

Line links up with Division on right, wire being continuous, across railroad, small posts existing in rails. On left a gap of 300 yards exists between trenches and METELEN BECQUE





### STRAZEELE STATION DEFENCE.

#### TRENCHES.

Divisional Boundary is along Railway line but the portion of Station Defence South of the line has been carried out by this Division.

The defences consist as shewn on plan and are a series of posts echeloned back to Support Line.

#### WIRE.

A continuous line of wire is to run round posts and link up with Support Line wire. This is complete along front but flanks require linking up.





DEFENCE OF STRAZEELE.TRENCHES.

This is to consist of a ring of Fire trenches with supporting posts in rear. Communications are to be dug to buildings and Machine Gun Positions are to be constructed in outlying houses. Gap exists from W 29 a.9.3. to W.29.a.8.3. in addition to incompleated rear portion.

WIRE.

The village is now completely encircled with a wire belt, in most cases double apron.

COMMUNICATION TRENCHES, M.G. EMBLACEMENTS & SUPPORTING POSTS.

These have not yet been commenced.

WORKING PARTIES.

These have been supplied as follows.-

Rendezvous	Time	No.	Battn.
W. 28 a.Cent.	8.30 p.m.	3 Officers 150 O.R.	6th. Battn.





BORRE DEFENCES.

These are to be the same as those of Strazeele, namely, a ring of fire trench with Supporting posts in rear, Communications trenches and M. G. Emplacements in houses.

TRENCHES

About 1,100 yards of ring trench is now complete.

WIRING.

Communication trenches and M.G. emplacements are practically untouched at present.

PROPOSED WORK.

As shewn on attached sketch.

WORKING PARTIES.

Two parties varying from 50 to 100 other ranks report daily to W.19.d0.5. at 9.am. and 1 p.m. These are supplied by Nucleus Battalion.





## MISCELLANEOUS WORKS.

ROAD MINES.

Mines are completed for firing as shewn on attached schedule.  
Mine at W.29.c.5.2. requires completion.

R.A.P's. These will be completed before relief.

GAS DOORS.

These are to be erected at locations given in attached instructions  
Doors at W.17.d 5.8 and W.22 d.9.9. are completed.

BDE. H.Q. W.25a.5.8.

Shell proof dugouts under construction.

The overhead cover of these two large English cupola Dugouts is nearly completed.

WORKING PARTIES.

These are.      4 Engrs. 14 Inf. from 9 a.m. to 4 p.m.  
                  4     7     12     "     "     6.p.m. to 11 p.m.

In addition an Infantry party of 12 O.R. report at 9 a.m. and 7 p.m.  
at W 24.b.1.2. and are used for salving rails and loading them on  
to pontoons.





SCHEDULE - MINES.

Location	Charge.	Back.	Location of Sapper to blow.	Instructions to blow given by.
E.3.d.2.7	120 lbs Sabulite. Time fuse		At house close by	C.O. 8th Batt.
W.29.a.6.6 W.23.c.4.1	240 lbs Sabulite. 2 mines. Time and Electric fuse		Building alongside Chimney W.29a5.4	do.
W 16.d.0.4	200 lbs. Sabulite.	10'	"D" Co. H. Q. 5th Battn. W.17.d38	C. O. 7th Battn.
W 17.b.5.6.	do.			
W.17.d.1.2.	do.			





LOCATIONS - DUMPS.

Location	Stock	Location	Stock.
W.24.a.9.8. White House Dump.	Wire, pickets & sandbags.	W.24.b.8.5.	Sandbags, screw pickets & wire
W.28.b.6.9.	Long & Short Wooden pickets	W.24.c.0.2.	Screw pickets, long & short wooden pickets & wire.
X.19.c.1.9.	Wire & screw pickets.	W.29.c.5.2	Cleared nightly.





HANDING OVER REPORT.

WORK SITUATED ON STRAZEELE-COURTE CROIX-FLETRE SWITCH from X.1.  
c.4.1. to X.1.c.6.4. to X.1.c.6.8. to X.1.a.9.0.

TRENCHES. Trench work is in primary condition 3' x 3' with parapet, except from X.1.c.6.8. to X.1.a.7.0. which is incomplete. Breastwork varying from 6" to 2'6" deep by 3' wide. 2 Box drains are required at points X.1.c.6.8. and X.1.a.8.0.

WIRING. Double apron is completed from X.1.c.8.1. to X.1.c.85.60 and continues along hedge to X.1.c.85.80 to X.1.d.1.8. to X.1.d.3.7. where a single apron commences at that point running along hedge to X.1.d.6.8.

There are no wiring stores on the jog except 3 mauls at X.1.d.3.8.

At X.1.c.85.60 there is a gap where a track leads to an A.A.P.

60. G.S. shovels are in trench at X.1.c.6.6.

None of the above trenching has been camouflaged and is under observation in daylight in several places.

ROAD MINES.

Shafts for road charges are complete, see table below.  
No charges have been laid.

W.3a.3.2. 1st shaft 6' deep 3' x 2' drive under road 6' long  
1 foot of water.  
2nd Shaft 5' deep. 3' x 2' drive under road 6' long.  
1'6" of water.

W.3.a.4.5.  
1st shaft 5' deep. 3' x 2' drive under road 5'6" long  
2nd. " 4'6" deep. 3' x 2' drive under road 5'6" long.

W.3.a.4.5.  
2 shafts opposite each other on side of road.  
Both are 4' deep. 1' of water in each.

W.17.a.6.8.  
1 shaft. 5'9" deep 3' of water  
2nd " 4'6" deep 2' do

450 lbs. of Sabulite for charges is dumped at W.9.b.2.9.

To

31st Division.  
B. E. F.

9th May 1918.





HANDING OVER REPORT.COURTE CROIX DEFENCES and STRAZEELE - ROUGE CROIX SWITCH.from 2nd. Field Co. Engrs. to 1st Pioneer Battn. A.I.F.COURTE CROIX DEFENCE.

TRENCHES. Trench is dug from W.18.c.7.9. to W.18.b.5.2. except for gap at road W.18.d.1.9. and small gap at W.18.b.1.8. MACHINE GUN POST at W.18.c.90.85, with connecting trench in progress. Other Machine Gun posts, as per accompanying memos not yet started.

WIRING. Double apron wiring from W.18.c.9.8. to W.18.d.4.9. except for gap at road at W.18.d.1.8.

HEDGES along W.18.c.8.9. to d.1.9. need thinning.

Sketch shewing work done is attached.

STRAZEELE - ROUGE CROIX SWITCH.

Trenches are practically completed with the exception of about 65 yards of trench situated in W.10.d.5.4. and W.10 Central

WIRING. Double apron practically completed with the exception of 50 yards in front of latter location where trench has still to be completed.

MATERIAL Sufficient wire on the job but not enough pickets.

11th May 1918.

