

AWM4
Australian Imperial Force unit war diaries,
1914-18 War

Formation Headquarters

Item number: 1/42/40 Part 10

Title: General Staff, Headquarters 1st
Australian Division

May 1918

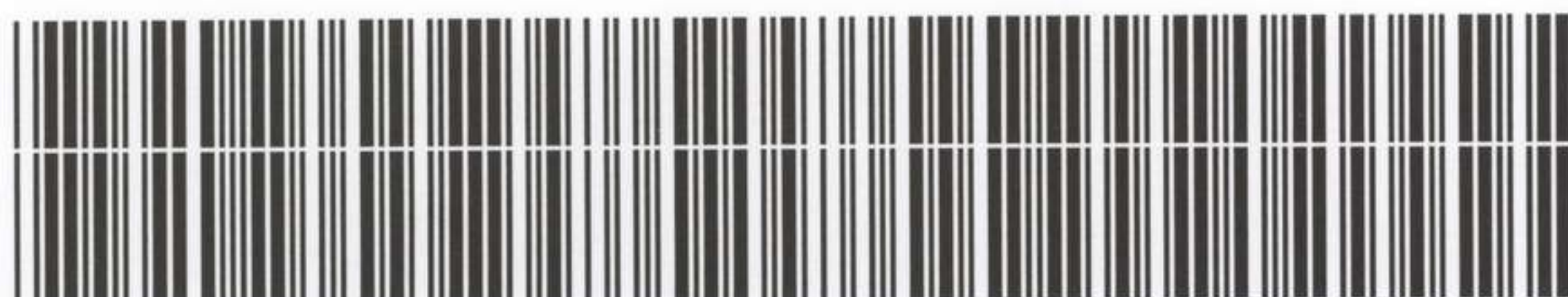

AWM4-1/42/40PART10

XV Corps No. 143/28 G,
dated 26/5/1918.

1st Australian Division.
9th Division.
29th Division.
4th Squadron, R.A.F.

1. All experience in the use of the "T" (POPHAM) Signalling Panel has proved that this apparatus provides an efficient means of communication between Infantry and Aircraft.
2. Brigade and Battalion Signallers will be carefully instructed in the use of this Panel.
3. In order to give battalions in the line practical experience of this method of signalling, arrangements have been made with 4th Squadron, R.A.F., for messages to be received by aeroplane from the Headquarters of battalions in the line in accordance with the following programme :-

Date.

Messages will be sent from
Headquarters of battalions in line to

29th May.
30th May.
31st May.
1st June.

Left Brigade, 29th Division.
Brigade, 1st Australian Division.
Right Brigade, 9th Division.
Left Brigade, 9th Division.

4. Messages sent will be such as would be sent in the case of active operations.
5. Messages will be dropped by aeroplane receiving them at Dropping Stations in the neighbourhood of Brigade Headquarters concerned.
6. O.C. 4th Squadron, R.A.F., will send an Officer to each Brigade Headquarters before the practice is carried out, to arrange all details as to time when aeroplane will come over position of the Battalion Signal Station, the Dropping Station, etc. Strips to mark Dropping Station will be provided under arrangements to be made by Divisions concerned.
7. O.C. 4th Squadron, R.A.F., will inform Divisional Headquarters concerned direct the time at which his representative will visit each Brigade Headquarters.
8. Attention is called to "Co-operation between Aircraft and Infantry," (S.S. 135, Appendix "B").
9. In the event of weather or other contingency making it impossible for the practice to be carried out on any of the above dates, O.C. 4th Squadron, R.A.F., will inform Corps Headquarters and the Division concerned. Any Brigade missing its practice in this manner will be allotted a date in the next programme.

XV Corps,
26/5/1918.

Copies to :- 31st Division.
A.D.A.S.

J. A. Albornet
for

Brigadier-General,
General Staff.

Appendix. 2A.

FIRST AUSTRALIAN DIVISION.Divisional Headquarters.
27th. May. 1918.

3rd. Aust. Inf. Bde.
1st. Div. Sig. Coy.
1st. Aust. Inf. Bde.)
2nd. Aust. Inf. Bde.) for information.)

HEADQUARTERS, 1ST AUSTRALIAN DIVISION.
No. 51/112
Date.....

Reference the attached XV Corps 143/28.G.
dated 26-5-18, the practice will be carried out on the
30th inst, under arrangements to be made by the G.O.C.
3rd. Aust. Inf. Bde. who will please forward a copy of his
instructions to Divisional Headquarters by 8.p.m. on the
29th Inst.

It is suggested that the dropping station be
established a short distance from Brigade H.Q.

The R.A.F. Officer has been asked to call at
3rd. Aust. Inf. Bde H.Q. on the 28th Inst.

Shuckian

Lieut-Colonel.
General Staff.
1st Australian Division.

G G
Ga ✓

1 G B

GT 1105

10 840



"A" Form.				Army Form C. 2121. (In pads of 100.)	
MESSAGES AND SIGNALS.				No. of Message.....	
Prefix.....	Code.....	Words.	Charge.	This message is on a/c of : Service. (Signature of "Franking Officer.")	Recd. at m.
Office of Origin and Service Instructions.		Sent			Date.....
		At m.			From.....
		To.....			By.....
		By.....			
TO {		4 th Squadron. R A F			
Sender's Number.		Day of Month.		In reply to Number.	
* 4974		27		A A A	
Reference		15 th Corps 143/289			
dated		26 th from 6 a.m.			
may the officer call at Aust.					
Bde H. 8 on the 28 th inst.					
From		1 st Aust Div			
Place					
Time					
The above may be forwarded as now corrected.				(Z)	
Censor.				Signature of Addressor or person authorised to telegraph in his name.	
				J. H. M. S. L. O. C.	
* This line should be erased if not required.					
(11160.) Wt. W 492/M1647. 65,000 Pads. 5/17. H. W. & V., Ltd. (E. 1187.)					



Appendix 28

492

AUSTRALIAN
INFANTRY BRIGADE

THIRD AUSTRALIAN INFANTRY BRIGADE

Brigade Headquarters,
28th May 1918.

51/112
29-5-18

No. 6.2789
Date

1. A practice with T (POPHAM) Signalling panel will be carried out by each Battalion on the morning of the 30th instant.
2. Messages sent will be such as would be sent during active operations.
3. The contact aeroplane will be available from 9.30 a.m. till 11.30 a.m. - a sentry will be posted by each Battalion during these hours to look out for the plane.
4. Ten transformations will be sent to the contact plane from each Battalion; these will be dropped at Brigade Headquarters on completion.
The time of receiving R.D. from the plane will be wired to Brigade Headquarters.
5. The panel will be pegged on an open piece of ground clear of buildings and trees, with the horizontal top of the "T" nearest the enemy. The Battalion semi-circle and Station code call will be placed on the ground close to the panel.

Procedure. (Reference S.S.135 Appendix B.).

On arrival of the plane the "call up" group will be exposed; when seen by the plane it will give the Station Code Call, then "G" on the Klaxon.
On receipt of each group the aeroplane sends "T" and on receipt of all messages will send "R.D.".

6. Panel, strips and ground sheet will be covered immediately a hostile aeroplane is signalled.

✓ *John Eason* Major.
Bde. Mjr. 3rd Aust. Inf. Bde.

Distribution.

File.
War Diary (3 copies).
9th Battalion.
10th Battalion.
11th Battalion.
12th Battalion.
1st Aust. Division.
O.C. No. 4 Squadron R.A.F.

Appendix 28

Appendix. 28

THIRD AUSTRALIAN INFANTRY BRIGADE

Appendix. 28

First Australian Division.

169/426
31-5-18

3RD AUSTRALIAN INFANTRY BRIGADE.
No. 42789
Date 30/5/18.

Herewith table showing the results of practice with a contact aeroplane this morning.

From the Infantry point of view everything worked very satisfactorily.

W. Bennett

30th May 1918.

Brig-General.
Commanding 3rd Aust. Inf. Brigade.

G. QP

Ga. ✓

Sz.

K.



THIRD AUSTRALIAN INFANTRY BRIGADE.

Table of Messages sent from Line Battalions to Brigade H.Qrs. by Contact 'Plane on 30.5.18.

From	To	Rec'd by plane	Dropped at	Messages.	Remarks.
ZOTA (12th Bn.)	VUNA 3rd A.I.Bde.	10.25 a.m.	10.32 a.m.	"Have gained the final objective, am moving my H.Qrs. to Q.26.c.6.9."	
ZOBA (10th Bn.)	VUNA	10.49 a.m.	10.55 a.m.	<ol style="list-style-type: none"> 1. "Have gained 1st objective" 2. "Have gained 2nd objective" 3. "Have gained 3rd objective." 4. "Have gained final objective." 5. "Am in touch with both flanks." 6. "Enemy counter-attacking." 7. "Enemy counter-attack repulsed." 8. "Have sent situation report by runner" 9. "Short of ammunition" 10. "Short of bombs." 11. "More stretcher bearers required." 	
ZODA (9th Bn.)	VUNA	11.12 a.m. (Bn. time)	11.15 a.m.	"Enemy has broken through on my right, C.27.d.3.5."	No time of receipt on observer's message.

30th May 1918.

Copies to -

9th Battalion.
 10th Battalion.
 11th Battalion.
 12th Battalion.
 1st Aust. Division.
 O.C. No. 4 Squadron R.A.F.
 War Diary (3 copies)
 File.

Major.
 Bde. Mjr. 3rd Aust. Inf. Brigade.

Appendix 28
 494

KR.

SECRET.

Appendix. 29.

Copy No. 14

PROVISIONAL DEFENCE SCHEME.

CENTRE DIVISION - XV CORPS.

CONTENTS.

Section I.	General description of front and area.
Section II.	General principles of defence.
Section III.	Action in case of attack.
Section IV.	Communications.
Section V.	Not issued.
Section VI.	Work Policy.
Section VII.	Administrative Scheme.

APPENDICES.

Appendix. I.	Action of Support Brigade.
" 2.	Action of Reserve Brigade.
" 3.	Action of Machine Guns
" 4.	Action of Artillery.
" 5.	Defence of Defended localities.
" 6.	Demolitions.
" 7.	Action during "Precautionary Stage"

MAPS.

Map A.	Divisional boundaries and defences.
Map B.	Location of Headquarters and dispositions of troops.
Map C.	Machine Gun positions and tasks.
Map D.	Artillery positions and tasks.
Map E.	Assembly positions and routes.

Distribution.

1) XV Corps.	10. "A.Q"
2) Right Division.	11. 1st Aust.M.G.Btn.
3. Left Division.	12. 1st Aust.Pioneer Bn.
4. 1st Aust.Inf.Bde.	13. 1st Aust.Div.Sig.Coy.
5. 2nd Aust.Inf.Bde.	14) War Diary.
6. 3rd Aust.Inf.Bde.	15) File.
7. C.R.A. 1st Aust.Div.	16)
8. C.R.E. 1st Aust.Div.	17)
	18)

25th May, 1918.

SECTION I.

GENERAL DESCRIPTION OF FRONT AND AREA.

1. TOPOGRAPHICAL. The Division occupies a front of approximately 5,000 yards, Square E.11.d.3.0. to the METEREN BECQUE.
 - (i) The main feature of the position is the ROUGE CROIX-STRAZEELE ridge which runs in a north east and south west direction. This ridge is well marked but the slopes are gentle. It culminates in two hills at STRAZEELE and ROUGE CROIX respectively. These are about 2,000 yards apart. The effect of this ridge is to obscure the enemy's view over that portion of the Divisional area which lies behind it except on the extreme south where it is under view from MONT de MERRIS. The northern portion of the Divisional area is in full view from METEREN. A low spur runs out from ROUGE CROIX in a south westerly direction and joins the elevation on which BORRE is situated.
 - (ii) STRAZEELE and ROUGE CROIX give two strong localities. ROUGE CROIX is in echelon to the north of the STRAZEELE position. The first objective of the enemy against the front of the Division will probably be the STRAZEELE locality. The enemy's line on the southern portion of the Divisional sector is about 1,000 yards distant from STRAZEELE. In the northern portion and directly east of STRAZEELE this distance is greatly increased as the enemy line runs north east from about MONT de MERRIS.

2. ORGANISATION OF DEFENCES.

- (i) The defence of the area is organised in two defensive zones i.e., FORWARD ZONE and SECOND ZONE.
- (ii) The FORWARD ZONE is organised in three systems of defence i.e., Firing Line System, Support System and Reserve System. In addition there are four defended localities - STRAZEELE, COURTE CROIX, ROUGE CROIX and PRADELLES. Switch lines join the localities of STRAZEELE to
 - (a) COURTE CROIX - known as the COURTE CROIX Switch.
 - (b) ROUGE CROIX - known as the ROUGE CROIX Switch.
- (iii) The SECOND ZONE is organised in the same manner as the FORWARD ZONE but the systems are known as "B" Line, "C" Line and "D" Line respectively. The defended locality of BORRE is situated between "B" and "C" Lines.
- (iv) The boundaries of the Divisional Area and a trace of the defensive works are given on Map "A".

SECTION II.1. GENERAL PRINCIPLES.

- (i) The defence is to be active. Any breach of any portion of the defences is to be promptly dealt with by counter-attack initiated by the Commander on the spot. Battalions in the line have a proportion of the garrison ready and organised for immediate counter-attack.
No post or trench is to be given up to the enemy.
(ii) The arrangements for defence are to include plans for dealing with a break through by the enemy of the flanking area of each unit and brigade. These are to be arranged in conjunction with the commanders on the flanks.
(iii) Complete mastery of NO MAN'S LAND is to be maintained.
(iv) Accommodation is to be provided in each system for its own garrison.

2. THE FORWARD ZONE.

- (i) The Firing Line System is organised as a picquet line. Its function is to hold up the enemy's attack, or, by resisting to the last, delay it so that the troops of the Support System and Reserve Companies may have time to deal with it effectively.
No picquet should be of less strength than one platoon, either in one post, or in mutually supporting posts - 60 yards is maximum distance between mutually supporting posts.
The gaps between the picquets should be strongly wired and when the whole system is to be gradually developed into a chain of connected strong points protected by wire.
(ii) The Support System is organised as a line of posts connected by a traffic trench and has a continuous belt of protective wire.
(iii) The Reserve System is a continuous fire trench and is protected by wire, which already forms an effective obstacle.
(iv) The COURTE CROIX and ROUGE CROIX Switch lines are continuous trenches protected by wire.
(v) The DEFENDED Localities of STRAZEELE, KLITE HILL*, ROUGE CROIX, COURTE CROIX and PRADELLES consist of a series of strong points and trenches dug on the perimeter of the villages, with a central keep. Protective wire has been erected around each locality.

* Under construction.

3. SECOND ZONE.

- (i) The "B" Line is well constructed, continuous, and well wired. The "C" and "D" Lines have been dug and wire has been erected. The defended locality of BORRE lies between "B" and "C" lines and is common to both.

4. ALLOTMENT OF TROOPS.

- (i) The troops available for the defence of the sector are
1 Division.
2 Army Brigades, R.F.A.
1 Special Company R.E.
(ii) Infantry. One Brigade holds the Forward Zone (less Reserve System and certain defended localities) and is disposed across the whole breadth of the Divisional front.

P.T.O.

-2-

The Divisional Pioneer Battalion, under the orders of Divisional Headquarters, supplied nucleus garrisons for selected strong points in Reserve System, COURTE CROIX switch, KLITE HILL and the defended localities of ROUGE CROIX and COURTE CROIX.

One Brigade (Support) quartered in the vicinity of the SECOND ZONE is available under the orders of Divisional Headquarters for counter-attack vide Appendix 1.

The "A" Battalion of this Brigade occupies an advanced position near the "B" Line behind ROUGE CROIX and is available for counter-attack under the orders of the G.O.C. the Brigade in line but not without reference to D.H.Q.

The Nucleus battalion of the Brigade in the line furnishes nucleus garrisons for the defended localities of PRADILLES and BORRE.

One Brigade (Reserve) is quartered in SERCUS area and is available for counter-attack vide Appendix 2, or to garrison the SECOND ZONE. As a precautionary measure, should the situation demand, this Brigade will be moved to a bivouac area in the vicinity of Le KREULE.

Locations of Headquarters and dispositions of troops are shown on Map "B".

(iii) Machine Guns. Machine Gun Companies are allotted as follows :-

- (a) 2 Companies to the FORWARD ZONE.
- (b) 1 Company to the SUPPORT BRIGADE.
- (c) 1 Company & with the Brigade in Corps Reserve.

For action in case of attack see Appendix 3, and for the distribution of guns and tasks see Map "C".

(iv) Artillery. The action of the Artillery is given in Appendix 4.

The distribution of batteries and tasks is shown on Map "D".

SECTION III.

ACTION IN CASE OF ATTACK.

1. Probable forms of attack.

When there are indications of an impending attack a precautionary stage will be initiated (vide Appendix 7)

Three forms of attack may be anticipated -

- (i) A Minor attack in the form of a raid to secure identifications or to seize a locality.
- (ii) (a) A deliberate prepared attack with Artillery bombardment.
- (b) An attack without preparatory bombardment.

2. Minor Attack.

The methods of dealing with this form of attack are well understood by all concerned.

3. General Attack.

(i) An attack of this nature, whether made with or without preparatory bombardment, will probably be made in conjunction with attacks on other parts of the Corps front. It is anticipated that the enemy will make his strongest efforts in the following directions -

- (a) Along the METEREN LECQUE with the object of turning the defences of the METEREN or STRAZEELE SPURS.
- (b) On STRAZEELE - KLITE HILL in conjunction with (a)
- (c) Along the low ground past STRAZEELE STATION in conjunction with (b) with the object of turning the defences of the STRAZEELE SPUR.

(ii) A surprise attack is possible but improbable owing to the facilities for observation which we possess.

(iii) The G.O.C. Brigade in the line is responsible that the FORWARD ZONE of the defences is maintained intact.

(iv) The method of employing the Support Brigade is given in Appendix 1.

(v) The method of employing the Reserve Brigade separately, or in conjunction with a Brigade allotted from Corps Reserves is given in Appendix 2.

(vi) The plans for the defence of defended localities are given in Appendix 5.

4. Working Parties.

(i) Working parties will always carry their arms with them.

(ii) In case of sudden attack working parties in the FORWARD ZONE will act as ordered by the G.O.C. the Brigade in line.

(iii) Officers and N.C.Os in charge of working parties in the SECOND ZONE will always have written instructions as to what to do in case of attack.

(iv) As a general principle, in default of orders, detached parties will occupy the nearest defences and will report to and act under the orders of the nearest Company battalion, or Brigade Commander in order to repel any sudden attack.

5. Action of Engineers.

- (i) Engineers working forward of the SECOND ZONE will remain with the parties whose work they are supervising, until they are formally withdrawn by orders of the C.R.E.
- (ii) Engineers working in the SECOND ZONE will withdraw to their company parade grounds and await orders of C.R.E.

6. Gas attack.

- (i) Gas shell or projector attacks are the most probable forms of gas attack.
- (ii) Appliances, such as shell cases, are to be installed for the purpose of spreading alarms. Gas sentries must be posted at all posts or billets and the most rigid gas discipline insisted on.
- (iii) Full details regarding the action to be taken in the event of a gas attack are given in "Standing Orders for Defence against Gas".
- (iv) Cellars and dug-outs unprotected by gas-proof curtains are to be evacuated during a gas-shell bombardment of the locality and will not be re-entered except on the direct order of an officer.

7. Demolitions.

Certain road junctions and bridges are to be prepared for demolition.
The responsibility for preparation and blowing charges and the responsibility for ordering this action is detailed in Appendix 8.

SECTION VI.

WORKS POLICY.

1. RESPONSIBILITY.

(i) The Division is responsible for the organisation and for the preparation of the

- (a) FORWARD ZONE.
- (b) SECOND ZONE.

(ii) The Brigade in the line is responsible for the preparation of the

- (a) Firing Line System.
- (b) Support System.
- (c) Locality of STRAZEELE.

Alterations affecting any part of the FORWARD ZONE are to be submitted for approval to D.H.Q. Work on both systems is to proceed simultaneously. The nucleus Battalion of the Brigade in the line working directly under D.H.Q. is responsible for the preparation of the defences of the locality of BORRE and PRADELLES.

(iii) The Pioneer Battalion is responsible, under the C.R.E. for the preparation of the Reserve System of the FORWARD ZONE, and for work on C.Ts and defended localities (except STRAZEELE, PRADELLES and BORRE).

(iv) Two companies of the "A" Battalion of the Support Brigade are available, under the C.R.E. for work in the FORWARD ZONE as required.

(v) The Support Brigade is responsible for the preparation of the defences of the SECOND ZONE (except BORRE). Definite sections for each system will be allotted to Battalions by the G.O.C. Support Brigade.

(vi) The C.R.E. is responsible for the distribution of Engineers and for the technical supervision of all field works. He will arrange for a complete system of liaison with brigades and battalions.

2. WORKING PARTIES.

(i) Working parties as a general rule will be detailed by platoons or companies whose officers will invariably accompany them. To avoid waste of personnel and work time it is essential that tasks are laid out on the ground before the parties arrive.

All work will be allotted as piece work.

Rendezvous must be clearly indicated to every party and arrangements made to ensure that when parties arrive they are promptly distributed to their tasks.

(ii) PROGRAMMES OF WORK. In order to ensure continuity of policy programmes of work will invariably be handed over to relieving troops. Details of hours, routes, hostile shelling should also be handed over.

(iii) Before relief Infantry Commanders are responsible for showing relieving officers over the works for which they are providing working parties.

3. ORDER OF WORK.

The order of importance of work on all systems is as follows:-

(1) Selection and construction of sites for M.G. emplacements. Many houses can be converted into strong M.G. positions.

P.T.O.

-2-

- (ii) Wiring. Tactical wiring, sited with reference to Machine Gun positions, is the most urgent and the FORWARD ZONE is to have preference.
- (iii) Provision of splinter proof cover for garrisons and M.G. detachments.
- (iv) Connecting the various posts and strong points in defensive systems and defended localities.
- (v) Construction of communication trenches from
 - (a) Reserve to Support Systems,
 - (b) Support to Firing Line Systems.

4. NOTICE BOARDS.

- (i) All strong points, M.G. positions, Works, trenches and Headquarters must be clearly marked.
- (ii) Direction and name boards are to be placed at the intersection of the routes and trenches and at the junction of trench lines.

APPENDIX 1.ACTION OF SUPPORT BRIGADE.

1. The Support Brigade (less one advanced battalion) is quartered in rear of the Second Zone. Should immediate counter-attack prove unsuccessful the Divisional Commander may order the Support Brigade to counter-attack with artillery assistance.
2. There are four probable forms of employment of the Support Brigade, i.e.,
PLAN "A". To counter-attack the left of the enemy penetration in the event of the enemy penetrating up the METELEN BECQUE in conjunction with operations against the troops on our left.
PLAN "B". To counter-attack with the object of recapturing STRAZEELE.
 (i) By day.
 (ii) At Dawn.
PLAN "C". To counter-attack with the object of recapturing the Reserve Line of the FORWARD ZONE. (It is presumed that ROUGE CROIX is still in our possession).
PLAN "D". To counter-attack with the object of recapturing STRAZEELE Railway Station and any ground lost in that vicinity (It is presumed that STRAZEELE is still in our possession).
3. As regards PLAN "A", the areas for assembly of this Counter-Attack will be the locality Square W.15.d., Square W.21.c. The line to be passed at zero hour will be the Reserve Line of the FORWARD ZONE. The centre of the attack would probably be directed on KLITE HILL.
 As regards PLAN "B",
 (i) The area for first assembly will be West of the Railway line in the locality Square V.18. and W.7. whence the move to the "B" Line (firing line System of Second Zone) would be in Artillery formation, and the attack carried out from there at zero hour.
 (ii) The assembly and advance would be carried out in the same manner as in (i), except that the troops would move to the Reserve Line in artillery formation and attack from that line at zero hour.
 In both (i) and (ii) the attack would be made with the right directed on the southern slope of the STRAZEELE eminence; the left on KLITE HILL; while the PRADELLES - STRAZEELE road would form roughly the centre of the attack.
 No troops are to actually move along the road.
4. As regards PLAN "C". - the area for first assembly, would be the same as in PLAN "B". The advance from the assembly area would be in artillery formation as far as "B" line; whence the attack would be made at zero hour.
 The right of the attack would be directed on the road junction in W.21.c.6.2. and the left on ROUGE CROIX.
 It is scarcely anticipated that this attack could be made in daylight or that the Brigade could do more than capture the Reserve line.
5. As regards PLAN "D", the brigade will assemble with its right flank in V.30.d. and its left flank in V.24.d.
 The advance would be made with the right flank directed on Le PARADIS and the left flank on the road junction in W.29.c.6.2.

P.T.O.

It is considered that two battalions in line would be sufficient on this narrow frontage, with one battalion in Support moving along the railway line and one battalion (if not already used by the G.O.C. Forward Brigade) in reserve WEST of BORRE.

6. Plans for counter-attack of the Support Brigade should provide for the probability of the "A" Battalion having already been used under the orders of the G.O.C. the brigade in the line.
7. Assembly positions for the Support Brigade and the approaches thereto are shown on Map E.
8. Although the actual programme of artillery co-operation cannot be drawn up until the exact situation is known, the C.R.A. will be prepared to co-operate at short notice.
9. The necessary reconnaissances of approach routes, assembly positions, and line of advance should be carried out by the support Brigade. Gaps should be cut in the hedges and provision made for crossing ditches, trenches &c.
10. The Support Brigade H.Q. will move to the Headquarters of the Brigade in the line in the event of Plans "A", "B", "C", or "D" being put into effect.
11. The code message for the move to any of the assembly positions will be "MOVE TO ASSEMBLY POSITION PLAN "A" (or "B" &c) Reports will be forwarded to Divisional Headquarters when the assembly is completed.

APPENDIX 2.

ACTION OF RESERVE BRIGADE.

1. The Reserve Brigade is normally quartered in the vicinity of SERCUS.
2. If indications point to the probability of a general attack a "precautionary" stage will be adopted. During the precautionary stage the Reserve Brigade will be brought up by march route to bivouac areas in the vicinity of LA KREULE. Bivouac areas and the approaches thereto are shown on Map E, they have been marked by notice and direction boards. Provided the weather is fine the route allotted to the Reserve Brigade for the march from SERCUS to LA KREULE is as follows:-

SERCUS.
V.25.a.
LES CINQ RUES.
V.19.b.
WEKE MEULIN.
V.15.d.

In the event of wet weather main roads will be used, but, as far as possible, HAZEBROUCK is to be avoided.

3. The Reserve Brigade may be required to counter-attack separately, or in conjunction with a Brigade of another Divn.
4. (i) It is anticipated that a counter-attack necessitating the employment of the Reserve Brigade of the 1st Australian Division and a Brigade of another Division will be made in the event of the enemy penetrating the Divisional front and gaining possession of STRAZELLE SPUR as far north as ROUGE CROIX.
(ii) The Reserve Brigade of the 1st Australian Division will assemble in the locality squares V.24. and V.30. The additional brigade will assemble west of the Railway Line in Squares W.7. and V.18. The assembly positions and routes leading thereto are being marked in connection with the support Brigade Scheme. Map E shows them in detail.
5. In the case of counter-attack the advance from assembly positions would be made in artillery formation to the "B" Line; whence the attack would be launched at zero hour. The inter-brigade boundary for the attack would probably be the road approximately following the grid line between W.15. and W.21. The additional brigade attacking north of the road and the brigade of the 1st Australian Division attacking south of the road. Owing to the facilities for observation from the STRAZELLE SPUR, this attack would necessarily be carried out at the Headquarters of the additional Brigade will be established at V.11.d.6.4. and of the 1st Aust.Div. Reserve Brigade at V.10.a.6.0. (which is in direct telephonic communication with D.H.Q. and V.11.d.6.4.)

P.T.O.

-2-

6. As it is impossible to foretell the number of batteries remaining in action when the counter-attack is launched, the details of artillery co-operation can be decided only at the last moment. The C.R.A. will be prepared to co-operate at short notice.
7. The Reserve Brigade may be ordered to occupy the SECOND ZONE in the event of counter-attacks having failed to restore the situation or owing to enemy penetration of ground in the territory of the Divisions on our flanks, a withdrawal has been ordered by higher authority. Brigade Headquarters in this case would be established at V.10.a.7.0.

APPENDIX 3.ORGANISATION OF MACHINE GUN DEFENCE.1. PRINCIPLES OF DEFENCE.

The defence of both the FORWARD and SECOND ZONES is effected by direct fire from guns placed from 600 to 800 yards in rear of the firing line systems. In the FORWARD ZONE certain of the guns are allotted barrage tasks to supplement the Artillery S.O.S. barrage but not more than 20% of the ammunition is to be used for that purpose.

2. SITING OF GUNS.

Guns are sited in depth and are so placed that rear guns afford continuity of support to forward guns. Guns of the two companies in the FORWARD ZONE are sited specially with a view to the defence of the STRAZERLE Ridge, the approaches to which they sweep from the flanks and in front.

3. ALLOTMENT OF COMPANIES.

- (a) Two companies are allotted to the FORWARD ZONE.
- (b) One company accommodated in the SECOND ZONE, is allotted as under:-
 - (i) 2 Sections as nucleus garrisons of the SECOND ZONE.
 - (ii) 2 Sections (less 2 guns) as a mobile reserve in the hands of the Divisional Commander. These guns will be used to check the advance of any enemy who may have penetrated into the FORWARD ZONE or to assist a counter-attack by the SUPPORT BRIGADE.
 - (iii) Two guns allotted to the defence of ROUGE CROIX. These guns would be moved to prepared positions on the order from D.H.Q. to adopt the Precautionary Stage.
- (c) One company accompanies the RESERVE BRIGADE to the SERCUS area, where intensive training is carried out. During the Precautionary Stage this company moves to bivouac area at V.17.c. and is available to assist counter-attacks or to garrison the SECOND ZONE as the occasion demands.

4. ACCOMMODATION and GUN POSITIONS.

- (a) At present gun teams are for the most part provided with weather shelter only. As material becomes available splinter proof shelter is to be provided. Alternative positions for each gun are under construction and in addition M.G. emplacements are being constructed in selected buildings.
- (b) A total of 14,000 rounds S.A.A. will be maintained at each gun, i.e., 4,000 in bolts and 10,000 rounds in bulk.

P.T.O.

-2-

(c) The following will be kept in each gun position:-

- (i) 8 gallons of water in tins.
- (ii) Range cards.
- (iii) Particulars concerning the alternative gun position and the location of neighbouring guns.

(d) Gun positions will be marked by a rectangular notice board showing the number of the gun position and its location.

5. NUMBERING of GUN POSITIONS.

Gun positions in the FORWARD ZONE are allotted numbers as follows:-

<u>Right Company.</u>		<u>Left Company.</u>	
<u>Gun Location.</u>	<u>Number.</u>	<u>Gun Location.</u>	<u>Number.</u>
E.10.a.25.25.	1.	W.23.d.28.66.	17.
E.4.c.3.2.	2.	W.23.d.40.90.	18.
E.4.a.10.55.	4.	W.24.c.60.15.	19.
E.4.a.25.00.	3.	W.24.d.25.25.	20.
W.27.c.30.25.	5.	X.19.c.42.46.	21.
W.27.c.30.40.	6.	X.19.a.30.25.	22.
W.27.a.75.20.	7.	X.19.a.70.44.	23.
W.27.a.80.40.	8.	X.13.d.05.05.	24.
E.4.b.6.2.	9.	W.17.d.85.30.	25.
E.4.b.9.5.	10.	W.18.c.23.40.	26.
W.28.o.25.35.	11.	W.18.d.75.95.	27.
W.28.c.55.65.	12.	W.18.b.35.35.	28.
W.28.d.55.70.	13.	W.18.b.30.50.	29.
W.29.c.15.55.	14.	W.17.a.40.60.	30.
W.29.d.35.95.	15.	W.17.a.35.95.	31.
W.29.b.55.55.	16.	W.11.c.35.23.	32.

The following are the gun positions in the SECOND ZONE for which no numbers have so far been allotted:-

W.14.a.80.15.	E.2.a.30.25.
W.9.c.50.20.	V.30.d.30.15.
W.9.c.50.40.	W.20.c.50.50.
W.8.c.50.40.	W.20.a.70.00.

6. In order to avoid undue losses as a result of hostile bombardment, (particularly gas) not more than three men at a time are to be in the gun positions. The remainder of the detachment is to be sheltered in the vicinity and will be available to supply reliefs.

APPENDIX 4.ACTION OF ARTILLERY.1. GENERAL PRINCIPLES.

- (a) The Field Artillery defence of the Divisional Front is organised on normal lines.
- (b) An S.O.S. line is registered and in case of attack brigades open fire within their respective zones.
- (c) In the event of heavy hostile bombardment or if attack is believed to be imminent Counter preparation will be ordered. Brigades operate within their respective zones.
- (d) Vigorous Harassing fire is carried out against enemy Communications and known centres of activity.
- (e) The heavy Artillery is allotted by Corps to S.O.S. and Counter battery tasks.

2. FIELD ARTILLERY DISPOSITIONS.

- (a) Two brigades of A.F.A. and two Army brigades R.F.A. are available to cover the front.
- (b) Positions have been selected to cover successively.
 - I. the front line,
 - II. the Reserve System FORWARD ZONE, and
 - III. the 'B' line, SECOND ZONE.
- (c) Six 6" Newton Mortars are in position covering the Front line and Six are in positions covering the Reserve System, FORWARD ZONE.
- (d) Field Artillery brigades act independently within their allotted zones but fire may be switched from one zone to another; either by direct order from D.A. Headquarters, or through the Artillery liaison officer at Infantry Brigade Headquarters.

3. S.O.S. ACTION.(a) FIELD ARTILLERY.

- I. When called for by S.O.S. Signal or message batteries will open on S.O.S. lines.
- II. At zero plus 3 minutes all 18-pdrs and 4.5. Hows lift plus 200 yards.
At zero plus 6 minutes guns and hows drop back to their starting line.
This procedure will be continued at 3 minutes intervals.
- III. Every effort will be made to localise the hostile attack so that if considered necessary fire may be switched from one Brigade zone to another.
- IV. Definite objectives must be given for lifts and switches.
- V. Rates of fire for S.O.S. will be -

18-pdrs - First	3 minutes	- 5 rds per gun per minute.
Next	5 "	- 4 " " " " " "
"	10 "	- 3 " " " " " "
"	5 "	- 4 " " " " " "

 Thereafter 2 rounds per gun per minute in accordance with the situation.
4.5. Hows - Half above rates.
- VI. To economise Ammunition and to avoid unnecessary casualties the front line Infantry should report when the situation no longer requires artillery S.O.S. action.

(b) HEAVY ARTILLERY

- I. The brigades at present covering the divisional front are -
 - 64th Brigade (part)
 - 45th Brigade
 - 13th Brigade
 - 12th Brigade (part)

(2)

II. Zones are allotted by the CORPS and alter from time to time in accordance with the varying strength of the Heavy artillery.

III. S.O.S. fire will be laid down in the form of a continuous barrage 750 yards from our front line. Special targets are allotted to guns and heavier types of Howitzers.

4. COUNTER PREPARATION.

- (a) Counter preparation will normally be ordered by CORPS or Divisional Headquarters. Brigade Commanders may however on their own initiative, carry out counter preparation in reply to a heavy hostile bombardment.
- (b) In counter preparation shoots a percentage of gas will be employed if the conditions are favourable but not without reference to Divisional Headquarters.
- (c) Within their allotted zones artillery will fire bursts on all places where the enemy may be expected to concentrate for attack.
- (d) Counter Preparation Schemes for field artillery will be prepared under the direction of the C.R.A. The G.O.C. R.A. Corps controls the action of the Heavy Artillery.

5. ANTI-TANK DEFENCE.

- (a) Four 15 pdr guns occupy forward positions for direct fire action against hostile tanks.

The positions at present occupied are as follows:-

E.4.D.00.80.
X.19.C.20.50.
W.23.B.30.20.
E.5.A.15.75.

- (b) Except in case of emergency, guns allotted to anti-tank tasks will not engage other targets.

RELIEFS OF PERSONNEL &C.

- (a) The number of men present at the guns is to be maintained at a minimum.
- (b) Personnel not at the guns should be organised as reliefs.
- (c) To avoid casualties, splinter and gas proof shelters are to be constructed for the personnel not actual working the guns.

ROUGE CROIX. Defended Locality

Div T.S. N° 20 Copy N° **SECRET**



APPENDIX 5.B

DEFENCE OF PRADELLES (.W.21.)

1. Object. A strong point has been established at PRADELLES, whose object is to deny a hostile advance, to form a pivot for our troops if required.
2. The village, sited on the reverse slope of the STRAZEELE ROUGE CROIX ridge, is distant some 2,000 yards from both these points and is overlooked by practically the whole of that ridge. It is virtually in the Reserve Line, Forward Zone.
3. Works have been constructed to meet attack from
 - (a) STRAZEELE village, along the STRAZEELE-PRADELLES Road.
 - (b) The S.E. if an enemy advance breaks our line in the vicinity of the MONT de MERRIS, and an advance takes place astride the railway.
 - (c) The N.E. from the STRAZEELE- ROUGE CROIX ridge.
 These works are shown on attached plan.
4. The Garrison allotted to PRADELLES Strong point consists of not less than 200 O.Rs of the nucleus battalion, of the Line Brigade. O.C. Nucleus Battalion of this Brigade will detail such numbers of the Nucleus Battalion as are required to make up 200 O.Rs from men at his disposal irrespective of the Battalion to which men may belong. A proportion of men trained as Lewis Gunners, Bombers, Rifle Grenadiers, and Signallers will be included.
 A skeleton garrison of 2 Officers and 40 O.Rs will be maintained at all times in this strong point. Improvements and repairs will be carried out by this skeleton garrison, supplemented by working parties from the Nucleus Battalion.
 skeleton The garrison will be relieved periodically by parties of men actually detailed as fighting garrison, thus ensuring that all are conversant with the locality and its works.
5. Command of this strong point is vested in the G.O.C. Line Brigade. Local command will be exercised by the Second senior officer of the Nucleus Battalion. His command post will be at W.21.a.1.1.
6. Preliminary arrangements. (a) All officers and at least 4 N.C.Os per company detailed to PRADELLES S.P. will reconnoitre the routes from bivouac to trenches and will make themselves acquainted with the trenches they are to occupy when ordered.
 (b) 300 rounds S.A.A. per rifle, 10 No. 23 bombs per man and 15 No. 36 Rifle Bombs per Cup, Discharger will be maintained in the trenches, in addition to 8,000 rounds per Lewis Gun.
 (c) Sufficient S.A.A. to fill each man up to 200 rounds and No. 23 bombs to issue two per man will be maintained at Nucleus Battalion Headquarters.
 (d) Two Lucas Lamps, for communication between Brigade Headquarters, and BORRE respectively. Line Brigade will allot the necessary Lamps.

P.T.O.

(c) Four Lewis guns and teams will be ready to move from A.A. Defence "D" Battalion Headquarters to PRADELLES Defences on receipt of precautionary stage order.

(f) A.D.M.S. will allot a Medical Officer, who will in consultation with O.C. PRADELLES Defences arrange a R.A.P. and stretcher bearers.

7. (a) On receipt of the order "Adopt Precautionary Stage" the garrison will complete up to 200 rounds S.A.A. and 2 Mills Bombs from stocks at Nuclous Battalion Headquarters. In addition 1 days Iron rations will be carried. 200 gallons of water and 200 M & V and biscuits rations will be drawn and stored where most likely to escape hostile shelling. This garrison will proceed to man their trenches in the PRADELLES Defences.
(b) 4 Lewis Guns will pass from "D" Battalion Headquarters to PRADELLES Defences (See 6 (c))
(c) Signal communication will be opened with Brigade Headquarters by Lucas Lamp.
(d) A regimental Aid Post will be established and stretcher bearers allotted. M.O. in 6 (f) will take charge of this.
(e) When all troops are in position, inform G.O.C. Line Brigade to that effect.
(f) Straggler Posts will be established.

8. Action. When the direction of attack is clearly indicated dispositions will be amended suitably. Until this is the case one company should occupy the trenches M and one S of the road with patrols towards the col between STRAZELLE and ROUGE CROIX, towards STRAZELLE and towards the railway about E.3.d. Liaise patrols should link the Reserve Line to PRADELLES Defences. Without written orders from the G.O.C. Line Brigade no withdrawal from PRADELLES Defences is to take place. It may be anticipated that the garrison will be augmented by stragglers, and, if our front and support lines are bent back, by units from those lines.

(Issued with Appendix 5A)

Scale 5000.

SECRET

Div. T. S. No 15

Сору № 124

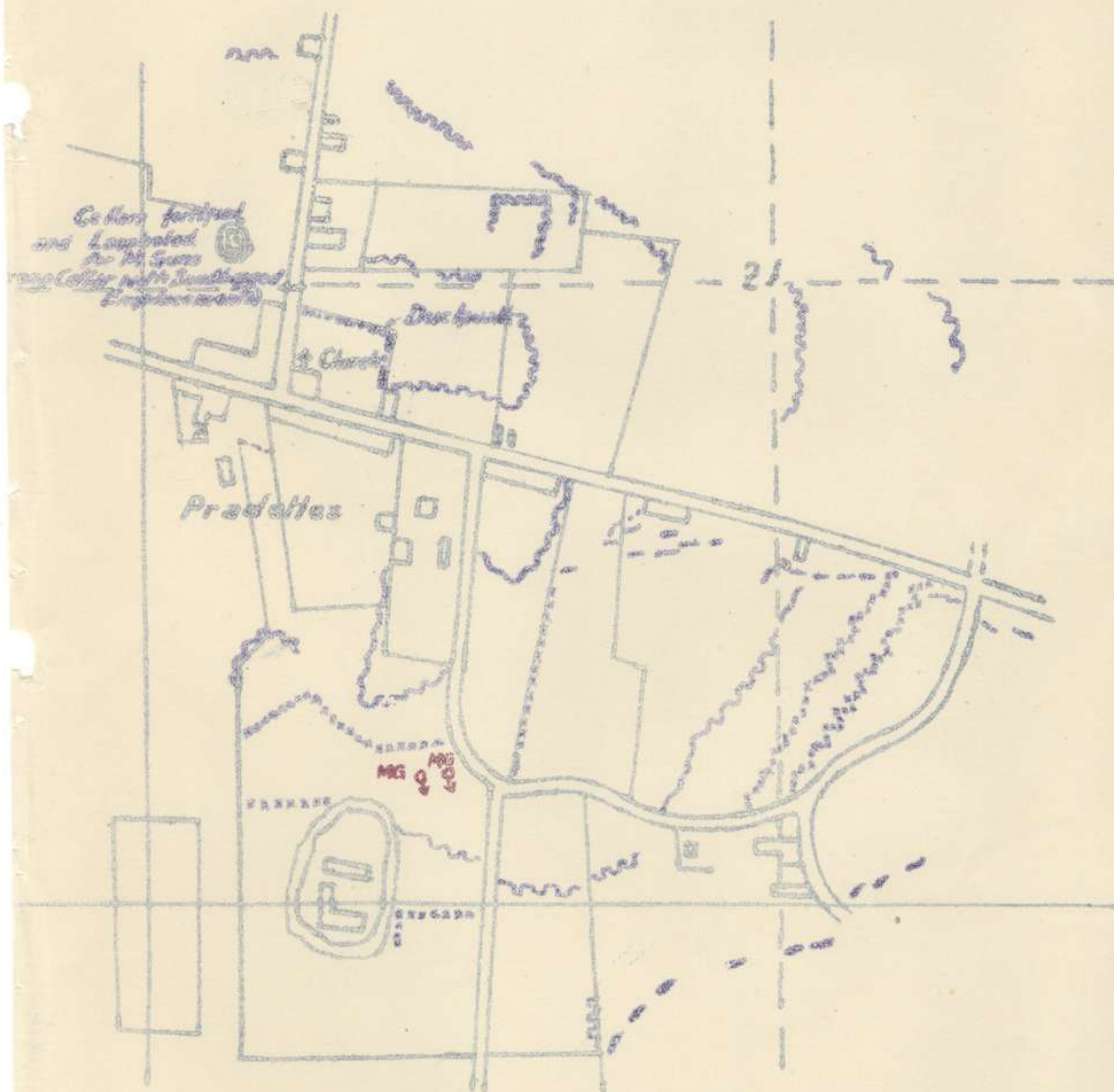

APPENDIX 5 C.

DEFENCE OF BORRE (W.19.)

1. Object. A strong point has been established at BORRE, whose object is to deny a hostile advance, and to form a pivot and delaying point.
2. The village covers the approach to HAZEBROUCK, by the STRAZEELE, PRADELLES Road. It is sited on a slight eminence which falls away to the S. and S.E. and overlooks a large area, as far as the Railway. On the N. the ground is flat and covered with crops. The Forward Zone and "B" line of the Second Zone cover the village.
3. Works have been constructed to deny approach from any direction. They are especially strong to meet an attack from the S. and S.E. The System STRAZEELE PRADELLES, BORRE should delay any attack in order to permit a Counter-attack to be organised and carried out.
Earth works and wire are shown in attached plan.
4. The fighting garrison for BORRE defences will be supplied by the nucleus Battalion of the Support Brigade. O.C.Nucleus Battalion will detail 400 men, with the requisite number of officers, bombers, Rifle Grenadiers and Signallers, as garrison of BORRE defences.
A skeleton garrison of 2 officers and 40 O.Rs will be maintained at all times by the nucleus Battalion of the line Brigade in this strong point. Improvements and repairs will be carried out by this skeleton garrison, supplemented by working parties from the Nucleus Battalion. This garrison will not be detailed as portion of the first garrison of PRADELLES; but, after relief by the fighting garrison of BORRE, the skeleton garrison will be at the disposal of the O.C. PRADELLES Defences.
5. Command. O.C. Nucleus Battalion Support Brigade will command BORRE Defences.
Command post will be at BRASSERIE (W.19.c.8.8.)
6. Preliminary arrangements - (a) All officers and at least 4 N.C.Os per company detailed to BORRE defences will reconnoitre the routes from bivouac to trenches and will make themselves acquainted with the trenches and surroundings.
(b) 300 rounds S.A.A. per man, 15 No. 36 Rifle Bombs per Cup Discharger, 10 No. 23 Bombs per man and 5,000 rounds S.A.A. per Lewis Gun will be maintained in the trenches.
(c) Sufficient S.A.A. to fill each man up to 200 rounds and No. 23 Bombs to issue 2 per man will be maintained under support Brigade Headquarters.
(d) Two Lucas Lamps, for communication between BORRE and PRADELLES and BORRE and Headquarters of Second Zone defences. Support Brigade will allot the necessary lamps.
(e) Four Lewis Guns and teams will be ready to move from A.A. Defence, "D" Battalion of Support Brigade to BORRE Defences on receipt of precautionary stage order.

P.T.O.

-2-

(f) A.D.M.S. will allot a Medical officer, who in consultation with O.C. BORRE Defences, will arrange a R.A.P. and Stretcher Bearers.

- 7.(a) On receipt of the order "Adopt Precautionary Stage" the garrison will complete up to 200 rounds S.A.A. and 2 Mills Bombs from stocks at Support Brigade Headquarters. In addition 1 days Iron Rations will be carried. This garrison will proceed to man the BORRE Defences.
- (b) 4 A.A. Lewis Guns will pass from "D" Battalion, Support Brigade to BORRE Defences (See para. 6.c)
- (c) Signal communication will be opened with Headquarters, Second Zone Defences.
- (d) A Regimental Aid Post will be established and stretcher bearers allotted. M.O. in 6 b will take charge of this.
- (e) When all troops are in position, inform Headquarters, Second Zone Defences.
- (f) Straggler posts will be established.

8. Action. When the direction of attack is clearly indicated dispositions will be amended suitably. Until the direction of attack is clear two companies of the Nucleus Battalion will occupy the trenches N. of the PRADELLES - HAZEBROUCK Road, and two the trenches S. of that road. Liaison patrols will maintain touch with PRADELLES garrison and the troops occupying the "B" Line, Second Zone Defences. Without written orders from the O.C. Second Zone Defences, no withdrawal from BORRE Defences is to take place.

DEFENDED LOCALITYBORRE

Scale 10.600

Issued with Appendix 5C.

SECRET

Div T.S. N° 14

Copy N° 14

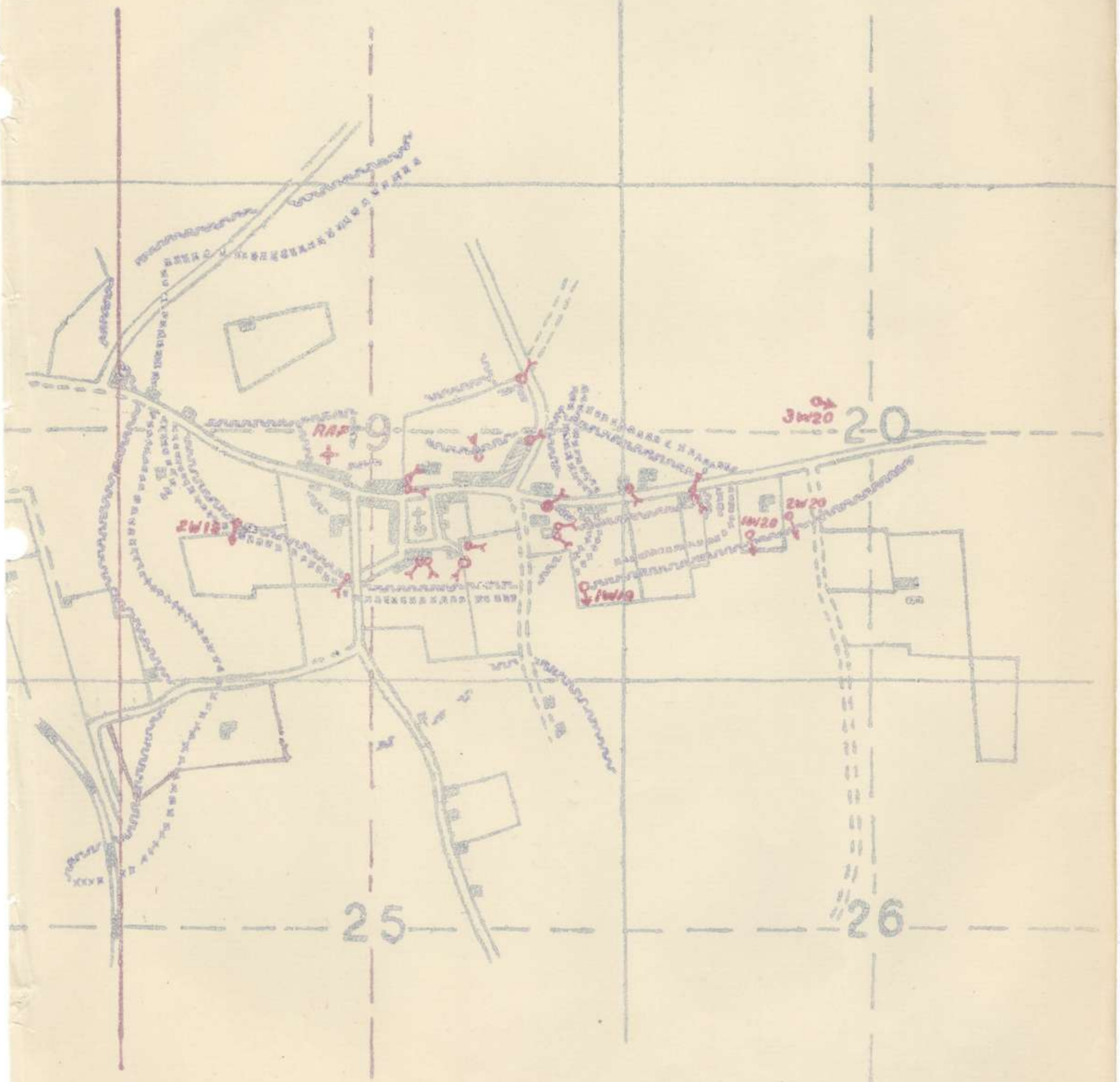
Vickers MG 
Lewis MG 

APPENDIX 5 (d).

DEFENCE OF ROUGE CROIX. (W.10)
(W.16)

1. Object. The defended locality of ROUGE CROIX forms the northern eminence of the STRAZEELE - ROUGE CROIX ridge. This ridge screens a large portion of the Divisional area from enemy observation and permits unobserved movement by our Reserve Troops. The defended locality forms a strong point, which with FLETRE, supports the Reserve Line. In addition ~~xx~~ it flanks a hostile advance by the METEREN BECQUE and directly opposes an advance from STRAZEELE.
2. Works have been constructed to provide for all round defence.
3. The Garrison allotted to ROUGE CROIX consists of a skeleton force of Pioneers (2 platoons) up to the Precautionary Stage after which it is increased by 1 Company of "A" Battalion of the Support Brigade with its six Lewis Guns and 2 machine guns of the 1st M.G. Battalion.
4. Command of ROUGE CROIX defences will pass to the Commander of the Company detailed by "A" Support Battalion when the Precautionary Stage is adopted. His command post will be at *
5. Preliminary arrangements (a) All officers and at least 4 N.C.Os of the company detailed in para. 3 will reconnoitre the routes from assembly position to trenches, and will make themselves acquainted with the trenches they are to occupy when ordered.
(b) 300 rounds S.A.A. per rifle, 10 No. 23 Bombs per man, and 15 No. 36 Rifle Bombs, per Cup, Discharger, will be maintained in the trenches in addition to 5,000 rounds per Lewis Gun (= 30,000 rounds). O.C. 1st Pioneer Battalion will arrange this for the complete garrison
(c) Sufficient S.A.A. to fill each man up to 200 rounds and No. 23 Bombs to issue 2 per man will be maintained with "A" Battalion, Support Brigade ready to issue to the detailed company. An issue on the same scale will be made to the 2 Pioneer platoons forming the skeleton garrison, forthwith, under orders of O.C. 1st Pioneer Battalion.
6. (a) On receipt of the order "Adopt Precautionary Stage" the Company detailed by "A" Battalion Support Brigade will complete up to scale in para. 5 (c) above and will carry 1 day's Iron rations. They will then proceed to man their trenches in the ROUGE CROIX defences. Command will pass to O.C. Company of "A" Battalion, Support Brigade.
(b) Communication will be opened with "A" Battalion Support Brgde. Headquarters at W.8.c.7.9.
(c) Straggler Posts will be established.
(d) When all troops are in position, inform "A" Battn. SUPPORT BDE. H.Q. who will pass the information to D.H.Q.
7. Action. When the direction of attack is clearly indicated dispositions will be amended suitably. Until this is the case, the garrison should occupy the trenches to the N.E. and E. of ROUGE CROIX.

P.T.O.

-2-

Liaison patrols should work to FLETRE and to the col between ROUGE CROIX and STEFAZEELE.

Without writton orders from the Officer Commanding the Second Zone no withdrawal from the ROUGE CROIX defences is to take place.

* To be selected and prepared forthwith. D.H.Q. to be notified.

APPENDIX 5 E.

ALLOTMENT OF NUCLEUS GARRISONS.

1. GENERAL PRINCIPLES.

(a) The Brigade in the line will provide the fighting garrisons for the Firing line and Support Systems of the FORWARD ZONE and for the defended locality of STRAZEELE.

(b) Nucleus garrisons will be found from sources outside of the Brigade in the line for such of the defences as are considered likely to become involved in the fighting at an early stage of the enemy's attack.

(c) Nucleus garrisons will on no account advance from their allotted positions for the purpose of counter-attack. Commanders of nucleus garrisons will take under their command any stragglers or troops driven out of positions further forward and will defend their own positions on the lines laid down for the garrison of a front line trench.

2. DETAILS OF NUCLEUS GARRISONS.

(a) Defences for which nucleus garrisons are detailed and the units furnishing them, are as follows:-

- | | |
|---------------------------------------|--|
| I. COURTE CROIX SWITCH | - One company 1st AUST PIONEER BN. |
| II. ROUGE CROIX SWITCH
(KLITE HIL) | - One platoon 1st AUST. PIONEER BATTALION. |
| III. RESERVE LINE, FORWARD ZONE | - 1st AUST. PIONEER BN.
(less 7 platoons) |
| IV. ROUGE CROIX locality | - 2 platoons, 1st AUST. PIONEER BATTALION. |
| V. PRADELLES Locality. | - 1 Officer & 40 O.R.
Nucleus Battalion
of Brigade in the
line. |
| VI. BORRE Locality. | - 1 Officer & 40 O.R.
Nucleus Battalion
of Brigade in the Line |
| VII. "B" Line. | - 8 Vickers Machine
Guns of "C" M.G. Co |

In the cases of III and IV Nucleus garrisons will not proceed to their stations until the Precautionary Stage is ordered, but the defences and routes must be thoroughly reconnoitred and defence arrangements thought out. In all cases the nucleus garrisons are already in their allotted positions.

- and Pioneer
3. Commanders of Infantry Nucleus Garrisons will allot their Commands by platoons to the points of greatest tactical advantage in the defences for which they are responsible. They must bear in mind that for a brief period, during which reinforcing or broken troops are being organised, the Nucleus garrison may have to bear the whole pressure of the hostile attack and their plans should provide for action accordingly.

4. Units supplying Nucleus garrisons are responsible for procuring and placing in the defences the authorised reserves of S.A.A. grenades, and 24 hours rations of food and water.
5. The names of Commanders of Nucleus garrisons, or of the company sectors allotted, will be notified to D.H.Q. by the H.Q. of the formation or unit concerned. This applied also to subsequent changes.

2. DETAILED OR NUCLEUS GARRISONS.

(a) Defence for which nucleus garrisons are detailed and the units furnishing them, are as follows:-

I. COURTES GARDEN SWITZER	- One company 1st AUS
II. ROUSE GARDEN SWITZER	- One platoon 1st AUS
III. RESERVE LINE, FORWARD TRENCH	- 1st AUS, 1st PLATOON
IV. ROUSE GARDEN SWITZER	- 2 platoons, 1st AUS
V. PRADDER SWITZER	- 1 platoon & 40 S.A.
VI. ROUSE GARDEN SWITZER	- 1 platoon & 40 S.A.
VII. "B" LINE	- 2 platoons, 1st AUS

In the case of III and IV nucleus garrisons will not proceed to their sectors until the Provisionary State is ordered, but the defence and reserve must be thoroughly reorganised and defence arrangements thought out. In all cases the nucleus garrisons are already in their allotted positions.

Commanders of Infantry Nucleus garrisons will also be advised by platoon to the points of interest tactical advantage in the defence for which they are responsible. They must be in mind that for a period, during which re-organising or broken troops are being organised, the nucleus garrisons may have to keep the whole pressure of the hostile attack and their plans should provide for action accordingly.

APPENDIX 6.

DEMOLITION OF ROADS AND BRIDGES.

1. The following points on roads have been prepared for demolition :
 - (a) Roads.

W.29.c.5.3.	W.29.a.5.7.
W.23.c.3.2.	W.17.d.1.2.
W.17.b.5.6.	W.11.a.9.5.
W.16.d.0.4.	W.10.c.1.0.
E.3.d.2.7.	W.19.a.0.8.
W.13.d.2.2.	
 - (b) Road Bridges. V.24.a.0.4,
 - (c) Railway Bridges. V.30.c.90.30.
2. (i) The C.R.E. is responsible for the preparation and blowing of mines under 1 (a) and (b). When mines have been prepared Sapper personnel will be posted to fire the charges when necessary.
 (ii) Within their respective zones Infantry Brigade Commanders will provide a guard for each prepared mine. The C.R.E. will be responsible for notifying the location of mines additional to the above.
3. The Divisional Commander delegates the authority for ordering the firing of mine charges as in para 1 (a) and (b) to the General Officer Commanding the Infantry Brigade (or Brigades) in the line.
4. Mine charges will be fired by the Sapper on duty when
 - (a) in receipt of written instructions signed by or for a Brigade Commander.
 - (b) When all our troops have passed that point, and the locality is in danger of falling into the hands of the enemy.
5. All preparations for destruction of railways and railway bridges are carried out by Transportation Department, which maintains the necessary personnel on the site. The actual order for the charges to be fired will be sent from Divisional Headquarters.
6. Within 1500 yards of the front line, all roads leading from the front which have not already been destroyed will be prepared for anti-tank defence by cutting a trench across more than eight feet wide. This work will be carried out on the responsibility of the G.O.C. the Brigade in the line, who will decide which roads are no longer needed for transport purposes. Sites of Anti-Tank trenches will be notified to D.H.Q.

APPENDIX 7.

ACTION DURING "PRECAUTIONARY STAGE"

1. Should indications point to the enemy making a general attack within 48 hours a "Precautionary Stage" will be ordered. The message from D.H.Q. to formations and units concerned will be "ADOPT PRECAUTIONARY STAGE".
2. On receipt of the message from D.H.Q. the following action will be taken forthwith:-

BRIGADE in the line-

The G.O.C. will

- (i) Assume command over all the defences in advance of the "B" Line and any nucleus garrisons posted therein.
- (ii) Issue instructions to the nucleus battalion (less 1 Officer and 40 other ranks allotted to posts in BORRE defences) to move to positions for the defence of PRADELLES (See Appendix 3B)
- (iii) Attach 4 A.A. Lewis guns to the nucleus battalion for duty with the PRADELLES defences.

SUPPORT BRIGADE.

The G.O.C. will

- (i) Issue instructions to reform the nucleus battalion.
- (ii) Issue instructions to the nucleus battalion to take over the defences of BORRE (See Appendix 5C)
- (iii) Attach 4 A.A. Lewis guns to the nucleus battalion for duty with the BORRE defences.

RESERVE BRIGADE.

The G.O.C. will

- (i) Move the Brigade group to the bivouac positions detailed in Appendix 2.
- (ii) Issue instructions to reform the nucleus battalion.

1st AUST. PIONEER BATTALION.

The companies will occupy the trenches and post to which they have been detailed as nucleus garrisons.

3. Completion of any part of the action ordered under para. 2 will be reported by wire to Divisional Headquarters.
4. Iron rations to be issued to the troops if not already done.

Add sub-para. iv - Issue instructions to "A" Battalion to despatch one Company to occupy the ROUGE CROIX defences.

After 1st AUST. PIONEER BATTALION and detail, insert -

1st AUST. M.G. BATTALION- The O.C. will despatch 2 Vickers Guns (from "C" Company) to occupy positions in the ROUGE CROIX defences.

— MAP —
SHOWING LINES OF DEFENCE
1ST AUSTRALIAN DIV. SECTOR.
Scale = 20,000

MAP "A"
DIV. T.S. No 8

SECRET

COPY No



524

From G.R.E.
1ST AUSTRALIAN DIV.
1918

1st AUS. DIV.

SECRET

APPENDIX 29

526

Machine Gun Dispositions and Barrage Lines

MAP "C"

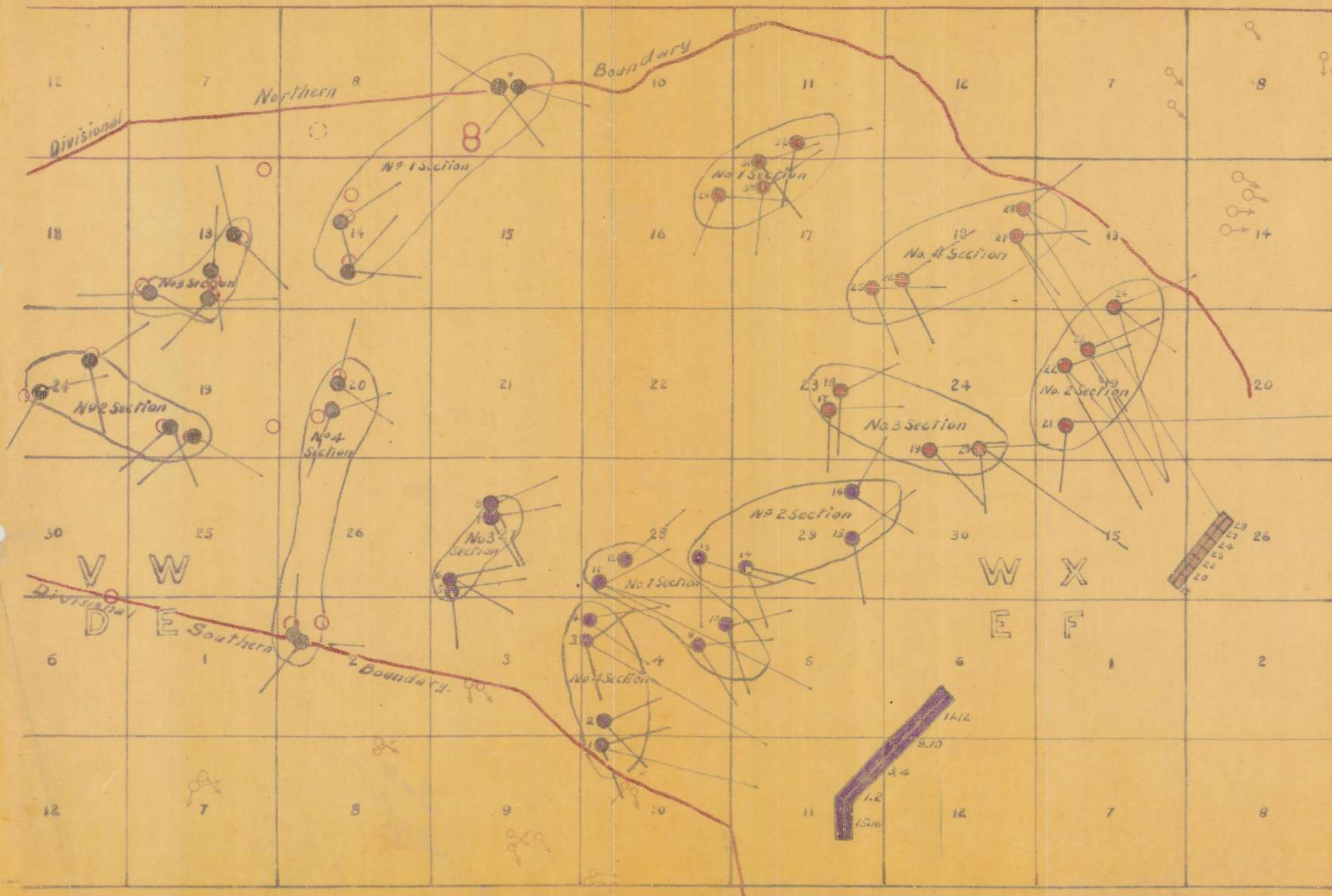

DIV TS No 10

COPY No 14

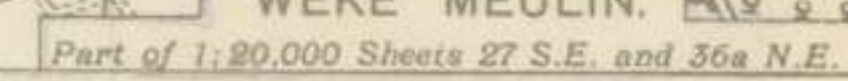

Div. T.S. № 12 Copy № 14

FIRST AUSTRALIAN DIVISION.

Daily Strength as at Noon.....1-5-18.....1918.

UNITS.	On Establishment.			Attached.			Remarks.
	Off.	O.R.	Total.	Off.	O.R.	Total.	
DIV. HEADQUARTERS.	29	84	113	8	293	301	
DIV. ARTL.	87	2336	2423	4	16	20	
DIV. ENGINEERS.	23	606	629	3	24	27	
Div. Signal Coy.	16	337	353	-	72	72	
PIONEER BATTALION.	42	1286	1328	1	2	3	
1st INF. BDE. H.Q.	7	20	27	4	96	100	
1st Battalion.	30	625	655	1	-	1	
2nd Battalion.	33	613	646	1	4	5	
3rd Battalion.	30	684	714	5	9	14	
4th Battalion.	27	607	634	2	2	4	
1st A.L.T.M. Battery.	2	39	41	-	15	15	
1st A.M.G. Coy.							
2nd INF. BDE. H.Q.	7	23	30	8	131	139	
5th Battalion.	36	766	802	2	1	3	
6th Battalion.	30	734	764	2	4	6	
7th Battalion.	32	649	681	1	1	2	
8th Battalion.	29	756	785	2	9	11	
2nd A.L.T.M. Battery.	3	44	47	-	-	-	
2nd A.M.G. Coy.							
3rd INF. BDE. H.Q.	3	22	25	6	40	46	
9th Battalion.	38	671	709	1	1	2	
10th Battalion.	32	732	764	1	5	6	
11th Battalion.	29	639	668	1	4	5	
12th Battalion.	29	609	638	2	2	4	
3rd A.L.T.M. Battery.	5	75	80	-	-	-	
3rd A.M.G. Coy.							
DIVISIONAL TRAIN.	24	438	462	1	75	76	
4th Field Ambulance.	9	246	255	1	51	52	
5th Field Ambulance.	10	238	248	1	4	5	
6th Field Ambulance.	11	229	240	2	25	27	
Div. Salvage Coy.	-	56	56	1	7	8	
Lab. Vety. Section.	1	26	27	-	7	7	
1st A.M.G. Coy. Bn.							
TOTALS.	58	880	938	2	17	19	

FIRST AUSTRALIAN DIVISION.

Daily Strength as at Noon.....1918.

31-5-18.

UNITS.	On Establishment.			Attached.			Remarks.
	Off.	O. R.	Total.	Off.	O. R.	Total.	
DIV. HEADQUARTERS.							
DIV. ARTL.	36	107	143	6	247	253	
DIV. ENGINEERS.	90	2402	2492	5	18	23	
Div. Signal Coy.	24	613	637	1	20	21	
PIONEER BATTALION.	16	343	359	-	77	77	
1st INF. BDE. H.Q.	42	1298	1340	1	3	4	
1st Battalion.	7	16	23	5	40	43	
2nd Battalion.	25	728	753	1	-	1	
3rd Battalion.	35	639	674	1	5	4	
4th Battalion.	36	802	838	1	2	3	
1st A.L.T.M. Battery.	29	631	660	2	2	4	
1st A.M.G. Coy.	2	35	37	-	16	16	
2nd INF. BDE. H.Q.							
5th Battalion.	7	23	30	-	40	40	
6th Battalion.	39	793	832	2	2	4	
7th Battalion.	32	804	836	3	4	7	
8th Battalion.	37	769	806	2	2	4	
9th Battalion.	32	907	939	2	2	4	
2nd A.L.T.M. Battery.	4	42	46	-	15	15	
2nd A.M.G. Coy.							
3rd INF. BDE. H.Q.							
9th Battalion.	6	23	29	2	58	40	
10th Battalion.	29	612	641	1	5	6	
11th Battalion.	29	666	695	1	12	13	
12th Battalion.	28	682	710	2	4	6	
13th Battalion.	27	699	726	2	2	4	
3rd A.L.T.M. Battery.							
3rd A.M.G. Coy.	5	71	76	-	-	-	
DIVISIONAL TRAIN.							
1st Field Ambulance.	24	449	473	2	66	68	
2nd Field Ambulance.	10	245	255	1	5	6	
3rd Field Ambulance.	10	239	249	1	7	8	
Div. Salvage Coy.	11	226	237	2	30	32	
Mob. Vety. Section.	1	62	63	-	1	1	
4th A.M.G. Coy.	1	20	21	-	-	-	
1st M.G. Bn. 48	48	870	918	1	12	13.	
TOTALS.							

Casualties for month of May.

<u>Killed.</u>	<u>Wounded</u>	<u>Missing</u>
<u>Off. O.Rs.</u>	<u>Off. O.Rs.</u>	<u>Off. O.Rs.</u>
18. 139.	56. 771.	- 5.

Number of Officers and Other Ranks joined for month of May.

<u>Off.</u>	<u>O.Rs.</u>
106.	1563.

Sick Wastage for Month of May.

<u>Off.</u>	<u>O.Rs.</u>
64.	1148.

John W. H. Jones

SECRET.

FIRST AUSTRALIAN DIVISION.

Appendix 33532
S/8174.

Divisional Headquarters.
3rd. May. 1918.

.....

ANTI-GAS INSTRUCTIONS.

1. STANDING ORDERS.

Standing Orders for Defence Against Gas are contained in App. IV. S.S. 534. dated March 1918.

2. GAS ZONES. (S.S. 534. App. IV. para 1.)

Until definite zones can be allotted the Provisional Alert Zone within the Corps area will be as follows;-

East of the MORBECQUE - GODEWAERSVELDE Railway.

3. Special attention is drawn to the order contained in S.S. 193. paragraphs 3 and 4, dealing with, "The Inspection of Respirators," "Posting of Gas Sentries," and "Action during and after a Gas Shell Bombardment."

4. GAS SHELL BOMBARDMENT.

(a) Units occupying positions in Woods, Valleys, Villages, within range of a gas shell bombardment will be warned of the persistent effect of the gas which is liable to be dangerous even after several days have elapsed.

(b) Alternative positions should be selected to which troops can be moved in the event of a heavy hostile gas shell bombardment.

(c) If it is impossible for tactical reasons to evacuate the positions entirely, as many troops as possible should be moved away, and those remaining in the gassed area should be relieved every six or eight hours.

(d) Every gas shell bombardment should invariably be reported, and it is important that any new gas or projectile should be investigated at once.

5. INSTRUCTIONS FOR WARNING IN EVENT OF A HOSTILE CLOUD GAS ATTACK. S.S. 534. Appendix. IV. para 5.

Brigades are responsible for warning all troops in their areas. Forward Brigades will be responsible for the forward area as far west as the HAZEBROUCK - GODEWAERSVELDE Railway, less the troops of the Reserve Brigade, and Machine Gun Battalion. They will also warn Flanking Brigades.

The Reserve Brigade will warn Reserve Brigade units and all troops in the Divisional area between the HAZEBROUCK - GODEWAERSVELDE railway, and the HAZEBROUCK-SYLVESTRE CAPPEL road except the Pioneer Battalion.

In every Signal Office there will be maintained a list of units to be warned in case of Gas Cloud Alarm. Telephone or telegraph message as laid down in S.S. 534. will be sent where possible - units not connected by wire will be warned by runner from the nearest signal office.

Shapin

Lieut-Colonel.
General Staff.
1st Australian Division.

33

DIVISIONAL
GAS OFFICER,
1ST AUSTRALIAN DIV.

No. AC 392
Date 1-6-18

1st Aust. Div.

War diary report for period
1st to 31st May 1918 inclusive.

The Division has been in the line for
period covered by report.
Yellow Cross (mustard gas) was mainly
used throughout the month in shells
of all calibre up to 8 inch.
8 inch calibre yellow cross gas shells have
not hitherto been used and our
Divisional front, but have previously
been reported in use in sectors
held by other divisions.
Appended is a summary of enemy
gas shell bombardments for the period
under review.

German front.
D 4.0.101 and Div.

Summary of enemy Gas Shell bombardments
on 1st Aust. Div. Sectors for period 1st to 31st May 1918.

DIVISIONAL
GAS OFFICER,
1ST AUSTRALIAN DIV.

No.
Date 1-6-18.

Date	Time	Locality	approximate no. of shells	Nature of Gas Shells
1.5.18	10 pm.	W. 30. C.	50	Green Cross
	11.30 pm.	X. 2. D. 3. 5	10	Blue Cross
2.5.18	2.30 am	X. 4. C. 4. 4.	5	Yellow Cross
	5.30 am - 6 am	W. 30. C.	few	Green Cross
4.5.18	7 pm - 9 pm	E. 3. C.	150	Green Cross
	9.45 pm - 10.10 pm	X. 10. D. & X. 16. B	few	Lockymatin
5.5.18	7.30 pm - 9 pm	W. 29. B.	few	Green Cross
	11 pm - 11.30 pm	W. 16. D.	30	Green Cross
6.5.18	4 am - 5 am	X. 10. D. & X. 1. D.	12	Green Cross
7.5.18	2 pm	X. 7. Central X. 20. A & B X. 14. C & D.	few	Green Cross
8.5.18	8.15 pm - 10.45 pm	X. 20. D. X. 20. B. X. 3. B.	few	Green Cross
9.5.18	12.25 pm	X. 20. C. X. 15. A.	10	Yellow Cross

Date	Time	Locality	Approximate No. of Stills	Nature of Gas Stills
10.5.18	During night	W.29	90	Green Cross
"	"	Scattered in bath area.	10	Green Cross
11.5.18	12.30 am - 3.15 am	E.4.D. W.28.B. W.29.	600	Green Cross
		W.23. W.24.A. W.18.		Yellow Cross and
		X.14.		Blue Cross
12.5.18	During night	Scattered in bath area	50	Yellow Cross
13.5.18	4.30 am	W.5.A. W.6.C.	just	Green Cross
16.5.18	10 pm - 12 midnight	W.29. X.25.	100	Blue Cross
17.5.18	12.15 am	W.28.A. & D.	100	Yellow Cross and
				Green Cross
	2.30 am	E.5.C. & D.	15	Yellow Cross
	12.30 am	W.29.C. W.20.B. W.21.A.	30	Green Cross
19.5.18	3 am	E.4.C. & D.	40	Green Cross
20.5.18	10.30 pm - 2 am	W.29.A	100	Blue Cross and
				Green Cross
21.5.18	8.30 am	W.18.D	60	Yellow Cross
	4.35 am - 5 am	W.18.C. & D	90	Blue Cross and
				Yellow Cross

3.					
Date	Time	Locality		approximate No. of Stills	Nature of Gas Stills.
21. 5. 18	10.30 pm - 12.30 am	W. 29. A		150	{ Blue Cross and Green Cross
22. 5. 18	10 pm - 11.30 pm	W. 29. A.		50	{ Blue Cross, Green Cross and Green Cross 1.
	10.30 pm	W. 22. A & C.	W. 15. D.	100	Green Cross
23. 5. 18	9.35 pm - 9.45 pm	W. 19. A.	W. 18. D.	300	Yellow Cross
24. 5. 18	3 am	W. 28. A & C.		200	{ Yellow Cross and Green Cross
	9.30 pm to 12 midnight	W. 29. A.		200	Blue Cross, Green Cross & Green Cross 1
	10 pm.	W. 7. C & D		430	Yellow Cross
	11 pm - 1 am	E. 5. C & D		20	Green Cross
	9.30 pm to 3.35 am	W. 20.	W. 21. W. 27	700	Yellow Cross & Green Cross 1.
25. 5. 18	3.30 am	W. 28. A & C.		200	Yellow Cross
	2 am to 4 am	W. 9. C.		100	Yellow Cross

Date	Time	Locality	Approximate No. of Shells	Nature of Gas Shells
26.5.18	8 pm - 4.30 am	W. 21.	500	Yellow Cross and Blue Cross
	8 pm - 4.30 am	W. 29. A.	250	Yellow Cross and Blue Cross
	9.50 am - 10.20 am	W. 10. A. W. 16. B. W. 18. A. W. 18. B.	few	Green Cross and Blue Cross
	8.20 pm - 11 pm	W. 16. D. W. 17. C. W. 18. A.	50	Blue Cross
27.5.18	8 pm - 2.30 am	W. 27. B. W. 27. D. W. 21. B.	100	Yellow Cross and Green Cross
	2.15 am - 5.45 am	W. 18. W. 13. W. 24. A. W. 17. W. 23. A.	250	Yellow Cross
	1 am - 3 am	W. 23. W. 24. X. 13.	50	Green Cross
28.5.18	2 am - 3 am	W. 1. B.	50	Yellow Cross
29.5.18	3.30 am	X. 19. A.	5	Yellow Cross
	12 midnight	V. 18. C. V. 18. D.	50	Yellow Cross
30.5.18	11 pm	W. 27. A.	150	Yellow Cross
	1 am.	W. 18. D. X. 13. C. E. 3. D.	90	Yellow Cross
	3.30 am	W. 23. A. W. 23. B.	50	Yellow Cross.

Date	Time	Location	Approximate No. of Shells	Nature of Gas Shells
30.5.18	2 am	W. 22. C. W. 22. D.	70	Green Cross and Yellow Cross
31.5.18	2.45 am	X. 19. A. X. 19. D.	100	Yellow Cross
	3 am	X. 19. A.	40 Mortar Projectiles	
	1 am.	W. 22. A. W. 22. D.	58	Yellow Cross
	1.5 am	W. 29. A.	60	Yellow Cross
	1 am - 3 am	X. 13. W. 18	100	Yellow Cross

Note.

Yellow Cross. (Mustard).
Green Cross
Green Cross 1
Blue Cross.

Dichloroethyl Sulphide
Diphosgene
Diphosgene and Chlorpicrin
Diphenylchlorarsine.

10th June 1918

W. H. Morrison Lieut.
D. G. O. 10th and 11th Div.

FIRST AUSTRALIAN DIVISION.

NUMBER OF OFFICERS AND OTHER RANKS SENT TO SCHOOLS

DURING MONTH OF MAY, 1918.

Course.	Nature of Course.	Duration.	Vacancies.		Remarks.
			Off.	O.Rs.	
Lewis Gun Branch, G.H.Q. Small Arms School, LE TOUQUET.					
"A" Course.	Company Commanders Course.	8 days.	4	-	Covers 3 Courses
"B" Course.	Junior Officers and N.C.Os course.	16 days.	2	10	" 2 "
2nd Army Anti-Gas School, WISQUES.	Training anti-gas personnel.	7 days.	8	8	Covers 2 Courses
2nd Army Central School of Instruction, WISQUES.	General training.	2 weeks.	33	96	Covers 2 Courses
2nd Army Cookery School, LUMBRES.					
Officers Mess Cooks.	Training of cooks for Officers Mess.	3 weeks.		1	
Company Cooks.	Training of men for Company Cooks.	6 weeks.		3	
Battalion Musketry Instructors Course, HAYLING ISLAND.	Training of Sergeants to be Battalion Sergeant Musketry Instructor.	3 weeks.		2	
XV Corps Signalling School, SELLES.	Training of personnel in Sig.duties etc.	1 month.	4	22	
2nd Army Central School, WISQUES.	General training	12 days.	16	32	
2nd Army Musketry School, LUMBRES.	Musketry training				
XV Corps School, SELLES.		14 days	3	19	
Lewis Gun. }		14 days.	3	19	
Musketry. }		do.	4	23	
Bombing. }		do.	5	26	
Infantry }		do	5	22	
Gas }		5 days.	6	42	Covers 3 Courses
	General training and instruction.				

Appendix.

5/6

Course.	Nature of Course.	Duration.	Vacancies		Remarks.
			Off.	O.Rs.	
2nd Army Signalling School, COLEMBERT.	Training of Signal personnel in all branches of the Signal Service.	6 weeks.	1	12	
2nd Army Artillery School. TILQUES.	Training of artillery personnel only.	2 weeks.	4	8	
Aeroplane Class at 4th Sqn, R.A.F. LONGUEUESSE.	For training of Sig. Personnel.	3 days.	2	12	
G.H.Q., P.&B.T. School. HARDELLOT PLAGE.	Training of Physical and Bayonet Fighting Instructors.	3 weeks.	1	2	
2nd Army Musketry School. LUMBRES.	Musketry instruction.	2 weeks.	11	23	
2nd Army S.O.S. School, LUMBRES.	Training of personnel in Scouting, Observation and Sniping, and use of telescopic rifle.	2 weeks.	2	2	
XV Corps School, QUESQUES. Bombing.) L.T. Mortars.) Lewis Gun.) Hotchkiss Gun.) Infantry.)	General training and instruction.	2 weeks.	2 8 4	20 12 21 3 35	

Appendix 34

551