

AWM4

**Australian Imperial Force unit war diaries,
1914-18 War**

Medical, Dental & Nursing

Item number: 26/62/43

Title: No 1 Australian Casualty Clearing
Station

August 1918



AWM4-26/62/43

CONFIDENTIAL.

ORIGINAL.
DUPLICATE.
TRIPLICATE.

368

Australian Imperial Force.

WAR DIARY

OF

1st Aust. C. C. S

FOR

AUGUST

1918

Signature of Officer compiling

Philip ...

Signature of Officer Commanding

WAR DIARY

Army Form C. 2118.

Instructions regarding War Diaries and Intelligence Summaries are contained in F. S. Regs., Part II, and the Staff Manual respectively. Title pages will be prepared in manuscript.

INTELLIGENCE SUMMARY.

(Erase heading not required.)

366

Place	Date	Hour	Summary of Events and Information	Remarks and references to Appendices
BLENDEN-QUES	1/8/17		Very hot oppressive day. Quiet. Evacuation at 3 pm. by some misunderstanding 50 lying cases were returned by E.M.O. this resulted in a good deal of serious inconvenience. Patients since they had to travel fruitlessly to ST. OMER T. base. The mother was reported to D.M.S. 2nd Army. During the last 3 days a hut hospital NISSEN has been under process of removal from former site of 15 C.C.S. EBBLINGHAM to this station under authority of D.M.S. It will be erected here as a resuscitation ward. CH WRIGHT, D.M.S. 1st Corps visited unit to enquire into conditions of V. Army personnel.	
	2/8/18		Wet day but cooler. Evacuation during morning, several reception of cases under sick. Preparations being made to have dressing room to site of front part of present prospectus ward, the main hut (hospital large) will be then located on site of present D. Room.	
	3/8/18		Dull day. Dressing room established to new site. Capt RAILTON M.C. reported from 8th F. Amb. as anaesthetist since Major WHITEHEAD reporting to 3 A.G.H. good evacuation in morning.	
	4/8/18		Dull day. Very heavy morning sick + gassed cases for V. Army. The cases began coming in to hospital at about 11.30 am + continued	

or

62

INTELLIGENCE SUMMARY

(Erase heading not required.)

Place	Date	Hour	Summary of Events and Information	Remarks and references to Appendices
BLENDÉCQUES	4/4/18.		throughout the day + evening of 4 about 10 p.m. 316th Canadian infantry brigade was sent to the front line . The gassed cases were all slight "mustard gas" casualties from 11th Corps (Vth Army). Major Whitman A.A.M.C. left report to HQ 3 A.C.H.	
	5/4/18		Quiet day, raining. Evacuation as usual. 316th Corps received up to 24 hrs delay saw including 68th (X1st) Corps.	
	6/4/18		Fine day, partly heavy raining. Mostly sick, a good lot of fairly slight cases were received from XIth Corps sent to station. Telegraphic instructions received during evening 8 p.m. for Lt Col Grisch's + Capt. Camp's teams to leave tomorrow morning at 8 am + 9.30 am respectively + report to 20 C.C.S. + HQ C.C.S. (SOMME AREA). Instructions were also received from D.M.S. (telephonic through E.M.O.) that under 6000 sick wastage, commencing from tomorrow the sick for 15th Corps would be allotted to H.Z. staff. Insp. on Thursdays, Thursdays + Saturdays + for the 18 C.C.S. on Thursdays, Wednesdays + Fridays + to Nos 1 + 2 Ant C.C.S. on Sundays. All sick cases ^{at present in hospital +} fit to travel are to be sent forward for this C.C.S. to 18 C.C.S.	
	7/8/18		Quiet day. Lieut Col Grisch's + Capt Camp's with their respective teams proceeded to 30th + 4th C.C.S. (SOMME AREA) respectively. They were relieved here by Capt OAG. R.A.M.C. 10 C.C.S. + Capt ALGUIRE C.A.M.C. 4th Canadian C.C.S.	

WAR DIARY

Army Form C. 2118.

Instructions regarding War Diaries and Intelligence Summaries are contained in F. S. Regs., Part II. and the Staff Manual respectively. Title pages will be prepared in manuscript.

INTELLIGENCE SUMMARY.

(Erase heading not required.)

Place	Date	Hour	Summary of Events and Information	Remarks and references to Appendices
BLENDÉCQUES	1/4/18		14th Corps have hady Anaesthetics. ^{Transferred} transferring sick to 78 C.C.S. the evacuation of wounded. details of Transfer ^{2 5} OK. 31.64.	OK
	8/8/18		Whole day. Few wounded apart from large no of passed cases. (167) about 60 here received from 15th Army 2/2 S. Highland F. Arch. in clothes. D. Arch. they had become casualties, remembering that being bathed with S. Arch. who have the attention of D.M.S. 2nd Army was called to this fact. A large no of sick here received from 11th Corps (15th Army) but none from XV th as per arrangements made on 6/8/18. Telegraphic instructions for Capt. ALQUIRES team to proceed tomorrow to 48 C.C.S. line	OK
	9/8/18		Whole day. 322 patients received during 24 hours ending 8am disposed of as follows. Transferred to 70th Station Hosp. 40 lying cases (general slight) 4th " " 100 " " " " " " " " " 28 " " 22 sitting cases.	OK
			Capt. GUTHRIE + PINFOLD N.Z.A.C. patient ^{patient} S. Arch. + 4 M. reported from N.Z. Station Hosp. for duty to Royal Corps.	OK
	10/8/18		Very quiet fine day, very few cases received.	OK
	11/8/18		Very quiet day. No evacuation, very few cases received.	OK

WAR DIARY

Army Form C. 2118.

Instructions regarding War Diaries and Intelligence Summaries are contained in F. S. Regs., Part II, and the Staff Manual respectively. Title pages will be prepared in manuscript.

INTELLIGENCE SUMMARY.

(Erase heading not required.)

Place	Date	Hour	Summary of Events and Information	Remarks and references to Appendices
BLENDECQUES	12/9/14		Quiet day no fighting receiving small evacuations. Major General Sir Wilfrid HERRINGHAM Consulting General G.H.G. visited the front with Lt Colonel. Consulting General Red Army.	JH
	13/9/14		At receiving. fine day.	
	14/9/14		Quiet day, good no of wounded received from NIEPPE front sector.	JH
	15/9/14		No of wounded received 24 hours ending 8 AM = 54. Capt E. CHAMPION proceeded on leave to PARIS, evacuations. Morning.	JH
	16/9/14		A no of gas cases & wounded cases received during the day from 31st Div. (XV Corps). It is now necessary to notify the Corps Chemical Adviser, ^{concerned} & also to the Army & the C.C.S. of the BLENDECQUES group the Army Chemical Adviser, whenever over 20 cases (gas) are received from any single unit in any Corps. Consequently since over 20 cases of gas poisoning have received from H.E. Lines up till 7 PM. the necessary advice have been sent to the Chemical Advisers of our Army & XV Corps. Major General GUISE MOORE D.M.S. Red Army visited the front during the morning. Lt Colonel MARSHALL of 1st Ant C.C.S. proceeded on leave to PARIS. MARSHALL C.E. MARSHALL acts as OT during his absence. No signs of wounded are being any longer received from V th Army, the no of signs reported is consequently falling as previously only small cases will be received from them on except on alternate Sundays, when signs from XV Corps will be received.	JH

WAR DIARY

Army Form C. 2118.

Instructions regarding War Diaries and Intelligence
Summaries are contained in F. S. Regs., Part II,
and the Staff Manual respectively. Title pages
will be prepared in manuscript.

INTELLIGENCE SUMMARY.

(Erase heading not required.)

Place	Date	Hour	Summary of Events and Information	Remarks and references to Appendices
BLENDÉCQUES	17/4/18		<p>Full cold windy day. That the 7 cases received up to 24 has today shown 186 including gained 4 off. 99 O.R. evacuation during the day to head of Am line + in evening 60 gained cases O.R. were transferred to 4 stations Hospital ARQUES.</p>	84
	18/4/18		<p>Full day. A hint was gained from the Intelligence Officer 2nd Army, that there was a likelihood of a rush of work during the day, hence was arranged for D.M.S. Road time later that an attack had been made by 15 Corps operating from OUTREASTRENE. The attack took place at 11 AM + the first wounded arrived from the front at 3 PM. Arrangements were made both 2nd and C.C.S. to assist in taking them when 100 cases had been received. The wounded arrived in good condition + well dressed + the first wounded was received by 4.45 pm + the Dons were then diverted to 2nd and C.C.S. who received them + transferred cases up to 6.30 pm. The cases arriving in at this time were mostly men who had been wounded within an hour of the opening of the attack. Enemy prisoners (wounded) commenced to arrive at 7.35 pm. The 2nd wounded cases were received here by 9.40 pm. + the 2nd and C.C.S. again diverted to. Arrangements were made by D.M.S. to leave the Blendécques C.C.S. free during the night, by diverting the cases arriving between 10 pm + 10 am (18/4/18) to the 9 B.R.C. Hosp. + the 18 C.C.S. respectively.</p>	85

WAR DIARY

Army Form C. 2118.

Instructions regarding War Diaries and Intelligence Summaries are contained in F. S. Regs., Part II, and the Staff Manual respectively. Title pages will be prepared in manuscript.

INTELLIGENCE SUMMARY.

(Erase heading not required.)

368

Place	Date	Hour	Summary of Events and Information	Remarks and references to Appendices
BLENDECQUES	18/8/18		The CCS was about 2 medical officers in leave, Ambulance had been made when the remains of the probable work were first received, for Capt BORTON'S team (day duty) to rest during the day until called. The remaining day team 2. worked during the afternoon & Capt BORTON'S team came on at 4 pm & worked with the other day & the night team (Major Champion in leave had been on duty) up till 4 am. The new resusculation band previously mentioned has not completed, but was quite advanced enough to be able to hold cases which required chest treatment but not resusculation. Receipts, some fractures mostly, Army, some head cases & several flesh wounds. It was equipped temporarily with blankets, dressings etc & an acetylene generator lamp (the electric light is not yet connected) & several many. Well as a for operator band.	
	19/8/18		Dull day, no indication could be gained from D.M.S. as to whether the station might have to receive in conjunction with the 2nd CCS during the day. A mutual arrangement however was arrived at between the 2 units, to the effect that the 2 should receive all the cases, if there was no sign of a rush, but that they should notify us, if the cases began to come in more rapidly, at any time during the day, so that we might prepare to be directed to.	<div>85</div> <div>87</div>

WAR DIARY

Army Form C. 2118.

Instructions regarding War Diaries and Intelligence Summaries are contained in F. S. Regs., Part II, and the Staff Manual respectively. Title pages will be prepared in manuscript.

INTELLIGENCE SUMMARY.

(Erase heading not required.)

368

Place	Date	Hour	Summary of Events and Information	Remarks and references to Appendices
BLENDYQUES	19/8/18		There were still a lot of cases requiring operation in the paediatric T. Resuscitation ward but they had been all operated on by evening. At 8.30 pm Mr 2 Ant. C.C.S. advised that they thought it likely that they might have to direct to Mr. D.M.S. was unable to confirm this opinion. Arrangements were made however to reinforce the 1 night team on duty, by using Capt GUTHRIE who was the first least qualified of the Surgeons with Surgeon Champion's assistance & Charles Butler & others. (Surgeon Champion being on leave). This arrangement had the advantage of allowing Capt PENFOLD (assisted by Capt Guthrie) to finish in the dressing rooms.	
	20/8/18		At 3 am Mr 2 Ant. advised that he might be directed to, as they had a lot of cases awaiting Op. up to 8 am 47 cases all requiring Op. were received. During the day Mr 4 B.R.C.S. hospital received cases, the directing of the cases was left to the C.C.S., the seriously wounded cases however were sent on. Consequently during the day we received about 4 serious thighs, abdomens & heads. Towards 7 pm Mr 4 B.R.C.S. advised that their accommodation was full & asked that we might relieve them, this was out of the question, as our team had been going hard since 18/8/18 & required a spell. D.M.S. was relieved & immediately	JH

WAR DIARY

Army Form C. 2118.

Instructions regarding War Diaries and Intelligence
Summaries are contained in F. S. Regs., Part II,
and the Staff Manual respectively. Title pages
will be prepared in manuscript.

INTELLIGENCE SUMMARY.

(Erase heading not required.)

368

Place	Date	Hour	Summary of Events and Information	Remarks and references to Appendices
BLENDÉCQUES	20/9/14		Arranged for the cases to be delivered to R.C.C.S. This allowed all work in house to be finished by 10 pm & the teams have all become a good night rest. 9 Blood transfusions were done during the day with most satisfactory results. An examination was held in the morning.	
	21/9/14		Very hot sultry day. Quiet. Not receiving. A new THREE disinfectant was supplied the unit to help coming out disinfection of patients clothing before being hauled for oblong. Chaplain the Rev S.E. DORMAN. left to report to A.I.F. HQ for temporary duty vice Chap the Rev. MILES	X
	22/9/14		The hottest & most oppressive day experienced for some time 10 haults. Receiving, being few cases. Disinfection from D.H.G. A.I.F. Unit was very a patient for a patient as a corporal had been allotted on a transport shortly before for Australia. The man chosen must be married with his home in Australia & must have left Australia in 1914. Visit during the day by five Committee who made suggestions etc for fine orders & equipment etc.	
	23/9/14		Cool Cloudy day. Not receiving. A good deal of firing in the sector during the afternoon evening, but no accounts of the no of cases arriving at the Ant C.C.S.	85

Instructions regarding War Diaries and Intelligence Summaries are contained in F. S. Regs., Part II, and the Staff Manual respectively. Title pages will be prepared in manuscript.

WAR DIARY or INTELLIGENCE SUMMARY.

(Erase heading not required.)

Army Form C. 2118.

368

Place	Date	Hour	Summary of Events and Information	Remarks and references to Appendices
BLENDÉCQUES	24/8/16.		<p>Fine day cool. heavy mist the ^{standard} cases occurred before midnight; however</p> <p>arrived from D.M.S. that a new, & very hut especially designed for X-ray work</p> <p>with special regard to ease of transport, (by Capt Gings) will shortly be ready</p> <p>for this C.C.S. The new Reensulation board with annex for transference</p> <p>theater, is now ready for equipping. Lt HONMAN & Maj LETHBRIDGE with D.M.S. mounted the hut during the day.</p>	84
	25/8/16.		<p>Fine day up till about 5 pm when heavy rain fell, not recurring. Capt E. CHAMPION reported</p> <p>had gone leave to PARIS. During the afternoon a try, & haul team from this C.C.S. successfully</p> <p>completed at sports held at S.C.C.S. winning the final pull in open contest. G. HUTTON</p> <p>secured 3rd place in the mile walk (open). Whilst Pte HUME & Gnr HALE won their</p> <p>respective heats in the 440 yards open championship but were replaced in the</p> <p>final. Sprint Slayth off 14 off 20 (20 yards) off 14 (20 yards) att. officers 6.</p> <p>Sprint 16 att Sprint 3. 8R 103. (3 on leave. 4 men).</p>	84
	26/8/16		<p>Whole day, rain at intervals, Wounded came in constantly during the day though small</p> <p>numbers were gained. Lieut G. MARKS, D.S.O. off C returned from leave to Paris.</p>	
	27/8/16		<p>Whole day, still rain at intervals. Evacuation at 11.30 pm. Sister S/N. SMITH. R.E!</p> <p>A.M.S. reported for duty. Vice S/N BURKE.L.</p>	

WAR DIARY

Army Form C. 2118.

Instructions regarding War Diaries and Intelligence Summaries are contained in F. S. Regs., Part II, and the Staff Manual respectively. Title pages will be prepared in manuscript.

INTELLIGENCE SUMMARY.

(Erase heading not required.)

368

Place	Date	Hour	Summary of Events and Information	Remarks and references to Appendices
BLENDENQUE	28/8/18		<p>Dull day, still rain at intervals. Received fair no 9 wounded during the day. Slight rush of cases during the afternoon, but only for about 1 hour. The majority of the cases had been wounded 24 hours previously, all were seriously wounded. Extracts of D.G.M.S. received per D.M.S. 2nd Army, that the initial dose of A.T.S. shall in future be 1500 units. During the day, during the course of an operation, under N20 + O, a patient stopped breathing, artificial respiration proving unavailing after about 15 minutes. Capt GENTLEMAN, N.Z.M.C. the surgeon operating, opened the chest near left sternal border & massaged the heart, the latter responding well & artificial respiration being continued for about 1 hour. The patient recommenced breathing & lived for several hours afterwards, gas gangrene was present in the left leg causing his collapse & subsequent death. Lt Col. MARKS, attended a conference of CCS (wounded) held at 17 CCS, ARNHEM to discuss the possibility of moving enough CCS equipment in 9 longboats to allow of a station opening up & accommodating 200 seriously wounded cases. Lt Col. D. YOUNG left report to A.I.F. HQ for transport duty to Antwerp, under scheme whereby an endeavour is being made to return as many decaying men as possible for 2 clear months leave in Australia, provided they are not injured with disease in Australia & left in 1914.</p>	

WAR DIARY

Army Form C. 2118.

Instructions regarding War Diaries and Intelligence Summaries are contained in F. S. Regs., Part II, and the Staff Manual respectively. Title pages will be prepared in manuscript.

INTELLIGENCE SUMMARY.

(Erase heading not required.)

Place	Date	Hour	Summary of Events and Information	Remarks and references to Appendices
BLENDÉCQUES	29/8/18		Full day, not receiving. Lt. Col. MARKS attended another conference at D.M.S. office attended by 15 C.C.S. to discuss further, the possibility of moving enemy C.C.S. equipment in 9 loading loads, to allow of the taking in of 200 cases.	
	30/8/18		Full day, receiving many few cases.	
	31/8/18		Full day, not receiving. Telephone message received from D.M.S. at 10.20 am. Ordering us to be forthwith + commencing moving to former site of 15 C.C.S. at EBBLINGHAM on 1/9/18. Lt. Col. + Adj. visited at 11.30 am. New site to be put at. found a no. of huts + stone buildings still as left there by 15 C.C.S. on return from site, a list was received advising that the teams of the C.C.S. + those attached horses moved to 58 C.C.S. during the day. Sick ^(XV Corp) sent for Ambulance 31-1st to NZ Station Hospital + 18 C.C.S. (as heretofore) except on Sundays when they let go to 58 C.C.S. XV Corp wounded will go to 18 + 58 C.C.S. Lt. + Adjutant visited HQ (D.M.S.) 2 p.m. to get definite information concerning some details of the move (as no orders except about disposal of sick + wounded had been received in writing). The points on which definite information was wanted were ① the disposal of the sick + wounded at present + Hospital. there are 12 cases too ill to move. the answer to this query was that all cases for evacuation fit to be	

Instructions regarding War Diaries and Intelligence
Summaries are contained in F. S. Regs., Part II,
and the Staff Manual respectively. Title pages
will be prepared in manuscript.

WAR DIARY or INTELLIGENCE SUMMARY.

(Erase heading not required.)

Army Form C. 2118.

368

Place	Date	Hour	Summary of Events and Information	Remarks and references to Appendices
BLENDÉCQUES	3/1/18		<p>here the sent to have the animal bag, those unfit to travel here the left at this station for 3 or 4 days until fit to move, a marquee (hangar) would be left standing for this purpose & the necessary personnel left to look after the cases. (2) What tents were the left on this site. all tents were the left. the one is anxious to take the LATOIE (theater) hat if possible as it makes a fine operating theater. (3) Could an ambulance car be attached the unit during the hour, as it is necessary to make many trips back & forth between the old & new sites, & the one car is insufficient for the 2 C.C.S. Yes a car can be attached. (4) When are the teams & attached teams the dispatched to 38 C.C.S. the attached will be sent at 6 pm & the C.C.S. teams on further orders. (5) Many lady anesthetists be attached to replace those whose period of training is just completed. yes. (6) There is a XV info DYSENTERY noted at the site to which this station is to open up. 75 cases are hospitalized there. How are these cases the disposed of & what M.O. & O.R. personnel of the F.A. at present in charge is the left to look after them. 2 of 30 O.R. will remain & change of these cases until further orders. (7) D.A.S. has also asked if the teams at present attached might be returned for 5 C.C.S. to this unit when the latter will have more pers to receive cases. as far as could be known they would be returned</p>	

WAR DIARY

Army Form C. 2118.

Instructions regarding War Diaries and Intelligence Summaries are contained in F. S. Regs., Part II, and the Staff Manual respectively. Title pages will be prepared in manuscript.

INTELLIGENCE SUMMARY.

(Erase heading not required.)

368

Place	Date	Hour	Summary of Events and Information	Remarks and references to Appendices
BLENDICQUES	31/5/48.		<p>D.M.S. advised O.C. that as the enemy has still falling back (barracks had just been secured) of the recapture of Mt KEMPAEL the line to EIBLINGHERA has been considered to be dangerous for the present. It was likely that the station + 2nd ant C.C.S. might be sent to the HONGHERA area at ANA JANA siding once there. The station will remain closed however + continue packing up. The D.M.S. is anxious that once the station does begin to move, it will be able to open up in recent time for the reception of chest, German + Abdomen cases.</p> <p>The O.C. is anxious to understand test the possibility of sending enough equipment on the front of boxes desirable as to open up for 200 cases. There will be no need to limit the amount of material to be moved, but it will be a very good opportunity of testing the scheme.</p> <p style="text-align: right;">J. H. H. H.</p>	

WAR DIARY

Army Form C. 2118.

Instructions regarding War Diaries and Intelligence
Summaries are contained in F. S. Regs., Part II,
and the Staff Manual respectively. Title pages
will be prepared in manuscript.

INTELLIGENCE SUMMARY.

(Erase heading not required.)

Place	Date	Hour	Summary of Events and Information	Remarks and references to Appendices
No 1 A.C.S.	1 st		Evacuation of Patients - Busy in all wards D.M.S. 2 nd Army visited station 8.9.7.	
August	2 nd		Received & evacuated patients - Fairly busy day - 8.9.7.	
	3 rd		Evacuated patients - Quiet in all wards 8.9.7.	
	4 th		Church Service & Review at Terdeggham attended by Sister in Charge - Fine day.	
			Received patients - Very busy - Many gasped patients admitted 8.9.7.	
	5 th		All wards busy until evacuation - 8.9.7.	
	6 th		Received & evacuated patients - Busy in all wards - 8.9.7.	
	7 th		Evacuation of patients - Sister Scott 2.A. 2.M.N.S.R. proceeded with surgical team from this Station to No 4 C.C.S. 13.9.7. - Col Fraser's team proceeded to No 20 C.C.S. - S. Fraser & S. Garlin 2.2.9.7. M.N.S.R. reported for duty with surgical team from No 10 C.C.S. - Sister 9.M. Lord & Sister 8.M. Paynter 6.A.M.C. reported for duty from No 4 Canadian C.C.S. - Fairly busy in hospital 8.9.7.	
	8 th		Received & evacuated patients - Very busy - Many gasped patients admitted 8.9.7.	
	9 th		Very busy - Evacuated patients - Sister Paynter & Sister Lord 6.A.M.C. transferred to No 4 C.C.S. - S. Fraser R. Hall reported for duty from No 11 C.C.S. - Sister Leitch proceeded on 14 days leave to United Kingdom - Sister Hawkins reported for duty with surgical team from New Zealand Stationary Hosp. 8.9.7.	

Instructions regarding War Diaries and Intelligence
Summaries are contained in F. S. Regs., Part II,
and the Staff Manual respectively. Title pages
will be prepared in manuscript.

WAR DIARY or INTELLIGENCE SUMMARY.

(Erase heading not required.)

Army Form C. 2118.

368

Place	Date	Hour	Summary of Events and Information	Remarks and references to Appendices
No 1 A.C.C.S.	10 ^h		Received patients - Quiet day 8.9.7.	
	11 ^h		Examined patients - Quiet day - Church Service at Terdeggham followed by a Review by His Majesty the King - attended by Sister in Charge. Fine day.	
	12 ^h		Received patients fairly quiet day - Very busy night - S/Mrs D. Thompson S/Mrs M. Thompson A.A.N.S. reported for duty from No 3 A.G.H. 8.9.7.	
	13 ^h		Examination of patients - Busy in operating theatre all morning - Busy in wards 8.9.7.	
	14 ^h		Received & examined patients - Busy in all acute wards - S/Mrs Faulkner A.A.N.S. proceeded to report for duty at No 3 A.G.H. 8.9.7.	
	15 ^h		Examined patients - Fairly quiet day. 8.9.7.	
	16 ^h		Received patients - Very busy - 8.9.7.	
	17 ^h		Examined Patients - Fairly busy - 8.9.7.	
	18 ^h		Received Patients - Very busy 8.9.7.	
	19 ^h		Examined Patients - Busy in hospital - Received at 4 am - 8.9.7.	
	20 ^h		Received Patients - Very busy all day in all acute wards - Small examination 8.9.7.	
	21 ^h		Examined & Received - Busy in Acute Surgical Wards - Conference of Matrons & Sisters	

WAR DIARY
or
INTELLIGENCE SUMMARY.

393

(Erase heading not required.)

Place	Date	Hour	Summary of Events and Information	Remarks and references to Appendices
No 10 C.C.S.	21 st		Sister in Charge at D.M.S. 2 nd Army Office to discuss the theoretical training of Nursing Orderlies. E.S.F.	
	22 ^a		Received & Examined Patients - Fairly busy. E.S.F.	
	23 ^a		Examined patients - Fairly busy. E.S.F.	
	24 ^w		Received patients - Quiet day. E.S.F.	
	25 ^w		Quiet day - E.S.F.	
	26 ^w		Received & Examined Patients - Fairly quiet day. E.S.F.	
	27 ^w		Examined Patients - Fairly quiet - S/H M.R. Smith reported for duty from No 1 A.G.H. E.S.F.	
	28 ^w		Received Patients Busy - S/H Nurse Inwards examined to No 11 C.C.S. Sick Sister - Diarrhoea - E.S.F.	
	29 ^{hi}		Examination of Patients - Busy in Chest's Acute Surgical wards E.S.F.	
	30 ⁿ		Received " " " " " "	
	31 st		Examined patients - Sister Carlin + S/H Nurse Jones left with team to proceed to No 58 C.C.S. S/H Nurse N.Z.M.C. left to Proceed to No 58 C.C.S. with Surgical team - Orders received for the removal of Station. E.S.F. B.G. Fleming Head Sister	E.S.F.

WAR DIARY

OF

1st Aust. C. C. S

FOR

August 1918

LIST OF APPENDICES.

- | No. | Subject. |
|-----|--|
| ① | Copy of D.M.S. Operations Order 25B. 1/8/18
2nd Army "East Area + Central Area" |
| ② | Copy of D.M.S. Memo 105/89 2/8/18. ref demands for
X ray material. |
| ③ | Copy of D.M.S. P420/187 6/8/18. relates to quick despatch
of medical teams + their constant readiness for service
but of "waiting" teams |
| ④ | D.M.S. 19/292/3 13/8/18. "Second Army Medical Arrangements
in the event of a hostile attack" |
| ⑤ | Location lists of 2nd Army units 12 noon 3/8/18. |
| ⑥ | Daily Guard states 1 st Aust C.C.S August 1918. |
| ⑦ | Copy of administrative duties etc for month August 1918 |
| ⑧ | Chart showing principal decisions for month August 1918. |
| ⑨ | Copies of Telegrams received at this C.C.S. relative to
move of new units. |
| ⑩ | Copies of reports from G.S. adjutant. Surgeon General. Pathologist
G.M. to D.M.S. A.S.F. for August 1918 |
| ⑪ | Copy of report furnished by G.S. 17 C.C.S. to D.M.S. 2nd Army on
a move by his station with 7 heavy loads of material. |

D.M.S., Second Army No. 19/236/24. COPY

MEDICAL ARRANGEMENTS, SECOND ARMY

OPERATION No. 25.B.

SECOND ARMY EAR, NOSE & THROAT CENTRE

1. The Second Army Ear, Nose & Throat Centre is attached to 58 CCS.
2. Cases of disease of the Ear, Nose & Throat, requiring special treatment, will be sent to this Centre under arrangements made by D.D's.M.S.
3. The days on which cases may be sent are as follows :-

Monday	II Corps	Thursday	XV Corps
Tuesdays	VII Corps	Friday	XLX Corps
Wednesday	X Corps		
4. All cases other than urgent must arrive before 9-30 a.m. on the day allotted. Urgent cases can be sent at any time.
5. Officers who wish to consult the ear, nose & throat Specialist may make appointments through D.D's.M.S. or A.D's.M.S. concerned.
6. Nominal rolls must accompany each batch of patients.
7. Every effort will be made to send cases to this centre on the same cars which take cases to the Ophthalmic Centre.
8. The above arrangement will come into force forthwith.

F. D. G. Howell,

Headquarters
Second Army
1st August 1918.
M.

Lieut-Colonel
for Major General,
Director of Medical Services

D.M.S., Second Army No. 165/89 (COPY)

2

A.D.M.S., St. Omer
Os.C., Stat: Hosps: & C. C. Stns.
Os. i/c Mobile X Ray Units.

In future all demands for X-Ray apparatus and material will be submitted through Captain W. S. FINZI, R.A.M.C., attached No. 10 C. C. S.

This Officer, after perusal, will if necessary, amend indents, initial all alterations and then transmit the demands for the approval of D.M.S. They will, if approved, be returned from this Office to the Unit concerned.

H.Q., Second Army
2.8.18
M.

F.D.G. Howell,
Lieut-Colonel,
for Major General
Director of Medical Services.

O.C. 1st. Australian C. C. S.

1. The situation may demand the services of Second Army Surgical Teams elsewhere than in this Army Area.
2. It is important that the movement of Surgical Teams be carried out with dispatch and that the minimum period of time be spent between receipt of orders and commencement of duty.
3. In order to carry the above into effect and to avoid any unnecessary delay the undermentioned Surgical teams are earmarked for duty outside the Army in case of necessity and members thereof will hold themselves in readiness to move with surgical equipment indicated below, at short notice :-

Surgical Teams

(1) Major R. D. Douglas,	A.A.M.C.	1st. Aus:G.Hp:	att. 3 Aus:CCS
(2) Lt. Col. P. Fiaschi,	A.A.M.C.	3rd. " " "	att: 1st. Aus:CCS
(3) Capt: H. S. Bush,	A.A.M.C.	1st. " " "	att: 2nd. Aus:CCS
(4) Capt. C.G. Aickin,	N.Z.M.C.	New Zealand St:Hp:	
(5) Major C.H. Crawshaw,	RAMC TF	64 C.C.S.	
(6) Capt: E.W. Blake,	RAMC TC	18 C.C.S.	
(7) Capt. J. Oag,	RAMC TC	36 C.C.S.	att: 10 C.C.S.
(8) "B" Team		1st. Canadian C.C.S.	
(9) Capt. A.H. Bostock,	RAMC TC	17 C.C.S.	att: 62 C.C.S.
(10) Capt. G.E. Sutton	MORC USA	36 C.C.S.	att: 2 Can.CCS

4. Surgical Teams for duty outside the Army Area will be comprised of the following personnel :-

- | | |
|-----------|-----------------------------|
| 1 Surgeon | 1 Anaesthetist |
| 1 Sister | 2 Operating Room Attendants |
| 1 Batman | |

5. The following Surgical Equipment will be taken with each Team :-

- | | |
|---------------------------|-----------------------|
| 1 Operating Table | 10 Sharp scalpels |
| 18 Artery forceps | 4 Dissecting forceps |
| 6 pairs assorted scissors | 2 large Retractors |
| 8 Towel clips | 2 small Retractors |
| 4 Lane's tissue forceps | 2 Intestinal clamps |
| Anaesthesia apparatus | Instrument sterilizer |

6. This office will be notified at once of any casualties that may occur in the above teams.

7. Acknowledge.

H.Q., Second Army
6-8-18
M.

Sd. F. D. G. Howell
Lieut-Colonel,
for Major General
Director of Medical Services.

SECOND ARMY MEDICAL ARRANGEMENTS IN THE EVENT OF HOSTILE ATTACK.

The following arrangements have been made in conjunction with A.D.G.T., Second Army and will come into force as soon as active operations of a determined character commence.

1. IInd. Corps. A Shuttle Temporary Ambulance Train, accommodating 400 sitting cases (or 250 sitting & 48 lying cases) will ply between BANDAGHEM and BERGUES on the broad gauge line; stock will include 6 covered trucks for lying cases. This T.A.T. will be available for loading at BANDAGHEM within 4 hours of notification that this service is required. The approximate time taken up on the journey from BANDAGHEM to BERGUES and back will be two hours.
2. XIXth. Corps. Metre gauge trains (14 trucks) each accommodating 350 sitters (150 sitting and 48 lying) will run from WATOU Town Siding (K.5.a.4.5.Sh.27) to BERGUES, or if required by E.M.O. at any point between WATOU Village and ST. JAN-TER-BIEZEN Station and BELL CAMP 27/L.3.b.3.8. This service will be available within 6 hours of notification. A two hourly service will be run from the first mentioned siding during times of pressure - otherwise according to demand.
Arrangements regarding entrainment to be made by D.D.M.S. concerned.
3. Xth. Corps.
(a) Full use to be made of light railways for conveyance of wounded to ESQUELBECC. Arrangements to be made by D.D.M.S., & Corps L.R. Officer concerned.
(b) In addition to light railways, a Metre Gauge Train Service (14 trucks) to begin 6 hours after Zero, will run from WAGENBRUGE NORTH to ESQUELBECC. A two hourly service from this station will be arranged during times of pressure - otherwise on demand. 350 sitters or 150 sitting and 48 lying can be accommodated in each train. This service will be available and should be used for entraining wounded of the Northern Division of XV Corps.
D.D's.M.S. of X & XV Corps will mutually arrange details.
4. XV Corps (or 250 sitting & 48 lying)
(a) A Broad Gauge Shuttle T.A.T. accommodating 400 sitters will ply between EBBLINGHEM Station and ARQUES or U.15.c. if situation so demands. This train will be available for loading within 3 hours of notification. A two hourly service will be run during times of pressure - otherwise on demand.
(b) A Shuttle Train will be arranged to run from U.6.c. (where main road from HONDEGHEM crosses line) to ARNEKE or ESQUELBECC. Should the military situation dictate the necessity and U.6.c. becomes untenable, entraining points will be arranged at O.29, Central or CASSEL Station. It is considered this service is unlikely to be required until the second day of fighting. This service (b) would only be arranged if WAGENBRUGE NORTH became untenable or EBBLINGHEM and U.15.c.
5. D.D's.M.S. will arrange for an ample supply of ladders at all entraining points unprovided with properly constructed platforms.
6. D.D's.M.S. concerned will note that the French operate the Metre Gauge line and there are no British R.T.O's in the neighbourhood of the entraining points indicated above. The Metre Gauge service is controlled by the R.T.O. BOLLEZEELE. It is essential for successful evacuation of wounded by Metre Gauge that communication be established between entraining points and this Officer.

/D.D's.M.S.

D.D's.M.S. concerned should endeavour to establish telephonic communication if possible, and failing this, a Motor Despatch Rider Service should be organised to run between entraining points and nearest telephone exchange.

7. All walking wounded of Xth & XIX Corps conveyed in lorries and not by rail will be evacuated to C.C.S's at ARNEKE.

8. D.D's.M.S. will issue the necessary instructions to ensure that only the stretcher cases selected for conveyance by rail are those that are well able to stand the journey and not considered likely in any way to suffer by that method of conveyance.

9. 10 Other Ranks under a reliable N.C.O. will be detailed by D.D's.M.S. concerned to assist at detraining Stations, as soon as possible after operations have commenced. This party will be billeted and rationed by C.C.S. or Stationary Hospital receiving their cases as indicated below :-

<u>IIInd. Corps</u>	A N.C.O. & 10 men attached	44 C.C.S. BERGUES.
<u>XIX Corps</u>	" " "	44 C.C.S. BERGUES.
<u>Xth. Corps</u>	" " "	2 Can: C.C.S., ESQUELBECQ
<u>XVth. Corps</u>	" " "	4 Stat: Hosp: ARQUES.

10. Please report when your arrangements are completed.

11. The attention of D.D's.M.S. is invited to A.D.G.T. No. AMB.5, dated 8.8.18. memorandum on "Emergency Ambulance Trains in case of Hostile Attack" and amendment thereto regarding same number dated 10.8.18 particularly with regard to Service "F" (Copies to D.D's.M.S. herewith).

H.Q., Second Army.

13.8.18.

M.

Ambr R
Major General,
Director of Medical Services.

Copies to:- D.G.M.S.,
Second Army "A"
Second Army "Q"
A.D.G.T., Second Army.
H.Q., Corps.
D.D's.M.S., Corps (with additional copies for A.D's
M.S. Divisions).
A.D.M.S., St. Omer.
R.T.O., BOLLEZEELE.
Os.C., Stat: Hosps:
Os.C., C. C. Stns.

(This Office No. 19/299/2 dated 7.8.18 is hereby cancelled.)

S E C R E TSITUATIONS OF MEDICAL UNITS
SECOND ARMY TROOPS
12 Noon 3rd. August, 1918.

M.S. No. 52.

CASUALTY CLEARING STATIONS.

BLENDÉCQUES.
No. 1, Aus: - Sh.36d.NE/F.5.b.7.6.
No. 2 Aus: - Sh.36d.NE/F.5.b.9.6.
WATTEN.
No.36 - Sh.27a.NE/L.19.c.5.5.
No.64 - Sh.27a.NE/K.24.c.8.4.
Nr. BERGUES.
No.10 - Sh.19/U.9.c.Central.
No.44 - Sh.19/O.20.b.7.7.
LONGUENESSE.
No.58 - Sh.27a.SE/X.16.b.7.7.

ESQUELBECQ.
No. 3 Aus: - Sh.27/B.6.c.7.1.
No. 2 Can: - Sh.27/C.7.b.1.4.
ARNEKE.
No.62 - Sh.27/I.19.c.8.3.
@-No. 1 Can: - Sh.27/I.19.c.3.5.
@-No. 4 Can: - Sh.27/H.11.d.0.3.
BOURG nr WISQUES.
@-No.17 - Sh.27a.SE/W.29.a.3.3.
MAI-ASSESE.
No.18 - Sh.27a.SE/X.17.d.9.7.
MOULLE.
No.11 - Sh.27a.SE/Q.11.c.4.8.

HOSPITALS.

CLERQUES nr LICQUES
No. 10 Stationary.
Sh.Calais 13/F.5.85.55.

ARQUES.
No.4 Stationary

BOURG nr WISQUES.
New Zealand Stationary.
Sh.27a.SE/W.29.b.3.8.

LONGUENESSE.

No.9 B.R.C.(Duchess of Sutherland's)
@ - Closed) Sh.27a.SE/X.10.c.2.1.

MOTOR AMBULANCE CONVOYS.

£-No. 2 (att Army) Sh.27/C.29.c.1.3.
No. 4 (att II Corps) COST CAPPEL
(Sh.19/W.19.b.6.8.)
Ø-No. 5 (att Army) WATTEN
(£ - Two Sections att: XIX Corps.
(Ø - One Section of each att: X Corps)

No.14 (att XV Corps) RACQUINGHEM
No.20 (att Army) Nr. St Omer.
Ø-(Sh.27a.SE/X.12.c.Cent:)
F.A.N.Y.(att ADMS St Omer)MAL-ASSESE

ADVANCED DEPOTS OF MEDICAL STORES.

No. 2 BLENDÉCQUES No.11 ARNEKE No. 2 Can: ESQUELBECQ

MOBILE LABORATORIES.

No.1 (Bac) Nr BERGUES(att 10 CCS)
No.4 (Hyg) BOURG

No. 8 (Bac) WATTEN (att 64 C.C.S.)
No.11 (Bac) BLENDÉCQUES(att 2 Aus:CC)

MOBILE X-RAY UNITS.

No. 3 ESQUELBECQ (att 2 Can: C.C.S.) No. 7 ARNEKE (att 62 C.C.S.)

OPHTHALMIC CENTRE ... LONGUENESSE (att 58 C.C.S.)
EAR, NOSE & THROAT CENTRE ... LONGUENESSE (att 58 C.C.S.)
MECHANICAL DENTAL CENTRE. ... LONGUENESSE (att 58 C.C.S.)
No. 4 MOBILE DENTAL UNIT. ... ARNEKE (att 62 C.C.S.)

SANITARY SECTIONS.

No.13 (att XIX Corps)
(K.35.d.8.8.Sh.27)
No.25 (att II Corps)
(F.29.d.5.9.Sh.27)
No.42 (att II Corps)
(E.7.a.3.3.Sh.27)
No.45 (att XIX Corps)
(I.17.b.2.7.Sh.27)
No.47 (att Army) LUMBRES

No.49 (att XV Corps) BLARINGHEM
No.56 (att Army) MOULLE
No.71 (att Army) RUBROUCK
No.72 (att Army) HEURINGHEM
No.81 (att II Corps) F.11.b.4.5.Sh.27.
No.82 (att X Corps) BAVINCHOVE
No. 2 Aust'n (att XV Corps)
(V.21.b.Cent:Sh.27)
N. Z. (att X Corps) P.5.a.8.5.Sh.27.

SANITARY SQUADS.

No.28 POFERINGHE
No.29 E.13.c.5.9.Sh.27.
No.38 EBBLINGHEM
No. 2 ST OMER

RAILHEAD SQUADS.

Nos. 1. 9. 53. 37. 39. 41 & 42
N.C.O's. and men distributed to
Railheads in Army Areas.

H.Q., Second Army.
3.8.18.
M.

J. S. Howell
Lieut. Colonel,
for Major General,
Director of Medical Services.

RCDIG1015163

5	8	18	6	8	18	7	8	18	8	8	18	9	8	18	10	8	18	11	8	18	368
11 A.M.	7 P.M.		11 A.M.	7 P.M.		11 A.M.	7 P.M.		11 A.M.	7 P.M.		11 A.M.	7 P.M.		11 A.M.	7 P.M.		11 A.M.	7 P.M.		368
4	300	304	212	358		405	296		206	331		498	305		215	225		208	208		
5	293	289	382	235	TOTAL	188	297	TOTAL	391	263	TOTAL	96	288	TOTAL	378	368	TOTAL	387	285	TOTAL	
6	133	4	133	5	149	150	49	2	55	12	138	197	172	3	125		24	26	19	2	30
7	200		92				110		103	7			188		89	14		37			
8	1			2			1	1				3	1		2	1		1			
9	4	17	1	7			1	2		2	5		3	11		1	1		2	6	
10	4	17	1	7			1	2		2	5		3	11		1	1		2	6	
11	46	31	31	26		26	29		29	36		39			1			36			
12	45 ^L	47 ^S		32 ^L	85 ^S	58 ^L	53 ^L	45 ^S	4 ^S	23 ^L	55 ^S	192 ^L	77 ^S	9 ^L	16 ^L	3 ^L	2 ^S	1 ^L	3 ^S	4 ^L	3 ^S
13		1 ^L				6 ^L	4 ^L		5 ^L			2 ^L									
14																					
15																					
16		1 ^L				4 ^L	1 ^L		1 ^L	1 ^L		1 ^L	23 ^L		2 ^L	5 ^L					
17	2	2 ^S	2 ^L	3		4 ^L	1 ^L			1 ^S		1 ^S									
18																					
19																					
20														2 ^L	2 ^L	2 ^L		2	2		
21	5	6					3		1	1				4					1		
22	5		6			1			2	2				2	5						
23	87	90	89	95		96	99		98	100		98	106		105	105		105	104		

12	8	18	13	8	18	14	8	18	15	8	18	16	8	18	17	8	18	18	8	18	
11Am	7Pm		11Am	7Pm		11Am	7Pm		11Am	7Pm		11Am	7Pm		11Am	7Pm		11Am	7Pm		368
4	208	207	257	203		193	231		240	189		182	227		360	296		236	271		
5	386	386	347	380	TOTAL	404	362	TOTAL	356	407	TOTAL	412	368	TOTAL	237	297	TOTAL	357	349	TOTAL	
6		19	21	51	18	64	1	45	57	6	4	5	42	49	134	3	136		65	102	
7		18					14			50		5				65		60	59		
8		1					1			1		1			1	2		1			
9	6	1		1	13			7		1			5			2					
10	6	1		1	13			7		1			5			2					
11	26	22		23			12					8			10			10			
12	5 ^L	5 ^L		22 ^L	10 ^L		2 ^L	22 ^L		29 ^L	1 ^L	2 ^L	25 ^L		116 ^L	100 ^L		51 ^L	40 ^L		
	3 ^S	3 ^S		21 ^S	2 ^S		2 ^S	13 ^S		15 ^S		2 ^S	5 ^S		30 ^S	1 ^S		1 ^S	13 ^S		
13																					
14																					
15																					
16										2 ^L											
17																		1 ^L			
18																					
19																					
20	2							1													
21	5	12			1		1	8		8		4	4		1						
22		1		12								5			2						
23	103	111		103	104		103	106		106	98	101	106		105	106		106	106		

APPENDIX 6

11Am	7Pm.		11Am	7Pm.		11Am	7Pm.		11Am	7Pm.		11Am	7Pm.		11Am	7Pm.		11Am	7Pm.	
19	8	18	20	8	18	21	8	18	22	8	18	23	8	18	24	8	18	25	8	18
4 307	328		238	242		204	206		177	202		179	183		181	191		223	225	
5 317	366		372	353		390	387		420	391		416	410		412	404		371	370	
6 94	30	TOTAL 94	35	19	TOTAL 54	4		TOTAL 4	1	29	TOTAL 33	28	6	TOTAL 22		18	20	34	2	43
7 56	88		37			36			22	1		49				8				
8 2			2	3		1	4		1	1		1			2					
9 6			3	2		12	1		12			2			2	3		5	5	
10 6			3	2		12	1		12			2			2	3		5	5	
11 12			12			12														
12 53 ⁴	17 ⁴		3 ⁴	17 ⁴		2 ⁴	6 ⁴			6 ⁴		1 ⁴	6 ⁴		5 ⁴	2 ⁴		38 ⁴	38 ⁴	
12 17 ⁵	1 ⁵		5 ⁵	5 ⁵		1 ⁵	1 ⁵			9 ⁵						4 ⁵		7 ⁵	7 ⁵	
13																				
14																				
15																				
16																				
17																				
18																				
19																				
20																				
21 1	1									4										
22			1						1			3				1		1		
23 103	106		102	100		96	104		103	103		99	101		101	101		98	102	

APPENDIX

6

11Am.	7Pm.		11Am.	7Pm.		11Am.	7Pm.		11Am.	7Pm.		11Am.	7Pm.		11Am.	7Pm.		11Am.	7Pm.	
26	8	18	27	8	18	28	8	18	29	8	18	30	8	18	31	8	18	1	9	18
4	178	203	219	168		170	190		171	168		170	159		155	148		148	112	1
5	419	393	375	425		428	406		424	425		426	435		438	445		445	480	3
6	3	25	TOTAL 30	23	TOTAL 25	22	32	TOTAL 32	30	3	TOTAL 25	8	13	TOTAL 13	19	11	TOTAL 11			480
7	50			51					46	1			18		22					31
8				1			2		1			2				3				1
9	1	3	2	8		3	4		1	4			1		1	12				5
10	1	3	2	8		3	4		1	4			1		1	12				5
11																				
12	1 ^s	18 ^L 2 ^s	35 ^L 7 ^s			5 ^L 2 ^s	13 ^L 6 ^s		2 ^L	5 ^L 1 ^s		9 ^L 1 ^s	4 ^L		1 ^L	8 ^L		19 ^L		
13						1 ^L														
14																				
15																				
16																				
17																8 ^L		7 ^L		
18																				
19																				
20																				
21		9					1		1			2	1		2	2				
22	1		6			2				1					1	2				
23	101	106	103	96		92	90		89	93		93	92		91	90		90		90

APPENDIX 6

APPENDIX

6

RETURN FOR MONTH ENDING

31st AUGUST 1918

BRITISH, All admissions etc.	Officers		Other Ranks	
	S	W	S	W
Remained last day of preceding month	10	8	220	145
Admitted during month	20	53	619	1187
Transferred from other C.C.S's.	-	-	-	-
Died during month		3	1	56
Transferred during month, to Base	16	56	551	857
do do C.C.S's	4	-	135	332
do do Rest Stations	-	-	-	-
Discharged to duty during month	7	1	50	16
Remaining last day of month. (midnight)	3	1	102	71

French Soldiers, admitted sick 1.
 French soldiers, transferred to C.C.S. sick 1

Cape Boys, admitted sick 3
 Cape Boys, evacuated to Base, sick 1
 Cape Boys, transferred to O/C.C.S. 1
 Cape Boys, died sick. 1

	Officers	Other Ranks
German Prisoners of War, remained, wounded.	1	4
German Prisoners of War, admitted, wounded	2	48
German Prisoners of War, evacuated to Base	3	45
German Prisoners of War, died, wounded	-	4
German Prisoners of War, remaining, wounded	-	3

To.

D. M. S.

L of C.

J. H. M. in Major
 Adjutant, 1st Australian C.C.S.

CHART SHOWING PRINCIPAL DISEASES ADMITTED DURING MONTH OF AUGUST 1918.

1.		I.C.T.	134.
2.		P.U.O.	108.
3.	Sprains, Contusions etc.	66.	
4.	Debility	45.	
5.	Cardiac Disease	35.	
6.	Myalgia	33.	
7.	Synovitis of Joints	29.	
8.	Diarrhoea	27.	
9.	Bronchitis	25.	
9.	Tonsillitis	25.	
10.	Gastritis	23.	
10.	Otitis Media	23.	
11.	Haemorrhoids	19.	
11.	Veneral Disease	19.	
12.	Influenza	17.	
13.	Appendicitis	16.	
14.	T/Fever Nephritis	14.	
15.	Nephritis	11.	
16.	Scabies	9.	
17.	Hernia.	8.	
18.	Dysentery	4.	
19.	Pleurisy	3.	

TO/

D. M. S.

Second Army.

J. H. M.

Major.

Adjutant, 1st. Australian C.C.S.

Prefix.....	Code.....	Words..... £ s. d.	Received From.....	Sent, or sent out At..... m.	Office Stamp. 9
Charges to collect			By.....	To.....	
Service Instructions. <i>Copy</i>					
Handed in at..... Office..... m. Received..... m.					
TO <i>O/c 1st Australian CCS</i>					
*Sender's Number <i>P 25</i>		Day of Month <i>31st</i>	In reply to Number		AAA
<i>From midnight 31st 1st and 2nd.</i> <i>Australian CCS will be closed and</i> <i>wounded will be sent 18th and 58th CCS.</i> <i>commencing 18 CCS midnight 31st/1st and</i> <i>sick will be sent as heretofore 18 CCS and</i> <i>N.Z. Stationary Hos. except Sundays when</i> <i>they will go to 58 CCS addressed DMS.</i> <i>15th Corps repeated 18 and 58 CCS and</i> <i>N.Z. Stationary Hospital.</i>					
FROM <i>DMS. 2nd Army</i>					
PLACE & TIME					

Prefix.....	Code.....	Words..... £ s. d.	Received From.....	Sent, or sent out At..... m.	Office Stamp.
Charges to collect			By.....	To.....	
Service Instructions.					
Handed in at..... Office..... m. Received..... m.					
TO <i>O/c 2nd A.C.C.S.</i>					
*Sender's Number		Day of Month <i>31/8/18</i>	In reply to Number		AAA
<i>Please arrange conjunction with</i> <i>O/c No 1 A.C.C.S. to visit squares</i> <i>situated 27 V 4 9 16 with a view</i> <i>of selecting C.C.S's.</i> <i>An ambulance en route to you</i> <i>10 hours to morning and</i>					
FROM <i>DMS. 2nd Army</i>					
PLACE & TIME					

D. M. S., A. I. F.

L O N D O N.

Attached please find reports from Registrar, Surgical Specialist, X-Ray Specialist, Quartermaster and Dentist.

These reports cover the working of the unit which as will be seen has been very steady.

The arrangement by which the sick were evacuated to other C.C.S's.. practically transformed the unit to an operating centre.

The only change in Officer personnel during the month. was the departure of Chaplain S. E. DORMAN, and I wish to take this opportunity of placing on record the value of his services.

By taking charge of the Library, it was possible for the patients to get literature easily and freely, his interest in sport and the energy he put into organising it in the unit, was of very great value.

During several periods of battle stress, while he was with the unit, Chaplain Dorman volunteered to assist in any manner, and was of great help in the Operating Theatre in giving Anaesthetics.

His departure was a very great loss to the unit.

Agst Mark
Lieut-Colonel.
Officer Commanding,
1st. Australian C. C. S.

A.I.F.

I have to report another month of steady work for this station. The number of sick arriving at the opening of this period showed a gradual increase. As in July, these cases were being received from 15th. Corps (2nd Army) but also from 5th. Army formations (left flank)

Owing to the steady encroaching on the enemy's positions, the station was placed in the anomalous position of being further from our own front line, as a first Echelon C.C.S., than whilst acting as a 2nd line station. The time occupied by cases in reaching the station varied considerably, it is noteworthy that following the action which resulted in the capture of the Outersteene ridges, the cases took but 4 hours to arrive here from the front line. Towards the end of the month a number of cases were admitted who had been wounded 24 hours previously, in some of these cases the circumstances attendant upon them being wounded, e.g. in the open and close to the enemy lines etc., explained this long period, other cases had apparently been held at Field ambulances for a much longer period than usual.

A large number of sick was received on each admitting day until 8. 8. 18. Instructions were received on the 6. 8. 18., that from 8. 8. 18., all sick cases from 15 Corps would be disposed of as follows:-

To 18 C.C.S., on Mondays, Wednesdays and Fridays, to New Zealand Stationary Hospital on Tuesdays, Thursdays and Saturdays, 1st and 2nd Australian C.C.S.'s on alternate Sundays. The majority of sick were being received from 5th. Army formations, and it was not until the latter began disposing of their sick within the army that the number of sick received fell to zero, except on alternate Sundays.

The Gassed cases admitted during the month were heavy. 68 on 5. 8. 18., 167 on 8. 8. 18., 94 on 17. 8. 18., and batches of 10 - 20 on other receiving days.

The Chemical Adviser of the Corps concerned has to be notified if more than 20 gassed cases from any one unit in his formation, are received at C.C.S., in a batch.

The Surgical work was constant and during the period 18 to 20th 8. 18. was heavy.

The Surgical Teams ^{attached} ~~alotted~~ underwent several changes. The month opened with Lieut-Col FIASCHI and Captain CAMPS attached. On 3. 8. 18. Capt. RAILTON, M.C., reported to relieve Major WHITEMAN as Anaesthetist to Col. Fiaschi. On 7. 8. 18., the above surgeons with their teams were ordered to report to 20th and 4th. C.C.S.'s respectively. They were replaced by Captain OAG, RAMC, and Captain ALGUIRE, CAMC. On 9. 8. 18 the latter was ordered to report to 48 C.C.S., and was replaced by Captain GUTHRIE, NZMC.

On 18. 8. 18, the attack on Outersteene Ridge opened at 11 am., the first wounded arrived at this Station at 3 pm. The cases were all severe but arrived in good condition. The first 100 were received by 4-45 pm, and No 2 Aust. C.C.S., were diverted to. They re-diverted on receiving 100 at 6-30 pm. The second 100 were received by 9-40 pm.

German prisoners, whose arrival generally signifies the end of a rush began to arrive in some numbers at 7-30 pm. 23 in all. D.M.S. arranged that all cases should be diverted to No 9 B.R.C.S. Hospital between 10 pm and 10 am, 19. 8. 18. This allowed good headway to be made with the work and all the operable cases were finished early on the morning of 19. 8. 18.

The Nissen Hut (H.P.) which had just been completed and was awaiting fitting out as a resuscitation, as apart from a pre-operative ward, was used for theatre cases not requiring resuscitation, whilst the old pre-operative ward was well heated up, and served well as a resuscitation ward.

On 19. 8. 18. No 2 Aust. C.C.S., received. It was agreed that they should divert to us if necessary. No information could be gained from D.M.S., as to whether there was any likelihood of a rush during the day. It is a very great help if a hint can be given as to

the prominence of any heavy work, since it allows of arrangements being made to conserve the teams to the best advantage.

On 20. 8. 18 at 3 am., No 2 Aust C.C.S., asked that we might receive, and up to 8 am 47 cases were admitted. On 20. 8. 18. No 9 B.R.C.S. Hospital received (an arrangement having been come to whereby that unit was to receive cases on Tuesdays) Corps had not been notified of this and the diverting of the cars had to be done at No 1. and No 2 Aust. C.C.S's, after the serious cases had been taken off. It thus came about that our admissions of wounded on this date were over 60 serious cases, which kept the teams going hard well into the night.

No 9 B.R.C.S., asked that we might receive at about 7 pm., as they could take no more, but D.M.S., on being told how we were situated, arranged that No 18 C.C.S., should take in.

After this period the work was much steadier.

During the month the initial dose of Anti-toxin (Tetanus) in all cases was fixed at 1500 units.

On the 31st., orders were received to move to Elbinghem to former site of No 15 C.C.S. Later on in the day D.M.S., notified the O.C. that the move to Elbinghem might be regarded as in abeyance, since the enemy retirement made it likely the station would move to Hondeghem.

The teams and attached teams were ordered to 58 C.C.S., as the station closed from midnight 31. 8. 18-1. 9. 18. All possible sick were evacuated, and those too ill to move segregated to Ward 3, to allow of all possible tents being struck, and the work of striking camp was immediately begun.

No 1454 Lance Corporal D. YOUNG, was selected for transport duty during the month, ^{as} being a married man with a home in Australia and having left there in 1914.

Appended is (1) A chart showing the principal diseases admitted during the month. (2) Table of admissions, discharges etc., during month.

D. Munro
Major.
Adjutant and Registrar,
1st. Australian C. C. S.

RESUME of the Q.M.Dept.for the month of AUGUST,1918.

1st.Australian Casualty Clearing Station.

~~~~~

I wish to bring under your notice the following suggestions with regard to stretcher-slings and porchways of tent,Marquee H.P. small :-

SLINGS,STRETCHER :-

I am continually returning to the Ordnance Officer,quantities of surplus stretcher slings. To overcome this wastage,I would suggest that stretchers be issued without slings and that an establishment be laid down for the number of slings which each F.Amb.,C.C.S.,and other units should carry. If this were done stretcher bearers could be issued with a sling as a portion of their equipment.

PORCHWAYS of TENTS,MARQUEE,H.P.SMALL :-

With each tent,marquee,H.P. small (Swiss Cottage pattern) there are issued 2 porchways,with necessary poles, valises,pegs etc. for same. As the majority of this class of marquee is brigaded in sixes at C.C.Stations,I would suggest that 4 porchways to each 6 marquees be issued by the Ordnance Depot.

A Casualty Clearing Station is allowed 81 Tent Marquees,H.P.Small and if my suggestion was availed of,only 54 porchways would be issued or manufactured for issue to each C.C.S. instead of 162 as at present,with a consequent saving of 108 porchways.

I have returned to Ordnance all porchways over the scale ,I have laid down for myself.

If effect could be given to the foregoing suggestions,a large quantity of material,labor in manufacture,freight etc.would be saved to the nation.

THRESH DISINFECTORS :-

I have to report the receipt of a "Thresh" disinfecter from No.18 C.C.S.

The "Thresh" disinfecter when travelling on the pave,invariably breaks the pins which hold the wheels on to the short axles,with the result that the vehicle capsizes and lies in the roadway until such time as a breakdown gang arrives or is available. This causes much inconvenience especially during a rapid move. If the makers could be informed of this weakness perhaps they could remedy same.

HORSEFALL DESTRUCTORS :-

Now that there is every likelihood of C.C.Stations continually moving forward ,I would suggest that they be equipped with Horsefall destructors at the rate of one per C.C.S.

When making rapid moves this type of destructor can be easily taken to pieces and when transported to the new location be re-erected and made fit for use in a few hours.



HORSEFALL DESTROYERS (Cont.)

The R.E's. at present erect a brick incinerator which not only takes time and much labor and material to construct, but is likely to become a dead loss on a C.C.S. moving forward.

The Horsefall type will last for years and the first cost is the last cost, outside of minor repairs and ordinary depreciation.

CONSTRUCTIONAL WORK :-

During the month, a hospital Nissen hut with an annex has been erected, also revetted.

TAILOR :-

I again wish to bring before you the fact, that if a tailor (P.B.man would meet the case), were provided, at least 50 % of the regimental clothing handed in for replacement could be repaired.

Much surplus equipment was returned to the O. Officer during the month.

During the month the following waste was saved and returned to the Base:

|                           |          |
|---------------------------|----------|
| Paper and Cardboard       | 656 lbs. |
| Hessian packing           | 398 "    |
| Candle ends & pieces soap | 105 "    |
| Sacks                     | 30 "     |

of tin sheeting  
There is 189lbs awaiting to be returned to the No. 14 Ordnance Depot.

STEWARDS STORE :-

RATIONS:- These on the whole have been ample and of good quality.

DIETS:- The following diets were issued to the cookhouse :-

|           | <u>Fluid</u> | <u>Soft</u> | <u>Full</u> |       |
|-----------|--------------|-------------|-------------|-------|
| AUG. 1-15 | 262          | 4475        | 9287        |       |
| " 16-31   | 83           | 2535        | 9208        | Total |
|           | 345          | 7010        | 18495       | 25850 |

LINEN AND CLOTHING STORE :-

All patients returning to duty have been fully equipped before marching out.

LAUNDRY :- 32320 pieces were washed by the Army laundry during the month.

Bootmaker From August 1st to the 15th the following boots were repaired :-

|               |              |
|---------------|--------------|
| <u>Heeled</u> | <u>Soled</u> |
| 23            | 15           |



PACK-STORE.:-

Salvage :- The following articles <sup>were</sup> ~~were salvaged and~~ handed over to the O.O. 2nd Army Troops No.1 :-

## ----- Unserviceable equipment -----

|                         |    |                         |    |
|-------------------------|----|-------------------------|----|
| Tents, operating        | 1  | Aprons oper. W.P.       | 7  |
| " C.S.L.                | 2  | Bottles H.W. Rubber     | 2  |
| " Marquee H.P. sml.     | 9  | Canvas bottoms, marquee |    |
| Valise " " "            | 1  | sets                    | 14 |
| Marquee H.P. lge. roof  |    | Stretchers F.A.         | 34 |
| outer                   | 2  | Box, staty. field       | 1  |
| Burners, Primus         | 24 | Plates, dinner enam.    | 36 |
| Pails slop              | 3  | Pannikans pt. "         | 30 |
| Saws hand 26"           | 1  | Basins 6" "             | 1  |
| Stoves, oil heating     |    | " 14" "                 | 12 |
| 200cp.                  | 5  | Lamps, hurricane        | 2  |
| Brooms bass             | 1  | Brushes, sweepg. long   | 5  |
| Lamps oper. acety. lge. |    | " hand scrub            | 4  |
| hanging                 | 2  | Knives, flaying         | 2  |
| Knives, cutting         | 1  |                         |    |

## ----- Surplus equipment -----

|                                            |     |
|--------------------------------------------|-----|
| Porchways of Marquee H.P. small (complete) | 32  |
| " " " (without poles)                      | 18  |
| Bags pin porchway                          | 7   |
| " " Large                                  | 10  |
| " " Small                                  | 25  |
| Valises porchway                           | 25  |
| Poles, walls sets                          | 23  |
| " Marquee H.P. sets                        | 4   |
| Curtains Tent Marquee H.P. small           | 27  |
| Roof inner " " "                           | 1   |
| Windows " " " sets                         | 31  |
| Slings stretcher ambulance                 | 400 |
| Stoves oil primus No.5                     | 4   |
| " " Beatrice                               | 1   |
| Lamps hand acety                           | 4   |
| Warmers stomach                            | 24  |
| Spoons                                     | 190 |
| Forks                                      | 160 |
| Knives                                     | 105 |
| Refills extincteurs                        | 24  |
| Ladder rope                                | 1   |
| Handles broom                              | 36  |
| Mattresses hospital                        | 24  |
| Sheets ground                              | 70  |
| Pillows hospital feather                   | 15  |
| Cases bolster barrack                      | 354 |
| " paillias tent                            | 300 |
| Pillows stretcher                          | 200 |
| Flags directing pennants                   | 4   |

## --- Returned to O.C.2 A.M.T.T.Coy. ---

|             |                      |   |
|-------------|----------------------|---|
| Tubes inner | 920 x 120            | 3 |
| " "         | 26 x 2 $\frac{1}{4}$ | 1 |
| " "         | 28 x 1 $\frac{3}{8}$ | 4 |
| Tyres outer | " "                  | 2 |
| " "         | 290 x 120            | 4 |



The following SURPLUS EQUIPMENT has been returned to AUSTRALIAN Branch, B.R.C.S. during the month :-

|                        |         |
|------------------------|---------|
| Bed Spreads, blue      | 180     |
| Deck Chairs            | 10      |
| Back Rests             | 20      |
| Camp Stools            | 5       |
| Bed Cradles            | 7       |
| Bed Quilts             | 27      |
| Dressing Gowns         | 119     |
| Ice Chests             | 2       |
| Sterilizers, Autoclave | 3       |
| Tables, anaethetist    | 4       |
| Kettles, Arbuthnot     | 3       |
| M.T. Bandages F/lette  | 5 bales |
| " " Calico             | 1 "     |
| Pads                   | 1 "     |
| Eye Bandages           | 1 case  |

#### SALVAGE :-

The following clothing and equipment has been salvaged, fumigated and returned to O.O. 2nd Army Troops No. 1 :-

|                 |           |                 |           |
|-----------------|-----------|-----------------|-----------|
| Greatcoats      | 549       | Jackets S.D.    | 795       |
| Trousers        | 467       | Cardigans       | 285       |
| Boots           | prs. 1101 | Socks           | prs. 1031 |
| Puttees         | " 414     | Shirts          | 535       |
| Drawers         | 295       | Vests, under    | 51        |
| Caps            | 371       | Kilts           | 51        |
| Braces          | 699       | Breeches        | 111       |
| Boots           | odd 39    | Leather Jerkins | 6         |
| Holdalls        | 98        | Aprons kilt     | 26        |
| Leggings        | prs 2     | Boots German    | prs. 46   |
| Clothing dmgd.  | 298       | Jackets German  | 38        |
| Trousers German | 26        |                 |           |

---

|                     |        |                   |      |
|---------------------|--------|-------------------|------|
| Rifles              | 497    | Steel Helmets     | 880  |
| Ground sheets       | 440    | Mess tins         | 570  |
| Bayonets            | 168    | Equipments        | 562  |
| Water bottles       | 72     | Haversacks        | 286  |
| Packs               | 145    | Respirators       | 351  |
| Field dressings     | 250    | Bandoliers        | 69   |
| Bombs               | 109    | Ammunition S.A.A. | 4896 |
| Equip. straps       | 148    | Spoons            | 485  |
| Knives              | 698    | Forks             | 501  |
| Oil bottles         | 145    | Pull through      | 298  |
| Revolvers           | 5      | Field Glasses     | 2    |
| Sundry sml. equipt. | 3 cwt. |                   |      |

#### POWER-HOUSE :-

The engines were run for 487 hours during the month.

#### TINSMITH :-

Many repairs to Primus stoves etc. were effected during the month.



CARPENTERS :-

The Lance-Corporal in charge of this dept. and his staff are to be congratulated on their excellent work. During the whole time we have been at the present site, we have not had to obtain any outside help. Their work at all times has been most invaluable to this Station.

COOK-HOUSE :-

Nothing further to report.

Bye-products saved during the month :-

|                     | Delivered to Ellis<br>Field Fat Factory. | Consumed in<br>mess | Used in<br>cooking | Total     |
|---------------------|------------------------------------------|---------------------|--------------------|-----------|
| Dripping 1st. Class | 1308 lbs.                                | 105 lbs.            | 92 lbs.            | 1505 lbs. |
| Fat residue         | 392 lbs.                                 |                     |                    |           |
| Bones               | 1064 lbs.                                |                     |                    |           |

SANITATION :-

Nothing further to report.

FIRE PRECAUTIONS & DRILL :-

Nothing further to report.

*R. Johnston*

-----Hon. Capt. & Quartermaster.

31-8-1918.



To/

The Officer Commanding

1st Australian C.C.S.

Sir.

During the Month the C.C.S. has been steadily working as a first line C.C.S.

GAS & OXYGEN ANAESTHESIA

This anaesthetic has been extensively used in cases of bad shock haemorrhage. The Coxeter Sight feed apparatus, and the apparatus constructed by Capt. WELLMAN. A.A.M.C. have proved very efficient, and have enabled us to utilise this anaesthesia in all cases where its use has been indicated. The use made of these two plants has shown that two Gas and Oxygen sets are really an imperative need in every C.C.S.

GAS GANGRENE

Twelve cases of Gas Gangrene have occurred during the month. Of these 3 had received A.T.S. + W serum, all of which died, while of the 9 who were inoculated with A.T.S. + O serum, 6 died. The Welchii Anti-gas gangrene serum is still being used in a certain number of the cases received here.

TRANSFUSION OF BLOOD

In view of the fact that the work has been fairly steady during the month, it has been possible to transfuse a larger percentage of cases than would be possible during Battle crises. Thirty-eight patients have been transfused during the month, and 24 of these have been evacuated, 14 dying. During the month a small annexe has been added to the hut for Resuscitation, to be used as a theatre for transfusion of blood. The provision of this annex would be of marked benefit during periods of battle crisis, as cases for transfusion could be dealt with separately from the main Operating Theatre, and then free surgical personnel and equipment for operative purposes. The provision of Transfusion Teams during "rush" periods would still further free the operative Surgical teams. Bayliss' 6% Sterile Gum Acacia Solution in Normal Saline Solution has been used for the treatment of "shock" cases.

DRESSING ROOM

151 cases have been treated under anaesthetics, and 1109 dressings done.

The Surgical Work has been done by:- Captains CAMPS and OAG. R.A.M.C. Capt. GUTHRIE. M.Z.M.C. Lieut-Col FIASCHI, Major CHAMPION, Capt. BARTON, and Major BELL, and during one period of slight rush, Major GLISSAN. A.A.M.C.

Capt. HAIR A.A.M.C. has continued in charge of the General work of the Chest ward, and a report by him on the work there during the period 17/6/18 to 31/8/18 is appended. A list of Operations done during the month, and a Resume of the more serious cases admitted since the C.C.S. became a first line C.C.S. (17/6/18) is also appended.

*George Bell J.* Major

Surgical Specialist 1st Aust. C.C.S.



Resume of more serious cases during period 17/6/18 to 31/8/18

Since this C.C.S. has acted as a 1st line C.C.S. (17/6/18) the following more serious cases have been admitted. Many of these were suffering from Multiple Shell wounds.

1. Cases of Abdominal injury. 70. Considering these in three classes.

A. Extraperitoneal wounds of Abdominal viscera, and intraperitoneal wounds not included in Class B.

B. Intraperitoneal wounds perforating Hollow viscera.

C. Cases dying on or shortly after admission.

In Class A. 24 cases have been admitted of which 17 were evacuated, 6 have died, and 1 remains in the C.C.S.; a mortality rate of 29%.

In Class B. (28 cases) 12 have been evacuated, 14 dying, a mortality rate of 57%.

The mortality rate of all cases of Abdominal injuries including Class C. (moribund) has been 58%.

2. Fractured Femurs. 68 cases have been admitted of which 6 were moribund.

17 of these have died (6 of which deaths were due to Gas Gangrene, and 6 moribund) a mortality rate of 25%.

Amputation of the Thigh has been done in 32 cases, 19 of which were for severe G.S.W. of thigh with severe comminution of the Femur, and 13 for very severe injuries of leg and knee.

3. Fracture of Skull, <sup>not</sup> including grazes etc. of outer Table.

Class A. where no penetration of the Dura had occurred, although a definite fracture of the skull was present. 14 cases, all evacuated.

Class B. Penetration of Dura mater, 29 cases:— 14 of these died, and 15 were evacuated.

The mortality rate for Classes A. & B. combined reaches 33%.

Class C. 10 cases moribund.

The total mortality rate of all Head cases is 45%.

4. Transfusion of Blood.

This has been done 78 times, and 48 of the recipients have been evacuated.

5. Chest ward report. (1) Total number of Penetrating Chests (including

Chest-abdomens) 102. (2) Number evacuated 93.

(3) Number of Deaths 9. (4) Number requiring operation 17.

(5) Mortality of Operation Cases (6) Number of Moribund Cases 5.



Arteries & Veins ligated

|              |      |                      |      |
|--------------|------|----------------------|------|
| Axillary     | A 1. | Femoral              | Al.  |
| Brachial     | A 6. | Femoral V. & Sciatic |      |
| Ulnar        | A 5. | nerve.               | 1    |
| Radial       | A 2  | Popliteal A. & V.    | 3    |
| Interosseous | A 2. | Ant. Tibial          | A 1. |
|              |      | Post Tibial          | A 7. |
| TOTAL 29.    |      |                      |      |

Joints

|                        |    |
|------------------------|----|
| Shoulder with fracture | 1  |
| Elbow " "              | 3  |
| Elbow without fracture | 1  |
| Knee with fracture     | 6  |
| Knee without fracture  | 2  |
| Ankle " "              | 1  |
| TOTAL                  | 14 |

Amputations

|          |    |       |    |
|----------|----|-------|----|
| Arm      | 9  | Thigh | 19 |
| Forearm  | 2  | Leg   | 4  |
| Fingers  | 15 | Toes  | 5  |
|          |    | Symes | 1  |
| TOTAL 55 |    |       |    |

Fractures

|                        |    |                |    |
|------------------------|----|----------------|----|
| Skull with penetration | 10 | Metacarpals    | 8  |
| Skull without do.      | 3  | Phalanges      | 3  |
| Sup. maxilla           | 1  | Ischium        | 3  |
| Inf. " "               | 4  | Ilium          | 5  |
| Spine                  | 7  | Sacrum         | 3  |
| Scapula                | 12 | Femur          | 19 |
| Humerus                | 19 | Patella        | 1  |
| Ulna                   | 18 | Tibia          | 11 |
| Radius                 | 6  | Fibula         | 3  |
| Ulna & Radius          | 1  | Tibia & fibula | 6  |
| Carpus                 | 3  | Metatarsal     | 4  |
| TOTAL 150.             |    |                |    |

|                                    |    |
|------------------------------------|----|
| Wounds penetrating chest           | 8  |
| Wounds penetrating abdomen         | 12 |
| Wounds penetrating Chest & Abdomen | 5  |
| Civil operations. Appendectomy     | 4  |
| Others                             | 9  |

Enucleation of Eye 7

Cystocopy 1

Transfusion of Blood 38

Operations of soft tissues 247

Total of all Classes 579.



## X - RAY REPORT, MONTH OF AUGUST 1918. 10

To/ O. C.,  
1st. Australian C.C.S.

I beg to report that 481 examinations were made during August, made up as follows:-

|         |      |
|---------|------|
| CHESTS  | 50.  |
| HEAD    | 48.  |
| ABDOMEN | 36.  |
| OTHERS  | 347. |

During the month a Reducing Apparatus was perfected, in conformity with your wishes, from material already available, by which a reduced print is taken from the negative, directly on to Bromide Paper.

This works well and should prove very useful where it is necessary to send radiographs with the patient to the base.

All the other apparatus is working well.

10th. September 1918.

W. Marshall Major.  
Radiographer,  
1st. Australian C. C. S.



ATTACHED1st. Australian Casualty Clearing Station

To/  
Officer Commanding,

1st. Australian C. C. S.

---

|                                          |     |
|------------------------------------------|-----|
| Extractions                              | 384 |
| Fillings                                 | 160 |
| Dressings, Scaling & minor<br>operations | 149 |
| New Dentures                             | 45  |
| Repairs to Dentures                      | 43  |

During the month only one Staff Sergeant has  
been working on New Dentures and Repairs.

In addition to the above Surgical work a  
number of French Civilians have been treated.

Arthur E. Wellman Capt.  
Dental Officer,  
No. 41. Dental Unit att.  
1st. Australian C. C. S.



About midnight on August 26th., the following order was received from D. M. S. 2nd Army. :-

"You will close your C. C. S., forthwith and proceed with 9 Lorry loads of essential material in accordance with this Office No. P.S. 23/18 dated 9.3.18 and open for the reception of cases immediately at Sh. 27/H. 11.d. 0.2.

"You should arrange an adequate guard on those stores and materials you are unable to remove in the lorries allotted. Move will commence on the receipt of this memo and notification should be sent by phone immediately you are ready to open at your new site. 9 lorries will report to you at 6. a.m. 27.8.18 for the purpose of this move.

Dated 26.8.18 11.p.m.

REVEILLE WAS ORDERED FOR 4 a.m. Breakfast 4.30 a.m. All the tentage was up in position. It was very wet and heavy with rain. It all had to be struck, packed and loaded. The lorries arrived punctually at 6.0. a.m. The first lorry loaded (with stretchers) at 6.20 a.m. With this lorry were the C/o., and 10 men.

The new site was reached in 1 1/2 hours, the distance being about 18 miles by lorry route. The roads were good and clear of traffic. The first lorry arrived at the new site at 7.50 a.m., the last about 2.0. P.m.

The personnel taken was 1 Officer (C.O.) the Sergt/Major, 3 Sergeants and 45 Other Ranks. These were distributed amongst the lorries and consequently had not arrived until the last lorry came in.

The first tent was started being pitched at 9.0.a.m. By 6.0.p.m. 28 marquees had been pitched and a small provision store, a Kitchen Shed, and Latrines erected.

The Wards, Operating Tent and Dressing Tent were equipped early the next morning. Later 6 more marquees were pitched.

I sent a telephone message to the D. M. S., that I could take in 200 cases at 10.0.a.m. 28th and at 3.0.p.m. 50 more cases.

The following is therefore the time table :-

26th inst: D.M.S., sends the order to move 11.0.p.m.  
Order reaches 17th C. C. S., midnight.

27th inst: Lorries arrive at old site 6.0.a.m.  
First lorry leaves 6.20.a.m.  
First lorry arrives at new site 7.50.a.m.  
Last " " " " " 2.0.p.m.

28th inst: Ready to receive 200 cases at 10.a.m. (that is- about 36 hrs from order leaving D. M. S., and 26 hours after arrival at new site.)

The site selected by the D.M.S., was a rectangular level grass field which had the great advantage of an excellent semicircular track for Motor Cars, of Railway Sleepers wide enough to take two Cars abreast. If this track had not been there I should have considered for the time being admission and evacuation would have taken place from the road which is wide enough for two vehicles abreast.

I attach a list of the most important articles brought.

There are some points in criticism of this list and of my own plan of campaign which might be brought forward.

It should be borne in mind that only nine lorry loads were brought. As a matter of fact it would have been easily possible for lorries to have done three journeys during daylight. I could have also utilised my own two lorries.

There are many things one would have liked apart from more accommodation.

1. More Blankets. I brought 600. This is not enough for 200 patients. A 1000 Blankets is more the figure.



368

1. I report to you at 6 a.m. 27.8.16

81. 1890.

It was very wet and heavy with rain. The lorries arrived and loaded (with stretchers) and 10 men. The distance being about 1000 yards. The road was very muddy and the last about 1000 yards. The road was very muddy and the last about 1000 yards.



2. More Stretchers. I brought 170. Fifty of these were reserved for exchanging with Motor Ambulances. This meant that 50 to 100 patients would have to sleep on the floor.
3. Wooden Tent Boards. For the Operating and Dressing Tents. These were out of the question however.
4. Porches for Marquees.
5. More Trestles.
6. Lots of Trench Boards.

I should make the following alterations to the list of articles brought on a future occasion.

1. No Palliasses or Bolsters. If straw could be obtained for filling these, they could be brought later.
2. Instead of 6 of the 6' foot tables - ten small folding tables.
3. Only 50 ground sheets instead of 200. There is tarpaulin on the floors of the Marquees.
4. No Sheets or Bolster Slips. These must wait until later.
5. I had more clothing than really necessary. (400 Shirts and Draws.)

The space gained by these excisions would be filled with extra Blankets and Stretchers. In fact I could bring enough of these by bringing 4 fewer Marquees. (About 40 fewer patients.)

The personnel was 50. As no other transport was provided and if they had marched it would have taken most of the day over it, they had to be carried in lorries. This must be accounted for as 50 men are 2 lorry loads. Only one Officer and no Sisters were brought. One Officer is enough, while the place is being erected but accommodation would have to be increased next day. I have not, in this scheme, provided for more than five or six Officers (3 Bell Tents.) There is no provision for Sisters. I brought two Marquees instead of Bell Tents for the men.

I do not consider this scheme provides a Unit fit for dealing satisfactorily with serious cases. I doubt if it can be made so. It would be an advantage to know beforehand what the unit was expected to do. If it was to act as an advanced Chest and Abdomen Centre different equipment would be taken, and again, the scheme would be altered if only walking wounded or sick were to be dealt with. Operations of any sort could be done, but the comforts and accommodation are poor and one would wish to evacuate all cases as soon as possible.

It would be an advantage too if the C/O., could, if possible, see the site selected or even assist in selecting it, for the actual move takes place. Each site needs modifications and planning and it is no easy matter to decide quickly, exactly how the place is to be laid out. A mistake may, almost irreparable, be made without much trouble and labour.

The plan must also be made out with the view to future expansion, the provision an so on. One would like a little time to think it over. One, final point, an important one, is that once a Unit is engaged in treating wounded, it cannot spare many men to enlarge the Camp. As it is there is much work to be done, paths to be made etc., etc.,

28/8/18

Sgdt. G.W.G. Hughes      Lieut-Colonel  
R.A.M.C.  
O/C., 17 C.C.S.



|                                        |     |   |            |
|----------------------------------------|-----|---|------------|
| Marquees.....                          | 36  | ) |            |
| Bell Tents.....                        | 3   | ) | 4 lorries. |
| Blankets.....                          | 600 | ) |            |
| Sheets Ground.....                     | 200 | ) | 1 lorry.   |
| Stretchers.....                        | 170 | ) | 1 lorry.   |
| Operating & Dressing<br>Equipment..... |     | ) |            |
| Dispensary.....                        |     | ) |            |
| Office Records.....                    |     | ) | 1 lorry.   |
| Q. M. Stores.....                      |     | ) |            |
| Supplies.....                          |     | ) | 2 lorries. |
| Kitchen Equipments.....                |     | ) |            |
| Fuel etc.....                          |     | ) |            |

## Most important articles taken.

|                      |                    |                                 |
|----------------------|--------------------|---------------------------------|
| Stretchers.....      | 170.....           | 50 more wanted.                 |
| Blankets.....        | 600.....           | 400 more wanted.                |
| Marquees.....        | 36                 |                                 |
| Bell Tents.....      | 3                  |                                 |
| Sayer's Stoves.....  | 6                  |                                 |
| Primus Stoves.....   | 10                 |                                 |
| Hurricane Lamps..... | 50                 |                                 |
| Acetylene Lamps..... | 5.....             | (3 large and 2 small.)          |
| Tables.....          | ( 6 feet ) 10..... | (not enough.)                   |
| Pyjamas.....         | 200 )              |                                 |
| Shirts.....          | 400 )              | Perhaps these might be reduced, |
| Drawers.....         | 400 )              | but 1000 patients might pass    |
| Socks pairs.....     | 400 )              | through in 24 to 36 hours.      |
| Latrine Buckets..... | 12                 |                                 |

### Rough Plan. of Camp.

(Not. to Scale)

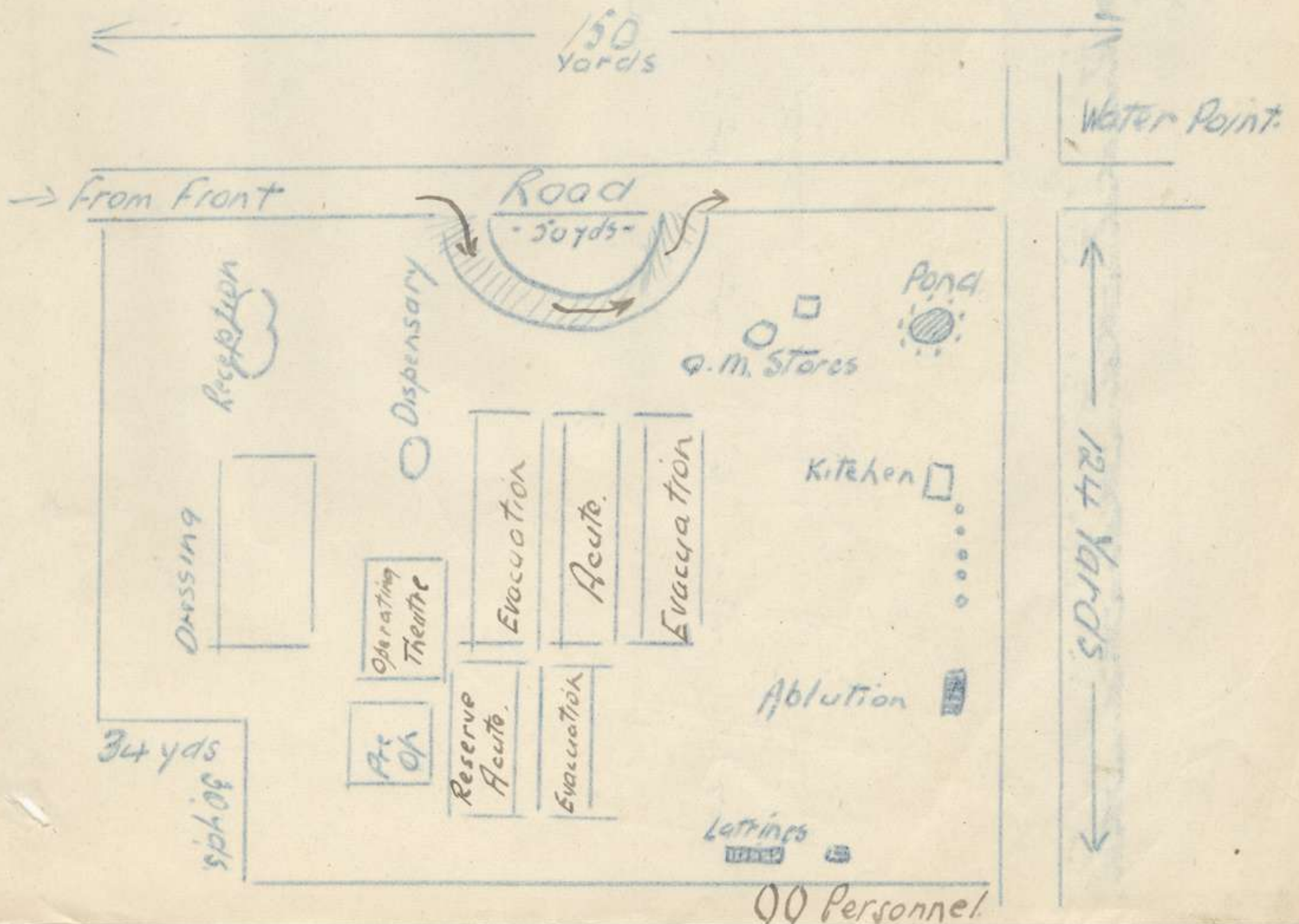



368

List of equipment, stores etc, to be taken for forming a Casualty Clearing Station in the event of an emergency move.

~~~~~

To accomodate 200 patients and personnel. Transport of 10 Lorries.

Description of Stores.	No.	Description of Stores.	No.
Axes Hand & felling, of each	2.	Basins enam: 7 $\frac{1}{2}$ inch	50.
Flags Disting. c. Poles	1.	do 6 do	200.
Forms Tent Dining	20.	Basins Wshg. Zinc. 11 inch	50.
Kettles Camp. Oval 12 qts	20.	Baths Arm	1.
Lamps Hurricane or F. S.	50.	Boilers Water Tin	4.
Sheets ground	200.	Boxes Dressing	10.
Stools Camp	10.	Cans 3 gallon	10.
Stoves Soyer's	6.	Cups Canteen Drinking	200.
Tables Camp	4.	Cups Spitting enam	50.
Tables portable 6'	10.	Forks Flesh	2.
Tents Marquee. Canvas bottom	36.	Implements Butchers Cases	2.
Tents. C. S. L.	3.	Jugs Enamel. F. A.	20.
Axes pick	3.	Kettles tea 2 qts	2.
Shovels G. S.	6.	Kettles. Cooking	10.
Chests. Tools. Carpenters	1.	Ladles Cooks. F. A.	4.
Boxes Slat 7lb	1.	Machines Mincing	2.
Brooms. Base	10.	Pails. I. G.	10.
Brushes. Scrubbing hand	10.	Pails. Slope	20.
Brushes. Long sweeping	10.	Pans. Bed enamel	20.
Brushes. Whitewashing	2.	Plates. Dinner	3200.
Feeders, Earthenware & enam.	50.	Pots Tea	2.
Lamps Oper. F. A.	2.	Saucepans F. A. Nests	2.
Lamps Oper. Acety. Large	3.	Stools. close. F. A. Nets of 8	2.
Lamps operating hand	10.	Stoves Primus	10.
Measure glasses 4 oz	5.	Stoves Portable	2.
Screens Bedside	10.	Tubs Washing 8 gals	10.
Tumblers & pint	10.	Blankets G. S.	600.
Urinals Zinc	50.	Bolster Cases	100.
Balance Spring 200 lbs	1.	Palliasse cases	100.
Balance Spring 30 lbs	1.	Pillows feather	25.
Basins enam. 14 inch	50.	Sheets Hosp	100.
Flags Union	2.	Aprons Operating	100.
Stretchers Amb	150.	Towls Hand	400.
Towels Operating	100.	Carriages Amb Stretcher	5.
Aprons Operating	50.	Fuel, Wood & Coal. Cwt	15.
Jackets Sleeping	200.	Parrifin. gals	10.
Methy. Spirits. gals	5.	Trousers Sleeping	300.
Buckets. Latrine	12.	Screens Latrine	3.
Shirts, Flannel, Grey	400.	Drawers, Woollen pairs	400.
Socks. Worsted prs	400.	Disinfectants for immediate use.	

Operating Theatre, Dispensary, Officer Records etc. - 1 Lorry

Splints. Thomas Thigh	20.	Gauze Yds	1218.
" Footpieces for	30.	Wool. C. A. lbs	50.
" Susp. Bars for	30.	Tow. lbs	20.
" Zinc Support for	60.	Bandages. Triang	360.
" Tho mas Arm C		" L.	1900.
Swivel Ring	15.	" Flannel	20.
" Jones's Arm	8.	Lint. lbs	20.
(4 right 4 left).			
" Posterier. leg c ftp	20.		
" Inter: Iron. Elbow	10.		
Splinting. Gooch. Rolls	4.		
Clarkes hinged arm	20.		
Long Listons	12.		

P.T.O.

Instruments to replace unserviceables.

~~~~~

Scalpels.....12  
 Forceps.S.W.....12  
 Forceps Dissect.....6  
 Forceps Sinus.....6  
 Scissors.S.W.....4  
 Saws.Gigles.....1  
 Aspirator Potains.....1

Knives Amputating.....2  
 Syringes, Hypo.....10  
 Syringes Serum.....10  
 Syringe Greys.....1  
 Syringe Barkers.....1  
 Saws.Amput.....2

SUNDRIES.

~~~~~

Omnopon..Boxes.....12
 Camphor in Oil..boxes.....12
 Prituitrin..... "10
 Catgut.Tubes.....400
 Gloves.Operating.....12
 A.T.S...doses.....400
 Aether.lbs.....14
 Chloroform.lbs.....7
 Rubber.Dam.....rolls.....4
 Ethyl Chloride.Tubes.....12
 Picric Acid in Aqua Dist
 Plaster Adhesive Rolls...36
 Bipp.....lbs.....6
 Materials for 25galls of
 Dakin's Solution...

~~~~~