

AWM4
Australian Imperial Force unit war diaries,
1914-18 War

Medical, Dental & Nursing

Item number: 26/49/28

Title: 6th Australian Field Ambulance

April 1918

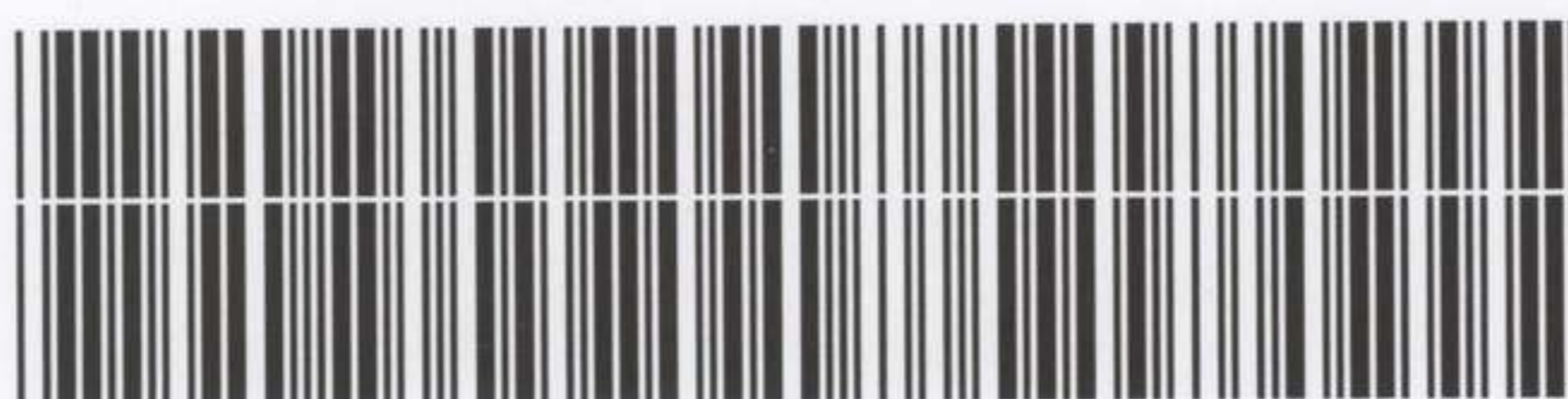

AWM4-26/49/28

18,000-12/1 -#723

CONFIDENTIAL.

ORIGINAL.
~~DUPLICATE.~~
~~TRIPLICATE.~~

Australian Imperial Force.

WAR DIARY

OF

6th AUSTRALIAN FIELD AMBULANCE

FOR

APRIL 1918

N.C.O.
Signature of Officer compiling *W. Simpson Sgt.*

Signature of Officer Commanding *H. Sturges Welch Lt. Col.*

108

WAR DIARY

Army Form C. 2118.

Instructions regarding War Diaries and Intelligence Summaries are contained in F. S. Regs., Part II. and the Staff Manual respectively. Title pages will be prepared in manuscript.

INTELLIGENCE SUMMARY.

(Erase heading not required.)

Place Sheet 28	Date	Hour	Summary of Events and Information	Remarks and references to Appendices
S.16.d.9.4.			The 77th British Field Ambulance relieved the 6th Aust. Field Ambulance at A.D.S. UNDERHILL Fm 28/T.18.d.5.5. and A.D.S. BREWERY 36/C.1.d.4.5. and all forward posts.	(Relief Order. Order 4
RAVELSBERG	1.4.18		The 57th British Field Ambulance relieved 6th Aust. Field Ambulance at D.R.S. REVELSBERG (Corps.	Order 4
Unit Moving	2.4.18		In accordance with 6th Aust. Inf. Bde. order No. 128 the Ambulance marched out from D.R.S. RAVELSBERG proceeding to METEREN. On arrival at destination it was found that the billets to be occupied were being used by 5th A.I. Bde owing to their movement having been delayed. Arrangements were made for the necessary accommodation at near OUTERSTEENE.	Move Order No. 1
	4.4.18		Captain J.H.R. McCutcheon Temp. attached for duty from Base.	Move
	5.4.18		In accordance with 6th A.I. Bde Order No. 129 the Ambulance entrained at CAESTRE for new area. The Ambulance disentrained at St. ROCH (near AMIENS) and proceeded by road to billeting area VOUX-EN-AMIENNOIS (AMIENS 17/C.1.) Mechanical Transport, which moved independently by road from old area, rejoined Ambulance at this place.	Order 2
			2 Officers and 11 O.R's were temp. detached for duty with No. 20 B.C.C.S.	(Move Order 3
	6.4.18		The Ambulance moved from VOUX-EN-AMIENNOIS to PONT NOYELLES 62D/H.18.a.1.7. The Ambulance moved from PONT NOYELLES to BEAUCOURT 62D/B.12.a.5.6.	(Move Order 4
	7.4.18		In accordance with A.A.M.C. No. 15 2nd Aust. Div. the Ambulance moved from BEAUCOURT to WARLOY 57.D/U.24.c.4.6. to relieve 12th Aust. Field Ambulance at Head-Quarters Rue de Baillon WARLOY A.D.S. HENENCOURT Chateau and all motor and advanced posts.	Move Order 5
			2 Officers and 81 O.Ranks, 2 Motor and 1 Horse Ambulance reported and were temp. attached for duty from 5th Aust. Field Ambulance.	
			No. 13645 Pte Roberts R.A. died of wounds (shell wd. R.Leg, Comm. cpd. fracture R. Thigh) buried at WARLOY Military Cemetery (Lens 11/G.6.)	
Sheet 57D U.24.c.4.6.	8.4.18		Relief of Transport and Bearer personnel of 13th Aust. Field Ambulance who were attached to 12th Aust. Fld. Amb. on 6th Aust. Fld. Amb. taking over, was completed and rejoined their H.Q. Promotion Major H.L.StV. Welch D.S.O. to be Temp. Lieut. Colonel as from 8.4.18	
	9.4.18		No. 4 Dental Unit acting under A.D.M.S. 2nd Aust. Div instructions moved to BEAUCOURT and opened for duty being Temp. attached to 5th Aust. Field Ambulance.	
	11.4.18		2 Officers and 11 O.R's temp. attd. 20th.C.C.S. transferred to 5th Aust. Fld. Amb. for temp. duty.	

WAR DIARY
or
INTELLIGENCE SUMMARY.

Instructions regarding War Diaries and Intelligence Summaries are contained in F. S. Regs., Part II, and the Staff Manual respectively. Title pages will be prepared in manuscript.

(Erase heading not required.)

Place	Date	Hour	Summary of Events and Information	Remarks and references to Appendices
	17.4.	18	In accordance with A.A.M.C. order No. 16 2nd Aust. Div. the Ambulance was relieved at A.D.S. HENENCOURT, LAVIEVILLE, BAIZIEUX and all forward posts by 5th Aust. Field Ambulance. H.Qrs 6th Aust. Fld. Amb. and transport moved to BEAUCOURT 62D/B.12.a.5.0. and established a Main Dressing Station. All the bearers 6th Aust. Fld. Amb. on duty at A.D.S. and forward posts were temp. attached to 5th Aust. Field Ambulance. On relief these men reported to H.Qrs WARLOY No. 4 Dental Unit stationed at BEAUCOURT became attached to 6th Aust. Fld.Amb. on arriving at BEAUCOURT.	Move Order 6
	18.4.	18	"C" Section bearer Sub-division and a portion of "B" Section bearer sub-division (67 O.R's) moved from WARLOY to A.D.S. FRANVILLERS and were attached for temp duty to 5th Aust. Fld. Amb. The personnel remaining at WARLOY of 6th Aust. Fld. Amb. joined Ambulance H.Qrs at BEAUCOURT.	
	30.4.	18	67 Other Ranke temp. attached for duty with 5th Aust. Fld. Amb. rejoined Unit at BEAUCOURT..	

D. D. & L., London, E.C.
(A7883) Wt. W809/M1672 350,000 4/17 Sch. 52a Forms/C/2118/14

WAR DIARY

OF

6th AUSTRALIAN FIELD AMBULANCE

FOR

APRIL

1918

LIST OF APPENDICES.

No.	Subject.
A)	Relief Order on hand over of Advanced Dressing Stations
B)	on MESSINES-PLOEGSTHEERT Sector and D.R.S. RAVELSBERG.
C	Movement Order No 1
D	Movement Order No 2
E	Movement Order No 3
F	Movement Order No 4
G	Movement Order No 5
H	Movement Order No 6
I	Explanatory notes and Maps on conversion of Chateau at WARLOY into an (x)Adv.Dressg.Stn. or (✓)Station for receiving Walking Wounded if either were necessary.
J	Maps and Reports on evacuation routes and Regl.Aid Posts on 6th & 7th A.I.B'de Sectors.
K	Maps and Reports on evacuation routes on MILLENCOURT Sector.
L	Maps shewing evacuation routes on Right & Left Sectors of 2nd Aust.Divisional Front.
M	Disposition report of 5th & 6th Aust.Fld.Ambulances personnel, blankets and stretchers at H'qrs, A.D.S., and all Advanced posts on line of evacuation which varied according to the daily situation in the line.
N	Procedure to be adopted by Ambulance in the event of an Advance or Withdrawal.
O	Hand-over and Disposition Reports for Main Dressing Stn. at BEAUCOURT-MONTIGNY.
P	Quartermaster's Report.
Q	Nil
R	Report on Unit's Horse Transport with 3 sketches attached.
S	Report on Mechanical Transport attached to Ambulance.
T	Block plan of site taken over by Ambulance at MONTIGNY, and converted into a Military Cemetery.
U	Unit statistics for month.

RELIEF ORDER by Major H.L. St. Vincent Welsh D.S.O.

C.O. 6th. Austn. Field Ambulance.

O.C. Brewery A.D.S.
O.C. Underhill A.D.S.

The reliefs of other Ranks for right and centre sectors will leave this D.R.S. at approx. 1.30 pm. 1.4.18., and should reach their respective A.D.S.'s independently at approx. 3.45 pm.

Each sector-party has already had its personnel allotted to the several posts of the sector to which it belongs.

Please send the guide of each sector-party back by Car to this D.R.S. when cars return.

If possible our relieved personnel should have their tea before ~~xxx~~ marching out from A.D.S.'s—in any case a hot drink will be ready for them on arrival at this D.R.S.

There is no objection to relieved personnel marching out from A.D.S.'s. to this D.R.S. in small parties as relieved should O.C.'s. sections find this more convenient than consolidating all personnel at A.D.S.'s.

One relieving Officer of 77th Field Ambulance with kit A.D.S. equipment, Q.M. representative and batman will proceed by Car to each A.D.S. to take over from O.C.'s. A.D.S.'s., leaving this D.R.S. with guides at 1.30 pm.

Relieving Unit is making its own arrangements about rations and water—the water-cart at present at UNDERHILL FARM A.D.S. will march out with relieved personnel or sooner if possible.

Receipts in triplicate of all stores handed over to incoming Unit will be taken, and forwarded to this Orderly Room.

1.4.1918.

(Signed)

H.L. St. Vincent-Welsh Major.
C.O. 6th. Austn. Field Ambulance.

CORPS ORDERS No. 4. for 2nd April 1918

by

Major H.L. St V. Welch D.S.O. C.O. 6th Aust. Field Ambulance

Orderly Officer Capt. B.D. Fethers

Orderly Sergeant Sergt. Johnson E.A.

POSTINGS. Officers are posted to Sections as follows:-

"A" Section Major C.C. Ross
Capt. B.D. Fethers

"B" Section Major W.F. Simmons
Capt. D. Wood
Capt. R.L. Poulton

"C" Section Major E.L. Hutchinson D.S.O.
Capt. W.L. Millett
Capt. A.P. Lawrence

RELIEF OF UNIT.

The 6th Aust. Field Ambulance was relieved on Right and Centre Sectors yesterday by personnel of the 77th Field Ambulance 25th Division. Relief complete at 5.48pm. The D.R.S. RAVELSBURG was taken over by an advance party of the 57th Field Ambulance, 19th Division yesterday, relief complete 5.53pm. The remaining personnel of 57th Field Ambulance will march into D.R.S. RAVELSBURG at 11am today after which hour, and until further notice, all ranks will be prepared to march out at three hours notice.

EVACUATION.

Evacuation of Ford Ambulance Car No. 24107 to workshops, Dvr Beard R.D.

2.4.1918

H.L. St V. Welch
Major.
C.O. 6th Aust. Field Ambulance

appendix "C"

MOVEMENT ORDER No.1 by Major H.L.St.V.Welsh D.S.O. 2/4/18.

- MOVE.** The 6th. Australian Field Ambulance will move out from D.R.S. RAVELSBERG to day, and proceed by road to new billeting area at Meteren.
- ROUTE.** D.R.S. RAVELSBERG, BAILLEUL, METEREN.
- BILLETING.** A billeting party consisting of Capt. D. Wood, one N.C.O., and two Men will proceed by Ford Car to Meteren, reporting on arrival to Billeting Officer Lieut. Hislop at Area Commandant's office at 11am.
- ROUTINE.** Fall in 10.30am.
Move off 10.50am.
- DRESS.** Full marching order.
- ORDER OF MARCH**) Half Sections at 50 yards distance. Transport will move in groups of six Wagons- 50 yards between each sixth and its succeeding ~~Wagon~~ Wagon- 200 yards between Transport and rear half-Section.
- COOKS.** The Cooks with Cooks Limber and full Water Cart will leave D.R.S. at or before 10am. and proceed independently to METEREN, reporting on arrival to Capt. Wood at Area Commandant's Office.
- EVACUATION OF SICK.**) The Brigade Sick will be called for after 10am. at their respective Battalions, etc. H'qtrs by Ambulance Car and ~~will be~~ evacuated to D.R.S. RAVELSBERG. One Daimler Motor Ambulance will be detailed for this purpose, and on completion will report direct to new H'qtrs of Ambulance at METEREN.

(Signed) H.L.St.Vincent Welsh. Major.
C.O. 6th. Austn. Field Ambulance.

108

MOVEMENT ORDER No.2 by Major H.L.St.V.Welsh D.S.O.

appendix "D"

C.O. 6th. Australian Field Ambulance.

MOVE.

The 6th. Austn. Field Ambulance less Motor Transport, will march out from No. 1 Austn.C.C.S. area and Billeting Area this day (4/4/18). and proceed by road to CAESTRE where it will entrain on No. 3 Train departing at 9.25 pm. for X.

ROUTE. No.1 A.C.C.S.- METEREN- FLETRE- CAESTRE.

HORSE) TRANSPORT. Major C.C.Ross and the Quartermaster with Horse Transport will march out at 3.30 pm. to arrive at Entraining Station three hours before scheduled time for departure of train. Officers Hacks will proceed with Horse Transport.

BREAST ROPES. Breast Ropes for Horse Trucks will be provided by Units themselves.

WATERING OF HORSES. Horses will be watered prior to Entraining.

WATER CARTS. Water Carts will entrain FULL.

TEA FOR HORSE TRANSPORT. Horse Transport Cook will provide Tea at Station for Personnel of Horse Transport.

ENTRAINING STATES. Major C.C.Ross will send a representative from the Transport Section four Hours before departure of train with Entraining State (in duplicate) to the Entraining Officer Capt. F. Sale M.C. 21st. Battalion.

CLEANING PARTY. A party consisting of 1 N.C.O. and six men with shovels and Brooms will march with Horse Transport and on arrival at Station will if necessary clean out Personnel Trucks allotted to this Unit in readiness for arrival of Personnel at 8 pm.

PERSONNEL Personnel will march out at 5 pm. to arrive at Station one and a half Hours before scheduled time for departure of train.

HOT DRINKS. The quarter master will arrange for hot drinks for the whole Unit at the Station at 8.45pm.

GREATCOATS. Due warning will be given to all concerned, according to the state of the weather, as to whether the Greatcoats is to be carried inside or outside the Pack.

RATIONS. 24 Hours Rations for three meals of the 5th. inst. will be issued at the Station.

IRON RATIONS. Iron Rations have been already been issued. Under no circumstances is any man to consume any part of this Ration without orders from C.O. of Unit.

WATER BOTTLES. All Men will march out with full Water Bottles.

TRAIN DISCIPLINE. 1 N.C.O. will be detailed to take charge of each Personnel Truck, and no one will leave the Truck after entraining without permission of the N.C. O. in charge, and then only for the purpose of relieving himself. No one is to leave the train at the detraining Station until the order for Detraining has been given.

BILLETING PARTY. Capt. D.Wood, 1 N.C.O. and two men will proceed as Advance Billeting Party by No.1 Train leaving CAESTRE at 3.25 pm. 4/4/18. (Car leaves for Station at 2 pm.)

MOTOR TRANSPORT. Motor Transport will proceed by road as a convoy in charge of Capt. H.W. Pottinger, instructions as to time of departure, route, etc. will be issued separately by Major C.C. Ross.

(Signed) H.L.St.Vincent Welsh. Major.

4/4/18.

C.O. 6th. Austn. Field Ambulance.

Ch. A. J. Ambul

108

MOVE ORDER No 3 By LIEUT. COLONEL H.L. St V. WELCH D.S.O.

appendix "E" 8

C.O. 6th. AUSTRALIAN FIELD AMBULANCE.

-----oOo-----

6.4.18

MOVE The 6th. Aust. Field Ambulance will move from VAUX-en-AMIENOIS to PONT NOYELLES to-day.

ROUTE VAUX-en-AMIENOIS-POULAINVILLE-ALLONVILLE-QUERRIEU-PONT NOYELLES.

ROUTINE Reveille 5.30a.m. Breakfast 6a.m.
Fall In 6.45a.m. Move Off 7a.m.
Arrive Pont Noyelles 12Noon Dinner (New billets) 12.15pm

DRESS Full marching order-greatcoats will be carried in packs unless otherwise ordered.

OFFICERS KITS Kits will be ready at billets for loading on wagon at 6.30a.m.

ORDER OF MARCH Half sections at 50 yards distance. Transport :-Groups of 6 wagons at 4 yards distance-50 yards between each 6th. & succeeding wagon-200 yards between rear of rear half section and head of transport.

WATER CARTS Water carts will march out 1/3rd full.

WATER BOTTLES Men will march out with full water bottles.

SECOND BLANKET The 2nd blanket issued for the night of 5/6.4.18 will be stacked by each man just inside the door of the billet immediately after reveille for collection by Q.M. staff.

ADVANCE

BILLETING PARTY An advance billeting party consisting of Capt. LAWRENCE 1 N.C.O. & 2 men will proceed by car leaving VAUX at 7a.m. arriving at PONT NOYELLES at 7.30a.m. & will report to Town Major on arrival.

TRANSPORT LIMIT The crest of the ridge immediately East of PONT NOYELLES is under direct enemy observation, consequently no transport will under any circumstances proceed East of a line joining L in LAHOUSOYE with 2nd N in PONT NOYELLES. (France 1/100000 AMIENS) without the written authority of C.O. Unit.

MOTOR TRANSPORT 1 Daimler will report to Capt. LAWRENCE at gate of Officers Mess at 6.50a.m. to take billeting party to PONT NOYELLES. One Daimler will proceed to church at StSAVUEUR and pick up any sick of 6th M.G. Coy at that point at 10a.m. afterwards proceeding to church at VAUX-en-AMIENOIS, church at BERTANGLES and church at COISY to pick up sick of 23rd & 24th Battns & L.T.M.B. 22nd & 21st Battns respectively. Sick will be taken to No 20 C.C.S. VIGNACOURT. If necessary 2 or more trips will be made. On completion cars will report back to H.Q.s PONT NOYELLES. Two Daimlers will report to Sgt. BURKE at 6.30a.m. will load Cooks, Cooks gear & rations necessary for dinner and will proceed with billeting car leaving gates of Officers Mess at 7a.m. for PONT NOYELLES. Hot dinner should be ready for all ranks on arrival at PONT NOYELLES at (approx) 12.15p.m. The Ford car will proceed in convoy with billeting & cooks car.

6.4.18

H.L. St V. Welch Lieut. Colonel
C.O. 6th. Australian Field Ambulance.

MOVEMENT ORDER No 4 By Lieut Colonel H.L.St V WELCH D.S.O.

C.O.6th Australian Field Ambulance

April 6th 1918

-----oOo-----

MOVE The 6th Aust.Field Ambulance will move to-day 6.4.18 from PONT-NOYELLES to new billets at BEAUCOURT.

ROUTE PONT-NOYELLES ~~Kx~~-by road East of River L'HALLUE-BEHENCOURT-MONTIGNY-BEAUCOURT.

ORDER OF MARCH Half Sections at 50 yards interval.Transport will move in groups of 6 wagons-50 yards between each sixth and its succeeding wagon-200 yards between transport and rear half-section.

ROUTINE Fall in 6.30p.m. move off 7p.m.

DRESS Full marching order - greatcoats in packs.

COOKS Sgt Cook with one assistant & necessary gear will proceed on ahead to BEAUCOURT by car leaving PONT-NOYELLES at 6p.m.& on arrival will prepare a hot drink for all personnel arriving at approx.9p.m.

PARK FOR HORSE T/PORT. On arrival at BEAUCOURT horsed transport will park in orchard opposite gates of 2nd Aust Division Headquarters.

(Signed) H.L.St V.WELCH Lieut.Colonel

C.O.6th.Australian Field Ambulance

MOVEMENT No 5 By Lieut.Colonel H.L.St V WELCH D.S.O.

C.O.6th Australian Field Ambulance April 7th 1918.

-----oOo-----

MOVE

The 6th Australian Field Ambulance will move to-day 7.4.18 from BEAUCOURT to a new Ambulance H'qrs. at WARLOY and on arrival will relieve the 12th Aust. Field Ambulance at that place and in A.D.S. HENENCOURT, Motor Posts at MILLENCOURT, LAVIEVILLE, and BAZIEUX and in the Relays and R.A.Ps beyond.

ROUTE

BEAUCOURT-CONTAY-WARLOY.

ROUTINE

Reveille 7.30a.m. Breakfast 8a.m. Fall In 8.45a.m. Move off 9a.m.

Dress

Full marching order - greatcoats in packs.

ADVANCE PARTY

An advance party consisting of Captain A.P.LAWRENCE, Quartermaster, W.O.CLARK D.C.M. and 3 cooks with necessary gear will proceed ahead by car leaving BEAUCOURT at 8.30a.m.

On arrival at WARLOY the Officer i/c of this party will report to C.O.12th Aust Field Ambulance and proceed with the take over.

The cooks will have dinner ready for all ranks at 12 noon.

(Signed) H.L.St V WELCH Lieut.Colonel

C.O.6th Australian Field Ambulance

108

Appendix "H"

MOVEMENT ORDER No 6 By Lieut Colonel H.L.St V WELCH D.S.O.

C.O.6th Australian Field Ambulance April 17th 1918

Reference Map Sheet 62 D 1/20000

H

RELIEF

The 6th Aust. Field Ambulance will be relieved at A.D.S. HENENCOURT, MOTOR POSTS at LAVIEVILLE and BAZIEUX and Relays and R.A.P's of 2nd Aust Divl. Front by 5th Aust. Field Ambulance on 17.4.18. The 5th Aust. Fld. Amb. will abandon M.D.S. at VADENCOURT and form a new A.D.S. at FRANVILLERS. A.D.S. at HENENCOURT and Motor Posts at LAVIEVILLE will be abandoned and all evacuations, except that from R.A.P. at D.21.c.9.7. through the 3rd Aust Div. motor post at D.27.c.2.0., will be changed over from present line to pass through new motor post on ALBERT-AMIENS road at D.16.d.1.8., thence down this road to new A.D.S. at FRANVILLERS.

Change over will take place at 6p.m., when relief will be considered complete.

On relief the Amb. H'qrs at RUE-DE-GRANDE BAILLON WARLOY will be abandoned and 6th Aust. Fld. Amb. will establish a M.D.S. at BEAUCOURT to be open for reception of cases at 6p.m. 17.4.18

ATTACHED PERSONNEL

All bearer other ranks of 6th Aust. Fld. Amb. at present in forward posts will remain there and come under the jurisdiction of C.O. 5th Aust. Fld. Amb. at 6p.m. on 17.4.18. In addition, the remaining other ranks of "B" Section Bearer Subdivision, plus the whole of other ranks of "C" Section Bearer Subdivision, making in all 2 bearer subdivisions, less Officers (67 O.R's) will be temporarily attached for duty to C.O. 5th Aust. Fld. Amb. These O.R's of "C" Sec. Bearers & balance of O.R's of "B" Sec. Bearers at present in reserve at WARLOY will march out at 9a.m. 18.4.18 under Captain ~~XXXXXX~~ Mc CUTCHEON via BAZIEUX to A.D.S. FRANVILLERS where they will be handed over to C.O. 5th Aust. Fld. Amb. Capt. McCUTCHEON will then report to M.D.S. BEAUCOURT.

All other personnel from posts forward of WARLOY, less Major E.L. HUTCHINSON D.S.O. will rendezvous to-night on relief at Amb. H'qrs WARLOY. Major E.L. HUTCHINSON D.S.O. will be temporarily attached to C.O. 5th Aust. Fld. Amb. for 24 hours from 6p.m. 17th. Ap. and will mutually arrange matters of detail of forward posts with an Officer of 5th Aust. Fld. Amb. He will arrange that all medical equipment from posts about to be abandoned is brought back to WARLOY. For this purpose a G.S. Wagon will report to him at A.D.S. HENENCOURT at 4p.m. 17.4.18. He will also make use of motor ambulances for conveyance of blankets & stretchers to WARLOY.

A team will report to A.D.S. HENENCOURT at 4p.m. to bring back water cart at present there.

ADVANCE PARTY

A party consisting of Capt A.P. LAWRENCE, Q.M., W.O. CLARK D.C.M. S/Sgt Nursing duties & 2 nursing orderlies, two cooks & one bearer squad with necessary advance medical equipment & cooks gear will proceed by cars to BEAUCOURT leaving at 5p.m., will take over the dressing station at MAIRIE from 5th Aust. Fld. Amb. and be prepared to take in patients at 6p.m. Remaining Officers of 6th A. Fld. Amb. less those already detailed & Capt D. WOOD will proceed to BEAUCOURT by car leaving at 7p.m.

-2-

HORSED
TRANSPORT

Wagons will pull up to Q.M.'s store for loading at 1p.m. and horsed transport will move independently under transport W.O. to BEAUCOURT leaving at 4.30p.m. On arrival it will park in area alongside billet 16 BEAUCOURT.

REAR PARTY

Capt WOOD with balance of personnel not already detailed will remain at WARLOY until to-morrow to clean up & load material at WARLOY on to wagons which will be sent from BEAUCOURT at 6.30a.m. 18.4.18 On completion he will hand over WARLOY to TOWN MAJOR WARLOY and report with his party to BEAUCOURT.

RECEIPTS

Receipts in triplicate will be taken by Q.M. for all stores and equipment handed over to relieving Unit and given for stores taken over at BEAUCOURT from relieved Unit.

(Signed) H.L. St V WELCH Lieut. Col.
C.O. 6th Australian Fld Ambulance

SUMMARY OF SYSTEM UPON WHICH CHATEAU, GRANDE RUE DE BAILLON, WARLOY,
HAS BEEN ARRANGED FOR PURPOSES OF AN A.D.S.
GROUND PLAN TO SCALE WITH EXPLANATORY NUMBERS IS ATTACHED. I (X)

Motor Ambulances enter by archway between rooms 1 and 9, and draw up at steps of room 20, down which a gradual ramp with expanded metal surface is being laid, the same being laid down steps from Lobby. Should Dressing Room (No. 20) be full, Car stops opposite rooms 1 and 2 and wounded are stored in either of these rooms pending attention in Dressing Room.

No. 1 is capable of accommodating 24 stretcher cases on racks.

" 2 is capable of accommodating 16 stretcher cases on racks.

No. 20 is a large room in which two Teams could work at once on two ~~xxx~~ stretchers with plenty of room for everybody. This could also be used as preparation room for removal of gross dirt before dressing in Room 21. The floors of both 20 and 21 are of unspoiled tiles and the walls and roofs are absolutely untouched. Cases would be carried from Room 20 to Room 21 through connecting door-way and dressings done in 21 in same way as in 20. Traffic can go on through 21 between 20 and Lobby without interfering with the work in 21, thus dressing can be done independently in either room. A clerk with table and chair in "cupboard" in corner of 21 can take all necessary particulars without being in anybody's way and same applies to Room 20. These two Clerks are in direct communication by a hole in the wall between the two "cupboards".

Car which has emptied at rooms 1 or at steps of room 20 then draws up at Lobby steps and receives dressed wounded for evacuation to M.D.S.. Should Car not be available, dressed stretcher cases are carried via duckboards to No. 10A. and walking cases walk to No. 10 where both types are fed and given hot drinks from Cookhouse at No. 11 pending evacuation by Car which draws in through big Barn doors to space (roofed) between 10A and 10, loads under shelter, and draws out through Barn doors on far side for road and M.D.S..

The brick partitions between sections of the barn 10a & 10 are pierced by wide openings through which stretchers can be carried.
No 10a & 10 combined are capable of accommodating 30 dressed stretcher c/s & 50 Do walking cases.

There is standing room in the court yard for at least 4 large cars in addition to a car at the Lobby steps, & another loading in the barn 10-10a. The car at the steps can get away independently of the car in the barn by the main archway between 9 & 10.

There is excellent accommodation for Officers & Other ranks & a large (now gas-proofed) cellar provides a very safe accommodation for at least 100 comfortably & a great many more if packed closely, for a short time.

The position of the A.D.S. is well away from the Church, main street, or any well marked spot.

Allotment of the various rooms - capacity etc is given on attached sheet :-

I

No 1	Storage for WAITING WOUNDED	24 Stretcher Cases.
2	" " " "	16 " "
3	-----	Mortuary
4	-----	Carpenter's Shop
5	-----	Corporal Packstore Keepers
6	-----	Packstore
7	----- (5 Officers Hacks)	This has been used for stable for a long time & therefore unsuitable for storage of wounded.
8	-----	Sergeants' Mess.
9	-----	Personnel (available in emergency for 40 stretchers.)
10	-----	Dressed walkers 50
10 A	-----	Dressed stretchers 30
11	-----	Cookhouse
12	-----	Regimental Tailor
13	-----	Q.M.Store (bulk)
14	-----	Q.M.Store (expendable stores)
15	-----	Orderly Room (general)
16	-----	Orderly Room (C.O.)
17	-----	Wood Store
18	-----	Dispensary
19	-----	Store (Med.equipment)
20	-----	Preparation (or Dressing) room Inwards
21	-----	Dressing Room - Outwards
22	-----	C.O.
23	-----	Officers (sleeping)
24	-----	Officers' Mess
25	-----	Second-in-Command
26	-----	Officers' Cookhouse & entrance to Gas-proof Bomb Shelter.

1st Storey accomodation provides for W.O., men's mess, sleeping accomodation for complete Tent Division, two Bearer Divisions & Motor Transport personnel & sleeping accomodation for 3 Officers.

From C.O. 6th. Australian Field Ambulance. (P)
 To A.D.M.S. 2nd. Australian Division.

Reference your 18/1/5- Establishment of Walking Wounded M.D.S. at WARLOY.

The Ground Plan of this Station ^{attached} and accompanying explanatory notes, which should have reached you after your 18/1/5 had been despatched, will make clear the capabilities of this Station for dealing with either Stretcher or Walking cases. If this is to be the rendezvous for all walking wounded it would be better in my opinion not to use the road BAIZIEUX to BEAUCOURT for any cases reaching BAIZIEUX, but to direct all cases down the hill to WARLOY, whence one central system of evacuation could be organised. The routes are being more thoroughly flagged and taped according to this plan.

I am not considering the formation of any collecting post further forward than WARLOY whence men might be brought by lorries to the Walking Wounded M.D.S. as it seems inadvisable that they should be ~~amixx~~ collected into any large group East of WARLOY.

The necessary staging is being built for loading walking wounded on to lorries.

Will a definite supply of motor lorries be made available for evacuation of these cases? If so the task of organising and administering this station as a Walking Wounded M.D.S. will be simple.

Any walking cases which are made into stretcher cases at this station will be put through my A. & D. Book, fed and made comfortable until such time as there is a full load for a Motor Ambulance, when they will be sent on one of my cars to M.D.S. VADENCOURT. The treatment, storage and feeding arrangements are complete. The only debatable question that arises is that of the supply of motor lorries. Very few pass through WARLOY at the present time, and in any case it would be difficult to side-track them to this station and send them off to a distant C.C.S. instead of to their proper destination. Given an average of 800 Walking Wounded per 24 Hours 10 motor lorries would be necessary if wounded were to be evacuated to VIGNACOURT and 13 lorries if VIGNACOURT were full and PICQUIGNY had to be used.

15
 18 . 4 . 18.

H. S. W. Welch Lieut. Colonel.
 C.O. 6th. Austn. Field Ambulance.

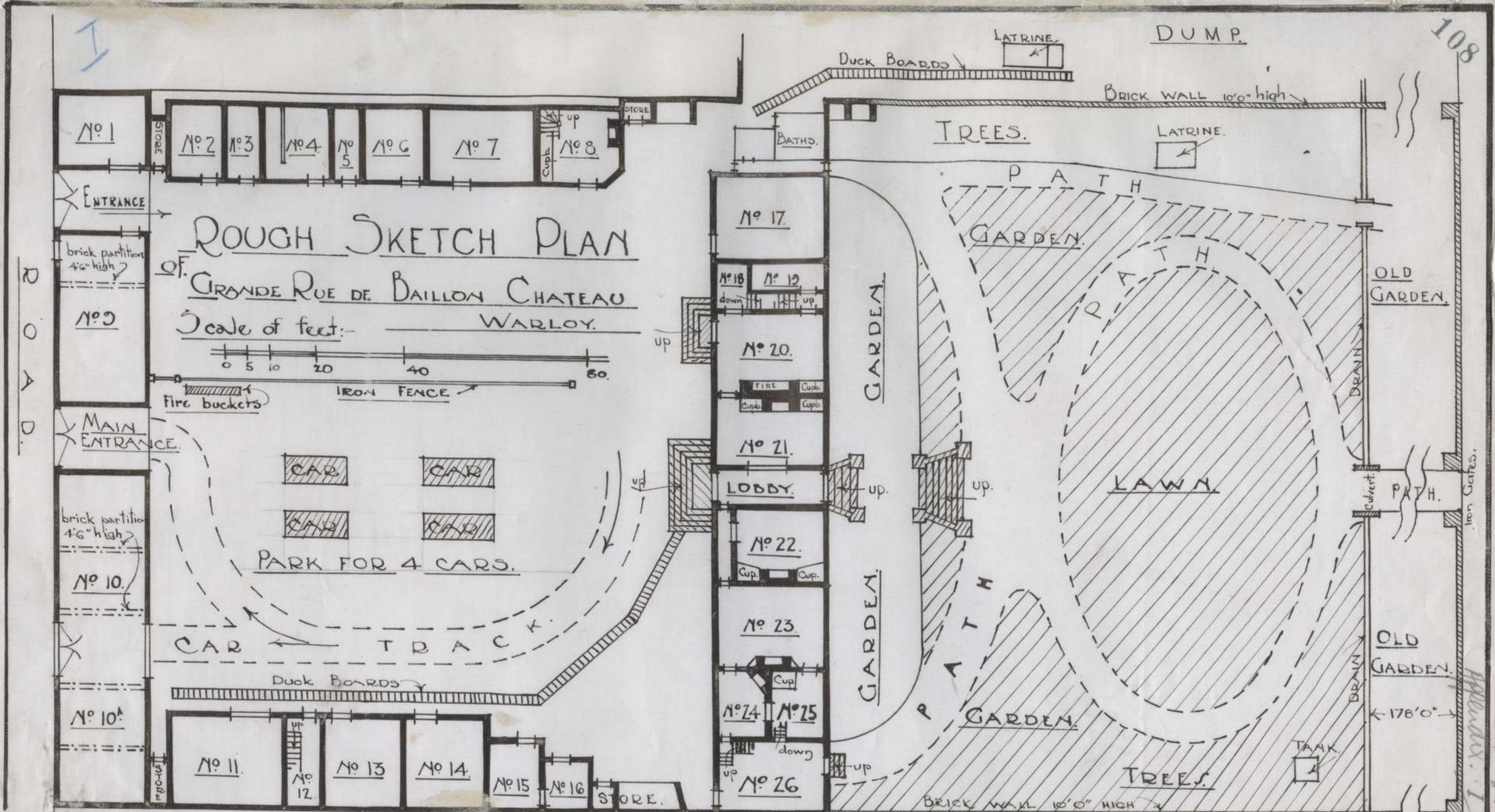

ROUGH SKETCH PLAN

OF
GRANDE RUE DE BAILLON CHATEAU
WARLOY.

Scale of feet:-
 0 5 10 20 40 60

IRON FENCE

fire buckets

PARK FOR 4 CARS.

CAR TRACK

Duck Boards

BRICK WALL 10'0" HIGH

BRICK WALL 10'0" HIGH

NOTE: ATTIC ROOMS OVER Nos. 2, 3, 4, 5, 6, 7, 8, 11, 12, 13, 14, 17, 18, 19, 20, 21, 22, 23, 24, 25, & 26.
 CELLAR UNDER Nos. 20, 21, 22, 23, 24 & 25 (Cellar is gas proofed & capable of protecting at least 100 men.)

L. PAYNE
 S. F. A. M. O.

REPORT ON 6th & 7th Brigade Sectors WOUNDED EVACUATION ROUTES.Reference attached map.Sheet 62^d 1156th Brigade Sector.

Left & Right R.A.P.'s about 50 yards apart. D.12.b.3.2.
accomodation - nature - length of carries etc, see separate Sketch Map
and Report on MILLENCOURT. (attached)

7th Brigade Sector.

Left Sector R.A.P. in QUARRY D.24.a.1.8. Accomodation Fair. •
Bearers quarters are rough shelters against the side of QUARRY - only
rain proof. The evacuation route is overland to a relay on Sunken Road
just off the main ALBERT ~~xxxx~~- AMIENS Road (roughly D.17.b.4.2.) From
there across the main road to A.D.S. & Collecting Post at LAVIEVILLE
The A.D.S. is in the North end of the village (LAVIEVILLE) The Dressing
Room etc is in a roomy cellar about 5 ft cover overhead. The evacuation
is by Motor Ambulance from here to HENENCOURT. The bearers enter a
barrage line approaching the village - the village isvregularly with
H.E. and Gas. SHELLED

Right Sector R.A.P.

R.A.P. in QUARRY off the RIBEMONT - WARLOY Road D21 09.5. The
accomodation is fair, surroundings good. The original evacuation route
was by rounding the hill, across country to the AMIENS Road, along this
in the direction of ALBERT to the LAVIEVILLE Road at the Aerodrome up the
LAVIEVILLE Road direct into the A.D.S. By arrangement with the Division
on our right who have a Motor Post & Wagon Collecting Post at the Factory
Corner at RIBEMONT our bearers carry from the R.A.P. in the Quarry to the
Factory Corner (D.27.b.4.0.) The Ambulance evacuates from there to HELLY
thus shortening the carry by 220 yards.

ROUGH SKETCH MAP
 of 6TH & 7TH BRIGADE SECTORS
 showing R.A.P.s - EVACUATION ROUTES & A.D.S.

R.A.P.s. 2 at D. 12. b. 3. 2.
 1. " D. 24. a. 1. 7.
 1. " D. 21. c. 95. 55.

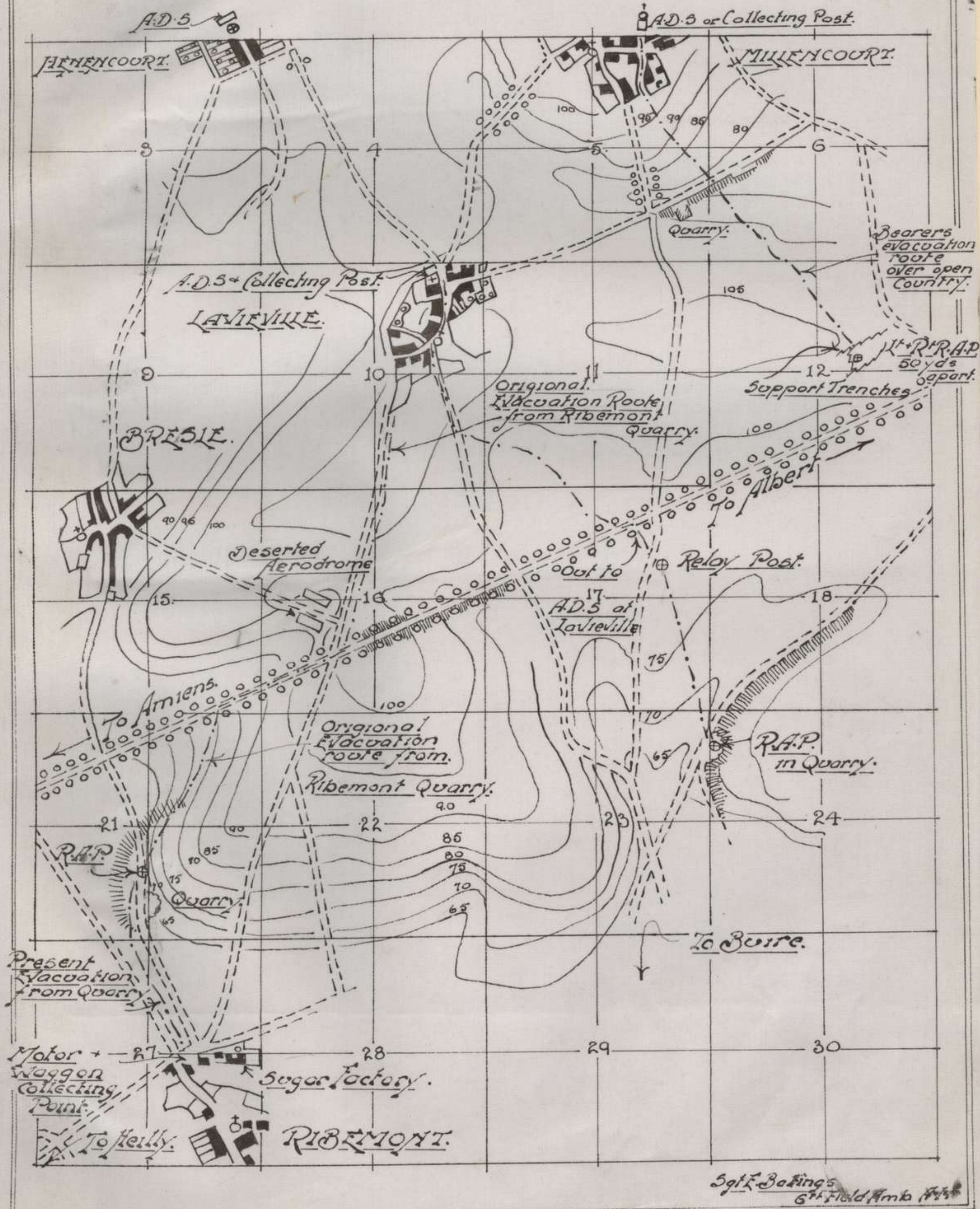
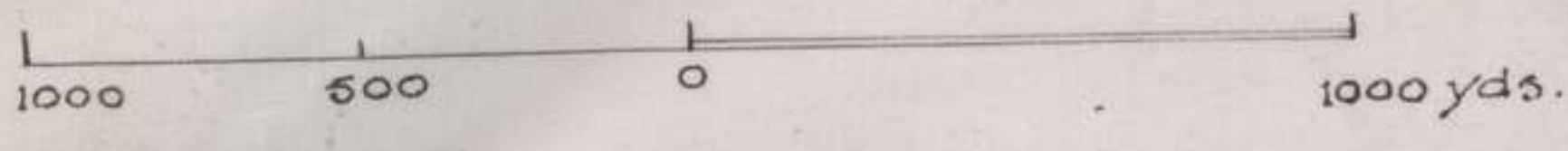

REPORT OF MILLENCOURT SECTOR WOUNDED EVACUATION ROUTE.Reference attached map ^K sheet 62^d N.E.

R.A.P.'s (right & left) D.12.b.3.2. - are about 50 yards apart situated in shallow support trenches. Accomodation poor and limited. The left is circular and about 10 feet in diameter with tarpaulin cover overhead - floor uncovered and muddy. The Bearers, four, share the dugout with the Battalion details. The right is along narrow dugout about 4 feet wide, 12 feet long and 6 feet high. Entrance at each end. Floor is boarded but being lower than the trench will easily flood. Roof is of corrugated iron only. In both cases only actual shelters from the rain. With the Right R.A.P. the Bearers, four, have a separate shelter, in the open trench with stretchers and blankets for cover overhead. The evacuation route is by beaten and taped track across open country over ploughed ground and young crops. The route is direct for the village of MILLENCOURT and the shortest possible, about 17000 yards. Shortly after leaving the R.A.P. you come into direct observation in the direction of ALBERT. The first 1000 yards is a down hill carry to the sunken road where you have to climb down a steep bank about 8 feet high, from here on the going is uphill across country, crosses the enemy barrage line on approaching the village. The A.D.S. is in the back area of the village on the main street leading on to road to HENENCOURT. The Dressing Room is front room of ruined cottage with cellar accomodation below, reserve cellar adjoining for storing of wounded. Bearers quarters in gas proof cellars across the street. The village is regularly shelled, mediums, heavies and gas. The wounded are evacuated from A.D.S. by motor ambulance to HENENCOURT Dressing Station. The conditions of the R.A.P.'s being so poor and with no means getting or making meals hot in the dug-outs, the bearers are relieved every 24 hours and return to their quarters in MILLENCOURT for 48 hours. If the sector became more active a relay would be necessary. The quarry in the sunken road would be suitable for this purpose. In such a time the village would ~~be~~ also be more constantly and heavily shelled making it advisable to cut MILLENCOURT out of the line of evacuation and carry by series of relays direct to HENENCOURT, the route to pass between MILLENCOURT and LAVIEVILLE.

ROUGH SKETCH MAP of the MILLECOURT SECTOR

Showing Wounded Evacuation ROUTE

AD-5 + Amb. Collecting Post.

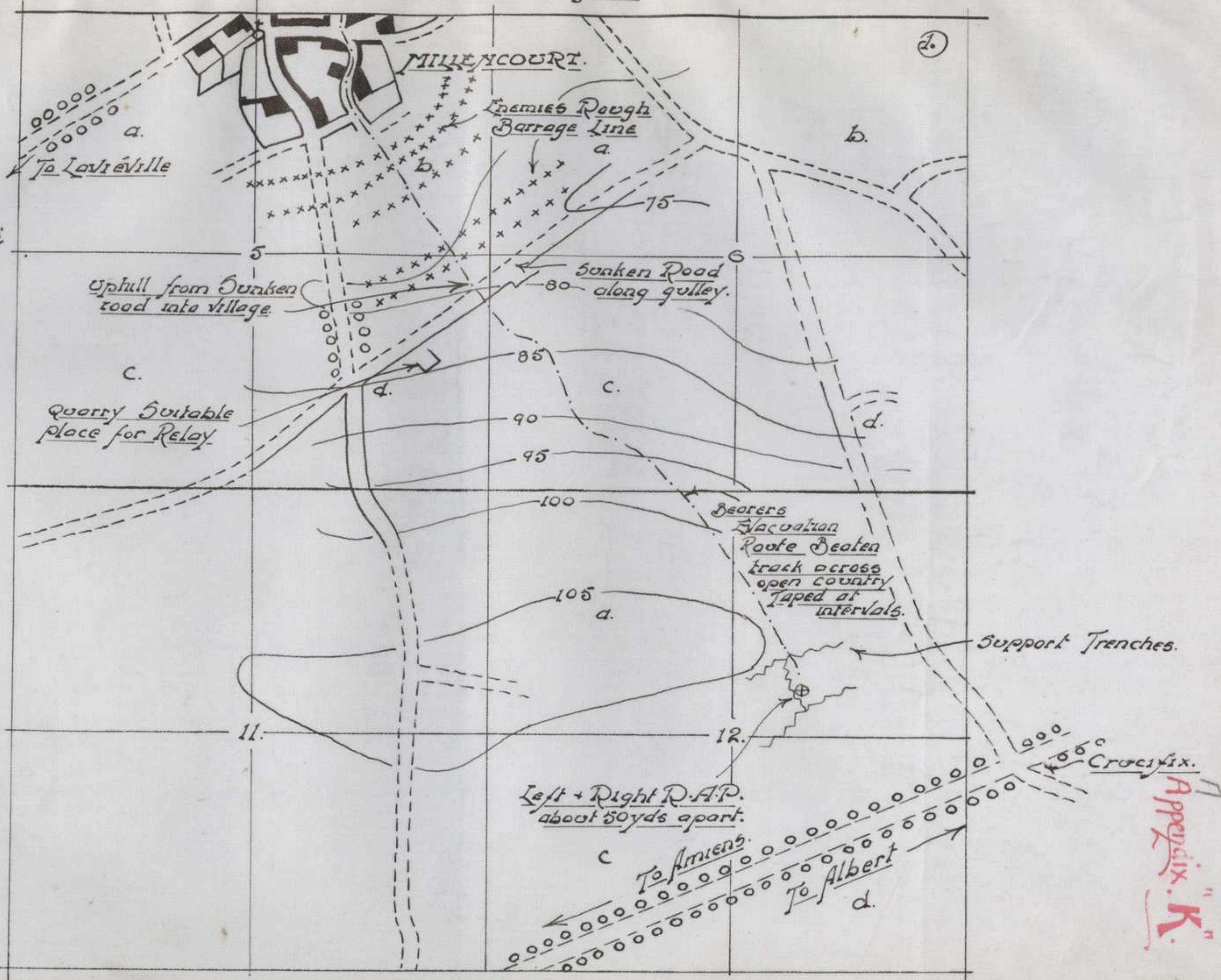

Sydney Hastings.
6th Aus Field Amb.
10.4.18

R.A.P's.
Sheet 62^D N.E
D. 12. b. 3. 2.

500 yds.

Appendix "K"

EVACUATION ROUTES ON RIGHT & LEFT SECTORS OF 2ND AUSTRALIAN DIVISIONAL FRONT Sheets 57^d & 62^d

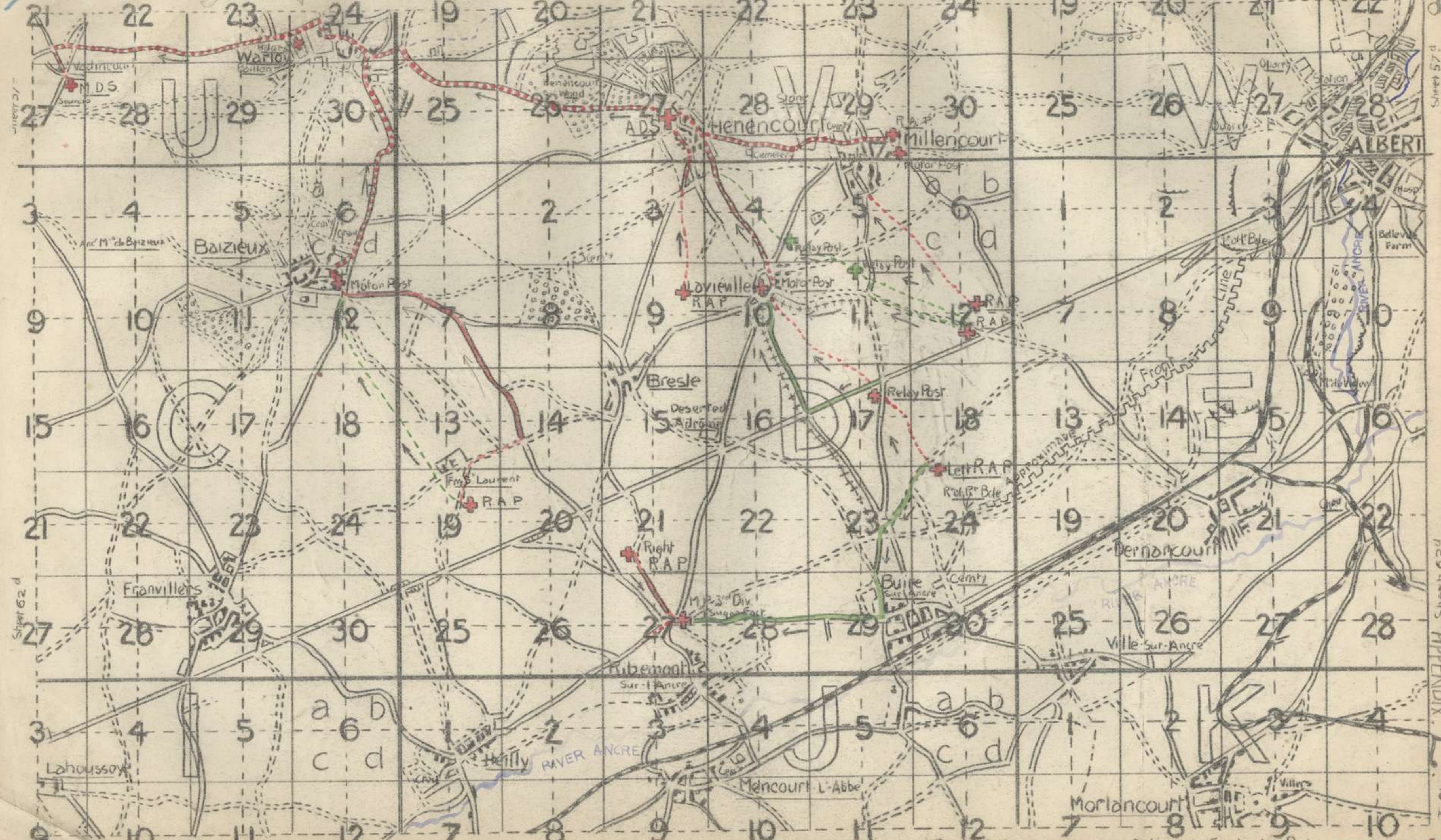

LEGEND: Actual Bearer Routes in Red. Alternative Bearer Routes in Green. Hand Carriage - Broken Line. Wheeled Stretchers - Continuous Line. Possible Car Routes at Night + + + + Ordinary Car Evacuation Routes R.A.P.s +

Sheet 57^d

Sheet 62^d

APPENDIX

DAILY DISPOSITION RETURN 16.4.18 8th Aust. Field Ambulance.

FORWARD POSTS

Right Sector	Bearer Sub-Div.		Tent Sub-Division		Sundries	Cars & H.Ambs	Ration Strength
	Off.	N.C.O's	Men	N.C.O's			
M.P.LAVIEVILLE	1	1 Sgt 1 Cpl (QM)	8	-	6th 2 N.D. 1 Driver 1 Orderly 1 Batman	1 Ford	16
Art. R.A.P.	-	-	4'	-	-	-	-
L. Relay	-	-	8	-	-	-	8
L. R.A.P.	-	-	8	-	-	-	8
R. R.A.P.	-	-	4"	-	-	-	-
Right Total	1	2	32	-	2	3 1 Ford	32
<u>Left Sector</u>							
M.P.MILLENCOURT	2	1 Sgt 1 L/cpl	16	1 Sgt.Std. 1 L/c.N.D.	1 N.D. 1 Driver 1 Orderly 2 Batman	1 Daimler	27
R.A.P. North	-	-	4	-	-	-	4
R.A.P.	-	-	4	-	-	-	4
Left Total	2	2	24	2	1	4 1 Dmlr	35
Total of F'wd Posts.	3	4	56	2	3	7 1 Ford 1 Dmlr	67
<u>HENENCOURT A.D.S.</u>							
	2	1 L/c 5th 1 " 6 "	3	1 S/S.Disp 1 Sgt do 1 " Clerk 1 L/S Std 1 " Nurse 1 " Cook 1 L/c.Nurse 1 " Cook	14	1 Batman 2 Drivers Attached 2 M.P's	2 Dmlrs
HENENCOURT A.D.S. Total	2	2	6	8	14	5 2 Dmlrs	37
<u>BAIZIEUX</u>							
	1	-	-	1	2 N.D's	2 MT Drivers 1 H. do 2 W.Ord 1 Batman Attached 4 San.Sect.	1 Dmlr 1 H.Amb. 2 H.D. 10
Support R.A.P.	-	-	4	-	-	-	4
BAIZIEUX Total	1	-	4	1	2	10 1 Dmlr 1 H.Amb. 2 H.D.	18

'Rationed by Arty. Right Sector 5th A.Fld Ambulance, except where noted.
" do " Battn Left do 6 " do do

Appendix "M"

DAILY DISPOSITION REPORT

H.Q. WARLOY

6th Fld Amb. Off.	Bearer N.C.O's	Sub-Div Men	Tent N.C.O's	Sib-Division Men	Sundries	Cars & H.Ambs.	Ration Strength
5	2 GD.Sgts	68	1 Sgt.Mjr,	1 N.D.	2 Q.M.Stores	1 Dmlr	
	3 Cpls		1 Q.M.S.	2 Clerks	6 Sundry D's		107
	4 L/cpls		2S/S.Disp	3 Cooks	Attached		
			1 " Clerk	1 D.R.	3 San.Sect.		3
			1 Sgt do		Transport.		
			1 " N.D's		1 W.O.	2 H.Ambs	
			2 Cpl. Pk.Str		2 Sgts		
			1 " Cook		1 Cpl Farrier		
					1 L/cpl		
					22 Drivers		
					7 MT do		
					4 Batmen		
					4 W.Cleaners		17 H.D.
					4 W.Orderlies		25 L.D.
					1 Cook		
5th Fld. Amb.	1 GD.Sgt.	27			3 Drivers	1 H.Amb.	2 H.D.
	1 Cpl				3 Orderlies	1 Ford	
	3 L/cpls					1 Dmlr	38
H.Qrs Total	5 14	95	10	7	64	2 Dmlrs	19 H.D.
						1 Ford	25 L.D.
						3 H.Amb.	195
GRAND TOTAL	11 20	161	21	26	86	6 Dmlrs	21 H.D.
						2 Fords	25 L.D.
						4 H.Ambs.	317

Other Information:-

	Amb H.Qrs WARLOY.	Grande Rue de Baillon					WATER SUPPLY
	A.D.S. Chateau	HENENCOURT					WARLOY Water Point
Left Sector	Motor Post	MILLENCOURT	V.29.d.6.1.				Water Cart
	R.A.P.	do	V.29.d.6.2.	23rd Battn			Local Well
	R.A.P.		D.12.d.2.8.	24th Battn			
	R.A.P. North		D.12.b.3.2.	21st do			
Right Sector	Motor Post	LAVIEVILLE	D.10.b.3.8.				Local Well
	R.A.P.	do	D.10.b.2.4.	22nd Battn			
	L. Relay		D.17.b.4.4.				
	L. R.A.P. R.A.P.		D.24.a.1.8.	25 & 26th Battns			
	R.A.P. (Arty)		D. 9.b.6.7.	4th A.F.A. Bde			
	R. R.A.P.		D.21.c.9.7.	28th Battn			
	Motor Post 3rd Div.		D.27.b.2.0.				
	Support R.A.P.		D.19.b.1.0.	27th Battn			
	Motor Post BAIZIEUX		Billet 50 York Street				Local Well
	R.A.P.		C.12.a.0.5.	46th Battn			

Appendix M

6th Australian Field Ambulance.DAILY DISPOSITION RETURN OF PERSONNEL, BLANKETS & STRETCHERS.

	Personnel Off. O.R's	Blankets	Stretchers
WARLOY H'qrs (Grande Rue de Baillon)	5 187	245	145
BAIZIEUX M.P. (Billet No.50 York St)	1 9	20	6
Support R.A.P. (D.19.b.1.0.)	- 4	4	2
A.D.S. HENENCOURT (Chateau)	2 31	97	35
<u>Right Sector.</u>			
LAVIEVILLE Motor Post (D.10.b.3.8.)	1 15	25	24
Arty R.A.P. (D. 9.b.6.7.)	- 4	6	2
L. Relay (D.17.b.4.4.)	- 8	30	13
L. R.A.P. (D.24.a.1.8.)	- 8	30	10
R. R.A.P. (D.21.c.9.7.)	- 4	10	3
<u>Left Sector</u>			
MILLENCOURT Motor Post (V.29.d.6.1.)	2 25	30	10
R.A.P. North (D.12.b.3.2.)	- 4	18	11
R.A.P. (D.12.d.2.8.)	- 4	18	10
Total	11 303	533	271

17.4.18

GENERAL PROCEDURE TO BE ADOPTED IN CASE OF ADVANCE OR WITHDRAWAL.ADVANCE

(a) Keeping touch.

(1) With Brigade Headquarters:- Immediately an advance appears imminent the Officer i/c of A.D.S. will detach 2 runners, with full water bottles three days rations, and 1 blanket each, but without packs, to 6th. A.I. Bde H'qrs. Immediately on arrival at site of new H.Q. one of them will report back to the A.D.S. with map location of new site. The second man will remain meanwhile with Brigade H.Q. in case of a further move during the temporary absence of the original runner. The Officer posting these men at Brigade H.Q. will at the same time make arrangements for Brigade to ration them, if necessary, after the third day.

(2) With R.A.Ps:- A squad posted at a R.A.P. will move with ~~the~~ the RMO whenever he selects a new R.A.P. site, and will at once report new map location to Officer i/c nearest forward Ambulance Post.

(3) Forward Ambulance Posts with A.D.S.:- Officer i/c of each forward post will detail 2 runners whose function will be to keep in constant touch with A.D.S. reporting new forward posts map locations to O i/c of A.D.S. whenever any changes occurs.

(4) A.D.S. with Ambulance H'qrs:- O i/c of A.D.S. will detail 2 runners to keep in touch with Ambulance H'qrs and to bring back from him reports in any change of locations of Brigade H'qrs., Forward posts, or A.D.S. itself as well as any other message or requisition.

NOTE Under no circumstances should both runners attached to any post or H'qrs be away from the post simultaneously.

(5) Horse Transport with Ambulance H'qrs.:- Transport W.O. will attach 2 mounted men to Ambulance H'qrs immediately it moves. The transport will remain parked in its present position under transport W.O. until instructions are sent from C.O. by mounted orderly who, will act as guide.

(6) Ambulance H'qrs. with A.D.M.S.:- This Unit will send back by despatch rider disposition and location reports to A.D.M.S. whenever a change of any post occurs during an advance.

(7) Water:- All ranks will fill their water bottles daily, and keep them full.

(8) Rations :- Iron rations already issued will be kept handy by every N.C.O. and Man and invariably carried by him in the event of an advance. The Q. Master will hold at all times at Ambulance H. Qrs a 24 hours emergency rations.

(9) Automatic change over between forward and reserve Ambulances.

Immediately a definite advance has taken place, reserve Field Ambulance will establish an A.D.S. and take over the forward evacuations, the one time forward Field Ambulance meanwhile establishing a M.D.S., and taking over the rear evacuations.

- No. 2 WITHDRAWAL. The likelihood of a withdrawal is exceedingly remote - nevertheless even this contingency must be provided for.
- (a) Warning to all Posts:- The Commander of any post receiving authentic news of a withdrawal will immediately endeavour to send back definite written news to A.D.S. by runner or car, giving as far as possible the direction from which the attack is expected - whether right or left flank or frontal. The nature of the operations will most probably make it impossible for this message to be sent, and the almost invariable cutting of wires by the first barrage will render ~~xx~~ impossible any warning of posts by Brigade H.Qrs through Battns. The question of warning will consequently become a matter for each individual post Commander.
 - (b) Despatch of Motor Ambulances:- If an initial enemy barrage is laid down but it is still reasonably possible to get away the Motor Ambulance attached to the Motor Post, this should be done at once after loading on to it any local casualties that may have occurred. No useful purpose can be served by keeping the cars at the post in the event of a heavy barrage, as it will almost certainly be rendered useless, whereas it might be rendering useful service back in evacuating from the A.D.S. wounded who have reached there by other means. On the other hand no drivers life is to be thrown away in a forlorn effort to ~~run~~ a car out through a box barrage. Cars which have succeeded in getting away from the Motor Post, will not return unless specially ordered to do so by an Officer if this Unit or an attached Medical Officer.
 - (c) Evacuation of Wounded:- It is quite ^{possible} that during a withdrawal it might be found impracticable to evacuate more than a very small proportion of our wounded. Where possible therefore, the balance should be placed in the safest position offering, with, if obtainable a supply of water. Only under the most exceptionable circumstances is it justifiable for medical personnel to be left or remain behind, and in allowing sentimental considerations to outweigh his sense of proportion an Officer i/c of a post would be incurring a very grave responsibility. A case was recently brought to notice in which two Medical Officers remained behind and were captured with approx. five wounded, the Army thus being deprived of services which would have been useful to several hundreds of men. The Officer i/c of each ~~xxxx~~ individual post must exercise his own judgment in this matter.
 - (d) Abandonment of Posts:- The exact moment at which any post should be abandoned must remain entirely at the discretion of the Officer i/c of the post. An attempt should be made to strike the mean between staying too long and abandoning the post, when a counter attack might leave it in our hands.
 - (e) Personnel of R.A.P s. and Relays:- Squads attached to R.A.P's which have automatically fallen back on a forward Ambulance post will where possible be sent back to the A.D.S. for instructions, should they have lost touch with the R.M.O.. If still in touch with the R.M.O. they will remain with him to keep up communications between R.M.O. and Field Ambulance.

- (f) A.D.S.:- As soon as it becomes apparent that the A.D.S. must be ultimately abandoned, the Officer i/c will send away in small parties all A.D.S. personnel with the exception of 3 or 4 necessary for loading Motor Ambulances. The Officer i/c will retain and man with this small loading party the A.D.S. site as a Motor Post, until the last possible moment in the hope that the cars may be able to make several trips before the position becomes untenable. Finally the cars will report back to the new A.D.S. for instructions.
- (g) Evacuation of Medical Equipment:- It is unlikely that on receipt of news of a retirement there would be time or inclination to send Horse Transport up to forward, for collection of Medical Equipment. An attempt should be made however to save as much of the equipment as possible on cars carrying a full load of patients and by other means offering.
- (h) Destruction of Transport:- Under no circumstances must Horse Transport be allowed to fall into the hands of the enemy. If a vehicle cannot be possibly got away, several spokes and fellows of each wheel should be knocked out, the axle bent if possible by several blows, and the team either ridden away or destroyed.
- (i) Stores and Equipment:- Nothing except actual drugs, splints and such purely medical and surgical equipment must be left for the enemy. Cotton Wool, roller & triangular bandages, gauze, lint, and all such cotton articles, also all wools, fats, and picric acid will be entirely destroyed by burning where possible. Where such stores as food, blankets clothing, etc, cannot be got away they will be covered with kerosene and fired, but only on a definite order of an Officer of this Unit.
- (j) Rendezvous for Personnel:- All ranks will be informed that should any retirement take place with much scattering of medical personnel, and consequent loss of touch with Unit, such unattached personnel will rendezvous without delay at M.D.S. BEAUCOURT, or failing this at 2nd Ayst. Div. H.Qrs wherever this may be.
- (k) Horsed Transport:- In the event of a retirement considerable ^{enough} to effect WARLOY, all transport will be harnessed ready for instant hooking in. Expendable stores etc, at present in Q.M's store would at once be loaded. On the order being given by the C.O. or his direct representative to hook in and march off, the whole horse transport will march under transport W.O. to BEAUCOURT, where it will pull off the road ~~and~~ in open formation and unhook but not unharness and await orders. Horses in this case will not be taken some distance from the wagons for water, but water cart will be filled and horses watered from this by buckets.

14.4.18

10

Particulars of M.D.S. BEAUCOURT - MONTIGNY

The M.D.S. consists of two sections - viz,
 Chateau MONTIGNY, for Stretcher Cases
 Church BEAUCOURT, for "N.Y.D. Gas" and Walking Cases.
 While casualties are light all types of cases are dealt with at MONTIGNY.
 They are brought from A.D.S. FRANVILLERS and A.D.S. WARLOY by divisional
 ambulance cars and evacuated to C.C.S. by cars of 3rd M.A.C.
 Each A.D.S. is distant from M.D.S. approx. 4½ miles and C.C.S.
 (VIGNACOURT) approx. 10 miles. State of roads medium generally, and
 between CONTAY and BEAUCOURT rough. When casualties are heavy, stretcher
 cases only are dealt with at MONTIGNY, all walking cases being directed
 across to the Church BEAUCOURT, where they sit in the seats while waiting
 to be dressed and are afterwards directed to the barn near by in Fork-
 Street for feeding and storage. This barn is capable of holding about
 120 men and has a clean sawdust floor. At one end is a buffet and counter
 for distribution of hot drinks and food. A ramp has been built at the ~~xx~~
 street door of the barn so that when Motor lorries back up to it the woun-
 ded can walk straight on to the tailboard. These lorries are empty re-
 turning Supply lorries and are obtained by arrangement with Division.
 Estimate of number of motor lorries required to evacuate 800 walking
 wounded per 24 hours, if lorries are at the full disposal of the Field
 Ambulance:-
 When evacuating to C.C.S. VIGNACOURT 10 lorries
 " " " C.C.S. PICQUINY 13 "

each lorry carrying 20 wounded per trip.

BILLETS OFFICERS Marie BEAUCOURT C.O. 2nd in Command and three others.
 Billet No. 23 - 2 Officers.

Billet No. 8 - 2 "

O/Ranks Chateau MONTIGNY 2 Officers - Total 11 Officers.
 Billet No. 16. Horse Transport Personnel in 4 Bell
 Tents at Horse Lines in rear of Town Major's billet
 at Western end of BEAUCOURT village.

Orderly Room, Officer's Mess and H'qrs of Ambulance Marie
 BEAUCOURT.

Q.M.Store Billet 8A

WATER By water cart from local water point.

LIST OF C.C.S.'s to which to evacuate:-

Area	Casualty Clearing Stations
111rd Corps	Nos. 5 & 47 Casualty Clearing Stations (both at CROUY) receiving in rotation. Overflow to Nos. 12 & 55 C.C.S.'s (both at LONGPRE.)
Australian Corps	Nos. 20 & 61 C.C.S.'s (both at VIGNACOURT) and No. 4 C.C.S. at PERNOIS. Receiving in rotation.
All N.Y.D.N., No. 12 C.C.S.	N.Y.D.Gas, S.I.W. Ophthalmic & Dental Cases will go to

1.5.18

(signed) H.L. St V. Welch Lieut. Colonel
 C.O. 6th Aust. Field Ambulance.

DISPOSITION OF PERSONNEL

M.D.S. MONTIGNY	Officers	N.C.O's & Duties	Men & Duties
	4	1 S/Sgt Dispenser	12 Bearers
		1 Sgt N.Duties	10 N.Duties
		1 " Clerk	2 Batmen
		1 " Steward	1 Hot drinks for patients
		1 Cpl Cook	1 Cookhouse
		2 L/Cpl Evac.N.C.O	1 Clerk
			3 Gen.Duties
			Total 4 Officers 37 O.R's
Div.Coll.Stn. (Barn at BEAUCOURT)	1	1 Sgt N.Duties	4 Nursing Duties
		2 L/Cpl do	1 Clerk
			1 Patients Cook
			Total 1 Officers 9 O.R's
Reserve Dressing Room for Walking Wounded. (Church BEAUCOURT)			4 Nursing Duties
			Total 4 O.R's.
Amb. H'qrs (Marie BEAUCOURT)	6	1 W.O. Gen.Duties	4 Q.M. fatigue
		1 Q.M.S.	3 Cookhouse
		1 Sgt. Steward	2 Billet Ord's
		2 S/Sgt Dispensers	1 Regt. Tailor
		2 Sgt Clerks	3 Gas Picquet
		1 " Gen. Duties	6 Gen. Duties
		2 L/Sgt. do	2 Sgts Mess Ord's
		1 do Cook	1 do Cook
		1 Cpl Cook	4 San. Fatigue
		1 " San. N.C.O.	1 Car Orderly
		1 L/Cpl Gen. Duties	2 Carpenters
		1 Cpl Packstore	1 Regt. Bootmaker
			1 Bath House
			1 Pte Clerk
			1 Post Orderly
			1 Despatch Rider
			1 Officers Cook
			2 Off. Mess Orderlies
			1 Sign Writer
			1 Regt. Barber
			9 Batmen
			1 Whitewasher
			Total 6 Officers 64 O.R's

QUARTERMASTER'S REPORT FOR MONTH

P

RATIONS AND SUPPLIES:- It is now a routine procedure in this Unit that whenever a party is detached from the main body or headquarters of the unit for any period, and the size of the party warrants it, a representative of the Quartermaster-usually a Sgt Steward-is detached with it to supervise generally its rations and supplies and to be responsible for station stores, if any, taken over by an outgoing unit. The conditions and circumstances under which the party is working, more than the size of the party, may determine the necessity or otherwise of this Q.M. representative; but one or two Officers & 10 O.R.'s or 15 running a A.D.S. may be taken as a fair example of a case in which such a representative is invaluable. In the same way a bearer sub-division complete, or less Officers, attached temporarily to another unit for duty needs a Q.M. representative of its own unit to supervise the distribution of its rations etc.

RAVELSBERG and PLOEGSTEERT SECTOR 24.3.18 to 1.4.18 :-

RATIONS. Two methods of rationing the A.D.S.'s and forward posts were tried in this sector.

(1) Sending rations in bulk by limber to UNDERHILL FARM A.D.S. and BREWERY A.D.S. for splitting up at, and distribution from each A.D.S. to its own forward posts.

(2) Bagging the rations in sand-bags at RAVELSBERG Ambulance-Headquarters according to the number of men at each forward post, and labelling the bags definitely for each post e.g. "Right R.A.P. 4 rations" before despatch, and sending the rations for each A.D.S. in bulk, but in sand-bags, to each A.D.S. for distribution to the personnel at that A.D.S. by the Q.M. representative attached there.

Method No.2 was found to be undoubtedly the best. Reasons:-

- (a) More equal distribution owing to the greater part of the splitting up being done under the one control at Ambulance-H.Qrs.
- (b) Prevention of soiling of the food such as occurs where big bulks of food such as half cheeses and sides of meat are carried in limbers.
- (c) Convenience in handling in smaller bulks.
- (d) Saving of time in forward distribution.
- (e) Cleaner food - one central meat house, chopping block, knives etc. well looked after in place of several make shifts further forward.

Special difficulties - practically nil.

- (a) The return of ration sand-bags from the forward posts through the A.D.S.'s to H'Qrs if properly organised is simple.
- (b) Provided that coal and kerosene are not carried in the same half limber as food, and that the limber is properly cleaned out there is no soiling of the food. Kerosene is never on any account allowed to be carried in a limber that is being, or will be, used for carrying food.

WATER:- Each A.D.S. supplied its forward posts with water in petrol tins (2 gallons per tin with brass screw top) and these were relayed through to the furthest posts forward (the R.A.P.'s) UNDERHILL Em. A.D.S. drew its supply by water cart from water point at HYDE PARK CORNER (vide disposition and information state handed over to relieving Field Ambulance) BREWERY A.D.S. derived its supply from a local well passed as fit by the Sanitary Section.

BLANKETS & STRETCHERS:- Blankets and Stretchers sent down on patients from A.D.S. to M.D.S. were replaced in the usual way by an equal number

-2-

from M.D.S. sent back to A.D.S. on returning cars.

FOOD & MEDICAL COMFORTS FOR PATIENTS:- A good supply of extra food and Medical Comforts was kept at A.D.S.'s. For all patients allowed it hot drinks (Coffee or Cocoa and Milk) was always available, especially those patients who were likely to need an Anaesthetic on arrival at C.C.S. The following are the Medical Comforts drawn for month

Tea	1 C/s	Tongue	44 lbs	Ideal Milk	5 C/s
		Jam	1 C/s	Butter	4 "
		Flour	3 Bags	Rabbit	3 "
		Bread	500 lbs	Coffee	2 "

FUEL:- Coal and coke from H'qrs by limber - wood from local supply.

WARLOY - HENENCOURT - MILLENCOURT - LAVIEVILLE - BAZIEUX Sector.

RATIONS:- In this case the method of bagging rations at Ambulance H'qrs, Warloy, was employed. Rations were bagged and labelled for individual posts, sent by limber each afternoon to A.D.S. HENENCOURT CHATEAU, and thence sent forward by Q.M. representative stationed there to Motor Posts at MILLENCOURT AND LAVIEVILLE where the Q.M. representative at each Motor Post sent on the Forward Post ration bags by the bearers, through the bearer relays. The rations were split up and bagged in accordance with Daily Disposition State (appendix M) The ration was a very satisfactory one, consisting of:-

Bread	3 lbs	Butter	$\frac{1}{2}$ lb) four men
Meat	2 $\frac{1}{2}$ "	Jam	$\frac{1}{4}$ "	

Candles qty Milk (1 tin every 3 days)

In addition each ration bag for four men contained daily four pairs of dry socks, a quantity of cigarettes, and one tin of café au lait. These comforts were occasionally supplemented by chocolate and biscuits.

DRY SOCKS:- The dry socks were reckoned on a basis of four pairs for each bearer in the line - thus -

- One pair on the man.
- One soiled and wet pair collected and on its way to H'qrs.
- One pair being washed and dried at H'qrs.
- One pair dry and on its way back to the man.

Q.M. representatives at each post were responsible for collection from the men and forwarding to H'qrs of all soiled and wet socks. As the weather improved and dried it was found that one dry pair of socks per 48 hours was sufficient. In two cases it was found more convenient, owing to distance, to arrange for certain squads to be rationed by the Unit (Inf. or Artillery.) to which the R.A.P. belonged. These men therefore took with them when being posted for duty 48 hours rations to cover the time before the Unit's indents for extra rations could be filled, and four days comforts, to cover the period of their whole tour of duty.

COOKING OF RATIONS AND SUPPLY OF HOT FOOD IN FORWARD POSTS AND R.A.P's:-

Where fires could not be lighted, owing to enemy observation, Posts

-3-

were supplied with Primus Stoves or Tommy cookers. Meat was cooked in bulk at A.D.S. HENENCOURT and sent forward hot in dixies by car to Motor Posts and forward posts. LAVIEVILLE was able to use a wood or coal stove in a cellar, the smoke dispursing through the house and so not being visible to the enemy.

FOOD FOR SICK AND WOUNDED:- Many men not ill enough or badly enough wounded to go back past motor posts or A.D.S. were kept for a few hours spell and fed before going back to their Units. Extra rations were obtained for these from A.S.C. Coffee and Milk and Cocoa kept hot on Primus stoves, biscuits, and more solied food was always available at motor posts and A.D.S. for patients passing through.

WATER:- A.D.S. HENENCOURT - By water cart from Warloy water-point. Motor Posts - from local wells requiring chlorination. Forward Posts - in petrol tins relayed through to R.A.P's by bearers.

BLANKETS AND STRETCHERS:- Nothing special.

DRUGS, DRESSINGS & GENERAL MEDICAL EQUIPMENT:- Daily by afternoon Ration limber on morning Indents.

SUPPLY OF CLEAN UNDERCLOTHING TO PERSONNEL IN THE LINE:- This was obtained in sufficient quantity from Bazieux Baths sent by car to A.D.S. and motor posts and the soiled clothing collected two days later and returned to the baths. By this time all men in their tour of duty had passed back from R.A.P's and Relays to motor posts, changed, and gone forward again wearing clean underclothing.

HORSE RATIONS:- During this period the Fodder Ration was good, being as follows:-

	L.D.	H.D.
Hay	9 lbs	9 lbs
Oats	10 "	15 "

On 26/4/18 an A.R.O. laid down that no more Linseed was to be given to horses until further orders.

ORDNANCE:- All Indents submitted to D.A.D.O.S. were promptly supplied. The system at present is very satisfactory. A motor lorry brings the stores to the Supply Dump daily from where they are issued to each Unit.

RED CROSS GOODS:- The goods supplied were very satisfactory, a varied assortment being always available. It is suggested that a Branch be formed nearer to the main body of Australian Troops - at present the nearest Depot is 30 miles away from this Field Ambulance. The following goods were drawn during the month:-

Chocolate	22 Pkts	Biscuits	12 C/s	Cigarettes	12,000
Coffee & Milk	9 c/s	Soap	84 Cakes	Shirts	150
Pyjamas	100 Suits	Tommy Cookers	100	Hospital Bags	300
Primus Stoves	8	Socks	230	Papers, Magazines	qty

R

REPORT ON HORSE TRANSPORT FOR MONTH.

VEHICLES.

REPLACEMENTS:- One Water cart in place of one destroyed by Shell fire at Messines on 11th instant.

CASUALTIES:- One Water Cart condemned by I.O.M. on account of bottom cracking in two places.

REPAIRS:- The sides of three Ambulance wagons painted three coats of G.S. paint, Red Crosses repainted and 1" white border painted round the Crosses. The old fashioned white hood has been given up as being too conspicuous. The whole hood except the red cross & 1" white border is now painted service color (dark olive green).

New spring put on "B" Section Amb. Wagon by 16th A.S.C.

G.S. WAGONS. Spare pole carrier's fixed on 6 wagons, these were supplied by 16th A.S.C. & adjusted to wagons by our men. One splinter^{rod} which had a flaw also replaced by 16th A.S.C. on "A" Section wagon. Two broken tail-boards & two unserviceable covers were replaced by Ordnance.

G.S. LIMBERS. One brake handle repaired on "B" Section limber by 16th ASC. A frame was put on each of the four limbers to carry four petrol tins for water. (vide diagram attached) Four unserviceable covers replaced by Ordnance.

WATER CARTS. Brake handle straightened by 16th A.S.C. One pole supporting bar replaced for one that was broken on train journey.

MALTESE CART. One side bar repaired by a wagon orderly.

HORSES

EVACUATIONS One H.D. suffering with Cellulitis evacuated to 2nd M.V.S. by V.O. on 13th inst.

REPLACEMENTS Nil.

During the month the horses have shown a marked improvement in condition and are fast loosing their coats. The improvement in condition of horses is due largely to a chaff-cutter which was obtained from a Salvage Dump near BAILLEUL. Grazing parades have made the green feed along the road sides improve the horses condition. The horses at present are in better condition than was the case during same period last year & previous year.

ROUTINE

Reveille 6.30a.m.

Parade 6.45a.m. On this parade the horse lines are cleaned and the manure dumped at end of lines ready for removal to manure dump which is at every village some little way from the town. In such a manure dump the manure is ~~dumped~~ packed as a preventive against breeding of house flies, and dump supervised under arrangements of the local Town Major. The weather being fine the horse rugs are taken off and spread out to air the horses are then given an oat feed with chaff.

Breakfast 7.30a.m.

Parade 9a.m. The rugs are removed, if not previously removed on early morning parade. The drivers then turn in to groom. After finishing their grooming the lines are again swept and manure carted to dump. Drivers then carry on with wagon & harness cleaning until 11a.m. when the

-2-

horses are cast off for exercise and watering at Army Horse Trough. (N°2- (vide diagram attached) After returning to lines at 11.40a.m. they are again given an oat feed with chaff.

Dinner. Noon.
Parade 1.45p.m. From this parade the men go on with wagon cleaning and the cleaning of harness, & polishing of steel work. For the cleaning of steel work sand is mostly used, but metal polish is very good if rust is thin and newly formed. Harness cleaning is gone on with until 3.20pm when the horses are again cast off for exercise and water. They return to the lines at 4p.m. when they are again groomed and the lines swept. The horses are then rugged and given another oat feed with chaff.

Tea 4.45p.m.
Parade 6.30p.m. The horses are given their hay feed which is tied on to lines ~~xxxx~~ in hay nets.

IMPROVEMENTS

Hay nets would have a much longer life if they were made with stronger material - telephone wire for preference. I estimate the life of the present hay net at about 4 weeks whereas the life of a wire net would be about 4 months.

Nose bags If these had a double bottom their life would be almost doubled especially in winter time when the horses are often in the open. The nose bag gets sodden with rain and slush and is easily torn.

Grooming Curry combs would be a great benefit in winter time to remove mud.

The ration of fodder during the month has been well up to the revised scale, but for horses doing constant work this ration is not sufficient especially for heavy draughts. The ration is at present:-

	<u>L.D.</u>	<u>H.D.</u>
Hay	9 lbs	9 lbs
Oats	10 "	15 "

MOVE FROM RAVELSBURG TO THE SOMME AREA.

On 2.4.18 the transport accompanied the Unit on the move to OUTERSTEEBNE. The transport went into a stable for 2 nights. On 4.4.18 the transport ^{move} to CAESTRE independently to entrain. The wagons were pulled on to the platform by horse/power. The horses were then unyoked and taken away to water prior to being trucked. The harness was left on horses. There was no trouble with the horses as they have become used to trucking. After the horses were trucked each driver took into the truck a nose bag feed and hay net feed for his horses to consume on the journey. While we were loading our horses an infantry loading party was putting the wagons aboard. On arrival at the detraining station the horses were unloaded, watered & yoked into the wagons as they were taken off the train. The wagons were pulled out of the station yard and halted to enable the horses to be watered and fed. The transport moved independently to VAUX-en-AMIENNOIS where billets were obtained for the night. The horses were again stabled in stables. The transport accompanied the Unit the following day on the march to PONT-NOVELLES where the column arrived at Noon. The transport parked a quarter of a mile out of the town. The horses put on to a line tied between the G.S.Limbers. This line was situated in a deep hollow & the horses were well sheltered from view and wind. About 3p.m. the enemy

-3-

shelled the main road. The 7th shell landed on the bank 5 yards from ~~our~~ our horse-lines but the horses were sheltered and there were no casualties. At 6p.m. orders were received to move and at 6.35p.m. the transport was on the road and moved to BEAUCOURT-sur-L'HALLUE arriving at 8p.m. The horses were again tied to a line between the wagons. The following morning 7.4.18 the transport moved independently to WARLOY where the transport parked. Posts were left standing by the out-going Unit & these were utilised for our lines. While at WARLOY the horses had a lot of green feed. On the eve of 17.4.18 the transport moved to BEAUCOURT Here new lines were made and round these a bomb proof shelter was built for the protection of the horses (vide sketch attached)

/y° 3.

ISOMETRIC SKETCH
 ARMY HORSE TROUGH

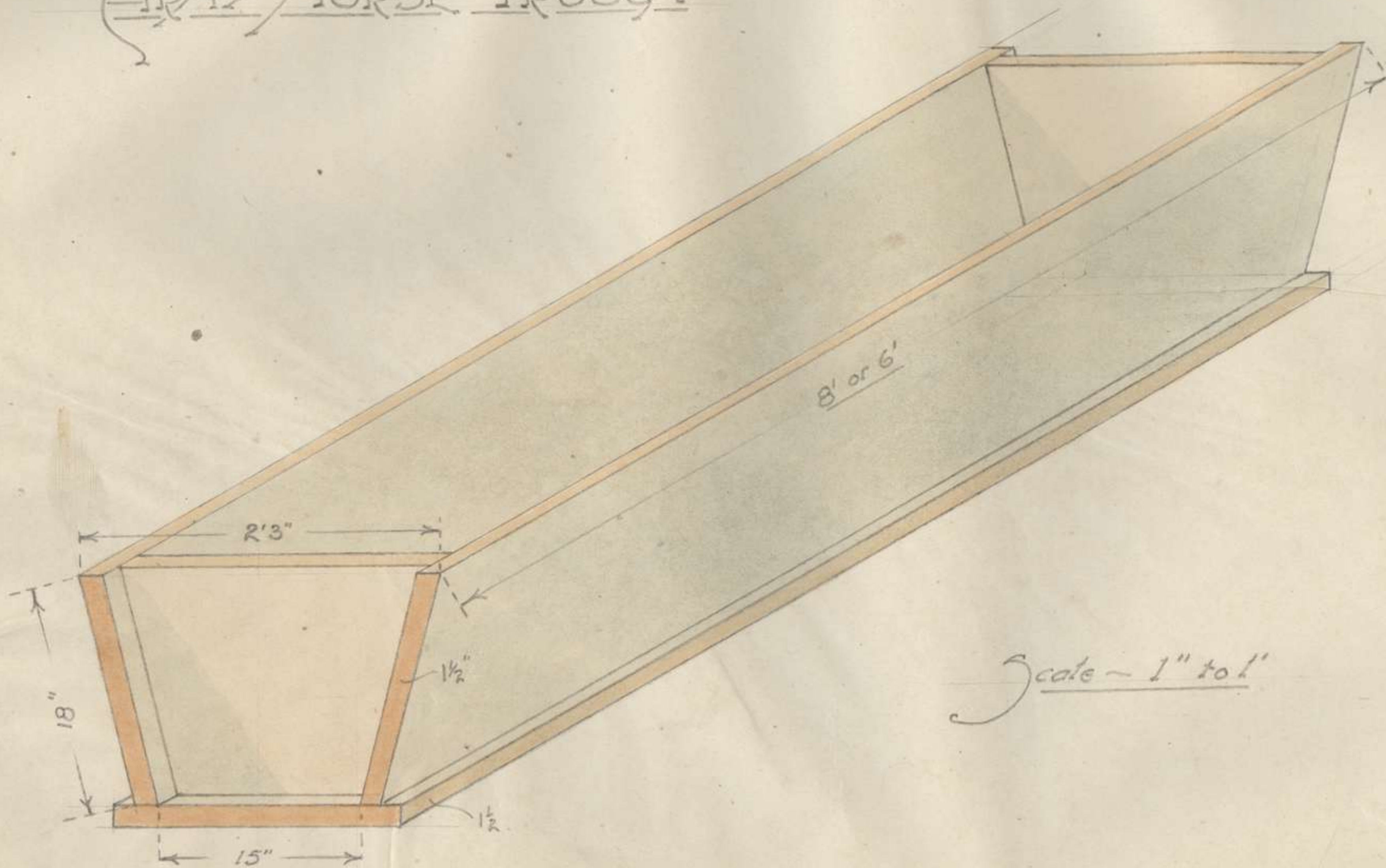

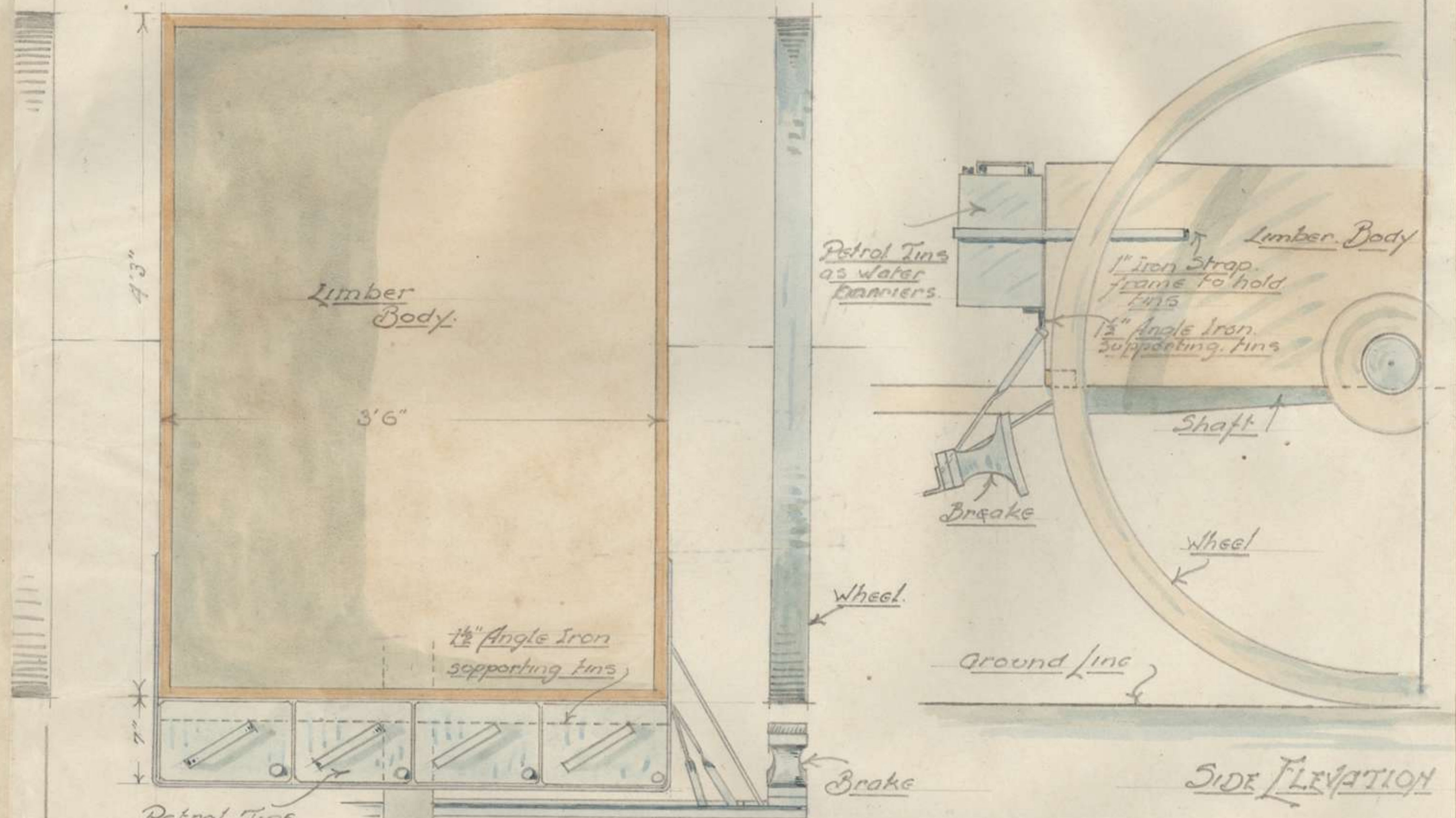

PLAN

SIDE ELEVATION

DITCH SHOWING PETROL TINS
 as WATER-CARRIERS
 as ATTACHED TO LIMBERS.

Scale:- 1" to 1'

Sgt E. Hastings.

Appendix: R

Block Plan of TRANSPORT LINES

6" Aust. Field Amb
Bomb proof parapets
to protect horses
Scale 1/20" to 1 ft

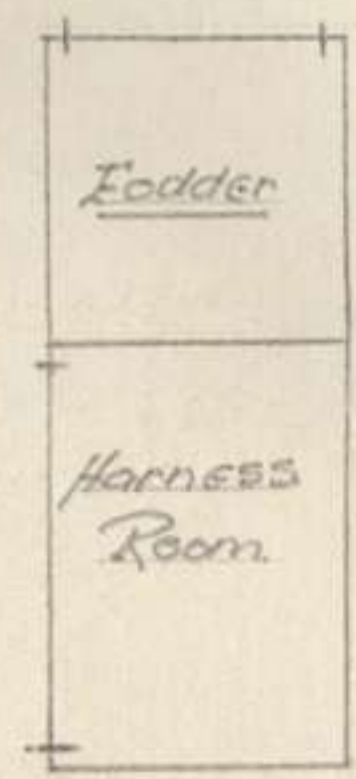
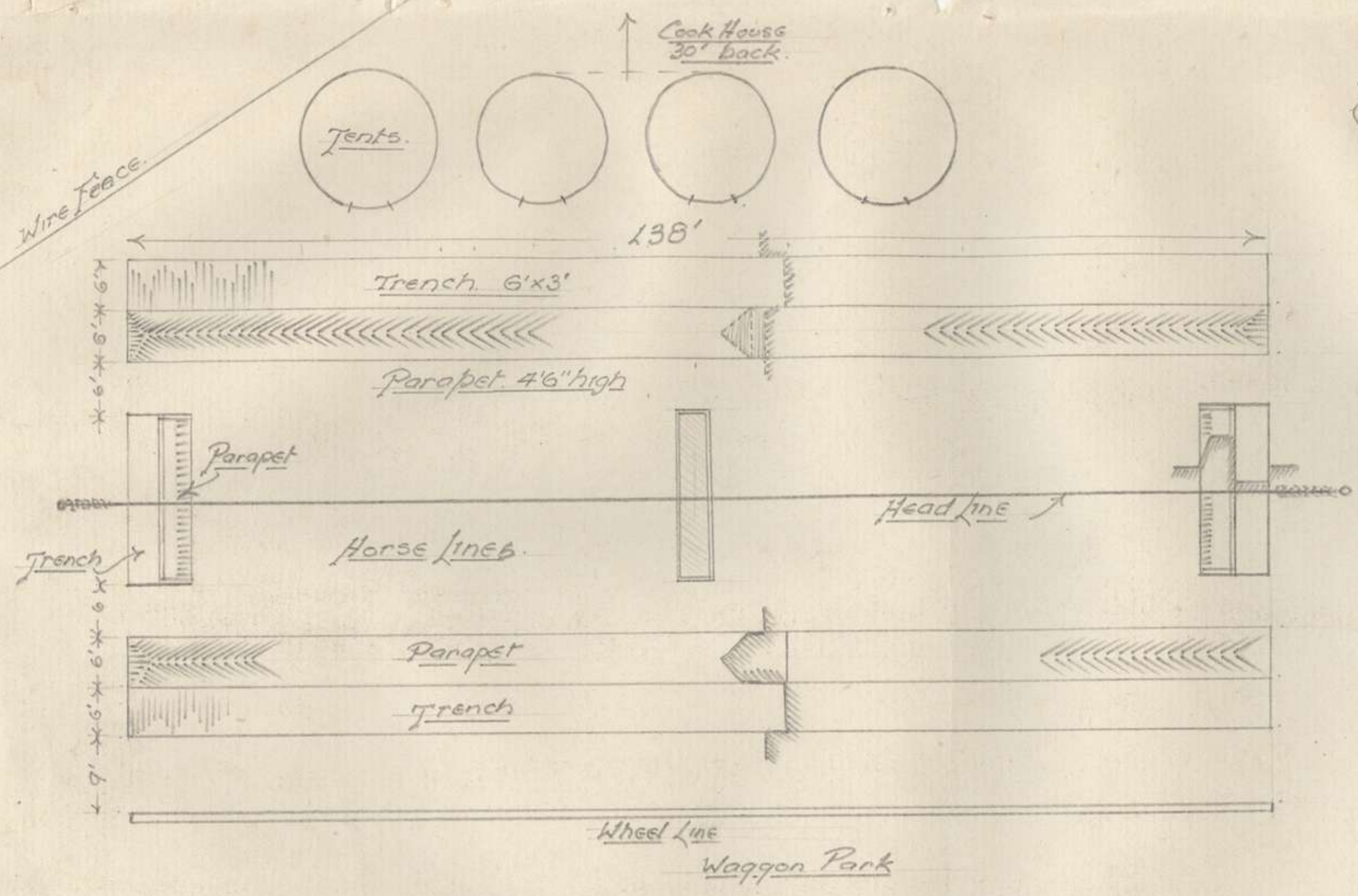

Appendix "R"

Road to Montigny

S

REPORT ON MECHANICAL TRANSPORT

Attached to 6th Australian Field Ambulance

The disposition of the Ambulance cars when I took over as Mechanical Transport Sergeant on 17/4/18 was as follows :-

- Daimlers 2 With Unit
- 2 Temp. attached to 5th Aust. Fld. Amb.
- 1 Temp. attached to A.D.M.S.

- Fords 2 With Unit

The Ambulance moved from WARLOY to BEAUCOURT on the evening of 17/4/18 2 Daimlers & 2 Fords accompanying Unit.

On 18/4/18 Ford car No 24108 was sent to workshops for general overhaul.

On 22/4/18 Daimler No 24102 giving trouble with gear box and differential was sent to workshops for repairs. I found the following defects:

- 3rd gear on ~~drill~~^{drive} shaft was badly worn.
- 3rd gear on counter shaft was badly worn.
- Worm drill and crown wheel was badly worn.
- Platinum points in magneto were badly worn.

Shortage of spare parts at workshops caused considerable delay in the return of this car to the Ambulance.

Ford car No 14646 was drawn from No 2 M.T. Coy to replace No 24107 evacuated on 2nd inst. I found this car in a very loose state.

On 23/4/18 one Sunbeam car attached for duty from 7th Aust.

Field Amb.

On 24/4/18 Ford car No 14646 out of action owing to faulty workmanship at Base in neglecting to drill oil holes to feed connecting rod big end bearings. I carried out the necessary repairs in the unit which occupied two days, the car being ready for the road at 5 pm. 25.4.18.

Two Daimler Cars reported back from temporary duty with 5th Aust Field Ambulance.

Sunbeam Car No. 29591 temp. attached for duty returned to 7th Aust. Field Ambulance.

Disposition of Cars on 30.4.18.

- Daimler No. 1 With Unit
- do 2 do
- do 3 do
- do 4 Workshop
- do 5 Temp. Attached A.D.M.S.
- Ford 1 With Unit
- do 2 Workshop

BLOCK PLAN OF MILITARY CEMETERY AT CHATEAU HILL MONTIGNY

Sheet 62^a.Y.W

B.18.a.4.6

SCALE OF FEET.

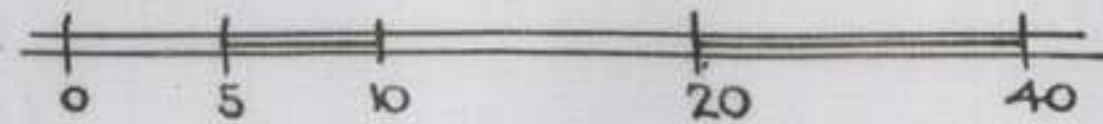

ENTRANCE

ROAD

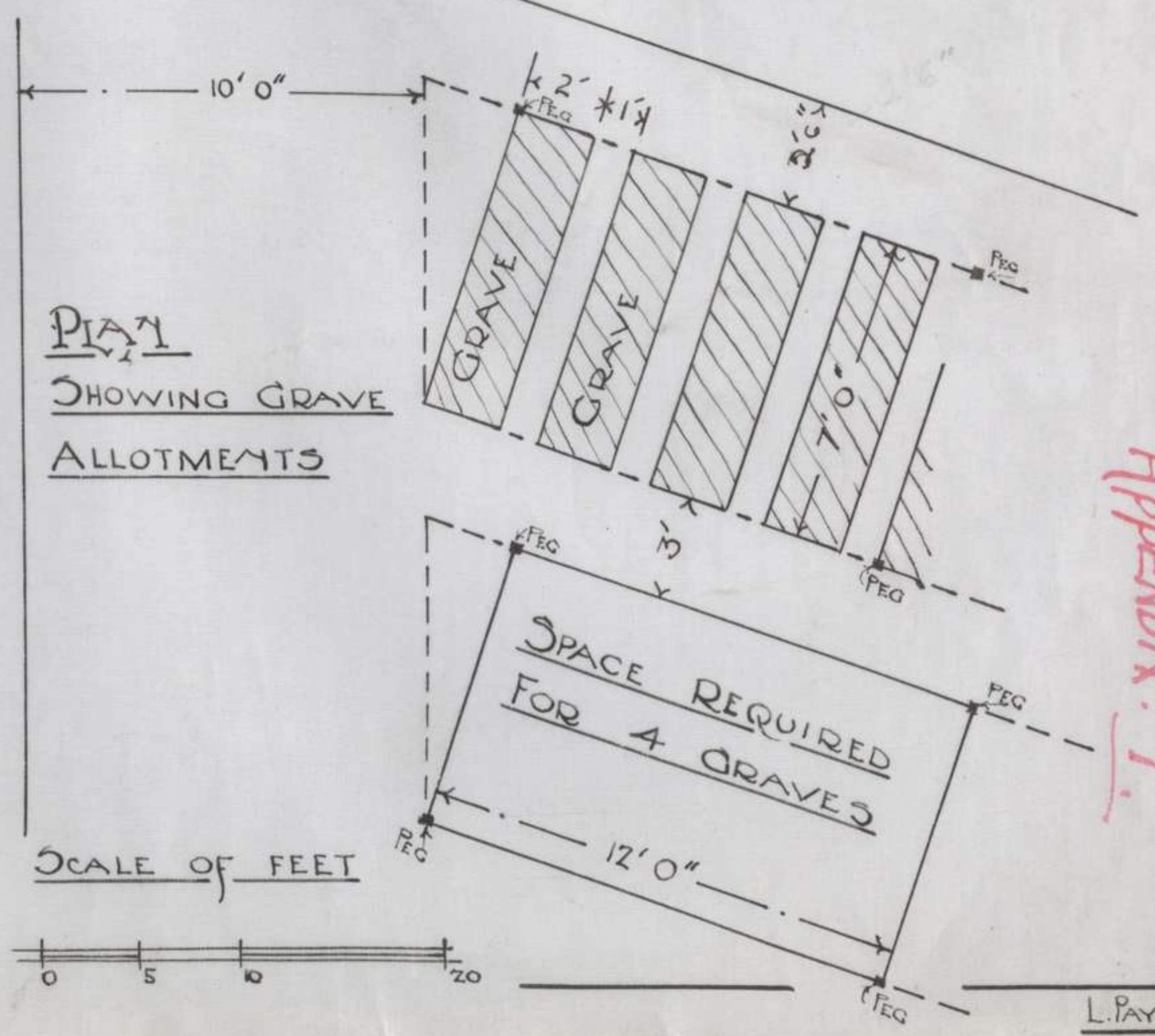
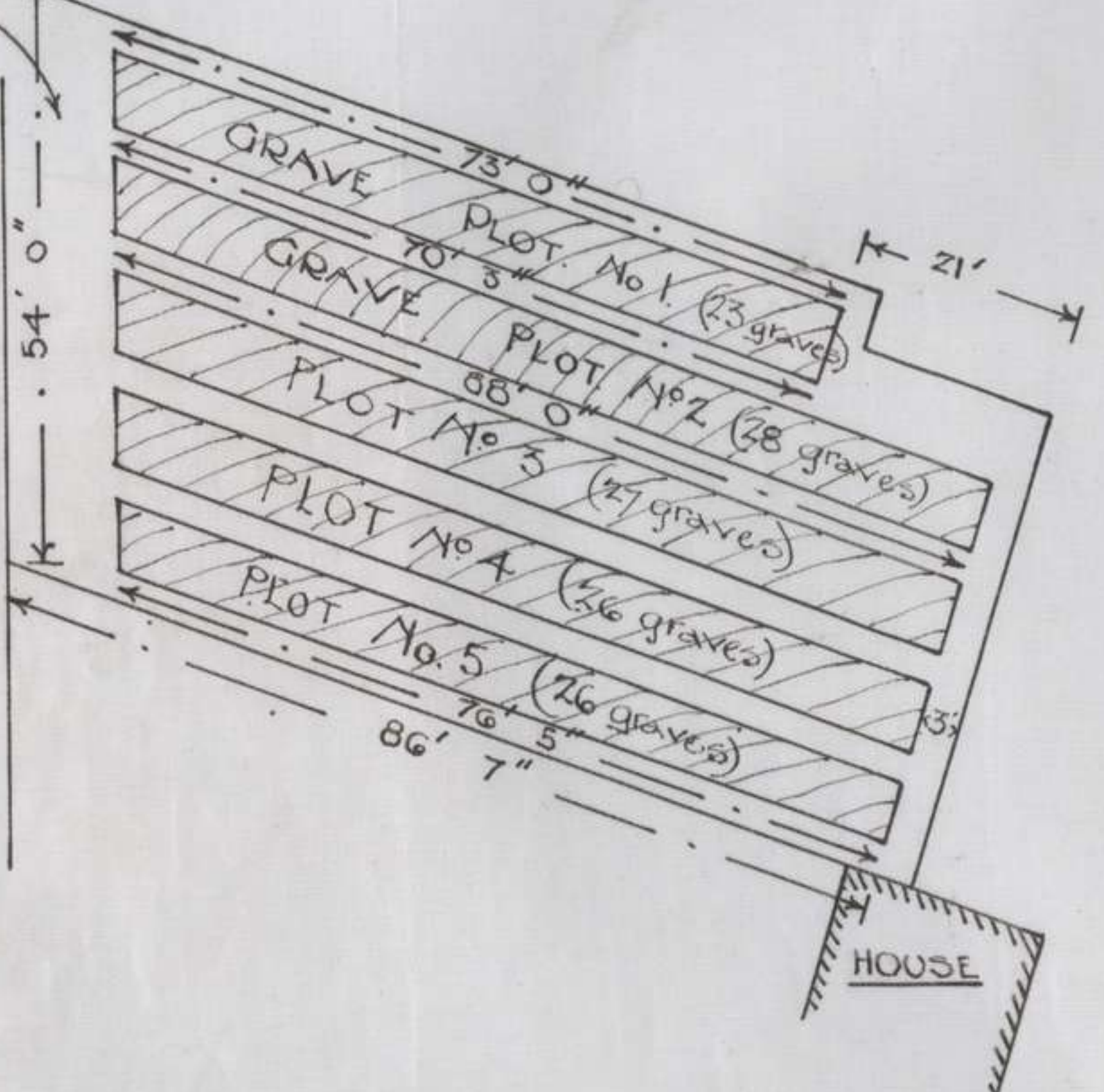

PLAN
SHOWING GRAVE
ALLOTMENTS

SCALE OF FEET

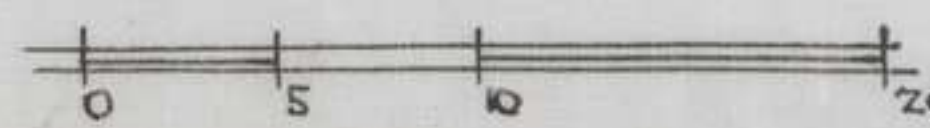

Appendix: "T"

L. PAYNE.

MOVEMENT OF PERSONNEL FOR MONTH

	1	2	3	4	5	6	7	8	9	10	11	12	13	14	15	16	17	18	19	20	21	22	23	24	25	26	27	28	29	30	
	OFFICERS																														
Attached Temporarily				1																											
Detached for Temp. duty				2									1																		
Rejoined from detached duty													1				2														
	OTHER RANKS																														
Died of W'ds.							1																								
Evac Wounded											1														1					1	
Evac Sick			2			1		1		1			1				1		1				1	1		2				1	
Detached for Temp. duty				12					1				1				67														
Rejoined from detached duty									1								14														
Rejoined from leave				1																											

OFFICERS

As On 31.3.18 10

M.O.Temp.attached 1

Strength 30.4.18 11

STRENGTH STATEMENT

As On 31.3.18 240

Struck off Strength 17

Strength 30.4.18 223

OTHER RANKS

Appendix U

HORSE AND MECHANICAL TRANSPORT

VEHICLES

	<u>War Est.</u>
Ambulance Wagons	3
G.S.Wagons	6
G.S.Limbers	8
Water Carts	3
Maltese Carts	1

<u>Evacuations</u>	<u>Deficient</u>
Water Cart 1	Nil

Replacements

Water Cart 1	Destroyed by shell fire.
-----------------	--------------------------

HORSES

Strength as on 31.3.18

R.	L.D.	H.D.
8	17	20

Evacuated sick

H.D. 1

Strength as on 30.4.18

R	L.D.	H.D.
8	17	19

MECHANICAL TRANSPORT

<u>Strength as on 31.3.18</u>	<u>Evacuated</u>	<u>Taken on strength</u>	<u>Strength 30.4.18</u>
Daimler Ambulance Car 5	Nil	Nil	5
Ford Do Do 2	1	1	2
Douglas Cycles 2	Nil	Nil	2

Appendix "U"

Serial No.	Corps	Unit	Regtl. No.	Rank	Name	Date of Admission	Nature of disease or wound	Date of			Discharges	Transfers	
								Death	Discharge	Transfer			
160	17 Bde		6715	Pte	Birchall	29-3-18	Strain ankle						
161	23		6469		Thompson		P.M.O.						
163	23		7323		Schwartz		P.M.O.						
165	Aust Corps	MT Coy	4028	Ser	Moyles		Myalgia back						
166	21 Bde		707	Pte	Dobson	30-3-18	Influenza						
168	21		1888		Barty		Bronchitis						
169	23		396	Hc	Lowen		Abscess Thigh R.						
170	5 Mach Gun Coy		5344	Pte	Harg		St. L Eye						
171	17 Bde		6866		Smith		P.M.O.						
173	17		4474		Marshall		Strain ankle L						
174	23		7378		McLeod		Neurasthenia						
178	6 (Ammun) AFAPA		3346	Ser	White		Gastric enteritis Diarrhoea						
179	20 Bde		6559	Pte	Rawsthorne	31-3-18	Toxilitis						
181	6 Aust Fdment		1842		Avery		P.M.O.						
182	22 Bde		6382		Lake		P.M.O.						
183	13		3878	Hc	Philpatt	1-4-18	Haemorrhoids						
184	22		2155	Cpl	Sparks		Diarrhoea						
185	23		1174	Pte	James		Septic Throat						
186	28		5590		Edwards		P.M.O.						
187	5 Aust FAPA		32941	Ser	Troyman		Haemorrhoids						
188	21 Bde		2487	Sgt	Smith		Abscess knee L						
189	23		4705	Pte	Yorda		Diarrhoea						
190	6 ALTMP		1028	Cpl	Quade		P.M.O.						
191	5 Aust FAPA		11624	Ser	McFadyen		P.M.O.						

D. A. G., Adjutant-General's Office at the Base.

Forwarded. The names of all officers and men (1) who have been admitted on account of wounds in action, or (2) who have died from all causes, were duly telegraphed at once to you as required.

Place In the field.

H. S. Macdonnell Major

Signature.

Date April 1918

* Except Cavalry and Infantry, the unit of the Corps must be entered.

† Specify whether discharged to join his unit or how otherwise disposed of.

† Specify whether discharged to join his unit or how otherwise disposed of.

FIELD SERVICE.

ARMY FORM A. 36.
(For reporting Colonial
Casualties only.)

(To be compiled by the Commander of a Medical Unit and to be forwarded weekly on Sunday to the Adjutant-General's Office at the Base)

Hospital Return for the week ended 2 April 1918 19 . Hospital and Place DRS (6 Aust. 2d Amb.) in the Field

This return is a nominal roll of all patients admitted to or discharged from hospital during the previous week, and is to include civilians and prisoners of War. Officers' names will be entered first and a line ruled after the name of the last officer. A table will be added at the foot of the form, or be attached, showing, by ranks, the total number of patients in each unit, rationed on the Saturday in the week for which the return is rendered. A separate return is not required for each unit.

N.B.—Reports of deaths of officers and men in hospital will, as they occur, be sent to the Adjutant-General's Office at the Base as well as to their Commanding Officer, whether he is at the station or elsewhere. All officers' deaths should also be reported by telegraph to the Adjutant-General at General Headquarters. (See Field Service Regulations, Part II.)

Serial No. (Field Service Admission and Discharge Book)	Corps*		Regtl. No.	Rank	Name	Date of Admission	Nature of disease or wound	Date of			Discharges Remarks as to †	Transfers Whither transferred and remarks
	Corps	Unit						Death	Discharge	Transfer		
	<u>Australian Troops</u>											
1	14	B.C.	1235	Pte	Edge	24-3-18	Gas			2-4-18		57 7th Aust.
2	4	D.T.C.	5840		Hitchcock		Injured knee					
3	58	P.C.	1632		Byrne		Trench fever					
4	12	(Army) A.P.A.R.	2950	Gm	Grigg		N.Y.D. Pyrexia					
7	15	P.C.	3441	Hc	Smith	24-3-18	Septic leg					
8	10	and F.A.R.	28326	Gm	Smith		Post. V. Venaria					
12	4	D.P.C.	1358	Dr	McDonald	24-3-18	N.Y.D. Pyrexia					
18	4	Div. Reg. Coy	2896	Spr	Sullivan	R.M.	Septic knee					
31	11	Aust. F.A.R.	2849	Gm	Shuster		Cut. Wound					
40	46	P.C.	3388	Pte	Terbach		N.Y.D. Pyrexia					
53	15		7334		Preston		Gas					
65	22		6314		Coote	25-3-18	Syphilis					
72	19		6052		Cooper		Rabies					
75	27		448	Hc	Shaw		Laryngitis					
77	23		635	Sgt	Porter		Pho					
90	22		5361	Hc	Hadlow	26-3-18	Impure lact.					
112	24		1524	Pte	Pemrose	T.V. P.G.	Diphtheria					
132	and	Loganloch Pte	2958		McIntosh	H.E.D. 27-3-18	Gastro-enteritis					
141	4	and 71	2696		Herridge	W.D. 28-3-18	Pericarditis leg.					
144	6	A.L.T.D.B.	1838		Lewis	A.L.	Diphtheria					
145	28	P.C.	6976		Blackett	W.D.	Diphtheria					
146	28		2188		Moran	R.G.	Debility					
151	25		3163		Plastow	G. 29-3-18	Trench fever					
153	28		4155		Loughridge	W.D.	Cold					
155	33		6300		Lovigan	R.G.	Diphtheria					
156	21		3098	Hc	Wright		Diphtheria					
157	25		1729	Dr	Porter	2 P.	Leucorrhoea					
159	17	and A.P.C.	9131		Richards	G.P.	Chronic inflammation					

* Except Cavalry and Infantry, the unit of the Corps must be entered.

† Specify whether discharged to join his unit or how otherwise disposed of.

FIELD SERVICE.

Duplicate.

ARMY FORM A. 36.
(For reporting Colonial Casualties only.)

Last return rendered 30/3/18.

(To be compiled by the Commander of a Medical Unit and to be forwarded weekly on Sunday to the Adjutant-General's Office at the Base.)

Hospital Return for the week ended 2 April 1918. 19 . Hospital and Place DRS (6 Aust. 3d Ambce) In the Field.

This return is a nominal roll of all patients admitted to or discharged from hospital during the previous week, and is to include civilians and prisoners of War. Officers' names will be entered first and a line ruled after the name of the last officer. A table will be added at the foot of the form, showing, by ranks, the total number of patients in each unit, rationed on the Saturday in the week for which the return is rendered. A separate return is not required for each unit.

N.B.—Reports of deaths of officers and men in hospital will, as they occur, be sent to the Adjutant-General's Office at the Base as well as to their Commanding Officer, whether he is at the station or elsewhere. All officers' deaths should also be reported by telegraph to the Adjutant-General at General Headquarters. (See Field Service Regulations, Part II.)

Serial No. <small>(Field Service Admission and Discharge Book)</small>	Corps*		Regtl. No.	Rank	Name	Date of Admission	Nature of disease or wound	Date of			Discharges Remarks as to †	Transfers Whither transferred and remarks
	Corps	Unit						Death	Discharge	Transfer		
	American Troops											
	30 Ings	U.S.A.	181247	Plt	Froelich	E. 7	30-3-18	Polio			2-4-18	57 3d Ambce
	2 April 1918.											60 DRS (6 Aust. 3d Ambce)

* Except Cavalry and Infantry, the unit of the Corps must be entered.

† Specify whether discharged to join his unit or how otherwise disposed of.

Serial No.	Corps*		Regtl. No.	Rank	Name	Date of Admission	Nature of disease or wound	Date of			Discharges	Transfers
	Corps	Unit						Death	Discharge	Transfer		
Hospital Return for the week ended 19												
<p>This return is a nominal roll of all patients admitted to or discharged from hospital during the previous week, and is to include civilians and prisoners of War. Officers' names will be entered first and a line ruled after the name of the last officer. A table will be added at the foot of the form, or be attached, showing by ranks the total number of patients in each unit, rationed on the Saturday in the week for which the return is rendered. A separate return is not required for each unit.</p> <p>N.B.—Reports of deaths of officers and men in hospital will, as they occur, be sent to the Adjutant-General's Office at the Base as well as to their Commanding Officer, whether he is at the station or elsewhere. All officers' deaths should also be forwarded in the Adjutant-General's Office at the Base (see Form A. 38, Part II).</p>												
<p>Serial No. _____ Corps _____ Unit _____</p> <p>Name _____ Rank _____</p> <p>Date of Admission _____</p> <p>Nature of disease or wound _____</p> <p>Date of Death _____ Discharge _____ Transfer _____</p> <p>Discharges _____</p> <p>Remarks as to † _____</p> <p>Whether transferred and remarks _____</p>												

D. A. G., Adjutant-General's Office at the Base.

Forwarded. The names of all officers and men (1) who have been admitted on account of wounds in action, or (2) who have died from all causes, were duly telegraphed at once to you as required.

Place _____

H. S. Sturges

Signature.

Date _____

* Except Cavalry and Infantry, the unit of the Corps must be entered.

† Specify whether discharged to join his unit or how otherwise disposed of.

† Specify whether discharged to join his unit or how otherwise disposed of.

* Except Cavalry and Infantry, the unit of the Corps must be entered.

108

FIELD SERVICE.

Date of last Return Rendered 1/4/18

APPENDIX

ARMY FORM A. 36. (For reporting Colonial Casualties only.)

(To be compiled by the Commander of a Medical Unit and to be forwarded weekly on Sunday to the Adjutant-General's Office at the Base.)

Hospital Return for the week ended 2 April 1918. Hospital and Place 6 Austr. Fld Ambul

This return is a nominal roll of all patients admitted to or discharged from hospital during the previous week, and is to include civilians and prisoners of War. Officers' names will be entered first and a line ruled after the name of the last officer. A table will be added at the foot of the form, or be attached, showing, by ranks, the total number of patients in each unit, rationed on the Saturday in the week for which the return is rendered. A separate return is not required for each unit.

N.B.—Reports of deaths of officers and men in hospital will, as they occur, be sent to the Adjutant-General's Office at the Base as well as to their Commanding Officer, whether he is at the station or elsewhere. All officers' deaths should also be reported by telegraph to the Adjutant-General at General Headquarters. (See Field Service Regulations, Part II.)

Serial No. <small>(Field Service Admission and Discharge Book)</small>	Corps*		Regtl. No.	Rank	Name	Date of Admission	Nature of disease or wound	Date of			Discharges Remarks as to †	Transfers Whither transferred and remarks
	Corps	Unit						Death	Discharge	Transfer		
AUSTRALIAN TROOPS.												
	23	Battalion	6814	Pte	Faulkner W.	2-24-18	Wound			2-24-18		2nd Lt
	23		6815		Gregory		H.V.O.					

H. S. ...
L. D. ...

Forwarded. The names of all officers and men (1) who have been admitted on account of wounds in action, or (2) who have died from all causes, were duly telegraphed at once to you as required.

* Except Cavalry and Infantry, the unit of the Corps must be entered.

† Specify whether discharged to join his unit or how otherwise disposed of.

(325) W289(M) 1203 000 917 McA & W Ltd (E. 1917)

Serial No. <small>(Field Service Admission and Discharge Book)</small>	Corps <small>(For reporting Colonies only)</small>		Regtl. No.	Rank	Name	Date of Admission	Nature of disease or wound	Date of			Discharges Remarks as to †	Transfers Whither transferred and remarks
								Death	Discharge	Transfer		
Hospital Return for the week ended												
This return is a nominal roll of all patients admitted to or discharged from hospital during the previous week, and is to include civilians and prisoners of War. Officers' names will be entered first and a line ruled after the name of the last officer. A table will be added at the foot of the form, or be attached, showing by ranks, the total number of patients in each unit, rationed on the Saturday in the week for which the return is rendered. A separate return is not required for each unit.												
N.B.—Reports of deaths of officers and men in hospital will, as they occur, be sent to the Adjutant-General's Office at the Base as well as to their Commanding Officer, whether he is at the station or elsewhere. All officers' deaths should also be reported to the Adjutant-General's Office at the Base.												

D. A. G., Adjutant-General's Office at the Base.
 Forwarded. The names of all officers and men (1) who have been admitted on account of wounds in action, or (2) who have died from all causes, were duly telegraphed at once to you as required.

Place _____
 Date _____

H. S. [Signature]
 Signature.

* Except Cavalry and Infantry, the unit of the Corps must be entered.
 † Specify whether discharged to join his unit or how otherwise disposed of.

FIELD SERVICE.

ARMY FORM A. 36.
(For reporting Colonial Casualties only.)

(To be compiled by the Commander of a Medical Unit and to be forwarded weekly on Sunday to the Adjutant-General's Office at the Base.)

Hospital Return for the week ended 1st April 1918 19 . Hospital and Place DRS (60th Field Ambn) In the Field

This return is a nominal roll of all patients admitted to or discharged from hospital during the previous week, and is to include civilians and prisoners of War. Officers' names will be entered first and a line ruled after the name of the last officer. A table will be added at the foot of the form, or be attached, showing, by ranks, the total number of patients in each unit, rationed on the Saturday in the week for which the return is rendered. A separate return is not required for each unit.

N.B.—Reports of deaths of officers and men in hospital will, as they occur, be sent to the Adjutant-General's Office at the Base as well as to their Commanding Officer, whether he is at the station or elsewhere. All officers' deaths should also be reported by telegraph to the Adjutant-General at General Headquarters. (See Field Service Regulations, Part II.)

Serial No. <small>(Field Service Admission and Discharge Book)</small>	Corps*		Regtl. No.	Rank	Name	Date of Admission	Nature of disease or wound	Date of			Discharges Remarks as to †	Transfers Whither transferred and remarks
	Corps	Unit						Death	Discharge	Transfer		
<u>Australian Troops.</u>												
32	20th	Gen. St. P. R. R.	777	Gen	Kitching	11.9	24-3-18	Influenza		1-4-18		Buty
33	57	1 st Lt.	3198	7 th	Kellum	9/9	✓	typhoid fever		✓		✓
47	16	"	3840	"	Osborne	9	✓	Contracted side		✓		✓
183	13	"	3878	Lt. Col.	Philpott	at	1-4-18	Hæmorrhoids				
4	32	"	3115	Cpl	Sparks	8B	✓	Dysentery				
5	23	"	1171	9 th	James	L. J.	✓	Septic throat				
6	28	"	5390	"	Edwards	67	✓	Flu				
7	5	20th	33941	Sur.	Thompson	ac	✓	Hæmorrhoids				
<u>1st April 1918.</u>												
<u>H. O. DRS (60th Field Ambn)</u>												

* Except Cavalry and Infantry, the unit of the Corps must be entered.

† Specify whether discharged to join his unit or how otherwise disposed of.

Serial No. (Field Service Admission and Discharge Book)	Corps		Regtl. No.	Rank	Name	Date of Admission	Nature of disease or wound	Date of			Discharges Remarks as to †	Transfers Whither transferred and remarks
	Corps	Unit						Death	Discharge	Transfer		
Hospital Return for the week ended												
This return is a nominal roll of all patients admitted to or discharged from hospital during the previous week, and is to include civilians and prisoners of War. Officers' names will be entered first and a line ruled after the name of the last officer. A table will be added at the foot of the form, or be attached, showing, by ranks, the total number of patients in each unit, rationed on the Saturday in the week for which the return is rendered. A separate return is not required for each unit.												
N.B.—Reports of deaths of officers and men in hospital will, as they occur, be sent to the Adjutant-General's Office at the Base as well as to their Commanding Officer, whether he is at the station or elsewhere. All officers' deaths should also be reported by telegraph to the Adjutant-General at General Headquarters.												
(To be completed by the Commanding Officer of the Hospital)												

D. A. G., Adjutant-General's Office at the Base.

Forwarded. The names of all officers and men (1) who have been admitted on account of wounds in action, or (2) who have died from all causes, were duly telegraphed at once to you as required.

Place _____

Date _____

M. S. Smith

Signature.

* Except Cavalry and Infantry, the unit of the Corps must be entered.

† Specify whether discharged to join his unit or how otherwise disposed of.

FIELD SERVICE.

Date of last Return Rendered 2/4/18
Army Form A. 36.

(To be compiled by the Commander of a Medical Unit and to be forwarded weekly on Sunday to the Adjutant-General's Office at the Base.)

Hospital Return for the week ended 5th April 1918. Hospital and Place 6th Aust. Fld. Amb. Base.

This return is a nominal roll of all patients admitted to or discharged from hospital during the previous week, and is to include civilians and prisoners of War. Officers' names will be entered first and a line ruled after the name of the last officer. A table will be added at the foot of the form, or be attached, showing, by ranks, the total number of patients in each unit, rationed on the Saturday in the week for which the return is rendered. A separate return is not required for each unit.

N.B.—Reports of deaths of officers and men in hospital will, as they occur, be sent to the Adjutant-General's Office at the Base as well as to their Commanding Officer, whether he is at the station or elsewhere. All officers' deaths should also be reported by telegraph to the Adjutant-General at General Headquarters. (See Field Service Regulations, Part II.)

Serial No. <small>(Field Service Admission and Discharge Book)</small>	Corps ^o		Regtl. No.	Rank	Name	Date of Admission	Nature of disease or wound	Date of			Discharges Remarks as to †	Transfers Whither transferred and remarks
	Corps	Unit						Death	Discharge	Transfer		
<u>AUSTRALIAN TROOPS.</u>												
	2 nd	Patrol	951	Cpl	Potance	31	5-4-18	D.A.H.			5-4-18	2 nd Stah. C.C.A.
21	✓		2023		Sakin	A	-	Influenza				-
21	✓		5976	Pte	Partlett	J.P.	-	Influenza				-
2	✓	Home	3203		Walker	J.P.	-	Ulceration of cornea				2 nd Stah. C.C.A.
<u>AUSTRALIAN OFFICERS.</u>												
	2 nd	Home		Sgt	Holder	E.M.	5-4-18	Low throat Enlarged & Bronchitis			5-4-18	2 nd Stah. C.C.A.

M. Vincent Welch, Colonel
6th Aust. Fld. Ambulance

Except Cavalry and Infantry, the unit of the Corps must be entered.

† Specify whether discharged to join his unit or how otherwise disposed of.

FIELD SERVICE.

ARMY FORM A. 36.
(For reporting Colonial Casualties only.)

(To be compiled by the Commander of a Medical Unit and to be forwarded weekly on Sunday to the Adjutant-General's Office at the Base.)

Last return rendered 3/2/18.

Hospital Return for the week ended 1st April 1918 19 Hospital and Place 6 Aust Fd Ambce In the Field.

This return is a nominal roll of all patients admitted to or discharged from hospital during the previous week, and is to include civilians and prisoners of War. Officers' names will be entered first and a line ruled after the name of the last officer. A table will be added at the foot of the form, or be attached, showing, by ranks, the total number of patients in each unit, rationed on the Saturday in the week for which the return is rendered. A separate return is not required for each unit.

N.B.—Reports of deaths of officers and men in hospital will, as they occur, be sent to the Adjutant-General's Office at the Base as well as to their Commanding Officer, whether he is at the station or elsewhere. All officers' deaths should also be reported by telegraph to the Adjutant-General at General Headquarters. (See Field Service Regulations, Part II.)

Serial No. <small>(Field Service Admission and Discharge Book)</small>	Corps*		Regtl. No.	Rank	Name	Date of Admission	Nature of disease or wound	Date of			Discharges Remarks as to †	Transfers Whither transferred and remarks
	Corps	Unit						Death	Discharge	Transfer		
	Australian Troops											
	15 Bde.		6596	Pte	Cameron	1-4-18	Gonorrhoea.		1-4-18	London. No. Yes		2 BCCS
	13		3878	Lt Col	Philpott	A.H.	Hæmorrhoids					DRS
	1 st April 1918.											

6.0 6 Aust Fd Ambce

* Except Cavalry and Infantry, the unit of the Corps must be entered.

† Specify whether discharged to join his unit or how otherwise disposed of.

FIELD SERVICE

Serial No. (Field Service Admission and Discharge Book)	Corps		Regtl. No.	Rank	Name	Date of Admission	Nature of disease or wound	Date of			Discharges Remarks as to †	Transfers Whither transferred and remarks
	Corps	Unit						Death	Discharge	Transfer		
Hospital Return for the week ended												
<p>This return is a nominal roll of all patients admitted to or discharged from hospital during the previous week, and is to include civilians and prisoners of War. Officers' names will be entered first and a line ruled after the name of the last officer. A table will be added at the foot of the form, or be attached, showing, by ranks, the total number of patients in each unit, returned on the Saturday in the week for which the return is rendered. A separate return is not required for each unit.</p> <p>N.B.—Reports of deaths of officers and men in hospital will, as they occur, be sent to the Adjutant-General's Office at the Base as well as to their Commanding Officer, whether he is at the station or elsewhere. All officers' deaths should also be reported by telegraph to the Adjutant-General's Office at the Base.</p>												
<p style="text-align: center;">Hospital and Place</p>												
<p style="text-align: center;">D. A. G., Adjutant-General's Office at the Base.</p>												

D. A. G., Adjutant-General's Office at the Base.

Forwarded. The names of all officers and men (1) who have been admitted on account of wounds in action, or (2) who have died from all causes, were duly telegraphed at once to you as required.

Place _____

Date _____

Signature _____

* Except Cavalry and Infantry, the unit of the Corps must be entered. † Specify whether discharged to join his unit or how otherwise disposed of.