

AWM4
**Australian Imperial Force unit war diaries,
1914-18 War**

Formation Headquarters

Item number: 1/50/27 Part 6

Title: General Staff, Headquarters 5th
Australian Division

May 1918



AWM4-1/50/27PART6

W. Scary.

Appendix 13.

157.

SECRET

Copy No. 16.....

PROVISIONAL DEFENCE SCHEME

"B"
"B" DIVISION.

A U S T R A L I A N C O R P S

CONTENTS.

- Section I General Description of front and area.
" II Defensive dispositions.
" III Action in case of attack.
" IV Communications.
" V Special units.
" VI Works Policy and Programme.
" VII Administration.
" VIII Training.

APPENDICES.

- Appendix I. List of units and fighting strength.
" 2. Artillery defence Scheme.
" 3. Defensive organisation of Machine and Lewis Guns.
" 4. Anti-aircraft Machine and Lewis Gun defences in the area.
" 5. Action to be taken by Tunnelling Coys and attached personnel in case of attack.
" 6. Distribution of Gas appliances and Map.
" 7. Accommodation in Forward Zone and Second Zone by map squares.
" 8. Details of Training grounds and area equipment.
" 9. Action in case of withdrawal.
" 10. Action of Tanks in case of Attack.

SECTION I.

GENERAL DESCRIPTION OF FRONT AND AREA.

1. GENERAL.

- (i) The front held by the Division extends from P.20.a.O.O. on the South to J.23.d.4.0 on the North, a trench length of 9900 yards.
- (ii) The area held by the Division is the battlefield on which the German offensive was halted, and the area is in process of being developed.
The area is marked by distinct tactical features and has great defensive qualities in the shape of command and observation.
- (iii) (a) The ridge - between the River AVRE - (with its tributary the River LUCE) - and the River SOMME - which culminates in the VILLERS BRETONNEUX Plateau on which the village stands. From this Plateau spurs run N.E., S and West.
The village of VILLERS BRETONNEUX and the plateau on which it stands, together with the BOIS L'ABBE and BOIS D'AQUENNE, are of the utmost strategical and tactical importance and must be held at all costs. Although not in this Division's sector it exercises an influence over the defence of the sector which must be taken into account.
- (b) The high narrow ridge between the River SOMME and River ANCRE gives excellent observation of the enemy's defences east of VILLERS BRETONNEUX, and artillery emplaced on this ridge can bring enfilade fire to bear on the enemy as far South as the right boundary of the Division.
- (c) The Rivers, SOMME, ANCRE and HALLUE give a line of defence in case of necessity, and with the villages in their valleys form tactical features which must be woven into the scheme of defence.
- (iv) The country is undulating and quite open except for a few isolated woods.
The River valleys and the numerous other valleys and depressions lend themselves to the enemy's gas tactics, and - in the case of the River valleys - he is able to close them to us as channels of communication.
Guns and vehicles are able to move across country quite well under the present conditions. The soil is chalk with a thin top layer of clay and the presence of the chalk renders the concealment of excavations well nigh impossible, thus forcing the use of dummy works.
- (v) The Divisional area is subdivided into three Brigade areas of which "A" and "B" are the forward brigade areas, and "C" the Reserve Brigade area. (See Map No. 1).
"A" Brigade has a frontage of 3780 yards; "B" Brigade a frontage of 5400 yards, including the gap between the flanks of "E" and "F" Battalions.
"A" Brigade has three battalions in the line and one in reserve, and is relieved periodically by the Reserve Brigade which is maintained in the Second or AUBIGNY Zone.
"B" Brigade holds the area with three battalions in the line and one in reserve, working inter-battalion reliefs.
The defensive zone is in the course of preparation, and is organised in three systems of defence:-
- (i) The FIRING LINE SYSTEM:
 - (ii) The SUPPORT SYSTEM.
 - (iii) The RESERVE SYSTEM:

- 2 -

2. The defences of the Forward and Second Zones are shown on Map No. 1. The object aimed at is an organisation in depth of a series of defences holding the firing line, supports, and reserves, of the battalions allotted to it.

In the front of the wiring of the front system are a series of posts the irregular result of recent offensives, chosen for a variety of reasons and of varying defensive ability.

The strength of the garrisons varies at present from 6 men to a platoon. Posts are being adjusted at present on the principles laid down in Section II.

In this Divisional sector our posts are at a varying distance from the enemy's. The Forward Zone in this sector South of the SOMME lies on the eastern face of the spurs running North and East from VILLERS BRETONNEUX. North of the SOMME the line runs in a northerly direction up the face of the southern slope of the ridge. The front line system is under observation and movement by day towards the front line is difficult. Firing line and posts are, generally speaking, on high ground except on the River flats, and the construction of a continuous line is in hand except on the marshy ground on the River flats where posts are being constructed.

SECTION II.

1. PRINCIPLES OF DEFENCE.

- (1) General (a) Ground now in our possession is so organised for defensive that our first defensive position is established as far forward as conditions permit.
- (b) The Front Line system with the Forward Zone is the main line of resistance which will be defended at all costs, and all troops in and in rear thereof will be organised for prompt offensive action for the maintenance of this system and those in rear of it.
- (c) Complete mastery of NO MANS LAND is to be maintained.
- (d) (i) Brigades in the line are responsible for the defence of all three systems of the Forward Zone within the limits of frontage allotted to the brigades. The defence is to be active. Any breach of any portion of the defensive is to be dealt with by counter attack when the first wave of the enemy's attacking force having halted on their first objective have lost their momentum. Owing to the natural disorganisation of the enemy attack formation which will be brought about by the "diehard" detachments specially detailed for the purpose, the time referred to above will be the most favourable for a counter attack.
- (ii) All Commanders will make, and communicate in writing their plans of action in case of eventualities - (to their subordinates and neighbouring commanders). The defence schemes will be kept up to date and handed over regularly on relief.
- (iii) All Headquarters personnel will be armed and trained to meet attacks. Written instructions for the rapid destruction of documents in case of an overwhelming attack by the enemy will be communicated to all those concerned.
- (iv) All unit commanders will have a thorough reconnaissance made of all approaches from the Support and Reserve areas to the Forward area. These routes will be marked to facilitate traffic by night.

(ii) THE FORWARD ZONE.

- (a) General. The principle governing the preparation of the Forward Zone is an organisation of the ground in depth and so provided that within it can be quartered the whole of the troops required for its defence. The Zone is organised irregularly to take full advantage of the ground and of flanking fire but, generally speaking, within it three systems are prepared for defence:- The FIRING LINE SYSTEM, The SUPPORT SYSTEM, and the RESERVE SYSTEM.
- (b) Posts. The advanced post exists for the double purpose of giving us all possible observation over the enemy defences and denying the enemy facilities of closely approaching our line. Small posts of a section or less will only be advanced beyond the Front line of the Forward Zone when a distinct advantage in observation accrues therefrom. Such small posts will not be pushed further forward than 60 to 80 yards. When it is necessary to maintain posts further forward, the strength thereof will not be less than a platoon. It is not intended however that a platoon shall be all in one post; it may be distributed in a series of posts all within close supporting distance of each other. The number of posts of this nature will be reduced to a minimum. Posts will be given all round wire protection and will in addition be covered by a long belt of defensive wire.

-2-

- (c) The firing line system has been chosen in obedience to the principle of the retention of all ground in our possession. It consists of a series of mutually supporting posts which are to be connected by a travel trench capable of being used as a fire trench. Splinter proof accommodation will be provided for the garrison.
- (d) The Support System. The Support System is organised as a series of mutually supporting posts which will be connected by a traffic trench in the manner laid down for the organisation of the Firing Line system. This system will be made capable of holding one fourth of the total garrison of the Forward Zone. In or in rear of this system accommodation will be provided for the support troops.
- (e) The Reserve System. The Reserve System will be organised similarly to the Support System.

- (f) Garrison of Lines in rear of the Firing Line System. In all defences in rear of the main line of resistance the principle will be followed of detailing to the defences immediately in their front the nucleus garrison of all support and reserve troops. The strength of the nucleus garrisons for the various systems, including those for the bridge head defence systems will be determined by the Brigade Commander concerned. It will be dictated by the duties with which they are charged, viz:-

- (i) To provide guides to indicate to the re-inforcing troops the line from which they will "Jump off" for the immediate or deliberate counter attack.
- (ii) To stop and re-organise troops who may be forced back temporarily.
- (iii) In case of an overwhelming attack to form a rear guard until troops can get into position on the new line.
- (iv) To hold up the enemy until re-inforcing troops or troops ordered back to a new line can cross the bridges.

From the above it will be seen that it is essential that nucleus garrisons should

- (i) Not be changed more than necessary.
 - (ii) Consist of specially selected officers, N.C.Os and men.
 - (iii) Have definite written orders as to their action.
 - (iv) NOT join in any attack or counter attack launched from their position. This will be carefully explained to the personnel of nucleus garrisons.
 - (v) In consequence of (iv) all personnel of nucleus garrisons will be marked with a white arm band to prevent them being ordered forward by Officers or N.C.O's of the attacking or counter attacking troops.
- In fairness to the personnel of the nucleus garrisons all ranks will be warned that nucleus garrisons have been ordered not to go forward.

- (g) Wire in front of Forward Zone defences. Defensive wire will be maintained in front of the firing line. All re-entrants, low lying ground, and caps in the defences will be concealed. Tactical wire will be maintained in front of defences on the Support and Reserve 3)

(iii) THE SECOND ZONE.

By reason of its position in this Divisional sector the Second Zone forms a system behind which Divisional reserves are sheltered. In the event of the enemy breaking through the Forward Zone the defences of the Second Zone will be held by the reserve troops of the Division quartered in rear of the Firing Line System of the Zone.

2. Total Troops available. The troops available for the defence of the sector are:-

1 Division with Divisional Artillery, including anti-tank guns.

4 F.A. Brigades.

Appendix I shows a complete list of the units giving strength.

3. Allotment of troops. The sector is divided into two brigade areas to each of which one infantry brigade is detailed. One Infantry Brigade is detailed as Divisional reserve. Dispositions are shown on Map No.1.
4. Defensive Organisation of Artillery. The defensive organisation of the Artillery is set out in Appendix 2.
5. Defensive Organisation of Machine Guns and Lewis Guns. Defensive organisation of Machine Guns and Lewis Guns is set out in Appendix 3.
6. Anti-aircraft Defences in the Area. Details of the disposition of Machine Guns and Lewis Guns for anti-aircraft protection is set out in Appendix 4.

SECTION IIIACTION IN CASE OF ATTACK.
-----1. PROBABLE FORMS OF ATTACK.

Three forms of attack must be anticipated:-

- (i) A minor attack in the form of a raid to secure identification or seize a locality.
- (ii) A general attack which may be
 - (a) A deliberate prepared attack with artillery bombardment.
 - (b) An attack without preparatory bombardment.Information as to the methods employed by the enemy in his attacks has already been issued separately.

2. MINOR OPERATION.

(i) In order to deal with a minor attack the following arrangements are in hand:-

- (a) Each artillery group has a forward O.P. which is in direct telephone communication with group headquarters.
- (b) If the S.O.S. is sent up the artillery opens on the usual S.O.S. barrage lines.
- (c) In order to bring concentrated artillery fire to bear on the enemy raiders as soon as the locality on which the raid is being made can be determined, a special light signal is sent up from the company attacked. This signal is issued to and sent up by officers of the front line companies only. If the special light signal is sent up, the artillery barrage is concentrated on the battalion front from which the signal appears. The C.R.A. will arrange for liaison barrages of the flanking artillery to cover the outer flanks of the Division.
- (d) The special signal to be employed is notified from time to time.

(ii) The extent and intensity of the enemy's bombardment and especially the gas shell bombardment should be an indication of his objective and in the event of any failure of the special preparations, careful observation of the hostile artillery fire may permit of bringing artillery fire to bear on the enemy's lines opposite the point raided. Should the enemy succeed in establishing himself in our lines he is to be counter-attacked immediately from both flanks and from the support trenches where such are in sufficiently close proximity. The counter-attack is to be launched by the order of the commander on the spot - the company commander, platoon commander, section commander, or the oldest soldier of the party.

It is essential that the counter attack be delivered without delay to prevent the enemy consolidating.

(iii) In any case, until the locality is retaken it must be isolated and firmly held in a pocket until its recapture, and to ensure this the flank of the "break through" will be reinforced. The artillery and machine guns will prevent German reinforcements coming up to support, and the infantry must endeavour to locate and report the exact position held by the enemy so that our artillery and trench mortars may bombard the captured locality with precision. Artillery fire will not be opened on the lost locality without the sanction of the infantry commander concerned.

3. A general attack may assume two forms:-

- (i) One in which we are well informed of the enemy's intentions by means of preliminary preparations. This attack will be preceded probably by an intense bombardment with H.E. and gas shells. The exact moment of such an attack cannot be foreseen with certainty. The Defence Schemes of Brigades and Battalions lay down the role of all troops allotted to the defence of the forward zone in the event of a general attack. No ground is to be given up under any circumstances.

The most forward portion of the defences must break up the enemy's attack. In the event of his breaking through the outpost system, the direct fire machine guns and trench mortars which are distributed in depth must break up his attack. If the enemy commences a general gas shell bombardment, all troops stand to and special officer observers are detailed. All headquarters will be warned. The officer on duty at all headquarters is responsible for questioning forward and flank headquarters with regard to any artillery activity that they may hear or observe.

- (ii) The second form of a general attack may be an attempt at surprise. A surprise attack is possible but is unlikely to be successful if the enemy is kept under careful and continuous observation and all signs of movement and unusual activity *or silence* on his part are reported. Special vigilance will be observed in foggy weather. The enemy will probably use tanks. Measures for combating these are shown in Appendix 10.

Brigades in the Line

G.O.C. Brigades in the Line are responsible that the forward zone of the defence is maintained intact. As soon as it is ascertained that a hostile attack in force is being made, they will ensure that the units under their command take action in accordance with the defence scheme. Detailed schemes are drawn ^{up} by each Brigade and each Battalion and these are to contain clear and concise instructions as to:

- (a) Role of all units in a general attack.
- (b) Distribution of troops to defences.
- (c) Places of assembly.
- (d) Roads from living places to places of assembly.
- (e) Position for deployment in addition to places of assembly if required.
- (f) Arrangements for counter attack.

4. DIVISIONAL RESERVE.

- (i) The Reserve Brigade is disposed as follows: -

Brigade Headquarters	TRONVILLE CHATEAU N.21.a.9.3
"I" Battalion	O.13.d.4.4
"J" Battalion	O.1.c.1.0
"K" Battalion	O.13.a.3.9
"L" Battalion	O.7.c.3.5
L.T.M.B.	O.24.b.6.5.
- (ii) The method of employment of the Reserve Brigade cannot be completely foreseen.
- (iii) The battalion parade grounds will be the positions of assembly and battalions will be ready to move therefrom at 20 minutes notice.
- (iv) Separate roads, tracks, and positions of readiness for each unit will be prepared and marked for night marching and assembly.

5. ACTION OF WORKING PARTIES.

- (i) Working parties east of the CACHY - FOUILLOY - CORBIE - BONNAY Road will always carry their arms with them.
- (ii) Officers and H.C.O's in charge of working parties east of the above mentioned road will always have written instructions as to what to do in case of attack. Working parties found by the infantry brigade in the line or from troops attached to these brigades will act as ordered by the G.O.C. the infantry brigade in the line.
- (iii) Parties of the reserve brigade working forward of the Reserve line system of the Forward Zone, in the event of a general attack will occupy positions in the reserve line system of the Forward Zone. The Commander will report at once to the nearest headquarters, and will send a signal message to his own brigade headquarters reporting his position.

Not more than a Battalion is to be employed forward of the CACHY - FOUILLOY Road at night.

- (iv) Troops will be instructed that, as a general principle in default of orders, report to and act under the orders of the nearest company, battalion or brigade commander in order to repel any sudden attack.
- (v) Parties working rear of the reserve line system of the Forward Zone will withdraw at once to their battalion position of readiness.

6. ACTION OF ENGINEERS AND PIONEERS.

(i) The action to be taken by the Tunnelling Company and attached personnel is given in Appendix No. 5.

(ii) Action of Pioneers.

(a) In order that the full strength of the Pioneer Battalion may be utilised to the best advantage the action as detailed below will be taken in the event of a hostile attack or general alarm. (M. Bn)

Serial No.	Detail.	Action to be taken.	To report location and strength to:
1.	Pioneer Bn.	Assemble and stand to arms.	Div. H.Q. when Bn. is ready to move.

(iii) Action of Engineers.

less 2 sections each,
Field Companies will be normally in the Divisional Reserve. Engineers working in rear of the Forward Zone will withdraw to their company parade ground, and arrange for their own protection. Orders for their subsequent movements will be issued by the C.R.E.

7. ACTION IN CASE OF GAS ATTACK.

- (i) The Standing orders for Defence against Gas (S.S. 193) will obtain.
- (ii) In the event of a hostile gas cloud attack on the divisional front the message to be sent will be "GAS" followed by the locality, i.e. VILLERS-BRETONNEUX, BOIS de VAIRE, HAMEL and SAILLY-LE-SEC.
- (iii) Gas rattles are only to be used in the case of a gas shell bombardment, as distinct from a gas cloud attack.
- (iv) The distribution of gas appliances is shown in Appendix 6.

8. ACTION IN CASE OF WITHDRAWAL.

The action to be taken in case of a forced withdrawal is detailed in Appendix 9, *which will be issued when necessary.*

Detached parties will occupy the nearest defences.

SECTION IV.

COMMUNICATIONS.

1. Signal communication in 5th Divisional Area is as under :-
Communication to two Brigades in line is maintained along poled cable to the River SOMME, thence by cable along the bed of the river to the Right Brigade (O.5.e.8.6.) and Advanced Division Exchange at FOUILLOY (O.10.a.6.4). From FOUILLOY cables are run overland to Left Brigade Headquarters (I.35.e.4.3). Forward of Brigades, Units are connected by ground lines and cable laid in the river.
2. Telegraph.
From Divisional Headquarters telegraph by sounder is used back to Australian Corps, laterally to 3rd Australian Division on left, and 4th Australian Division on right, also forward to 8th, 14th and 15th Australian Infantry Brigades.
3. Telephone.
Telephone communication is established to Australian Corps, Right and Left Divisions, Corps Heavy and Divisional Artillery, 8th, 14th and 15th Australian Infantry Brigades, 13th and 14th A.F.A. Brigades, Advanced Division Exchange at FOUILLOY (O.10.a.6.4) and Machine Gun Battalion.
From Brigades, telephone communication is established to all Battalions and Batteries, Machine Gun Companies are also connected to their Battalion.
4. Visual.
From Advanced Division Station at FOUILLOY (O.10.a.6.4) visual signalling is arranged to Battalions and Machine Gun Companies in line and these stations are also in touch by visual with each other.
5. Wireless.
Wireless stations are established at Divisional Headquarters and also at Headquarters of two Brigades in line - O.5.e.8.6. and I.35.e.4.3. These stations are in touch with each other also with Australian Corps, Left and Right flank Divisions, and the Brigades of the flank Divisions. Left Brigade is also in touch with its centre Battalion by wireless.
6. Power Buzzer and Amplifier.
Power Buzzer and Amplifier station is situated at Right Brigade Headquarters, and this works forward to a similar station at Battalion Headquarters O.12.b.2.3.
7. Despatches.
Despatches are delivered and collected by Motor Cyclist from Divisional Headquarters, Right and Left Brigade Headquarters in line, Advanced Division Station, FOUILLOY, and Artillery Brigade, thence they are distributed by runner to Battalions, Batteries and surrounding units.
8. Dropping Ground for Messages.
Dropping Ground for aeroplane messages is situated at H.34.b.2.2.
9. Diagram.
Explanatory line diagram is attached marked Map. No. 3.

SECTION VI.

WORKS POLICY.1. RESPONSIBILITY.

The Division is responsible for the organisation, preparation and maintenance of

- (i) The Forward Zone.
 - (a) Outpost System.
 - (b) Support System.
 - (c) Reserve System.

Brigades in the line are responsible for the preparation and maintenance of the

- (a) Outpost System.
- (b) Support System.

Alterations affecting the organisation of any part of the Forward Zone are to be submitted for approval to Divisional Headquarters.

(ii) Instructions are issued from time to time as to the responsibility and allotment of troops for the preparation of the Reserve System of the Forward Zone.

(iii) Work on all Systems is to proceed simultaneously.

(iv) C.R.E. is responsible for the distribution of Engineers and for the technical supervision of all field works. He will arrange for a complete system of liaison with Brigades and Battalions in the line.

(v) Commanding Officers of Infantry units are responsible for detailing working parties for their allotment to tasks in co-operation with the engineer liaison officer, and for their arrival with necessary tools at the time and place appointed.

Tactical working units will be detailed, not tactical working parties, unless the strength is less than 20.

Commanding Officers of Infantry units are responsible for the maintenance of communication trenches and duck walks in their area. They will consult the engineer officer working with them as to work on these.

2. PRINCIPLES OF WORK.

(i) Work will be allotted as task work whenever possible. Troops are marched home at once on completion of the allotted task to the satisfaction of the supervising engineer officer.

(ii) Parties will be allotted permanently to each task until the task is completed. If this party is relieved for a special reason e.g. on taking over garrison duty in the front line, its relief will remain permanently until the task is completed.

(iii) When working parties are relieved by incoming units, representatives of the incoming units will arrive one day before taking over and will be present at each task which is being carried out by the working unit.

3. ENGINEER DISTRIBUTION.

14th Field Company. Headquarters at I.33.d.7.3. Transport at O.1.c.0.5 Allotted to Right Brigade area at present held by 14th Australian Infantry Brigade. Responsible for work from AUBIGNY Line (exclusive) to RESERVE Line (inclusive) of Forward Zone.

15th Field Company. Headquarters at I.34.c.2.8. Transport at H.36.a.3.5. (One Section living forward at J.28.a.6.8 and J.26.d.5.9 for work north of River); allotted to Left Brigade Area at present held by 8th Australian Infantry Brigade. Responsible for work from AUBIGNY Line (exclusive) forward to Reserve Line (inclusive) of Forward Zone.

- 2 -

8th Field Company. Headquarters at O.1.a.3.5. Transport at N.12-b.3.7. Responsible (as Reserve Field Co.) for works from AUBIGNY Line (inclusive) towards rear; also includes bridgehead defences on right bank of SOMME, for bridges west of Railway Bridge at N.12.d.4.3, and bridgehead defences on both banks of SOMME for bridges east of this inclusive. Also responsible for other general works not in the two forward Brigade areas.

4. PIONEER DISTRIBUTION.

Headquarters in BUSSY -LES- DAOURS, H.35.c.7.3. Unit bivouacked in splinter proof dugouts along bank 500 yards east of BUSSY. Responsible for work under C.R.E. Have been chiefly employed so far on

- (1) Bridge approach roads.
- (2) Support Line of AUBIGNY Zone and its communication to front line of same.
- (3) Bridgehead defences.
- (4) Entrenchment of Divisional Right Flank, facing VILLERS BRETONNEUX.

5. SYSTEM OF SUPPLY OF R.E. STORES: LOCATION OF DUMPS ETC.

R.E. Stores are conveyed from Corps R.E. dumps at QUERRIEU and POULANVILLE by motor lorries to 5th Australian Division R.E. Dump at AUBIGNY O.9.a.7.4.

These stores are then conveyed by horse transport to Field Company dumps at O.6.d.7.9 and O.10.d.6.8 and thence to the line.

A proportion of R.E. stores is delivered direct by motor lorries from Corps Dumps to Field Company Dump at I.34.c.2.8 for use on Defences north of the SOMME.

6. DIVISIONAL WORKSHOPS. Nil

7. WORKS IN HAND SHEWN IN ORDER OF URGENCY

(1) Right Flank Defences. from O.20.b.7.3 to approx. O.18.d.5.2 to be dug as a line of Pivot S.P's. firing south, and ultimately to be made a connected line by putting in intermediate S.P's. and Communication trenches.

(2) Reserve Line of AUBIGNY ZONE. This has been sited, and is to be constructed on the same principle as (1) except the direction of fire.

(3) Bridgehead Defences.

(4) Completion of works on Reserve Line of Forward Zone with its switch to the rear of HAMELET. This line is strongly established and is therefore not placed higher up on the list.

(5) Linking up our Zones to works in the area north of the SOMME which was taken over from 3rd Australian Division.

(6) Digging of a Communication Trench (and fire trench combined) from J.28.a. through J.27.b.5.2. thence west following approximately the contours and connecting existing posts.

General. Assistance to front line Battalions (with wiring and connecting up).
Dugouts; Brigade, Battalion, O.Fs., Artillery.
Bridges, maintenance of.

8. PROPOSED WORKS.

1. Preparation of whole of AMIENS - ALBERT Railway line in the Divisional Sector for defence.

NOTE: The defences will be arranged in such a way that the working of the railway is not interfered with.

2. Completion of rear lines of defence north of the SOMME, and improvement of existing works.

3. Provision of deep dugout accommodation for Reserve troops when material becomes available. (Brigade and Battalion Headquarters are already catered for.)

4. Forward communication from Reserve Line to Forward Posts.

5. Repair of roads, as this becomes necessary, and material available.

At present roads in this area are remarkably good.

233

169

Appendix 12.

Appendix 13

3
(4)

- 5. Provision of deep dugout accommodation for Reserve Troops when material becomes available. (Brigade and Battalion Headquarters are already catered for).
- 6. Forward communication from Reserve Line to Forward Posts.
- 7. Repair of Roads, as this becomes necessary, and material available. At present roads in this area are remarkably good.

SECTION VII.

"B" - ADMINISTRATION.

1. ORGANISATION OF AREA:

The Divisional and Brigade Areas are shown on Map No.1.

Town Majors have been appointed as under : -

CORBIE	Capt. TRATMAN,	32nd Battalion.
BUSSY-les-DAOURS	Lieut. HARRISON,	17th Battalion.
AUBIGNY	Capt. MORISSET,	31st Battalion.

2. ACCOMMODATION:

The accommodation in the area is set out in Appendix "A".
In addition, accommodation in temporary shelters is available as under : -

	<u>Accommodation.</u>
H.35.a.	1,022 Officers and Other Ranks
N.12.d., N.18.b. & d.	2 Battalions.
N.17.d.6.4.	1 T.M. Battery.

3. Headquarters and Echelons are located as set out in Appendix "B".

4. SUPPLIES:

The Railhead for the Division is at AILLY-sur-SOMME.
Refilling Points are as under : -

8th. Inf. Brigade	PONT NOVELLES.
14th Inf. Brigade	DAOURS.
15th Inf. Brigade	DAOURS.
Divisional Troops	PONT NOVELLES.

Supplies are drawn from Railhead by Motor Transport and taken to Refilling Points, thence by second line transport to Quartermasters' Stores, where rations are cut up. From the Quartermasters' Stores rations are taken forward and distributed as under : -
8th Inf. Brigade.

Supplies arrive at Brigade Transport Lines in supply wagons at 8 a.m. They are then cut up at the Quartermaster's Store, established at Brigade Transport Lines, and taken forward on limbers to Battalion Headquarters, leaving the Transport Lines at 8 p.m. 30th Battalion (holding the Right Sector) cook at the Transport Lines and send their rations forward in hot boxes. The 32nd Battalion (in Support) do likewise. G (Left) and (Centre) Battalions (in the line) have established cookhouses in the forward area and send all their hot food on to the front line from these points in hot boxes.

14th Inf. Brigade.

Units draw by second line transport at 9 a.m. daily, and the rations are then taken to Regimental Quartermasters' Stores. Dry rations are split up and bagged for the respective Companies, under the supervision of the Company Quartermaster Sergeants. The remainder of the rations are cooked on travelling kitchens at Quartermasters' Stores. The rations are transported to the line as follows : -

<u>Right Line Battalion.</u> "A" Bn	
Two front Line and Support Companies	- By limber to P.13.a.6.2.
Reserve Company	- By limber to O.24.a.8.7.

Support Company supplies carrying party for two front line Companies as well as its own Company as far as forward Company Headquarters, where the rations are collected by the respective Platoons. Reserve Company supplies its own carrying party.

Left Line Battalion. B Bn

By limber to each Company Headquarters, from whence they are collected under Platoon arrangement.

Both line Battalions are served with two hot meals daily, the food being taken forward in improvised hot food containers and hot boxes. In addition, Tommy Cookers are issued for use in front line Companies and are used to heat the mid-day meal and make tea.

Right Reserve Battalion. C Bn

By limber to Battalion Headquarters, O.17.c.2.2., and man-handled from there to the respective Companies. Hot rations are cooked at Quartermaster's Store and delivered three times daily, the limber itself being converted into a hot box by means of straw, etc.

Left Reserve Battalion. D Bn

By limber to each Company Headquarters, and issued from there, three hot meals being supplied daily. The same method of transport is employed as with the Right Reserve Battalion.

14th L.T.M. Battery.

By limber to their Headquarters, O.17.c.3.5., from whence distribution is made.

15th Inf. Brigade.

Supplies are drawn by second line transport and conveyed to Quartermasters' Stores, which are located at Transport Lines. Rations are taken forward by first line transport to Battalion Cookers located as under :-

I Bn 57th Battalion	-	N.18.d.2.5.
J Bn 58th Battalion	-	MILL, DAOURS O.1.c.2.5.
K Bn 59th Battalion	-	O.13.a.1.3.
L Bn 60th Battalion	-	O.13.a.1.6.

5. AMMUNITION:

Ammunition Railhead is at FLESSELLES. The S.A.A. Section of the D.A.C. is located at 62D - M.3.c.3.9.

The system of supply is as follows :-

Brigades forward information to Divisional Headquarters by mid-day daily of the number of rounds of S.A.A., grenades, etc., expended, and the numbers required to keep echelons full. The S.A.A. Section is then instructed to forward necessary amounts to transport lines of Brigades, and it is then conveyed to Battalions.

Dumps are established as under :-

8TH. INF. BRIGADE.

Brigade Dumps.

P.1.a.40.65.	I.36.a.40.45.
J.33.a.40.70.	J.20.d.20.20.

Battalion Dumps.

Right Battalion Rear Dump	O.6.d.9.6.
" " Forward "	P.2.c.6.7.
Centre Battalion	J.25.d.7.4.
Left Battalion	J.28.a.7.6.
Battalion in Support	J.19.c.4.3.

14TH. INF. BRIGADE.

Brigade Dump.

Battalion Dumps.

Right Battalion	{ O.24.a.4.6.
	{ P.13.a.6.2.
Left Battalion	{ O.12.b.9.4.

15 a 49
O.8.d.3.5.

Battalion Dumps are replenished from Mobile Reserve, which is immediately completed from Brigade Dump. Brigade Dump is supplied by S.A.A. Section of D.A.C.

In the Reserve Brigade there is no Dump, but 20,000 rounds are held at each Battalion Headquarters in addition to Mobile Echelons.

6. SUPPORTING POINT AND GENERAL RESERVE RATIONS:

8TH. INF. BRIGADE.

Supporting Point Rations (Iron Rations).

1,000 Iron Rations at P.1.a.5.5.

1,000 Iron Rations at I.36.a.5.8.

In addition, each Battalion has a reserve of 100 petrol tins of water at the Battalion Headquarters.

14TH. INF. BRIGADE.

Supporting Point Rations (Iron Rations).

1,000 at G.12.c.70.15. (Left Battalion Headquarters)

1,000 at O.17.c.2.5. (Right Battalion Headquarters).

These rations are in a dry place, and under guard.

15TH. INF. BRIGADE.

Supporting Point Rations (Iron Rations).

2,000 at N.18.d.5.4.

GENERAL RESERVES.

1,000 Iron Rations with S.O., DACURS.

7. MEDICAL ARRANGEMENTS:

The system of evacuation is as set out in Appendix "C".

8. WATER:

8TH. INF. BRIGADE.

Ample water can be drawn from pumps and wells in HAMELET, VAIRE and SAILLY-le-SEC. In this sector the Battalion in reserve draws water from the well at Battalion Headquarters, J.19.c.7.2., and in addition water is carried forward in petrol tins for two Companies from Transport Lines.

14TH. INF. BRIGADE.

Water is obtained from wells in DAOURS and BUSSY (in the vicinity of Transport Lines), and is sent forward with rations nightly in petrol tins for forward Companies. Rear Companies are supplied from water-cart, each Battalion sending up a water-cart, which remains for 24 hours in a position close to Battalion Headquarters. Reserve supplies of water are kept at Battalion Headquarters.

15TH. INF. BRIGADE.

Water is drawn from the Refilling Point at N.6.e.9.6.

9. ORDNANCE:

D.A.D.O.S. is situated at 62D - G.20.central,
AMIENS-RAINNEVILLE Road.

10. VETERINARY:

The Mobile Veterinary Section is established at
62D - G.24.d.5.9,
Veterinary Collecting Station is at BUSSY-les-DAOURS,
62D - H.34.d.7.6.

Battalion Groups are repositioned from Mobile Reserves which is immediately completed from Brigade Dump. Brigade Dump is supplied by S.A.A. Section of D.A.C.

In the Reserve Brigades there is no Dump, but 20,000 rounds are held at each Battalion Headquarters in addition to Mobile Reserves.

SUPPORTING TROOP AND GENERAL RESERVE BATTALIONS

1ST INF. BRIGADE

Supporting Troop BATTALIONS (from Reserves)

1,000 from Reserves at 7.1.4.3.8.
1,000 from Reserves at 1.3.4.3.8.

In addition, each Battalion has a reserve of 100 rounds of water at the Battalion Headquarters.

2ND INF. BRIGADE

Supporting Troop BATTALIONS (from Reserves)

1,000 from Reserves at 1.3.4.3.8. (Left Battalion Headquarters)
1,000 from Reserves at 1.3.4.3.8. (Right Battalion Headquarters)

These Reserves are in 400 pieces, and under guard.

The following additional waterpoints are now in operation :

BUSSY, near Chateau. Standpipe for Carts and dixie filler.

COISY, A.26.b.9.3. (Sheet 62D). Two standpipes for carts, dixie filler and 72 feet of horse trough.

GLISY, near Chateau. Standpipe for carts and dixie filler.

PONT NOYELLES, H.12.a.7.5. (Sheet 62D). Two standpipes for carts, dixie filler and 72 feet of horse trough.

LA HOUSSEY, G.2.d.8.5. (Sheet 62D). Two standpipes for carts, dixie filler - 72 feet of double sided trough.

Water is obtained from wells in various parts of the vicinity of (Chateau) and is sent forward with Reserves (from forward Companies). Reserves are supplied from water-carts, each Battalion sending up a water-cart which remains for 24 hours in a position close to Battalion Headquarters. Reserve supplies of water are kept at Battalion Headquarters.

3RD INF. BRIGADE

Water is drawn from the Kelling Point at H.4.4.3.8.

4TH INF. BRIGADE

D.A.C.O.S. is situated at 62D - 6.30.4.3.8. AMNES-RAINVILLE Road.

VETERINARY

The Mobile Veterinary Section is established at 62D - 0.24.4.3.8. Veterinary Collection Station is at BUSSY-JAC-DAOURS, 62D - H.34.4.3.8.

11. SALVAGE:8TH. INF. BRIGADE.

Each Battalion has its own Salvage Dump at Battalion Headquarters, and it is taken from there to Quartermasters' Stores, then sorted out and sent to Salvage Dump at FONT NOVELLES.

14TH. INF. BRIGADE.

Salvage is collected in the forward area under Battalion arrangements, and is returned by ration limbers to Brigade Refilling Point at DAOURS, where a Salvage Dump is established. A further Salvage Dump under Brigade arrangements has been established at AUBIGNY, O.S.b.3.5., where shell cases, R.E. material, etc., are dumped.

15TH. INF. BRIGADE.

All salvage is returned to Brigade Salvage Dump, DAOURS.

12. Y.M.C.A., COMFORTS FUND, SOUP KITCHENS:

The Y.M.C.A. is established at DAOURS. Comforts are issued by the Y.M.C.A. representative to Quartermasters, who send them up with rations. The Y.M.C.A. also has a Depot at N.18.a.9.6., and free distributions are made to the troops.

The Australian Comforts Fund representative is at Divisional Train Headquarters.

13. BATHS:

Baths under Divisional arrangements are established in CORBIE (capacity, 75 per hour), and at the Mill in DAOURS (capacity, 140 per hour). A bathing place has also been established under Battalion arrangements at VAIRE.

14. R.E. STORES:

The Divisional Dump is at Sheet 62D.	O.9.a.7.4.
14th Field Company Dump	- " O.10.d.6.8.
15th Field Company Dump	- " O.1.a.3.5.
8th. Field Company Dump	- " I.34.c.5.7.

15. REINFORCEMENTS:

Reinforcement Railhead	-	PERNOIS
Corps Reinforcement Camps	-	PERNOIS
Divisional Wing	-	PERNOIS
Staging Depot		FLESSELLES - AMIENS R.F.

E. of VAUX-en AMIENS 62E. - F.81.d.8.0.

Reinforcements when moving forward to their Units stage the first night at Staging Depot. Kits and packs are sent forward by lorry from PERNOIS to Staging Depot, and from Staging Depot to BUSSY les DAOURS by G.S. wagons, under arrangements made by G.C. Staging Camp. Kits and packs are dumped at BUSSY-les-DAOURS till arrival of personnel. On arrival at BUSSY-les-DAOURS the men are fed and given hot tea before proceeding to Units. Billet 72, Lowland Street, BUSSY-les-DAOURS, is reserved as local Staging Camp - accommodation, 200.

16. TRAFFIC CONTROL:

Traffic Control Posts are situated at : -

N.6.a.central	O.8.b.5.6.
N.6.b.5.4.	I.27.c.4.2.
N.6.c.9.3.	H.35.c.7.3. (BUSSY-les-DAOURS)
N.6.c.7.2.	N.5.d.8.0. (DAOURS).
N.34.d.6.9.	

Divisional Prisoners of War Collecting Station is at O.3.c.1.1.

Battle Straggler Collecting Station is at O.3.c.1.1. Proposed Posts in the event of a Second Line being

taken over : -

Battle Straggler Posts will be at - .. .

I.33.b.3.3.

O.1.c.2.3.

N.24.a.0.0.

Straggler Posts are situated now at -

I.33.b.3.3.

O.5.c.5.8.

In the event of active operations, Battle Straggler Posts will be at : -

I.33.b.3.3.

O.10.d.6.8.

O.5.c.5.8.

O.9.a.7.4.

O.11.a.6.1.

O.8.b.5.7.

Traffic Regulations.

Headlights will not be used on cars or lorries in the Divisional Area East of the DOULLENS - AMIENS Road. Motor cycles may use headlights, but will cover them when halted. Cars and lorries when halted will cover or extinguish sidelights, except sufficient to mark convoys.

17. TRANSPORT:

"D".

Transport and Wagon Lines are as set out in Appendix

133

APPENDIX "A".

BILLETING ACCOMMODATION IN 'A' DIVISIONAL AREA.
B

Place	Total Accommodation.	
	Officers	Other Ranks
AUBIGNY	70	1,800
FOUILLOY	80	2,600
CORBIE	Two Brigade Headquarters	
HAMELET	50	1,450
HAMELET (In cellars)	20	280
LA NEUVILLE	50	1,450
DAOURS - VECQUEMONT	105	3,000
BUSSY-les-DAOURS	90	2,000

All accommodation shown above is in billets. In addition there is accommodation in dug-outs as shown in para.2, Section VII.

APPENDIX "B"LOCATIONS OF ECHELONS, HEADQUARTERS, ETC.

Divisional Headquarters,		
'G' Branch	H.35.a.0.2.	BUSSY-les-DAOURS
'A' & 'Q' Branch	H.35.c.3.7.	BUSSY-les-DAOURS
O.R.A.	H.35.c.3.7.	BUSSY-les-DAOURS
C.R.E.	H.35.c.5.7.	BUSSY-les-DAOURS
A.D.M.S.	H.35.c.3.7.	BUSSY-les-DAOURS
D.A.D.V.S.		BUSSY-les-DAOURS
Claims Officer		BUSSY-les-DAOURS
Divisional Paymaster		BUSSY-les-DAOURS
D.A.D.O.S.	G.20.central.	DAOURS
Salvage Company		VECQUEMONT
A.P.M.		BUSSY-les-DAOURS
French Mission		
5th. Aust. Mob. Vet. Section	G.24.d.8.4.	
Advanced M.V.S. Post		BUSSY-les-DAOURS
5th. D.A.C. S.A.A. Section	M.3.c.8.9.	

HEADQUARTERS.

Artillery	13th A.F.A. Bde.	I.27.b.0.6.
	14th A.F.A. Bde.	I.23.d.6.2.
	5th. D.A.C.	N.5.a.7.7.
	D.T.M.O.	LA NEUVILLE
Infantry	8th. Aust. Inf. Brigade	I.35.c.4.8. I 33 central
	14th Aust. Inf. Brigade	O.5.c.8.6.
	15th Aust. Inf. Brigade	N.21.a.9.3.
Machine Gun Bn.	5th. Aust. M.G. Battalion	H.35.c.35.50.
Pioneers	5th. Aust. Pioneer Battalion	BUSSY-les-DAOURS
Engineers	8th. Field Company A.E.	I.34.c.5.7.
	14th Field Company A.E.	I.33.d.7.3.
	15th Field Company A.E.	O.1.a.3.5.
A.A.M.C.	8th. Field Ambulance	AUBIGNY
	14th Field Ambulance	DAOURS
	15th Field Ambulance	LES AIENCONS
	Sanitary Section	N.6.c.9.4.
A.A.S.C.	H.Q. Divisional Train	BUSSY-les-DAOURS
	10th Company A.A.S.C.	ALLONVILLE
	18th Company A.A.S.C.	BUSSY-les-DAOURS
	28th Company A.A.S.C.	BUSSY-les-DAOURS
	29th Company A.A.S.C.	PONT NOYELLES

APPENDIX "C".

MEDICAL ARRANGEMENTS IN 5th AUSTRALIAN DIVISIONAL SECTOR.

1. DIVISIONAL UNITS.

8th Australian Field Ambulance :

Headquarters at WOOLLEN MILLS, DAOURS.

Advanced Dressing Station; AUBIGNY.

Advanced Dressing Station, LA NEUVILLE, and following forward posts :-

REGIMENTAL AID POSTS.

O:24.a.central

P:7.a.1.1

O:6.b.7.6 and O:6.d.7.8

J:31.b.6.4

J:22.d.2.3.

BEARER RELAY POSTS.

J:28.central

J:26.central

O:23.

MOTOR POSTS.

O:17.c.3.6

P:7.a.1.1

I:30.a.6.1

O:13.d.2.9 (For Reserve Brigade).

14th Australian Field Ambulance :

Main Dressing Station at the MAIRIE, DAOURS, N:6.c.8.2

Ambulance Post at N:5.a.7.0 BUSSY

Ambulance Post at N:22.d.1.9 BLANGY-TRONVILLE.

15th Australian Field Ambulance:

Divisional Collecting Station at LES ALENCONS (CHATEAU).

CASUALTY CLEARING STATIONS :

Nos. 20 and 61 Casualty Clearing Stations (both at VIGNACOURT) and No. 4 at FERNOIS receiving in rotation.

ADVANCED DEPOTS MEDICAL STORES :

No. 13 at NAMPS.

No. 14 at PICQUINY

No. 13 at LONGPRE LES CORPS SAINTS.

AUSTRALIAN BRANCH, BRITISH RED CROSS :

At FRIEVENT.

MEDICAL COMFORTS RAILHEAD :

At SAIBUX.

MOTOR AMBULANCE CONVOY :

Headquarters of 3rd Motor Ambulance Convoy at VILLERS-BOCAGE.

GAS TREATMENT CENTRE :

Maintained by 14th Australian Field Ambulance at DAOURS.

733

8. FOOT TREATMENT CENTRES :

At WOULVEN MILL, DAOURS, and MOTOR POST, HAMELET.

9. SCABIES TREATMENT :

At the Baths at DAOURS special treatment will be given by medical personnel to Scabies cases before return to their units.

10. EVACUATION OF WOUNDED :

(a) From R.A.D.'s South of the SOMME by hand carriage and wheeled stretcher to Motor Posts, thence to Advanced Dressing Station and Main Dressing Station by Divisional Ambulance Cars and Wagons.

(b) From R.A.P. North of the SOMME by bearer relays to Motor Post, HAMELET, and thence by car to A.D.S. AUBIGNY or by bearer relays to Motor Post at I.30.a.6.1 and thence by cars to Advanced Dressing Station LA NEUVILLE or Advanced Dressing Station BONNAY.

(c) From the Main Dressing Station stretcher cases will be evacuated in M.A.C. cars to Casualty Clearing Station and walking wounded in returning empty transport or ambulance wagons to Divisional Collecting Station LES ALENCONS.

11. EVACUATION OF SICK :

(a) Stretcher cases will be evacuated by M.A.C. cars to C.C.S., VIGNACOURT.

(b) Slight cases will be retained and treated for a period of 48 hours if necessary, at the Ambulance Post at N.5.a.7.8 BUSSY.

12. SPECIAL CASES :

All N.Y.D.N., N.Y.D. Gas, S.I.W. and Ophthalmic cases will be evacuated in M.A.C. cars direct to No. 12 Casualty Clearing Station at LONGERE.

Dental treatment will when necessary be given by the Dental Unit attached to the 14th and 15th Australian Field Ambulances.

13. BLANKETS AND STRETCHERS :

A sufficient supply is maintained at all Posts. Further supplies if urgently required may be obtained by indent, countersigned by D.D.M.S. Australian Corps, on 3rd M.A.C.

14. RECORDS :

These will be kept at the Main Dressing Station and Divisional Collecting Station.

15. ALTERATION IN DISPOSITIONS:

Special instructions regarding possible alterations in sites of Dressing Stations is issued herewith.

SPECIAL INSTRUCTIONS AS PER PARA. 15 OF "MEDICAL ARRANGEMENTS IN 5TH. AUSTRALIAN DIVISIONAL SECTOR".

In the event of a forced withdrawal of our troops, the following re-arrangements of Field Ambulances will take place.

1. The forward Field Ambulance will fall back from the ADVANCED DRESSING STATION at AUBIGNY and LA NEUVILLE and forward posts, via Ambulance Post at N.5.a.7.8. to LES ALENCONS, where it will open up as a Divisional Collecting Station, with one tent sub-division.
2. The present DIVISIONAL COLLECTING STATION at LES ALENCONS will become the MAIN DRESSING STATION.
3. The present MAIN DRESSING STATION at DAOURS (or at alternative site N.4.c.9.1.) will become the ADVANCED DRESSING STATION.
4. The O.C. Divisional Collecting Station will hold his bearer sub-divisions and transport in readiness to go forward and be at the disposal of the C.O. Forward Field Ambulance.
5. Evacuation from Advanced Dressing Station to Main Dressing Station will be by Divisional Ambulance vehicles, and from Main Dressing Station to Casualty Clearing Station by M.A.C. cars and lorries, and also if necessary by returning empty transport.
6. All records will be kept at the Main Dressing Station and Divisional Collecting Station.
7. These re-arrangements will hold good while the three Brigades are operating in the Divisional Area.
 If a Brigade be detached, or detailed as a Reserve Brigade for special purposes, and be therefore accompanied by a Field Ambulance.
 - (a) The Field Ambulance will be that forming the Divisional Collecting Station.
 - (b) A tent sub-division of the Field Ambulance forming the Main Dressing Station will take over and maintain the Divisional Collecting Station.
 - (c) The bearers and transport of the Field Ambulance forming the Main Dressing Station will be at the disposal of the C.O. Forward Field Ambulance.

APPENDIX "D".TRANSPORT.

Transport Lines are located as under : -

8th. Inf. Bde. Headquarters	I.34.e.60.15.
29th Battalion	I.34.c.50.45.
30th Battalion	I.34.c.45.10.
31st Battalion	I.34.a.5.1.
32nd Battalion	I.34.c.1.6.
8th. L.T.M. Battery	I.34.c.60.15.
14th Inf. Bde. Headquarters	H.35.a.1.4.
53rd Battalion	N.6.c.9.9.
54th Battalion	N.11.b.5.9.
55th Battalion	H.10.d.1.9.
56th Battalion	H.35.c.1.2.
15th Inf. Bde. Headquarters	N.21.a.9.3.
57th Battalion	N.11.b.4.3.
58th Battalion	N.11.d.1.6.
59th Battalion	N.17.d.4.5. <i>N9a</i>
60th Battalion	N.17.a.9.0. <i>N9a</i>
15th L.T.M. Battery	N.17.d.1.4.
5th. Pioneer Battalion	H.35.d.5.4.
	H.35.b.3.3.
	H.35.b.5.9.
	H.36.o.2.0.
	N.5.b.5.2.
5th. M.G. Battalion. H.Q.	H.35.c.00.46.
8th. M.G. Company	H.36.c.5.5.
14th M.G. Company	H.34.d.98.35.
15th M.G. Company	H.35.d.6.9.
25th M.G. Company	H.34.d.98.35.
13th A.F.A. Bde. H.Q.	I.20.b.9.5.
14th A.F.A. Bde. H.Q.	I.9.o.2.2.
5th. D.A.C. H.Q.	H.26.a.3.8.
5th. D.A.C. S.A.A. Section	M.16.b.3.8.
8th. Field Company A.E.	N.12.b.3.7.
14th Field Company A.E.	O.1.c.0.5. <i>I32a9.9.</i>
15th Field Company A.E.	H.36.a.3.5.
10th Company A.A.S.C.	ALLONVILLE
18th Company A.A.S.C.	H.26.a.8.8.
28th Company A.A.S.C.	H.21.central
29th Company A.A.S.C.	PONT NOYELLES
5th. Div. Signal Company	H.35.c.7.7.
8th. Field Ambulance	Woollen Mill, DAOURS.
14th Field Ambulance	N.4.Central.
15th Field Ambulance	LES ALIENCONS.

SECTION VIII.

TRAINING

1. Training is carried out by the Division
 - (a) within the Divisional Area;
 - (b) at the Divisional Reinforcement Wing and Nucleus Camp, PERNOIS.

2. Training under I (a) is as follows:-
 - (i) Reserve Brigade. A Brigade School for aspirant officers and aspirant N.C.Os is held at N.II.central. Number of candidates is approximately 125. The course is a general infantry course.
 - (ii) Machine Gun Battalion. Signal School. Location H. 35.c.60.25. Four weeks course.
 - (iii) Anti-aircraft training. D.A.C. and Div.Train A.A. personnel receive instruction in A.A. work from Infantry A.A. instructors attached.
 - (iv) Patrolling and Observation. Attached Light Horse and Cyclist personnel receive practical training in (a) night patrolling, and (b) day observation from Divisional and Brigade O.P's.

3. Training under I (b) is as follows:-
 - (a) Divisional Nucleus. The following classes are held:-
 - (i) Lewis Gun (artillery personnel included).
 - (ii) Intelligence.
 - (iii) Rifle Grenade.
 - (iv) German Machine Gun.
 - (v) Signalling.
 - (vi) Officers' classes.
 In addition general infantry and gas training is carried out.
 - (b) Divisional Reinforcement Wing. The following classes are held:-
 - (i) Lewis Gun.
 - (ii) Intelligence.
 - (iii) Rifle Grenade.
 - (iv) German Machine Gun.
 - (v) Signalling.
 General infantry and gas training is carried out. The above training is carried out under the direction of the O.C. Divisional Reinforcement Wing.

4. Details of Training Grounds is given in Appendix 8.

Appendix 13

Appendix 2.

SECRET

COPY No. 51

A U S T R A L I A N C O R P S

^B DIVISIONAL ARTILLERY

Defence Scheme.

Hamilton

Major,
Brigade Major,
5th Australian Divisional Artillery.

3/5/1918.

SECRET.

Copy No. 51

B
"A" DIVISIONAL ARTILLERY DEFENCE SCHEME.

- Sheet "A" -- Artillery Organisation and Sub-Division.
 Sheet "B" -- General Policy.
 Sheet "C" -- Counter Preparation.
 Sheet "D" -- Liaison and Co-operation with Infantry, Heavy Artillery, Flank Artillery, Counter Batteries and Royal Air Force.
 Sheet "E" -- Anti-Tank Defence and Protection against low flying aeroplanes.
 Sheet "F" -- Communications.
 Sheet "G" -- Ammunition Supply.
 Sheet "H" -- "S.O.S".
 Sheet "I" -- Lines of Rear Defence and Action in case of withdrawal.
 Sheet "J" -- Bridges over the Rivers SOMME, HALLUE & ANCRE.
 Sheet "K" -- Composition and Organisation of Medium Trench Mortar Batteries.

Issued to:-	Copy No.		Copy No.
R. A. Australian Corps	1	14th Aust. Inf. Brigade	35
H. A. Australian Corps	2	15th Aust. Inf. Brigade	36
13th Aust. F. A. Brigade	3-7	3rd Aust. Divl. Artillery	37
14th Aust. F. A. Brigade	8-12	"A1" Divisional Artillery	38
298th Army Brigade, R. F. A.	13-19	D. T. M. O.	39
150th Army Brigade, R. F. A.	20-26	C. B. S. O. (thro' A. C. H. A)	40
77th Army Brigade, R. F. A.	27	R. O.	41
16th Army Brigade, R. H. A.	28-31	Retained for handing over	42
EG 5th Aust. Division	32	War Diary	43-45
Staff Captain	33	File	46
8th Aust. Inf. Brigade	34	Spare	47-49
		B. M.	50.

W. H. M. H. M.

Major,
 Brigade Major,
 5th Australian Divisional Artillery.

3rd May, 1918.

5th Australian Divisional Artillery.

SECRET

Sheet "A"

Copy No. 51

"A" DIVISIONAL ARTILLERY DEFENCE SCHEME.

ARTILLERY ORGANISATION AND SUB-DIVISION.

Reference Sheet 62D.

Headquarters "A" Divisional Artillery are at BUSSY-les-DAOURS.

1. The "A" Divisional boundaries are as follows:-

- North boundary: East and West along the grid line between Squares J.24 and J.30.
- South boundary: East and West along the grid line through P.19.central.

2. The Divisional front is held by two Brigades in the line.
 The dividing line between Infantry Brigades is East West line through P.8.b.5.0.

The Division is operating under the Australian Corps.

3. The Divisional front is divided into three Sectors for Artillery defence-

- (a) Left: Northern Divisional boundary to River SOMME.
- (b) Centre: River SOMME to East West line through P.8.c.central.
- (c) Right: East and West line through P.8.c.central to Southern Divisional boundary.

4. These Zones are covered by Artillery as follows:-

- Left Group: 4-18 pdr and 2-4.5" Howitzer batteries (Group Headquarters I.30.a.80.30)
- Centre Group: 3-18 pdr and 1-4.5" Howitzer batteries (Group Headquarters I.25.d.60.20)
- Right Group: 5-18 pdr and 1-4.5" Howitzer batteries (Group Headquarters, The Asylum, FOUILLOY).

These Brigades are responsible for the protection of their Zone fronts and that there are no gaps left between them and the Groups on either side of them; for the answering of wireless calls in their Zones, and for the engagement of favourable targets within their range on any part of the front. In case of hostile attack all batteries should be employed by observed fire.

5. One Brigade of Field Artillery is superimposed on the Divisional front:- Headquarters I.27.b.00.60.

The superimposed Brigade assists in the defence of the front in case of attack, answers all wireless calls on the front, and engages favourable targets within range on any part of the front.

6. One Brigade, R.H.A., (3-13 pdr batteries) Headquarters, BUSSY-les-DAOURS, is in mobile reserve. Two batteries North of the River SOMME and one battery South of the River SOMME. The battery South of the River SOMME has one Section in action ready for hostile tank attack.

7. Flanking Units are as follows:-

- Left flank: 3rd Australian Divisional Artillery.
- Right flank: 4th Australian Divisional Artillery.

Detailed Disposition Returns are issued from time to time.
P.T.O.

186
appendix 13

SECRET

ARTILLERY ORGANISATION AND SUB-DIVISION.

8. Dumps of 300 rounds per gun for 18 pdr and 250 for 4.5" Howitzers are maintained at gun position and establishment on wheels is kept complete.

9. Teams are sufficiently close to the guns to avoid delay in the event of a move of position becoming necessary.

The Divisional front is held by two Brigades in the line. The dividing line between Infantry Brigades is West West line through P.O.S. 2, 3, 4, 5, 6, 7, 8, 9, 10, 11, 12, 13, 14, 15, 16, 17, 18, 19, 20, 21, 22, 23, 24, 25, 26, 27, 28, 29, 30, 31, 32, 33, 34, 35, 36, 37, 38, 39, 40, 41, 42, 43, 44, 45, 46, 47, 48, 49, 50, 51, 52, 53, 54, 55, 56, 57, 58, 59, 60, 61, 62, 63, 64, 65, 66, 67, 68, 69, 70, 71, 72, 73, 74, 75, 76, 77, 78, 79, 80, 81, 82, 83, 84, 85, 86, 87, 88, 89, 90, 91, 92, 93, 94, 95, 96, 97, 98, 99, 100.

These zones are covered by Artillery as follows:-
Left Group: 4-15 pdr and 2-4.5" Howitzer Batteries (Group Headquarters I.S.O. 8.00.50)
Centre Group: 2-15 pdr and 1-4.5" Howitzer Batteries (Group Headquarters I.S.O. 4.00.20)
Right Group: 2-15 pdr and 1-4.5" Howitzer Batteries (Group Headquarters, The Ayrton, BULLOCKY)

These Brigades are responsible for the protection of their zone fronts and first care is to keep left between them and the groups on either side of them; for the answering of wireless calls in their zones and for the engagement of favourable targets within their range on any part of the front. In case of hostile attack all batteries should be employed by observed fire.

One Brigade of Field Artillery is superimposed on the Divisional front:-
Headquarters I.S.O. 2.00.00

The superimposed Brigade assists in the defence of the front in case of attack, answers all wireless calls on the front, and engages favourable targets within range on any part of the front.

One Brigade, R.H.A., (2-15 pdr batteries) Headquarters, HURRY-LEE, is in mobile reserve. Two batteries North of the River BOMBE and one battery South of the River BOMBE. The battery South of the River BOMBE has one section in position ready for hostile bank attack.

Planning Units are as follows:-
Left Flank: 5th Australian Divisional Artillery.
Right Flank: 4th Australian Divisional Artillery.

Detailed Disposition Notes are issued from time to time.
P.O.S.

"A" DIVISIONAL ARTILLERY DEFENCE SCHEME.

GENERAL POLICY.

1. An active defence is maintained. This takes the form of harassing fire directed at the enemy's main arteries of approach to his forward areas, and is carried out both by day and by night. The enemy has mainly made his attacks by day and seldom in force at night. His assembly takes place in daylight or just before dawn; at times, however, assembly is effected under cover of mist, in folds of the ground, in woods or in the vicinity of villages where buildings afford protection from view. It is necessary, therefore, to search villages, woods, and all other places where assembly by day may take place out of view of our aeroplanes or observers.
2. Every possible endeavour is made to locate positions of assembly, and when located, they are dealt with so thoroughly that an attack is either impossible or so half-hearted that our infantry can easily cope with it.
3. If positions of assembly can be located, they are dealt with by every available gun with concentrated and synchronised fire. Sudden bursts of concentrated fire prove far more effective than fire of an equal volume spread over prolonged periods.
4. The choice of positions for batteries is of utmost importance. Batteries are not clumped together and are sited in depth. Where possible 4 guns of a battery are in a main position and are kept absolutely silent during daylight, except in case of hostile attack. During the day all shooting is normally done with a detached section. These main positions are chosen with a view to avoiding a sudden hostile bombardment and to facilitate the breaking up of an hostile attack before reaching our front line system. Every possible means is employed of deceiving the enemy as to which are our occupied positions and active positions are constantly changed. Each battery has at least two alternative positions. Personnel of the main positions live at some distance from their guns.

SECRET.

Sheet "C"

Copy No. 5

"A" DIVISIONAL ARTILLERY DEFENCE SCHEME.**COUNTER PREPARATION.**

1. With a view to producing the heaviest possible fire on any portion of the "A" Divisional Artillery front for counter preparation purposes the front of the "A" Divisional Artillery is divided into lanes each of 500 yards. These lanes run East along the grid lines. These lanes are numbered "5A", "5B", "5C", etc, from North to South.

The lane running East in Square J.30.a. is "5A"
 The lane running East in Square J.30.c. is "5B"
 The lane running East in Square P.3.d. is "5F"
 The lane running East in Square P.20.d. is "5K" & so on.

The lane "5D" runs East in Square J.35.d.
 The lane "5E" runs P.3.b.00.00 - P.3.b.50.50 - P.5.b.20.65 -
 J.35.d.35.00 - J.36.c.00.00 - P.6.a.00.00.

These lanes are divided into Zones of 500 yards in depth beginning from the start line and extending back 4 Zones, i.e. 2000 yards. These Zones will be lettered "A", "B", "C" and "D" from West to East. The start line is 100 yards East and parallel to the S.O.S. line. When "CP Scheme Phase 2" is ordered the Zone or Zones to be swept are indicated.

2. Counter preparation is ordered on a number of lanes, e.g., "5C" to "5E". On this order Group commanders distribute evenly all guns which can fire on the frontage indicated. The Heavy Artillery co-operate on similar lines commencing at 600 yards beyond the S.O.S. lines.

3. The rate for searching is 100 yards in two minutes.

4. When an attack is considered imminent counter preparation is ordered from the "A" Divisional Artillery office.

5. The principles upon which counter preparation are based are broadly -

- (a) The delivery of a maximum of harassing fire and of counter battery action at one stage.
- (b) At another stage a concentration of annihilating fire against all probable places of assembly and areas over which enemy movement must take place prior to an attack.

6. For counter preparation Field Artillery are responsible for the area from their S.O.S. lines to 1,000 yards to the East.

7. Counter preparation is ordered in the following forms:-

- "CP Scheme Phase 1a" means a maximum of counter battery fire.
- "CP Scheme Phase 1b" means a maximum of harassing fire.
- "CP Scheme Phase 2" means a maximum of annihilating fire.

8. The targets for "CP Scheme Phase 1b" are likely places of assembly for hostile troops and the nature of fire should be concentrated. The concentration schemes made out by the "A" Divisional Artillery are used and in addition each Group commander keeps up to date a list of suitable targets on his Group front to be dealt with by his Group and forwards to this office the detail of

SECRET.

- 2 -

COUNTER PREPARATION.

tasks allotted to batteries.

9. Normal rates of fire - 18 pdrs 5 rounds per gun per minute. 4.5" Hows 2 rounds per gun per minute.

10. For "CP Bohane Phase 2" the Field Artillery puts down a creeping barrage over the whole area concerned, commencing from the start line and searches back by lifts of 100 yards in 2 minutes. The operation will be repeated as often as may seem necessary. This may be on the whole Divisional Artillery front or may be on part in which case the method of putting the operation into action is detailed in para. 1.

The lane running east in square 1.50.a. is "A"
 The lane running east in square 1.50.b. is "B"
 The lane running east in square 1.50.c. is "C"
 The lane running east in square 1.50.d. is "D" & so on.

The lane "A" runs east in square 1.50.a.
 The lane "B" runs 1.50.a.00 - 1.50.b.00 - 1.50.c.00 - 1.50.d.00 - 1.50.e.00 - 1.50.f.00 - 1.50.g.00 - 1.50.h.00 - 1.50.i.00 - 1.50.j.00 - 1.50.k.00 - 1.50.l.00 - 1.50.m.00 - 1.50.n.00 - 1.50.o.00 - 1.50.p.00 - 1.50.q.00 - 1.50.r.00 - 1.50.s.00 - 1.50.t.00 - 1.50.u.00 - 1.50.v.00 - 1.50.w.00 - 1.50.x.00 - 1.50.y.00 - 1.50.z.00.

These lanes are divided into zones of 500 yards in depth beginning from the start line and extending back 4 lanes, i.e. 2000 yards. These zones will be lettered "A", "B", "C" and "D" from west to east. The start line is 100 yards west and parallel to the B.O.S. line. When "CP Bohane Phase 2" is ordered the zone of lanes to be swept are indicated.

Counter preparation is ordered on a number of lanes, e.g. "A" to "D". On this order Group commanders distribute evenly all guns which are fire on the frontage indicated. The Heavy Artillery co-operate on earlier lanes commencing at 600 yards west of the B.O.S. line.

The rate for searching is 100 yards in two minutes.

When an attack is considered imminent counter preparation is ordered from the "A" Divisional Artillery office.

The principles upon which counter preparation are based are:

- (a) The delivery of a maximum of harassing fire and of counter battery action at one stage.
- (b) As another stage a concentration of annihilating fire against all probable places of assembly and areas over which enemy movement must take place prior to an attack.

For counter preparation Field Artillery are responsible for the area from their B.O.S. line to 1,000 yards to the front.

Counter preparation is ordered in the following format:-

"CP Bohane Phase 1a" means a maximum of counter battery fire.
 "CP Bohane Phase 1b" means a maximum of harassing fire.
 "CP Bohane Phase 2" means a maximum of annihilating fire.

The targets for "CP Bohane Phase 1b" are likely places of assembly for hostile troops and the nature of fire should be controlled. The concentration should be made out by the "A" Divisional Artillery and used and in addition each Group commander keeps up to date a list of suitable targets on his Group front to be dealt with by his Group and forwards to the office the details of

133

SECRET.

Sheet "D"

Copy No. 51

"A" DIVISIONAL ARTILLERY DEFENCE SCHEME.

LIAISON AND CO-OPERATION.

With Infantry, Heavy Artillery, Flank Artillery, Counter Batteries and Royal Air Force.

1. Each Artillery Brigade has one officer, not below the rank of Captain, at the Headquarters of the Infantry Brigade whose front it is covering, and he is in direct communication with his Brigade.

Right Group Field Artillery has a Liaison Officer with the Right Infantry Brigade.

Centre Group Field Artillery has a Liaison Officer with the Left Infantry Brigade.

Left Group Field Artillery has a Liaison Officer with the Battalion in the line North of the River SOMME.

In addition, an Artillery Officer is at the Headquarters of each Battalion Headquarters in the line, who is in direct communication with the Liaison Officer at Infantry Brigade Headquarters.

2. Liaison barrages with flank Divisional Artillery consist of barrages on "S.O.S" line opposite our own front, either on the entire front or on sectors, as may be required.

3. Co-operation with the Infantry for major operations is arranged direct by Divisional Headquarters. For minor operations, affecting one Brigade alone, it is arranged directly between the Artillery Liaison Officer with the Infantry Brigade and the G.O.C., Infantry Brigade and referred to Divisional Artillery Headquarters if necessary.

4. (a) Heavy Artillery, Australian Corps, with Headquarters at MONTIGNY, cover the Australian Corps Sector.

Composition of Heavy Artillery, Australian Corps, and locations, are issued from time to time to all concerned.

(b) The Heavy Artillery Group, acting in co-operation with this Divisional Artillery, is the 9th R.G.A., Headquarters, BUSSEY-les-DAURES.

5. (a) The Australian Corps Counter Battery Officer is at MONTIGNY.

(b) All hostile shelling is to be immediately reported to Australian Corps Counter Battery, through Group Headquarters or through Headquarters "A" Divisional Artillery whichever is the quicker.

(c) "A" Divisional Artillery have a telephone line to the Australian Corps Counter Battery office through the Australian Corps Heavy Artillery exchange.

(d) Information required by Australian Corps Counter Battery is as follows:-

- (i) Unit calling.
- (ii) The number and calibre of hostile guns or howitzers firing.
- (iii) Time of hostile shelling.

SECRET.

- 2 -

LIAISON AND CO-OPERATION

With Infantry, Heavy Artillery, Flank Artillery, Counter Batteries and Royal Air Force.

5 contd.

- (iv) Locality shelled.
- (v) Nature of fire, e.g. "Salvoes of 3 each 2 minutes" "one round each 10 minutes"
- (vi) Direction from which the hostile shelling is coming. When possible this should be given in grid line bearing, and the place stated from which the bearing is taken. The mode of obtaining direction will be stated, viz: Flash or Sound.

(e) The Counter Battery Officer must be kept informed of the continuance or otherwise of all hostile shelling reported; the time of cessation being of the utmost importance.

6. (a) Flying Squadrons working on this Divisional front are the 35th Squadron, R.A.F., and the 3rd Squadron, Australian Flying Corps.

(b) (i) N.F. calls will be answered by one battery only in the manner laid down in S.S. 131. Not more than four salvoes will be expended unless the situation and observations received render it desirable to continue the fire on the hostile battery.

The 5th Australian Divisional Artillery will engage N.F. calls West of the line P.21.central, P.9.d.0.0, P.10.o.0.0, P.10.a.0.0, P.12.a.0.0, P.6.o.0.0, P.6.d.0.0, P.6.b.0.0, Q.1.a.0.0, K.31.o.0.0, K.31.d.0.0, K.31.b.0.0, K.32.a.0.0, K.26.o.0.0, K.26.d.0.0, K.20.d.0.0.

The Heavy Artillery will engage N.F. calls East of the above lines.

Groups will arrange to answer N.F. calls in their own sectors.

(ii) G.F. calls will be answered by a section of all batteries that can bear on the target. A burst of fire (see S.S. 131) will consist of 3 section salvoes.

ground. In addition to sending the S.O.S. call by wireless, the pilot flying towards the enemy keeps sounding his Klaxon horn and drops a white parachute light over them. - The parachute light descends very slowly.

(c) Officers commanding Groups, Brigades or Batteries, to which wireless receiving sets are attached keep the wireless operator informed as to which Zone calls he is to take, i.e., those of the Zones into which they can fire. All such calls are taken by the operator who is not asked to take the calls of other Zones.

SECRET.

Sheet "E"

Copy No. 51

"B" DIVISIONAL ARTILLERY DEFENCE SCHEME.

ANTI TANK DEFENCE AND PROTECTION AGAINST LOW FLYING AEROPLANES.

1. There are 3-15 pdrs B.L.C. on the "B" Divisional front. 100 rounds of H.E. ammunition are at each of these positions. These 3-15 pdrs B.L.C. are emplaced as under:-
 - (i) One at J.19.d.9.0. This gun is attached to and manned by personnel from the Centre Group
 - 1.(ii) One at P.19.b.00.90 and one at P.8.c.20.00. These 2-15 pdrs are manned by personnel of the "B" Divisional Artillery Trench Mortars. Reliefs are arranged by the D.T.M.C.
2. 2-18 pdrs are emplaced at O.17.c.80.10 and O.17.d.20.35 to cover the Ridge with a field of fire South East.
3. The positions referred to in paras 1 & 2 are not to be given away prematurely, and although the primary object is the destruction of hostile Tanks, yet full advantage is to be taken in their employment against hostile infantry should favourable opportunities occur.
4. One battery of the R.H.A. Brigade in mobile reserve has a roving commission South of the SOMME, with the especial role of dealing with hostile Tanks in case of Tank attack.
5. In addition, one Section of 18 pdrs per Group is detailed as an Anti-Tank Section and immediately engage any targets of that nature that present themselves.
6. Protection against low flying aeroplanes. Each battery has its own two Lewis guns in action at the battery for defence against aircraft; these are so sited that they can be used to defend the battery position from Infantry attack in case of necessity.

AMENDMENT No. 6 to "B" DIVISIONAL ARTILLERY DEFENCE SCHEME.

1. Sheet "E" of the "B" Divisional Artillery Defence Scheme is CANCELLED and the above SUBSTITUTED.
2. ACKNOWLEDGE ON ATTACHED FORM.

Handwritten signature

Headquarters, 10/5/18

Major,
Brigade Major,
5th Australian Divisional Artillery.

Issued at 3.30 p.m. to all recipients of "B" Divisional Artillery Defence Scheme.

SECRET.

COMMUNICATIONS.

FROM	TO	DESCRIPTION OF LINE.
"B" DIVL ARTY	"Y" ARMY BDE, RFA.	From Forward Exchange along SOME to approx I.30.0 thence cable to Brigade.
"B" DIVL ARTY	"W" BDE, AUST.F.A.	From Forward Exchange. Local cable.
"B" DIVL ARTY	"i" H.A.GROUP	Local cable.
"B" DIVL ARTY	"A" KITE BALLOON SECTION.	Local cable.
"B" DIVL ARTY	"B" KITE BALLOON SECTION.	Local cable (party with "A" Kite Balloon Section)
"B" DIVL ARTY	"B" DIVL A.COLUMN	Cable to H.34.d thence air line to H.22.b.2.7.
"B" DIVL ARTY	"W" BDE WAGON LINES EXCHANGE.	Local cable.
"B" DIVL ARTY	BDE, R.H.A.	Local cable.

"W" BRIGADE, AUST.F.A?		

"W" BDE, AUST.F.A.	LEFT INF.BDE LIAISON	Buried cable all way.
"W" BDE, AUST.F.A.	RIGHT INF.BDE	Part ground cable and part bury to Brigade.
"W" BDE, AUST.F.A.	BATTALION LIAISON	Ground cable in party with "Za" Btery and O.P.
"W" BDE, AUST.F.A.	"Wa" Battery "W" BDE	Ground cable to Battery.
"W" BDE, AUST.F.A.	"Wb" Bty "W" BDE	Ground cable to Battery.
"W" BDE, AUST.F.A.	"Wc" Bty "W" BDE	Ground cable to Battery.
"W" BDE, AUST.F.A.	"Wd" Bty "W" BDE	Ground cable to Battery.
"W" BDE, AUST.F.A.	"XXa" Bty "XX" BDE } "XXc" Bty "XX" BDE }	Party line, part bury and part ground line. Alternative on both Batteries through Exchange at "Za" Rear.
BATTERY O.P. LINES DIRECT TO BATTERIES.		
"Z" ARMY BDE, R.F.A.		

"Z" ARMY BDE, R.F.A.	"ii" BDE, R.G.A.	Two lines, ground cable (alternative means of getting "B" DIVL ARTY).
"Z" ARMY BDE, R.F.A.	"X" BDE, AUST.F.A.	Ground cable via "Wd" Bty.

P.T.O.

194

23

SECRET.

Sheet "F"

Copy No. 46

"B" DIVISIONAL ARTILLERY DEFENCE SCHEME.

COMMUNICATIONS.

FROM.	TO.	DESCRIPTION OF LINE.
"B" DIVL ARTY	CORPS HEAVY ARTILLERY	Local cable to Army route at H.34.d, thence air line to MONTIGNY.
"B" DIVL ARTY	"B" DIVISION	Local cable (2 lines)
"B" DIVL ARTY	G.S.O.1 "B" DIVN	Direct from Brigade Major to G.S.O.1.
"B" DIVL ARTY	"A" DIVL ARTY	On Corps Bury system.
"B" DIVL ARTY	"C" DIVL ARTY	Cable to Army route at H.34.d, thence air line to "C" DIVL ARTILLERY.
"B" DIVL ARTY	FORWARD EXCHANGE (FOUILLOY)	Cable to river near DAOURS thence sub-cable to FOUILLOY.
"B" DIVL ARTY	"Z" ARMY BDE, RFA.	Cable all way. Runs approx H.35.central - H.36.central - I.31.a - I.32.a - I.21.b.5.8.
"B" DIVL ARTY	"Z" ARMY BDE, RFA.	Extension of "B" DIVL.A.C., line. Cable runs approx East to Brigade.
"B" DIVL ARTY	"Z" ARMY BDE, RFA.	Cable from extension at "ii" Brigade, R.G.A.
"B" DIVL ARTY	"X" BDE, AUST.F.A.	Cable from Forward Exchange runs North from FOUILLOY across River SOMME to railway line thence along line to Brigade.
"B" DIVL ARTY	"X" BDE, AUST.F.A.	Cable to River SOMME at approx 0.1.a thence sub-cable in SOMME and ANCRE (with test point at LA NEUVILLE). D.T.M.O. "B" Divn party on line.
"B" DIVL ARTY	"Y" ARMY BDE, RFA	Cable from Forward Exchange runs North from FOUILLOY to railway thence along line to "X" Brigade, thro' office at "X" Brigade and cable to "Y" Brigade.
"B" DIVL ARTY	"Y" ARMY BDE, RFA.	Cable to SOMME at 0.1.a thence sub-cable along SOMME and ANCRE (with test point at LA NEUVILLE and "X" Brigade) to "Y" Brigade.

P.T.O.

SECRET.

- 3 -
COMMUNICATIONS.

FROM. TO. DESCRIPTION OF LINE.

"Z" ARMY BDE, R.F.A. continued.

"Z" ARMY BDE R.F.A.	"Za" Bty "Z" BDE	Ground cable to Battery.
"Z" ARMY BDE, RFA.	"Zc" Bty "Z" BDE	Ground cable to Battery.
"Z" ARMY BDE, RFA.	"Zd" Bty "Z" BDE	Ground cable to Battery.
"Z" ARMY BDE, RFA.	WAGON LINES	Ground cable.
"Z" ARMY BDE, RFA.	H.A.G., O.P.	Ground cable to O.P.

BATTERY O.P. LINES DIRECT TO BATTERIES.

"X" BDE, AUST.F.A.

"X" BDE, AUST.F.A.	"Xa" Bty "X" BDE "Xb" Bty "X" BDE	Ground cable to Batteries (party). Both Batteries connected laterally.
"X" BDE, AUST.F.A.	"Xc" Bty "X" BDE "Xd" Bty "X" BDE	
"X" BDE, AUST.F.A.	"Zb" Bty "Z" BDE	Ground cable to Battery.
"X" BDE, AUST.F.A.	LEFT INF. BDE LIEUTENANT	Direct line (cable) with tee into "Xd" Battery.
"X" BDE, AUST.F.A.	"W" BDE, AUST.F.A.	Ground cable via "Wd" Bty.
"X" BDE, AUST.F.A.	WAGON LINES	One line ground cable (serves all Wagon Lines).
"X" BDE, AUST.F.A.	"B" DIVL O.P.	Direct line (cable).
"X" BDE, AUST.F.A.	LEFT INF. BDE	From Brigade to River ANCRE thence in River to Left Inf. Brigade.

BATTERY O.P. LINES DIRECT TO BATTERIES.

"Y" ARMY BDE, R.F.A.

"Y" ARMY BDE, R.F.A.	"Ya" Bty "Y" BDE	Cable all way (ground).
"Y" ARMY BDE, RFA.	"Yb" Bty "Y" BDE	Cable all way (ground).
"Y" ARMY BDE, RFA.	"Yc" Bty "Y" BDE	Cable all way (ground).
"Y" ARMY BDE, RFA.	"Yd" Bty "Y" BDE	Cable all way (ground).
"Y" ARMY BDE, RFA.	"XXb" Bty "XX" Bde) "XXd" Bty "XX" Bde)	Party line Ground cable all way. Also lateral connection.
"Y" ARMY BDE, RFA.	"X" BDE, AUST.F.A.	Ground cable (two lines).
"Y" ARMY BDE, RFA.	LEFT BDE "A" DIVL ARTY	Ground cable.

BATTERY O.P. LINES DIRECT TO BATTERIES.

"G" DIVISIONAL ARTILLERY DEFENCE SCHEME.

AMMUNITION SUPPLY.

1. The present method of ammunition supply to batteries is as follows:-

From Railhead at FRESSILLIES on demand by the 5th Australian Divisional Artillery as under:-

(a) H.16.d.5.0 on charge to 5th Australian Divisional Ammunition Column.

Ammunition of all natures is drawn from this Dump by 5th Australian Divisional Ammunition Column for delivery to 13th and 14th Australian Field Artillery Brigades.

(b) N.6.c.0.0 on charge to 5th Australian Divisional Ammunition Column.

Ammunition of all natures is drawn from this Dump by 77th Army Brigade Ammunition Column, 150th Army Brigade Ammunition Column and 298th Army Brigade Ammunition Column for delivery to 77th, 150th and 298th Army Brigades, R.F.A., respectively.

2. Brigades will demand ammunition direct from Divisional Ammunition Column and Brigade Ammunition Columns concerned who will deliver to battery wagon lines.

3. Ammunition to be maintained at own positions will be as follows:-

"3 (a) 18 pdr ammunition is being issued in the proportion of 60% A and 40% AX and will be fired and maintained in this proportion, both dumped and in echelons. 10% of AX issued is fuzeed with 106 Fuze".

4. A Dump for emergency supply for 150th Army Brigade, R.F.A., on charge to 150th Army Brigade Ammunition Column is situated at I.32.b.8.1. This will be drawn on by 150th Army Brigade Ammunition Column and one Section of 77th Army Brigade Ammunition Column in case of emergency only, should the supply A.R.P. at N.6.c.0.0 prove insufficient.

5. A second emergency Dump on Corps charge is situated on road at G.36.c.4.8. Ammunition maintained - 7,000 A, 3,000 AX, 2,000 BX.

6. A closed Corps Dump is situated in the wood at G.24.b.5.7 which, in case of motor transport failing to keep up supply, will be drawn on by Divisional and Brigade Ammunition Columns.

7. Trench Mortar Ammunition is demanded from Railhead, forwarded to 5th Australian Divisional Ammunition Column A.R.P. at H.16.d.5.0 and taken forward under arrangements made direct between D.T.M.O., 5th Australian Division and C.O. 5th Australian Divisional Ammunition Column.

8. All echelons for 13 pdr guns of the 16th Army Brigade, R.H.A., are kept complete on wheels include the Brigade H.T. Column. The latter is parked at ALLONVILLE with the 3rd Australian H.T. Coy who are connected by telephone. Lorries are sent forward on demand of C.O. 16th Army Brigade Ammunition Column, R.H.A., through Staff Captain 5th Australian Divisional Artillery. An emergency supply of 1120 M and 1960 BX is located at the Dump at G.36.c.4.8.

33

196

SECRET.

Sheet "G"

Copy No. 51

"A" DIVISIONAL ARTILLERY DEFENCE SCHEME.

AMMUNITION SUPPLY.

1. The present method of ammunition supply to batteries is as follows:-

From Railhead at FRESSILLIES on demand by the 5th Australian Divisional Artillery as under:-

- (a) H.16.d.5.0 on charge to 5th Australian Divisional Ammunition Column.
Ammunition of all natures is drawn from this Dump by 5th Australian Divisional Ammunition Column for delivery to 13th and 14th Australian Field Artillery Brigades.
- (b) N.6.c.0.0 on charge to 5th Australian Divisional Ammunition Column.
Ammunition of all natures is drawn from this Dump by 77th Army Brigade Ammunition Column, 150th Army Brigade Ammunition Column and 298th Army Brigade Ammunition Column for delivery to 77th, 150th and 298th Army Brigades, R.F.A., respectively.

2. Brigades will demand ammunition direct from Divisional Ammunition Column and Brigade Ammunition Columns concerned who will deliver to battery wagon lines.

3. Ammunition to be maintained at gun positions will be as follows:-

Handwritten notes on a separate piece of paper, partially obscured.

- 300 rounds per gun (75% A, 25% AX)
- 250 rounds per gun (100% BX)
- 300 rounds per D/Bty Gas (50% BNC, 50% BCBH).

4. A Dump for emergency supply for 150th Army Brigade, R.F.A., on charge to 150th Army Brigade Ammunition Column is situated at I.32.b.8.1. This will be drawn on by 150th Army Brigade Ammunition Column and one Section of 77th Army Brigade Ammunition Column in case of emergency only, should the supply A.R.P. at N.6.c.0.0 prove insufficient.

5. A second emergency Dump on Corps charge is situated on road at G.36.c.4.8. Ammunition maintained - 7,000 A, 3,000 AX, 2,000 BX.

6. A closed Corps Dump is situated in the wood at G.24.b.5.7 which, in case of motor transport failing to keep up supply, will be drawn on by Divisional and Brigade Ammunition Columns.

7. Trench Mortar Ammunition is demanded from Railhead, forwarded to 5th Australian Divisional Ammunition Column A.R.P. at H.16.d.5.0 and taken forward under arrangements made direct between D.T.M.O., 5th Australian Division and C.O. 5th Australian Divisional Ammunition Column.

8. All echelons for 13 pdr guns of the 16th Army Brigade, R.H.A., are kept complete on wheels include the Brigade H.T. Column. The latter is parked at ALLONVILLE with the 3rd Australian H.T. Coy who are connected by telephone. Lorries are sent forward on demand of C.O. 16th Army Brigade Ammunition Column, R.H.A., through Staff Captain 5th Australian Divisional Artillery. An emergency supply of 1120 N and 1960 BX is located at the Dump at G.36.c.4.8.

SECRET.

Sheet "H"

Copy No. 51

"A" DIVISIONAL ARTILLERY DEFENCE SCHEME.

"S.O.S"

1. The "S.O.S" signal is the call for immediate assistance from the Artillery normally covering the Sector in question sent by any responsible officer in the front line. This signal, whether by telephone or visual method (such as a rocket), is a call for a barrage in "No man's land". The "S.O.S" signal will be sent when the enemy are actually attacking.

The "S.O.S" signal is notified from time to time.

"S.O.S" line will run K.19.c.60.00 - K.25.a.60.50 - K.25.a.15.00 - J.30.a.80.00 - J.36.a.25.50 - J.35.d.30.20 - P.5.b.20.65 - P.3.b.50.50 - P.3.c.50.00 - P.9.a.40.40 - P.8.d.60.30 - P.14.b.40.60 - P.14.b.30.40 - P.14.d.00.70 - P.14.c.70.00 - P.20.c.90.90.

- 3. All Brigades responsible for the defence of the front will have an overlap of 50 yards with the Units on each side of them.
- 4. 18 pdrs will use 75% A and 25% AX. 4.5" Howitzers BX.
- 5. At each 18 pdr gun-pit 20 rounds are to be kept distinctly labelled "S.O.S" with fuzes correctly set. This ammunition will be changed periodically, and the replaced ammunition will be fired off.
- 6. Field Howitzers will bombard specially selected points.
- 7. On receipt of the "S.O.S" signal, Field Artillery will open fire on their "S.O.S" lines. Rates of fire will be as follows:-

First 8 minutes	-- 4 rounds per gun per minute
Second 7 minutes	-- 3 rounds per gun per minute

The above provisions are not to be taken in limiting either Group or Battery Commanders from developing the full fire power of their Batteries in the event of their knowledge of the situation demanding it.

8. All fire will cease at the end of fifteen minutes.

If the "S.O.S" signal is repeated after the opening of fire, the maximum rate of fire will be reverted to and the procedure as laid down above carried out.

9. The Artillery will act on seeing the prescribed Rocket signal whether the telephone is working or not, although the Rocket signal should be confirmed by wire by the Infantry concerned.

Telephone lines to the Infantry are to be tested at least every half-hour during the day and night.

10. All officers must clearly understand that it is their duty to obtain immediate information as to the situation for their higher formation; e.g., Batteries to Groups, and Groups to Headquarters "A" Divisional Artillery. It is only by this means that the necessary concentrations of Artillery can be produced.

P.T.O.

SECRET.

- 2 -

"S.O.S"

- 11. A sentry will always be posted at each battery position as a "Look-out" during the day and night.
- 12. Pointers showing Inter-Group boundaries and battery zone boundaries will be provided at each battery position.
- 13. A battery receiving an "S.O.S" call will repeat it at once to -
 - 1. Batteries on either flank.
 - 2. Group Headquarters.

The Groups will at once inform -

- 1. Batteries in the Group.
- 2. Groups on either flank.
- 3. C.R.A.
- 4. Affiliated Heavy Artillery Group.

The C.R.A. will inform -

- 1. H.A. Corps.
- 2. R.A. Corps.
- 3. "G" "A" Division.

N.B. If the message has not come through the Battalion, the Battalion must be informed by the Group.

The above provisions are not to be taken in limiting sense. Group or Battery Commanders from developing the full time power of their batteries in the event of their knowledge of the situation being in doubt.

All time will cease at the end of fifteen minutes.

If the "S.O.S" signal is repeated after the opening of the main arm of the line will be reverted to and the procedure as laid down above carried out.

The Artillery will not on seeing the prescribed Hooked signal whether the telephone is working or not, although the Hooked signal should be confirmed by wire by the Infantry concerned.

Telephone lines to the Infantry are to be tested at least every half-hour during the day and night.

All officers must clearly understand that it is their duty to obtain immediate information as to the situation for their higher formation; e.g., Batteries to Groups, and Groups to Headquarters. It is only by this means that the necessary communications of Artillery can be produced.

233

Appendix 13 199

51

DIAGRAM

- Showing -

S.O.S Line & Zones of Fire.

Reference Sheet 62^D 1-40000.

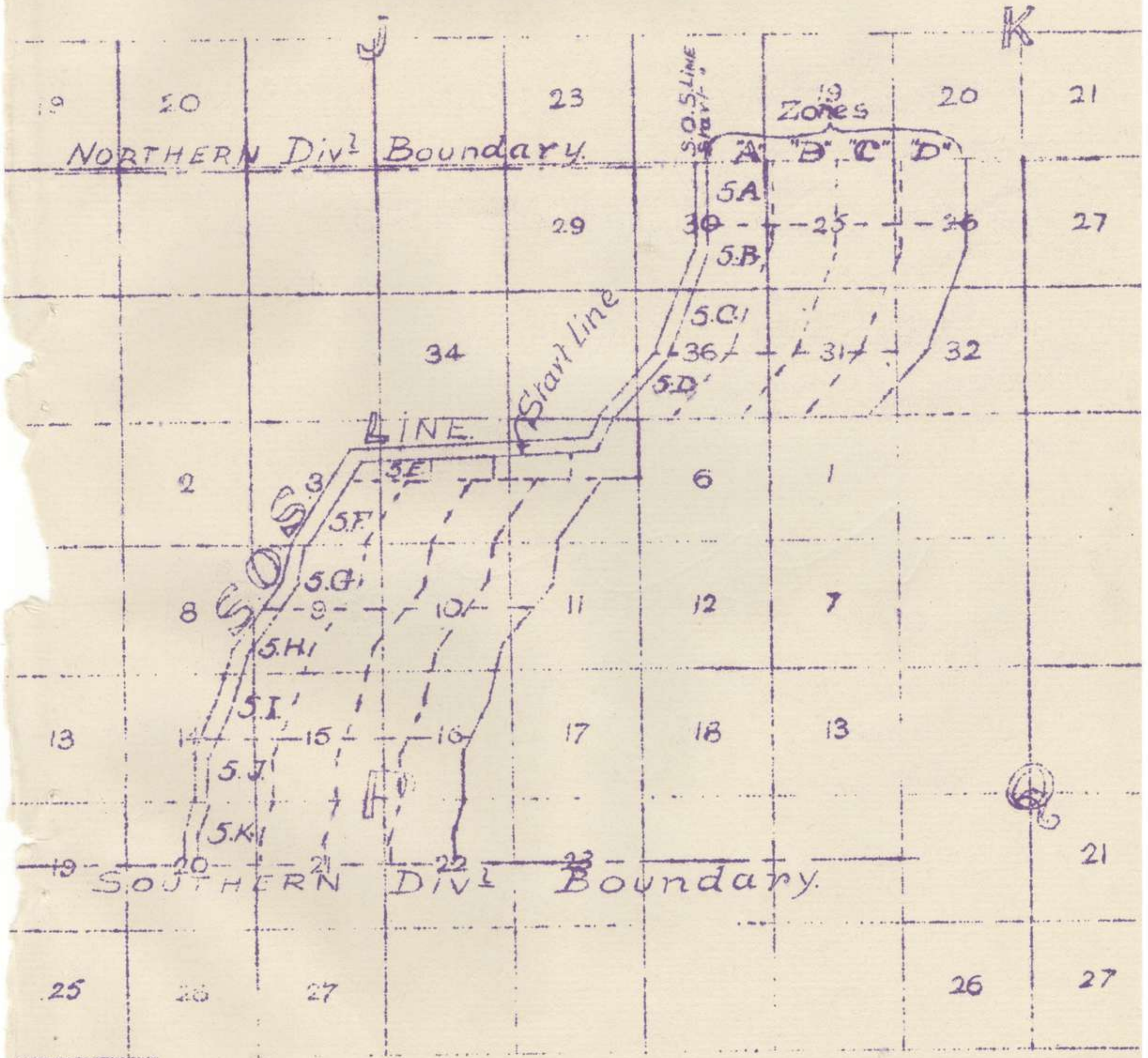

733

Appendix B

SECRET

Sheet "I"

Copy No. 51

"A" DIVISIONAL ARTILLERY DEFENCE SCHEME.

LINES OF REAR DEFENCE AND ACTION IN CASE OF WITHDRAWAL.

1. Should it become necessary to withdraw from the present front the principles of withdrawal as regards the Field Artillery of the "A" Divisional Artillery Group will be as detailed below.
2. Withdrawals either of Brigades or batteries will be by echelons; the front must never be uncovered and unless the withdrawal is voluntary, every yard of the way is to be stubbornly contested.
3. Frontages allotted to Brigades will be as in Sheet "A", but these instructions are not in any way to interfere with the initiative of commanders of lower formations at the moment who will seize every opportunity of inflicting loss on the enemy and helping the troops on either flank.
4. On the Right and Centre Sectors, the 13th Australian Field Artillery Brigade, and the 298th Army Brigade, R.F.A., will withdraw first; these Sectors being covered by the 14th Australian Field Artillery Brigade. The 13th Australian Field Artillery Brigade will take up an intermediate position about I.31-32 and be prepared to fire on any portion of the Divisional front.
5. The 298th Army Brigade, R.F.A., will withdraw to the North side of the SOMME by DAOURS and take up a position about N.15, N.16, N.17 and N.9, as far North as the road in N.9.d. The area in squares H.29 and H.30 is allotted to the 14th Australian Field Artillery Brigade. Should the 13th and 14th Australian Field Artillery Brigades have to take up a position West of the River HALLUE the area in square N.9 North of the road in N.9.d Northwards to an East and West line through N.4.a.40 is allotted to these Brigades. The area 100 yards North and South of road in N.9.d is reserved for the Heavy Artillery. The area East and West through N.4.a.40 North to East and West along grid line between H.28 and H.34 is allotted to the 77th Army Brigade, R.F.A.
6. On the Left Sector, the 150th Army Brigade, R.F.A., will withdraw either by bridge at HELLILY or BONNAY, as the situation requires, and take up positions to cover the GENTELLES - AUBIGNY - FRANVILLERS line, about square H.21 and H.27.
7. The 16th Army Brigade, R.H.A., in case of hostile attack will operate in the area North of the River SOMME and South of Grid line East and West through I.13 central and assist the withdrawal as the tactical situation demands.
8. On taking up positions to cover the GENTELLES - AUBIGNY - FRANVILLERS line, batteries of the 77th Army Brigade, R.F.A., will come under the tactical control of the C.O. 77th Army Brigade, R.F.A.
9. To cover the QUERRIEU - BLANGY TRONVILLE System, areas are allotted to Brigades as under:-

150th Army Brigade, R.F.A.	-- G.36.a.b.c.
13th Aust. F.A. Brigade RFA	-- G.35.b & d.
14th Aust. F.A. Brigade	-- M.5.a & b.
298th Army Brigade, R.F.A.	-- M.11.b. M.12.a.
77th Army Brigade, R.F.A.	-- G.24 and G.19.c.

P.T.O.

Appendix 13

SECRET

- 2 -

LINES OF REAR DEFENCE AND ACTION IN CASE OF WITHDRAWAL.

9 contd. The 77th Army Brigade, R.F.A., will be superimposed on the fronts of the 150th Army Brigade, R.F.A., and 14th Australian Field Artillery Brigade. The 13th Australian Field Artillery Brigade will be superimposed on the fronts of the 14th Australian Field Artillery Brigade and the 298th Army Brigade, R.F.A.

10. Maps showing systems of defence and areas allotted to Brigades are attached.

11. In the event of a withdrawal becoming necessary the 5th Australian Divisional Ammunition Column, the 298th Brigade Ammunition Column, the 150th Brigade Ammunition Column and the 77th Brigade Ammunition Column will move as detailed below:-

(a) 5th Australian Divisional Ammunition Column to G.18.d.

(b) 298th Brigade Ammunition Column and 77th Brigade Ammunition Column to G.18.a. West of metal road.

And substitute the following -

Route for 298th R.F.A., Brigade Ammunition Column: Road N.8.c - N.7.b - N.2.c & a - H.32.c - H.31.b - H.25.d & b - G.24.b - G.18.d & a.

Route for 77th R.F.A., Brigade Ammunition Column: Any tracks or roads as tactical situation demands.

ALLONVILLE

Route: Centre N.13.b - Cross roads N.7.d to T.Roads M.11.a. thence direct to ALLONVILLE.

The above locations and routes will be reconnoitred forthwith by all officers.

Water is available in ALLONVILLE; one pond in front of Church and one at Southern end of town.

On the left sector, the 150th Army Brigade, R.F.A., will withdraw either by bridge at MILLIE or BOWAY, as the situation requires, and take up positions to cover the QUEENSLAND - AUSTRALIAN - TROUVILLE line, about square H.31 and H.32.

The 14th Army Brigade, R.F.A., in case of hostile attack will operate in the area North of the river BOWAY and South of grid line East and West through I.13 central and assist the withdrawal as the tactical situation demands.

On taking up positions to cover the QUEENSLAND - AUSTRALIAN - TROUVILLE line, rear area of the 77th Army Brigade, R.F.A., will come under the tactical control of the G.O. 77th Army Brigade, R.F.A.

To cover the QUEENSLAND - AUSTRALIAN - TROUVILLE line, areas are allotted to Brigades as under:-

150th Army Brigade, R.F.A. -- G.30.a, b, c, d.
 14th Aust. Field Artillery Brigade -- G.32.a, b, c, d.
 14th Aust. T.A. Brigade -- M.2.a, b, c, d.
 298th Army Brigade, R.F.A. -- N.11.b, N.12.a, c.
 77th Army Brigade, R.F.A. -- G.24 and G.18.c, d.

R.F.A.

Appendix 1 B

