

**Series: AWM95**  
Australian Army commanders' diaries  
[Vietnam]

Army Aviation units

**Item number: 8/1/3**

**Item: 161 Reconnaissance Flight**

Narrative

Annexes

[1-31 Dec 1965]

# RECEIPT FOR CLASSIFIED MATTER

Issued to AMA (C)

Date 18 Jan 66

I acknowledge receipt of the Classified Matter listed below:

Classification	Reference No.	Date of Origin	Title	Copy Nos. or No. of Copies
SECRET	R 107.6.2	18 Jan 66	/	1

The ORIGINAL of this Receipt will be returned to:

HQ AAFV

SAIGON.....VIETNAM

Signature [Signature]

Initials and Surname

(in block letters)

Date 21/1/66

Appointment 5502 DSJ

- NOTES—1. When classified matter is identifiable by its classification, reference number and date of origin, the title will NOT be inserted and this receipt will be returned in a single un-registered envelope.
2. When classified matter bears NO reference number its title will be inserted and this receipt returned by registered post.

SECRET

JAB/VCB



AUSTRALIAN MILITARY FORCES

IN REPLY PLEASE QUOTE  
R707:6:2

HEADQUARTERS  
AUSTRALIAN ARMY FORCE  
VIETNAM

18 Jan 66

AHQ (C)

COMMANDERS DIARY 161 RECONNAISSANCE FLIGHT

Attached is the Commanders Diary in respect of the above unit for the period 1 Dec to 31 Dec 65.

*Preneur*  
Brig <sup>C401</sup>  
10R Comd

① DMT

② DMO & P (LAW).



SD (co - ord)

*Entered in Report Book  
2/1/66*

SECRET

ORIGINAL+  
DUPLICATE+  
TRIPLICATE+

SECRET

Instructions for compiling this Commander's Diary  
are printed inside this cover. They will be  
strictly observed by all responsible for compiling  
these Diaries.

COMMANDER'S DIARY  
OF

..... 161 RECCE FLIGHT .....

(Unit or Formation)

Name of Commanding Officer: Maj. P. D. LIPSCOMBE .....

From... 1 Dec 65 ..... to... 31 Dec 65 .....

Signature of OC unit or senior staff officer

..... Maj. P. D. Lipscombe

INDEX

OC 161 RECCE FLT  
14 JAN 1966

Narrative (AF C2118)

Annexes	Enclosure Numbers
*A Duty Officer's Log	.....to.....
*B Messages connected with log	.....to.....
C Operation orders and instructions issued	.....to.....
D Operation orders and instructions received	Opo 2111.30 Nov to Opo. 18/65
*E Sitreps issued	65(A/82 Avn Co) to.....
F Orders of battle and location reports issued	.....to.....
G Intelligence reports and summaries issued, appreciations made	.....to.....
H Administrative orders and instructions issued	.....to.....
J Administrative orders and instructions received	.....to.....
*K Administrative reports and bulletins; ammunition returns; field strength returns	.....to.....
L Standing Orders issued	.....to.....
M Commander's policy and demi-Official letters	.....to.....
N Action reports (if required)	.....to.....
O Other papers eg, maps and diagrams, air photos, reports from sub units	.....1.....to.....2.....
P Periodical summaries of operations	.....to.....
Z Top Secret Supplementary Report	{ NIL+ RETAINED+ DESPATCHED to ..... on.....(date)
Q. Flying Statistics 28 Sep 65 to 18 Dec 65.	
R. RAAF Non-Operational Statistical Summary (Nov 65)	
S. Special Occurrence Report 5 Dec 65.	

\* Only to be included during operations. +Cross out whichever is not applicable.

SECRET

# WAR DIARY or INTELLIGENCE SUMMARY.

Army Form C.2118.  
(Adapted.)

(Erase heading not required.)

Unit 161 Recce Flt Date and Time.—From 1 Dec 65 To 12 Dec 65

Place.	Date.	Hour.	Summary of Events and Information.	Remarks and references to Appendices, Diaries, &c.
VO DAT	1 Dec 65	1100	Helicopter A1-395 returned to BIEN HOA for servicing.	
	3 Dec 65		A1-395 return to VO DAT - total str 2 CESSNAS, 2 SIOUX.	
	4 Dec 65		FW and RW tasks in sp 173 Bde.	
	5 Dec 65		FW and RW tasks in sp 173 Bde.	
		1600	A1-394 engine U/S.	
	6 Dec 65	1000	A1-394 back loaded to BIEN HOA by C130.	
			FW and RW tasks VO DAT	
	7 Dec 65		"	
	8 Dec 65		"	
	9 Dec 65		"	
	10 Dec 65		"	
	11 Dec 65		A1-395 had birdstrike - hole in canopy.	
	12 Dec 65		Canopy repaired; FW and RW tasks.	

SECRET

SECRET

# WAR DIARY or INTELLIGENCE SUMMARY

(Erase heading not required)

Army Form C.2118  
(Adapted)

D.4661/7.45-C.6546

Unit 161 Recce Flt

Date and Time.— From 13 Dec 65

To 20 Dec 65

Place	Date	Hour	Summary of Events and Information	Remarks and References to Appendices, Diaries, &c.
VO DAT	13 Dec 65		FW and RW tasks.	
		1300	Capt B J SMITH began check-out on UH-ID.	
	14 Dec 65		FW and RW tasks.	
	15 Dec 65		"	
	16 Dec 65	1100	CESSNAS and road party departed for BIEN HOA.	
		1000	SIOUX departed.	
		1530	All aircraft and Flt personnel at BIEN HOA.	
	17 Dec 65		RW tasks in sp 1 RAR.	
			FW tasks in sp HQ AAFV.	
	18 Dec 65	1030	Pte P VINEY evacuated to 173 CCS with fever of unknown origin.	
	19 Dec 65		RW tasks in sp 173 Bde.	
	20 Dec 65		RW tasks in sp 173 Bde.	

SECRET

SECRET

# WAR DIARY or INTELLIGENCE SUMMARY.

Army Form C.2118.  
(Adapted.)

(Erase heading not required.)

Unit 161 Recce Flt Date and Time.—From 21 Dec 65 To 31 Dec 65

Place.	Date.	Hour.	Summary of Events and Information.	Remarks and references to Appendices, Diaries, &c.
BIEN HOA	21 Dec 65		RW tasks in sp 173 Bde.	
	22 Dec 65		"	
	23 Dec 65		"	
	24 Dec 65		Camp adm.	
	25 Dec 65		Christmas Day celebrations!	
	26 Dec 65		Camp adm.	
	27 Dec 65		RW task 2 Bn 503 Inf.	
	28 Dec 65		RW tasks 2 Bn 503 Inf, FW task 105 Fd Bty.	
	29 Dec 65		RW tasks 173 Bde.	
	30 Dec 65		RW tasks 173 Bde.	
	31 Dec 65		RW tasks 173 Bde.	
			11509 Capt B J SMITH flying UH-ID with A/82 Avn Coy during current operation.	

(11)

SECRET

1 Dec 65 - 21 Dec 65

COPY NO

6

A/82ND AVN CO

173D ABN BDE (SEP)

211130 NOV 65

MAT

## TASK ORGANIZATION:

1st Platoon	2nd Platoon
3rd Platoon	173d Platoon (-)
161 Recce Flt (-)	Service Platoon (-)
166th TC Det (-)	Co Hqs (-)
	Opns Section
	Mess Section
	Supply

## Rear Detachment

Co Hqs (-)  
 Mess Section (-)  
 Supply (-)  
 166th TC (-)  
 Service Platoon (-)  
 173d Platoon (-)  
 Opns Section (-)  
 25th Med Detch

## 1. SITUATION:

A. Enemy: Annex B

B. Friendly Forces:

- (1) 173d Abn Bde (Sep)
- (2) ARVN Forces will conduct coordinated operation adjacent to 173d Abn Bde.
- (3) 145th Avn Bn (Reinf) provides helicopter support.
- (4) 2nd Air Div (USAF) provides airlift for movement of forces to obj area and provides tactical air support during conduct of operation.
- (5) 2nd Bde, 1st Inf Div, assumes responsibility of defense of Bien Hoa A/B effective 220800 Nov 65.

C. Attachments &amp; Detachments: Task Organ

2. MISSION: A/82 (-) provides helicopter support as directed, to the 173d Abn Bde (Sep).

## 3. EXECUTION:

A. A/82 (-) provides helicopter support to elements 173d Abn Bde (Reinf) for movement to VO DAT. Movement will be executed in four phases. Of these four phases A/82nd is involved in phases I, III, &amp; IV.

(1) Phase I-Movement of TF Foxtrot (2/503), TF Alpha (1/RAR) and TF Echo (1/503), in that order, by helicopter, on 21 Nov 65 to VO DAT. Upon securing airfield, Arty, Cav, and C&C elements will be airlanded.

(2) Phase II-Expansion of VODAT airhead.

(3) Phase III-Movement of T/F Bravo (1/26th Inf) from PV to BH by helicopter and T/F Delta (1/26th Inf) from PV to BH by convoy on 22 Nov 65.

(4) Phase IV-Movement of TF Delta from BH to Gia Ray by convoy and TF Bravo accompanied by combat support and combat service support elements from BH to VO DAT on 23 Nov 65.

MAT



MAT

B. 1st Platoon:

- (1) Provide specified flight crews for air movement of 173d Abn Bde on 21 and 22 Nov 65.
- (2) Provide one flight crew to Bde forward CP at VO DAT on order on 21 Nov 65.
- (3) Be prepared to displace platoon (-) to Vo Dat on 24 Nov 65.

C. 2nd Platoon:

- (1) Provide specified flight crews for air movement of 173d Abn Bde on 21 and 22 Nov 65.
- (2) Be prepared to displace platoon (-) to Vo Dat on 24 Nov 65.

D. 3rd Platoon:

- (1) Provide specified gun crews for escort helicopter on 21 and 22 Nov 65.
- (2) Displace one LFT to Vo Dat on 21 Nov 65.
- (3) Be prepared to displace platoon (-) to Vo Dat on 24 Nov 65.

E. 161st Recce Flight: (-):

- (1) Be prepared to displace air element to Vo Dat on 24 Nov 65.
- (2) Displace ground element with A/82 ground element on 23 Nov 65.

F. 173d Aviation Platoon (-):

- (1) Be prepared to displace to Vo Dat on 24 Nov 65.
- (2) Platoon (-) continue present mission.

G. Service Platoon (-):

- (1) Provide limited 2d echelon maintenance capability at Vo Dat.
- (2) Be prepared to displace forward ground element to Vo Dat on 23 Nov 65.
- (3) Platoon (-) continue present mission at BH.
- (4) Provide cl III A and cl III support at Vo Dat. Be prepared to handle 10,000 gals daily.

H. 166th TC Detch (-):

- (1) Provide limited 3d echelon support at Vo Dat.
- (2) Detchment (-) continue present mission.

I. Co Hqs (-)

(1) Operations section:

- a. Provide flight following capability in Bde TACR.
- b. Provide necessary maps for Bde TACR.
- c. Displace ground element to Vo Dat on 23 Nov 65.
- d. Be prepared to displace by helicopter to Vo Dat on 24 Nov 65.

(2) Mess Section:

- a. Provide 2 cooks with necessary equipment to provide A rations.
- b. Coordinate with service plat Cmdr for space on vehicles for equipment and personnel.

J. Rear Detachment:

- (1) Provide necessary administrative and logistical support to Company elements located at Vo Dat.
- (2) Continue present mission.

MAT

MAT

K. Coordinating Instructions:

(1) Flight following grid will be annotated on individual maps as soon as practicable.

(2) Service Platoon leader will coordinate with Support Battalion for movement of vehicles.

(3) C.O. 161 Recce Flight coordinate with Service Platoon leader for cl III A and movement of vehicles.

(4) The following points of origin are effective on dates indicated:

202000H to 212000H Nov 65	7234=tree;7133=bird
212000H to 222000H Nov 65	7432=river;7232=fruit
222000H to 232000H Nov 65	7430=boy;7528=state; 7224=ocean;7122=car, 7323=dog
232000H to 242000H Nov 65	7125=Girl;7423=Flower;7227=Sport;7020=Bridge 6721=Gun
242000H to 252000H Nov 65	6413=City;6515=Color;6414=Country;6613=fish 6516=Measurement

(5) The following numerical challenges and passes will be used in the operational area only on dates indicated:

<u>Eff Date/Time</u>	<u>Challenge</u>	<u>Password</u>
201800H to 211800H Nov 65	6	9
211800H to 221800H Nov 65	8	3
221800H to 231800H Nov 65	9	2
231800H to 241800H Nov 65	5	8
241800H to 251800H Nov 65	9	7

4. Administration and Logistics: TBP

5. Command and Signal:

a. Current SOI in effect

b. Co C.P. will be established at Vo Dat upon arrival of air element.

ACKNOWLEDGE:

CHAMPLIN  
Maj

OFFICIAL:

*Nelson*  
NELSIN  
Opns

MAT

DISTRIBUTION:

- 1st Platoon
- 2nd Platoon
- 3rd Platoon
- 173d Avn Platoon
- 161 Recce Flight
- Ser Platoon
- 166th TC Det

SECRET

Annex 'D' to Comds Diary  
1 Dec 65 - 31 Dec 65

Copy No.

49

161 Receiver

1 RAR  
BIEN HOA  
29 Dec 65

Ops 59

Maps: 6242/1, 4. 6243/1, 2, 3, 4. 6244/2, 3. 6342/4. 6343/3, 4. 6344/3.

OpO 18/65.

1. Situation.

a. Enemy Forces. See Annex A.

b. Own Forces.

(1) 173 Bde with under comd addl medium arty sp to conduct search and destroy ops in area DUC HOA (5996), BAO TRAI (5304) and SE to SONG DONG (5096) and WEST of SONG DONG .

(2) Bde less Fwd LOC and 319 Arty Bn (-) to be airlifted BAO TRAI .

(3) Fwd LOC and 319 Arty Bn (-) moves by rd to BAO TRAI .

(4) 1RAR, 1/503, 2/503 airlifted to op areas .

(5) USAF provides air cover throughout.

c. Atts and dets .

(1) Remaining under comd FAC Team USAF

(2) Under comd from 1700 hrs 31 Dec. RRU Team

(3) det to comd 3/319 Arty Bn from 1700 hrs 31 Dec . 105 Bty RAA less four FO teams

(4) det to comd 173 Engr Coy from 0600 hrs 1 Jan . Plant 3 Field Tp RAE.

(5) det to comd 173 Bde from 0600 hrs 1 Jan until release. 1 APC Tp (PWLH)

2. Mission. To locate and destroy 506 LF Bn within TAOR 18/65 from 1 Jan 66 to 14 Jan 66 .

3. Execution

a. Gen Outline.

(1) Overlay Annex P (issued)

(2) Op conducted in five phases.

(a) Phase 1. Move to op base.

i. Rd move to SNAKE PIT .

ii. Airlift to BAO TRAI (RUBBER STAMP).

(b) Phase 2. Airlift from BAO TRAI (RUBBER STAMP) and to LZ SCOTCH (altn GIN) estb Bn Base for nights D/D+1 and D+1/D+2.

.../2.

(c) Phase 3

SECRET

SECRET

-2-

- (c) Phase 3. Patrolling allotted sectors.
- (d) Phase 4. Repositioning of Bn bases by hel and allocation of new TAOR. NOT before D+5.
- (e) Phase 5. Extraction to BIEN HOA.

b. A Coy.

(1) Grouping.

- (a) Remaining under comd. Med Asst
- (b) Under comd from 1700 hrs 31 Dec. four SBs  
FO Party 161  
Field Bty

(2) Tasks.

- (a) Phase 1. Last in order of mov.
- (b) Phase 2.
  - i. Last in order of mov.
  - ii. Bn Reserve.
  - iii. Harbour to NORTH in Bn Base at LZ SCOTCH.

c. B Coy.

(1) Grouping.

- (a) Remaining under comd MFC  
Med Asst  
Interpreter (ARVN)
- (b) Under comd from 1700 hrs 31 Dec. Four SBs  
FO Party 105  
Field Bty.

(2) Tasks.

- (a) Phase 1. 3rd coy in order of mov after Bn HQ Gp.
- (b) Phase 2.
  - i. 3rd coy in order of mov after Bn HQ Gp.
  - ii. Harbour to EAST in Bn Base at LZ SCOTCH.
- (c) Phase 3.
  - i. D+1. Patrol sector 3 return to base.
  - ii. D+2. Patrol sector 7.
  - .../3. D+3 Patrol sector 9

SECRET

iii. D+3. Patrol sector 9; complete search of RIVER BANK by 1200 hrs.

d. C Coy.

(1) Grouping.

- |     |                                  |   |
|-----|----------------------------------|---|
| (a) | Remaining under comd             | MFC<br>Med Asst   |
| (b) | Under comd from 1700 hrs 31 Dec. | Four SBs<br>FO Party 105<br>Field Bty.<br>Interpreter<br>(1RAR) |

(2) Tasks.

- (a) Phase 1. 1st coy in order of move.
- (b) Phase 2.
- i. Assault Coy onto LZ SCOTCH.
  - ii. Harbour to WEST in Bn Base.

(c) Phase 3.

- i. D+1. Patrol sector 1.
- ii. D+2. Patrol sector 5.
- iii. D+3. Patrol sector 8; complete search of RIVER BANK by 1200 hrs.

e. D Coy.

(1) Grouping.

- |     |                                  |  |
|-----|----------------------------------|--|
| (a) | Remaining under comd.            | Med A sst  |
| (b) | Under comd from 1700 hrs 31 Dec. | MFC<br>Four SBs<br>FO Party 105<br>Field Bty.<br>Interpreter<br>(1RAR) |

(2) Tasks.

- (a) Phase 1. 2nd Coy in order of mov.
- (b) Phase 2.
- i. 2nd Coy in assault
  - ii. Harbour SOUTH in Bn Base.
- (c) Phase 3.
- i. D+1. Patrol sector 2.
  - ii. D+2. Patrol sector 6.
  - .../4. iii. D+3. Patrol

iii. D+3. Patrol sector 10, complete search of RIVE R BANK by 1200 hrs.

f. Mor Pl.

(1) Grouping.

- (a) One sect with Bn HQ Gp.
- (b) One sect with 1 APC Tp PWLH.
- (c) One sect remains BIEN HOA.
- (d) MFCs to B, C and D Coys.

(2) Tasks.

- (a) Moves with Bn HQ Gp less APC sect.
- (b) Provide fire sp throughout op.

(c) Ammo.

- i. Carried by pl (-) 26 rds HE  
4 rds WP.
- ii. Carried by APC 120 rds HE  
20 rds WP  
10 rds illg

iii. First line to be carried by mor veh with fwd LOC.

g. Aslt Pnr Pl.

(1) Grouping.

- (a) Phase 1. Moves with Bn HQ Gp.
- (b) Phase 2. Remains BAU TRAI. Moves fwd with 1 APC Tp PWLH on D+1.

(2) Tasks.

- (a) Protection Bn HQ.
- (b) Carry sufficient explosives for immediate tunnel dmIs.
- (c) Carry tear gas (10 grenades) and 4 masks.
- (d) Two ZODIAC aslt craft with Fwd LOC.
- (e) One flame unit prepared with Fwd LOC.

h. Anti Tank Pl.

- (1) Provide protection Bn HQ Gp.
- (2) Carry M72 on scale 3 rds per sect.

.../5.

j. 1 APC Tp PWLH

- j. 1 APC Tp PWLH.
- (1) Grouping. Under comd 173 Bde until revert to comd 1 RAR (possibly on D+1).
  - (2) Tasks.
    - (a) Provide tactical tpt and fire power throughout op.
    - (b) Be prepared to effect RIVER reconnaissance.
- k. 105 Field Bty.
- (1) Grouping.
    - (a) FO party to each rifle coy.
    - (b) BC party with Bn HQ.
    - (c) IO with 3/319 Arty Bn.
  - (2) Tasks.
    - (a) Fire sp throughout op.
    - (b) Fire Plan Annex C (to follow).
- l. 3 Field Tp.
- (1) Grouping.
    - (a) Aslt Engrs with Bn HQ Gp.
    - (b) Limited plant with 173 Engr Coy.
    - (c) Remainder effect projects op base BIEN HOA under direction 2IC 1RAR.
  - (2) Tasks.
    - (a) Provide engr assistance for tunnel, bunkers, booby trap clearance, destruction, and gas clearance.
    - (b) Protection Bn HQ Gp.
- m. Coord Instrs.
- (1) Order of mov phases 1 and 2.
    - C Coy
    - D Coy
    - Bn HQ Gp
    - B Coy
    - A Coy.
  - (2) Timings. Sequence of Events Annex B.
  - (3) Embussing. As for op 16/65 with new order of mov.

.../6. (4) Air Mov

(4) Air Mov.

(a) Emplaning details to follow.

(b) Unit DACO (2IC/UEO) responsible move from SNAKE PIT.

(c) Asst S3 responsible move from BAU TRAI.

(5) On arrival at assault LZ (SCOTCH or GIN) coys will assume same posture as for Bn Base.

(6) Rules of engagement. SOP.

(7) Reports. SOP

(8) Recognition. SOP

(9) Ammo. SOP. 2 each M72 per rifle sect or equivalent to be carried.

(10) Tear Smoke.

(a) Report codeword CRY BABY immediately following use.

(b) 2 grenades per sect to be carried.

(11) Coloured Smoke. SOP.

(12) Poaching. SOP.

(13) D Day. 1 Jan 66

(14) Air Sp. Air Sp on request throughout op. AGS Annex

(15) Marker Balloons. SOP.

4. Admin and Log.a. Rats.

(1) Breakfast present loc 1 Jan.

(2) 2 days rats carried. Expire after breakfast 3 Jan 66.

b. Water.

(1) SOP

(2) Local sources are to be used. Water is to be sterilized and filtered.

c. Resupply. SOPd. Batteries.

(1) AN-PRC 25 one spare bty.

(2) AN-PRC 10 two spare bty's

## e. VCC, en docus. SOP

## f. Casevat. SOP

.../7. 8. RAP be with



g. RAP. Loc with Bn HQ Gp

h. Clothing.

(1) Sect Kitbags. These are NOT only to include a spare set of clothing but also

(a) Spare pair boots per man.

(b) Spare pair socks per man placed inside the boot.

(2) Each man is to carry two spare pairs of socks in his pack.

5.

Comd and Sig.

a. Bn HQ. Located in area LZ SCOTCH on arrival. Further moves related to coy movement during op.

b. Signal.

(1) Radio.

(a) Codes: SOI 25 - 12, KAC Code HE 741, KAC - JJ Code 287 (numbers code and authentication) are in effect throughout operation.

(b) Equipment Allocation. Annex C attached.

(c) Radio nets: Annex D attached. Bn comd net is to open at 010730 hrs. Bn Adm log net from Bn HQ to open on estab of A Ech. Adm Log net (HF) is to open on estab of A Ech.

(d) Spare Equipment. One spare handset H33 and one antenna AT 271 per 10 set is to be issued.

(2) Line.

(a) Rifle Coys: 1 reel unit CE11 filled and 1 x tele are to be carried. Line is to be laid immediately on joining Bn Har posn.

(b) Bn HQ. SDP

(c) Sig Pl. 400 metres of D10 cable to be carried as reserve.

.../8

c. Nicknames

c. Nicknames.(1) Tac.

Serial	Nickname	Meaning	Issued by
(a)	(b)	(c)	(d)
1.	GUT RUMBLE	am moving, or move.	
2.	COW PAT	have reorg, have RV, or am in harbour or as executive command.	
3.	PACK SADDLE	Am ready to move, prepare to move.	
4.	RUBBER STAMP	BAU TRAI	
5.	WET SOCK	SONG DONG or ORIENTAL RIVER.	
6.	UNCLE TOM	CAMBODIA/CAMBODIANS.	
7.	BARNEY RUBBLE	ARVN/PF	
8.	CASTLE PEAK	Bn Harbour or Def Posn	
9.	PIRATE PLANK	River/Canal/Stream crossing Pt	
10.	BIG DIPPER	Possible APC Entrance/Exit on Waterways.	
11.	ARNHEM LAND	Area WEST of WET SOCK	

(2) Block Nicknames.

Serial	A Coy	B Coy	C Coy	D Coy	Bn HQ
(a)	(b)	(c)	(d)	(e)	(f)
1.	SQUARE LEG	BAR RAIL	OLD SALT	FLAT HEAD	LAST POST
2.	TENT PEG	THICK MALLET	LAMBS WOOL	SNAIL SHELL	YARD STICK
3.	PINE TENT	KEY RING	STEEL CLIP	DEAD FISH	KITCHEN SINK
4.	TORN PACE	STAB KICK	PEPPER TREE	STUMPY DOG	GUEST BED
5.	LIFE BELT	HEAVY SLAG	DIM LIGHT	TINY TOP	STRIP HEATER
6.	PAINT WORK	CAR BRAKE	HOT SLING	TABLE END	STALE FRUIT
7.	WATER BOY	DRY BED	SHORT CAKE	BRAIN STORM	PLASTIC DISH
8.	CURRY TIN	MEAL TICKET	ROW BOAT	SHARP POINT	HALF NIP
9.	LONG BOARD	SAND HEAP	HOT BRANDY	TRAFFIC LIGHT	WET DECK
10.	ROUND PIPE	DIRTY LOOK	GOLD TOOTH	ROUGH GLUE	MONEY BAGS

.../9.

d. Q Hr

- d. Q Hr. Q hr for the period of the operation is 1400 hrs
- e. Passwords. To be issued separately.
- f. Points of Origin.

Serial	Date/Time	Point of Origin
(a)	(b)	(c)
1.	300001 - 310001	FISH 3699, BOY 0752, STATE 9957
2.	310001 - 010001	CITY 0138, COLOUR 9344, GIRL 0456
3.	010001 - 020001	COUNTRY 9448, BOY 0052, CAR 0750
4.	020001 - 030001	FISH 0442, CITY 5093, COLOUR 0655
5.	030001 - 040001	COUNTRY 4001, CAR 5090, DOG 5008
6.	040001 - 050001	BOY 5410, CITY 6099, GIRL 4392

g. Synchronization.

- (1) Pre-operation By radio at 010745 hrs.
- (2) During op. Approx 0800 hrs daily.

Authentication.

*James Paul*  
Maj  
OC Sp Coy

A V PREECE, MVO  
CO 1 RAR

Annexes.

- A - Intelligence (Issued)
- B - Sequence of Events
- C - Equipment Allocation
- D - Radio Nets
- E - Fire Plan (To follow)
- F - Admin and Log (To follow)
- P - Op Overlay
- Q - AGS

SECRET

DISTRIBUTION

	<u>Copy Number incl Annexes</u>	<u>Annex F</u>
A Coy	1	1
B Coy	2	2
C Coy	3	3
D Coy	4	4
Sp Coy	5	5
Admin Coy	6-8	6-8
Mor Pl	9-10	-
Aslt Pnr Pl	11	-
Anti Tank Pl	12	-
Sig Pl	13	-
1 APC Tp PWLH	14	9
3 Field Tp RAE	15-16	10
105 Field Bty RAA	17-20	-
161 Field Bty RNZA	21-23	-
RRU	24	-
FAC USAF	25	-
173 AB Bde (Sep)	26-27	11
1/503	28	-
2/503	29	-
3/319	30	-
Bde Avn Offr	31	-
Bde ALO	32	-
CO	33	-
2IC	34	12
Oc Sp Coy	35	13
Adjt	36	-
Asst Adjt	37	14
IO	38	-
LO	39	-
RSM	40	-
Int Sect	41	15
AAFV	42	16
Comds Diary	43-45	17-19
File	46	20
Spare	47-50	21-23

SECRET

SECRET

Annex B to  
1RAR OpO 18/65 dated 29 Dec 65

SEQUENCE OF EVENTS

Serial	Time	Event
(a)	(b)	(c)
	<u>D-1</u>	
1.	310900 hrs	O Group
2.	311800 hrs	UEDs conference
	<u>D Day</u>	
3.	010810 hrs	SUEDs leave for SNAKE PIT
4.	010815 hrs	Coys at Embussing Pt
5.	010820 hrs	Loading commences
6.	010825 hrs	Depart for SNAKE PIT
7.	010850 hrs	Arrive SNAKE PIT
8.	010905 hrs	Prep to load on helis
9.	010915 hrs	1st Lift 1RAR
10.	011015 hrs	RAR lift complete BAO TRAI
11.	011515 hrs	} 15 minutes notice to move from BAO TRAI to LZ SCOTCH. } SUEDs to Asst S3 for breifing at BAO TRAI
12.	011535 hrs	Air Force preparation LZ SCOTCH.
13.	011600 hrs	1st elements 1RAR load LZ WHISKEY (BAO TRAI)
14.	011605 hrs	arty preparation LZ SCOTCH
15.	011615 hrs	H Hr 1 st elements 1RAR land SCOTCH.
	<u>D+1</u>	
16.	-	1 APC Tp PWLH follow up to SCOTCH.
17.	020730 hrs	Patrolling commences

SECRET

SECRET

Annex C to ~  
1RAR OpO 18/65 dated 29 Dec 65

EQUIPMENT ALLOCATION

Sub Unit	25set	10set	A510	Aerial RC 292
A Coy	4	2	-	-
B Coy	3	3	-	-
C Coy	3	3	-	-
D Coy	4	2	-	-
Mor Pl	5	-	-	-
Htk Pl	-	1	-	-
Pnr Pl	-	1	-	-
Sig Pl (fwd)	5	1	1	2
Sig Pl (rear)	1	-	2	1

Note:- The complete issue of AN-PRC 25 sets is dependant upon their arrival. A revised allocation is to be effected if this occurs.

SECRET

RADIO NETS

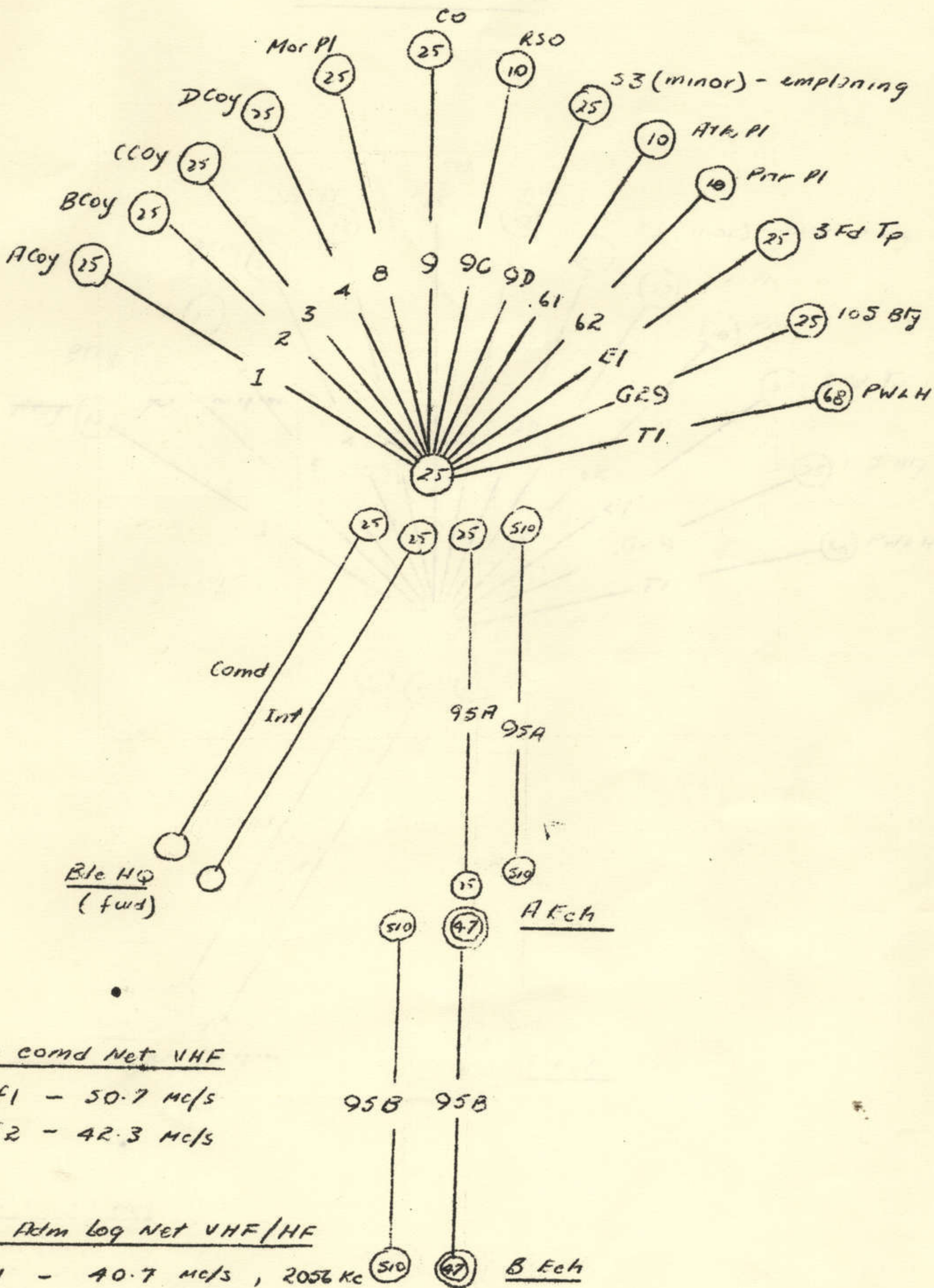

Bn comd Net VHF

f1 - 50.7 Mc/s  
f2 - 42.3 Mc/s

Bn Adm Log Net VHF/HF

f1 - 40.7 Mc/s, 2056 Kc  
f2 - 38.8 Mc/s, 3172 Mc/s

Auth: *ef* 29/12

# SECRET

Maps: PHU CUONG  
SAIGON  
DUC HOA  
CU CHI

1:50,000

Annex P to LRAR

OpC 18/65 dated

29 Dec 65

## OVERLAY BOUNDARIES, SECTORS

AIRPHOTOMOSAIC issued 28 December 65

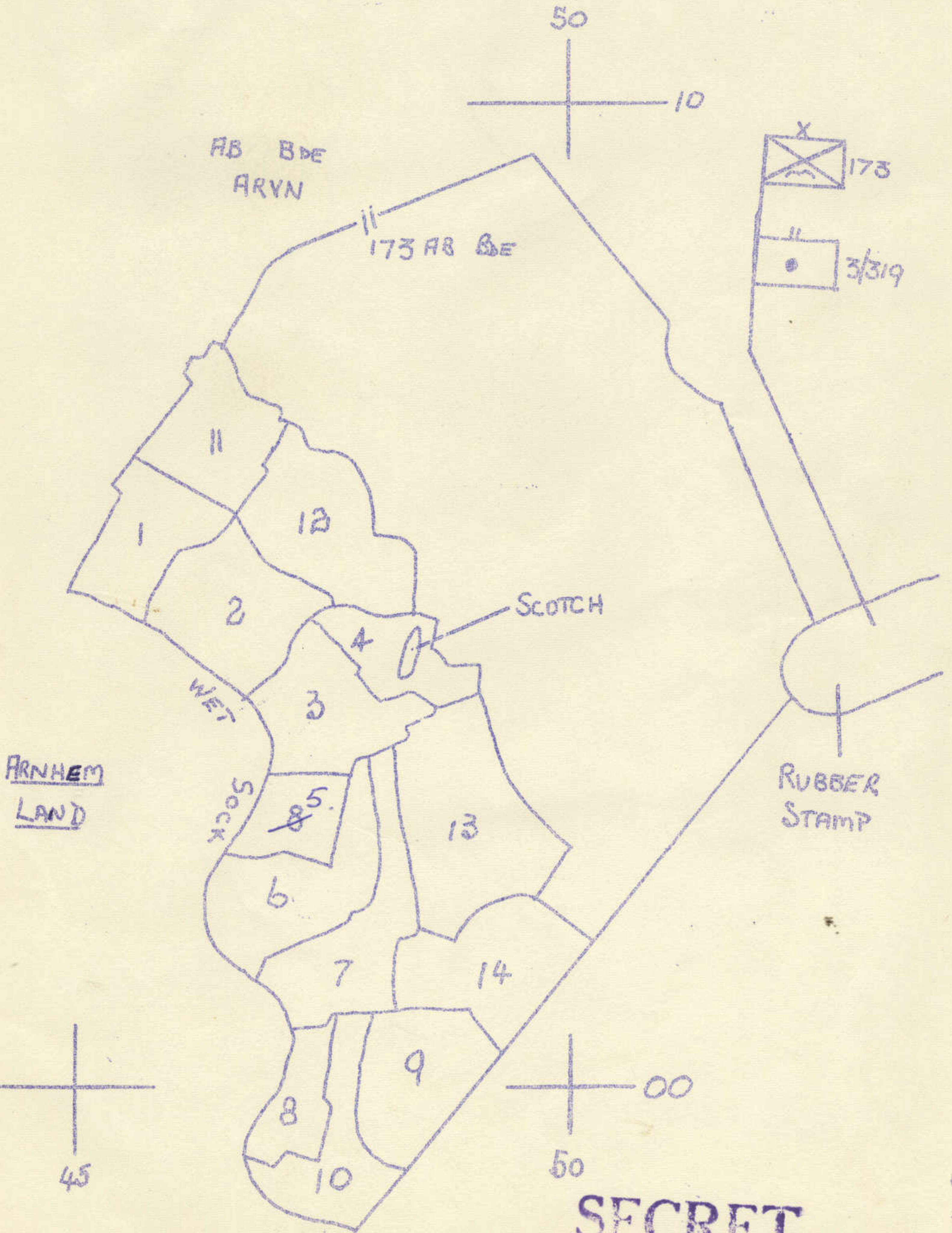



SECRET

Appendix 1 to  
Annex F to IRAR  
Op 18/65 dated  
29 Dec 65

OVERLAY FOR ALPHEO MOSAIC  
Issued 23 Dec 65

52

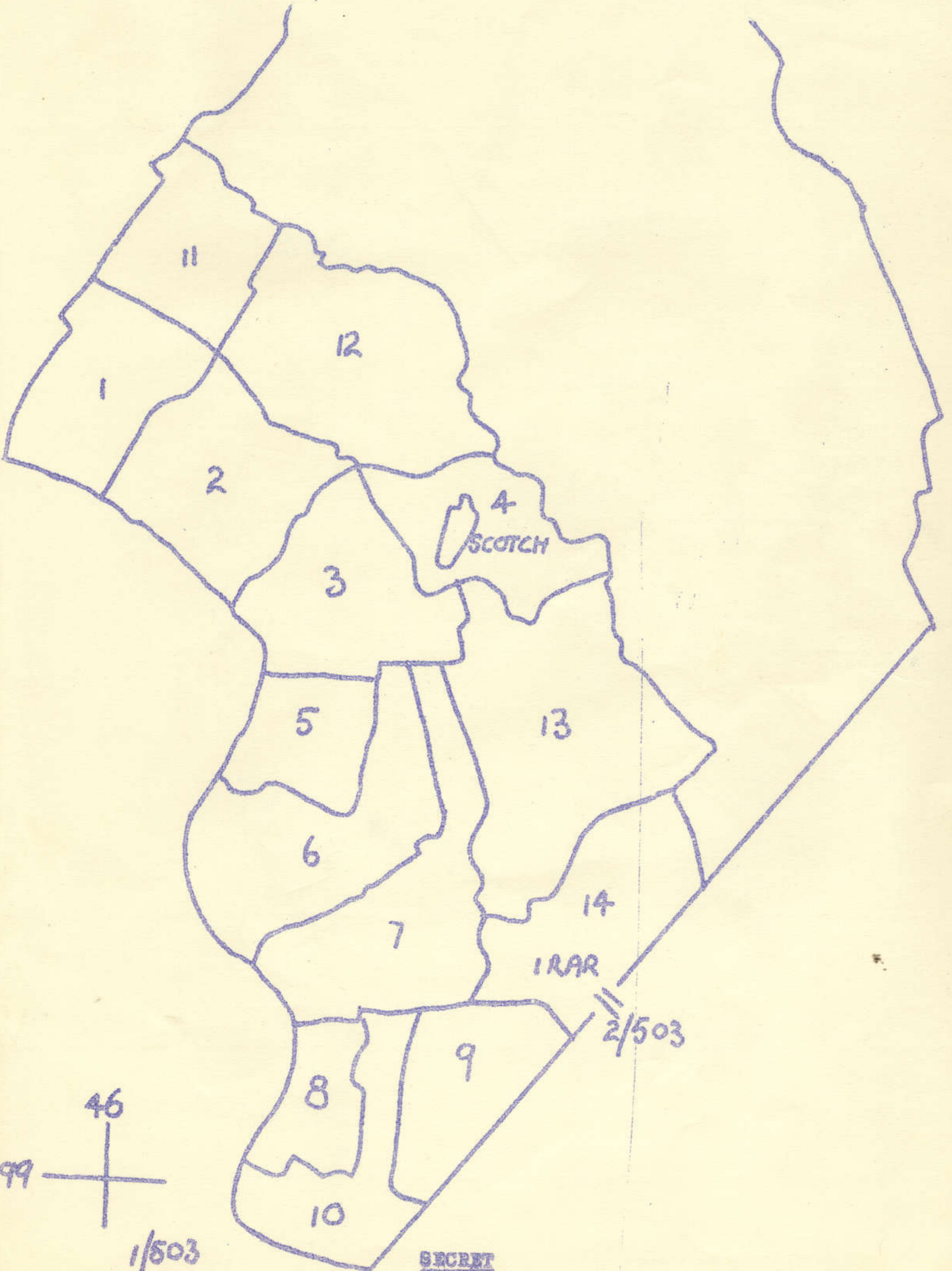

SECRET

Annex 9 to LPAR  
Opd 18/65 dated  
29 Dec 65

AIR GRID SYSTEM

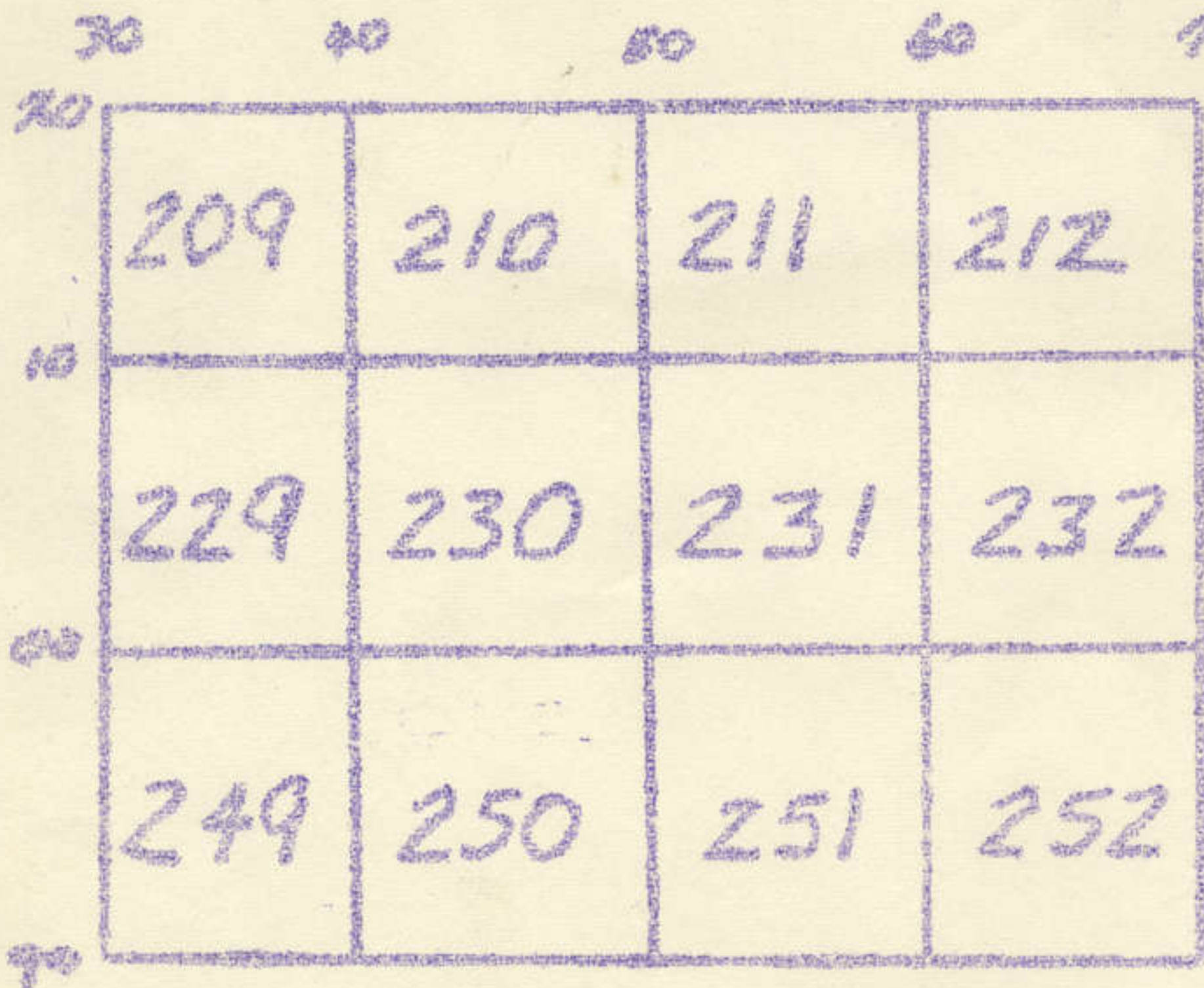
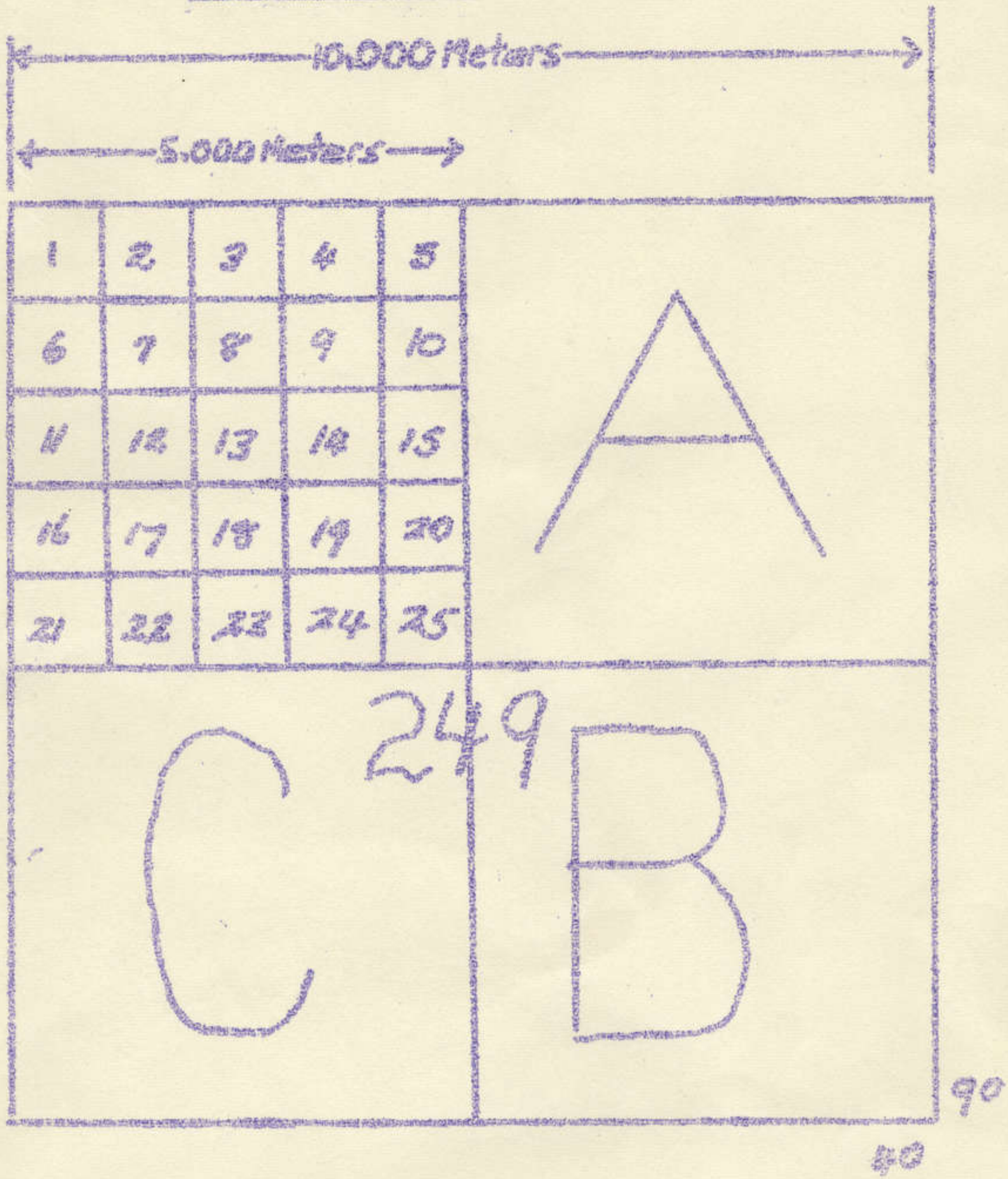

SECRET

49  
161 Reece

1 RAR  
BIEN HOA  
30 Dec 65

AMENDMENT NO 1 TO OPO 18/65 DATED 29 DEC 65.

1. The following are changes and additions to OpO 18/65.
2. Corrected Points of Origin

Serial (a)	Date/Time (b)	Point of Origin (c)
1.	312000H to 012000H	3699 FISH, 5207 BOY, 5799 STATE
2.	012000H to 022000H	3801 CITY, 4493 COLOUR, 5604 GIRL
3.	022000H to 032000H	4894 COUNTRY, 5200 BOY, 5007 CAR
4.	032000H to 042000H	4204 FISH, 5093 CITY, 5506 COLOUR
5.	042000H to 052000H	4001 COUNTRY, 5090 CAR, 5008 DOG
6.	052000H to 062000H	5410 BOY, 6099 CITY, 4392 GIRL

..... 3. Plan for occupation of LZ WHISKEY during staging is attached at Annex A.

4. Friendly Situation (ARVN Dispositions)

46 Regt HQ	XS 832730	50 Regt and HQ	XS 638757
1/46	XS 740759	1/50	XS 596973
2/46	XS 831726	2/50	XS 570880
3/46	XS 787670	3/50	XS 615757
4/46	XS 785000	4/50	XS 551656
49 Regt and HQ	XT 645118	2/10 Cav	XS 597965
		25 Recon Coy	XS 593958
		34 Ranger Bn	XS 596973
1/49	XT 486193	38 Ranger Bn	XT 529043
2/49	XT 629129	51 Ranger Bn	XT 412238
3/49	XT 522052		
4/49	XT 639122		

..... 5. Passwords are attached at Annex B.

..... 6. Amended Sequence of Events is attached at Annex C.

Distribution

As for OpO 18/65 Dated 29 Dec 65.

*James C. [Signature]*  
for Lt Col  
CO 1RAR

SECRET

STAGING AREA BAD TRAI PHASE 1

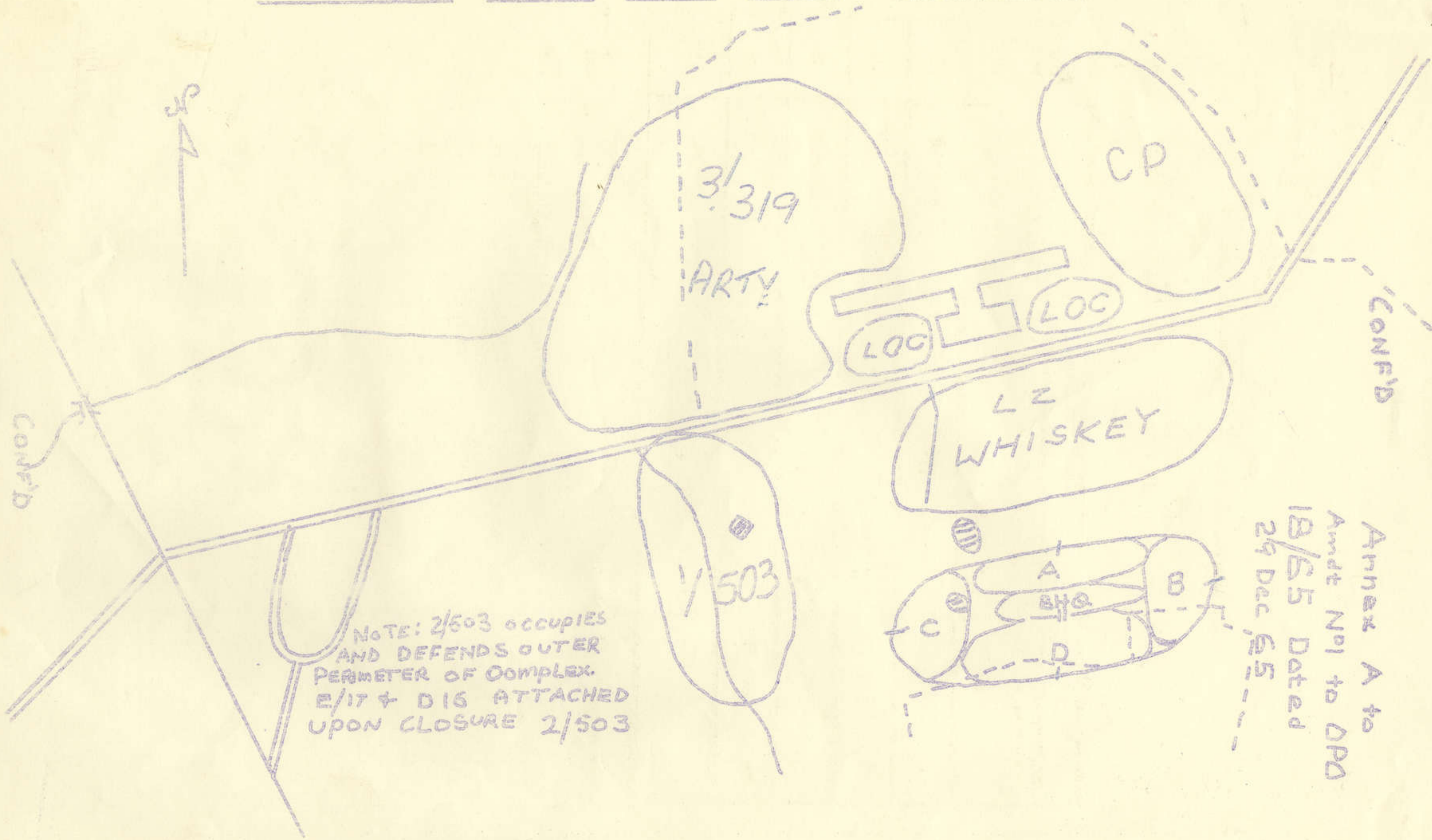

NOTE: 2/503 OCCUPIES AND DEFENDS OUTER PERIMETER OF COMPLEX. E/17 & D16 ATTACHED UPON CLOSURE 2/503

Annex A to  
Ampt No 1 to DPD  
18/65 Dated  
29 Dec 65

SECRET

Annex B to  
Amdt No 1 to OpO 18/65 Dated 29 Dec 65

CHALLENGES AND PASSWORDS

1. The following numerical Challenges and Passwords will be used in the operational area of operation KICKOFF only.

Serial	Date/Time	Challenge	Password
(a)	(b)	(c)	(d)
1.	311800 to 011800	3	9
2.	011800 to 021800	6	2
3.	021800 to 031800	4	1
4.	031800 to 041800	5	7
5.	041800 to 051800	8	3
6.	051800 to 061800	6	9
7.	061800 to 071800	5	2
8.	071800 to 081800	7	3
9.	081800 to 091800	4	8
10.	091800 to 101800	5	9
11.	101800 to 111800	3	7
12.	111800 to 121800	5	8
13.	121800 to 131800	1	5
14.	131800 to 141800	7	4
15.	141800 to 151800	9	6
16.	151800 to 161800	3	8
17.	161800 to 171800	5	2
18.	171800 to 181800	4	9
19.	181800 to 191800	6	8
20.	191800 to 201800	7	3

SECRET

SECRET

Annex C to  
Amdt No 1 to OpO 18/65 dated 29 Dec

SEQUENCE OF EVENTS

Serial	Time	Event
(a)	(b)	(c)
	<u>D-1</u>	
1.	310900 hrs	O Group
2.	311800 hrs	UED's conference
	<u>D Day</u>	
3.	010805 hrs	SUEDs leave for SNAKE PIT
4.	010810 hrs	Coys at embussing pt
5.	010815 hrs	Loading commences
6.	010820 hrs	Depart for SNAKE PIT
7.	010845 hrs	Arrive SNAKE PIT
8.	010905 hrs	Prep to load on helis
9.	010915 hrs	1st lift 1RAR
10.	011020 hrs	RAR Lift complete BAO TRAI
11.	011515 hrs	} 15 minutes notice to move from BAO to LZ SCOTCH. } SUEDs to Asst S3 for briefing at BAO TRAI.
12.	011535 hrs	Air Force preparation LZ SCOTCH
13.	011605 hrs	1st elements 1RAR load LZ WHISKEY (BAO TRAI)
14.	011605 hrs	Arty preparation LZ SCOTCH
15.	011620 hrs	X Hr 1st elements 1RAR land SCOTCH
16.	011650 hrs	RAR lift complete LZ SCOTCH
	<u>D+1</u>	
17.	-	1APC to PVLH follow up to SCOTCH.
18.	020730 hrs	Patrolling commences

SECRET

SECRET

1 RAR  
BIEN HOA  
30 Dec 65

Distribution:~  
As for OpO 18/65 dated 29 Dec 65

USE OF KAC - JJ CODE

1. Authentications: Only the challenge and reply authentication is to be used for challenging a station. The transmission authentication has NO meaning under present Bde procedures.
2. KAC - JJ Code: Insufficient security is provided for overnight locstats with the method of points of origin used at present. This code is to be used for overnight locstats or any locstat likely to remain unchanged for more than 4 hours. The code is purely a numbers code; use of the spelling facility is to be restricted to a minimum.

eg. A locstat message:

Clear. " Hello 2. CHQ 123456 (.) 21 124457 (.) 22 125258(.)  
23 121454(.) "

Code. " Hello 2 (.) NG DO EH YM TR LG LA AX DZ (.) KZ PU CK HX DW  
SJ PA (.) etc "

The following points are to be noted:

- a. Precede KAC - HE code with "Group Count". Do NOT use "Group Count" with KAC - JJ Code.
- b. With grid references use figures 0 - 9 incl and NOT double figures 10 - 99 incl.
- c. Use double figures 10 - 99 for callsigns or other uses where confusion cannot possibly occur.

*J. J. J.*  
Lt Col  
OO 1RAR

SECRET

Annex 'O' to Comds Diary  
1 Dec 65 to 31 Dec 65  
Number 1

1st PLAT \_\_\_\_\_  
2<sup>d</sup> PLAT \_\_\_\_\_  
161 Recce FW \_\_\_\_\_  
74<sup>th</sup> Arm PLAT \_\_\_\_\_

3<sup>d</sup> PLAT \_\_\_\_\_  
173<sup>d</sup> PLAT \_\_\_\_\_  
161 Recce RW \_\_\_\_\_

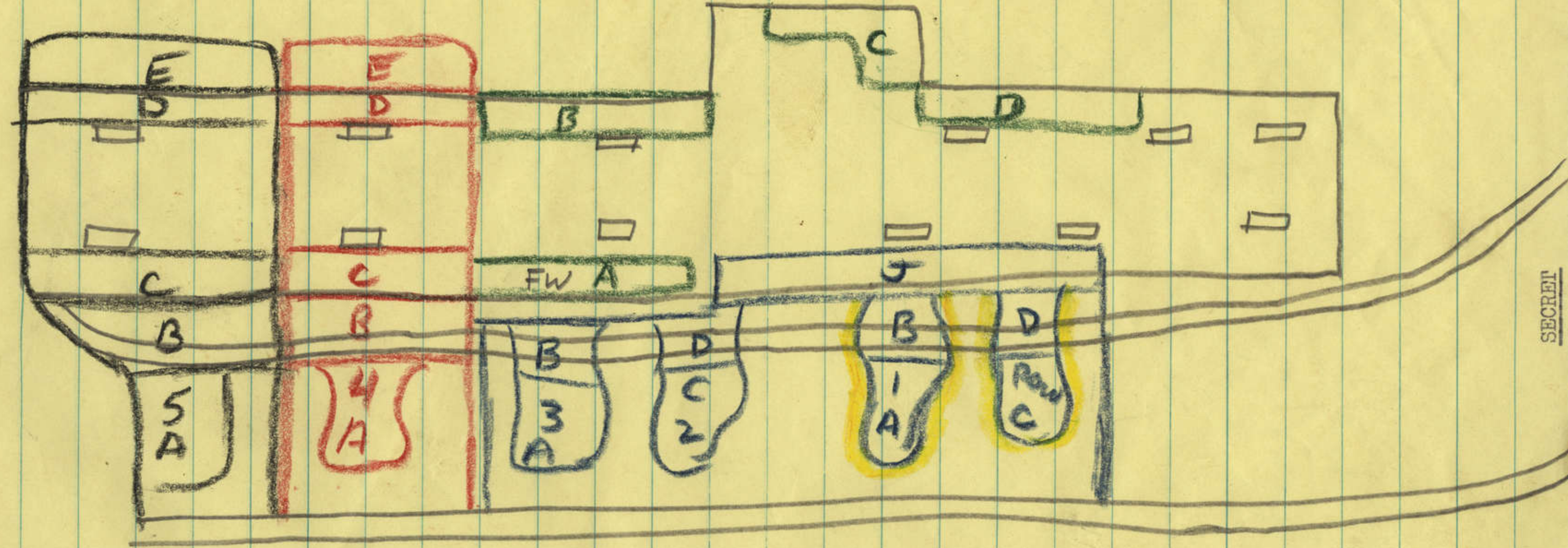

NIGHTLY DISPERSAL PLAN

SECRET

SECRET



LEGEND

- WIRE PIT
- TRAP FIXTURES
- ⊙ LATRINES
- ⊗ TENTS SPECTERS
- NOT STRICTLY TO SCALE; VERTICAL (PRIMED) LINES REPRESENT RUBBER TREE LINES

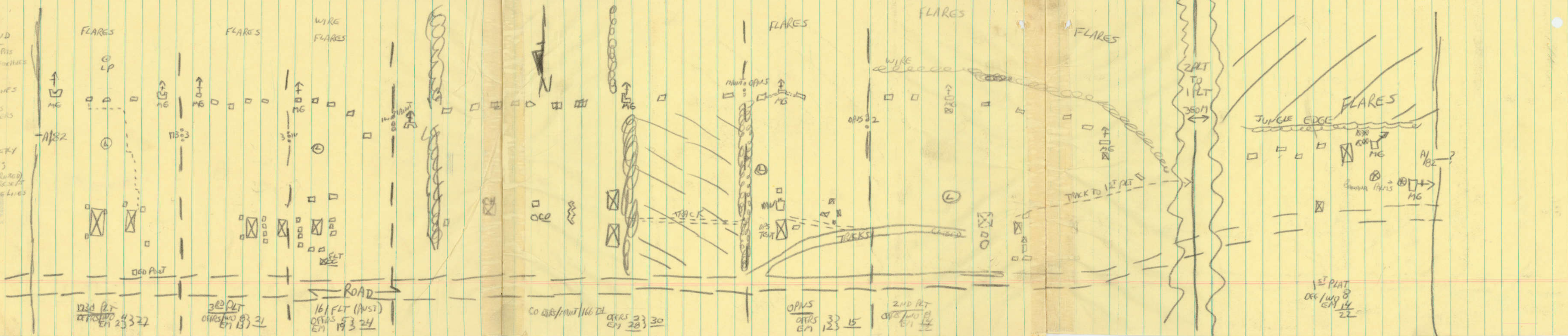

Addendum 1 (Additional Information) to Annex B (Enemy Composition and Disposition -OB) to Intelligence Estimate, Hau Nghia Province.

1. The information that is contained in this Addendum was obtained on 26 December and appropriate changes to the data contained in the Intelligence Estimate should be made.

2. The following locations have been reported as probable VC base areas; XS 475995, XS 491987, XT 411142 and XS 558925. (The above coordinates are given as centers of areas extending in a 500 to 1000 meter radius.)

3. The following VC Local Force Companies are reported to be operating in the following districts:

<u>DISTRICT</u>	<u>UNIT</u>	<u>LOCATION</u>	<u>DATE</u>
Cu Chi	C 26	Unknown	N/A
Duc Hue	C 120	Unknown	N/A
Duc Hoa	C 2	XT 575036	25/12/65
Trang Bang	C 54	XT 482221	16/12/65

4. The following Main Force Battalions were reportedly located as follows:

267th Bn of Dong Thap II - XT 411141 - 25/12/65, and 506th Bn XT 542114 - 25/12/65.

5. Changes in OB:

a. The existence of the Tuo Do Regiment is extremely doubtful.

b. Forces most likely to be encountered in the TAOR are:

(1) Dong Thap II Regiment

(a) 267 Bn

(b) 269 Bn

(2) 506th Battalion

(3) 2nd Independent Battalion

(4) Quiet Thang Battalion (306th)

(5) Local District Companies:

(a) C 26

(b) C 120

(c) C 2

(d) C 54

(6) Plus local village and hamlet guerrilla forces.

c. Recent Activities:

(1) The most recent significant activity in the area of interest took place on the night of 17 and 18 Dec 1965. The VC simultaneously placed mortar fire on artillery positions at Duc Hoa (XS 593968), My Hanh (XT 630026), Bao Trai (XT 527047), and attacked outposts at My Hanh (XT 630026), and Duc Lap (XT 552061). It is believed that elements of the 2nd Independent Battalion, took part in the attack on the outposts; and that the weapons elements of the 267th Battalion, 506 Battalion, and C.2 Local Company, placed mortar fire on the artillery positions.

(2) On 161010 Dec 65 at XT 398144 the VC ambushed an ARVN company with the following results: 50 KIA, approximately 30 WIA. The ARVN lost a number of small arms, 1 60mm mortar and 10 PRC/10 radios to the VC. This ambush

CONFIDENTIAL

Addendum 1 (Additional Information) to Annex B (Enemy Composition and Disposition -OB) to Intelligence Estimate, Hau Nghia Province.

was probably executed by the Quyet Thang Battalion, (306th) previously reported.

(3) On 22 Dec 65 two small ambushes were set up at XT 561060 during daylight hours. Results: 3 National Police KIA.

d. Miscellaneous Information:

(1) The area immediately adjacent and East of the Song Vam Co Dong (XT 4703 to XS 4997) is reported to be heavily booby-trapped and to have numerous bunkers with overhead cover.

(2) Curfews in effect in the area of interest:

(a) Villagages and Towns: 2200-0500.

(b) Countryside: 1900-0500.

(c) River Traffic (Song Vam Co Dong): Darkness to daybreak, except from coordinates XT 460044 - XT 427080. The area between these two points does not have a curfew on river traffic. There is a sugar refinery located at Ap Tan Hoa (XT 439054) and the workers are allowed to transport sugar cane to the refinery during the hours of darkness. Therefore this stretch of the river is not a specified strike zone (unless one is fired upon).

(3) Specified Strike Zone - The entire area West of the Oriental River except immediately West of the Sugar Refinery where there is a small PF element located (AT 438053).

*Marshall*

MARSHALL  
C2

CONFIDENTIAL

19/12/65

CONFIDENTIAL

Addendum 1 (Additional Information) to Annex B (Enemy Composition and Disposition -OB) to Intelligence Estimate, Hau Nghia Province.

1. The information that is contained in this Addendum was obtained on 26 December and appropriate changes to the data contained in the Intelligence Estimate should be made.

2. The following locations have been reported as probable VC base areas; XS 475995, XS 491987, XT 411142 and XS 558925. (The above coordinates are given as centers of areas extending in a 500 to 1000 meter radius.)

3. The following VC Local Force Companies are reported to be operating in the following districts:

<u>DISTRICT</u>	<u>UNIT</u>	<u>LOCATION</u>	<u>DATE</u>
Cu Chi	C 26	Unknown	N/A
Duc Hue	C 120	Unknown	N/A
Duc Hoa	C 2	XT 575036	25/12/65
Trang Bang	C 54	XT 482221	16/12/65

4. The following Main Force Battalions were reportedly located as follows:

267th Bn of Dong Thap II - XT 411141 - 25/12/65, and 506th Bn XT 542114 - 25/12/65.

5. Changes in OB:

a. The existence of the Tuo Do Regiment is extremely doubtful.

b. Forces most likely to be encountered in the TAOR are:

(1) Dong Thap II Regiment

(a) 267 Bn

(b) 269 Bn

(2) 506th Battalion

(3) 2nd Independent Battalion

(4) Quyet Thang Battalion (306th)

(5) Local District Companies:

(a) C 26

(b) C 120

(c) C 2

(d) C 54

(6) Plus local village and hamlet guerrilla forces.

c. Recent Activities:

(1) The most recent significant activity in the area of interest took place on the night of 17 and 18 Dec 1965. The VC simultaneously placed mortar fire on artillery positions at Duc Hoa (XS 593968), My Hanh (XT 630026), Bao Trai (XT 527047), and attacked outposts at My Hanh (XT 630026), and Duc Lap (XT 552061). It is believed that elements of the 2nd Independent Battalion, took part in the attack on the outposts; and that the weapons elements of the 267th Battalion, 506 Battalion, and C.2 Local Company, placed mortar fire on the artillery positions.

(2) On 161010 Dec 65 at XT 398144 the VC ambushed an ARVN company with the following results: 50 KIA, approximately 30 WIA. The ARVN lost a number of small arms, 1 60mm mortar and 10 PRC/10 radios to the VC. This ambush

CONFIDENTIAL

CONFIDENTIAL

Addendum 1 (Additional Information) to Annex B (Enemy Composition and Disposition -OB) to Intelligence Estimate, Hau Nghia Province.

was probably executed by the Quyét Thang Battalion, (306th) previously reported.

(3) On 22 Dec 65 two small ambushes were set up at XT 561060 during daylight hours. Results: 3 National Police KIA.

d. Miscellaneous Information:

(1) The area immediately adjacent and East of the Song Vam Co Dong (XT 4703 to XS 4997) is reported to be heavily booby-trapped and to have numerous bunkers with overhead cover.

(2) Curfews in effect in the area of interest:

(a) Villagages and Towns: 2200-0500.

(b) Countryside: 1900-0500.

(c) River Traffic (Song Vam Co Dong): Darkness to daybreak, except from coordinates XT 460044 - XT 427080. The area between these two points does not have a curfew on river traffic. There is a sugar refinery located at Ap Tan Hoa (XT 439054) and the workers are allowed to transport sugar cane to the refinery during the hours of darkness. Therefore this stretch of the river is not a specified strike zone (unless one is fired upon).

(3) Specified Strike Zone - The entire area West of the Oriental River except immediately West of the Sugar Refinery where there is a small PF element located (XT 438053).

*Marshall*  
MARSHALL  
C2

CONFIDENTIAL

CONFIDENTIAL

Addendum 1 (Additional Information) to Annex B (Enemy Composition and Disposition -OB) to Intelligence Estimate, Hau Nghia Province.

1. The information that is contained in this Addendum was obtained on 26 December and appropriate changes to the data contained in the Intelligence Estimate should be made.

2. The following locations have been reported as probable VC base areas; XS 475995, XS 491987, XT 411142 and XS 558925. (The above coordinates are given as centers of areas extending in a 500 to 1000 meter radius.)

3. The following VC Local Force Companies are reported to be operating in the following districts:

<u>DISTRICT</u>	<u>UNIT</u>	<u>LOCATION</u>	<u>DATE</u>
Cu Chi	C 26	Unknown	N/A
Duc Hue	C 120	Unknown	N/A
Duc Hoa	C 2	XT 575036	25/12/65
Trang Bang	C 54	XT 482221	16/12/65

4. The following Main Force Battalions were reportedly located as follows:

267th Bn of Dong Thap II - XT 411141 - 25/12/65, and 506th Bn XT 542114 - 25/12/65.

5. Changes in OB:

a. The existence of the Tuo Do Regiment is extremely doubtful.

b. Forces most likely to be encountered in the TAOR are:

(1) Dong Thap II Regiment

(a) 267 Bn

(b) 269 Bn

(2) 506th Battalion

(3) 2nd Independent Battalion

(4) Quyet Thang Battalion (306th)

(5) Local District Companies:

(a) C 26

(b) C 120

(c) C 2

(d) C 54

(6) Plus local village and hamlet guerrilla forces.

c. Recent Activities:

(1) The most recent significant activity in the area of interest took place on the night of 17 and 18 Dec 1965. The VC simultaneously placed mortar fire on artillery positions at Duc Hoa (XS 593968), My Hanh (XT 630026), Bao Trai (XT 527047), and attacked outposts at My Hanh (XT 630026), and Duc Lap (XT 552061). It is believed that elements of the 2nd Independent Battalion, took part in the attack on the outposts; and that the weapons elements of the 267th Battalion, 506 Battalion, and C.2 Local Company, placed mortar fire on the artillery positions.

(2) On 161010 Dec 65 at XT 398144 the VC ambushed an ARVN company with the following results: 50 KIA, approximately 30 WIA. The ARVN lost a number of small arms, 1 60mm mortar and 10 PRC/10 radios to the VC. This ambush

CONFIDENTIAL

CONFIDENTIAL

Addendum 1 (Additional Information) to Annex B (Enemy Composition and Disposition -OB) to Intelligence Estimate, Hau Nghia Province.

was probably executed by the Quyethang Battalion, (306th) previously reported.

(3) On 22 Dec 65 two small ambushes were set up at XT 561060 during daylight hours. Results: 3 National Police KIA.

d. Miscellaneous Information:

(1) The area immediately adjacent and East of the Song Vam Co Dong (XT 4703 to XS 4997) is reported to be heavily booby-trapped and to have numerous bunkers with overhead cover.

(2) Curfews in effect in the area of interest:

(a) Villages and Towns: 2200-0500.

(b) Countryside: 1900-0500.

(c) River Traffic (Song Vam Co Dong): Darkness to daybreak, except from coordinates XT 460044 - XT 427080. The area between these two points does not have a curfew on river traffic. There is a sugar refinery located at Ap Tan Hoa (XT 439054) and the workers are allowed to transport sugar cane to the refinery during the hours of darkness. Therefore this stretch of the river is not a specified strike zone (unless one is fired upon).

(3) Specified Strike Zone - The entire area West of the Oriental River except immediately West of the Sugar Refinery where there is a small PF element located (XT 438053).

*Marshall*  
MARSHALL  
C2

CONFIDENTIAL

CONFIDENTIAL

Annex B (Additional Information) to Annex B (Enemy Composition and Disposition -OB) to Intelligence Estimate, Hau Nghia Province.

1. The information that is contained in this Addendum was obtained on 26 December and appropriate changes to the data contained in the Intelligence Estimate should be made.

2. The following locations have been reported as probable VC base areas; XS 475995, XS 491987, XT 411142 and XS 558925. (The above coordinates are given as centers of areas extending in a 500 to 1000 meter radius.)

3. The following VC Local Force Companies are reported to be operating in the following districts:

<u>DISTRICT</u>	<u>UNIT</u>	<u>LOCATION</u>	<u>DATE</u>
Cu Chi	C 26	Unknown	N/A
Duc Hue	C 120	Unknown	N/A
Duc Hoa	C 2	XT 575036	25/12/65
Trang Bang	C 54	XT 482221	16/12/65

4. The following Main Force Battalions were reportedly located as follows:

267th Bn of Dong Thap II - XT 411141 - 25/12/65, and 506th Bn XT 542114 - 25/12/65.

5. Changes in OB:

a. The existence of the Tuo Do Regiment is extremely doubtful.

b. Forces most likely to be encountered in the TAOR are:

(1) Dong Thap II Regiment

(a) 267 Bn

(b) 269 Bn

(2) 506th Battalion

(3) 2nd Independent Battalion

(4) Quyet Thang Battalion (306th)

(5) Local District Companies:

(a) C 26

(b) C 120

(c) C 2

(d) C 54

(6) Plus local village and hamlet guerrilla forces.

c. Recent Activities:

(1) The most recent significant activity in the area of interest took place on the night of 17 and 18 Dec 1965. The VC simultaneously placed mortar fire on artillery positions at Duc Hoa (XS 593968), My Hanh (XT 630026), Bao Trai (XT 527047), and attacked outposts at My Hanh (XT 630026), and Duc Lap (XT 552061). It is believed that elements of the 2nd Independent Battalion, took part in the attack on the outposts; and that the weapons elements of the 267th Battalion, 506 Battalion, and C.2 Local Company, placed mortar fire on the artillery positions.

(2) On 161010 Dec 65 at XT 398144 the VC ambushed an ARVN company with the following results: 50 KIA, approximately 30 WIA. The ARVN lost a number of small arms, 1 60mm mortar and 10 PRC/10 radios to the VC. This ambush

CONFIDENTIAL



CONFIDENTIAL

Addendum 1 (Additional Information) to Annex B (Enemy Composition and Disposition -OB) to Intelligence Estimate, Hau Nghia Province.

was probably executed by the Quyét Thang Battalion, (306th) previously reported.

(3) On 22 Dec 65 two small ambushes were set up at XT 561060 during daylight hours. Results: 3 National Police KIA.

d. Miscellaneous Information:

(1) The area immediately adjacent and East of the Song Vam Co Dong (XT 4703 to XS 4997) is reported to be heavily booby-trapped and to have numerous bunkers with overhead cover.

(2) Curfews in effect in the area of interest:

(a) Villagages and Towns: 2200-0500.

(b) Countryside: 1900-0500.

(c) River Traffic (Song Vam Co Dong): Darkness to daybreak, except from coordinates XT 460044 - XT 427080. The area between these two points does not have a curfew on river traffic. There is a sugar refinery located at Ap Tan Hoa (XT 439054) and the workers are allowed to transport sugar cane to the refinery during the hours of darkness. Therefore this stretch of the river is not a specified strike zone (unless one is fired upon).

(3) Specified Strike Zone - The entire area West of the Oriental River except immediately West of the Sugar Refinery where there is a small PF element located (AT 438053).

*Marshall*

MARSHALL  
C2

CONFIDENTIAL

FLYING STATISTICS  
28 SEP 65 TO 18 DEC 65 (inclusive)

1.	SORTIES BY TYPE.	AOP	RESUP	RECCE	LIAISON	MISC
	a. FW	41		25	95	15
	b. RW	26	25	128	104	59
2.	TOTAL FLYING TIME.					
	a. FW -	256.15				
	b. RW -	258.15				
3.	AC FLYING HOURS. +	043	045	394	395	
	a. FW	148.30	99.20			
	b. RW			63.45	181.40	
4.	PILOT HOURS AND SORTIES	Hours		Sorties		
	a. FW					
	(1) Maj LIPSCOMBE	28.45		30		
	(2) Capt PINKHAM	72.50		59		
	(3) 2Lt COCKERELL	70.55		51		
	(4) 2Lt HPRIDGE	83.45		36		
	b. RW					
	(1) Capt SMITH	63.15*		112		
	(2) Lt GUILD	97.15		101		
	(3) Lt VON MUENCHHAUSEN	98.15		129		

+ These ac hours are not exact.

\* This does not include 6 hours flying in non unit ac.

# NON-OPERATIONAL STATISTICAL SUMMARY

(AFO 18/F/7A)

Form A 124, Jun 62

161 RECCE FLT

NOV 65

PART A — FLYING ACTIVITY — See reverse side for instructions on preparation and dispatch

Type and Mark of Aircraft	Av Dly Str	Complete Crews		Gals Fuel		Flying Activity						Flying by Non-Unit Crews in Unit Aircraft		Flying by Unit Crews in Non-Unit Aircraft		
		Effect	Non-Effect	Added	Removed	Type of Flying	Sorties			Hours			Sorties	Hours	Sorties	Hours
							Day	Night	Total	Day	Night	Total				
(a)	(b)	(c)	(d)	(e)	(f)	(g)	(h)	(i)	(k)	(l)	(m)	(n)	(o)	(p)	(q)	(r)
CERBERA	2	4		1105		Ops	52	4	56	115.25	1.15	116.40				
						Cont	3		3	2.25		2.25				
						Test	1		1	1.00		1.00				
<b>Sub total</b>	<b>2</b>	<b>4</b>		<b>1105</b>			<b>56</b>	<b>4</b>	<b>60</b>	<b>118.50</b>	<b>1.15</b>	<b>120.05</b>				
STOCK	2	3		1343		Ops	46	2	48	109.40	1.30	111.10				
						Cont		4	4	1.40		1.40				
						Test	7		7	5.50		5.50				
<b>Sub total</b>	<b>2</b>	<b>3</b>		<b>1343</b>			<b>53</b>	<b>6</b>	<b>59</b>	<b>115.30</b>	<b>3.10</b>	<b>118.40</b>				
<b>TOTALS .. ..</b>	<b>4</b>	<b>7</b>		<b>2448</b>			<b>109</b>	<b>10</b>	<b>119</b>	<b>234.20</b>	<b>4.25</b>	<b>238.45</b>				

PART B — MISCELLANEOUS — Include items of general interest or statistical significance affecting the flying effort and remarks pertaining to Part A.

*Paul Pearson*  
OC 161 RECCE FLT  
Commanding Officer

19 Dec 65  
Date

NON-OPERATIONAL STATISTICAL SUMMARY

Form A 124, Jan 62

INSTRUCTIONS

Column

- (a) State separately aircraft type and mark.
- (b) Include all aircraft allotted to the unit (Do not omit storage or reserve aircraft). In the case of a unit under a wing organization include aircraft detached to Wing Maintenance Squadron. Calculate average daily strength as follows:—  
$$\frac{\text{sum of daily totals of aircraft on strength by type}}{\text{No of days in month (including week-ends and public holidays)}}$$
- (c) "Effective Strength" — average of the greatest number of complete crews which could be assembled from effective flying personnel each day. Calculate as follows:—  
$$\frac{\text{sum of daily totals of complete effective crews on strength}}{\text{No of days in month (including week-ends and public holidays)}}$$
 (correct to the nearest whole number)
- (d) "Non-effective Strength" — include all flying personnel on posted strength who are not available for duty due to sick leave, detachment etc (Vide definition AFO 1/A/3). A daily record of non-effective flying personnel should be kept to facilitate accurate calculations of monthly averages.
- (e) Include all fuel added wherever obtained. If measured in American gallons, insert "US" after quantity.
- (f) Record even if aircraft type has not been flown during month.
- (g) State type of flying separately by each type and mark of aircraft; eg Operational Training, Conversion, Refresher, Staff Officer Practice, Course (no and type), Test, Travel, Ferry, SAR or Bush Fire Patrol.
- (h - n) State separately sorties and hours flown for each type of flying listed in column (g). (See also notes on cols (q - r) ).
- (o - p) Record flying by non-unit crews in unit aircraft. (eg Wing C/O; Staff Officers etc). This flying will also have been included in cols (h - n). Annotate name of unit or appointment of such crews.
- (q - r) Record flying by unit crews in non-unit aircraft. This flying will not have been included in cols (h - n). Annotate name of unit whose aircraft was used.

DISPATCH

1. Before dispatch check that flying hours shown agree with the unit or Wing Monthly Servicing Report.
2. Units are to dispatch Form A124 not later than the third working day of the succeeding month (AFO 18/F/7A).

*[Handwritten signature]*  
 Commanding Officer



U.S. FORCES - REPUBLIC OF VIETNAM

## Special Occurrence Report A1-394.

TOTAL Eng hours <sup>225.50</sup>  
~~218.25~~  
Pilot hours Lt J.A. GUND 350.

1. On 5th Dec 65 I was flying a mission in sp of D17 Cav.
2. The ac had flown on that day a mission of 3 hours duration refuelled and was on its second mission.
3. At 1345 hours (after 2.50 sortie time) at 1500' whilst in a gradual descent returning for refuel the engine began to run unevenly. All instruments were checked and were correct.
4. After another 2 minutes the instruments were checked again and were once again all reading correctly.
5. At this time I was 1 mile away from D17 position where I was to drop off my passenger



U.S. FORCES - REPUBLIC OF VIETNAM

before refueling.

6. When I again checked my instruments on my final approach I noted the cylinder head temperature had dropped to just above 100°.
7. I discontinued my approach and turned toward the airfield at 10 DAT which was miles away.
8. I called the airfield control notified them of the emergency and was cleared to land immediately.
9. On the approach to the airfield the cylinder head temperature dropped to 90°.
10. I landed and carried out the normal shut down procedure.

Joe Gould Lt

235224 Lt J.A. GUILD.

SECRET

SOR 41-394.

AC 35

AC Airframe Hours 240.50.

Pilot W Guild

Pilot Hours. 360.

1. At 1458 I departed VO DAT airfield,  
with Capt FENCER USAF as passenger,  
for movement to Bu HQ of the 2/503  
Bw.

2. At 1500 hours at 50' a  
white bird struck the bubble  
approximately in the top center.

3. The bubble was broken so  
I immediately returned to  
the airfield and landed.

J. A. Guild W

238224 W J.A. GUILD.

SECRET