

DIBEISI®

OWNER'S MANUAL

MODEL: DBS6528T-RGB

6.5" 2-Way Waterproof Stereo Speakers with Lights

Completely Waterproof

For Marine or Car Use

Injection Cone with Rubber Edge

1" Titanium Dome Tweeter

Molded ABS Plastic Basket

Max Power: 150 Watts

Magnet: 10 Oz

Frequency Response: 60Hz-20KHz

Impedance: 4 Ohm

Sensitivity: 91 dB

Dimensions(mm): D192,d142,H98,h65

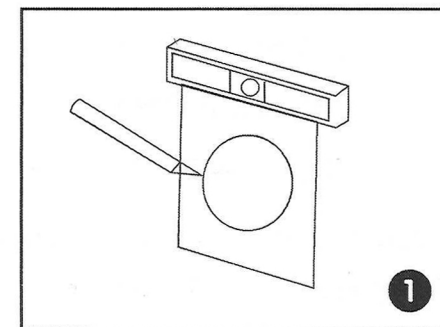
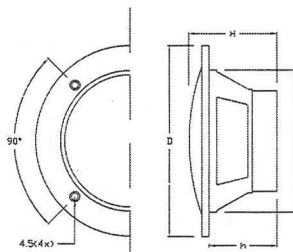

Cut the Surface.
Note: Always allow at least 1 1/2" or 1.5" between a wall stud and the speaker cutout or the locking tabs will not be able to swivel into place.

INSTALLATION GUIDE

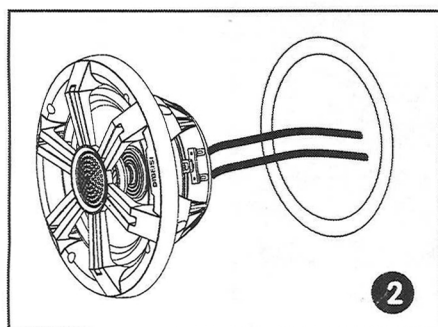

Connect the speaker wires to the speaker.

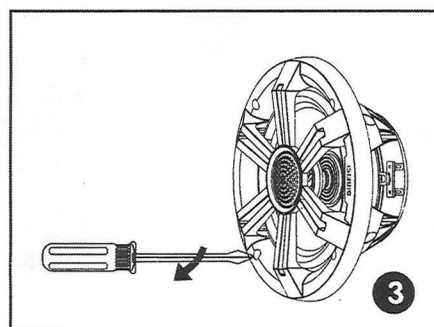

Screw down each of the four Phillips head screws. The locking tabs will swivel into place and secure the unit to the rear surface. Apply the adhesive strip to secure the grill.

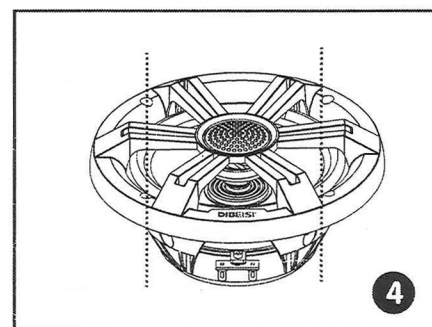

Replace the plastic grill.

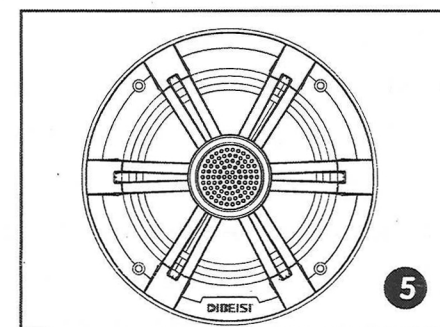

Complete.