

Exhibition station concept design

At Exhibition, an upgraded station located between the RNA Showgrounds and the Royal Brisbane and Women's Hospital, will provide year-round rail services to one of Brisbane's fastest growing inner-city suburbs.

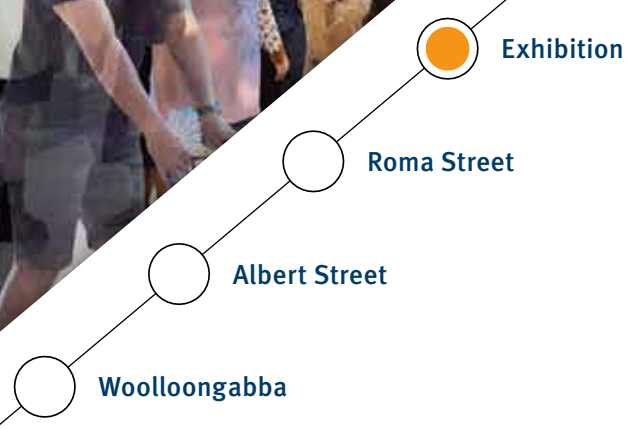



Station features

Features of the Exhibition station include:

- Pedestrian link between the station to Bowen Bridge Road, and future provision for links to O’Connell Terrace and Gregory Terrace
- 165m long island platform with future provision for extending to nine-car trains
- Design that includes vertical transport solutions to improve accessibility, movement, connectivity and safety around the stations for all customers.

Current status

Early works are continuing including geotechnical investigations, survey, environmental monitoring and preparing the detailed design for construction. Major construction at Exhibition station is scheduled to start in late 2020.

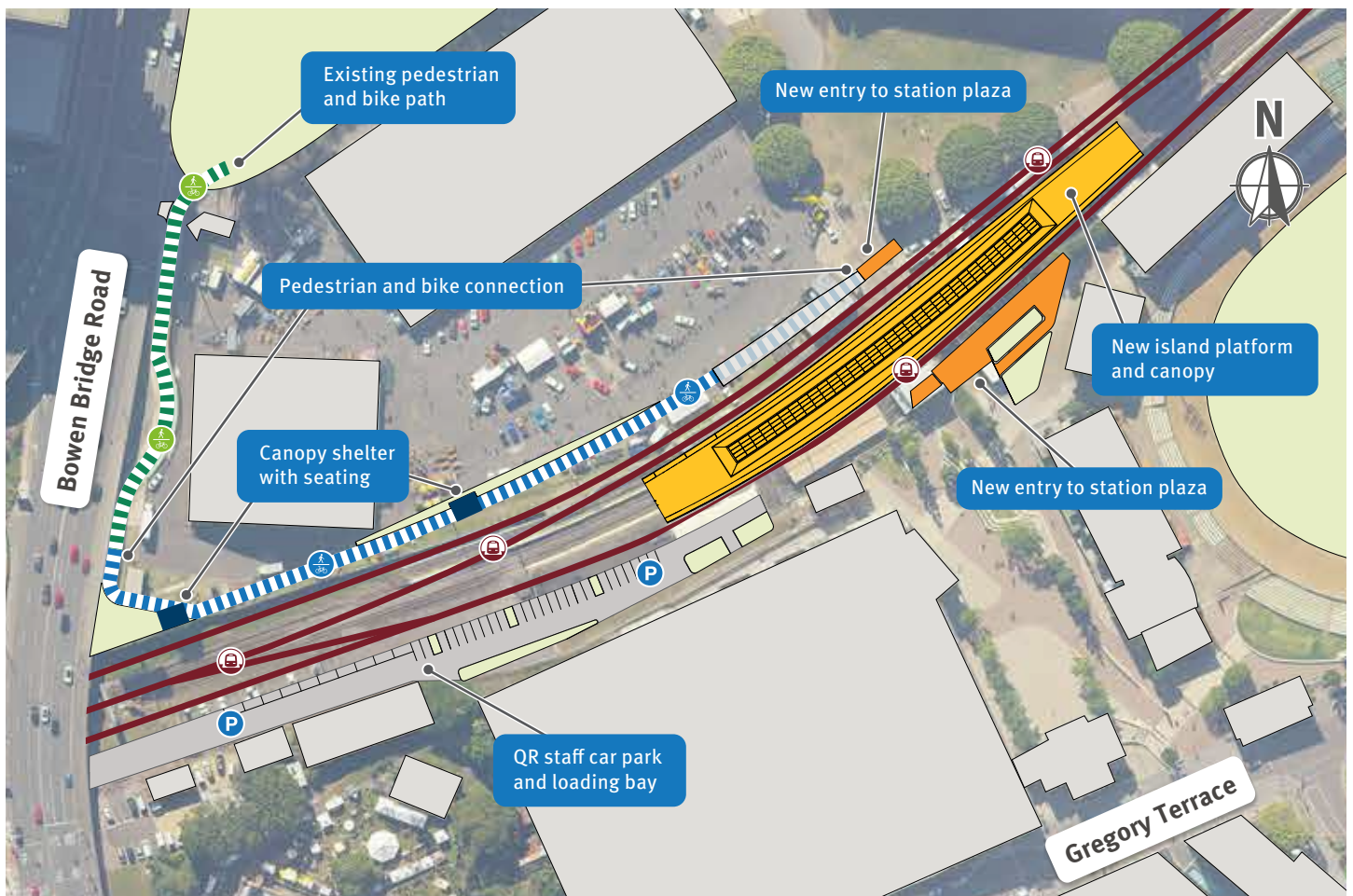

Contact us

- ☎ 1800 010 875
- ✉ info@unityalliance.com.au
- 🌐 crossriverrail.qld.gov.au



If you need an interpreter to assist you in understanding this document, please call the Translating and Interpreting Service (TIS National) on 131 450 and request to be transferred to Multicultural Affairs Queensland on 13 QGOV (13 74 68)

