

# Works Notice

October 2020

## Albert Street station construction update

Throughout October, works will continue at each of the Albert Street station construction sites. This includes ongoing excavation for the future main station entrance (Lot 1), ongoing tunnelling activities within the acoustic shed (Lot 2) and demolition at 142 Albert Street, the future northern station entrance site (Lot 3).

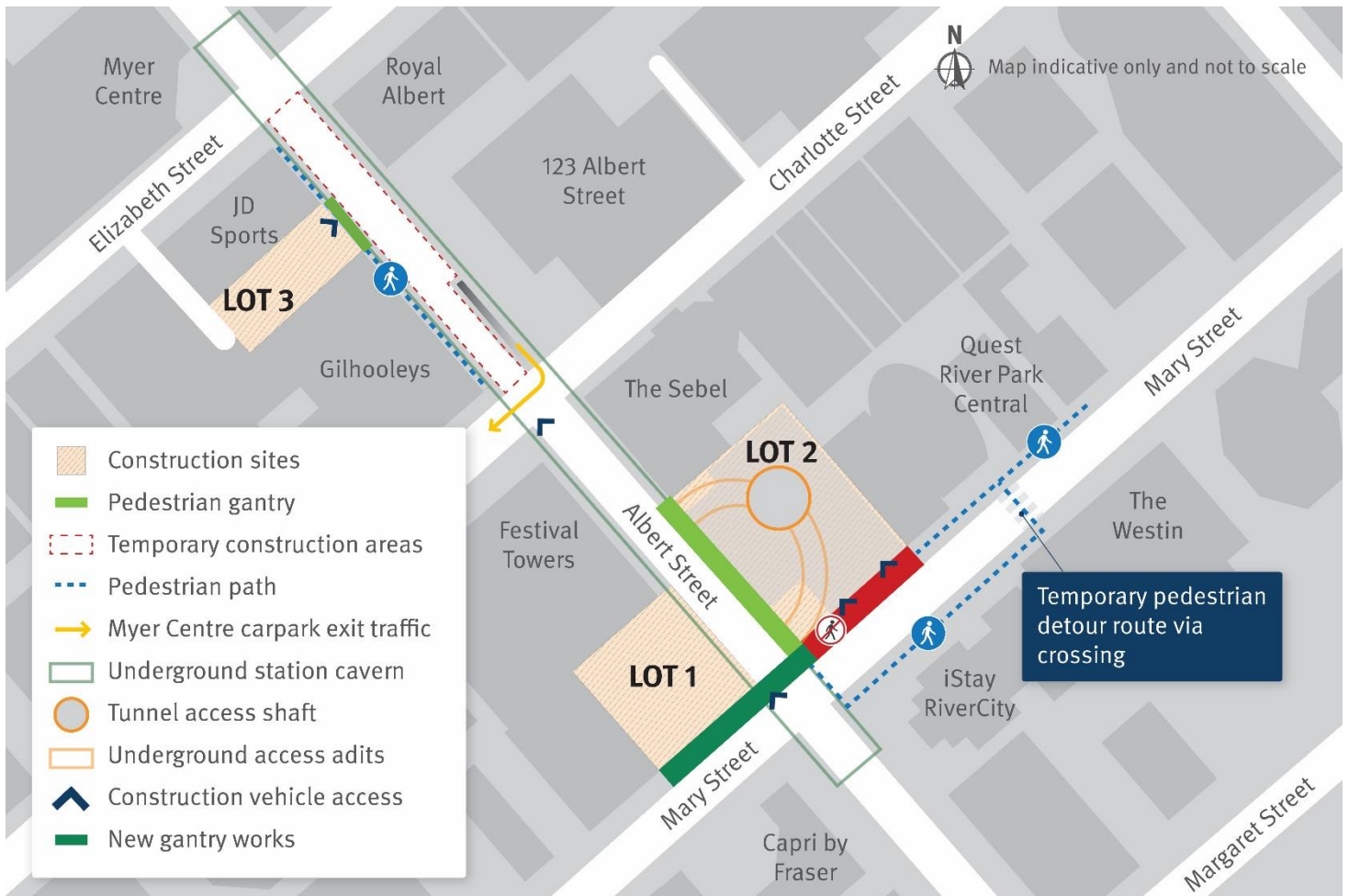

Map above: Indicative map showing work locations throughout October. Turn overleaf for work details.

### What to expect

- Construction activity in the area with potential for an increase in noise, dust, vibration, truck movements and workers.
- Construction impact mitigation activities such as street sweepers, water suppression and hoarding installation.
- Ongoing delivery and removal of material, equipment and machinery, including oversized plant.
- Temporary road, laneway and pedestrian traffic detours under the direction of traffic control which may cause delay in journey times and routes.

### Register to receive project updates

#### Register for email updates

To subscribe for email updates, visit [crossrивerrail.qld.gov.au](http://crossrивerrail.qld.gov.au) and look for the subscription area at the bottom of every page, or email [crossrивerrail@cbquiv.com.au](mailto:crossrивerrail@cbquiv.com.au)

#### Register to receive SMS updates

We send free SMS messages ahead of tunnelling and selected night work. To subscribe, send your name, mobile phone number and address to [crossrивerrail@cbquiv.com.au](mailto:crossrивerrail@cbquiv.com.au)

Personal information collected by Cross River Rail Tunnel & Stations for the purposes of email and SMS services will be managed in accordance with the Information Privacy Act 2009 (QLD).

## LOT 1 – Main station entrance

Western corner of Albert and Mary streets intersection



### Excavation of the main station entrance

Ongoing

- Excavation and ground retention activities including rock hammering, shotcreting and rock anchoring
- Adjustments to site facilities

### Installation of pedestrian gantry

October 2020

- Finishing works to pedestrian gantry on the Mary Street footpath alongside Lot 1, including intermittent footpath closures during lifting activities
- Line marking and lane adjustment activities on Mary Street

## LOT 2 – Tunnelling site, within the acoustic shed

Northern corner of Albert and Mary streets intersection



### Underground excavation within the acoustic shed

October 2020

- Excavation of underground access adits and platform cavern by roadheader and controlled blasting
- Ground stabilisation and retention works including shotcreting and rock bolting

### Tunnelling support activities

October 2020

- Installation of tunnel shaft elevator
- Shed finishing works including construction of shed egress points
- Extension activities to ventilation and tunnel services

## LOT 3 – Northern station entrance

142 Albert Street



### Site establishment

October 2020

- Site and geotechnical investigations
- Service locations and relocations
- Installation and adjustment of barriers, fencing and hoarding
- Installation of site facilities
- Installation of pedestrian gantry and traffic controls
- Construction of site access crossover
- Pedestrian gantry finishing works

### Demolition of 142 Albert Street

October 2020

- Installation, adjustment and removal of protective scaffolding
- Removal of internal fittings and fixtures
- Hazardous material (HAZMAT) inspections, monitoring and removal
- Disconnection, relocation and removal of existing services
- Demolition of the building structure

## Local streets

Albert Street between Alice and Queen streets: Elizabeth, Charlotte and Mary streets



### Utility work and geotechnical investigations

October 2020

- Locating, installing and relocating services
- Geotechnical investigations
- Borehole drilling and reinstatement works
- Lane closures and traffic changes, where required

### Footpath closure and new pedestrian crossing

October 2020 until construction completion

- Footpath closure on Mary Street alongside Lot 2
- Preparation work and construction of a temporary pedestrian crossing on Mary Street between The Westin and Quest River Park Central. Detour in place until construction completion (see map overleaf)



#### Standard construction hours

Standard construction hours are 6:30am to 6:30pm, Monday to Saturday.



#### Out of hours works

Some activities will be completed out of normal construction hours. Timing of these works are detailed in project updates - follow steps (*right*) to register.



#### 24 hours

Tunnelling and tunnelling support activities are undertaken 24 hours a day.

#### Albert Street controlled blasting update

As part of excavation of the tunnel access adits at Lot 2, the Cross River Rail Tunnel & Stations contractor will recommence controlled blasting from mid-October 2020.

Blasting will be carried out between **7:30am and 4:30pm, Monday to Saturday**, excluding public holidays.

#### Register for SMS alerts of controlled blast times

Register to receive SMS alerts prior to each controlled blast, please send your name, phone number and address by email to [crossriverrail@cbgujv.com.au](mailto:crossriverrail@cbgujv.com.au) or by text to 0419 679 314 (message and data rates may apply).

☎ 1800 010 875

✉ [crossriverrail@cbgujv.com.au](mailto:crossriverrail@cbgujv.com.au)

🌐 [crossriverrail.qld.gov.au](http://crossriverrail.qld.gov.au)



If you need an interpreter to assist you in understanding this document, please call the Translating and Interpreting Service (TIS National) on 131 450 and request to be transferred to Multicultural Affairs Queensland on 13 QGOV (13 74 68)

