



# Sharon Reserve Upgrade

## Manningham Council is upgrading Sharon Reserve as part of the 2015/16 Neighbourhood Park Development Program.

Community consultation was undertaken in late 2015 and in response to the feedback received, the following improvements have been added to the final design for the reserve:

- Additional seating around the reserve
- Creating a new concrete circuit path

The play equipment to be installed is shown on the concept plan below.

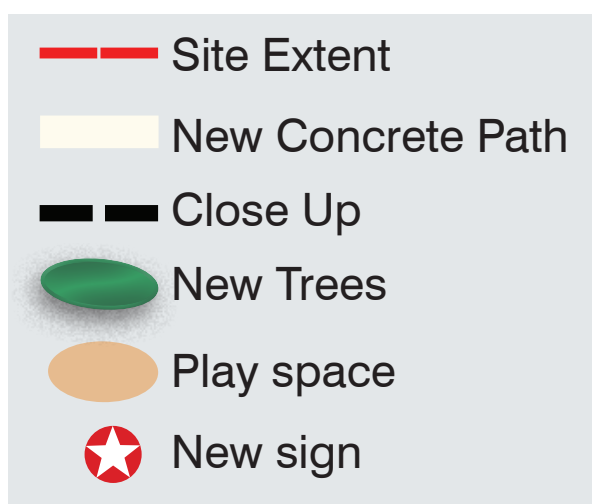

1 Spinner



2 Pavers



3 Table seat



4 Climbing hut



5 Trees and plants



6 Swings



7 Seats



8 Mudstone rocks

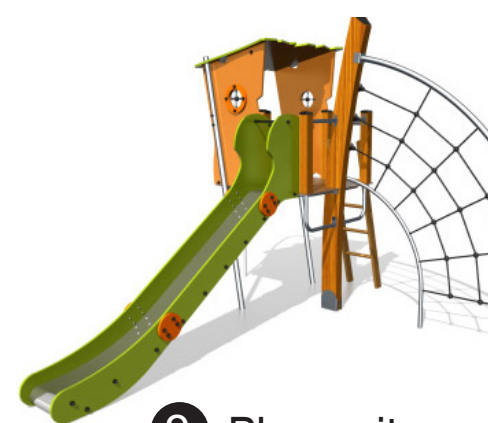

9 Play unit



10 Timber log



11 Improved paths



9840 9355

Works are expected to be completed by the end of June 2016.

For more information, call Council's Recreation Planner on 9840 9303 or email [eepadmin@manningham.vic.gov.au](mailto:eepadmin@manningham.vic.gov.au)