

KEY PLAN

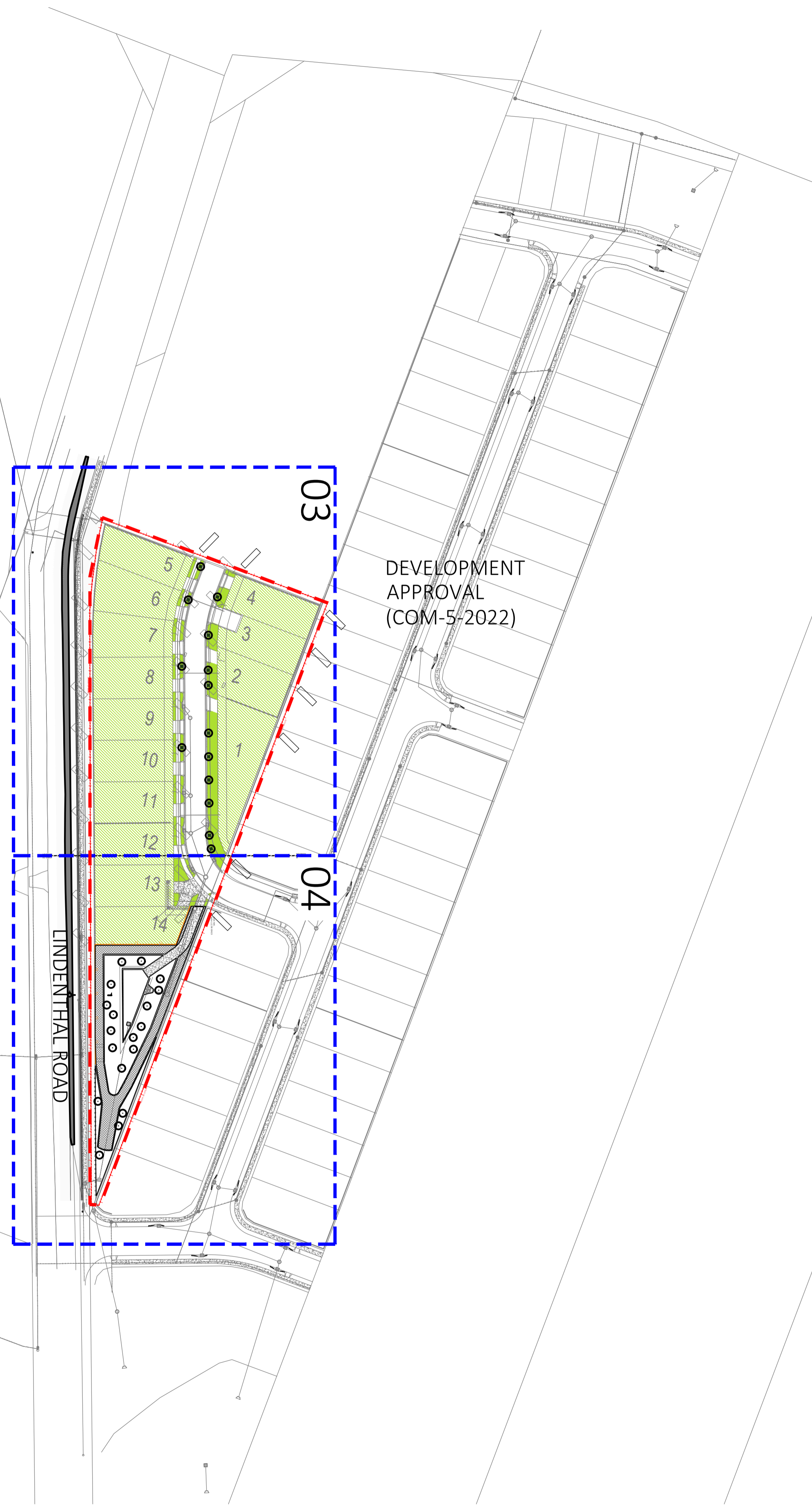

PLANT SCHEDULE

| CODE | BOTANICAL NAME | AREA | PLANTING CTRS | POT SIZE | QUANTITY |
|--------------------------|-----------------------|------|---------------|----------|-----------|
| STREET TREES | | | | | |
| ELA eum | Elaeocarpus eumundii | | On Plan | 45L | 4 |
| HAR pen | Harpullia pendula | | On Plan | 45L | 4 |
| TRI lau | Tristaniopsis laurina | | On Plan | 45L | 3 |
| LOP con | Lophostemon confertus | | On Plan | 45L | 3 |
| Street Tree Total | | | | | 14 |

| DRAINAGE RESERVE BUND - PA1 | | 493m ² | | | |
|------------------------------------|----------------------|-------------------|----------------------|-----------|-------------|
| CAR app | Carex appressa | | 4-5 / m ² | TUBESTOCK | 350 |
| IMP cyl | Imperata cylindrica | | 4-5 / m ² | TUBESTOCK | 350 |
| FIC nod | Ficinia nodosa | | 4-5 / m ² | TUBESTOCK | 350 |
| JUN usi | Juncus usitatus | | 4-5 / m ² | TUBESTOCK | 350 |
| THE tri | THEMEDA triandra | | 4-5 / m ² | TUBESTOCK | 350 |
| MYO ell | MYOPORUM ellipticum | | 4-5 / m ² | TUBESTOCK | 350 |
| MYO par | MYOPORUM parvifolium | | 4-5 / m ² | TUBESTOCK | 350 |
| Plant Total | | | | | 2450 |

| DRAINAGE RESERVE BATTER - PA2 | | 560m ² | | | |
|--------------------------------------|-----------------------------|-------------------|--------------------|-----------|-------------|
| EUC rob | Eucalyptus robusta | | On Plan | TUBESTOCK | 3 |
| BAN int | Banksia integrifolia | | On Plan | TUBESTOCK | 2 |
| COR pty | Corymbia ptychocarpa | | On Plan | TUBESTOCK | 3 |
| MEL vim | Melaleuca viminalis | | On Plan | TUBESTOCK | 6 |
| LEP pol | Leptospermum polygalifolium | | On Plan | TUBESTOCK | 10 |
| MEL thy | Melaleuca thymifolia | | On Plan | TUBESTOCK | 20 |
| WES fru | Westringia fruticosa | | On Plan | TUBESTOCK | 17 |
| LOM hys | Lomandra hystrix | | 6 / m ² | TUBESTOCK | 1099 |
| FIC nod | Ficinia nodosa | | 6 / m ² | TUBESTOCK | 1099 |
| JUN usi | Juncus usitatus | | 6 / m ² | TUBESTOCK | 1099 |
| Plant Total | | | | | 3358 |

| DRAINAGE RESERVE FLOOR - PA3 | | 126m ² | | | |
|-------------------------------------|----------------------|-------------------|---------------------|-----------|-------------|
| CAR app | Carex appressa | | 10 / m ² | TUBESTOCK | 210 |
| CYM ref | Cymbopogon refractus | | 10 / m ² | TUBESTOCK | 210 |
| GHA asp | Gahnia aspera | | 10 / m ² | TUBESTOCK | 210 |
| IMP cyl | Imperata cylindrica | | 10 / m ² | TUBESTOCK | 210 |
| FIC nod | Ficinia nodosa | | 10 / m ² | TUBESTOCK | 210 |
| JUN usi | Juncus usitatus | | 10 / m ² | TUBESTOCK | 210 |
| Plant Total | | | | | 1260 |

| GENERAL PLANTING - PA4 | | 150m ² | | | |
|-------------------------------|-----------------------------|-------------------|----------------------|-----------|------------|
| BAN int | Banksia integrifolia | | On Plan | TUBESTOCK | 1 |
| COR pty | Corymbia ptychocarpa | | On Plan | TUBESTOCK | 1 |
| MEL vim | Melaleuca viminalis | | On Plan | TUBESTOCK | 2 |
| MEL thy | Melaleuca thymifolia | | On Plan | TUBESTOCK | 5 |
| WES fru | Westringia fruticosa | | On Plan | TUBESTOCK | 11 |
| LEP pol | Leptospermum polygalifolium | | On Plan | TUBESTOCK | 15 |
| LOM hys | Lomandra hystrix | | 2-3 / m ² | TUBESTOCK | 130 |
| FIC nod | Ficinia nodosa | | 2-3 / m ² | TUBESTOCK | 130 |
| JUN usi | Juncus usitatus | | 2-3 / m ² | TUBESTOCK | 130 |
| Plant Total | | | | | 425 |

LEGEND

- EXTENT OF WORKS
- TURF
REFER TO SCHEDULE
- TURF TYPE 2
REFER TO SCHEDULE
- PLANTING AREA 1 - PA1
DRAINAGE RESERVE BUND
REFER TO SCHEDULE
- PLANTING AREA 2 - PA2
DRAINAGE RESERVE BATTER
REFER TO SCHEDULE
- PLANTING AREA 3 - PA3
DRAINAGE RESERVE FLOOR
REFER TO SCHEDULE
- PLANTING AREA 4 - PA4
GENERAL PLANTING
REFER TO SCHEDULE
- MOWING EDGE
- TIMBER
REFER TO SCHEDULE
- RETAINING WALL
REFER TO CIVIL
- FENCE TYPE 1
POOL FENCE
REFER TO SCHEDULE
- TREES
REFER TO PLANT SCHEDULE
- STREET TREE IN MULCH
REFER TO SCHEDULE AND DETAIL 7
- NEW SHRUBS PLANTING
REFER TO SCHEDULE
- BOLLARD
B1 - @ 1500 CENTRES
LCC 08 00422
- LOCK RAIL
AS PER LCC DETAIL
LCC 08 00423

| | | | | | |
|-------|--------------|------------|-----|----|----|
| C | FOR APPROVAL | 2025-10-29 | QS | DM | DM |
| B | FOR APPROVAL | 2025-08-06 | QS | DM | DM |
| A | FOR APPROVAL | 2025-02-04 | DD | ME | ME |
| ISSUE | DETAILS | DATE | DES | DC | QA |

PROJECT TITLE
20 - 46 LINDENTHAL ROAD
PARK RIDGE

CLIENT
BHAVIN GANDHI

PLAN TITLE
LANDSCAPE PLAN
COVERSHEET

SCALE: NTS

| DOCUMENT NUMBER | AREA | STAGE | PLAN | ISSUE |
|-----------------|------|-------|------|-------|
| B4703L A1_DA1 | | LP01 | C | |

20-46 LINDENTHAL ROAD, PARK RIDGE

NOTES - GENERAL

This landscape plan references JFP civil B4703EA1_DA1, issue B

1. DRAINAGE

Refer to relevant engineering drawings for storm water drainage and field gully sizing and connections. Field gullies are to be supplied, installed and connected to the stormwater system.
Install subsoil drains where indicated on plans, and behind all retaining walls.
Connect subsoil drains to either storm water drainage system or to gravel soakage pit as indicated on plan.

Where soakage pits are located in turf, finished levels of the pits should be at a minimum of 100mm below surface level with 100mm depth of soil over, and then turf. Where soakage pits are located in a planting bed, finish the pit flush with soil level and place 100mm mulch over, as specified. Refer to landscape details.

2. FALLS, LEVELS AND GRADING

2.1 Spot levels take precedence over contours.
2.2 Direct all surface falls away from buildings for a minimum 1200mm. Grade all lawns and planting areas evenly, in the direction shown by arrows, or by using the spot levels provided.
Ponding is unacceptable.

Final surface levels to be verified on site. Refer Engineering drawings for levels on road surfaces, pits, gullies etc.

Unless noted otherwise on plan, surrounding maximum grades should be 1:3 for planting beds, and 1:6 for turf areas.

3. PLANTING SELECTION

Refer to plant schedule for plant selection and to plans for the locations of tree and associated planting.

3.1 Fertiliser to planting areas:

Install Agriform 10gm Slow Release Tablets to all plants under 45Ltr at planting as per the Manufacturer's instructions. Install Agriform 21gm Slow Release Tablets to all plants over 45Ltr at planting as per Manufacturer's instructions. Use Dynamic Lifter or equivalent through topsoil as per manufacturer's recommendations. Apply a general organic fertiliser to all plants. Fertilisers containing phosphorous must not be used on Banksia, Grevillea, Hakea, Telopea, Hardenbergia, Proteas, Alyogyne and Phebalium species.

3.2 SH - Sun hardened

It is the contractors responsibility to ensure all plants are sun hardened to the sites climatic conditions.

4. PLANTING AREAS (PA)

a) Common Planting Areas.

Cultivate to 150mm depth and place 300mm topsoil, as specified. Place 100mm layer of organic mulch, as specified. Mound garden beds above adjacent hard surfaces to promote positive drainage and as directed on plan.

b) General Planting into Common Planting Areas - 140mm to 25lt pot sizes.

Mound up additional topsoil around the base of the plants to achieve minimum soil depths, as shown in the landscape detail drawings. The profile of mounding is to provide a smooth transition to the grades, as shown.

c) Advanced & Super Advanced Stock Planting - 45lt to 200lt & Ex-ground stock.

All stock is to be planted with imported topsoil, and with a specified minimum quantity of topsoil immediately surrounding the planting basin. Minimum quantity varies according to the size of the stock installed.

d) **Deep Planting Areas** - Deep planting areas are provided around the extremity of the site allowing trees optimum growing space. Refer Plan for locations.

Cultivation

cultivate all of revegetation that do not occur within the drip line of existing vegetation to a minimum depth of 150mm.

Mulch

- All imported mulch is to meet AS4454-2012.
- Mulch must be a minimum of 100mm depth unless specified and contain a combination of leaf, timber and bark unless otherwise specified. Ensure no wood pieces larger than 100mm in size. Ensure free from wood slivers.
- Where blanket mulch is not specified use pre-fabricated jute-mat squares or approved equivalent or mulch rings around all tube stock as specified.
- No soil laden tub grindings will be allowed to be used as mulch.
- Soil laden tub grindings may only be used as an additive to site topsoil used in revegetation areas.
- Planted slopes equal to or steeper than 1:6 must be fully mulched with a locking mulch such as unscreened hoop pine.
- Mulch material including soil additives shall not contain peanut shell or other irritant materials.
- Where field gullies abut or are within garden beds provide appropriate filter to ensure that mulch does not enter drainage system.

5. EQUITABLE ACCESS

All pathways are to have maximum cross-falls of 1:40.

Handrails and pathways to comply with AS1428.1.

Tactile indicators to comply with 1428.4.

6. PAVEMENTS

Pavements are to be non-slip to comply with BCA requirements and AS1428.

7. LAWN AREAS

Cultivate existing subgrade to a depth of 200mm, place 100mm of topsoil as specified, and lay turf rolls, species as specified. Ensure flush to adjacent pathways.

8. EDGING

Construct continuous mowing strips in locations shown on plans. Refer to detail for type and size.

9. FENCES AND RETAINING WALLS

Refer to landscape plans for wall and fence types and dimensions. Refer to Engineer's details for construction.

10. STREET TREE PLANTING

Place street trees to local authority policy and generally to the centre of lots to maximise distance from driveways, services and street lights.

11. NAT SPEC

At the time of planting all trees must conform to guidelines outlined with 'Specifying Trees - A Guide to Assessment of Tree Quality'(Author - Ross Clark) otherwise known as Nat Spec. Responsibility for planting only Nat Spec compliant trees will rest with the landscape contractor.

Where Nat Spec quality trees can not be sourced, no other tree species is to substituted without referring the issue to the landscape architect.

The landscape contractor is responsible for informing the landscape architect if a tree species is not available due to issues of non-Nat Spec compliance.

| MATERIALS & FINISHES SCHEDULE | | | | | |
|---|---|------|---|--|------------------------|
| Item | | Code | Description | Specification | Qty |
| A SITE WORKS, MINOR EARTHWORKS, DRAINAGE | | | | | |
| 1 Site Works/ Minor Earthworks | | | | | |
| 1 | 1 | | Shaping - adjust civil profiles to desired shape & trim | Civil to provide site at handover minus 100mm +/- 50mm of finished surface levels shown on landscape plans | m ² 7567.00 |
| 1 | 2 | | Cultivation and Soil amendments | As per specification & detail Gypsum: Incorporate at the rate of 0.25 kg/m ² . Refer section C - Planting areas for soil depth and section c - Turf for soil depth | m ² 7567.00 |

| B HARDSCAPE | | | | | |
|------------------------------|---|----|-----------------------------|------------------|---------|
| 2 Fences and Barriers | | | | | |
| 2 | 1 | F1 | Fence type 1 | Refer to Detail. | m 83 |
| 2 | 1 | B1 | BOLLARD B1 - @ 1500 CENTRES | BSD 7093 | item 30 |
| 2 | 1 | LR | LOCK RAIL AS PER BCC DETAIL | BSD 7054 | item 1 |

C SOFTSCAPE

| 3 Edging | | | | | |
|-----------------|---|----|--------------------------------------|------------------|---------|
| 3 | 1 | M1 | Timber mowing edge to planting areas | Refer to Detail. | m 42.00 |

4 TU Turf

| | | | | | |
|---|---|-----|-------------------|--|------------------------|
| 4 | 1 | TU1 | Internal Lot Turf | Hydromulch Spec: To QLD Department of Transport & Main Roads - MRTS16 - Section 7.4.3 standards. Grass seed mix to be as per Section 7.4.9.1 | m ² 5743.00 |
| 4 | 3 | TU2 | Turf | A-grade wintergreen Soil depth: 100mm ameliorated site topsoil Cultivation: Min 200mm | m ² 495.00 |

5 PA Planting Areas - (includes watering costs until PC)

| | | | | | |
|---|---|------|-------------------------|---|-----------------------|
| 5 | 1 | | General soil note | All soils used on site are to be to QLD Department of Transport & Main Roads - MRTS16:2017 standard. If these needs to be substituted it must be to AS4419:2019 AND meet PFAS levels outlined in the PFAS National Environmental Management Plan: Jan 2018 for the 'Residential with garden/accessible soil' category | |
| 5 | 2 | PA 1 | Drainage reserve bund | Soil Depth: 300mm ameliorated site topsoil Cultivation: 200mm Mulch Depth: min 100mm Mulch Type: Aged forest mulch Refer to Detail. | m ² 493.00 |
| 5 | | PA 2 | Drainage reserve batter | 300mm deep ameliorated site soil to soil report recommendations. Jutemaster TM or approved equivalent fixed to manufacturer's detail. Refer to Detail. | m ² 560.00 |
| 5 | 3 | PA 3 | Drainage reserve floor | Following sacrificial turf laid by civil floor to be mulched with sugar cane mulch and hessian netting. Jute mesh to manufacturer's detail. Sugar cane mulch to be laid 75mm thick below Jute. Refer to Detail. Refer to Civil Engineer drawings for the Bioretention filtration media. | m ² 126.00 |
| 5 | 2 | PA 4 | General planting | Soil Depth: 300mm ameliorated site topsoil Cultivation: 200mm Mulch Depth: min 100mm Mulch Type: Aged forest mulch Refer to Detail. | m ² 150.00 |
| 5 | 4 | PA | Fertiliser | Apply dynamic lifter or approved equivalent as per specification | - - |

6 Planting Stock to PA

| | | | | | |
|---|---|--|---|--|----------|
| 6 | 1 | | Refer to planting schedule for planting stock | | |
| 6 | 2 | | Slow release nutrient bags | Agriform - 2x10g tablets per plant | kg 97.00 |
| 6 | 3 | | Water retention additive for each plant | Green Harvest Rainsaver Water crystals or approved similar | item |

7 PC Post Practical Completion - Plant Establishment Period

| | | | | | |
|---|---|--|--------------------------------|--|-----|
| 7 | 1 | | Establishment - 13 week period | Fortnightly Mowing and turf edging to all turf areas. Fertilising, pruning of plants trees as required and chemical and physical weed removal to all garden areas. Training of vines up trellises. Rubbish removal as required. Mulch to be topped up to install heights. Plants & trees to be pruned to not overhang paths. | - - |
|---|---|--|--------------------------------|--|-----|

8 PC Post Practical Completion - Ongoing Maintenance

| Note Practical Completion will be given at the time the Local Authority provides On Maintenance or Superintendent certifies completion. | | | | | |
|--|---|--------------------------|---|--|-----|
| 8 | 1 | TU1, TU2, PA1, PA2 & PA3 | Ongoing Maintenance after Plant Establishment to Streetscape Turf & Planting Areas - 9 months | Fortnightly Mowing and turf edging to all turf areas. Fertilising, pruning of street trees as required and chemical and physical weed removal to all garden areas. Rubbish removal as required | - - |

| | | | | | |
|-------|--------------|------------|-----|----|----|
| C | FOR APPROVAL | 2025-10-29 | QS | DM | DM |
| B | FOR APPROVAL | 2025-08-06 | QS | DM | DM |
| A | FOR APPROVAL | 2025-02-04 | DD | ME | ME |
| ISSUE | DETAILS | DATE | DES | DC | QA |

PROJECT TITLE

20 - 46 LINDENTHAL ROAD
PARK RIDGE

CLIENT

BHAVIN GANDHI

APPROVAL ISSUE

LEGEND

- EXTENT OF WORKS
- TURF
REFER TO SCHEDULE
- TURF TYPE 2
REFER TO SCHEDULE
- PLANTING AREA 1 - PA1
DRAINAGE RESERVE BUND
REFER TO SCHEDULE
- PLANTING AREA 2 - PA2
DRAINAGE RESERVE BATTER
REFER TO SCHEDULE
- PLANTING AREA 3 - PA3
DRAINAGE RESERVE FLOOR
REFER TO SCHEDULE
- PLANTING AREA 4 - PA4
GENERAL PLANTING
REFER TO SCHEDULE
- MOWING EDGE
- TIMBER
REFER TO SCHEDULE
- RETAINING WALL
REFER TO CIVIL
- FENCE TYPE 1
POOL FENCE
REFER TO SCHEDULE
- TREES
REFER TO PLANT SCHEDULE
- STREET TREE IN MULCH
REFER TO SCHEDULE AND DETAIL 7
- NEW SHRUBS PLANTING
REFER TO SCHEDULE
- BOLLARD
B1 - @ 1500 CENTRES
LCC 08 00422
- LOCK RAIL
AS PER LCC DETAIL
LCC 08 00423

| | | | | | |
|-------|--------------|------------|-----|----|----|
| C | FOR APPROVAL | 2025-10-29 | QS | DM | DM |
| B | FOR APPROVAL | 2025-08-06 | QS | DM | DM |
| A | FOR APPROVAL | 2025-02-04 | DD | ME | ME |
| ISSUE | DETAILS | DATE | DES | DC | QA |

PROJECT TITLE
20 - 46 LINDENTHAL ROAD
PARK RIDGE

CLIENT
BHAVIN GANDHI

PLAN TITLE
LANDSCAPE PLAN

SCALE: 1:200 at A1
DOCUMENT NUMBER
JOB NUMBER AREA STAGE PLAN ISSUE
B4703L A1_DA1 LP03 C

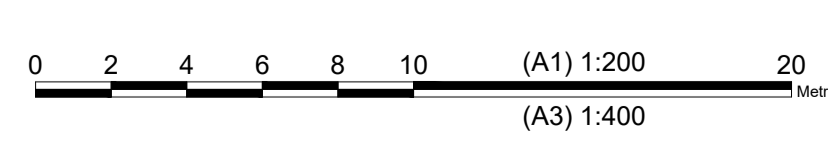
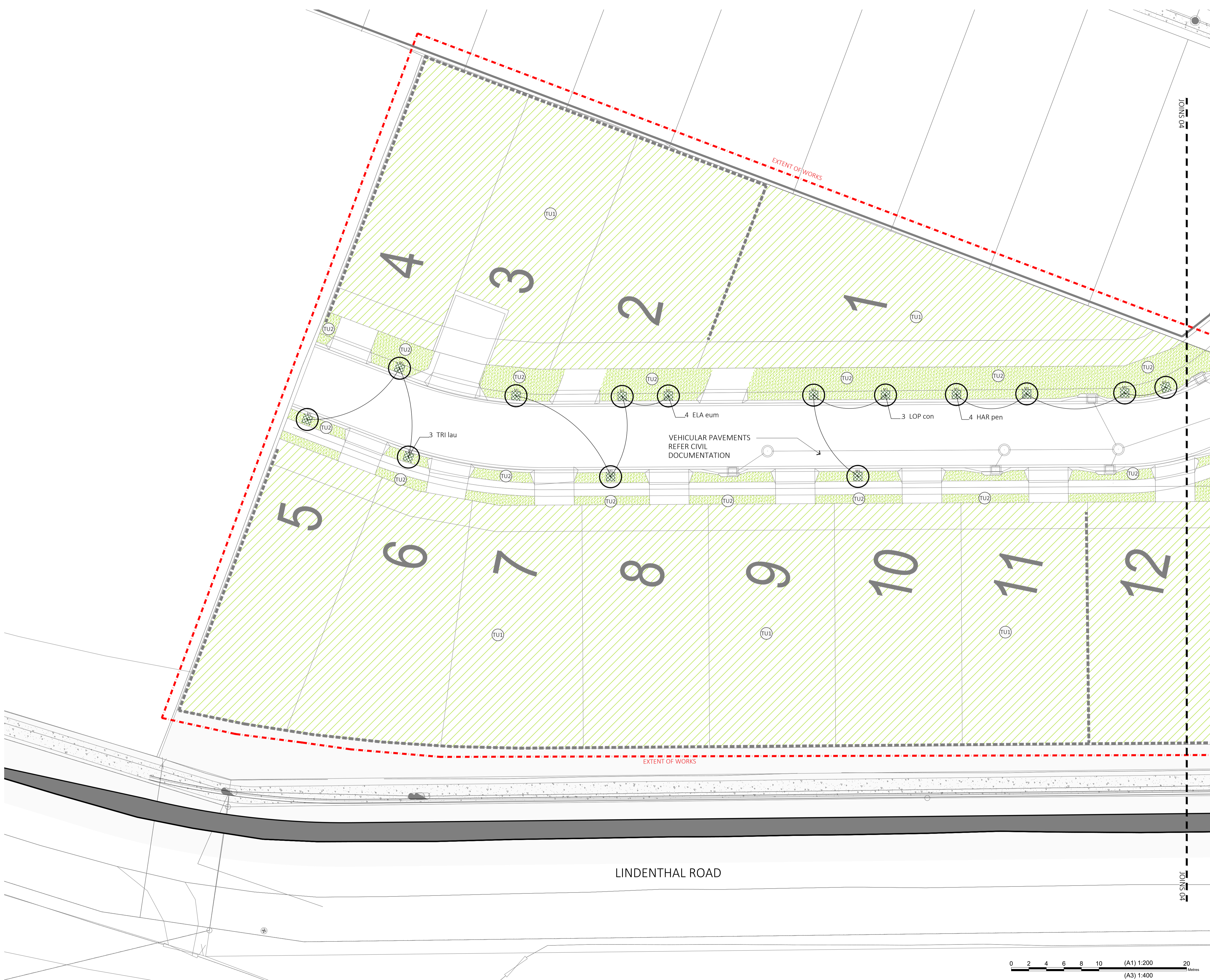

APPROVAL ISSUE

LEGEND

- EXTENT OF WORKS
- TURF (TU1) REFER TO SCHEDULE
- TURF TYPE 2 (TU2) REFER TO SCHEDULE
- PLANTING AREA 1 - PA1 DRAINAGE RESERVE BUND REFER TO SCHEDULE
- PLANTING AREA 2 - PA2 DRAINAGE RESERVE BATTER REFER TO SCHEDULE
- PLANTING AREA 3 - PA3 DRAINAGE RESERVE FLOOR REFER TO SCHEDULE
- PLANTING AREA 4 - PA4 GENERAL PLANTING REFER TO SCHEDULE
- MOWING EDGE (M1) REFER TO SCHEDULE
- TIMBER REFER TO SCHEDULE
- RETAINING WALL REFER TO CIVIL
- FENCE TYPE 1 (F1) POOL FENCE REFER TO SCHEDULE
- TREES (+) REFER TO PLANT SCHEDULE
- STREET TREE IN MULCH (MUL) REFER TO SCHEDULE AND DETAIL 7
- NEW SHRUBS PLANTING (•) REFER TO SCHEDULE
- BOLLARD (B1) @ 1500 CENTRES LCC 08 00422
- LOCK RAIL (LR) AS PER LCC DETAIL LCC 08 00423

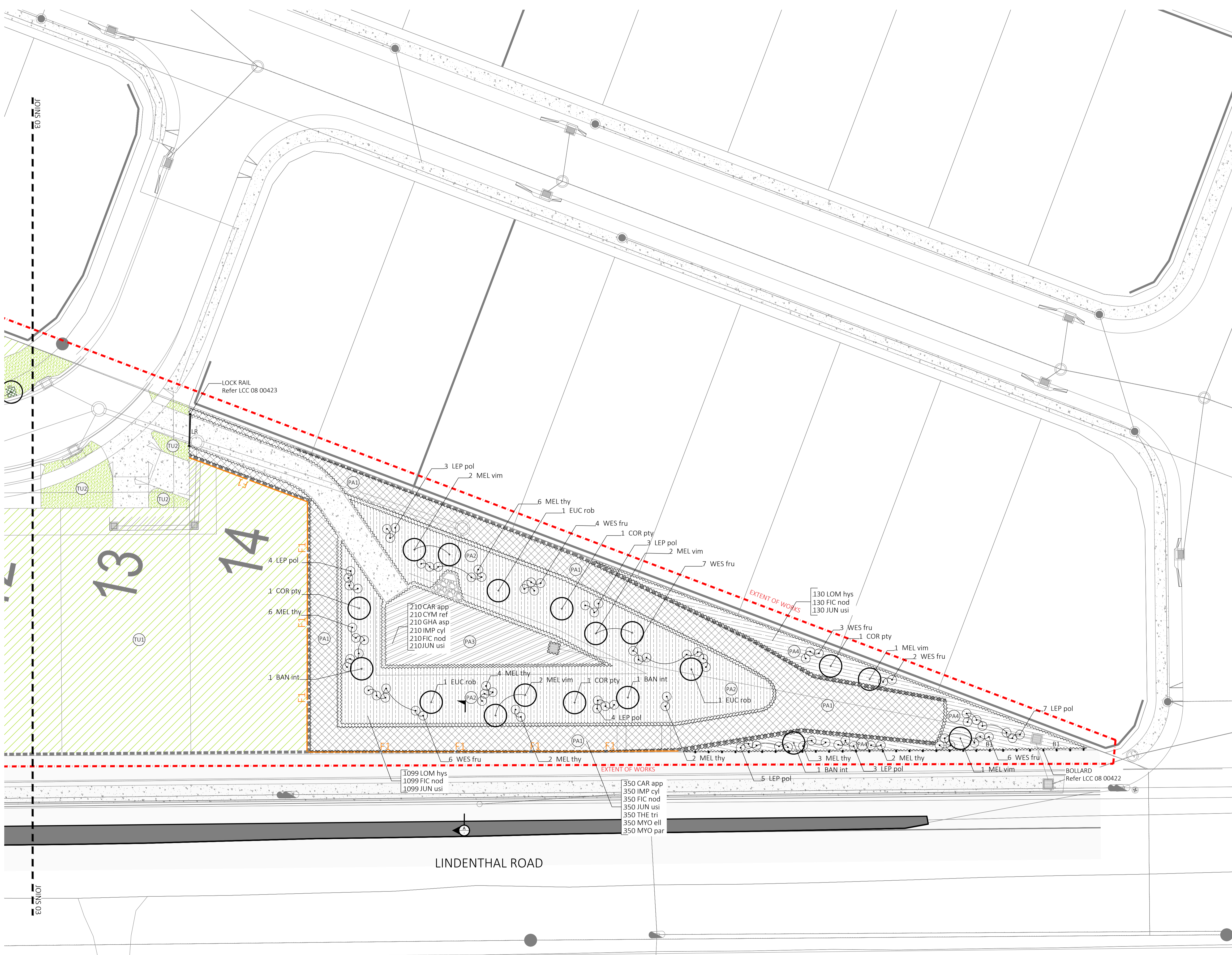

| | | | | | |
|-------|--------------|------------|-----|----|----|
| C | FOR APPROVAL | 2025-10-29 | QS | DM | DM |
| B | FOR APPROVAL | 2025-08-06 | QS | DM | DM |
| A | FOR APPROVAL | 2025-02-04 | DD | ME | ME |
| ISSUE | DETAILS | DATE | DES | DC | QA |

PROJECT TITLE
 20 - 46 LINDENTHAL ROAD
 PARK RIDGE

CLIENT
 BHAVIN GANDHI

PLAN TITLE
 LANDSCAPE PLAN

SCALE: 1:200 at A1
 DOCUMENT NUMBER
 JOB NUMBER AREA STAGE PLAN ISSUE
 B4703L A1_DA1 LP04 C

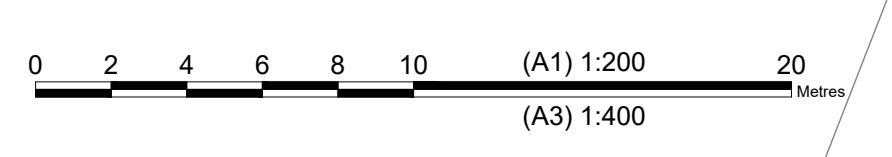

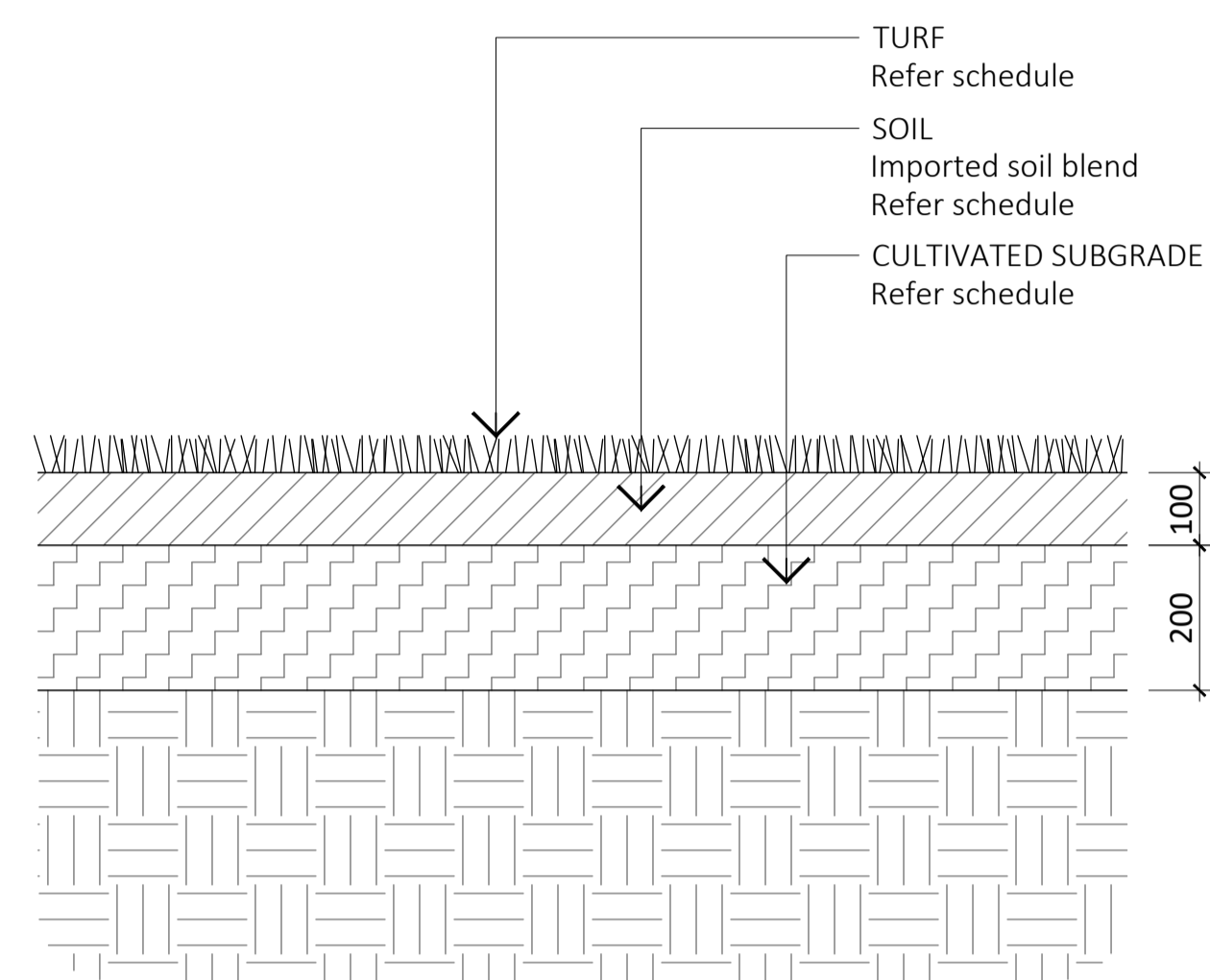

1 TU - TURF
Scale 1:10

- NOTES
- Embed timber stakes a min. of 300mm into solid natural ground and so that the top of the timber edge is flush with the level of adjacent mowed grass or other surface treatment.
 - Refer to schedule for edge size.
 - For sleeper edges use min. 600mm star pickets in lieu of timber stakes.
- STAKE SIZE:
- 50 x 50 x 450
 - 600mm star picket
- TIMBER TYPE:
- 100 x 16 - SWD
 - 100 x 25 - SWD
 - 100 x 38 - HWD
 - 200 x 50 - SWD
 - 200 x 50 - HWD
 - 100 x 50 - SWD
- CCA Treated HS or better

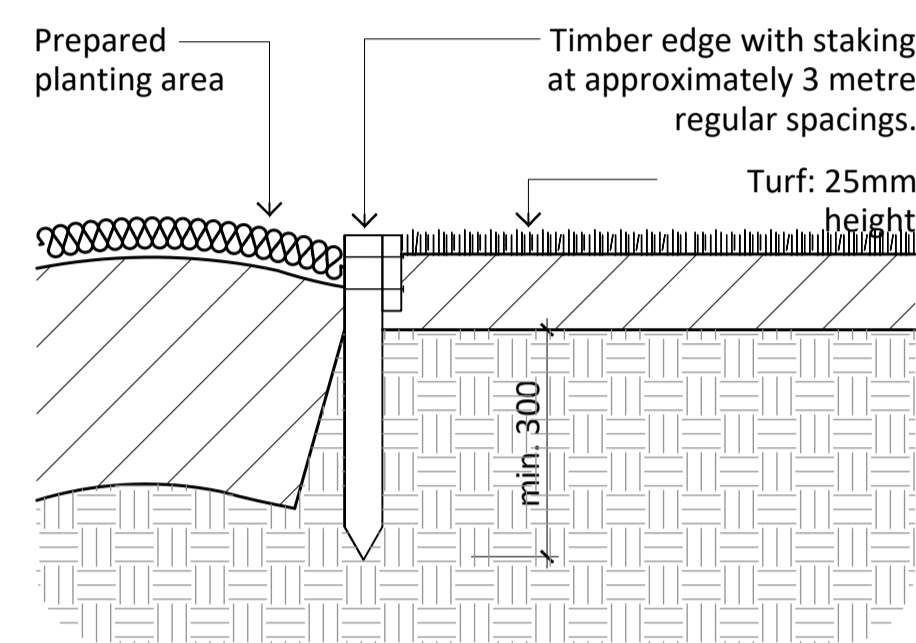

2 M1 - TIMBER GARDEN EDGING
Scale 1:10

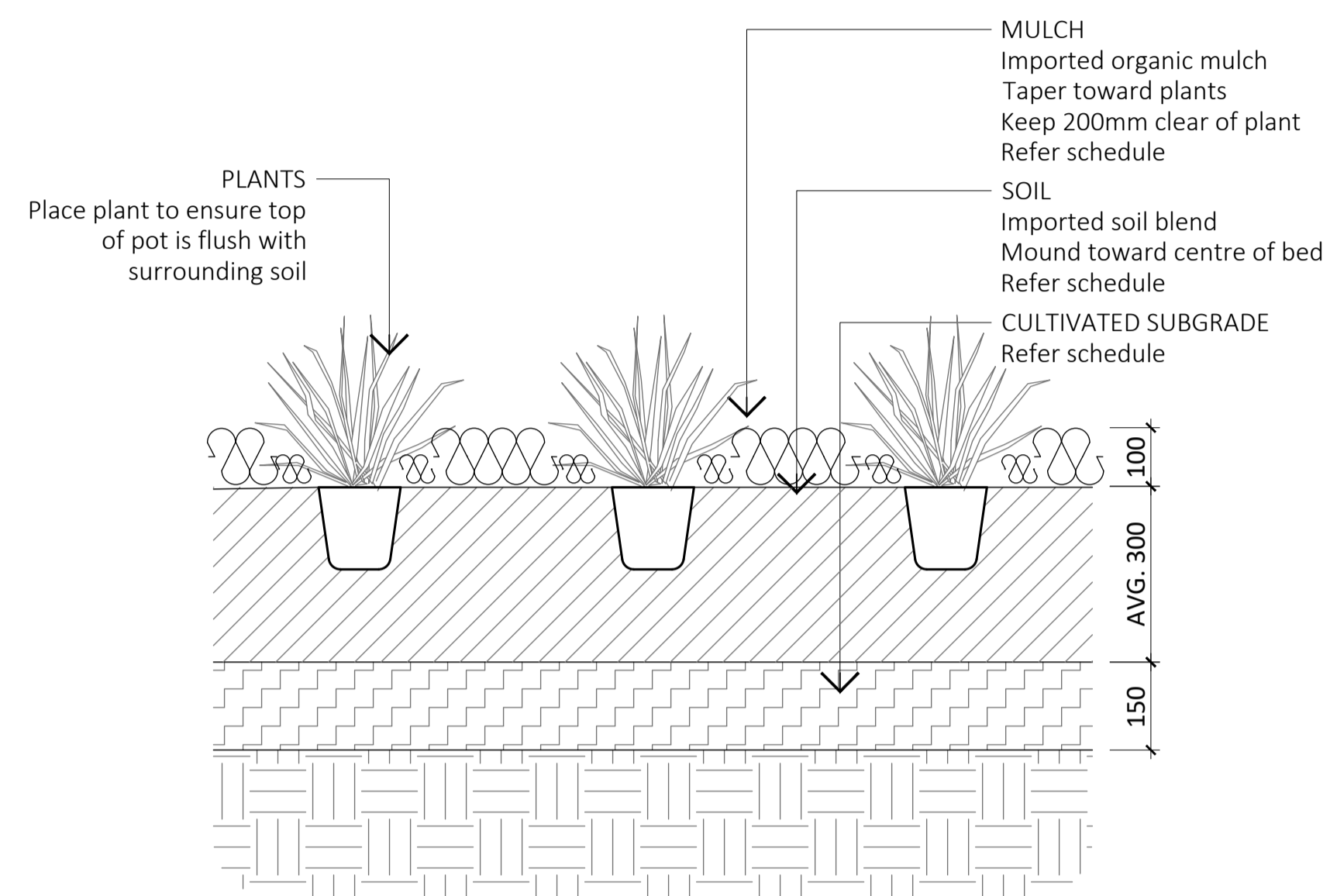

3 PA3 - DRAINAGE RESERVE BUND
Scale 1:10

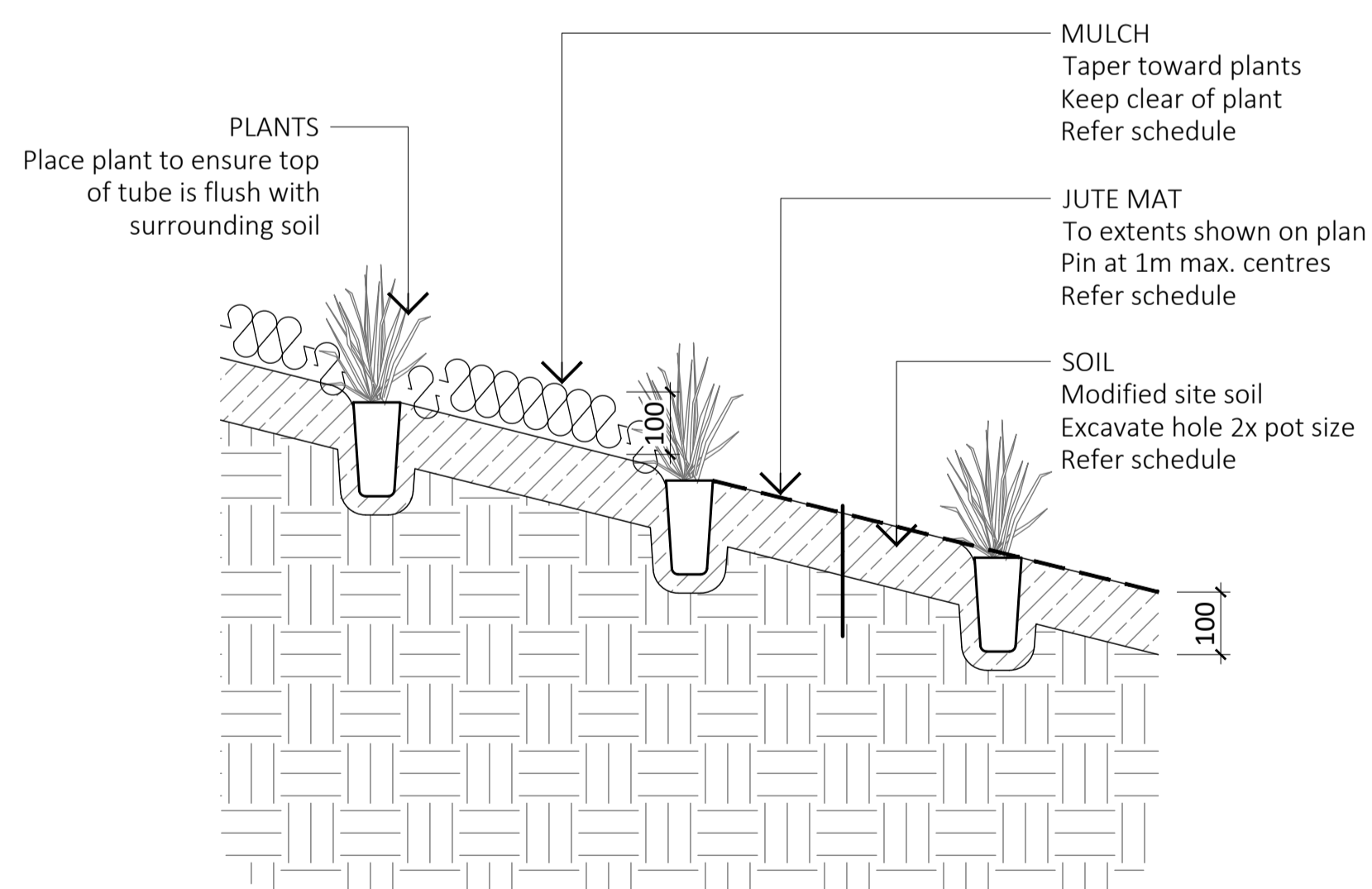

4 PA2 - DRAINAGE RESERVE BATTER
Scale 1:10

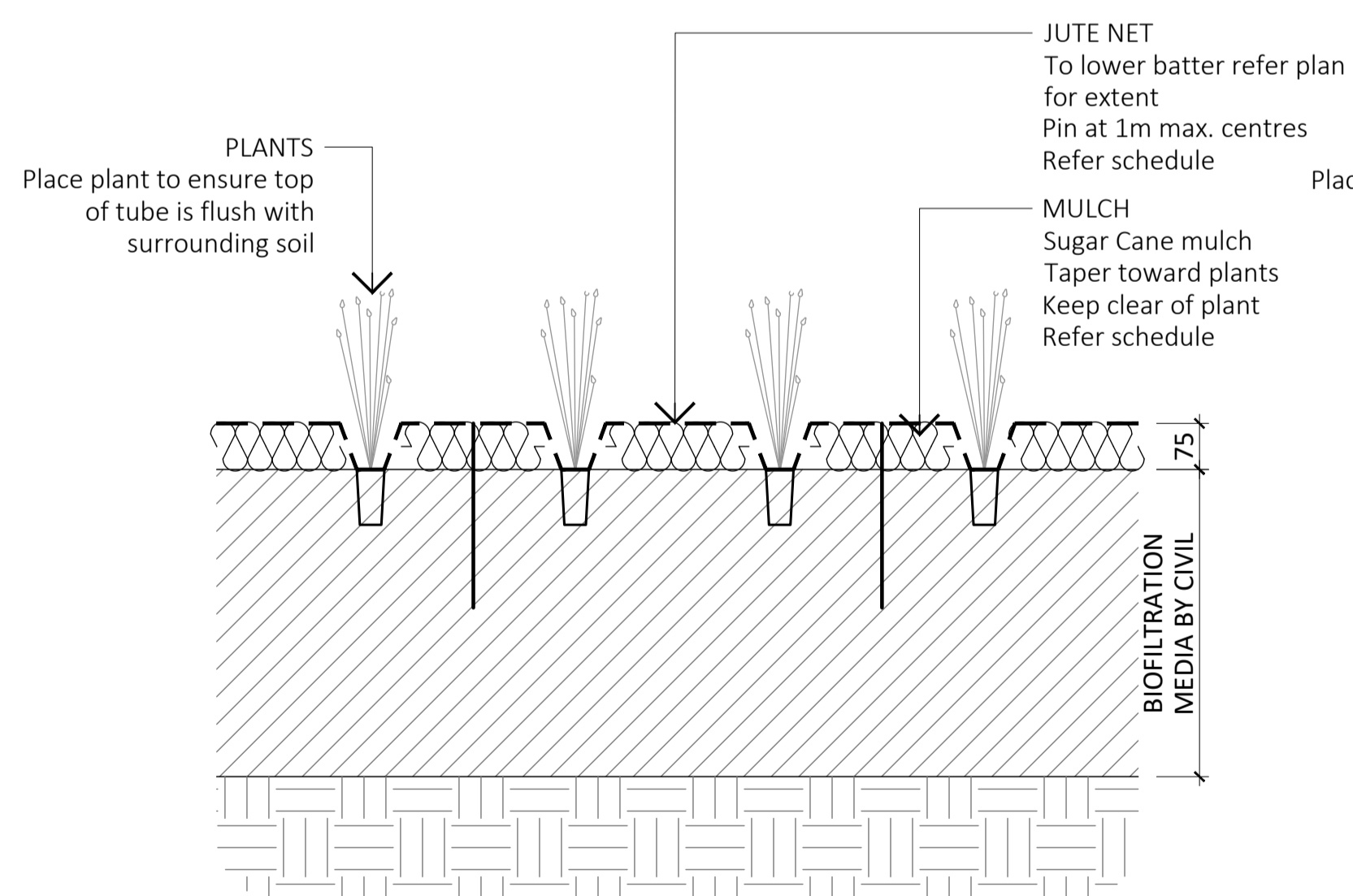

5 PA3 - DRAINAGE RESERVE FLOOR
Scale 1:10

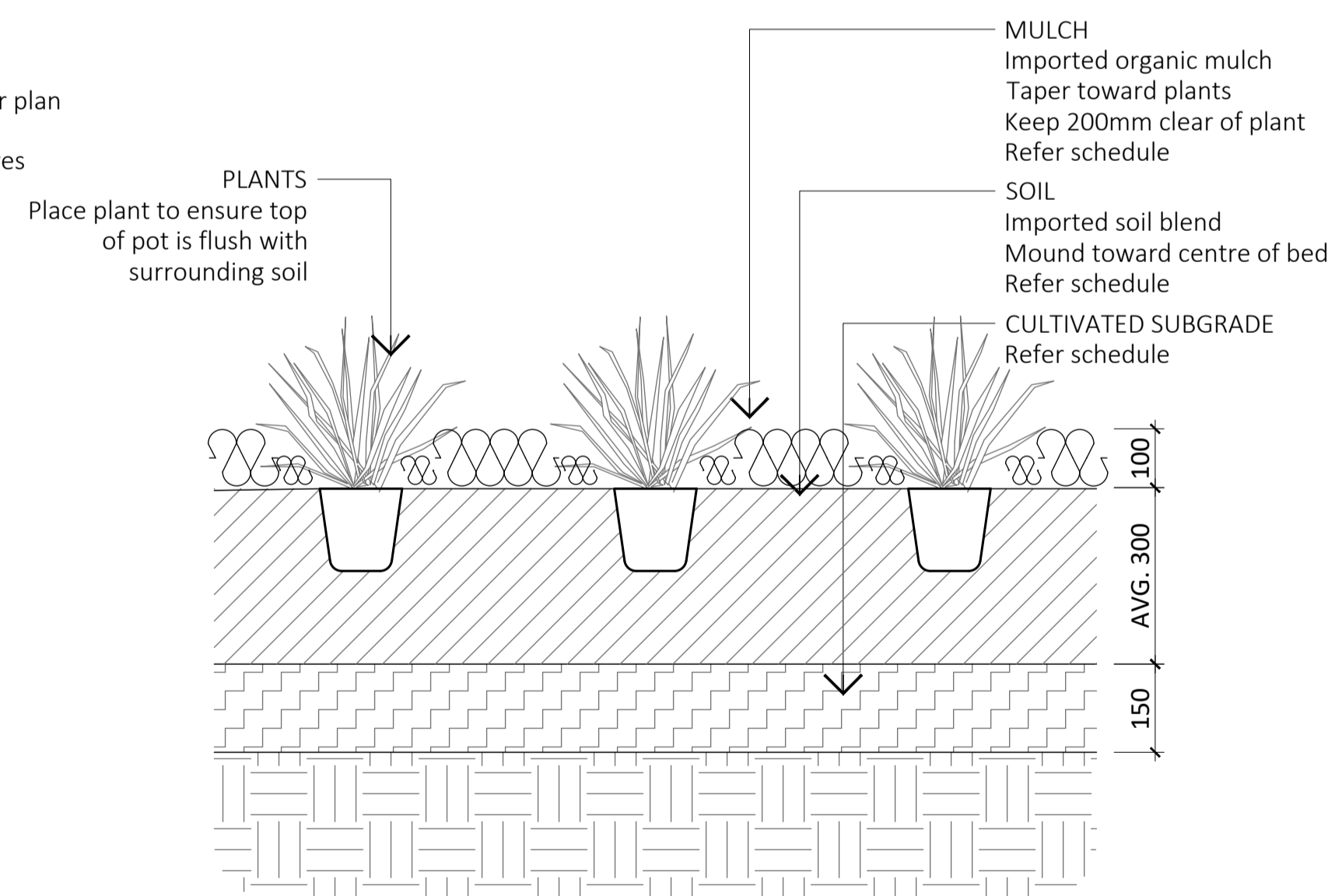

6 PA4 - GENERAL PLANTING
Scale 1:10

| | | | | | |
|-------|--------------|------------|-----|----|----|
| C | FOR APPROVAL | 2025-10-29 | QS | DM | DM |
| B | FOR APPROVAL | 2025-08-06 | QS | DM | DM |
| A | FOR APPROVAL | 2025-02-04 | DD | ME | ME |
| ISSUE | DETAILS | DATE | DES | DC | QA |

PROJECT TITLE
20 - 46 LINDENTHAL ROAD
PARK RIDGE

CLIENT
BHAVIN GANDHI

PLAN TITLE

LANDSCAPE PLAN
DETAILS

| | | | | |
|-----------------|------|-------|------|-------|
| DOCUMENT NUMBER | AREA | STAGE | PLAN | ISSUE |
| B4703L A1_DA1 | | LP05 | C | |

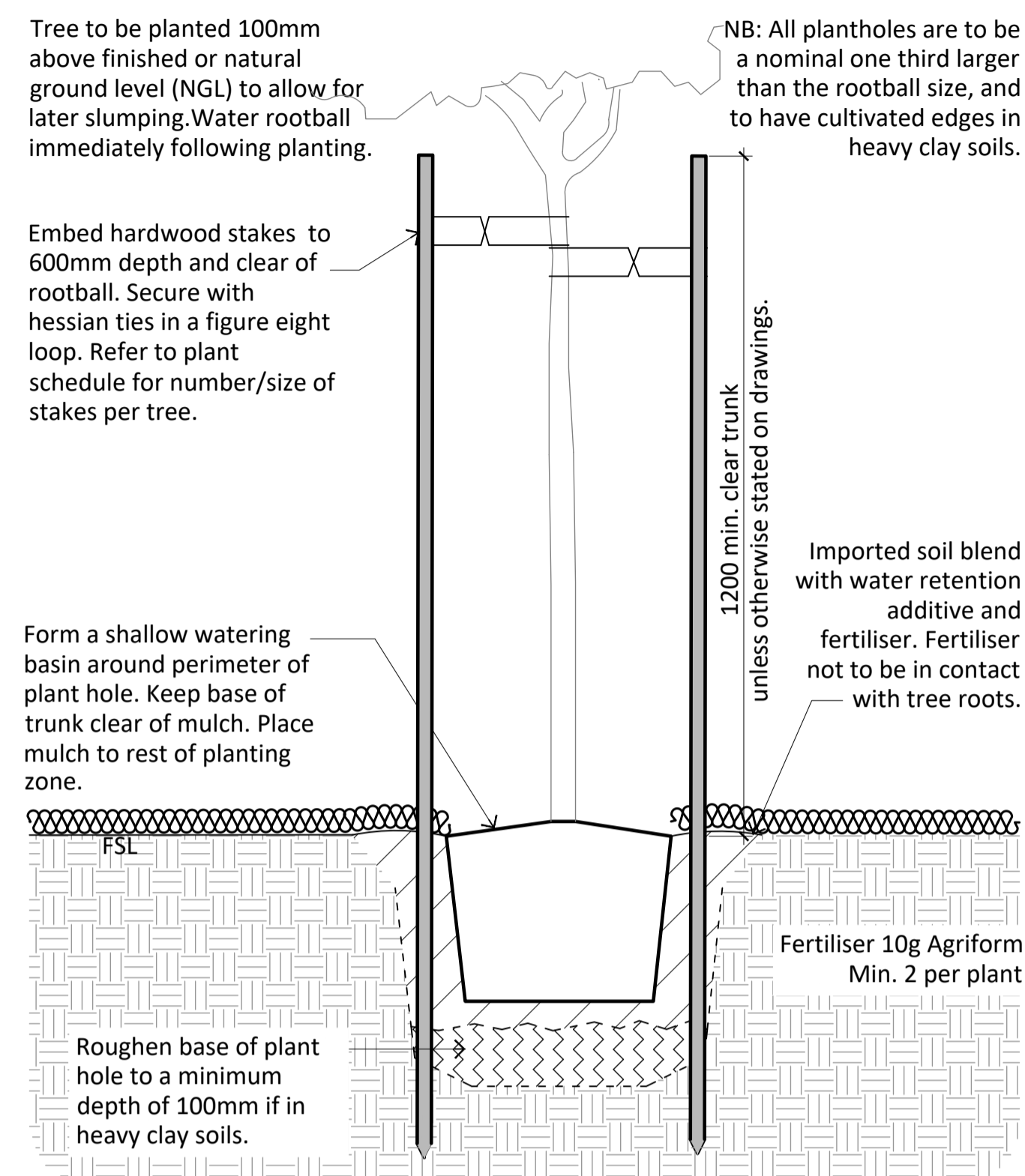

6 ADVANCED TREE PLANTING
Scale 1:10

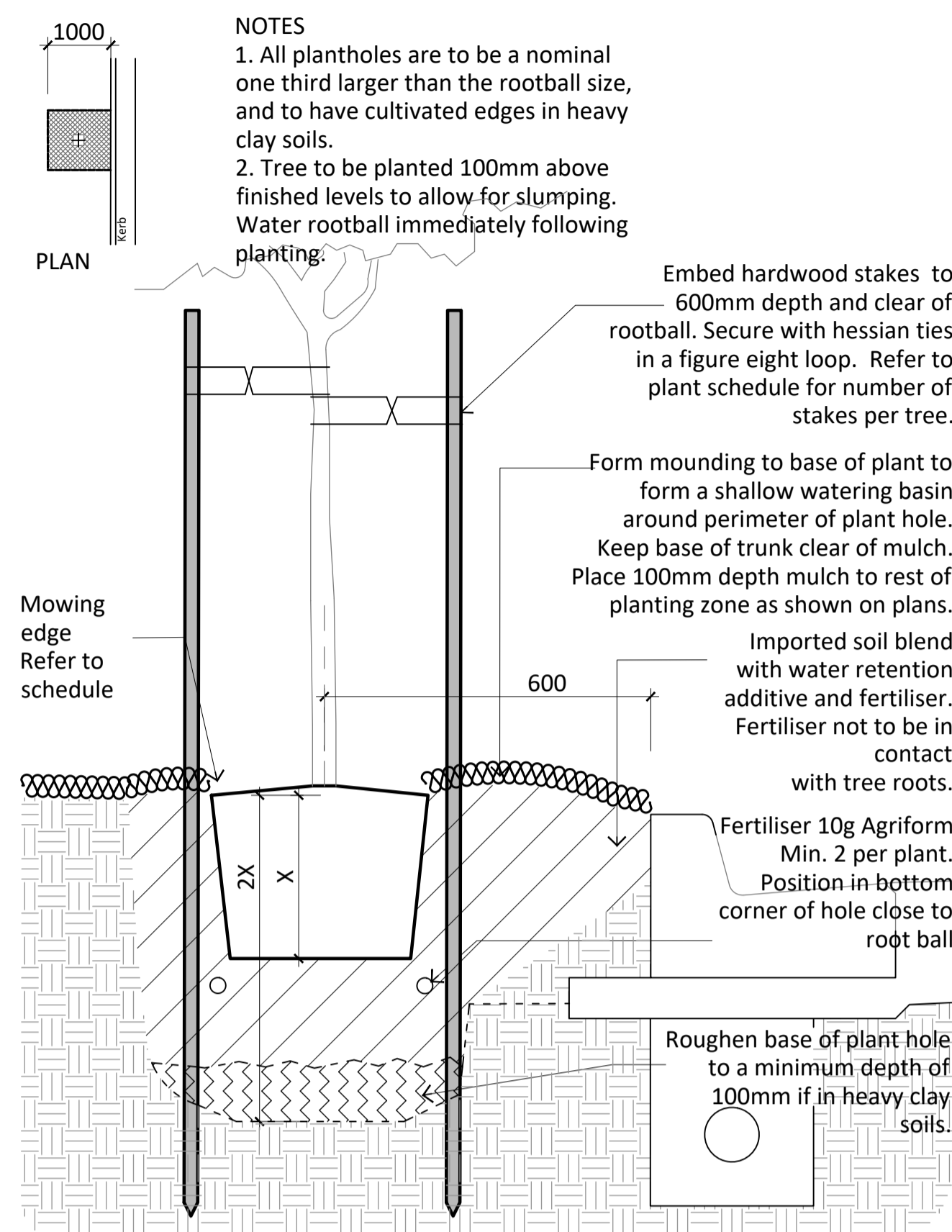

7 TYPICAL STREET TREE PLANTING
Scale 1:10

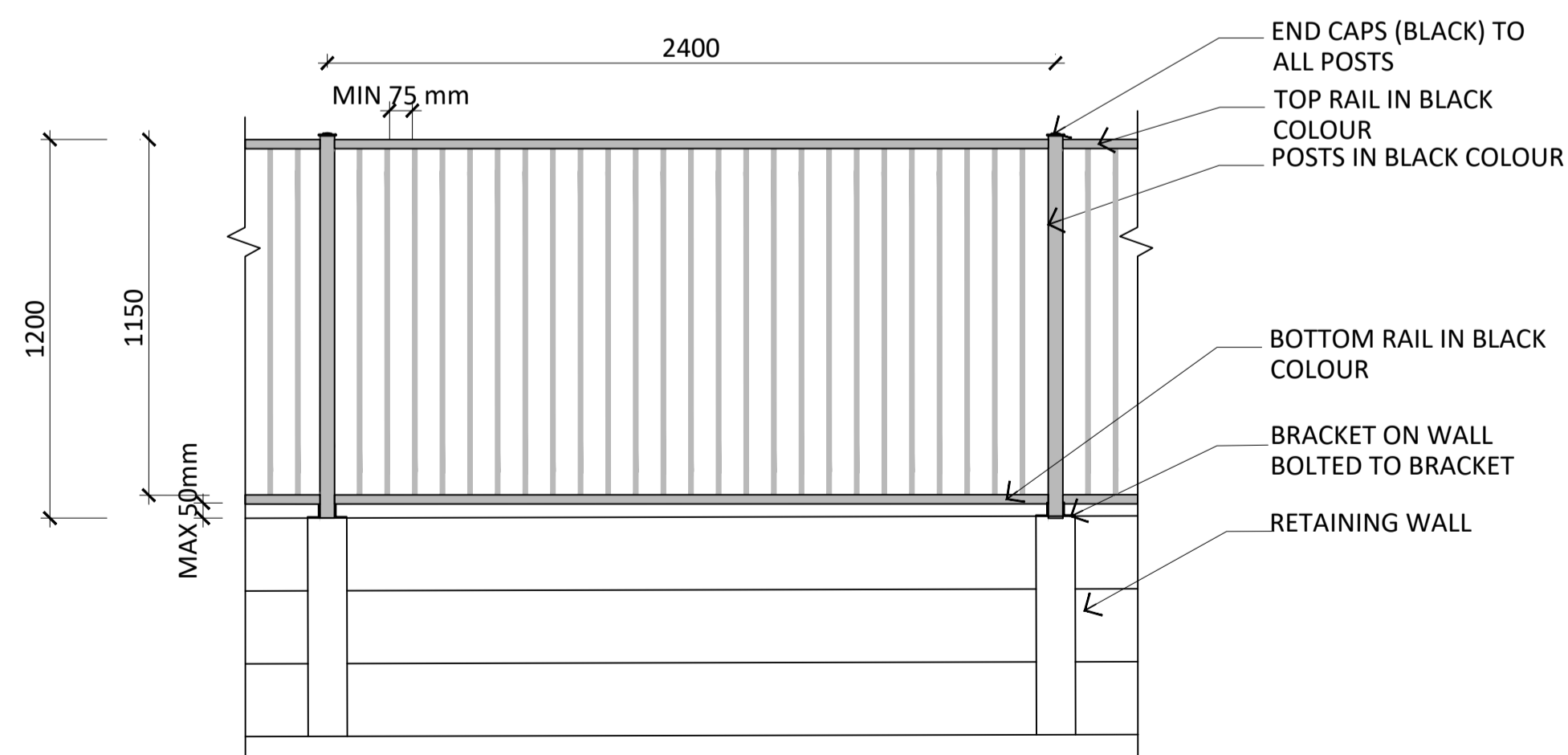

ELEVATION

8 FENCE 1
Scale 1:20

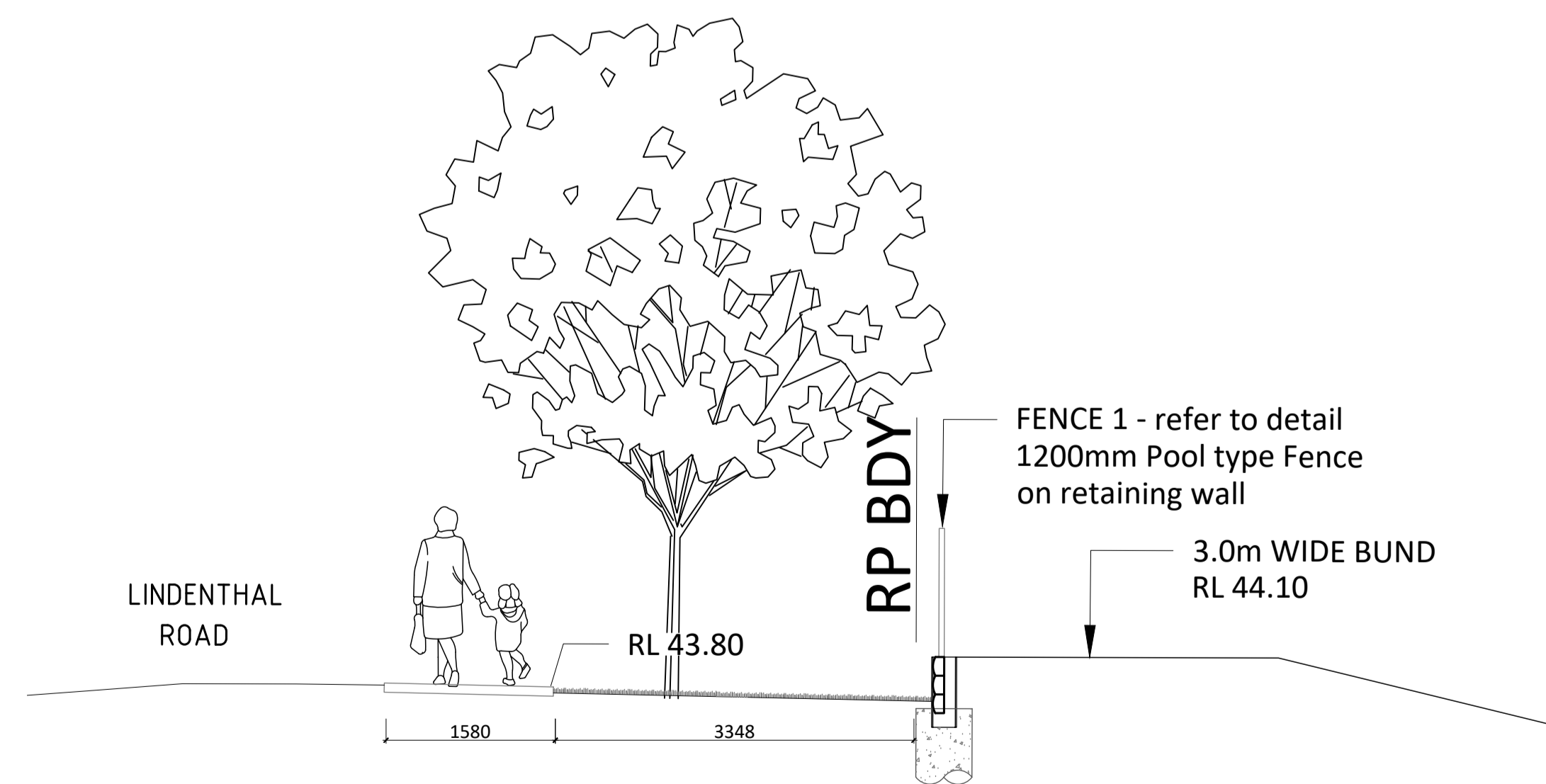

A SECTION A refer to JFP CIVIL B4703EA1_DA1_CE03
Scale 1:50

| | | | | | |
|-------|--------------|------------|-----|----|----|
| C | FOR APPROVAL | 2025-10-29 | QS | DM | DM |
| B | FOR APPROVAL | 2025-08-06 | QS | DM | DM |
| A | FOR APPROVAL | 2025-02-04 | DD | ME | ME |
| ISSUE | DETAILS | DATE | DES | DC | QA |

PROJECT TITLE
20 - 46 LINDENTHAL ROAD
PARK RIDGE

CLIENT
BHAVIN GANDHI

PLAN TITLE
LANDSCAPE PLAN
DETAILS

| | | | | |
|-----------------|------|-------|------|-------|
| DOCUMENT NUMBER | AREA | STAGE | PLAN | ISSUE |
| B4703L A1_DA1 | | LP06 | | C |