

03.00 Development Assessment

VEGETATION CLEARING PLANS

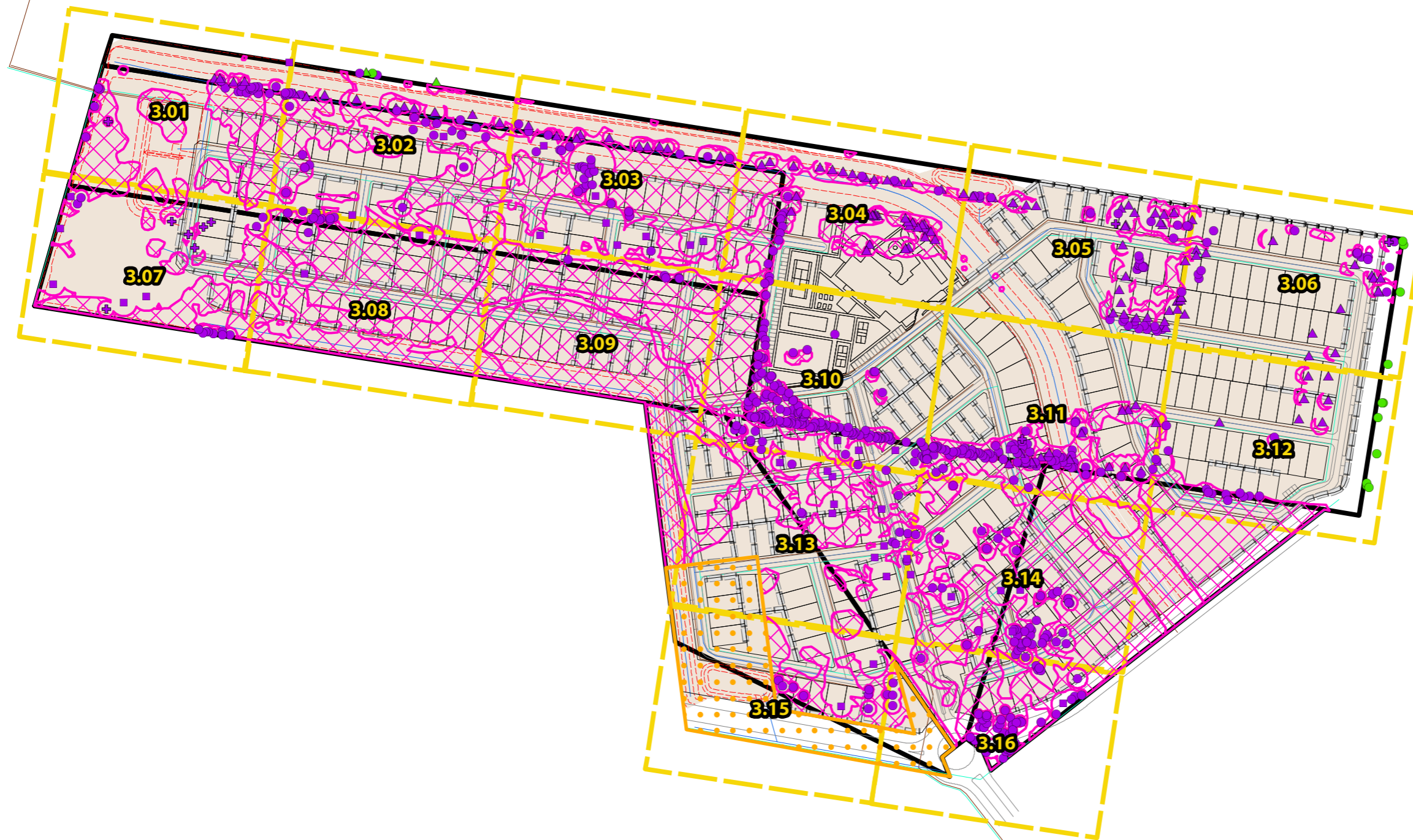

Notes:
 This plan was prepared as a desktop assessment tool. The information on this plan is not suitable for any other purpose. Property dimensions, areas, numbers of lots and contours and other physical features shown have been compiled from existing information and may not have been verified by field survey. These may need verification if the development application is approved and development proceeds, and may change when a full survey is undertaken or in order to comply with development approval conditions. No reliance should be placed on the information on this plan for detailed design or for any financial dealings involving the land. Saunders Havill Group therefore disclaims any liability for any loss or damage whatsoever or howsoever incurred, arising from any party using or relying upon this plan for any purpose other than as a document prepared for the sole purpose of accompanying a development application and which may be subject to alteration beyond the control of the Saunders Havill Group. Unless a development approval states otherwise, this is not an approved plan.

Layer Sources
 © State of Queensland (Department of Resources) 2024.
 Updated data available at
<http://qldspatialinformation.qld.gov.au/catalogue/>

* This note is an integral part of this plan/data. Reproduction of this plan or any part of it without this note being included in full will render the information shown on such reproduction invalid and not suitable for use.

Legend

- Site DCDB
- Qld DCDB
- GPS Tree Plot**
 - LCC Native Tree to Retain [12]
 - Introduced Tree to Retain [2]
 - LCC Native Habitat Tree to Remove [42]
 - LCC Native Tree to Remove [504]
 - Dead/Stag Tree to Remove [10]
 - Introduced Tree to Remove [141]
- Additional Vegetated Areas to Remove - 84,753 m² **84,573m²**
- Engineering Detail**
 - Proposed Lots
 - Proposed Roads and Footpaths
 - Earthworks Batters
 - Retaining Walls
 - Swale Design
 - Sewer Design
 - Water Design
 - Earthworks Extent
 - Vegetation to be removed in accordance with OWVM/7/2023

LOGAN CITY COUNCIL

APPROVED DOCUMENT

This is an approved document for Development Application

MCUI/12/2023

Issue	Date	Description	Drawn	Checked
A	18/11/2022	Preliminary	LS	KT
E	3/09/2024	Council Response	TF	KT

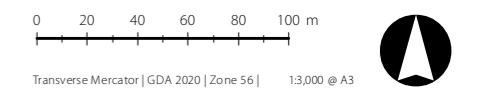

Address / RPD: Logan Reserve

03.01 Development Assessment

Notes:
 This plan was prepared as a desktop assessment tool. The information on this plan is not suitable for any other purpose. Property dimensions, areas, numbers of lots and contours and other physical features shown have been compiled from existing information and may not have been verified by field survey. These may need verification if the development application is approved and development proceeds, and may change when a full survey is undertaken or in order to comply with development approval conditions. No reliance should be placed on the information on this plan for detailed design or for any financial dealings involving the land. Saunders Havill Group therefore disclaims any liability for any loss or damage whatsoever or howsoever incurred, arising from any party using or relying upon this plan for any purpose other than as a document prepared for the sole purpose of accompanying a development application and which may be subject to alteration beyond the control of the Saunders Havill Group. Unless a development approval states otherwise, this is not an approved plan.

Layer Sources
 ©State of Queensland (Department of Resources) 2024.
 Updated data available at <http://qldspatialinformation.qld.gov.au/catalogue/>

* This note is an integral part of this plan/data. Reproduction of this plan or any part of it without this note being included in full will render the information shown on such reproduction invalid and not suitable for use.

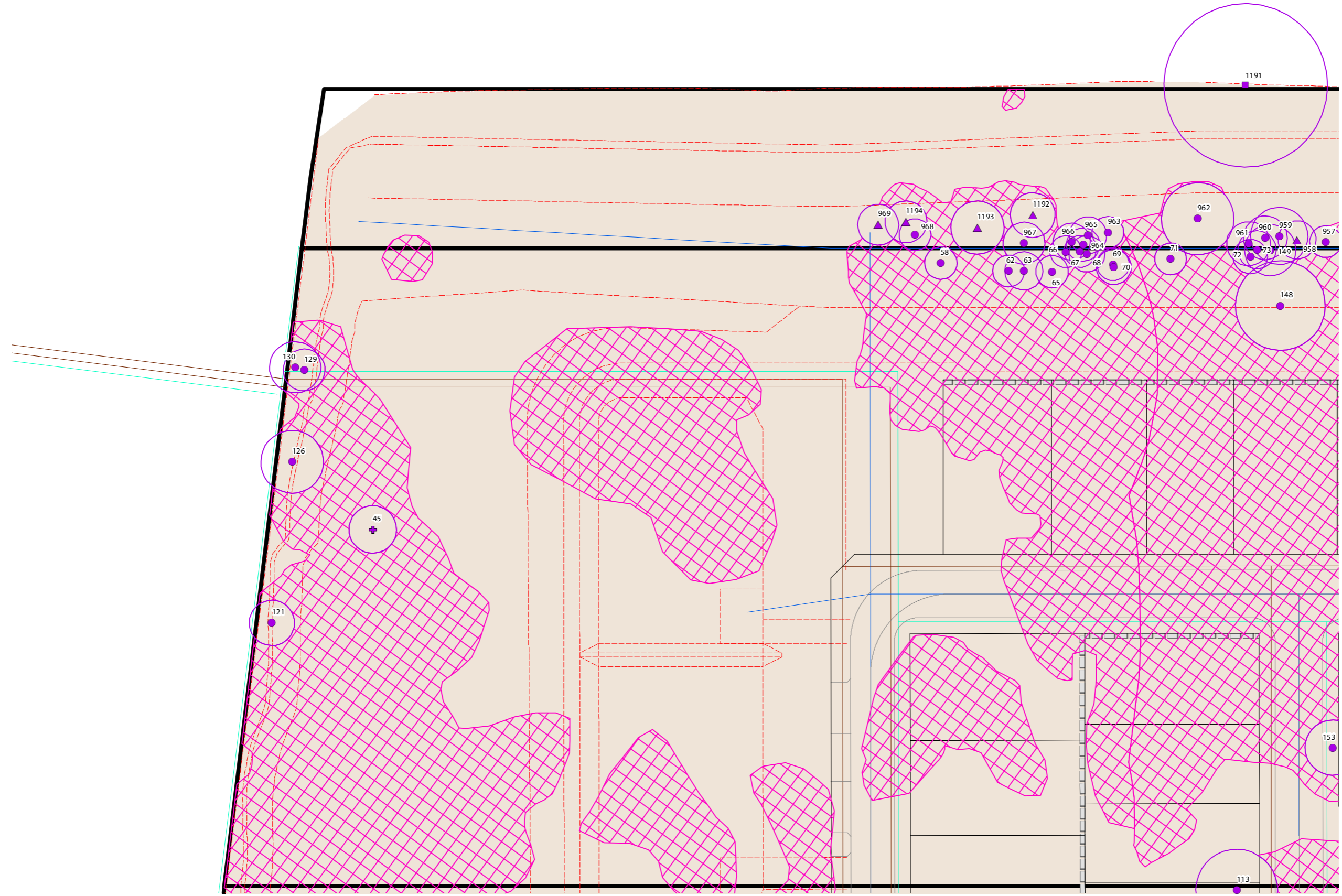

Legend

- Site DCDB
- Qld DCDB
- GPS Tree Plot (w/ TPZ)**
- LCC Native Tree to Retain [12]
- Introduced Tree to Retain [2]
- LCC Native Habitat Tree to Remove [42]
- LCC Native Tree to Remove [504]
- Dead/Stag Tree to Remove [10]
- Introduced Tree to Remove [141]
- Additional Vegetated Areas to Remove - 84,753 m² **84,573m²**
- Engineering Detail**
- Proposed Lots
- Proposed Roads and Footpaths
- Earthworks Batters
- Retaining Walls
- Swale Design
- Sewer Design
- Water Design
- Earthworks Extent
- Vegetation to be removed in accordance with OWVM/7/2023

Issue	Date	Description	Drawn	Checked
A	18/11/2022	Preliminary	LS	KT
E	3/09/2024	Council Response	TF	KT

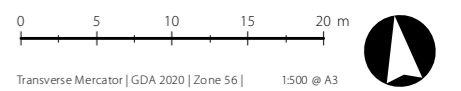

Address / RPD: Logan Reserve

3/09/2024 | 9277 E 03_1 Development E



Chambers Flat Road, Logan Reserve

03.03 Development Assessment

Notes:
 This plan was prepared as a desktop assessment tool. The information on this plan is not suitable for any other purpose. Property dimensions, areas, numbers of lots and contours and other physical features shown have been compiled from existing information and may not have been verified by field survey. These may need verification if the development application is approved and development proceeds, and may change when a full survey is undertaken or in order to comply with development approval conditions. No reliance should be placed on the information on this plan for detailed design or for any financial dealings involving the land. Saunders Havill Group therefore disclaims any liability for any loss or damage whatsoever or howsoever incurred, arising from any party using or relying upon this plan for any purpose other than as a document prepared for the sole purpose of accompanying a development application and which may be subject to alteration beyond the control of the Saunders Havill Group. Unless a development approval states otherwise, this is not an approved plan.

Layer Sources
 ©State of Queensland (Department of Resources) 2024.
 Updated data available at
<http://qldspatialinformation.qld.gov.au/catalogue/>

* This note is an integral part of this plan/data. Reproduction of this plan or any part of it without this note being included in full will render the information shown on such reproduction invalid and not suitable for use.

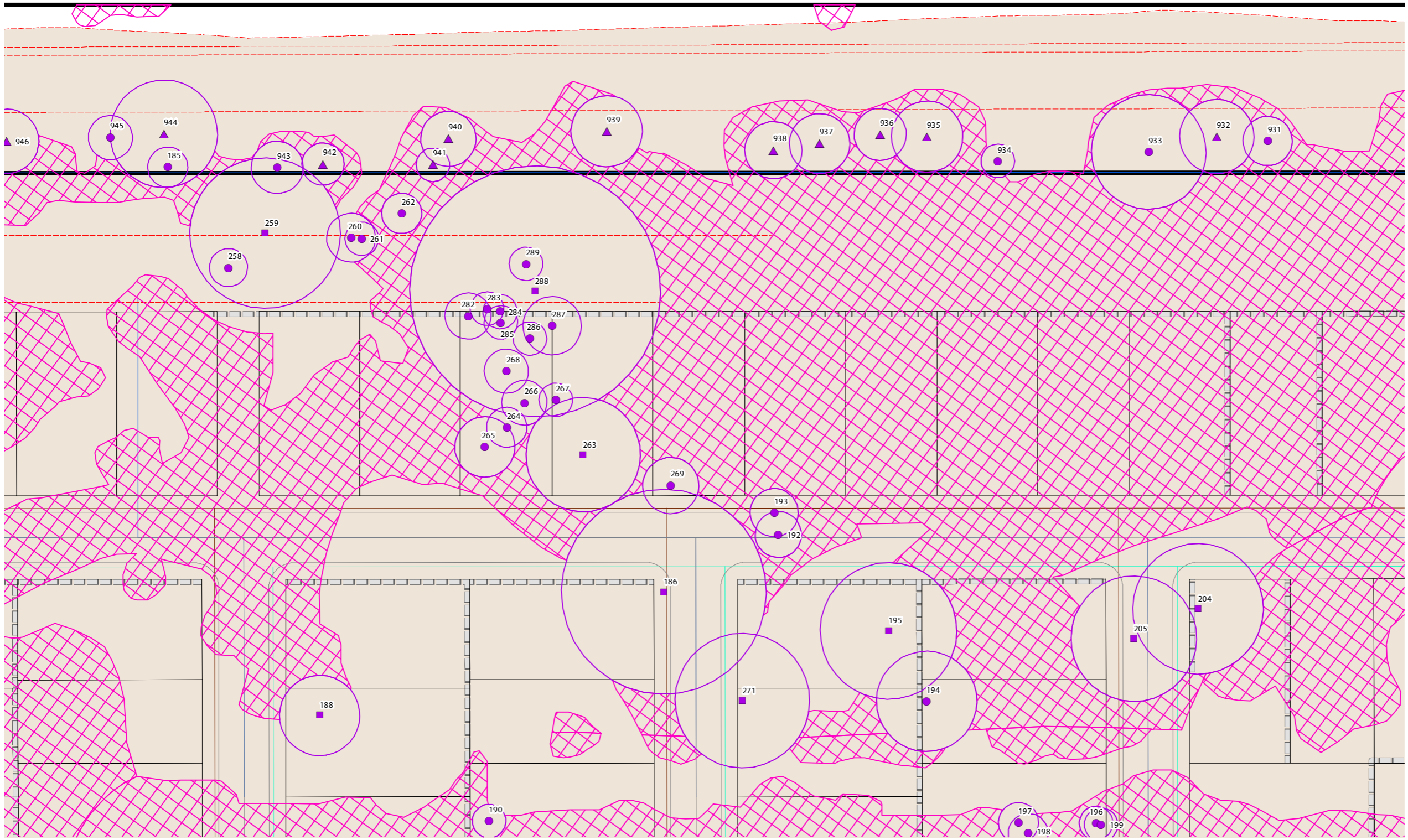

Legend

- Site DCDB
- Qld DCDB

GPS Tree Plot (w/ TPZ)

- LCC Native Tree to Retain [12]
- Introduced Tree to Retain [2]
- LCC Native Habitat Tree to Remove [42]
- LCC Native Tree to Remove [504]
- Dead/Stag Tree to Remove [10]
- Introduced Tree to Remove [141]

Additional Vegetated Areas to Remove - 84,753 m² **84,573m²**

Engineering Detail

- Proposed Lots
- Proposed Roads and Footpaths
- Earthworks Batters
- Retaining Walls
- Swale Design
- Sewer Design
- Water Design
- Earthworks Extent
- Vegetation to be removed in accordance with OWVM/7/2023

Issue	Date	Description	Drawn	Checked
A	18/11/2022	Preliminary	LS	KT
E	3/09/2024	Council Response	TF	KT

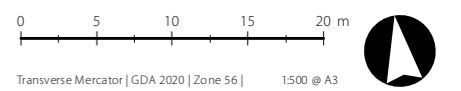

03.04 Development Assessment

Notes:
 This plan was prepared as a desktop assessment tool. The information on this plan is not suitable for any other purpose. Property dimensions, areas, numbers of lots and contours and other physical features shown have been compiled from existing information and may not have been verified by field survey. These may need verification if the development application is approved and development proceeds, and may change when a full survey is undertaken or in order to comply with development approval conditions. No reliance should be placed on the information on this plan for detailed design or for any financial dealings involving the land. Saunders Havill Group therefore disclaims any liability for any loss or damage whatsoever or howsoever incurred, arising from any party using or relying upon this plan for any purpose other than as a document prepared for the sole purpose of accompanying a development application and which may be subject to alteration beyond the control of the Saunders Havill Group. Unless a development approval states otherwise, this is not an approved plan.

Layer Sources
 ©State of Queensland (Department of Resources) 2024.
 Updated data available at
<http://qldspatialinformation.qld.gov.au/catalogue/>

* This note is an integral part of this plan/data. Reproduction of this plan or any part of it without this note being included in full will render the information shown on such reproduction invalid and not suitable for use.

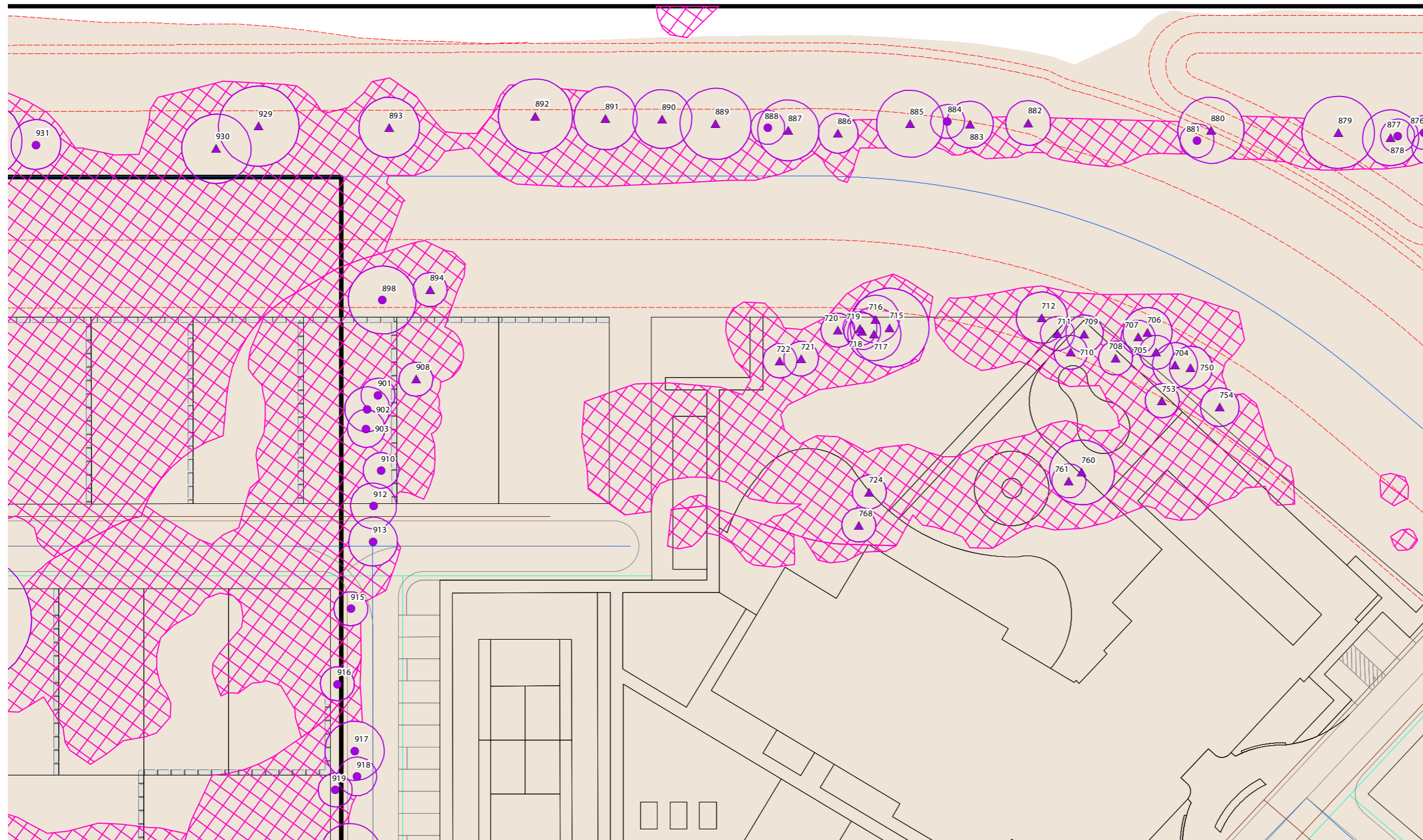

Legend

- Site DCDB
- Qld DCDB
- GPS Tree Plot (w/ TPZ)**
- LCC Native Tree to Retain [12]
- Introduced Tree to Retain [2]
- LCC Native Habitat Tree to Remove [42]
- LCC Native Tree to Remove [504]
- Dead/Stag Tree to Remove [10]
- Introduced Tree to Remove [141]
- Additional Vegetated Areas to Remove - 84,753 m² **84,573m²**
- Engineering Detail**
- Proposed Lots
- Proposed Roads and Footpaths
- Earthworks Batters
- Retaining Walls
- Swale Design
- Sewer Design
- Water Design
- Earthworks Extent
- Vegetation to be removed in accordance with OWVM/7/2023

Issue	Date	Description	Drawn	Checked
A	18/11/2022	Preliminary	LS	KT
E	3/09/2024	Council Response	TF	KT

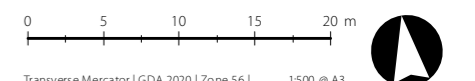

03.05 Development Assessment

Notes:
 This plan was prepared as a desktop assessment tool. The information on this plan is not suitable for any other purpose. Property dimensions, areas, numbers of lots and contours and other physical features shown have been compiled from existing information and may not have been verified by field survey. These may need verification if the development application is approved and development proceeds, and may change when a full survey is undertaken or in order to comply with development approval conditions. No reliance should be placed on the information on this plan for detailed design or for any financial dealings involving the land. Saunders Havill Group therefore disclaims any liability for any loss or damage whatsoever or howsoever incurred, arising from any party using or relying upon this plan for any purpose other than as a document prepared for the sole purpose of accompanying a development application and which may be subject to alteration beyond the control of the Saunders Havill Group. Unless a development approval states otherwise, this is not an approved plan.
 Layer Sources
 © State of Queensland (Department of Resources) 2024.
 Updated data available at
<http://qldspatialinformation.qld.gov.au/catalogue/>
 * This note is an integral part of this plan/data. Reproduction of this plan or any part of it without this note being included in full will render the information shown on such reproduction invalid and not suitable for use.

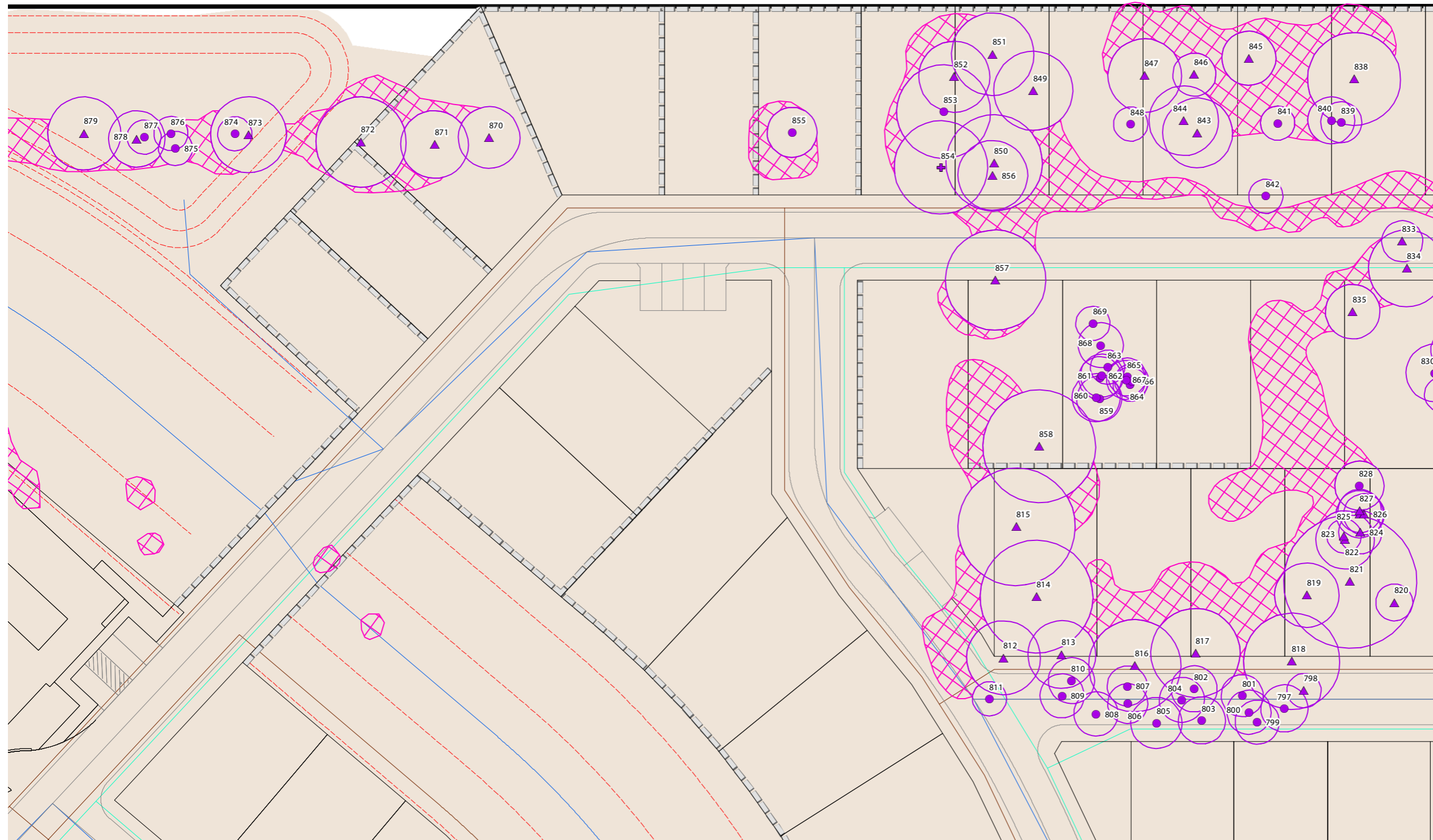

Legend

- Site DCDB
- Qld DCDB
- GPS Tree Plot (w/ TPZ)**
- LCC Native Tree to Retain [12]
- Introduced Tree to Retain [2]
- LCC Native Habitat Tree to Remove [42]
- LCC Native Tree to Remove [504]
- Dead/Stag Tree to Remove [10]
- Introduced Tree to Remove [141]
- Additional Vegetated Areas to Remove - 84,753 m² **84,573m²**
- Engineering Detail**
- Proposed Lots
- Proposed Roads and Footpaths
- Earthworks Batters
- Retaining Walls
- Swale Design
- Sewer Design
- Water Design
- Earthworks Extent
- Vegetation to be removed in accordance with OWVM/7/2023

Issue	Date	Description	Drawn	Checked
A	18/11/2022	Preliminary	LS	KT
E	3/09/2024	Council Response	TF	KT

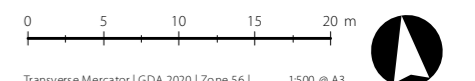

03.06 Development Assessment

Notes:
 This plan was prepared as a desktop assessment tool. The information on this plan is not suitable for any other purpose. Property dimensions, areas, numbers of lots and contours and other physical features shown have been compiled from existing information and may not have been verified by field survey. These may need verification if the development application is approved and development proceeds, and may change when a full survey is undertaken or in order to comply with development approval conditions. No reliance should be placed on the information on this plan for detailed design or for any financial dealings involving the land. Saunders Havill Group therefore disclaims any liability for any loss or damage whatsoever or howsoever incurred, arising from any party using or relying upon this plan for any purpose other than as a document prepared for the sole purpose of accompanying a development application and which may be subject to alteration beyond the control of the Saunders Havill Group. Unless a development approval states otherwise, this is not an approved plan.

Layer Sources
 ©State of Queensland (Department of Resources) 2024.
 Updated data available at
<http://qldspatialinformation.qld.gov.au/catalogue/>

* This note is an integral part of this plan/data. Reproduction of this plan or any part of it without this note being included in full will render the information shown on such reproduction invalid and not suitable for use.

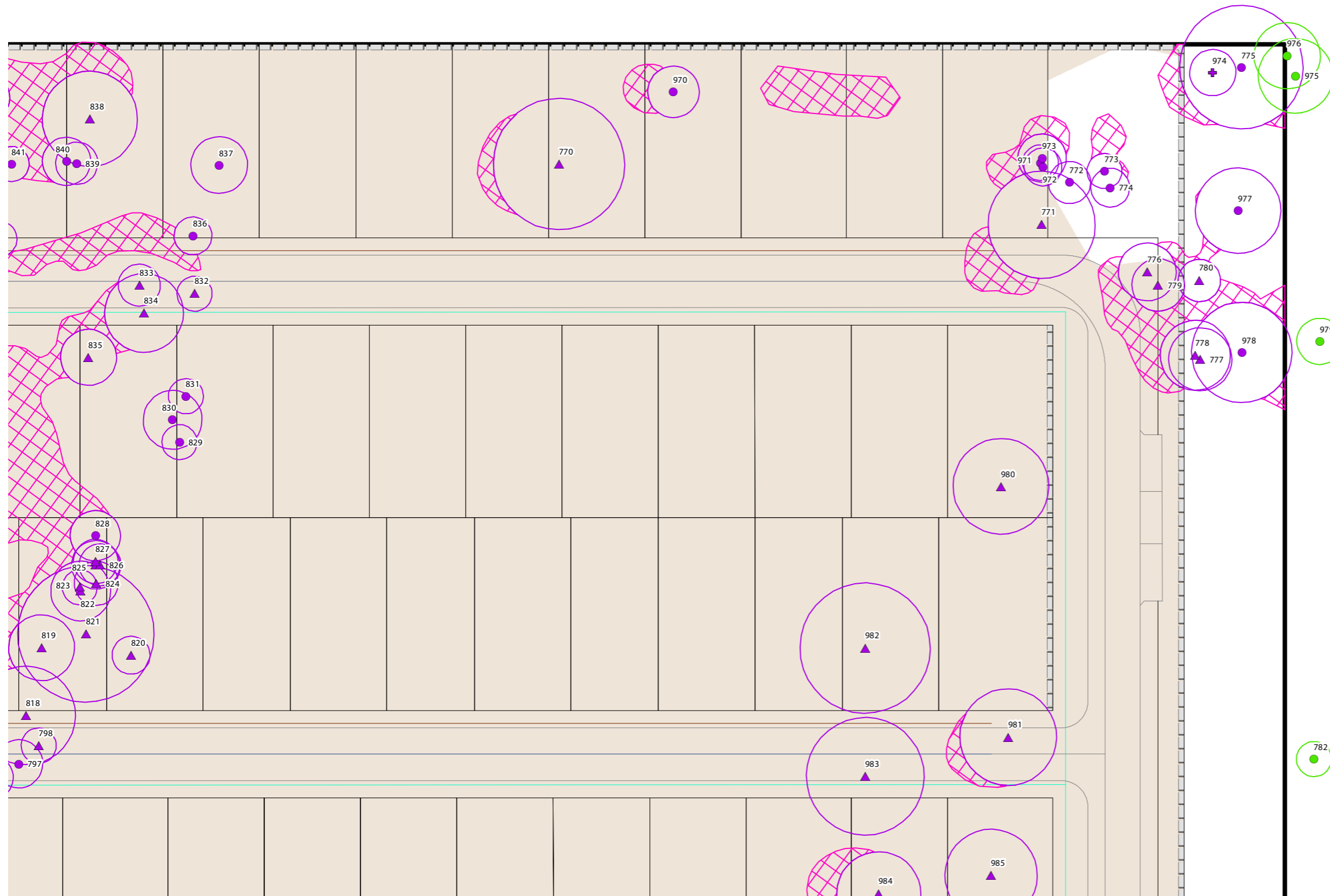

Legend

- Site DCDB
- Qld DCDB
- GPS Tree Plot (w/ TPZ)**
- LCC Native Tree to Retain [12]
- Introduced Tree to Retain [2]
- LCC Native Habitat Tree to Remove [42]
- LCC Native Tree to Remove [504]
- Dead/Stag Tree to Remove [10]
- Introduced Tree to Remove [141]
- Additional Vegetated Areas to Remove - 84,753 m² **84,573m²**
- Engineering Detail**
- Proposed Lots
- Proposed Roads and Footpaths
- Earthworks Batters
- Retaining Walls
- Swale Design
- Sewer Design
- Water Design
- Earthworks Extent
- Vegetation to be removed in accordance with OWVM/7/2023

Issue	Date	Description	Drawn	Checked
A	18/11/2022	Preliminary	LS	KT
E	3/09/2024	Council Response	TF	KT



03.07 Development Assessment

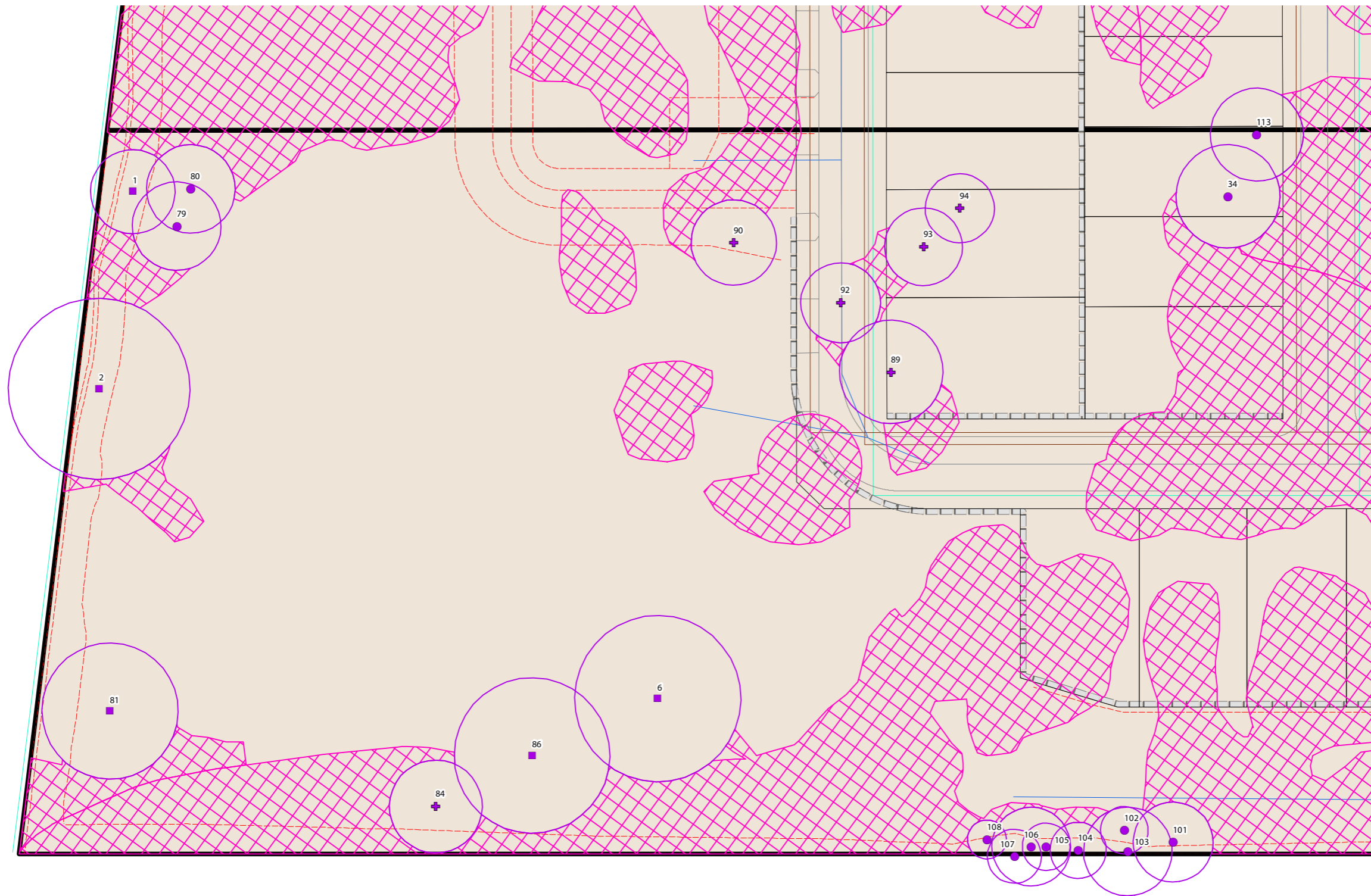

Notes:
 This plan was prepared as a desktop assessment tool. The information on this plan is not suitable for any other purpose. Property dimensions, areas, numbers of lots and contours and other physical features shown have been compiled from existing information and may not have been verified by field survey. These may need verification if the development application is approved and development proceeds, and may change when a full survey is undertaken or in order to comply with development approval conditions. No reliance should be placed on the information on this plan for detailed design or for any financial dealings involving the land. Saunders Havill Group therefore disclaims any liability for any loss or damage whatsoever or howsoever incurred, arising from any party using or relying upon this plan for any purpose other than as a document prepared for the sole purpose of accompanying a development application and which may be subject to alteration beyond the control of the Saunders Havill Group. Unless a development approval states otherwise, this is not an approved plan.
Layer Sources
 ©State of Queensland (Department of Resources) 2024.
 Updated data available at <http://qldspatialinformation.qld.gov.au/catalogue/>
 * This note is an integral part of this plan/data. Reproduction of this plan or any part of it without this note being included in full will render the information shown on such reproduction invalid and not suitable for use.

Legend

- Site DCDB
- Qld DCDB
- GPS Tree Plot (w/ TPZ)**
 - LCC Native Tree to Retain [12]
 - Introduced Tree to Retain [2]
 - LCC Native Habitat Tree to Remove [42]
 - LCC Native Tree to Remove [504]
 - Dead/Stag Tree to Remove [10]
 - Introduced Tree to Remove [141]
- Additional Vegetated Areas to Remove - 84,753 m² **84,573m²**
- Engineering Detail**
 - Proposed Lots
 - Proposed Roads and Footpaths
 - Earthworks Batters
 - Retaining Walls
 - Swale Design
 - Sewer Design
 - Water Design
 - Earthworks Extent
 - Vegetation to be removed in accordance with OWVM/7/2023

Issue	Date	Description	Drawn	Checked
A	18/11/2022	Preliminary	LS	KT
E	3/09/2024	Council Response	TF	KT

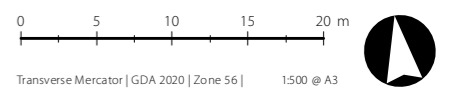

Transverse Mercator | GDA 2020 | Zone 56 | 1:500 @ A3
 Address / RPD: Logan Reserve
 3/09/2024 | 9277 E 03_1 Development E

03.08 Development Assessment

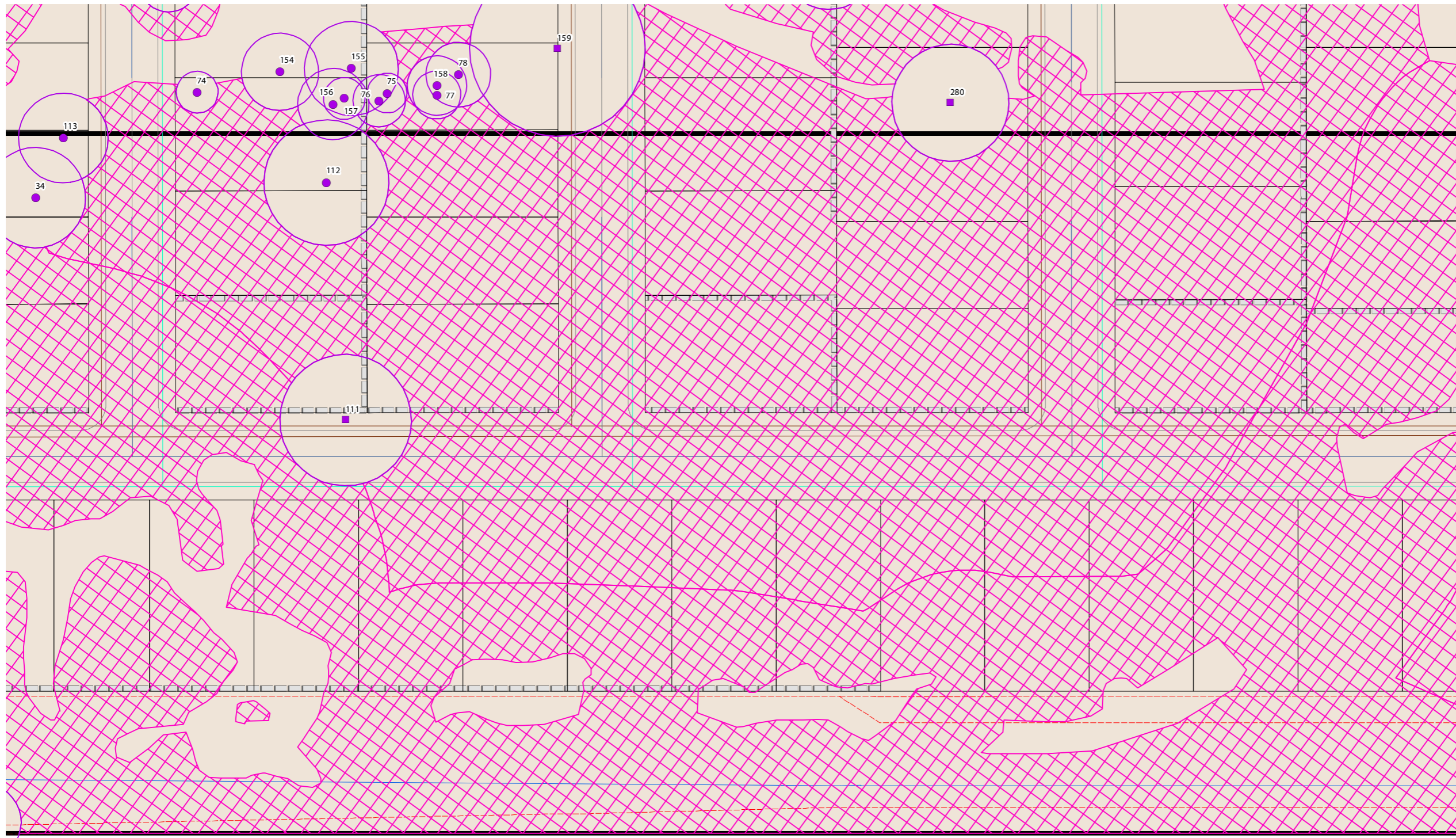

Notes:
 This plan was prepared as a desktop assessment tool. The information on this plan is not suitable for any other purpose. Property dimensions, areas, numbers of lots and contours and other physical features shown have been compiled from existing information and may not have been verified by field survey. These may need verification if the development application is approved and development proceeds, and may change when a full survey is undertaken or in order to comply with development approval conditions. No reliance should be placed on the information on this plan for detailed design or for any financial dealings involving the land. Saunders Havill Group therefore disclaims any liability for any loss or damage whatsoever or howsoever incurred, arising from any party using or relying upon this plan for any purpose other than as a document prepared for the sole purpose of accompanying a development application and which may be subject to alteration beyond the control of the Saunders Havill Group. Unless a development approval states otherwise, this is not an approved plan.
Layer Sources
 ©State of Queensland (Department of Resources) 2024.
 Updated data available at <http://qldspatialinformation.qld.gov.au/catalogue/>
 * This note is an integral part of this plan/data. Reproduction of this plan or any part of it without this note being included in full will render the information shown on such reproduction invalid and not suitable for use.

Legend

- Site DCDB
- Qld DCDB
- GPS Tree Plot (w/ TPZ)**
- LCC Native Tree to Retain [12]
- Introduced Tree to Retain [2]
- LCC Native Habitat Tree to Remove [42]
- LCC Native Tree to Remove [504]
- Dead/Stag Tree to Remove [10]
- Introduced Tree to Remove [141]
- Additional Vegetated Areas to Remove - 84,753 m² **84,573 m²**
- Engineering Detail**
- Proposed Lots
- Proposed Roads and Footpaths
- Earthworks Batters
- Retaining Walls
- Swale Design
- Sewer Design
- Water Design
- Earthworks Extent
- Vegetation to be removed in accordance with OWVM/7/2023

Issue	Date	Description	Drawn	Checked
A	18/11/2022	Preliminary	LS	KT
E	3/09/2024	Council Response	TF	KT

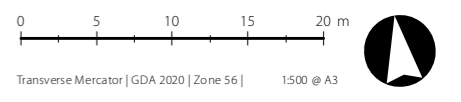

Transverse Mercator | GDA 2020 | Zone 56 | 1:500 @ A3
 Address / RPD: Logan Reserve

03.09 Development Assessment

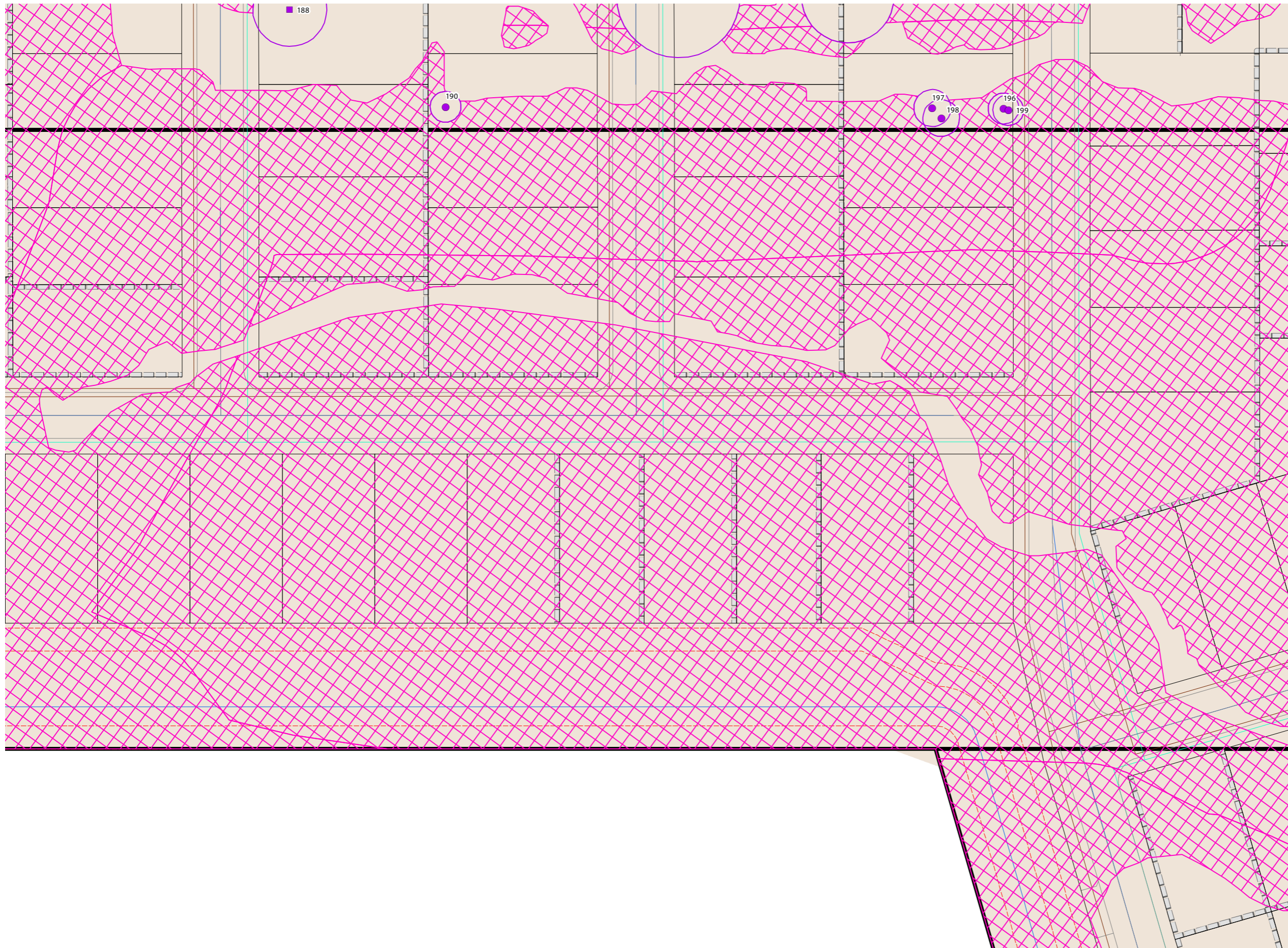

Notes:
 This plan was prepared as a desktop assessment tool. The information on this plan is not suitable for any other purpose. Property dimensions, areas, numbers of lots and contours and other physical features shown have been compiled from existing information and may not have been verified by field survey. These may need verification if the development application is approved and development proceeds, and may change when a full survey is undertaken or in order to comply with development approval conditions. No reliance should be placed on the information on this plan for detailed design or for any financial dealings involving the land. Saunders Havill Group therefore disclaims any liability for any loss or damage whatsoever or howsoever incurred, arising from any party using or relying upon this plan for any purpose other than as a document prepared for the sole purpose of accompanying a development application and which may be subject to alteration beyond the control of the Saunders Havill Group. Unless a development approval states otherwise, this is not an approved plan.

Layer Sources
 ©State of Queensland (Department of Resources) 2024.
 Updated data available at:
<http://qldspatialinformation.qld.gov.au/catalogue/>

* This note is an integral part of this plan/data. Reproduction of this plan or any part of it without this note being included in full will render the information shown on such reproduction invalid and not suitable for use.

Legend

- Site DCDB
- Qld DCDB
- GPS Tree Plot (w/ TPZ)**
- LCC Native Tree to Retain [12]
- Introduced Tree to Retain [2]
- LCC Native Habitat Tree to Remove [42]
- LCC Native Tree to Remove [504]
- Dead/Stag Tree to Remove [10]
- Introduced Tree to Remove [141]
- Additional Vegetated Areas to Remove - 84,753 m² **84,573m²**
- Engineering Detail**
- Proposed Lots
- Proposed Roads and Footpaths
- Earthworks Batters
- Retaining Walls
- Swale Design
- Sewer Design
- Water Design
- Earthworks Extent
- Vegetation to be removed in accordance with OWVM/7/2023

Issue	Date	Description	Drawn	Checked
A	18/11/2022	Preliminary	LS	KT
E	3/09/2024	Council Response	TF	KT

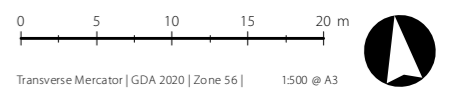

03.10 Development Assessment

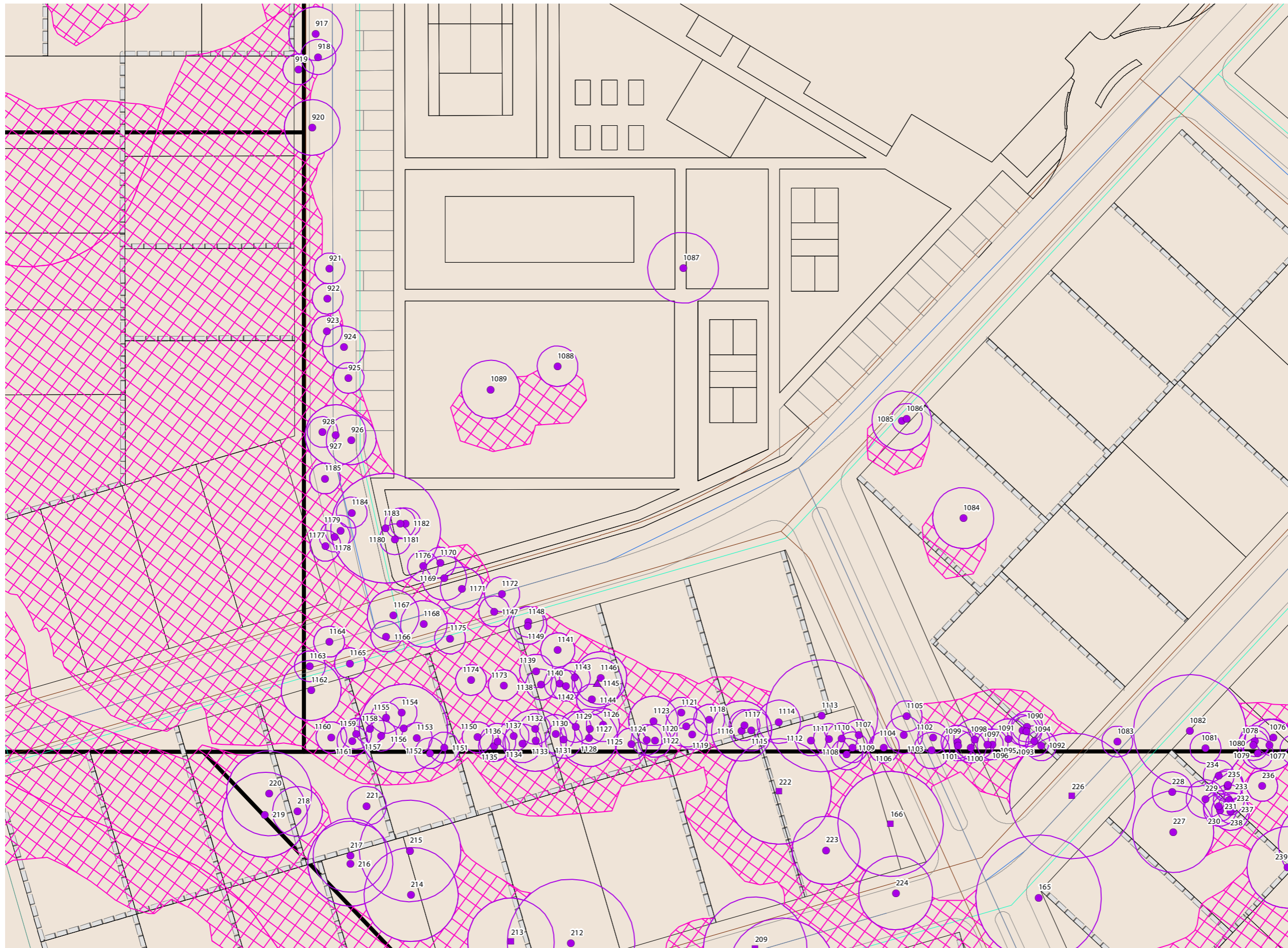

Notes:
 This plan was prepared as a desktop assessment tool. The information on this plan is not suitable for any other purpose. Property dimensions, areas, numbers of lots and contours and other physical features shown have been compiled from existing information and may not have been verified by field survey. These may need verification if the development application is approved and development proceeds, and may change when a full survey is undertaken or in order to comply with development approval conditions. No reliance should be placed on the information on this plan for detailed design or for any financial dealings involving the land. Saunders Havill Group therefore disclaims any liability for any loss or damage whatsoever or howsoever incurred, arising from any party using or relying upon this plan for any purpose other than as a document prepared for the sole purpose of accompanying a development application and which may be subject to alteration beyond the control of the Saunders Havill Group. Unless a development approval states otherwise, this is not an approved plan.

Layer Sources
 ©State of Queensland (Department of Resources) 2024.
 Updated data available at <http://qldspatial.information.qld.gov.au/catalogue/>

* This note is an integral part of this plan/data. Reproduction of this plan or any part of it without this note being included in full will render the information shown on such reproduction invalid and not suitable for use.

Legend

- Site DCDB
- Qld DCDB

GPS Tree Plot (w/ TPZ)

- LCC Native Tree to Retain [12]
- Introduced Tree to Retain [2]
- LCC Native Habitat Tree to Remove [42]
- LCC Native Tree to Remove [504]
- Dead/Stag Tree to Remove [10]
- Introduced Tree to Remove [141]

Additional Vegetated Areas to Remove - 84,753 m² **84,573m²**

Engineering Detail

- Proposed Lots
- Proposed Roads and Footpaths
- Earthworks Batters
- Retaining Walls
- Swale Design
- Sewer Design
- Water Design
- Earthworks Extent

Vegetation to be removed in accordance with OWVM/7/2023

Issue	Date	Description	Drawn	Checked
A	18/11/2022	Preliminary	LS	KT
E	3/09/2024	Council Response	TF	KT

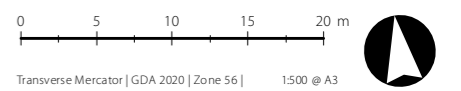

03.11 Development Assessment

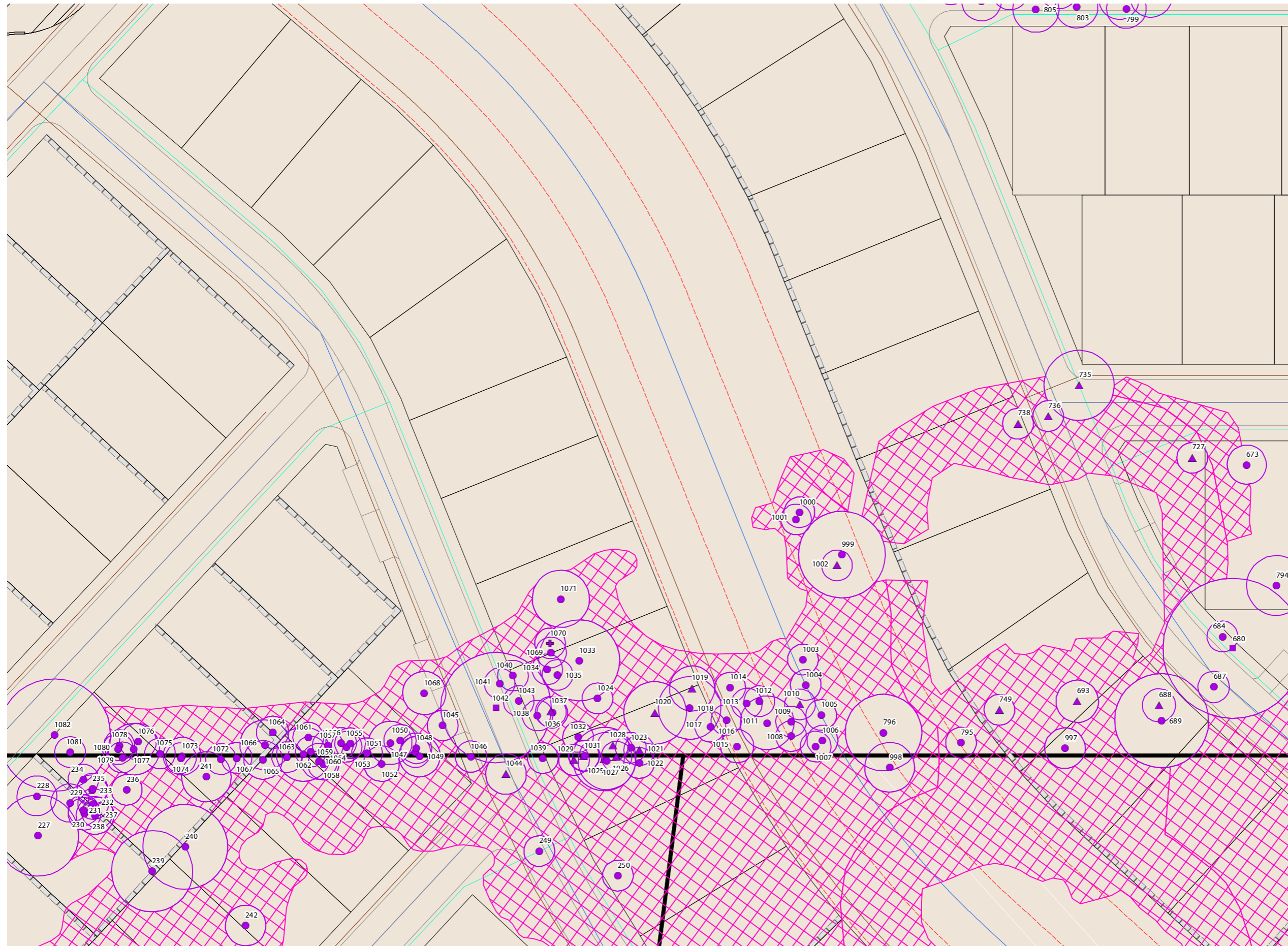

Notes:
 This plan was prepared as a desktop assessment tool. The information on this plan is not suitable for any other purpose. Property dimensions, areas, numbers of lots and contours and other physical features shown have been compiled from existing information and may not have been verified by field survey. These may need verification if the development application is approved and development proceeds, and may change when a full survey is undertaken or in order to comply with development approval conditions. No reliance should be placed on the information on this plan for detailed design or for any financial dealings involving the land. Saunders Havill Group therefore disclaims any liability for any loss or damage whatsoever or howsoever incurred, arising from any party using or relying upon this plan for any purpose other than as a document prepared for the sole purpose of accompanying a development application and which may be subject to alteration beyond the control of the Saunders Havill Group. Unless a development approval states otherwise, this is not an approved plan.

Layer Sources
 ©State of Queensland (Department of Resources) 2024.
 Updated data available at <http://qldspatialinformation.qld.gov.au/catalogue/>

* This note is an integral part of this plan/data. Reproduction of this plan or any part of it without this note being included in full will render the information shown on such reproduction invalid and not suitable for use.

- Legend**
- Site DCDB
 - Qld DCDB
 - GPS Tree Plot (w/ TPZ)**
 - LCC Native Tree to Retain [12]
 - Introduced Tree to Retain [2]
 - LCC Native Habitat Tree to Remove [42]
 - LCC Native Tree to Remove [504]
 - Dead/Stag Tree to Remove [10]
 - Introduced Tree to Remove [141]
 - Additional Vegetated Areas to Remove - 84,753 m² **84,573m²**
 - Engineering Detail**
 - Proposed Lots
 - Proposed Roads and Footpaths
 - Earthworks Batters
 - Retaining Walls
 - Swale Design
 - Sewer Design
 - Water Design
 - Earthworks Extent
 - Vegetation to be removed in accordance with OWVM/7/2023

Issue	Date	Description	Drawn	Checked
A	18/11/2022	Preliminary	LS	KT
E	3/09/2024	Council Response	TF	KT

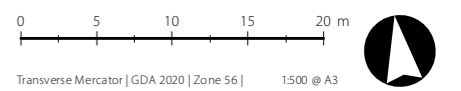

03.12 Development Assessment

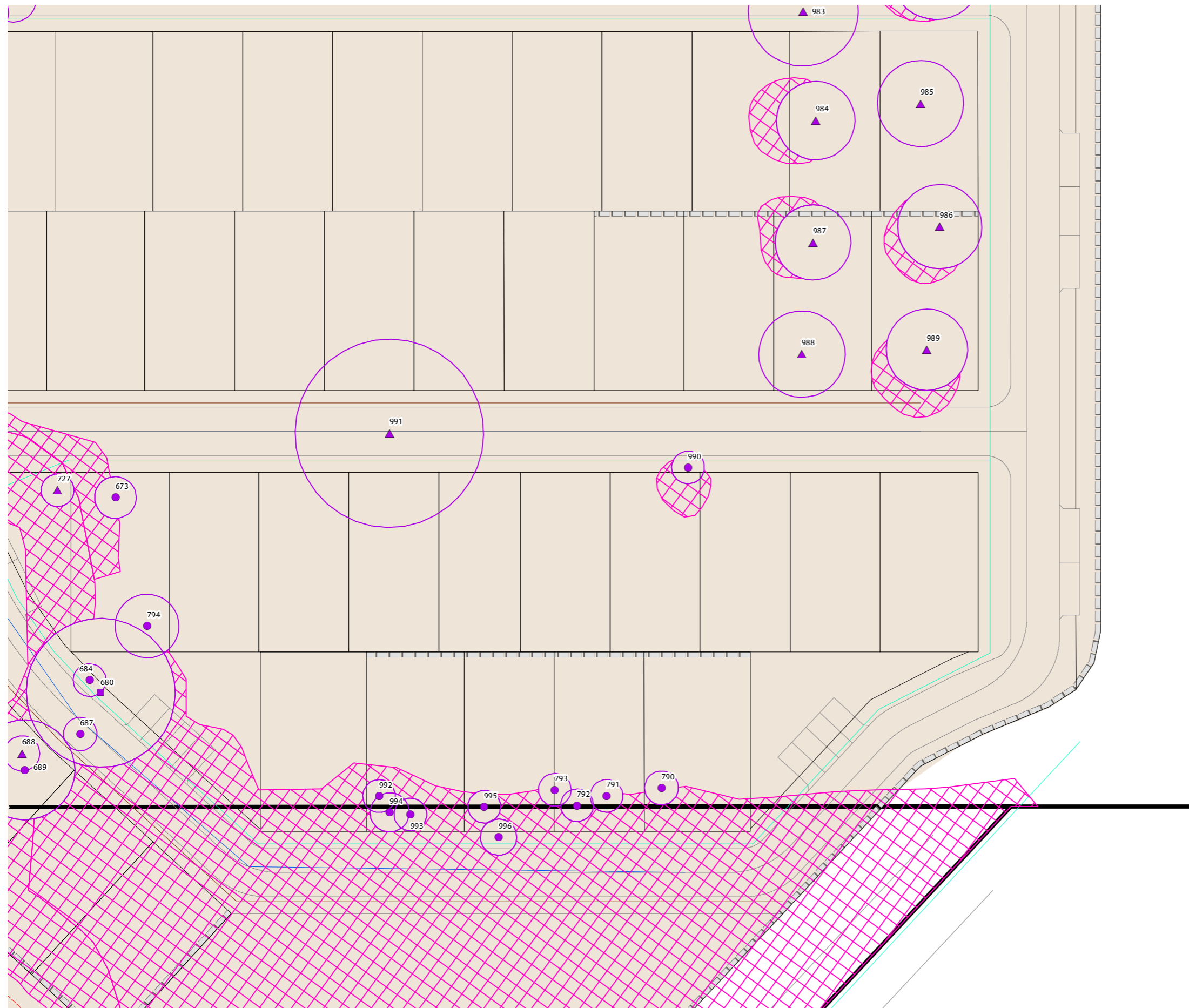

Notes:
 This plan was prepared as a desktop assessment tool. The information on this plan is not suitable for any other purpose. Property dimensions, areas, numbers of lots and contours and other physical features shown have been compiled from existing information and may not have been verified by field survey. These may need verification if the development application is approved and development proceeds, and may change when a full survey is undertaken or in order to comply with development approval conditions. No reliance should be placed on the information on this plan for detailed design or for any financial dealings involving the land. Saunders Havill Group therefore disclaims any liability for any loss or damage whatsoever or howsoever incurred, arising from any party using or relying upon this plan for any purpose other than as a document prepared for the sole purpose of accompanying a development application and which may be subject to alteration beyond the control of the Saunders Havill Group. Unless a development approval states otherwise, this is not an approved plan.

Layer Sources
 ©State of Queensland (Department of Resources) 2024.
 Updated data available at <http://qldspatialinformation.qld.gov.au/catalogue/>

* This note is an integral part of this plan/data. Reproduction of this plan or any part of it without this note being included in full will render the information shown on such reproduction invalid and not suitable for use.

Legend

- Site DCDB
- Qld DCDB
- GPS Tree Plot (w/ TPZ)**
- LCC Native Tree to Retain [12]
- Introduced Tree to Retain [2]
- LCC Native Habitat Tree to Remove [42]
- LCC Native Tree to Remove [504]
- Dead/Stag Tree to Remove [10]
- Introduced Tree to Remove [141]
- Additional Vegetated Areas to Remove - 84,753 m² **84,573m²**
- Engineering Detail**
- Proposed Lots
- Proposed Roads and Footpaths
- Earthworks Batters
- Retaining Walls
- Swale Design
- Sewer Design
- Water Design
- Earthworks Extent
- Vegetation to be removed in accordance with OWVM/7/2023

Issue	Date	Description	Drawn	Checked
A	18/11/2022	Preliminary	LS	KT
E	3/09/2024	Council Response	TF	KT

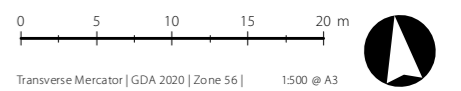

Transverse Mercator | GDA 2020 | Zone 56 | 1:500 @ A3

Address / RPD: Logan Reserve

3/09/2024 | 9277 E 03_1 Development E

03.13 Development Assessment



Notes:
 This plan was prepared as a desktop assessment tool. The information on this plan is not suitable for any other purpose. Property dimensions, areas, numbers of lots and contours and other physical features shown have been compiled from existing information and may not have been verified by field survey. These may need verification if the development application is approved and development proceeds, and may change when a full survey is undertaken or in order to comply with development approval conditions. No reliance should be placed on the information on this plan for detailed design or for any financial dealings involving the land. Saunders Havill Group therefore disclaims any liability for any loss or damage whatsoever or howsoever incurred, arising from any party using or relying upon this plan for any purpose other than as a document prepared for the sole purpose of accompanying a development application and which may be subject to alteration beyond the control of the Saunders Havill Group. Unless a development approval states otherwise, this is not an approved plan.
 Layer Sources
 ©State of Queensland (Department of Resources) 2024.
 Updated data available at
<http://qldspatialinformation.qld.gov.au/catalogue/>
 * This note is an integral part of this plan/data. Reproduction of this plan or any part of it without this note being included in full will render the information shown on such reproduction invalid and not suitable for use.

Legend

- Site DCDB
- Qld DCDB
- GPS Tree Plot (w/ TPZ)**
 - LCC Native Tree to Retain [12]
 - Introduced Tree to Retain [2]
 - LCC Native Habitat Tree to Remove [42]
 - LCC Native Tree to Remove [504]
 - Dead/Stag Tree to Remove [10]
 - Introduced Tree to Remove [141]
- Additional Vegetated Areas to Remove - 84,753 m² **84,573m²**
- Engineering Detail**
 - Proposed Lots
 - Proposed Roads and Footpaths
 - Earthworks Batters
 - Retaining Walls
 - Swale Design
 - Sewer Design
 - Water Design
 - Earthworks Extent
 - Vegetation to be removed in accordance with OWVM/7/2023

Issue	Date	Description	Drawn	Checked
A	18/11/2022	Preliminary	LS	KT
E	3/09/2024	Council Response	TF	KT

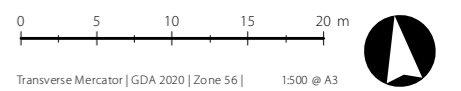

03.14 Development Assessment

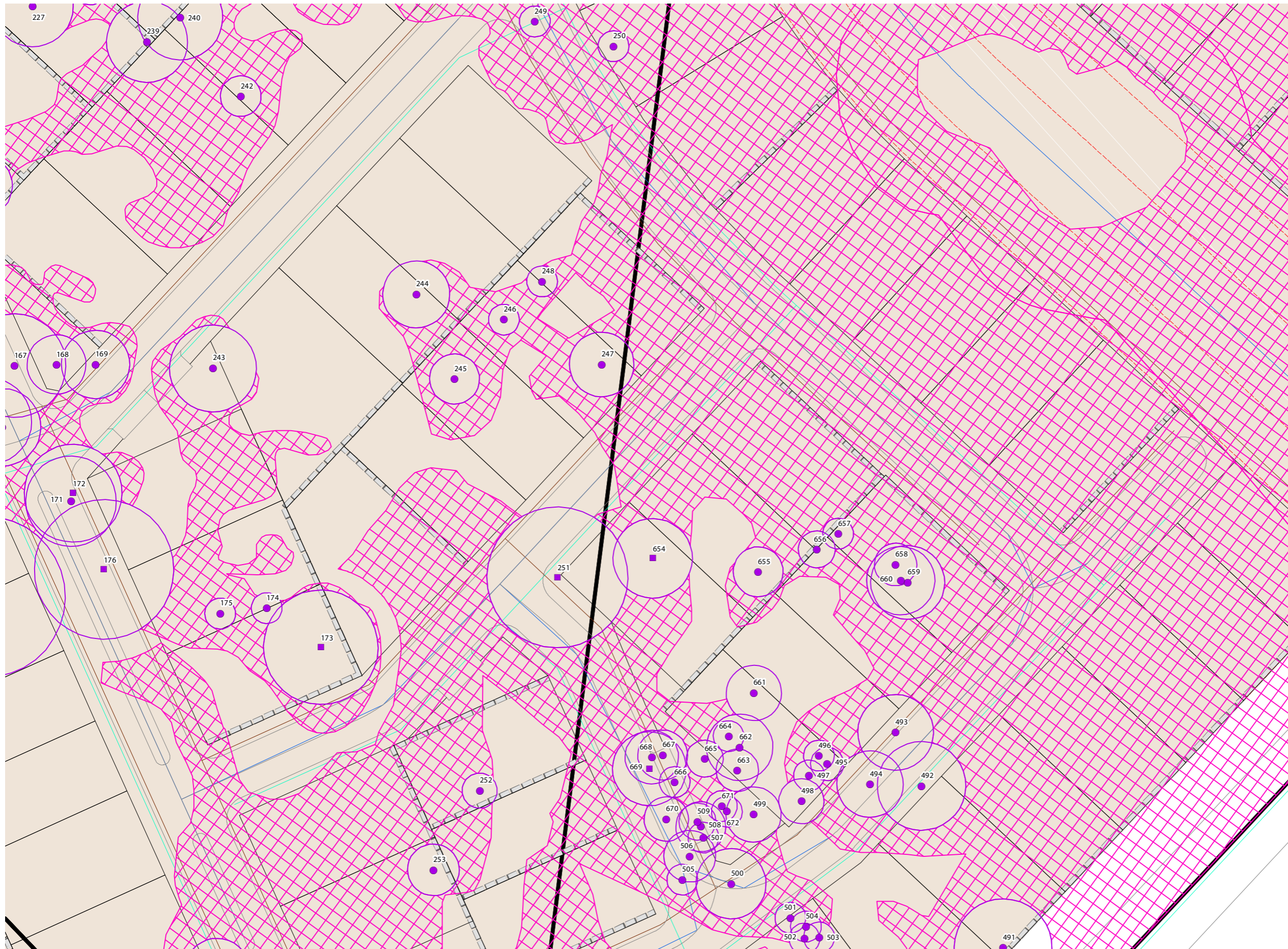

Notes:
 This plan was prepared as a desktop assessment tool. The information on this plan is not suitable for any other purpose. Property dimensions, areas, numbers of lots and contours and other physical features shown have been compiled from existing information and may not have been verified by field survey. These may need verification if the development application is approved and development proceeds, and may change when a full survey is undertaken or in order to comply with development approval conditions. No reliance should be placed on the information on this plan for detailed design or for any financial dealings involving the land. Saunders Havill Group therefore disclaims any liability for any loss or damage whatsoever or howsoever incurred, arising from any party using or relying upon this plan for any purpose other than as a document prepared for the sole purpose of accompanying a development application and which may be subject to alteration beyond the control of the Saunders Havill Group. Unless a development approval states otherwise, this is not an approved plan.
 Layer Sources
 ©State of Queensland (Department of Resources) 2024.
 Updated data available at
<http://qldspatialinformation.qld.gov.au/catalogue/>
 * This note is an integral part of this plan/data. Reproduction of this plan or any part of it without this note being included in full will render the information shown on such reproduction invalid and not suitable for use.

Legend

- Site DCDB
- Qld DCDB
- GPS Tree Plot (w/ TPZ)**
- LCC Native Tree to Retain [12]
- Introduced Tree to Retain [2]
- LCC Native Habitat Tree to Remove [42]
- LCC Native Tree to Remove [504]
- Dead/Stag Tree to Remove [10]
- Introduced Tree to Remove [141]
- Additional Vegetated Areas to Remove - 84,753 m² **84,573m²**
- Engineering Detail**
- Proposed Lots
- Proposed Roads and Footpaths
- Earthworks Batters
- Retaining Walls
- Swale Design
- Sewer Design
- Water Design
- Earthworks Extent
- Vegetation to be removed in accordance with OWVM/7/2023

Issue	Date	Description	Drawn	Checked
A	18/11/2022	Preliminary	LS	KT
E	3/09/2024	Council Response	TF	KT

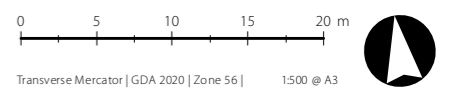

Address / RPD: Logan Reserve

3/09/2024 | 9277 E 03_1 Development E



Chambers Flat Road, Logan Reserve

03.15 Development Assessment

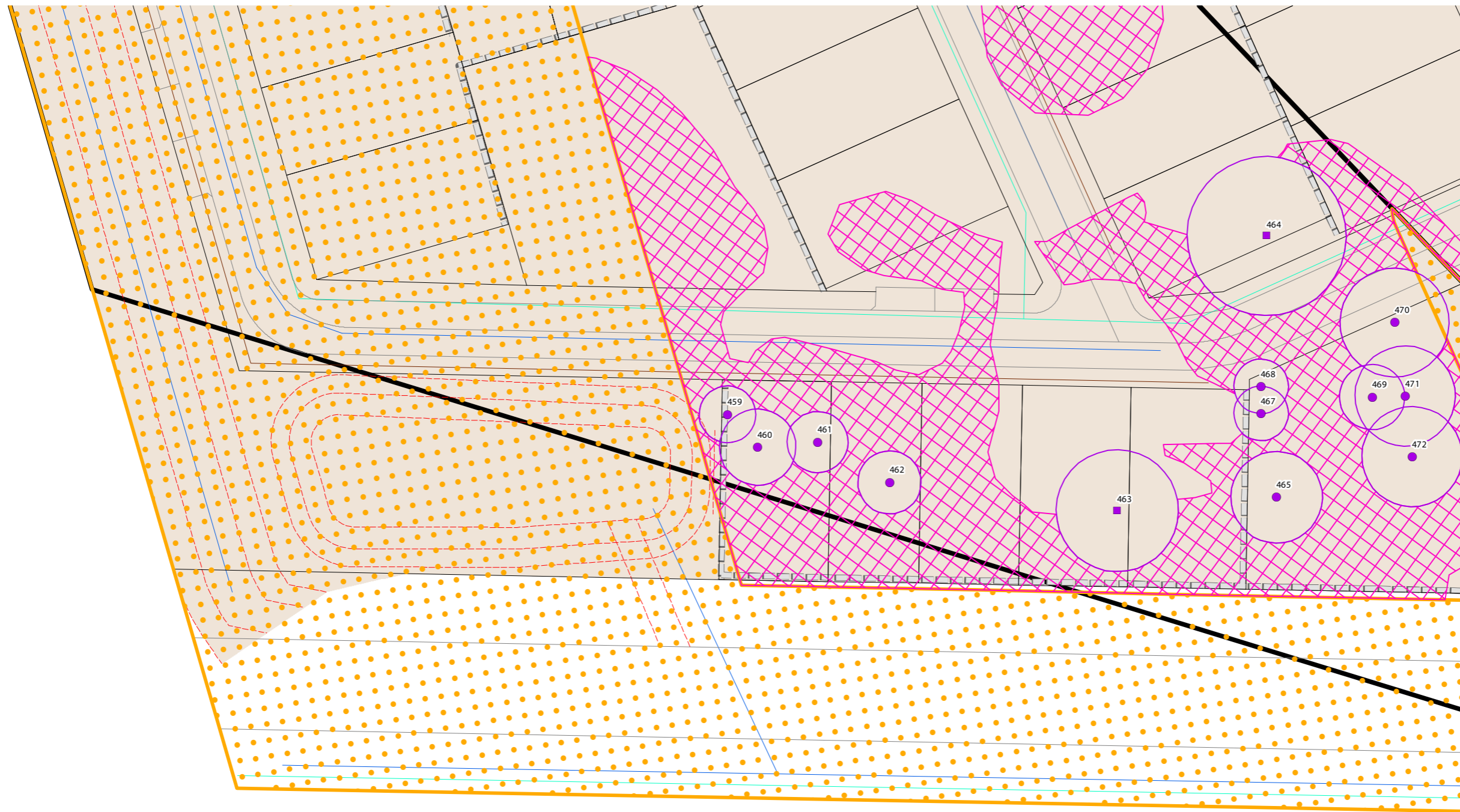

Notes:
 This plan was prepared as a desktop assessment tool. The information on this plan is not suitable for any other purpose. Property dimensions, areas, numbers of lots and contours and other physical features shown have been compiled from existing information and may not have been verified by field survey. These may need verification if the development application is approved and development proceeds, and may change when a full survey is undertaken or in order to comply with development approval conditions. No reliance should be placed on the information on this plan for detailed design or for any financial dealings involving the land. Saunders Havill Group therefore disclaims any liability for any loss or damage whatsoever or howsoever incurred, arising from any party using or relying upon this plan for any purpose other than as a document prepared for the sole purpose of accompanying a development application and which may be subject to alteration beyond the control of the Saunders Havill Group. Unless a development approval states otherwise, this is not an approved plan.
 Layer Sources
 © State of Queensland (Department of Resources) 2024.
 Updated data available at
<http://qldspatial.information.qld.gov.au/catalogue/>
 * This note is an integral part of this plan/data. Reproduction of this plan or any part of it without this note being included in full will render the information shown on such reproduction invalid and not suitable for use.

Legend

- Site DCDB
- Qld DCDB
- GPS Tree Plot (w/ TPZ)**
- LCC Native Tree to Retain [12]
- Introduced Tree to Retain [2]
- LCC Native Habitat Tree to Remove [42]
- LCC Native Tree to Remove [504]
- Dead/Stag Tree to Remove [10]
- Introduced Tree to Remove [141]
- Additional Vegetated Areas to Remove - 84,753 m² **84,573m²**
- Engineering Detail**
- Proposed Lots
- Proposed Roads and Footpaths
- Earthworks Batters
- Retaining Walls
- Swale Design
- Sewer Design
- Water Design
- Earthworks Extent
- Vegetation to be removed in accordance with OWVM/7/2023

Issue	Date	Description	Drawn	Checked
A	18/11/2022	Preliminary	LS	KT
E	3/09/2024	Council Response	TF	KT

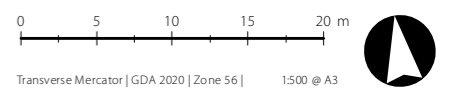

03.16 Development Assessment

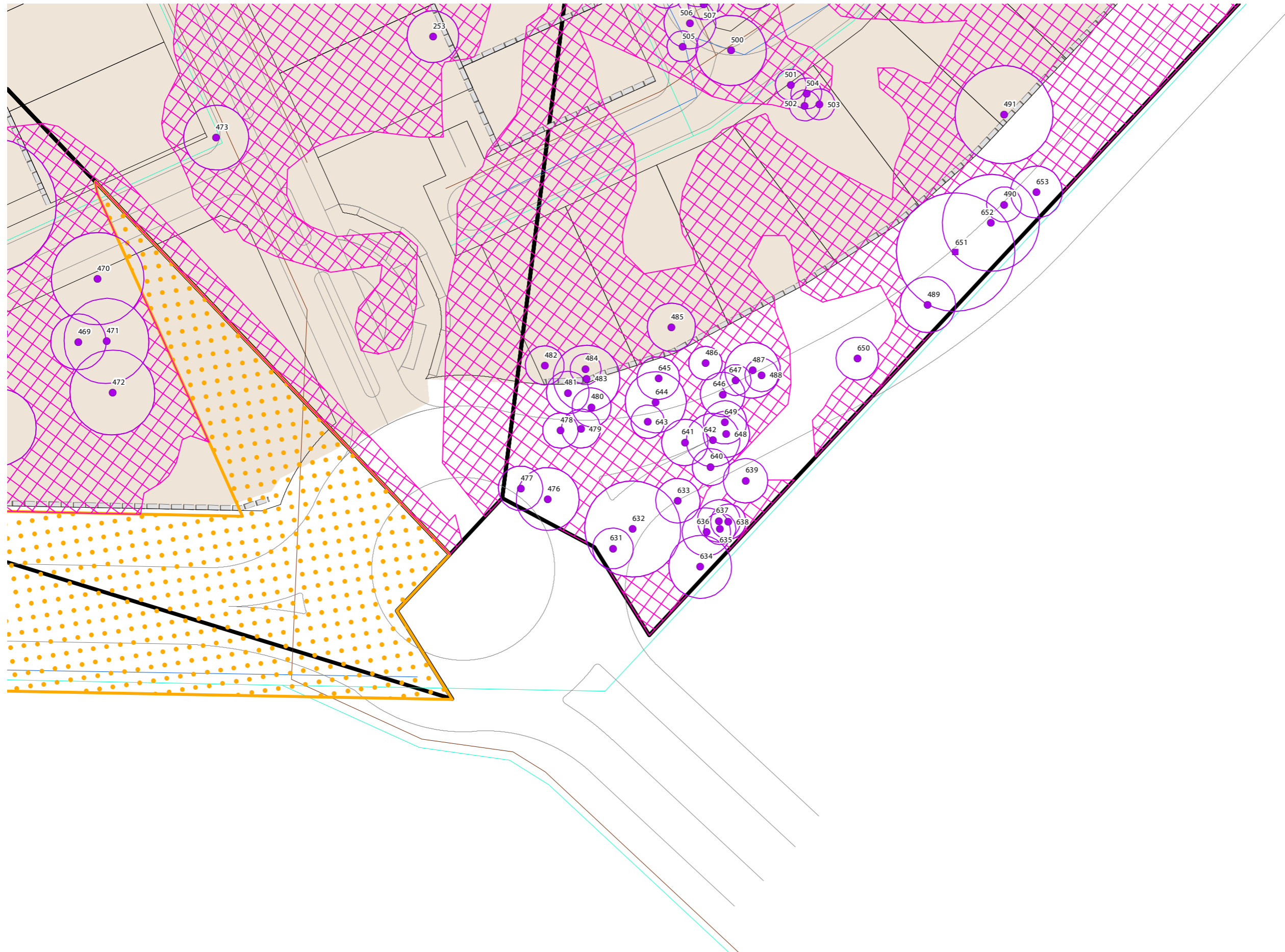

Notes:
 This plan was prepared as a desktop assessment tool. The information on this plan is not suitable for any other purpose. Property dimensions, areas, numbers of lots and contours and other physical features shown have been compiled from existing information and may not have been verified by field survey. These may need verification if the development application is approved and development proceeds, and may change when a full survey is undertaken or in order to comply with development approval conditions. No reliance should be placed on the information on this plan for detailed design or for any financial dealings involving the land. Saunders Havill Group therefore disclaims any liability for any loss or damage whatsoever or howsoever incurred, arising from any party using or relying upon this plan for any purpose other than as a document prepared for the sole purpose of accompanying a development application and which may be subject to alteration beyond the control of the Saunders Havill Group. Unless a development approval states otherwise, this is not an approved plan.
 Layer Sources
 ©State of Queensland (Department of Resources) 2024.
 Updated data available at
<http://qldspatialinformation.qld.gov.au/catalogue/>
 * This note is an integral part of this plan/data. Reproduction of this plan or any part of it without this note being included in full will render the information shown on such reproduction invalid and not suitable for use.

Legend

- Site DCDB
- Qld DCDB
- GPS Tree Plot (w/ TPZ)**
- LCC Native Tree to Retain [12]
- Introduced Tree to Retain [2]
- LCC Native Habitat Tree to Remove [42]
- LCC Native Tree to Remove [504]
- Dead/Stag Tree to Remove [10]
- Introduced Tree to Remove [141]
- Additional Vegetated Areas to Remove - 84,753 m² **84,573m²**
- Engineering Detail**
- Proposed Lots
- Proposed Roads and Footpaths
- Earthworks Batters
- Retaining Walls
- Swale Design
- Sewer Design
- Water Design
- Earthworks Extent
- Vegetation to be removed in accordance with OWVM/7/2023

Issue	Date	Description	Drawn	Checked
A	18/11/2022	Preliminary	LS	KT
E	3/09/2024	Council Response	TF	KT

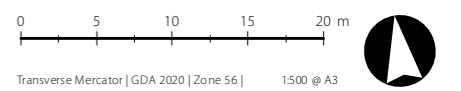

Transverse Mercator | GDA 2020 | Zone 56 | 1:500 @ A3
 Address / RPD: Logan Reserve