

## APPENDIX B PROPOSAL PLANS

Prepared by  
REYER





○ SITE PLAN  
1:500

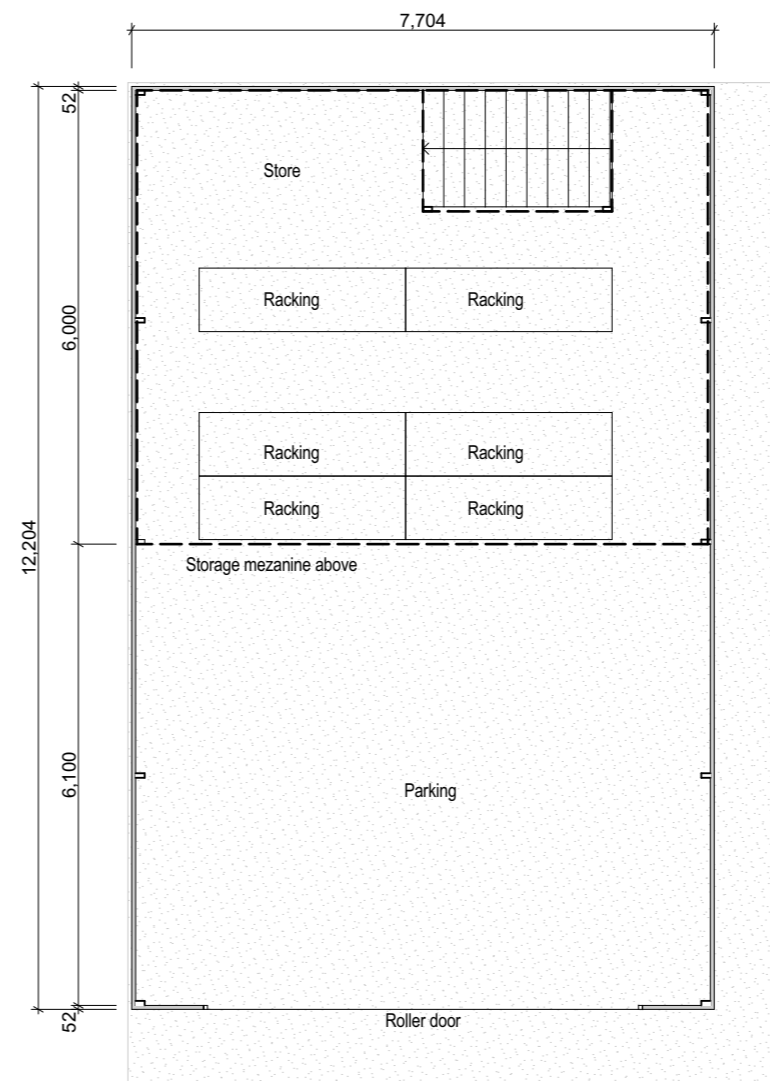

○ EXISTING GROUND FLOOR - SHED  
1:100

### NOTES

1. Third party information was utilized to complete this plan.
2. Survey information was accessed from Council Interactive Mapping and on site measure.
3. Actual levels and dimensions may vary on site.
4. If there is any discrepancies between documentation REYER must be contacted immediately.

### RPD:

Lot: Lot 128  
Plan: RP891090  
Area: 1416m<sup>2</sup>  
Council: Logan City Council

### SITE AREAS:

Total Site Cover: 584m<sup>2</sup> (41.2%) Aprox  
Business Site Cover: 94m<sup>2</sup> (6.6%) Aprox

### Gross Floor Areas:

Home Based Business: 136m<sup>2</sup>

