

HINCHINBROOK SHIRE COUNCIL

INSITU STABILISATION PROGRAM - ABERGOWRIE ROAD

JOB NUMBER - 23RDS005

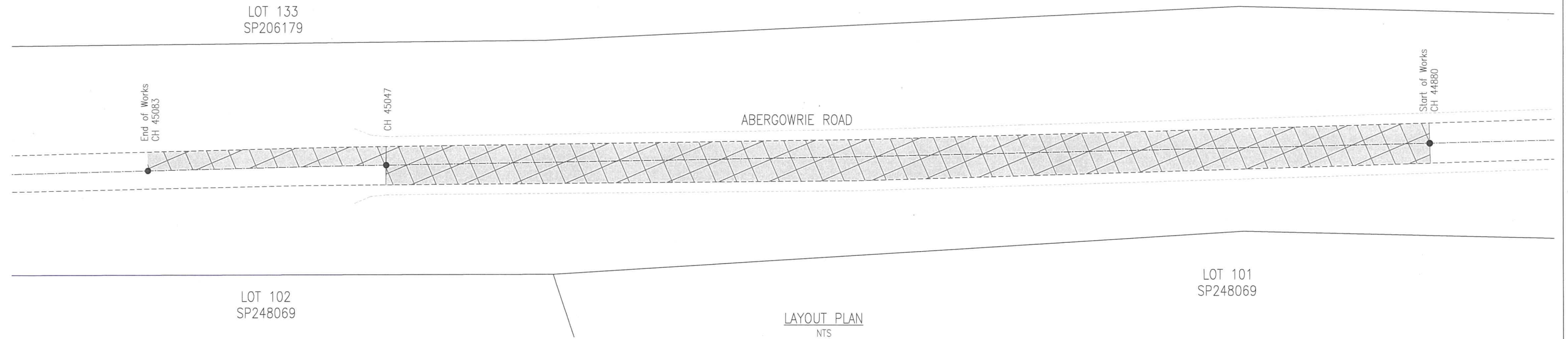
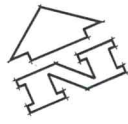

LOCALITY PLAN
NTS

DRAWING SCHEDULE:

Plan No.	Description	Revision
8619	Cover Page & Drawing Schedule	A
8620	Layout Plans and Details	A

<div><div></div><div></div><div></div></div>			As Shown	LEVEL DATUM: AHD der	Drafted: GB	Designed: GB	Examined By Client:	Approved by Council's DIUS: Date: 23/1/23 RPEQ No. 16571	Survey Number XXXX	Field Books XXXX	Level Books XXXX		HINCHINBROOK SHIRE COUNCIL		Job No				
A		19/01/2023		Original	ABERGOWRIE ROAD - ABERGOWRIE								23RDS005						
DATE PLOTTED: Tuesday, 24 January 2023 2:03:23 PM		Scale		Associated Plans:		INSITU STABILISATION PROGRAM							Plan No						
				Plan No. 1 of 2	Checked: HG	Checked: HG	Date: / /						KEYPLAN AND SCHEDULE		8619				
															A				

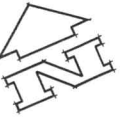

LOT 133
SP206179

CH 45083 CH 45080 CH 45070 CH 45060 CH 45050 CH 45040 CH 45030 CH 45020 CH 45010 CH 45000 CH 44990 CH 44980 CH 44970 CH 44960 CH 44950 CH 44940 CH 44930 CH 44920 CH 44910 CH 44900 CH 44890 CH 44880

Tie new works neatly into existing as required.

Tie new works neatly into existing as required.

ABERGOWRIE ROAD

Existing Concrete Drain (refer to note 16)

Tie new works neatly into existing as required.

LOT 102
SP248069

LOT 101
SP248069

LAYOUT PLAN
NTS

NOTES:

1. Insitu stabilise and bitumen seal Abergowrie Road as per details on this plan from CH 44880 to CH 45083.
2. Degrass existing shoulders as required and dispose of the material in an approved location.
3. Horizontal and vertical alignments are to be confirmed onsite by HSC Works Team Leader.
4. Any unsuitable subgrade is to be removed and replaced as per HSC Std Drg R008. Areas are to be approved by HSC IOS Manager prior to commencing any works.
5. Any existing drainage structures are to be cleaned out and inspected to ensure the structure is in a safe and reasonable condition.
6. Refer to typical cross section for pavement information.
7. All existing signs and guideposts are to be removed (if required) during construction and reinstalled (if in good condition) in accordance with the MUTCD.
8. Tidy up shoulders on both sides to ensure road is formed correctly. Add an approved deco material and compact if required.
9. All new seal works are to be done by others. Design to be confirmed by HSC prior to commencing any works.
10. Cutback existing seal as required and match new formation as required. New seal to marry in neatly with existing.
11. Reinstall any linemarking as per existing and in accordance with the MUTCD.
12. All disturbed areas are to be grass seeded after the completion of works.
13. Locate any existing services and ensure depths to these services are sufficient prior to commencing any works.
14. Locate all survey pins and marks prior to commencing any works and ensure they remain undisturbed throughout the job.
15. All works are to be undertaken in accordance with the MUTCD Part 3: Works on Roads.
16. No works to existing concrete drains are to be undertaken as apart of this project.

LEGEND:

 Reseal & Insitu Stabilisation Works
(Approx. area: 1196.6m²)

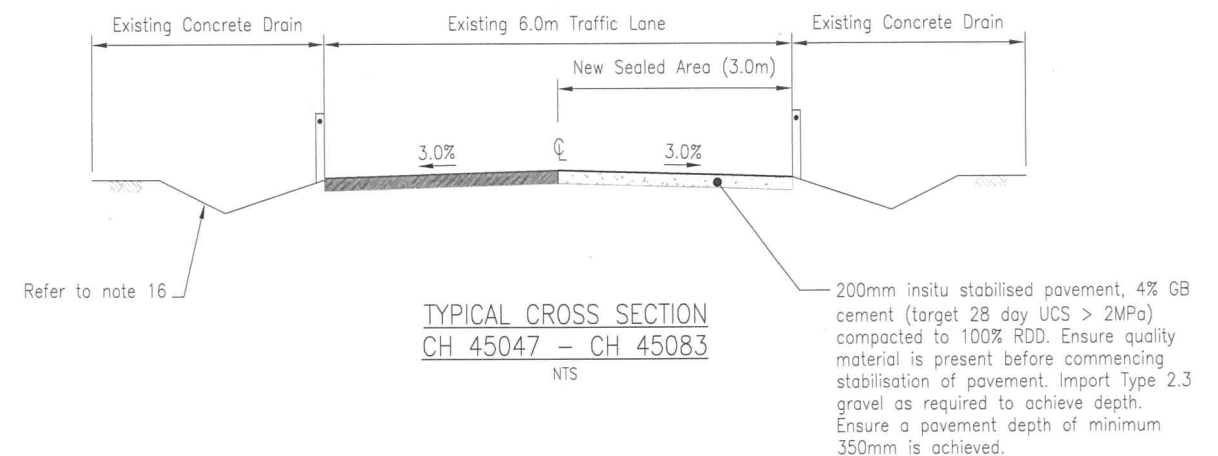
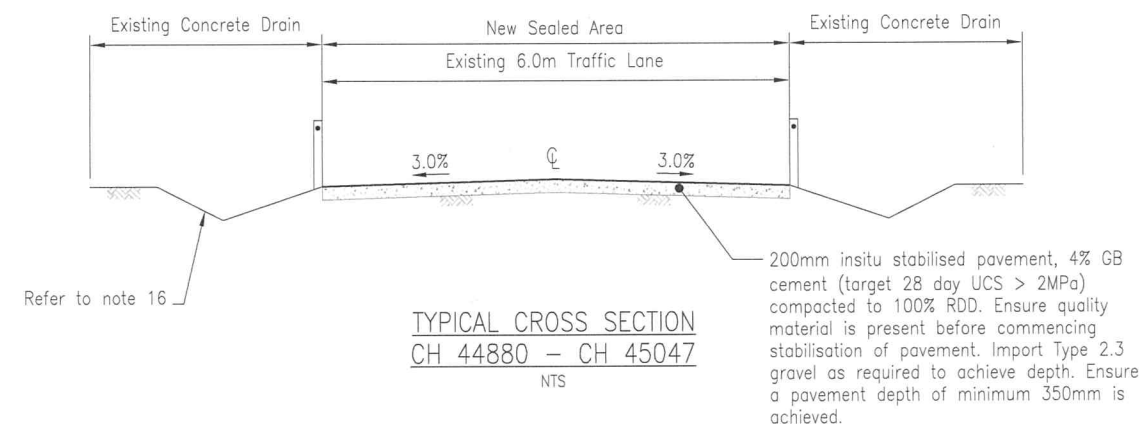

			As Shown	LEVEL DATUM: AHD der	Drafted: 6B	Designed: 6B	Examined By Client:	Approved by Council's DIUS:	Survey Number XXXX	Field Books XXXX	Level Books XXXX	_____	HINCHINBROOK SHIRE COUNCIL			Job No
				Associated Plans:	Checked: 6B	Checked: 6B							ABERGOWRIE ROAD - ABERGOWRIE			23RDS005
A	19/01/2023	Original		Plan No. 2 of 2	Checked: H6	Checked: H6	Date: 25/1/23	RPEQ No. 16571					INSITU STABILISATION PROGRAM			Plan No
DATE PLOTTED: Wednesday, 25 January 2023 4:33:49 PM			Scale				Date: / /						LAYOUT PLAN			8620
													A			

DATE PLOTTED: Wednesday, 25 January 2023 4:33:49 PM

FILEPATH: C:\USERS\GEORGIA1952\HINCHINBROOK SHIRE COUNCIL\2022-23 CAPITAL PROJECTS - DOCUMENTS\23RDS005 - INSITU STABILISATION PROGRAM (R2R)\04-DESIGN\DRAWINGS\ABERGOWRIE ROAD\CAD PLANS\ABERGOWRIE JUMP UP INSTITU DWG