

Airedale 205

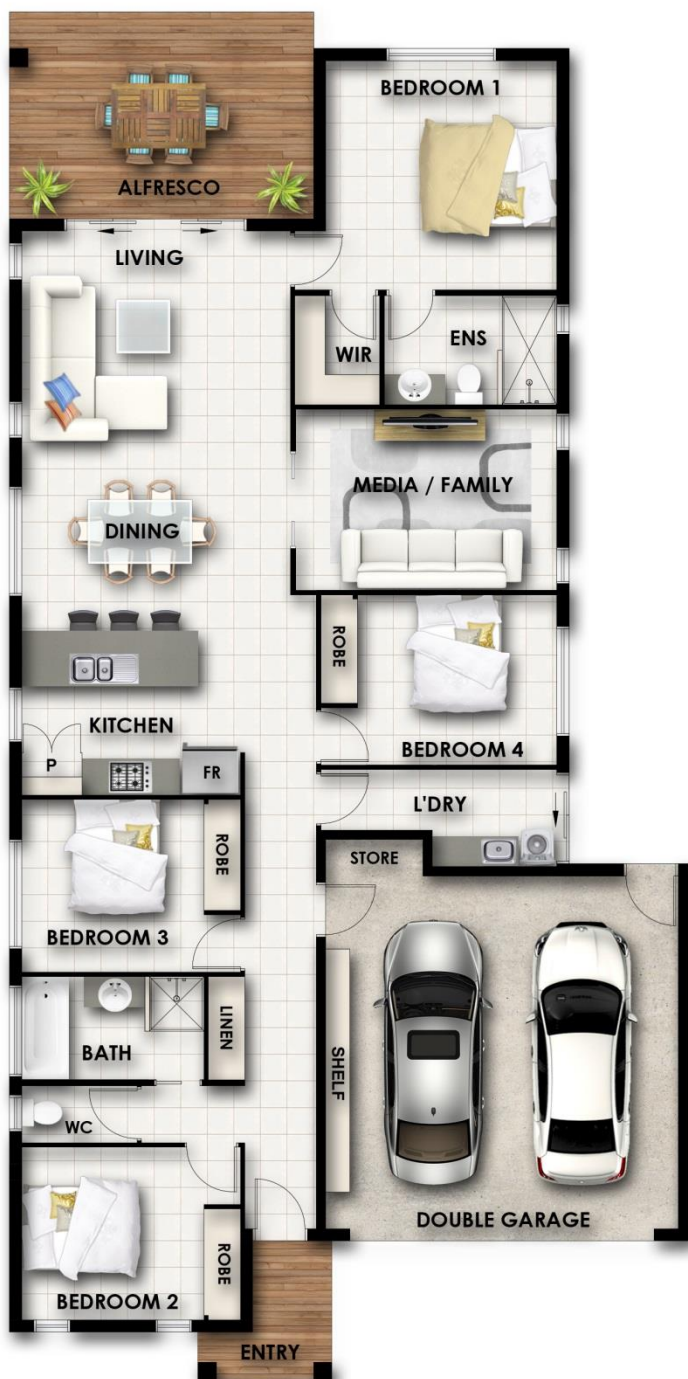

Living area	147.33m ²
Garage area	37.40m ²
Patio area	17.00m ²
Entry area	3.70m ²
Total area	205.43m²

Cougar Packages Include:

- Masonry block walls with smooth coat texture finish
- Blockwork Garage internal walls
- Colorbond roof, gutters and fascia with blanket insulation to entire roof area
- Quality floor coverings throughout, including tiled patio and porch
- Professionally designed kitchen with stone benchtops and soft close cabinetry
- Stainless steel kitchen appliances
- Generous LED lighting and power point allowance
- Architectural plumbing fixtures throughout
- Exposed aggregate driveway allowance
- Council and statutory fees

Cougar Homes Pty Ltd
QBSA No. 1033596
www.cougarhomes.com.au