

Canopy 298

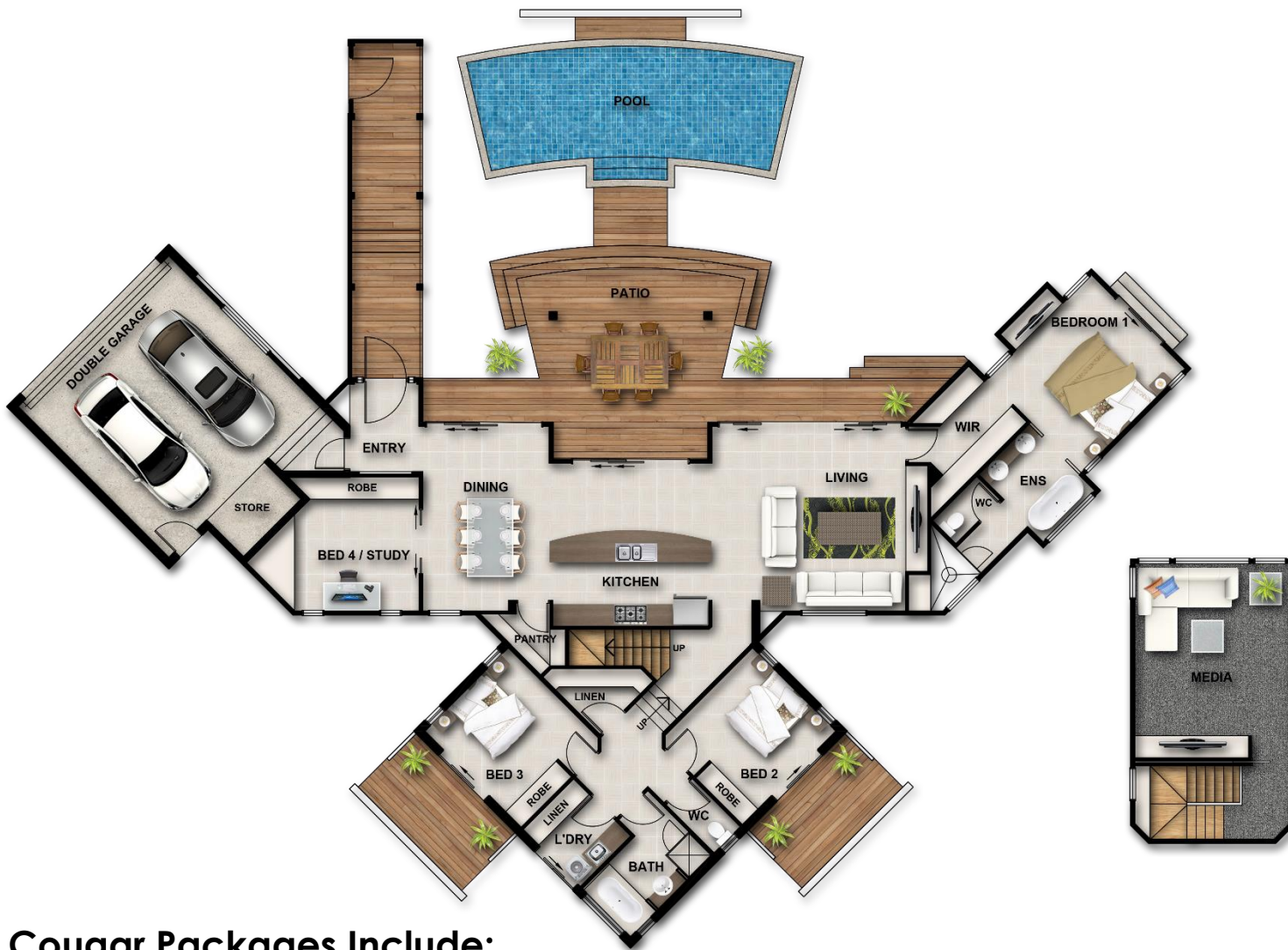

4 2 2

GROUND FLOOR

Living area	186.00m ²
Garage area	43.28m ²
Patio area	17.42m ²
Entry area	18.43m ²

FIRST FLOOR

Living area	33.56m ²
-------------	---------------------

Total area 298.69m²
 Decked areas on beds 2 & 3 + entrance walkway not included as standard.



Cougar Packages Include:

- Masonry block walls with smooth coat texture finish * Blockwork Garage internal walls
- Colorbond roof, gutters and fascia with blanket insulation to entire roof area
- Quality floor coverings throughout, including tiled patio and porch
- Professionally designed kitchen with stone benchtops and soft close cabinetry
- Stainless steel kitchen appliances * Generous LED lighting and power point allowance
- Architectural plumbing fixtures throughout * Exposed aggregate driveway allowance
- Council and statutory fees

Cougar Homes Pty Ltd
 QBSA No. 1033596
www.cougarhomes.com.au

Plans, elevations & images do not form any part of the build contract. Colours, furniture, vehicles, fencing, paving, landscaping, and pools are artists impressions only, and are not included. Standard pricing allows for hip roof construction, and tiling in lieu of decking to porches and patios, and excludes any gables, gate houses, roof features and feature blockwork. Refer to builders / package inclusions for full details. Pricing and availability is subject to change without notice. These designs are copyright to Cougar Homes Pty Ltd. QBSA 1033596