

28.10.20

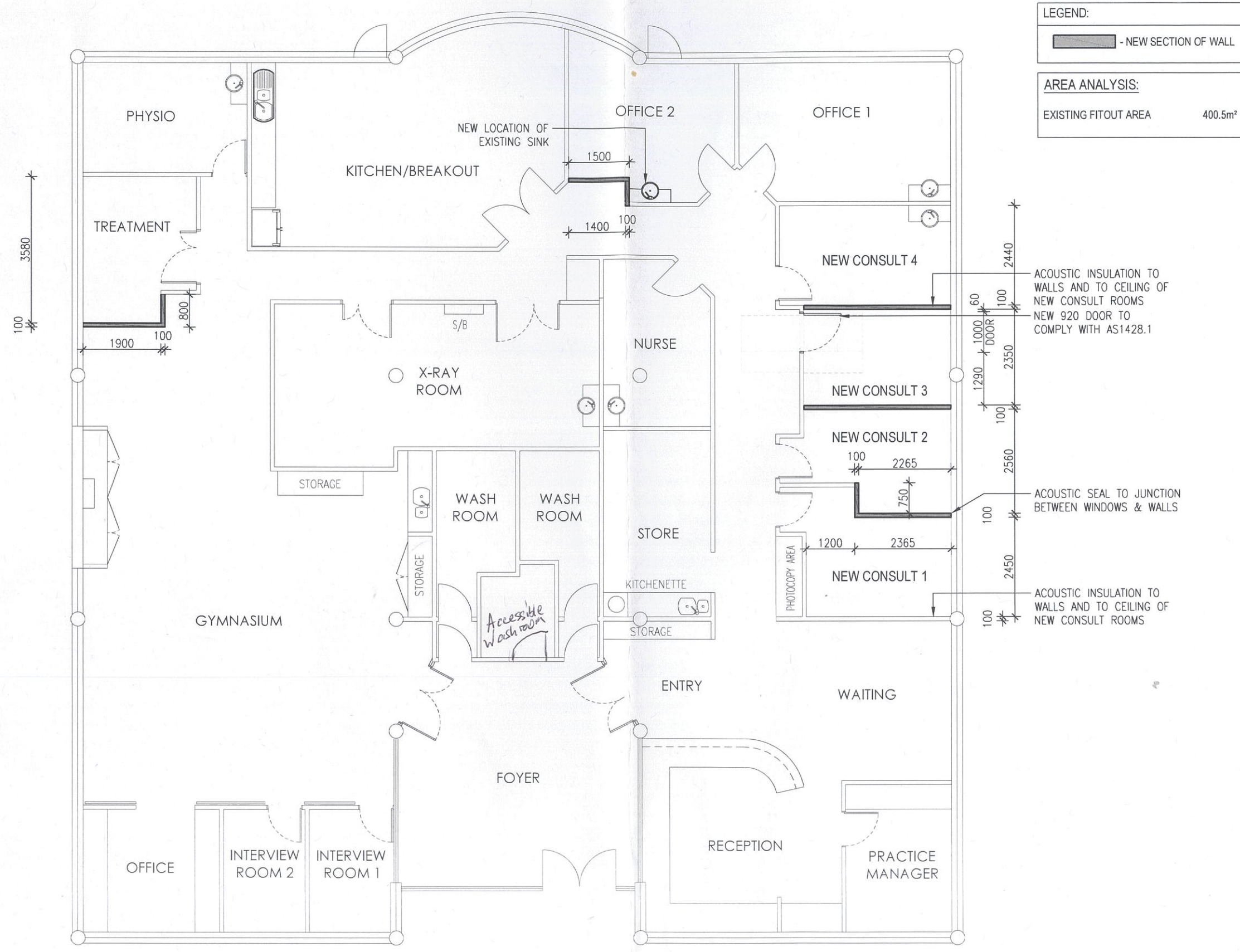

**LEGEND:**

NEW SECTION OF WALL

**AREA ANALYSIS:**

EXISTING FITOUT AREA 400.5m²

**GENERAL NOTES:**

ALL WORKS ARE TO COMPLY WITH THE RELEVANT AUSTRALIAN STANDARDS & ALL RELEVANT AUTHORITY REQUIREMENTS. ALL DIMENSIONS DEPENDENT ON EXISTING SITE CONDITIONS SHALL BE VERIFIED BY THE BUILDER ON SITE PRIOR TO THE COMMENCEMENT OF THE WORKS. DO NOT SCALE OFF DRAWING.

A REGISTERED SURVEYOR TO SET OUT STRUCTURE & CONFIRM POSITIONS OF ALL RELEVANT BUILDING ENVELOPE SETBACKS & EASEMENTS PRIOR TO THE COMMENCEMENT OF THE WORKS.

ALL TIMBER FRAMING & CONSTRUCTION MUST COMPLY WITH AS1684 'THE NATIONAL TIMBER FRAMING CODE'. PROVIDE TEMPORARY & PERMANENT BRACING TO ALL FRAMING IN ACCORDANCE WITH THE STANDARD.

ALL CONCRETE SLABS & FOOTINGS ARE SUBJECT TO A SOIL CLASSIFICATION & ARE TO COMPLY WITH ENGINEERS DRAWINGS OR AS2870 'RESIDENTIAL SLABS & FOOTINGS CODE' INCLUDING ALL RELEVANT REGION SPECIFIC SUPPLEMENTS.

ALL STORM WATER DRAINAGE & SEWERAGE TO BE CONNECTED TO EXISTING SERVICES IN ACCORDANCE WITH THE BCA & ALL LOCAL AUTHORITY REQUIREMENTS OR SELECTED RAINWATER TANK OR SEPTIC SYSTEM.

ALL LINTELS, BEAMS, & SUPPORTS TO BE SPECIFIED BY A REGISTERED ENGINEER OR RELEVANT AUSTRALIAN STANDARD.

PROVIDE TERMITE CONTROL TO SUB-FLOOR IN ACCORDANCE WITH THE BCA & ALL RELEVANT LOCAL AUTHORITY REQUIREMENTS OR PROVIDE ANT CAPPING AND TERMITE BARRIER. THE STRUCTURE SHALL BE MAINTAINED IN A STABLE CONDITION AT ALL TIMES, & NO ELEMENT SHALL BE OVERSTRESSED, DURING & AFTER CONSTRUCTION.

ALL WET AREA FIXTURES SHALL BE TO CLIENT'S SELECTION OR INCLUSIONS LIST.

**COPYRIGHT:**

UNAUTHORISED USE OR REPRODUCTION IN WHOLE OR IN PART OF THESE DOCUMENTS WITHOUT WRITTEN PERMISSION MAY LEAD TO LEGAL ACTION.

ANY FORM OF REPRODUCTION OF THIS DRAWING IN FULL OR IN PART WITHOUT THE WRITTEN PERMISSION OF DOWSE NORWOOD ASSOCIATES ARCHITECTS PTY LTD CONSTITUTES AN INFRINGEMENT OF COPYRIGHT.

© COPYRIGHT DOWSE NORWOOD ASSOCIATES ARCHITECTS PTY LTD.

**AMENDMENTS**

REV. A 2020.10.28

1. ISSUE FOR CONSTRUCTION

**FOR CONSTRUCTION**