

LOCATION PLAN

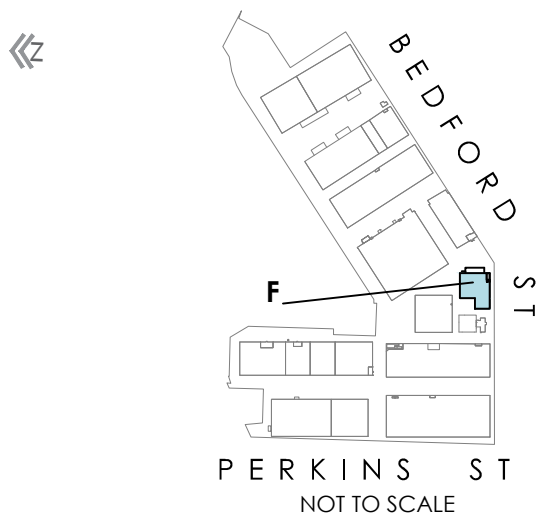

SCHEDULE OF AREAS

WAREHOUSE F	4,142.1 m²
GROUND FLOOR OFFICE F1	103.2 m²
FIRST FLOOR STORAGE F2	103.2 m²
OFFICE F4	18.2 m²
OFFICE F4	24.0 m²
TOTAL AREA	4,390.7 m²
CANOPY F	486.7 m²

DISCLAIMER: THIS PLAN HAS BEEN PREPARED FOR MARKETING PURPOSES ONLY. INTERESTED PARTIES SHOULD UNDERTAKE THEIR OWN ENQUIRIES AS TO THE ACCURACY OF THE INFORMATION. AREAS ARE APPROXIMATE AND DIMENSION ROUNDING MAY RESULT IN AREA DISCREPANCIES.

NOTES:

1. THIS PLAN HAS BEEN PREPARED FOR MARKETING PURPOSES ONLY. INTERESTED PARTIES SHOULD UNDERTAKE THEIR OWN ENQUIRIES AS TO THE ACCURACY OF THE INFORMATION. TOTAL AREA TAKEN FROM REALSERVE SURVEY REF: 30489RS DATED 07/01/08.
2. DIMENSION ROUNDING MAY RESULT IN AREA DISCREPANCIES.

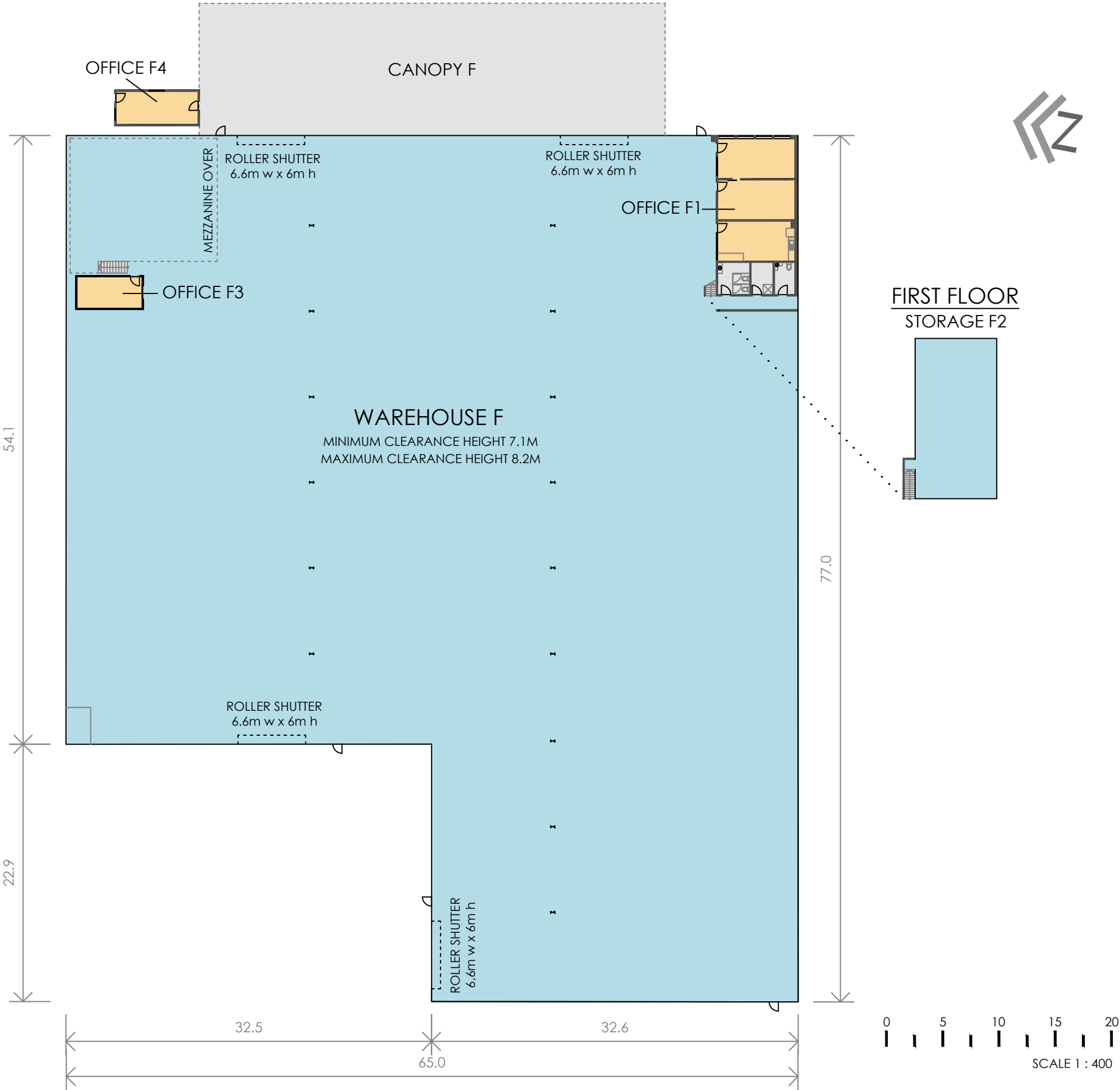

CLIENT:



MARKETING DRAWING

PORT ADELAIDE DISTRIBUTION CENTRE,
BEDFORD STREET, GILLMAN, SA

DATE: 28/09/2011

REF: 73700 REV: A
DRAWN: BR CHECKED: TF
SCALE: 1:400 SHEET: 1 OF 1

Australia | New Zealand



Building Measurement Specialist
Consulting Land Surveyors
3D Laser Scanning
ph. 08 8294 0704
www.realservice.com.au