

FOR LEASE



17 Zeta Crescent, O'Connor

Warehouse | Factory

Lot 1 is Now Leased and Lot 2 is
Still Available

On-Site Parking

Amidst O'Connor Industrial Area

Eric Rogers

m: 0412 228 555

e: egr@metwaywa.com

9228 2255 (24 Hours)
www.metwaywa.com

Licensed Estate Agents. Property Consultants. Auctioneers.

Real Estate and Business Agent Member of the Real Estate Institute of WA (Inc)
Licensee: Cityfield Investments Pty Ltd (ACN 078 234 974) as Trustee for the Real Estate
Trust - Trading as Metway Real Estate (ABN 93 918 167 259)

17 Zeta Crescent, O'Connor

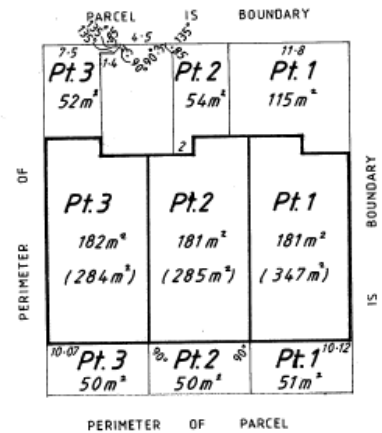
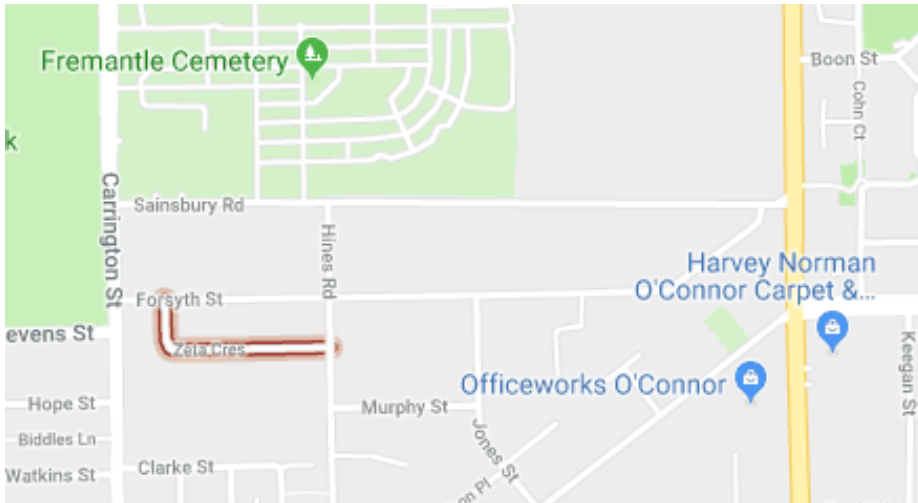

Location

Lots 1 and 2 are separate high truss factory warehouse units in the center of the O'Connor Industrial Area. The premises each have street frontage and great access to Stock Road, Carrington Street and South Street.

Premises

*** NOW LEASED LOT 1 CONSISTS OF THE WAREHOUSE (181 M²) PLUS THE EXCLUSIVE REAR YARD AREA (51 M²). PARKING ON-SITE IS AVAILABLE ***

Still Available is Lot 2 which encompasses the warehouse (181 m²) plus the exclusive rear yard area (50 m²). Parking on-site is available.

Lettable Area

*** NOW LEASED LOT 1 - 181 SQM + 51 M² YARD ***

Still Available is Lot 2 - 181 sqm + 50 m² yard

Rental (+GST)

\$75 psm pa

Outgoings (+GST)

\$400 per month

Parking

On-Site Parking Available

Lease Term

3 - 5 Years

Eric Rogers

m: 0412 228 555

e: egr@metwaywa.com

9228 2255 (24 Hours)

www.metwaywa.com

Disclaimer: The particulars contained in this brochure do not form part of any contract. While care has been taken in this presentation, no representation or warranty is made by the vendor/s or the selling agents. No responsibility is accepted for the accuracy of any information in this brochure. All persons must make their enquiries and satisfy themselves in all respects. Privacy Policy: The agents are committed to protecting your privacy. If at any time you choose not to receive information from them or wish to amend your personal information please notify them directly.