

RICHARD NOBLE

COMMERCIAL



MEDICAL/CONSULTING ROOMS READY TO OCCUPY

179 High Road, Willetton

A rare opportunity to secure a tenancy with plans approved for medical/consulting.

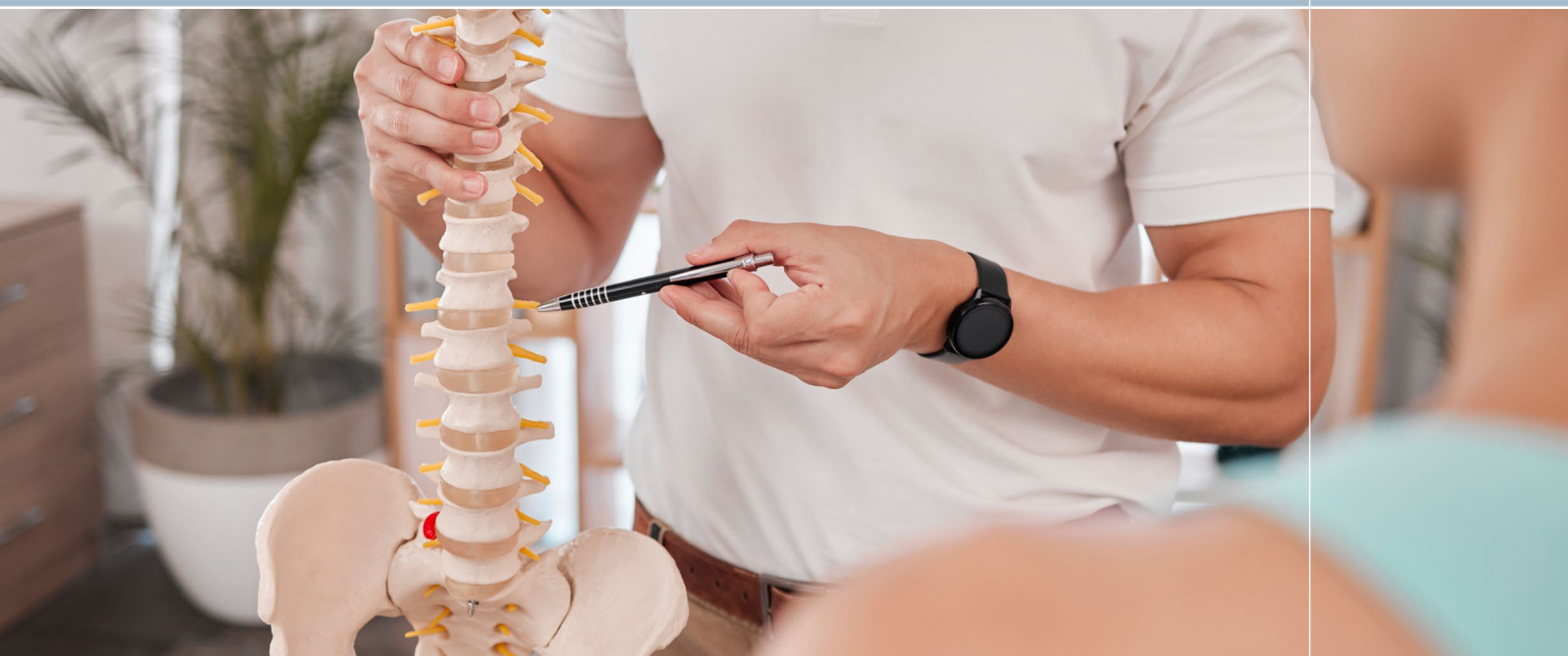

Richard Noble and Company are delighted to offer this unique opportunity to secure a long term lease over a new medical/healthcare centre located in Willetton.

- 400 sqm* tenancy
- Great exposure with over 19,500** cars passing daily
- Exclusive pylon signage
- Above average number of people per household in Willetton and surrounding suburbs***
- Dedicated 100amp switchboard with three phase power
- All fitout approvals in place and contractor ready to mobilise – changes can be made to fitout plans to suit your needs
- Ample parking front and rear of property
- Motivated landlord ready to negotiate favourable lease terms for the right operator

*approximately

**data from Main Roads average M-F

***data from ABS Census All Persons 2021

PROPOSED FLOOR PLAN

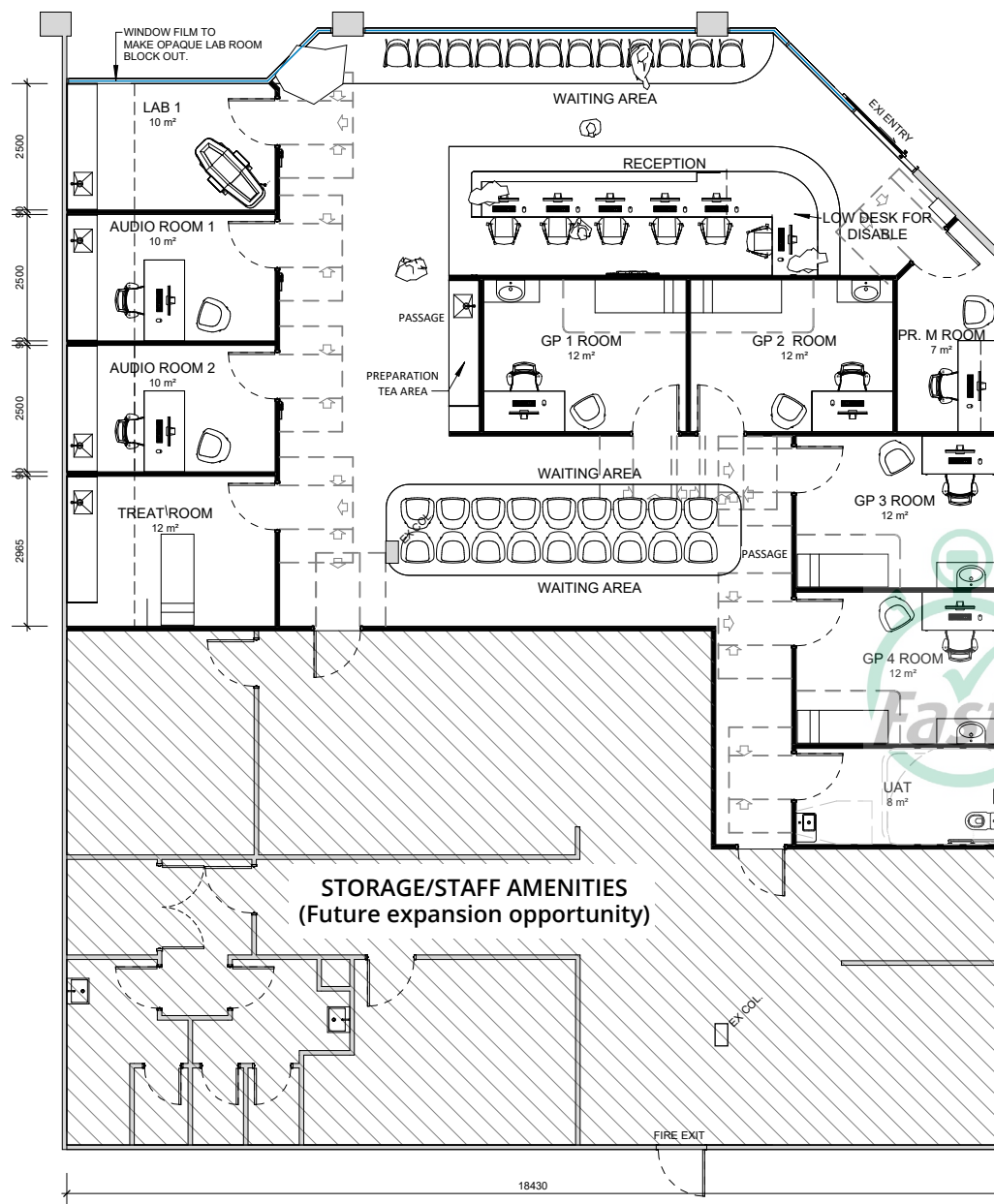

1 PROPOSED FLOOR PLAN
DW101 1:100

Fitout as shown has been scoped and costed by Office Fitout Professionals
– full set available upon request



NOTE: 3D images may differ in color or material from the final product. Please refer to the finish schedule for further clarification.



NOTE: 3D images may differ in color or material from the final product. Please refer to the finish schedule for further clarification.

RICHARD NOBLE

ENQUIRIES

For more information please contact:

Paul Peou

Head of Sales and Leasing

m: 0400 949 849

e: ppeou@rnoble.com.au

Disclaimer - The information provided in this brochure has been prepared in good faith and due care by Richard Noble & Company and is intended to be used as a guide only and is not to be copied, distributed or reproduced without prior written consent from Richard Noble & Company. Users of this brochure should not rely on information contained within and should make their own enquiries and obtain independent advice to verify any of the information. Richard Noble & Company does not warrant the accuracy of any information contained within this brochure. This brochure does not constitute advice, and does not take into account the individual circumstances of any interested party.

The fitout plans and drawings remain the property of Office Fitout Professionals (who are not affiliated with Richard Noble & Company) and they hold the council approved building permit for the designs presented within this brochure. The completion of the fitout in accordance with these plans (or otherwise) is to be considered as part of the leasing negotiations.