

1 Mercantile Dock, Port Adelaide

ESTIMATED GROSS LETTABLE AREA

GROUND FLOOR:	178 sq.m
FIRST FLOOR:	178 sq.m

TOTAL GLA: 356 sq.m

Site Area: 197 sq.metres*

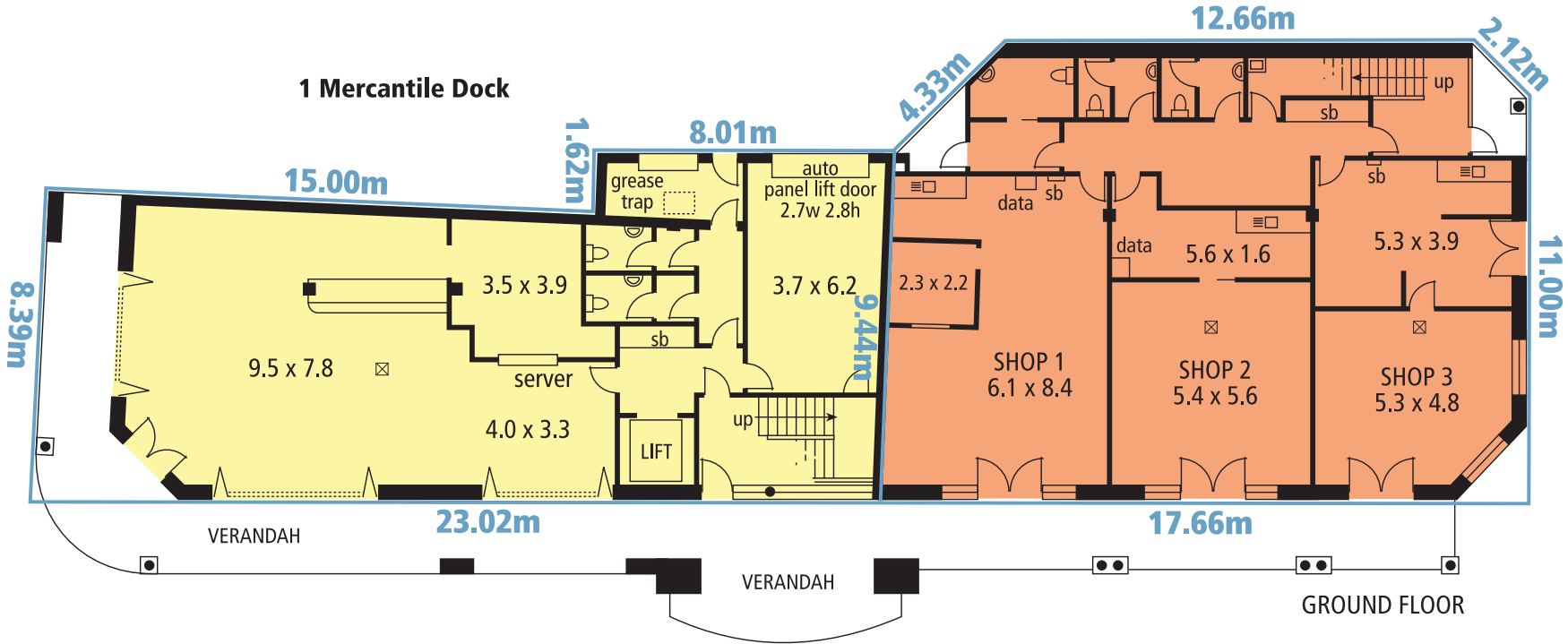

27-29 Mercantile Dock, Port Adelaide

ESTIMATED GROSS LETTABLE AREA

GROUND FLOOR:	203 sq.m
FIRST FLOOR:	211 sq.m

TOTAL GLA: 414 sq.m

Site Area: 211 sq.metres*

sb = switch board
 dist = distribution board
 a/c = air conditioner
 ☒ = air conditioner duct

