

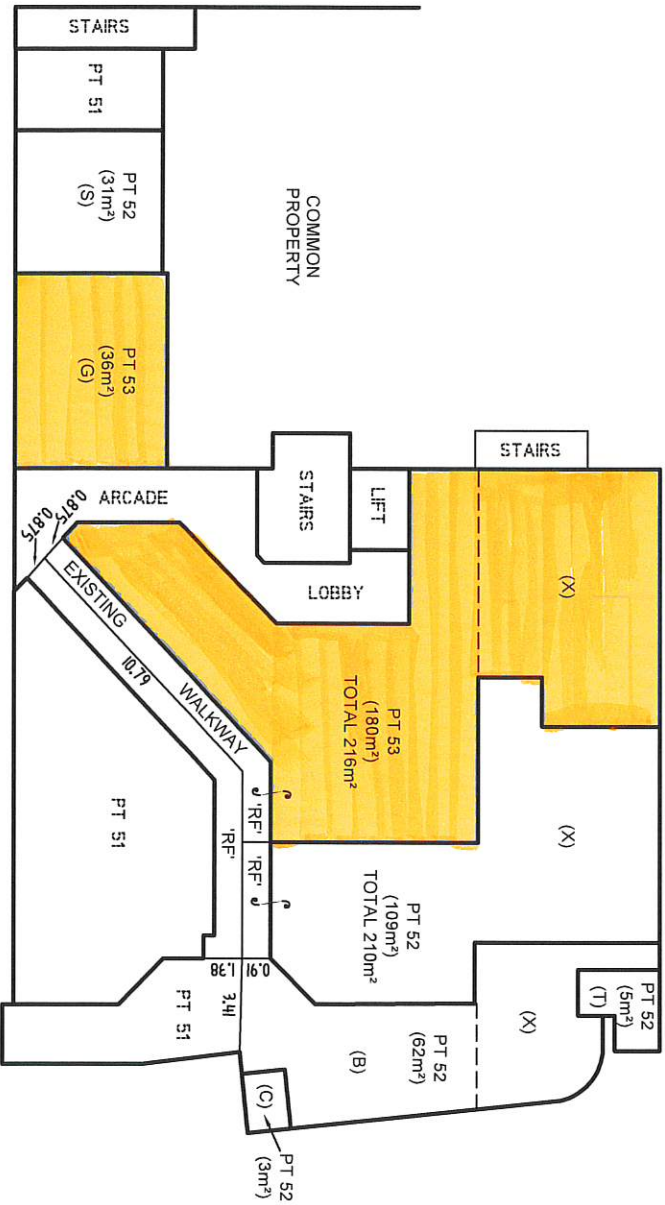

- NOTES:
- (T) TILED STRIPS
  - (G) GARAGE (COVERED)
  - (S) PARKING SPACE
  - (C) CONCRETE STEPS
  - (B) BALCONY
  - (PT) PART
  - RF- RIGHT OF FOOTWAY VARIABLE WIDTH
  - (WIDE SP 77876)
  - (X) BENEFITED BY RIGHT OF WAY 1.5 WIDE- SP55224



**LEVEL 2**

ALL AREAS SHOWN HEREON ARE FOR THE PURPOSE OF THE STRATA SCHEMES DEVELOPMENT ACT ONLY AND ARE APPROXIMATE

THE STRATUM OF THE TILED STEPS EXTENDS FROM THE UNDERSIDE OF TILES TO A HEIGHT 2.2 METRES IMMEDIATELY ABOVE THAT SURFACE, EXCEPT WHERE OVERHANGS PROJECT IN WHICH CASE HEIGHT IS LIMITED TO THE UNDERSIDE OF THOSE SURFACES.

THE STRATUM OF THE PARKING SPACE IS LIMITED TO 2 METRES ABOVE THE UPPER SURFACE OF THE CONCRETE SLAB FORMING THE PARKING SPACE FLOOR, EXCEPT WHERE OVERHANGS PROJECT IN WHICH CASE HEIGHT IS LIMITED TO THE UNDERSIDE OF THOSE SURFACES.

THE STRATUM OF EACH BALCONY EXTENDS FROM THE UNDERSIDE OF TILES FORMING THE BALCONY FLOOR TO A HEIGHT 2.4 METRES ABOVE THAT SURFACE, EXCEPT WHERE OVERHANGS PROJECT IN WHICH CASE HEIGHT IS LIMITED TO THE UNDERSIDE OF THOSE SURFACES.

THE STRATUM OF THE CONCRETE STEPS EXTENDS FROM THE UPPER SURFACE OF THE CONCRETE FORMING THE STEPS TO A HEIGHT 2.2 METRES IMMEDIATELY ABOVE THAT SURFACE.

<p>SURVEYOR Name: ANDREW EDWARD DALY Date: . Reference: 29988</p>	<p>PLAN OF SUBDIVISION OF LOT 50 SP 77876</p>	<p>LGA: PORT STEPHENS Locality: NELSON BAY Reduction Ratio 1:200 Lengths are in metres</p>	<p>REGISTERED</p>	
---	---	--	-------------------	--