

NOTES:
1. AREAS MARKED AS * INDICATE INACCESSIBLE AT TIME OF SURVEY

ST BISHOP LANE

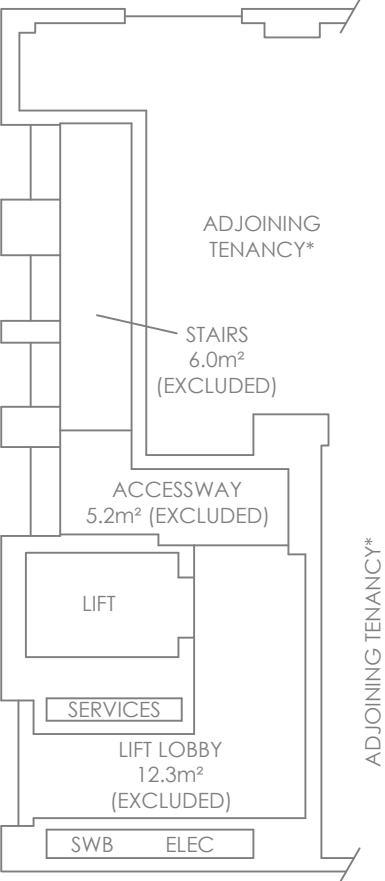

GROUND LEVEL

ST BISHOP LANE

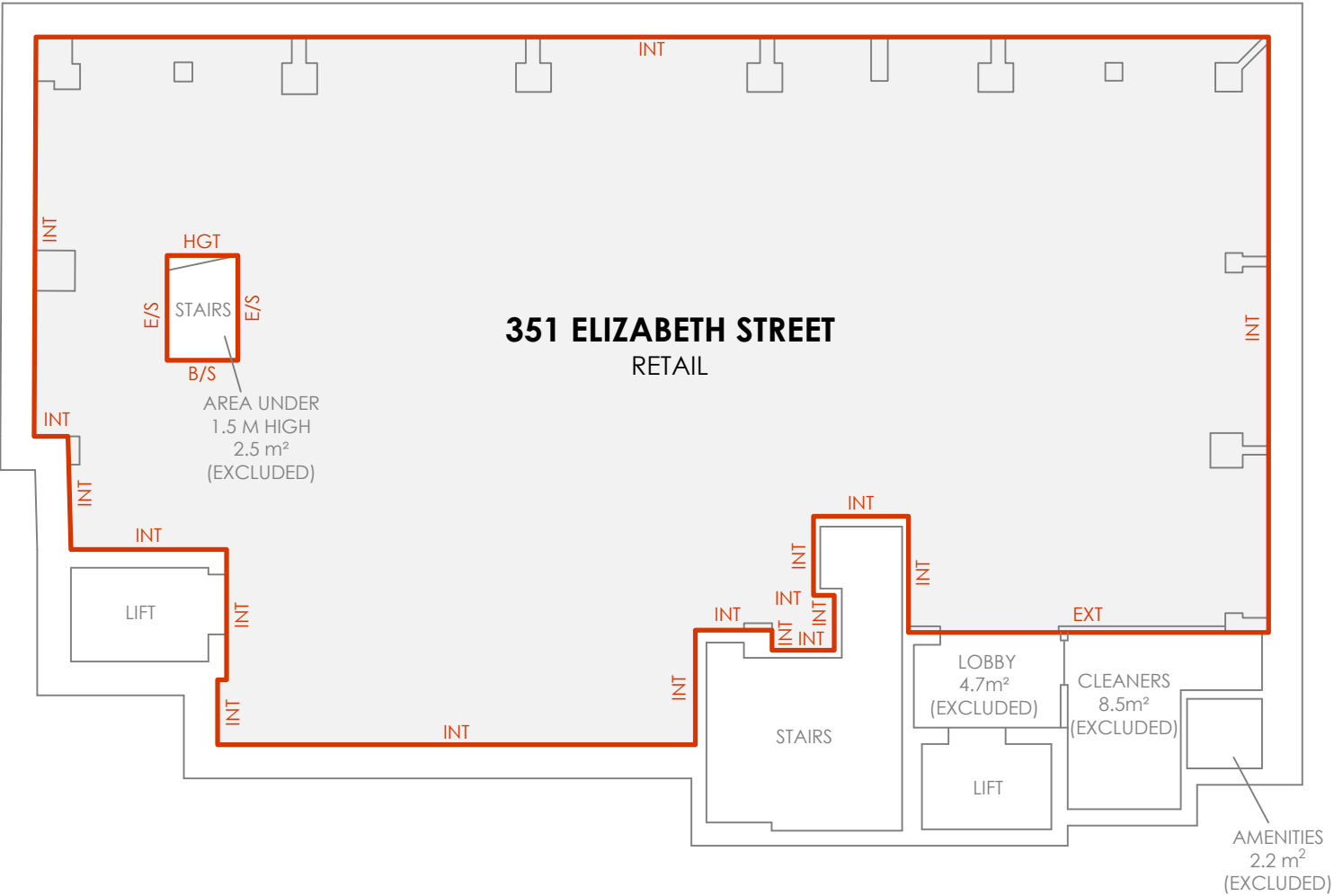

BASEMENT LEVEL

ELIZABETH STREET

- LEGEND
- INT - INTERNAL FACE
 - EXT - EXTERNAL FACE
 - B/S - BOTTOM STEP
 - E/S - EDGE OF STAIRS
 - HGT - HEIGHT CLEARANCE TO 1.5m

CLIENT:

TESKA CARSON

LETTABLE AREA PLAN
BASEMENT LEVEL & GROUND LEVEL,
351 ELIZABETH STREET, MELBOURNE, VIC

DATE: 18/12/2023
REF: 88050
DRAWN: GC
SCALE: 1:125 @ A3
REV: 1
CHECKED: LW
SHEET: 1 OF 1

Australia | New Zealand
REALSERVE
Start confident.

Building Measurement Specialist
Consulting Land Surveyors
3D Laser Scanning
ph. 03 9415 6565
www.realserve.com.au

METHOD OF MEASUREMENT

AREAS HAVE BEEN CALCULATED IN ACCORDANCE AND UNDER
INTERPRETATION OF THE PROPERTY COUNCIL OF AUSTRALIA (PCA)
METHOD OF MEASUREMENT FOR LETTABLE AREA (2008)

(SURVEY DATE 07/12/2023)

GUIDELINES USED

GROSS LETTABLE AREA RETAIL

ALL PARTIES USING THE AREAS EXPRESSED HEREIN, SHOULD AGREE
WITH THE BOUNDARY DEFINITIONS, THIS PLAN WAS PRODUCED FOR
THE CALCULATION OF FLOOR AREAS ONLY

SCHEDULE OF AREAS

BASEMENT LEVEL
RETAIL 254.2 m²

LETTABLE AREA



THE LETTABLE AREA IS SHOWN ENCLOSED BY CONTINUOUS LINES

