



**Office Building at**  
**34A Francis Street, Port Adelaide**  
ESTIMATED GROSS LETTABLE AREA

Office:	119 sq.metres
Amenities:	41 sq.metres

**TOTAL GROSS LA: 160 sq.metres**

Complies with the  
PCA Method of Measurement

ceiling height 2.4m

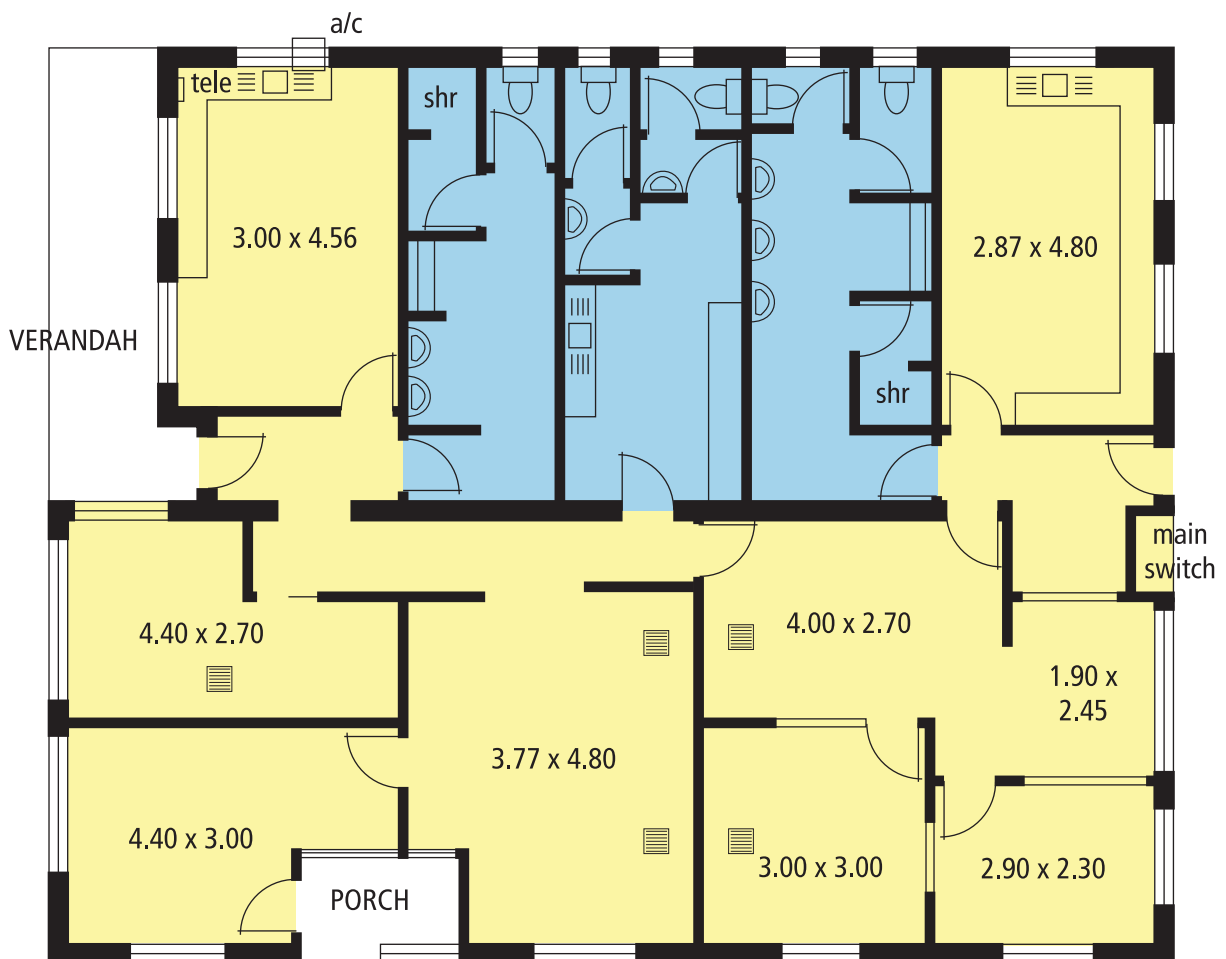

Scale 1:100  
(original sheet size A4)