



*Join key state government
and national tenants in the
middle of Midland's
commercial hub*



CALE HOUSE
MIDLAND

Leasing opportunity

Cale House is a mix-use building ideally located in the middle of Midlands' commercial and retail hub, opposite the popular Midland Gate Shopping Centre and only minutes from Midland train station, major government departments such as Landgate, City of Swan, Centrelink and the Midland Courthouse.

Spread over 3 levels, Cale House can't be missed. The top 2 floors are occupied by government offices and the ground floor comprises of 8 retail units.

The tenants include Cale St Local, Baskin Robbins, Crust Pizza, Katsu Japanese Cafe, Ali Barber Shop, Nails and Beauty, Fitness Studio and the Department of Child Protection and Family Support.



CALE HOUSE
MIDLAND



Location

**Cale House is located at
52 Cale Street, Midland**

Cale House adjoins the heritage listed former school precinct, now transformed into an Art precinct and dining strip including Dome Cafe and The Principal Bar & Restaurant.

Given the central location and great exposure to Midland Gate Shopping Centre and the new Midland Cinema Complex, Cale Street is 'the' entertainment and dining hub of Midland.

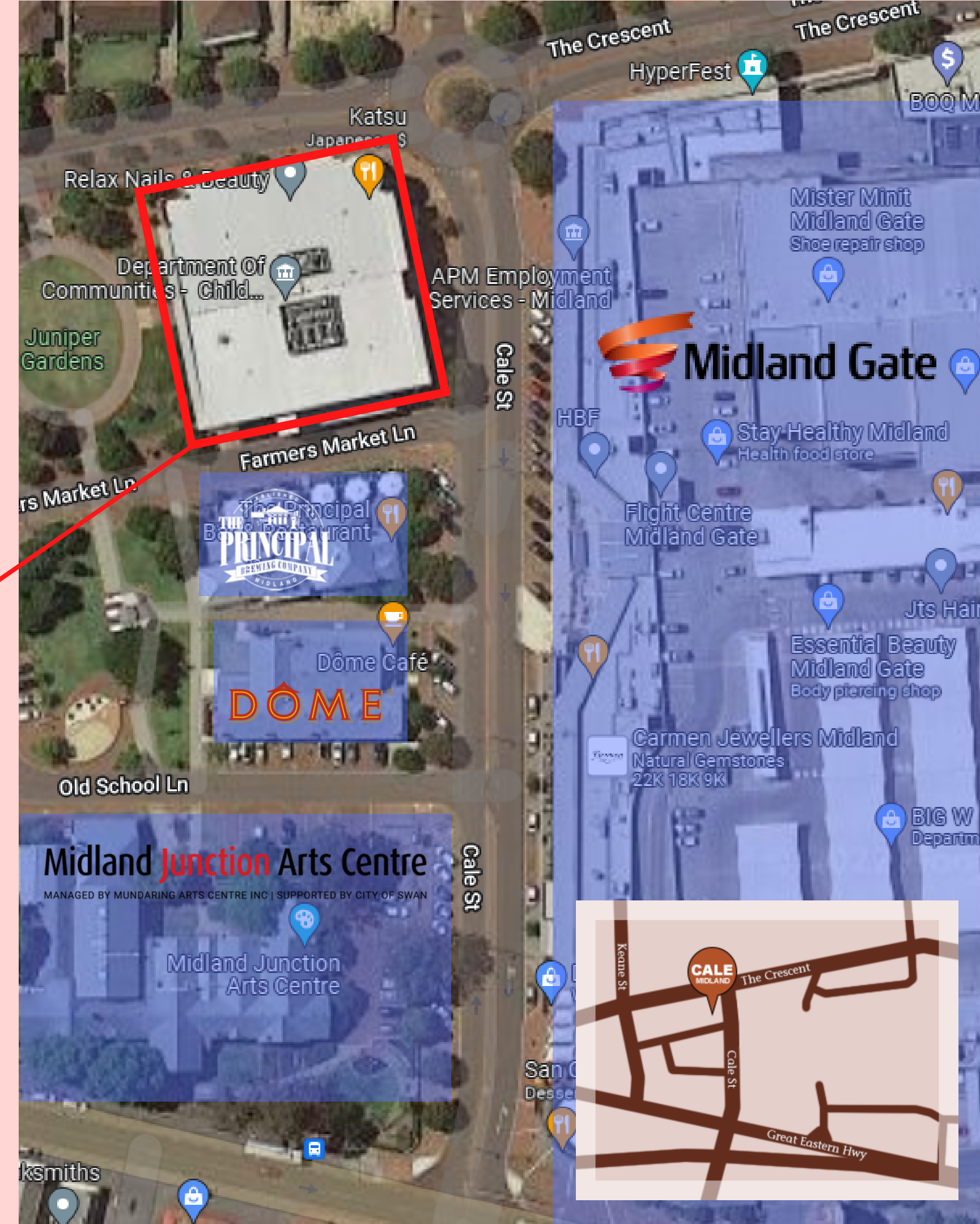

Opportunity

Shop 5A

- Area: 54 m², rectangle shape.
- Last shop available to lease
- Shop 5A is facing The Crescent road and sits between Katsu Japanese Restaurant and Ali Barber.
- Great exposure from a busy road and footpaths.
- Suitable for any use.
- Water and storage available on the premises with communal staff toilet.

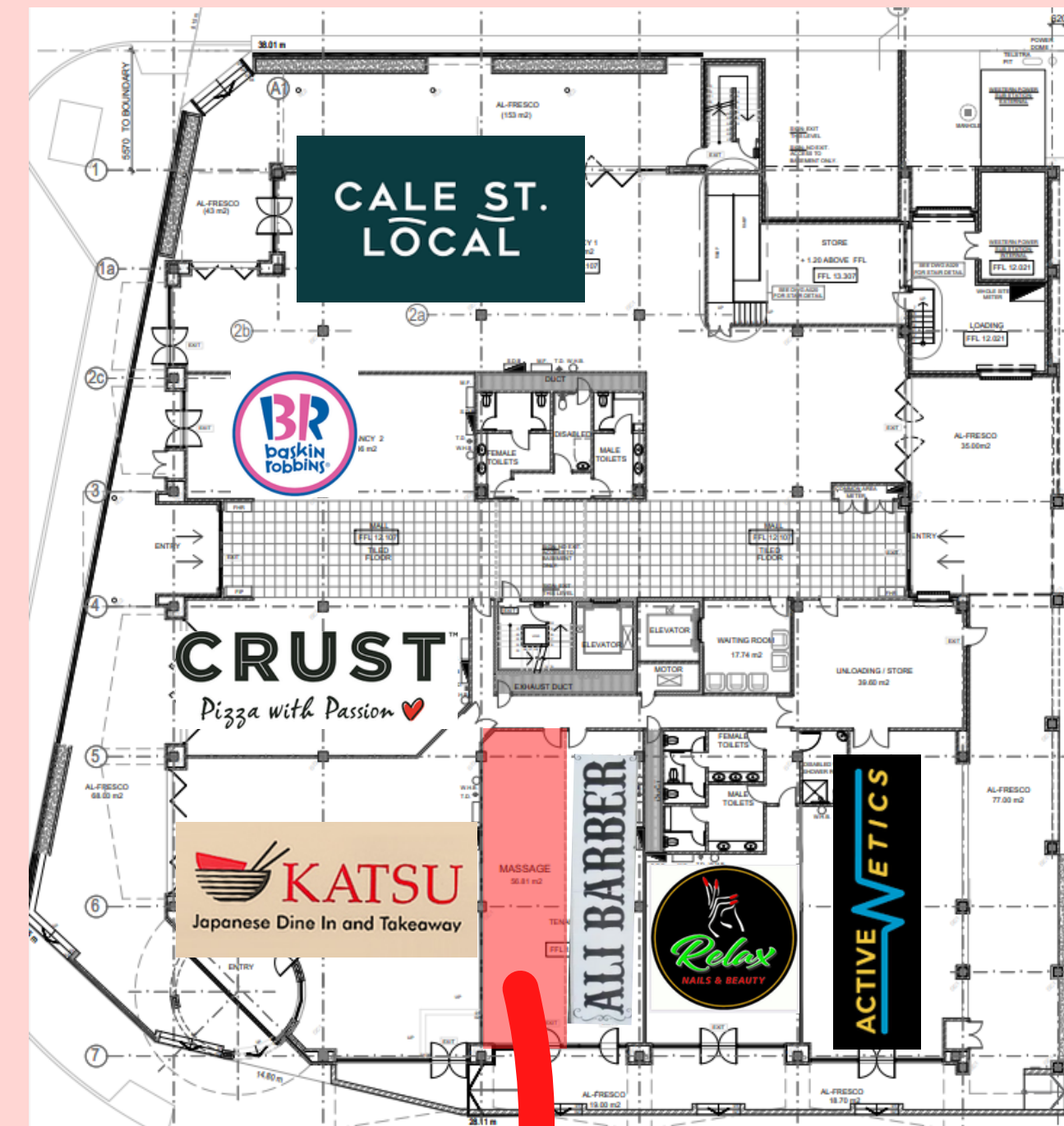
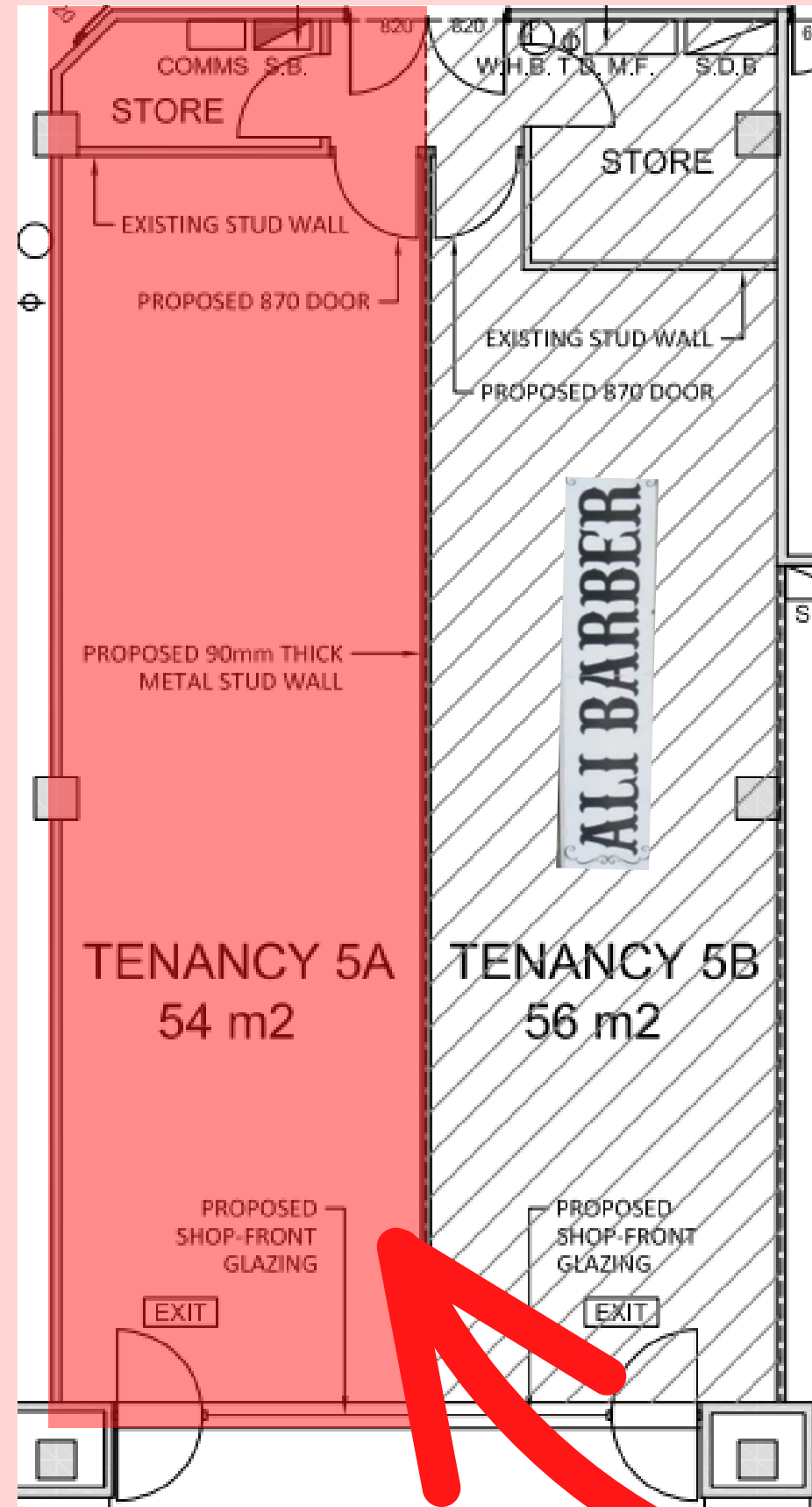

CALE HOUSE
MIDLAND

Contact

For more information, please contact:

Anthony Sorgiovanni
anthony@erceg.com.au
0411 889 355

Vladimir Bullo
vladimir@erceg.com.au
0407 597 885



www.calehouse.com.au



facebook.com/calehousemidland



CALE HOUSE
MIDLAND

 **ERCEG**
MANAGEMENT

