

55/OFF/002/2025

Off-licence

Sections 17 to 20, and 64, Sale and Supply of Alcohol Act 2012

Pursuant to the Sale and Supply of Alcohol Act 2012 (the Act), **Morrison Supermarkets Ltd** (the licensee) is authorised to sell alcohol on the premises situated at **124-128 High Street Greymouth** and known as **New World Greymouth**, to any person for consumption off the premises and to supply alcohol free, as a sample, for consumption on the premises.

Conditions:

- 1. Alcohol may be sold on the premises for consumption off the premises and supplied free as a sample for consumption on the premises on the following days and during the following hours: Monday to Sunday, 7.00am to 9.15pm.**
- 2. No alcohol is to be sold on or delivered from the premises on Good Friday, Easter Sunday, Christmas Day or before 1pm on Anzac Day.**
- 3. When alcohol is being supplied free as a sample, water is to be provided free of charge at the place where the samples are being supplied.**
- 4. No alcohol may be sold other than -**
 - a. Beer that complies with the applicable New Zealand food standard for beer; or**
 - b. Mead that complies with the applicable New Zealand food standard for mead; or**
 - c. Fruit or vegetable wine that complies with the applicable New Zealand food standard for fruit or vegetable wine; or**
 - d. Grape wine that complies with the applicable New Zealand food standard for grape wine; or**
 - e. A food flavouring, prepared for culinary purposes, that is unsuitable for drinking undiluted.**
- 5. A properly appointed certificated or acting or temporary manager must be on duty, at or nearby the point of sale, at all times when the premises are open for the sale and supply of alcohol.**
- 6. The Licensee must display signage as follows:**
 - a. At every point of sale detailing restrictions on the sale and supply of alcohol to minors and intoxicated persons;**
 - b. A copy of the licence attached to the inside of the premises so as to be easily read by people entering each principal entrance to the premises; and**
 - c. A sign prominently displayed at the premises which identifies by name the manager for the time being on duty.**
- 7. The "single alcohol area" for the premises is as described on the plan dated 18 November 2025. The licensee must ensure that:**
 - a. No alcohol is displayed, promoted or advertised outside the single alcohol area; and**
 - b. No products that are not alcohol are displayed, promoted or advertised inside the single alcohol area.**
- 8. The licence is subject to the payment of licence fees as required by the Sales and Alcohol (fees) Regulations 2013.**

The premise licensed area is set out on the plan submitted with the application and date stamped 18 November 2025.

Duration:

Subject to the requirements of the Act relating to the payment of fees, and to the provisions of the Act relating to the suspension and cancellation of licences, this licence continues in force—

- (a) either—
 - (i) until the close of the period for which it was last renewed; or
 - (ii) if it has never been renewed, until the close of the period of 12 months after the day it was

- issued; but
- (b) if an application for the renewal of the licence is duly made before the licence would otherwise expire, either—
- (i) until the close of the period of 3 years after the period for which it was last renewed; or
 - (ii) if it has never been renewed, until the close of the period of 4 years after the day it was issued.

Dated at Greymouth this 23rd day of December 2025



**Group Manager Economic Development & Regulatory Services
for Secretary**

Subject to the requirements of the Act relating to the payment of fees, and to the provisions of the Act relating to the suspension and cancellation of licences, this licence expires on:

24 December 2026

REVISION NOTES:
1 - Refer to previous revisions produced in AutoCAD.

NOTE:
THIS IS A FSI PRODUCED AS-BUILT PLAN THAT REPRESENTS THE CURRENT LAYOUT OF THE PROJECT. ANY CHANGES TO THE PROJECT BEING PRODUCED AS INFORMATION SHOWN IN THE MODEL FROM A PLAN PERSPECTIVE MAY REQUIRE VERIFICATION ON SITE & HEIGHTS OF ALL BUILDING ELEMENTS SHALL BE VERIFIED. ALL HEIGHTS, WALLS & CEILING HEIGHTS ETC. WILL NEED TO BE VERIFIED PRIOR TO ANY FUTURE DEVELOPMENT.

LIQUOR LAYOUT LEGEND

Light Grey	Liquor Main Body
Dark Grey	Liquor Area A
Yellow	POS Area
Blue	Entry / Exit Area

Received At
Grey District
Council
18.11.2025

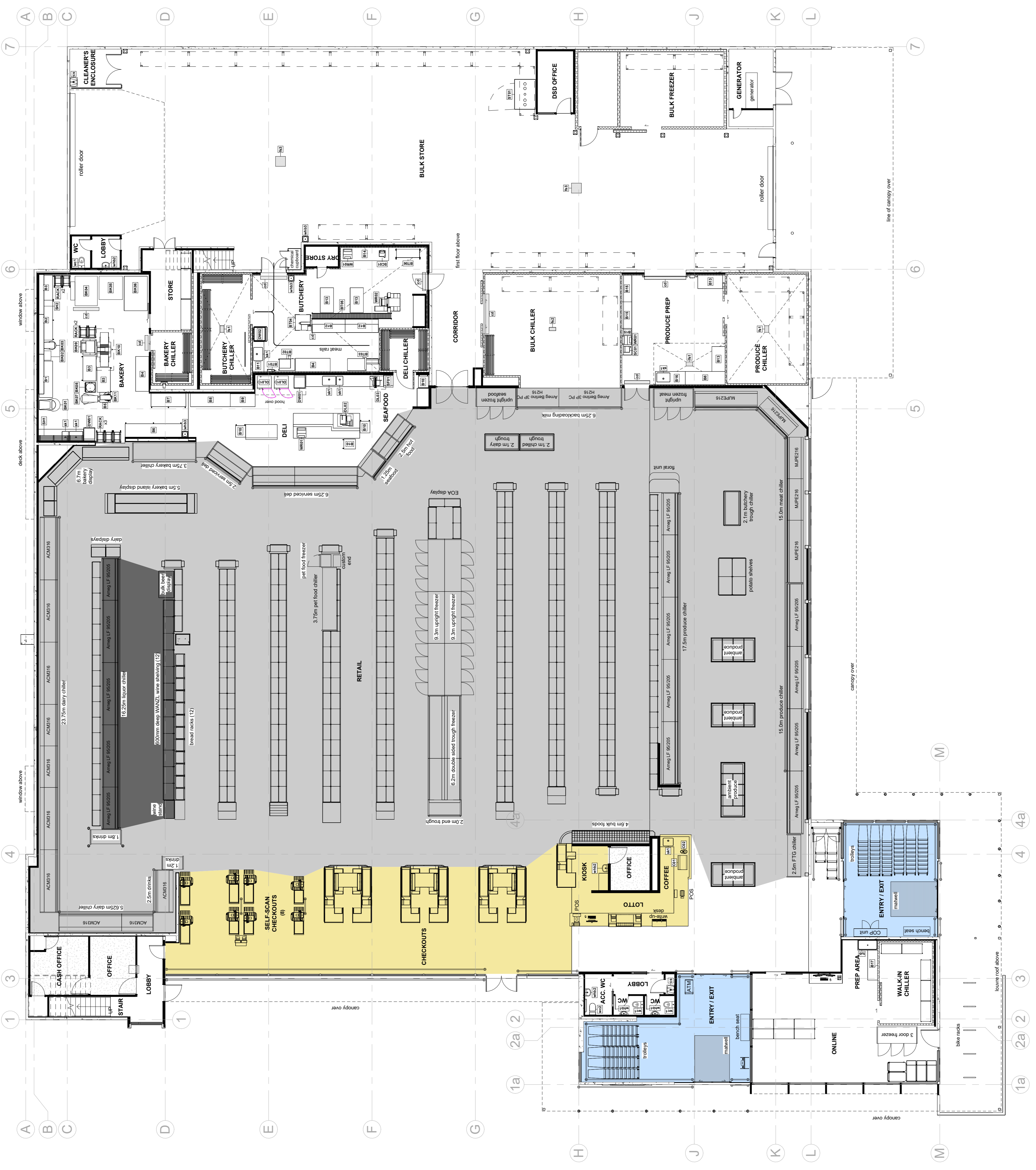

Rev.	Revit As-Built	Amendment	CN	11/09/2025	By	Date
L						

Foodstuffs
South Island

Project name:
New World
Greymouth

Sheet name:
Ground Floor Layout Plan - Liquor Area

Scale:
As indicated @ A1

Date:
17/11/2025 1:18:26 pm

Drawn by:
C. Taylor

Revision:
AS BUILT

Project Status:
AS BUILT

Ground Floor - Liquor, Checkouts & Entry / Exit
Scale 1 : 125