

OFF-LICENCE

Sections 17 to 20, and 64, Sale and Supply of Alcohol Act 2012

DLC Ref: 56/OFF/065/2025

PURSUANT to the Sale and Supply of Alcohol Act 2012 (the Act), **Montaro Limited** is authorised to sell and supply alcohol on the premises situated at **116 Revell Street, Hokitika**, and known as "**New World Hokitika**", to any person for consumption off the premises and to supply alcohol free, as a sample, for consumption on the premises. The licensee is also authorised to sell alcohol on or from the premises and deliver it somewhere else.

The authority conferred by this licence must be exercised through a manager or managers appointed by the licensee in accordance with Section 212 of the Act.

CONDITIONS

This licence is subject to the following conditions:

1. Alcohol may be sold only on, or delivered from, the premises for consumption off the premises, and supplied free as a sample for consumption on the premises, only on the following days and hours:

Monday to Sunday 7.00am to 9.30pm

2. No alcohol is to be sold on or delivered from the premises on Good Friday, Easter Sunday, Christmas Day or before 1.00pm on Anzac Day.
3. No alcohol may be sold other than alcohol that-
 - a. beer that complies with the applicable New Zealand standard for beer; or
 - b. mead that complies with the applicable New Zealand standard for mead; or
 - c. fruit or vegetable wine that complies with the applicable New Zealand standard for fruit or vegetable wine; or
 - d. grape wine that complies with the applicable New Zealand standard for grape wine; or
 - e. a food flavouring, prepared for culinary purposes, that is unsuitable for drinking undiluted.
4. While alcohol is being supplied free as a sample, water is to be provided to patrons at no cost from a water supply prominently situated on the premises.
5. A properly appointed Certificated, or Acting or Temporary, Manager must be on duty, within the licensed area, at all times when the premises are open for the sale and supply of alcohol.
6. The Licensee must display signage as follows:
 - a. At every point of sale, signs detailing restrictions on the sale and supply of alcohol to minors and intoxicated persons;
 - b. A copy of the licence attached to the inside of the premises so as to be easily read by people entering each principal entrance to the premises; and
 - c. A sign prominently displayed at the premises, which identifies by name the manager for the time being on duty.
7. The "single alcohol area" for the premises is as described on the plan included with the application. The Licensee must ensure that:
 - a. No alcohol is displayed, promoted or advertised outside the single alcohol area; and
 - b. No products other than alcohol, low-alcohol and non-alcoholic beer, wine or mead are displayed, promoted or advertised inside the single alcohol area.
8. Alcohol is not to be stacked higher than the height of the black shelving ends, nor should it extend beyond the front edge of the black shelving ends currently installed on the end-of-aisle displays.

Duration

Subject to the requirements of the Act relating to the payment of fees, and to the provision of the Act relating to the suspension and cancellation of licenses, this licence continues to be in force-

- (a) either
 - (i) until the close of the period for which it is renewed; or
 - (ii) if it has never been renewed, until the close of the period of 12 months after the day it was issued; but
- (b) if an application for the renewal of the licence is duly made before the licence would otherwise expire, either-
 - (i) until the close of the period of 3 years after the period for which it was last renewed;or
 - (ii) if it has never been renewed, until the close of the period of 4 years after the day it was issued.

DATED at Hokitika this 29 October 2025



Secretary
Westland District Licensing Committee
Westland District Council

Expiry Date: 29 October 2026



29 October 2025

Montaro Limited
116 Revell Street
Hokitika 7810



Westland District Council
36 Weld Street
Private Bag 704
Hokitika 7842

Phone 03 756 9010
Fax 03 756 9045

Email council@westlanddc.govt.nz

Dear Scott

**SALE AND SUPPLY OF ALCOHOL ACT 2012: GRANT OF OFF LICENCE:
56/OFF/065/2025**

I wish to advise that the following decision has been made under delegated authority in respect of the above application.

DECISION:

Pursuant to Section 64 of the Sale and Supply of Alcohol Act 2012, an Off Licence is granted to Montaro Limited.

REASON FOR DECISION:

The Westland District Licensing Committee has specific criteria to consider in relation to this application. This Committee is satisfied that the application, supporting information and enquiries made demonstrate that the licence is able to be granted within those criteria.

LICENCE EXPIRY AND RENEWAL

Subject to the requirements of the Act relating to the payment of fees, and to the provisions of the Act relating to the suspension and cancellation of licenses, an application for renewal has to be made before the expiry of 29 October 2026.

GENERAL

You are reminded of the various obligations under the Sale and Supply of Alcohol Act 2012 that you have as a licensee. In particular, please note the requirements for the renewal of the licence and the need to have a copy of the licence on display at the principle entrance and other prescribed signage throughout the premises.

Any holder of an Off Licence must appoint a manager or managers who hold a certificate in accordance with Section 212 of the Act. The manager or managers are required to be on duty at all times during the premise's operation for the sale of liquor.

Sincerely

Vern Morris
Team Leader – Regulatory & Community Services
For Secretary, Westland District Licensing Committee

VM/YK

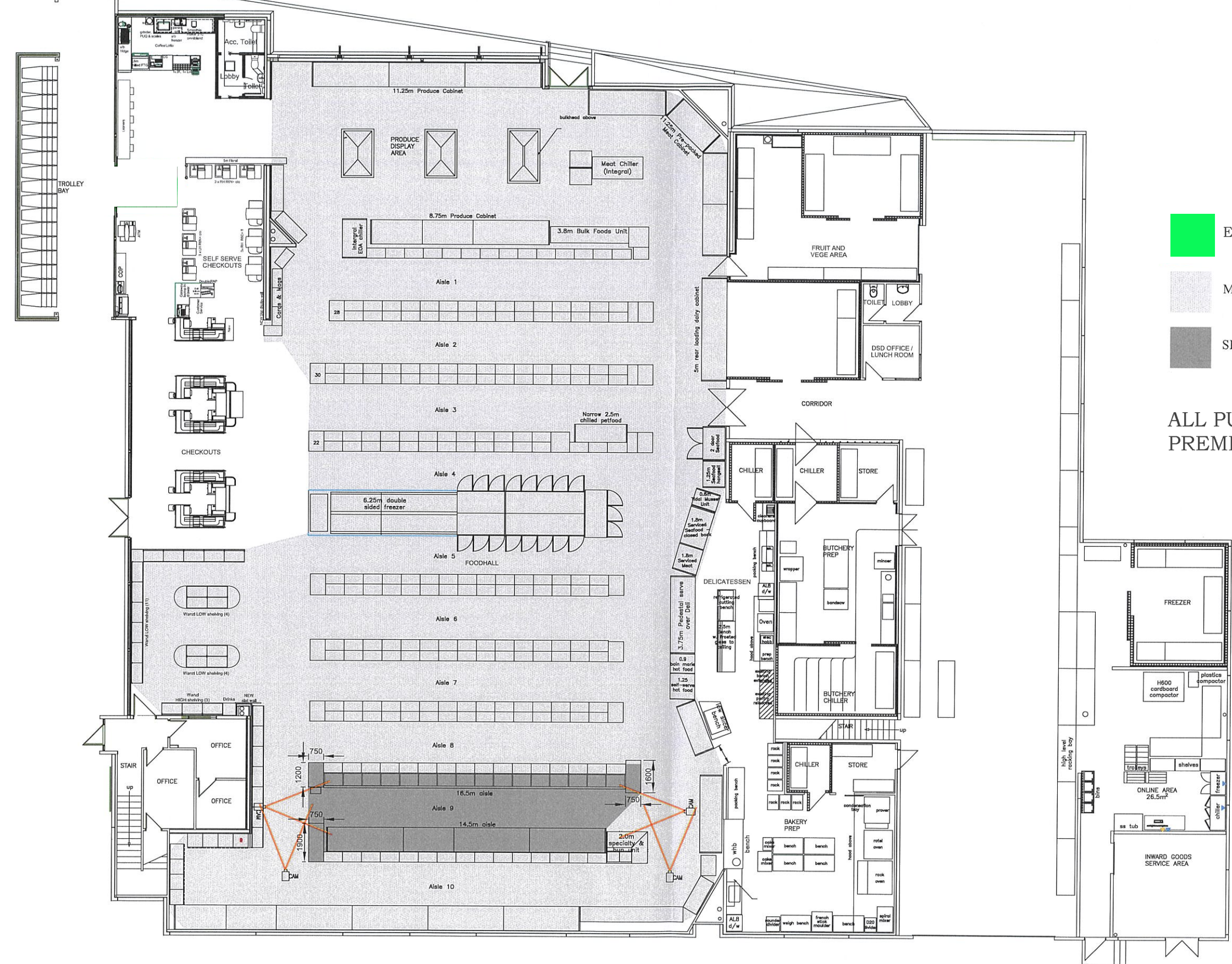

- ENTRY/EXIT
- MAIN BODY
- SINGLE ALCOHOL AREA

ALL PUBLIC PARTS OF THE PREMISES UNDESIGNATED

1. New Coffee to go & Lollo kiosk, produce islands, bulk food unit, wine shelves, checkouts, upright freezer, deli units, wine wine shelving, beer chiller, bakery displays & benches

Revision Notes	
G	Fit out team visit updates/Online TS 14.01.22
F	Foyer/checkout/cafe relay TS 24.11.20
E	See notes RH 12.12.12
D	General amendments from site measure RH 15.05.12
C	Updated -- Areas GM 28.07.06
B	Updated HJM 15.01.04
A	Preliminary TH 24.10.01
Rev.	Amendment By Date

Foodstuffs
South Island

HOKITIKA AS BUILT Ground Floor	
Drawing Scales at A1 size: 1:100	Drawn: McCoy & Wilson Date: 24.10.01
Project No: -	Drawing No: AS.01
	Revision: G

ALL DIMENSIONS TO BE VERIFIED ON SITE

Decision number: 137-2025

IN THE MATTER of the Sale and Supply of
Alcohol Act 2012 (the Act)

AND

IN THE MATTER of an application by **Montaro Limited** pursuant to Section 100 of the Act for the grant of an OFF Licence in respect of premises situated 116 Revell Street, Hokitika known as "**New World Hokitika**"

BEFORE THE WESTLAND DISTRICT LICENSING COMMITTEE

The Application

This is an application by **Montaro Limited** for the grant of an OFF Licence in respect of premises situated 116 Revell Street, Hokitika known as "**New World Hokitika**."

The general nature of the business is that of a supermarket and has been operating under a Temporary Authority for several months.

The days and hours sought are **Monday to Sunday 7.00am to 9.30pm**.

These hours are within the default national maximum trading hours for off licences of 7am to 11pm.

The business is a large open-plan New World franchised store with shelves holding food products and other household goods on all sides and it has a well-defined single alcohol area.

The application was notified on the council's website from the 23rd of September 2025, and no objections were received from members of the public.

Building and Planning certificates have been sought and issued for this activity.

Neither the Police nor the Medical Officer of Health opposed the grant of this licence.

REASONS FOR THE DECISION

The application is complete and contains all the necessary considerations as required under s.100 of the Act. It was duly advertised and no objection or matters in opposition has been received.

Nine certificated managers are currently attached to the business, and a certificated manager is always on duty when the store is open for the sale and supply of alcohol.

Based on this, along with the other criteria outlined in Section 33(2) of the Act, the Committee is satisfied that the business is that of a supermarket and has a compliant Single Alcohol Area (SAA).

We have secured the agreement on the stacking limitations on the end of aisles by way of a discretionary condition that must be complied with at all times.

Subject to the above, I am satisfied as to the matters to which we must have regard as set out in s.105-106 and s.112-114 of the Act.

Accordingly, I deal with the matter on the papers.

DECISION

The District Licensing Committee Chairman, acting pursuant to the Sale and Supply of Alcohol Act 2012, **grants** an application by **Montaro Limited** for an OFF Licence in respect of premises situated 116 Revell Street, Hokitika known as “**New World Hokitika.**” subject to conditions.

Conditions:

The licence is subject to the following conditions:

1. Alcohol may be sold on, or delivered from, the premises for consumption off the premises, and supplied free as a sample for consumption on the premises, only on the following days and hours: **Monday to Sunday 7.00am to 9.30pm.**
2. No alcohol is to be sold on, or delivered from, the premises on Good Friday, Easter Sunday, Christmas Day or before 1.00 pm on Anzac Day.
3. No alcohol may be sold other than –
 - a. beer that complies with the appropriate New Zealand food standard for beer; or
 - b. mead that complies with the appropriate New Zealand food standard for mead; or
 - c. fruit or vegetable wine that complies with the appropriate New Zealand food standard for fruit or vegetable wine; or
 - d. grape wine that complies with the appropriate New Zealand food standard for grape wine; or
 - e. a food flavouring, prepared for culinary purposes, that is unsuitable for drinking undiluted.

4. While alcohol is being supplied free as a sample, water is to be provided to patrons at no cost from a water supply prominently situated on the premises.
5. A properly appointed Certificated, or Acting or Temporary, Manager must be on duty, within the licensed area, at all times when the premises are open for the sale and supply of alcohol.
6. The Licensee must display signage as follows:
 - a. At every point-of-sale signage detailing the restrictions on the sale and supply of alcohol to minors and intoxicated persons.
 - b. A copy of the licence attached to the inside of the premises so as to be easily read by people entering each principal entrance to the premises; and
 - c. A sign prominently displayed at the premises, which identifies by name the manager for the time being on duty.
7. The “single alcohol area” for the premises is as described on the plan included with the application. The licensee must ensure that:
 - a. No alcohol is displayed, promoted or advertised outside the single alcohol area; and
 - b. No products other than alcohol, low-alcohol and non-alcoholic beer, wine or mead are displayed, promoted or advertised inside the single alcohol area.
8. Alcohol is not to be stacked higher than the height of the black shelving ends, nor should it extend beyond the front edge of the black shelving ends currently installed on the end-of-aisle displays.

The licence is granted for 12 months from the date of issue.

DATED at Hokitika this 24th day of October 2025



Murray Clearwater
Chairperson/Commissioner
Westland District Licensing Committee



Report to District Licensing Committee.

Date: 24 October 2025
To: Secretary of District Licensing Committee.
From: Licensing Inspector.

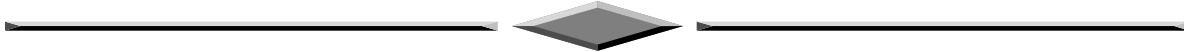

APPLICATION FOR: Off Licence

APPLICANT: Montaro Limited

POSTAL ADDRESS: 116 Revell Street, Hokitika 7810

1. Premises Details:

- a) **Trading name: New World Hokitika**
- b) **General nature: Supermarket**
- c) **Business description: Supermarket**
- d) **Location address: 116 Revell Street, Hokitika**
- e) **Hours of Operation: Off Licence
7.00am to 9.30pm Monday to Sunday**

f) Is the sale of alcohol to be the principal business?	No
g) Has the premises been previously licensed?	Yes
h) Are the premises currently operating pursuant to a Temporary Authority?	Yes
i) Were the premises subject to a previous public hearing decision?	Yes

2. Applicant Details:

a) The status of the application (partnership, company, natural person, trust, etc.)	Company
b) If a company, are the director's details clearly given?	Yes
c) Does the applicant's name match the Certificate of Incorporation?	Yes
d) Is it clear that the applicant will take the profit from the sale of alcohol?	Yes

3. Host Responsibility Details:

a) Is there a menu or an indication of food availability?	n/a
b) Provision of non-alcoholic and low alcohol beverages?	Yes
c) Statement re: Sale of alcohol to prohibited persons?	Yes
d) Steps that the applicant proposes to take to provide assistance with or information about alternative forms of transport from the premises?	n/a

4. Plan Details:

a) Are they accurate and properly reflect the entire premises?	Yes
b) Any outdoor areas shown and designated?	n/a
c) Are the designations (if any) shown, and are they appropriate?	Yes
d) Should the entire premises be designated?	No
e) Is the principal entrance able to be clearly identified?	Yes

5. Public Notice:

a) Does the applicant's name match?	Yes
b) Is it worded correctly?	Yes
c) Do the proposed hours match?	Yes
d) Is the general nature of the operation clearly detailed?	Yes
e) Is any waiver necessary?	No

6. Resource Management Certificate:

a) Does the address given match?	Yes
b) Is it unconditional?	Yes
c) If NO, are the conditions to which it is subject appended to the certificate, and do they alter the application in any way (affect the hours of operation/ability to trade on certain days/allow the service of alcohol to appropriate classes of patrons in terms of S.7)?	n/a

7. Building Code Compliance:

a) Does the address given match?	Yes
b) Is it worded correctly, certifying the premises meets the requirements of the code or are exempt?	Yes
c) If NO, are the conditions to which it is subject appended to the certificate, and do they alter the application in any way (affect the hours of operation/ability to trade on certain days/allow the service of alcohol to appropriate classes of patrons in terms of S.7)?	n/a

8. Police Report:

a) Is the application clearly identified?	Yes
b) Does the report make a positive recommendation?	Yes
c) Is it a final clearance?	Yes

9. Medical Officer of Health Report:

a) Is the application clearly identified?	Yes
b) Does the report make a positive recommendation?	Yes
c) Is it a final clearance?	Yes

10. General:

a) Is the application of a similar type and with similar conditions to matters already approved by the Authority/Agency?	Yes
b) (off licence only) Where the applicant also holds an on licence, do the hours sought in respect of this off licence application correspond with those hours?	n/a
c) Is the application signed and dated?	Yes

11. Conclusion:

- a) Is the application suitable to hold a licence?
- b) Are the proposed hours of operation satisfactory?
- c) Is the nature of the proposed premises satisfactory?

Yes
Yes
Yes

Comments

SETTING:

New World Hokitika supermarket is located at 116 Revell street, on the edge of the commercial area of Hokitika. The supermarket offers a comprehensive range of food and non-food household items to the general public.

Within a 50-metre radius from the New World premises, there are two Off licenses, being Super Liquor Store and The Bottle-O Hokitika. Additionally, two other Off licenses operate in Hokitika, being Coasters Supermarket, approximately 700 metres away, and Stafford Street Four Square, situated over a kilometre away.

LOCAL ALCOHOL POLICY:

The Westland District Council does not have a local alcohol policy.

DAYS ON WHICH AND THE HOURS DURING WHICH THE APPLICANT PROPOSES TO SELL ALCOHOL:

The applicant has proposed the following hours of trading for the premises:

Off Licence:

7am to 9.30pm Monday to Sunday

The hours sought for the Off licence are identical to those held by the previous licensee.

These hours are reasonable considering the type of activity that occurs on the premises.

The premises operate as a supermarket and frequently extend their hours during the summer to accommodate events such as the Hokitika Wildfoods Festival.

SUITABILITY OF THE APPLICANT:

The director of the applicant company has managed Pak n Save Northlands in Canterbury for the last nine and a half years. Upon inquiry, The Chief Alcohol Licensing Inspector from Christchurch City Council advised no known issues. No concerns have been brought to my attention regarding any breaches of the Sale and Supply of Alcohol Act 2012.

DESIGN AND LAYOUT OF THE PREMISES:

Alcohol is displayed on both sides of a single aisle in the premises. The alcohol display area is located as far as practicable from the entrance/exit and the checkout area. Customers are able to complete their shopping without passing through the single alcohol area aisle; however, those purchasing chilled goods or bread and bakery items will need to pass this area. The operator intends for the entire public part of the supermarket, with the exception of the toilet facilities, to be undesignated.

WHETHER THE APPLICANT IS ENGAGED IN, OR PROPOSES ON THE PREMISES TO ENGAGE IN, THE SALE OF GOODS OTHER THAN ALCOHOL, LOW ALCOHOL REFRESHMENTS, NON-ALCOHOLIC REFRESHMENTS AND FOOD AND IF SO, WHICH GOODS:

The applicant sells a variety of non-food household items.

WHETHER THE APPLICANT IS ENGAGED IN, OR PROPOSES ON THE PREMISES TO ENGAGE IN, THE PROVISION OF SERVICES OTHER THAN THOSE DIRECTLY RELATED TO THE SALE OF ALCOHOL, LOW ALCOHOL REFRESHMENTS, NON-ALCOHOLIC REFRESHMENTS AND FOOD AND IF SO, WHICH SERVICES:

The applicant does not intend to provide other services from this premises.

WHETHER THE APPLICANT HAS APPROPRIATE SYSTEMS, STAFF AND TRAINING TO COMPLY WITH THE LAW:

The New World group (Foodstuffs) utilise point-of-sale equipment with a default setting that requires supervisor authorisation for all the alcohol transactions.

An excellent in-house training programme is in place for all staff, focusing on the responsible sale of alcohol.

Currently, nine staff members hold managers certificates. All staff are fully aware of the legal restrictions on sale of alcohol to minors and intoxicated people, as well as the specific days on which alcohol sales are prohibited.

Regular monitoring visits have been conducted at this business, with no issues recorded to date.

WHETHER THE AMENITY AND GOOD ORDER OF THE LOCALITY WOULD BE LIKELY TO BE REDUCED, TO MORE THAN A MINOR EXTENT, BY THE EFFECTS OF THE ISSUE OF THE LICENCE:

This application has resulted from the sale of this business to a company led by a director with extensive experience in the supermarket sector. The granting of this licence will not increase the number of Off licenses within the commercial area of Hokitika.

The central business district of Hokitika experiences a very low incidence of anti-social behaviour, including noise and vandalism, particularly when compared to larger metropolitan areas.

The issue of this Off licence will not result in the amenity and good order of the locality being reduced by more than a minor extent.

WHETHER THE AMENITY AND GOOD ORDER OF THE LOCALITY ARE ALREADY SO BADLY AFFECTED BY THE EFFECTS OF THE ISSUING OF THE EXISTING LICENCES:

The District Licensing Committee must assess consider whether the amenity and good order of the locality are already been so adversely affected by existing licenses that the issuance of an additional licence would be unlikely to be reduced further, or would only be reduced further to a minor extent by the effects of the issue of the licence but it is nevertheless desirable not to issue any further licences.

The central business district of Hokitika does not experience the social issues such as vandalism, excessive noise, or other forms of anti-social behaviour, commonly associated with larger metropolitan centres. The amenity and good order of the locality is not affected in any significant manner.

MATTERS ARISING IN ANY REPORTS FROM THE POLICE OR MEDICAL OFFICER OF HEALTH:

The application was not opposed by either the Police or the Medical Officer of Health, and no comments were included in their respective reports.

OBJECT OF THE ACT

The object of the Act is that:

- (a) The sale, supply and consumption of alcohol should be undertaken safely and responsibly; and
- (b) The harm caused by excessive or inappropriate consumption of alcohol should be minimised.

The applicant has had extensive experience, having managed similarly licensed premises for a nine and a half years. The New World organisation upholds robust training programmes, comprehensive guidelines, and well-established policies and practices to ensure the responsible sale of alcohol of alcohol.

Recommendation:

Principal Entrance

The public entrance to the building at the southern end of the building

Trading hours

Monday to Sunday 7am to 9.30pm

Designations

The entire public part of the premises is undesignated as outlined in the site plan submitted with the application.

Condition

That alcohol is not be stacked higher than the height of the black shelving ends, nor should it extend beyond the front edge of the black shelving ends currently installed in the end-of-aisle areas.



Yolanda Knoetze

INSPECTOR OF LICENSED PREMISES

Officer for Enquiries: Rodney Beckett

8 October 2025

The Secretary
District Licensing Committee
C/o Westland District Council
Hokitika 7842

Attention: Yolanda Knoetze

Dear Madam

RE: SALE AND SUPPLY OF ALCOHOL ACT 2012 – APPLICATION BY MONTARO LIMITED, TRADING AS NEW WORLD HOKITIKA FOR AN OFF LICENCE AT NEW WORLD HOKITIKA, SITUATED AT 116 REVELL STREET, HOKITIKA

Having discussed the Off Licence at the supermarket with the director and Duty Manager of the applicant company and received an email on behalf of the Alcohol Harm Prevention Officer New Zealand Police West Coast, I have no matters in opposition to the application.

I have no opposition to the granting of an Off Licence to Montaro Limited, trading as New World Hokitika, for the reported hours at New World Hokitika, situated at 116 Revell Street, Hokitika.

Yours sincerely,



Rodney Beckett
Alcohol Licensing Officer
for Dr Cheryl Brunton
Medical Officer of Health, West Coast

[TeWhatuOra.govt.nz](https://www.TeWhatuOra.govt.nz)

3 Tarapuhi Street, Greymouth, 7840
Waea pūkoro: +64 27 886 0562

Yolanda Knoetze

From: WILKINSON, Julie <Julie.Wilkinson@police.govt.nz>
Sent: Thursday, 2 October 2025 12:18 pm
To: Yolanda Knoetze
Cc: Rodney Beckett
Subject: New Off Licence - Montaro Ltd T/A New World Hokitika OF137

This email is from an external sender. Be careful when opening any links or attachments. If you are unsure, please contact IT for assistance.

Good afternoon Yolanda

Re: New Off Licence - Montaro Ltd T/A New World Hokitika OF137

Police have no opposition to the issue of this Off Licence.

Regards,

Julie Wilkinson K524
Watchhouse Officer
Hokitika

E julie.wilkinson@police.govt.nz



WARNING
The information contained in this email message is intended for the addressee only and may contain privileged information. It may also be subject to the provisions of section 50 of the Policing Act 2008, which creates an offence to have unlawful possession of Police property. If you are not the intended recipient of this message or have received this message in error, you must not peruse, use, distribute or copy this message or any of its contents. Also note, the views expressed in this message may not necessarily reflect those of the New Zealand Police. If you have received this message in error, please email or telephone the sender immediately.