



KuMax

CS3U-335 | 340 | 345P (IEC1000V)

CS3U-335 | 340 | 345P (IEC1500V)

With Canadian Solar's poly cell technology and the industry leading innovative LIC (Low Internal Current) module technology, we are now able to offer our global customers high power poly modules up to 345 W.

The KuMax poly modules with a dimension of 2000 x 992 mm, close to our 72 cell MaxPower modules, have the following features:

MORE POWER



Low power loss in cell connection



**Low NMOT: 42 ± 3 °C
Low temperature coefficient (Pmax): -0.38 % / °C**



Better shading tolerance



High PTC rating of up to: 92.52 %

MORE RELIABLE



Minimizes micro-cracks



Lower hot spot temperature



**Heavy snow load up to 5400 Pa,
wind load up to 3600 Pa***

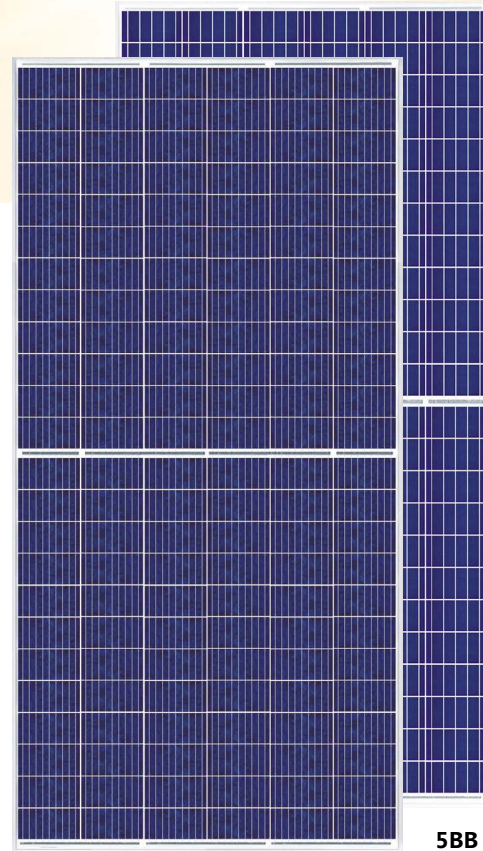

MBB

5BB



linear power output warranty



**product warranty on materials
and workmanship**

MANAGEMENT SYSTEM CERTIFICATES*

ISO 9001:2008 / Quality management system
ISO 14001:2004 / Standards for environmental management system
OHSAS 18001:2007 / International standards for occupational health & safety

PRODUCT CERTIFICATES*

IEC 61215 / IEC 61730: VDE / CE
UL 1703: CSA



* If you need specific product certificates, and if module installations are to deviate from our guidance specified in our installation manual, please contact your local Canadian Solar sales and technical representatives.

CANADIAN SOLAR INC. is committed to providing high quality solar products, solar system solutions and services to customers around the world. As a leading PV project developer and manufacturer of solar modules with over 25 GW deployed around the world since 2001, Canadian Solar Inc. is one of the most bankable solar companies worldwide.

* For detailed information, please refer to Installation Manual.

CANADIAN SOLAR INC.

Canadian Solar MSS (Australia) Pty Ltd., 44 Stephenson St, Cremorne VIC 3121, Australia
support@canadiansolar.com, www.canadiansolar.com/au

ENGINEERING DRAWING (mm)

Rear View

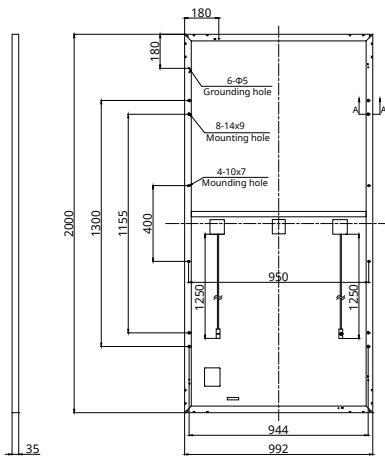

Frame Cross Section A-A

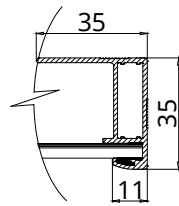

Mounting Hole

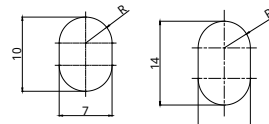

CS3U-340P / I-V CURVES

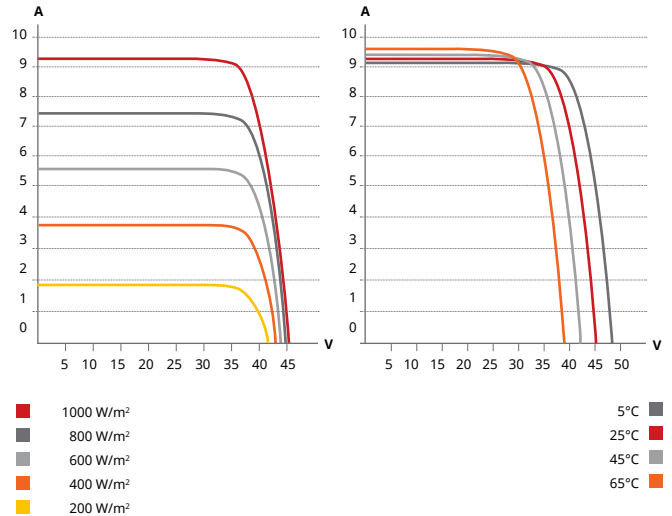

ELECTRICAL DATA | STC*

CS3U	335P	340P	345P
Nominal Max. Power (Pmax)	335 W	340 W	345 W
Opt. Operating Voltage (Vmp)	38.2 V	38.4 V	38.6 V
Opt. Operating Current (Imp)	8.77 A	8.86 A	8.94 A
Open Circuit Voltage (Voc)	45.7 V	45.9 V	46.1 V
Short Circuit Current (Isc)	9.28 A	9.36 A	9.44 A
Module Efficiency	16.89%	17.14%	17.39%
Operating Temperature	-40°C ~ +85°C		
Max. System Voltage	1500V (IEC/UL) or 1000V (IEC/UL)		
Module Fire Performance	TYPE 3 / Type 13 (UL 1703) or CLASS A (IEC61730)		
Max. Series Fuse Rating	30 A		
Application Classification	Class A		
Power Tolerance	0 ~ + 5 W		

* Under Standard Test Conditions (STC) of irradiance of 1000 W/m², spectrum AM 1.5 and cell temperature of 25°C. Measurement uncertainty: ±3 % (Pmax).

ELECTRICAL DATA | NMOT*

CS3U	335P	340P	345P
Nominal Max. Power (Pmax)	249 W	252 W	256 W
Opt. Operating Voltage (Vmp)	35.3 V	35.5 V	35.7 V
Opt. Operating Current (Imp)	7.04 A	7.11 A	7.18 A
Open Circuit Voltage (Voc)	42.7 V	42.9 V	43.1 V
Short Circuit Current (Isc)	7.49 A	7.55 A	7.62 A

* Under Nominal Module Operating Temperature (NMOT), irradiance of 800 W/m², spectrum AM 1.5, ambient temperature 20°C, wind speed 1 m/s.

MECHANICAL DATA

Specification	Data
Cell Type	Poly-crystalline, 156.75 X 78.38 mm
Cell Arrangement	144 [2 X (12 X 6)]
Dimensions	2000 X 992 X 35 mm (78.7 X 39.1 X 1.38 in)
Weight	22.5 kg (49.6 lbs)
Front Cover	3.2 mm tempered glass
Frame	Anodized aluminium alloy, crossbar enhanced
J-Box	IP68, 3 diodes
Cable	4 mm ² (IEC), 12 AWG (UL)
Cable Length	1250 mm (49.2 in), 1670 mm (65.7 in) is optional for single tracking system with leap-frog connection
Connector	T4 series (MC4 series is available)
Per Pallet	30 pieces
Per Container (40' HQ)	660 pieces

TEMPERATURE CHARACTERISTICS

Specification	Data
Temperature Coefficient (Pmax)	-0.38 % / °C
Temperature Coefficient (Voc)	-0.31 % / °C
Temperature Coefficient (Isc)	0.05 % / °C
Nominal Module Operating Temperature	42 ± 3°C

PARTNER SECTION



* The specifications and key features contained in this datasheet may deviate slightly from our actual products due to the on-going innovation and product enhancement. Canadian Solar Inc. reserves the right to make necessary adjustment to the information described herein at any time without further notice.

CANADIAN SOLAR INC.

Canadian Solar MSS (Australia) Pty Ltd., 44 Stephenson St, Cremorne VIC 3121, Australia
support@canadiansolar.com, www.canadiansolar.com/au