



Instruction Manual

15.6" Full HD Portable Monitor - BP15PM603D



Enjoy it.

CONTENTS

General Safety	4
Controls and Connections	8
Split-Screen Mode Settings	12
Menu Button Operation	13
Operation	
Picture	14
Color Effect	14
Information	15
Reset	15
Advance	16
Option	16
Temperature	17
OSD Setting	17
Specifications	18
Customer Helpline	Last Page

GENERAL SAFETY

Read this manual thoroughly before you start using the Monitor.

Store this manual, the completed warranty card, your receipt and the product packaging.

The safety precautions instructions reduces the risk of fire, electric shock and injury when correctly complied to.

Please follow all instructions and take notice of all warnings.



The cover (or back) of the unit should not be removed to prevent risk of electric shock.

This unit must be serviced by a qualified service personnel only.



The lightning flash with symbol within the triangle is intended to warn you of a non-insulated dangerous voltage in the product's enclosure that could be of sufficient magnitude to generate a risk of electric shock to persons.



The exclamation point within the triangle is intended to warn you to the presence of important operating and maintenance instructions in the documents included with the product.

IMPORTANT INFORMATION

The lightning flash symbol within the triangle is intended to warn you of non-insulated dangerous voltage the product's enclosure that could be of sufficient magnitude to generate a risk of electric shock to persons.

- Using Cabinets or stands recommended by the manufacturer of the monitor.
- Only using furniture that can safely support the Products.
- Ensure the Product is not overhanging the edge of the supporting furniture.
- Do not place the product on a high furniture without securing both the furniture and the product to a stable support.
- Do not place the product on cloth or other conductive materials.
- Warn children of the dangers of climbing on furniture to reach the monitor or its controls and to call for an adult to assist.

GENERAL SAFETY (CONT.)

IMPORTANT INFORMATION

- Do not expose this appliance to rain or moisture as it may result in fire or an electric shock hazard
- Do not tamper or change or modify the product in any way.
- Only use Accessories outlined and recommended by the manufacturer.
- Please do not expose the product to splashing or water contact
- Please do not place any object on top of the product including objects filled with liquids such as vases.

Installation

Please follow instruction when installing this product in accordance with the instruction manual. This product must be positioned in a sufficiently stable location, it can be potentially hazardous due to falling and can cause injury, particularly to children if it positioned incorrectly.

- Before installing this Monitor set, make sure your outlet voltage corresponds to the voltage stated on the product rating label
- Do not use a damaged power cord, plug or loose outlet. Doing so may cause an electric shock.
- Do not plug several devices into the same outlet. Doing so may cause the outlet to overheat and start a fire. Make sure the outlet is readily accessible during operation of the equipment.
- Do not bend, twist or kink the power cord excessively.
- Do not allow anything to rest on or roll over the power cord and antenna cable. Doing so may cause a fire or an electric shock.
- Do not run the power cord near heat-producing appliances such as radiators, stoves or irons. The excessive heat could melt the insulation and expose live wires, resulting in fire or electric shock.
- Unplug this Monitor during lightning storms or when unused for long periods of time. Not doing so may result in fire or electric shock.
- Do not cover the ventilation openings of the product with items such as newspapers, tablecloths, curtains etc or insert objects into the slots available on the products. As this could result in the product temperature rising and could cause a fire.
- If you notice any unusual odors or smoke around the unit, immediately disconnect the unit from the outlet and contact the service center. Failure to do so may result in fire or electric shock.
- When not using the unit for long periods of time or when you are moving the unit please ensure to disconnect the power cord from the wall socket.

GENERAL SAFETY (CONT.)

- Please beware that Dust could accumulate over time on the unit and cause it to generate heat and or deteriorate insulation, which in turn may result in an electrical fire.
- The product is not intended for use by persons (including children) with reduced physical, sensory or mental capabilities, or young children of any age, They must be supervised product by a person responsible for their safety.
- To maintain the product do not use any chemical or cleaning agent or wet cloth, please only ensure to utilize a dry cloth to wipe it down from marks or dust and only after unplugging the product from the power socket.
- Please ensure to contact our call center for any repair or service required for the products.
- Make sure to always carry Monitor from the sides, always be sure to have assistance by another person. Do not carry the Monitor from the middle.

WARNING!

Toppling furniture and Monitor's can cause serious injury or death.

If a monitor is not positioned in a sufficiently stable location, it can be potentially hazardous due to falling. Many injuries, particularly to children, can be avoided by taking simple precautions such as:

- Using cabinets or stands recommended by the manufacturer of the monitor.
- Only using furniture that can safely support the monitor.
- Ensuring the monitor is not overhanging the edge of the supporting furniture.
- Not placing the monitor on tall furniture (for example, cupboards or bookcases) without anchoring both the furniture and the monitor to a suitable support.
- Not standing the monitor on cloth or other materials placed between the monitor and supporting furniture.
- Educating children about the dangers of climbing on furniture to reach the monitor or its controls.

GENERAL SAFETY (CONT.)

Please make sure upon positioning this product, the place is:

- Not wet or damp and Well ventilated
- Away from direct sunlight or heaters.
- Away from splashes or food.
- Protected from excessive dust or grease.
- Do not install this equipment in a confined space such as a bookcase or similar unit.
- Do not install the Monitor set near heat sources such as radiators, stoves or other audio visual equipment that produce heat.
- Do not place containers with liquids, if liquid falls inside the products it may result in short-circuit, fire or electric shock.
- Do not place small metallic objects on top of the unit. Metal object falls inside the product it may result in short-circuit, fire or electric shock.
- Do not use or store flammable or combustible materials near the unit. Doing so may result in fire or explosion. Do not place any naked flame sources, such as lit candles, cigarettes or incense sticks on top of the Monitor set.
- Install the unit at a reasonable distance from the wall to ensure sufficient ventilation.



The terms HDMI, HDMI High-Definition Multimedia Interface, and the HDMI Logo are trademarks or registered trademarks of HDMI Licensing Administrator, Inc.

CONTROLS & CONNECTIONS

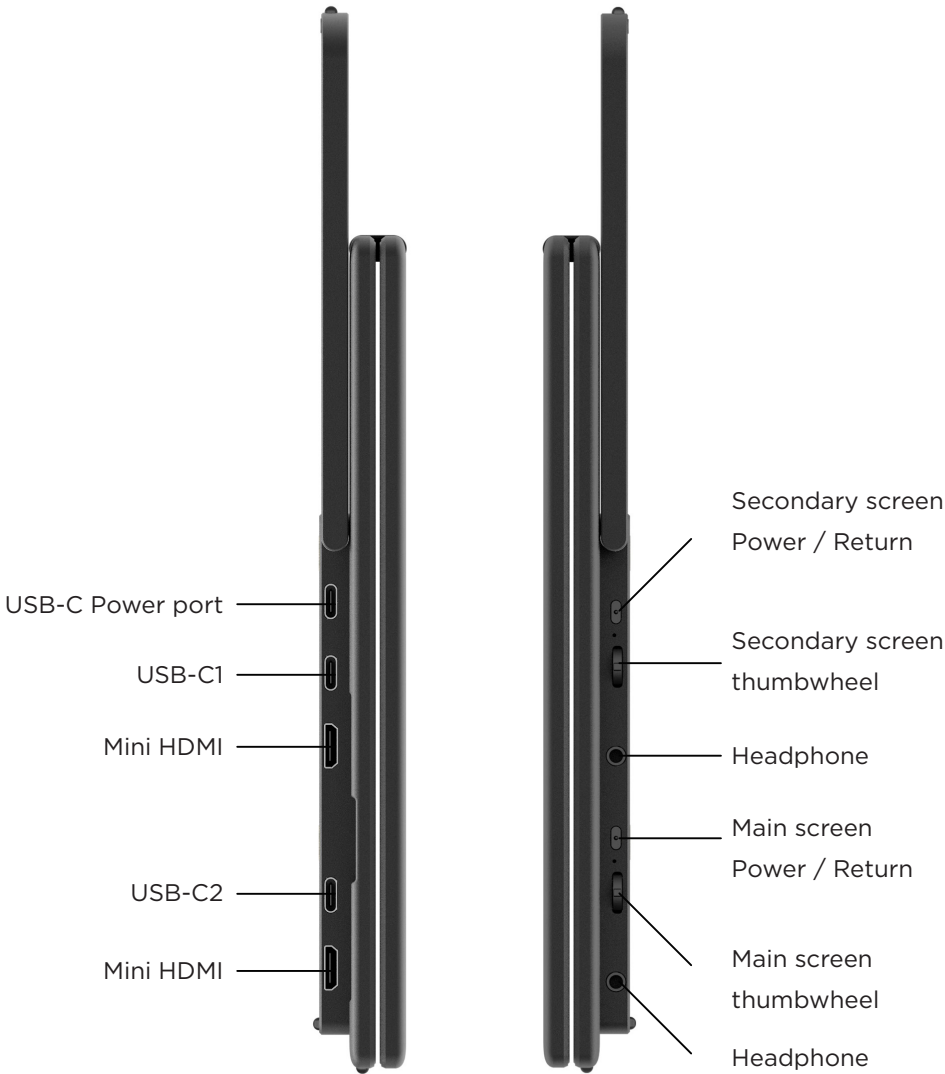

CONTROLS & CONNECTIONS(CONT.)

Mini HDMI	Responsible for the transmission of audio and video signals
USB-C1	This port supports full functionality, PD power supply, and the connection of devices with USB-C video and audio source output functions. One-cable work, turn on the upper screen.
Mini HDMI	Responsible for the transmission of audio and video signals
USB-C2	This port supports full functionality, PD power supply, and the connection of devices with USB-C video and audio source output functions. One-cable work, both the upper and lower screens can be lit up.
USB-C Power port	For charging use
Secondary screen Power / Return	Return to the upper-level menu/Flip the upper screen
Secondary screen thumbwheel	Control the upper screen, pull it up and down to quickly adjust the brightness or volume. Hold down the middle to enter the menu
Headphone	Supports external 3.5mm headphones/speakers
Main screen Power / Return	Power button (hold for 3 seconds to turn on/off)/Return to the upper-level menu
Main screen thumbwheel	Control the lower screen, pull it up and down to quickly adjust the brightness or volume. Hold down the middle to enter the menu
Headphone	Supports external 3.5mm headphones/speakers

CONTROLS & CONNECTIONS(CONT.)

USB-C PORTS

Note: When connecting the laptop and the monitor with a USB-C cable, please first confirm whether the USB-C port of the laptop is USB3.1. Non-USB 3.1 ports do not support USB-C connections. Please refer to the “HD connection” method below for wiring.

USB-C cable at one end connected to the middle of the lower monitor under USB-C port, the other end is connected to a fully functional USB-C port video output device (such as a laptop); Plug the external power supply into another USB-C port on the lower monitor.

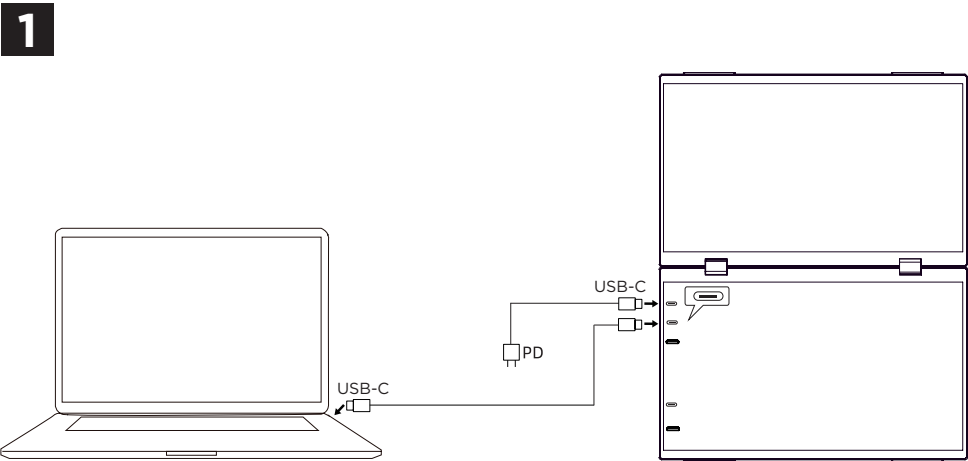

HD CONNECTION

Please first supply power externally with a power source that meets quality requirements. Then, connect one end of the HD cable to the HD port of the monitor and the other end to a video output device with an HD port (such as a laptop).

Note: When connecting an external HD cable, please connect the power supply first and then the HD to ensure smooth signal transmission. The power supply should not be less than 15W(5V3A).

For HD connection, the main and secondary screens need to provide signals respectively, and the connected devices should have two HD ports. If the device does not have two HD, please prepare an additional expansion dock.

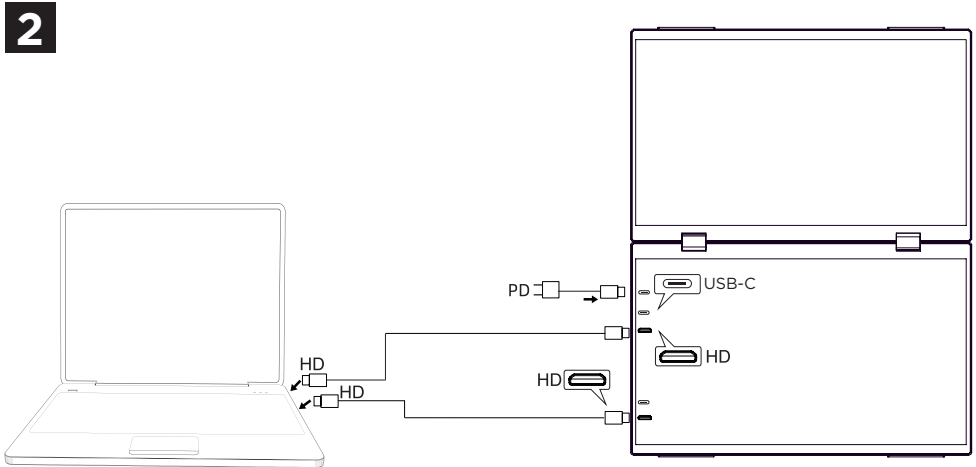

SPLIT-SCREEN MODE SETTINGS

1. Please connect the display screen to the device correctly according to the “Device Connection Reference”, then open the computer “Settings - Screen” and set the display screen to Copy or extend.
2. Then, short press the power button on the lower screen to enter the split-screen mode Settings. Scroll down the thumbwheel to select the ideal split-screen mode. Short press the protruding part of the thumbwheel to confirm the selection.

Note

For users who need to set up an extension, if they have successfully selected “Extension” in the split-screen mode (the word “Extension” in the split-screen function turns orange, indicating a successful setting), and the monitor still shows the same content, please return to the computer’s “Settings - Screen” and set the split-screen mode of the monitor to “Extend to These Displays” again. Apply it, and the process will be completed.

MENU BUTTON OPERATION

Shortly press menu button (the protruding part in the middle of the thumbwheel) open the OSD menu function, through the scroll thumbwheel, find the need to set up the content, short press the menu button to select, scroll thumbwheel to adjustment model/data, short press the menu button to confirm.

After completing the Settings, short press the power button to return.

OPERATION

PICTURE

- Brightness
- Contrast
- Black- equalizer
- Game Mode

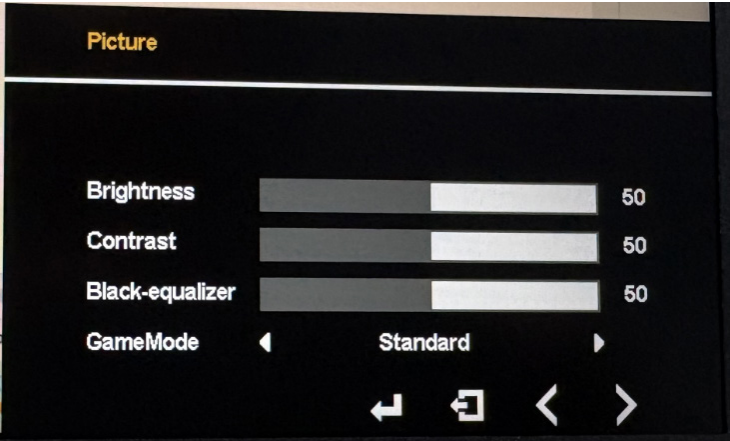

COLOR EFFECT

- Saturation
- Hue
- Sharpness
- DispRotate

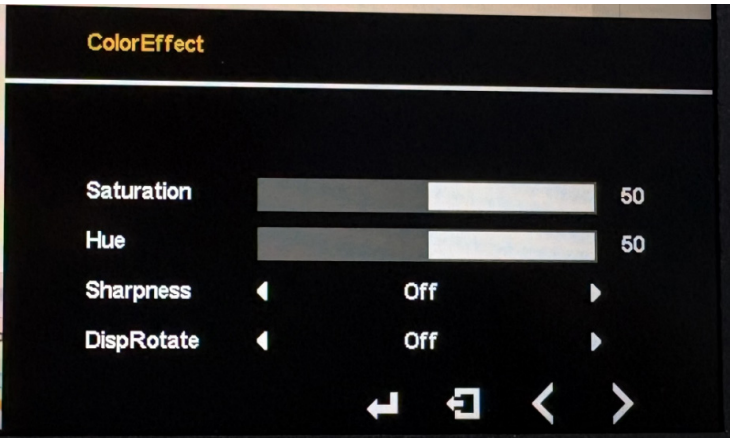

OPERATION (CONT.)

INFORMATION

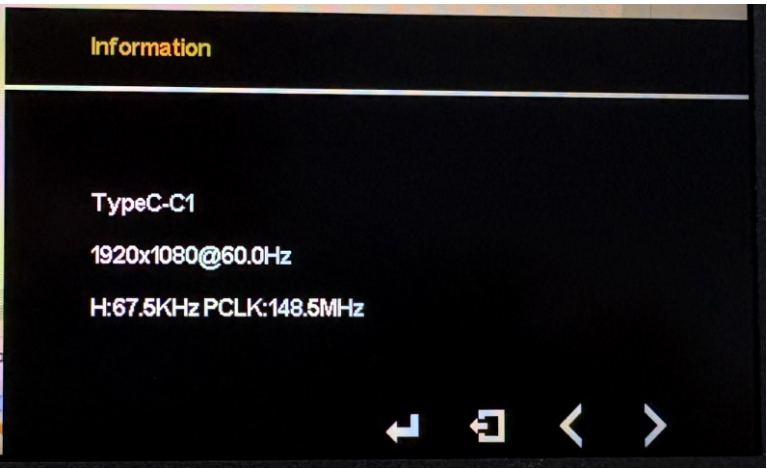

RESET

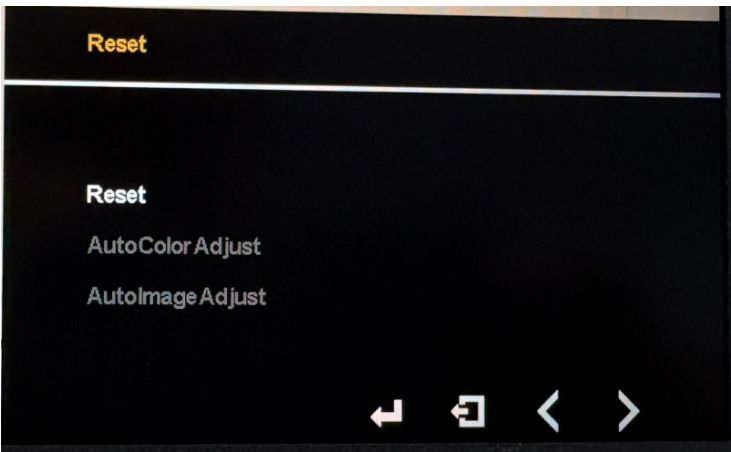

OPERATION (CONT.)

ADVANCE

- Ultra HDR Mode
- Eye Protection
- 3D Sound
- Crosshair

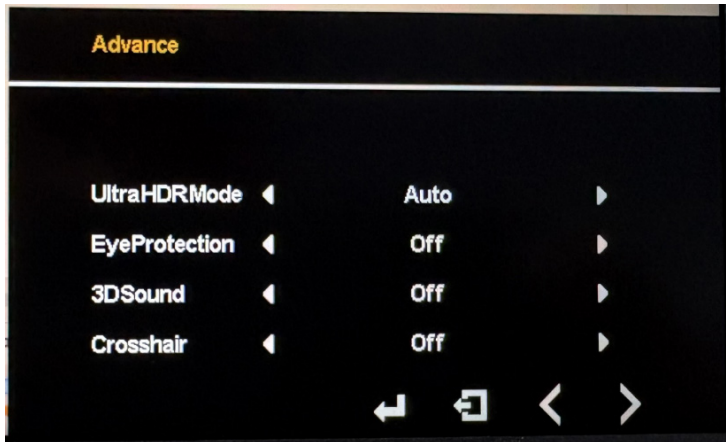

OPTION

- Source
- Language
- Aspect Ratio
- Volume

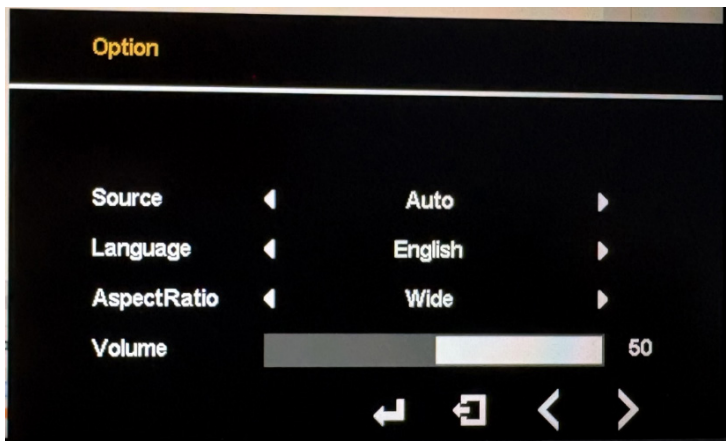

OPERATION (CONT.)

TEMPERATURE

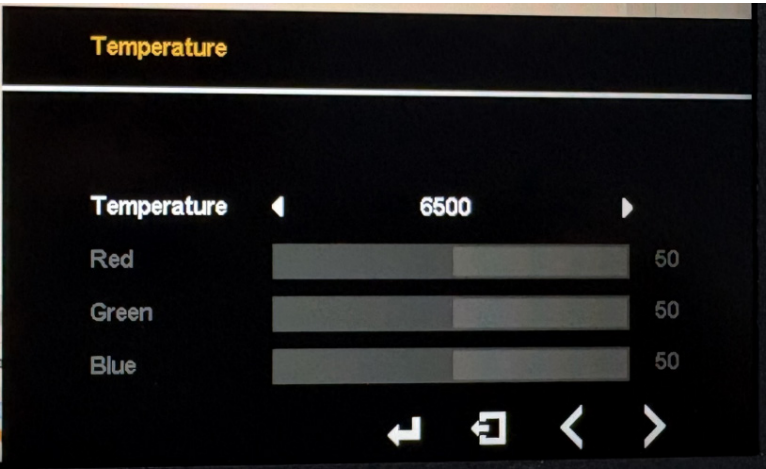

OSD SETTING

- H.Position
- V.Position
- Menu Time
- Transparency

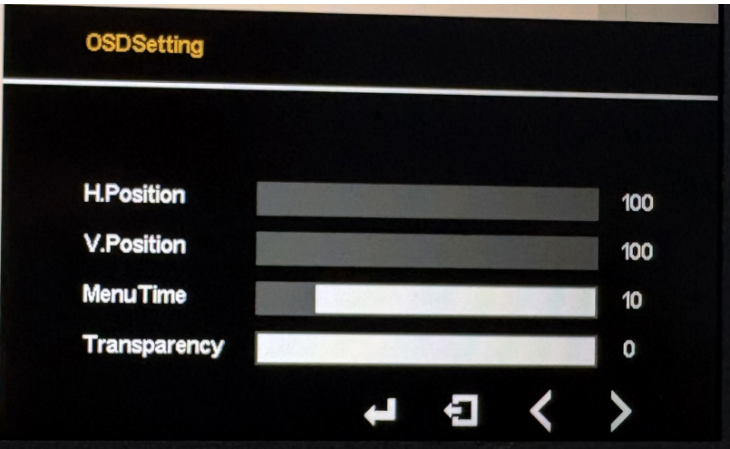

SPECIFICATIONS

Resolution	1920 x 1080 P	
Screen gamut	45% NTSC	
Contrast ratio:	1000 : 1	
Brightness	250nit	
Refresh Rate	60Hz	
Input	5V⎓ 3A	
Accessories	1 x Instruction Manual	1 x Warranty Card
	1 x USB-C to USB-C Cable	1 x Mini HDMI Cable

THIS PAGE IS
LEFT BLANK ON
PURPOSE



CUSTOMER HELPLINE:

info@ayonz.com
02 8279 8606

DISTRIBUTED BY:

Ayonz Pty Ltd