



**Model: WCCA10**  
**Infrared Auto-Sensing**  
**Wireless Charging Cradle**



**Qi Certified**

Certification program ensures this charger has passed rigorous tests to guarantee safety, compatibility and energy efficiency.

User Manual v1.1

**Product Specification**

- Infrared sensor automatically detects your phone and opens the cradle
- To remove your phone, simply press the button on the side to open the cradle
- Supports 10W wireless fast charging for compatible devices such as Samsung Galaxy S20 / S10 / S9 / S8 Note 10 / 9 / 8 / 5\*
- Supports 7.5W Apple wireless fast charging for the latest wireless charging iPhones\*
- Supports 5W standard wireless charging for all Qi enabled devices
- No need to remove your case. Works with most cases up to 3mm thick
- Full safety protection for your devices with Qi certified temperature control, strict voltage regulation & short circuit protection
- Includes premium vent mount, dash mount and window mount
- Includes Quick Charge 3.0 USB car charger and 1.2m USB-C cable
- Wireless Standard: WPC/Qi (v1.2.4)
- Input: DC 5V 2A / 9V 1.67A / 12V 2A
- Output: 5W / 7.5W / 10W / 15W

\* When connected to included Quick Charge 3.0 USB car charger

**Control Button Function**



The control button is used to turn the infrared sensor on or off.

If you don't have your phone in the cradle and the movement of your hands are triggering the infrared sensor, you can turn it off.

Press control button and the infrared sensor will turn off. You can still open and close the locking arms by pressing the buttons on either side of the cradle.

Press the control button again to turn the infrared sensor back on.

**Adjustable Holder Function**

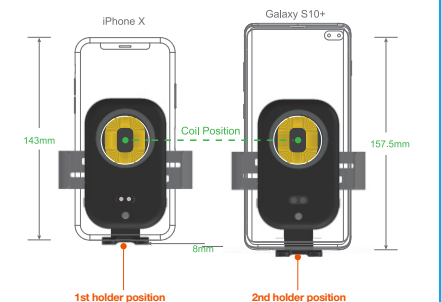

compatible with all size mobile phones					
1st holder position			2nd holder position		
size of phone ≤ 153mm			size of phone > 153mm		
Brand	Model	Length	Brand	Model	Length
Samsung	S6	143.4mm	Samsung	S8+	159.5mm
Samsung	S7	142.4mm	Samsung	S9+	158.1mm
Samsung	S8	148.9mm	Samsung	S10+	157.5mm
Samsung	S9	147.7mm	Samsung	NOTE8	162.5mm
Samsung	S10	149.9mm	Samsung	NOTE9	161.9mm
Samsung	S10e	142.2mm	Apple	iPhone XS Max	157.5mm
Samsung	Note5	153.2mm	LG	G7	153.2mm
Apple	iPhone 8	138.4mm	Huawei	Mate P30 pro	158mm
Apple	iPhone X	143.6mm	Huawei	Mate 20 pro	158.2mm
Apple	iPhone XS	143.6mm	Xiaomi	Mi9	157.5mm
Apple	iPhone XR	150.9mm			

This wireless charging cradle has an adjustable bottom holder. The holder can be adjusted up or down to suit different size mobile phones. For optimum wireless charging results, the wireless receiver coil in the mobile phone should be aligned with the wireless transmitter coil in the cradle.

To achieve optimum wireless charging results, use the table provided as a guide to which holder position is best for your mobile phone model.

**Installation Steps**

**1. How to install the air vent holder.**

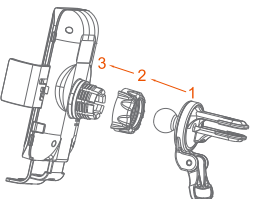

Follow the arrows to install the 3 parts.

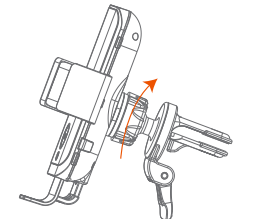

Tighten the screw cap so the cradle is secure but still able to swivel.

**2. Connect the wireless charger to the QC 3.0 USB car charger with the supplied cable.**

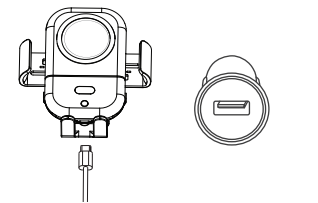

For fast wireless charging, you must use the supplied Qualcomm Quick Charge 3.0 USB car charger.

**3. Press the vent holder prongs together to open and then insert into the vent. Adjust the bottom stability arm to best suit the vent.**

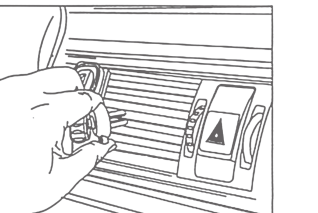

**4. Placing your mobile phone**

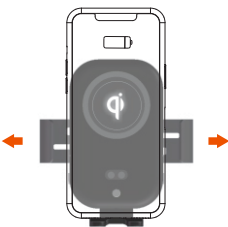

Infrared sensor



Push Button

**Infrared Sensor Control**  
Bring your phone close to the infrared sensor and the locking arms will open. Place your phone in the cradle and the arms will automatically close and securely hold your phone. Wireless charging should automatically commence.

**Push Button Control**  
If the infrared sensor is turned off, press the button on either side of the cradle to open the locking arms. Place your phone in the cradle and press the button to close the arms. Wireless charging should commence automatically.

**5. Removing your mobile phone**



Press the button on either side of the cradle and the locking arms will open.

Push Button

**6. LED indicator shows the charger status:**

1. White LED: Standby-mode.
2. Blue LED: Charging normally.
3. Red LED: Charging abnormally.



LED indicator

⚠ If the LED light is red during wireless charging, this indicates a charging failure.

The following situations can cause charging failures, including over heating, slow charging or no charging.

1. The charging cradle is connected to a USB charger that is not supplying enough power. For best results and fast charging, use the supplied QC 3.0 USB car charger and charging cable.
2. The charging cable is not an original or quality 3rd party cable.
3. The phone case is too thick (cases with a thickness less than 3mm are recommended).
4. The wireless charging receiver coil on your phone is not aligned with the wireless transmitter coil on the cradle. Adjust the bottom holder to align the coils.
5. There is metal or a magnet on the back of your phone or phone case.

iPhone is a trademark of Apple inc., registered in the U.S. and other countries.  
The 'Qi' Symbol is a trademark of the Wireless Power Consortium.



www.mycomsol.com.au

Made in China