



# WEBCAM

CP11-AF200V



USER GUIDE



# Welcome

We hope you enjoy your purchase!

SPHERE products are carefully designed and produced to the highest standards of performance and safety, backed by our comprehensive 1 Year Warranty.

This user guide will provide all the information required for you to setup and use your new product.

# Contents

Welcome	2
General Safety Warnings	4
Product Overview	7
Operation	9
Troubleshooting	11
Specifications	13
Compliance and Responsible Disposal	14



## General Safety Warnings



This product complies with Australian Safety Standard AS/NZS 62368.1 to ensure the safety of the product.

**Location:** Make sure the location for the product is well ventilated, and away from damp and cold, protected from overheating and away from direct sunlight, away from moisture drips or splashes and protected from excessive dust or grease.

**Heat:** Do not place the product set near heat sources (eg. radiators, stoves, electrical equipment, amplifiers).

**Water:** Do not place containers with liquids (eg. vases) or with small metallic objects on top of the product.

**Fire:** Do not place any naked flame sources (eg. lit candles, cigarettes) on the product.

**Children:** Supervise young children to ensure they do not play with the product.

## Cleaning and Maintenance

Unplug or turn off the product before cleaning it.

Cleaning: Only use a soft, dry cloth for cleaning the product; do not use a damp cloth. Never clean with industrial strength polish, wax, benzene, paint thinner, air freshener, lubricant, detergent or other chemicals. Wipe off any moisture, dirt or dust on the power plug pins with a clean, dry cloth.

## Privacy and Security

Always ensure your computer has the latest software updates which helps patch vulnerabilities in your software that could allow hackers access to your device.

Install and run security software.

Use a secure login password for your computer.

Unplug the webcam when not in use.

## Recycling and Disposal

The National Television and Computer Recycling Scheme was established in 2011 to provide Australian households and small businesses with access to free industry-funded collection and recycling services for televisions and computers, including printers, computer parts and peripherals.

Please dispose of the product responsibly by taking it to a recycling drop-off point. Planet Ark maintains a database of free television and computer drop-off points. Search for recycling near you at:  
<https://recyclingnearyou.com.au/ewastescheme/>

# Product Overview

What's in the box:

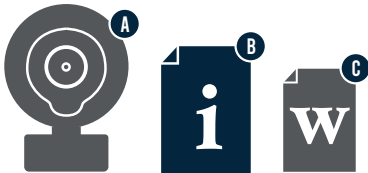

A. Webcam

B. User Guide

C. Warranty Card

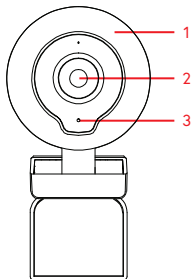

Front view

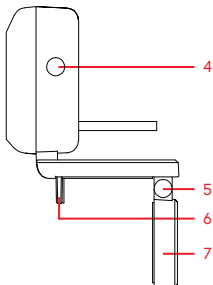

Side view

- 1. LED light
- 2. Camera lens
- 3. Microphone
- 4. Touch button

- 5. Adjustable mounting clip
- 6. Mounting clip edge
- 7. Mounting base



# Operation

## Setting up the webcam

You can place the webcam either on top of your desktop or mount on your monitor using the adjustable mounting clip.

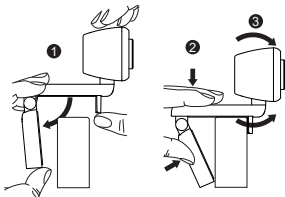

The illustrations are for reference only. Actual image of product may be different.

To mount onto your monitor, hold the webcam as pictured above and open up the mounting base. Mount the webcam, ensuring the mounting clip edge is flush with the back of your monitor. Adjust the angle of the webcam to your desired direction.

Plug in the webcam's USB cable into the USB port of your computer/laptop. The webcam will automatically start installing, it will take around 1 minute.

To ensure that the webcam has been installed successfully, on your laptop/computer go to:

For Windows: Computer Management > Device Manager > Cameras and USB camera should appear.

For Mac: Applications > Photo Booth > and USB 2.0 Camera should appear.

Your webcam is now ready to use. When using the webcam for video calling, ensure that both you and the other party:

- Have a speaker or headset.
- Microphone (the webcam has a built-in microphone).
- Internet connection.

The webcam also has a built in LED light. Press the touch button on the webcam to turn the light on/off, and press repeatedly to change the brightness.

# Troubleshooting

Problem	Solution
<b>Camera not working on some video calling apps</b>	<ul style="list-style-type: none"><li>• Some applications including Skype use a different camera by default. Go to the video settings on the app and select the correct camera as the video resource.</li><li>• Some applications require enabling from the Chrome browser. Go to Settings &gt; Search Camera &gt; Site Settings and select the applications you want to enable and change the camera permissions to "allow".</li><li>• Ensure the USB cable is connected to the USB port of your laptop/computer</li></ul>

Problem	Solution
<b>Camera is not recognized by operating system</b>	<ul style="list-style-type: none"><li>• After connecting the USB cable to the USB port of your laptop/computer, go to: Control Panel &gt; System and Security &gt; System &gt; Device Manager.</li></ul>

# Specifications

<b>Resolution</b>	2 megapixel 1932 x 1088 resolution
<b>Viewing angle</b>	75°
<b>Power supply</b>	DC 5V 160mA
<b>Weight</b>	105g
<b>Dimensions (W x D x H)</b>	56 x 28 x 145mm

# Compliance and Responsible Disposal

## Packaging

The packaging of your product has been selected from environmentally friendly materials and can usually be recycled. Please ensure these are disposed of correctly. Plastic wrapping can be a suffocation hazard for babies and young children, please ensure all packaging materials are out of reach and are safely disposed of. Please recycle these materials rather than throwing them away.

## Product

At the end of its working life, do not throw this product out with your household rubbish. An environmentally friendly method of disposal will ensure that valuable raw materials can be recycled. Electrical and electronic items contain materials and substances which, if handled or disposed of incorrectly, could potentially be hazardous to the environment and human health.

This product complies with the Australian Safety Standard AS/NZS 62368.1 to ensure the safety of the product.

# Notes



**sphere**

**Customer Helpline AU:**

1300 886 649

[info@tempo.org](mailto:info@tempo.org)

**Distributed by:**

Tempo (Aust) Pty Ltd,

PO Box 6056,

Frenchs Forest

DC 2086