

J.BURROWS

INSTRUCTION MANUAL

AIR MOUSE LASER PRESENTER
MODEL No. JBWLP16



System requirements:
Windows® 10 or later,
MacOS 10.10 or later.





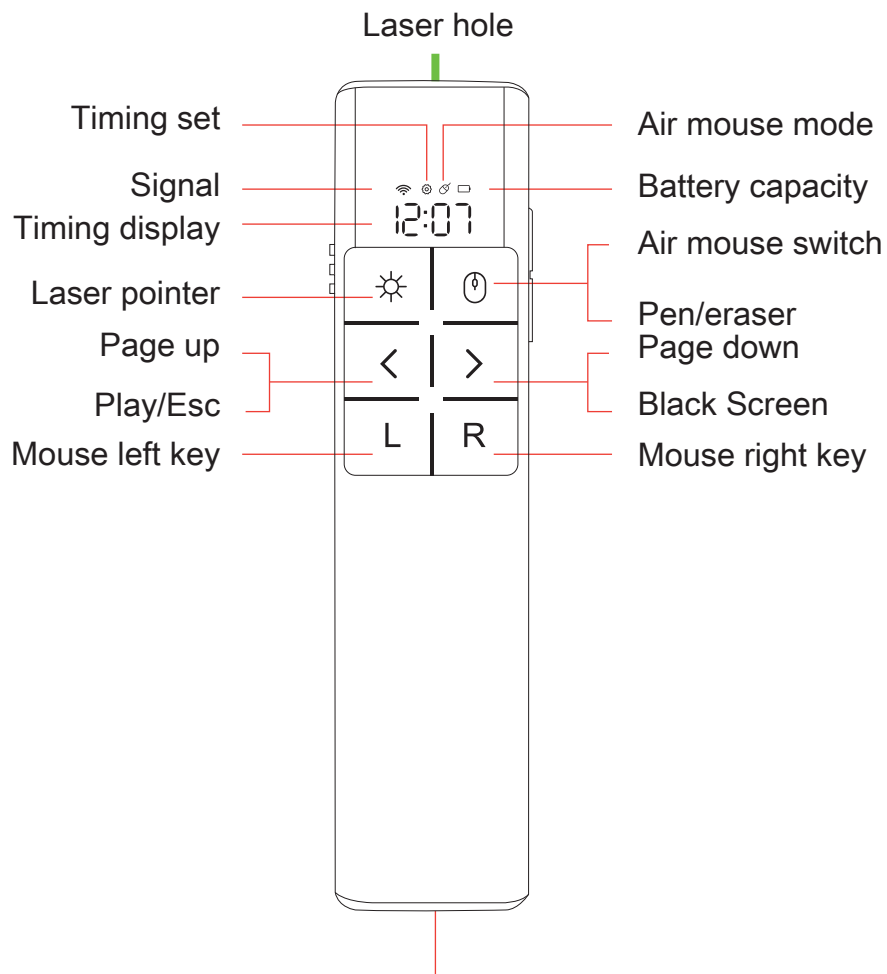



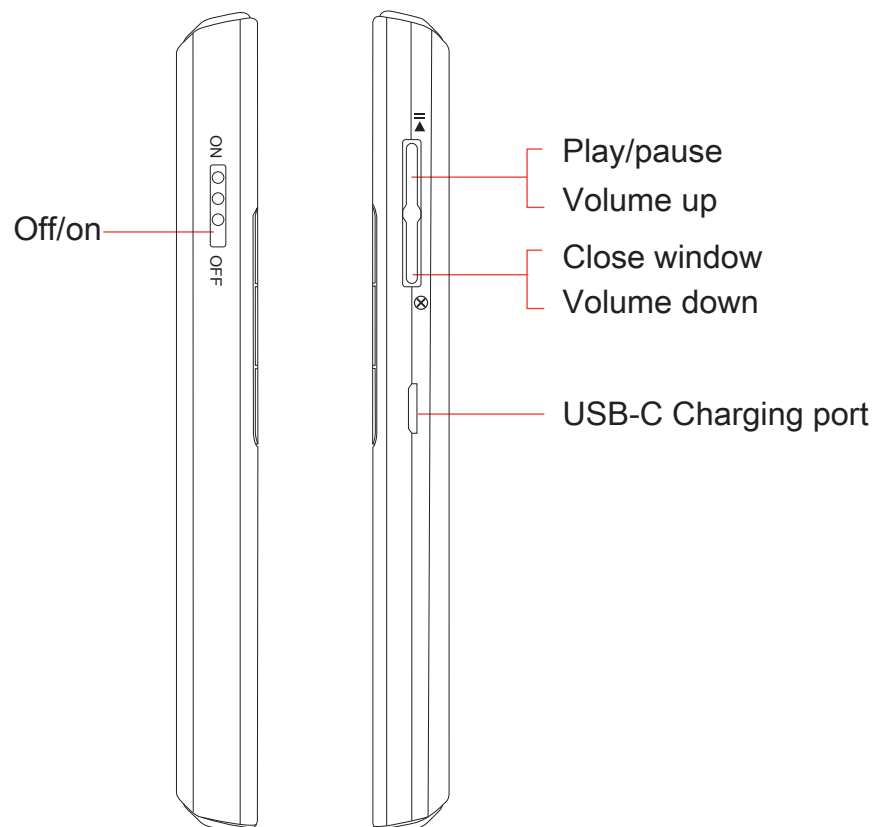

Product Functions



Stored in USB-A receiver



Operation Descriptions

Keys	Operation Descriptions
	Laser Pointer: Holding the button for laser beam.
	Single click to switch on/off Air Mouse. When LED screen displays “  ”, it is Air mouse Mode.
	Long press: Pen function. Keep pressing this button and move your hand to make marks; Release your hand to exit. (for PowerPoint full slideshow only)
	Double click to erase the marks (for PowerPoint full slideshow only)
	Single click to Page Up
	Long Press to Play/Esc (for PowerPoint only)
	Single click to Page Down
	Long press to Black Screen (for PowerPoint/Keynote full slideshow only)
	Mouse Left Key
	Mouse Right Key
	Single click to Media Player
	Long press to Volume Up
	Single click to Close Window
	Long press to Volume Down
Power Switch	Push towards “NO” to switch on; Push towards “OFF” to switch off.
Charging Port	Support USB-C charging

Note: In Mac system Keynote software, only support Page Up, Page Down, Black Screen, volume control and air mouse functions.

How to Use Timer

1. **Enter Timer settings interface:** Press 【 L 】 and 【 R 】 simultaneously for 2 seconds, LED screen displays 【 ⚙️ 】 then to set.

Note: If no operation is performed within 15 seconds, the timer settings will automatically quit.

2. **Timer Setting (Up to 9 hours):**

- ① Press 【 < 】 once to decrease 1 minute, hold to keep decreasing time; Press 【 > 】 once to increase 1 minute, hold to keep increasing time.
 - ② Then press 【 R 】 once to save settings and start timer, and then LED displays the countdown; Press 【 L 】 once, it will quit settings.
3. **Vibration reminder:** Vibration reminder should be notified at half time, with 5 minutes and 0 minutes remaining.
 4. **Quit:** Though start timer but users want to cancel, first press 【 L 】 and 【 R 】 simultaneously for 2 seconds to timer settings interface again, then press 【 > 】 to quit.

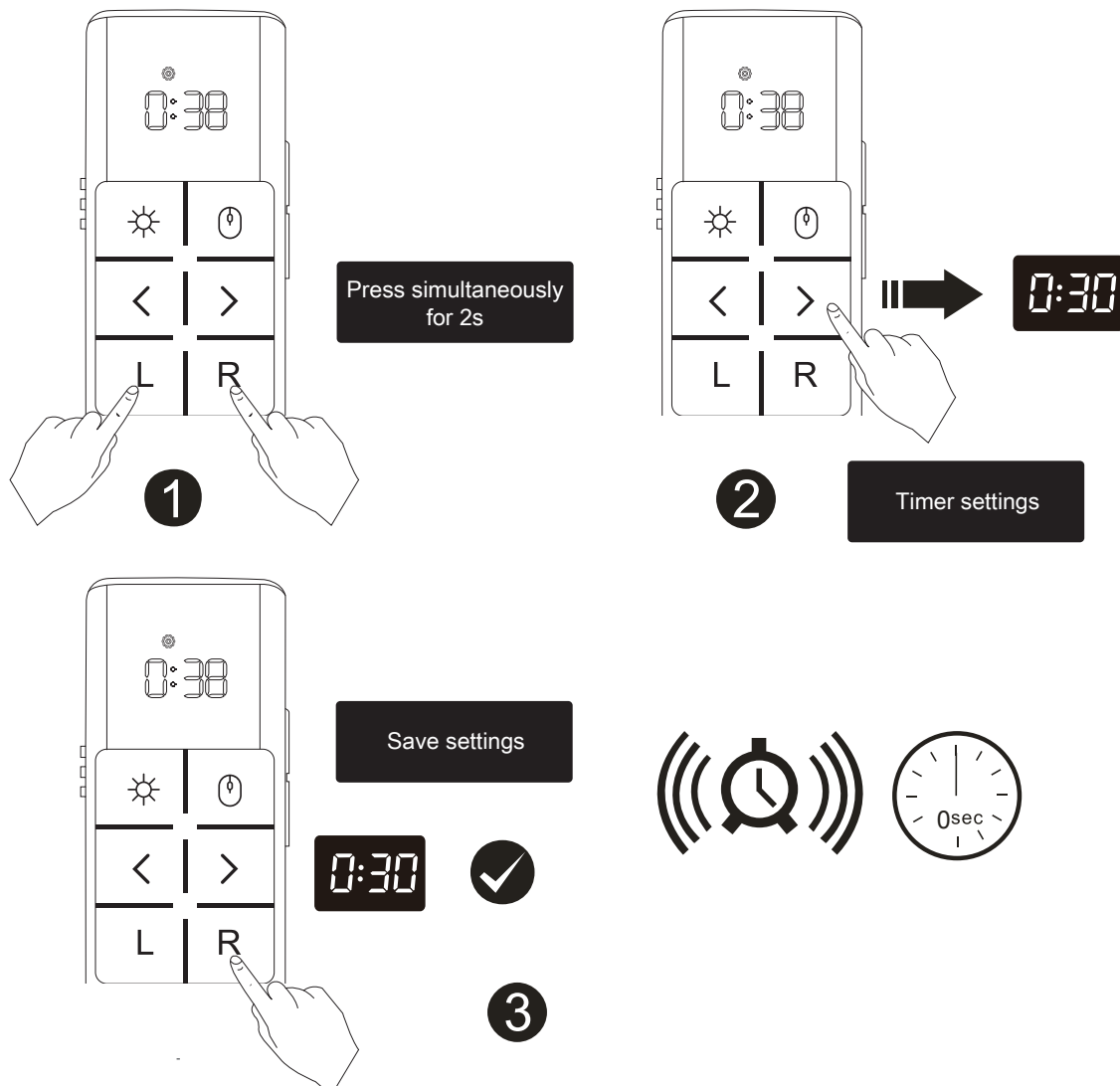

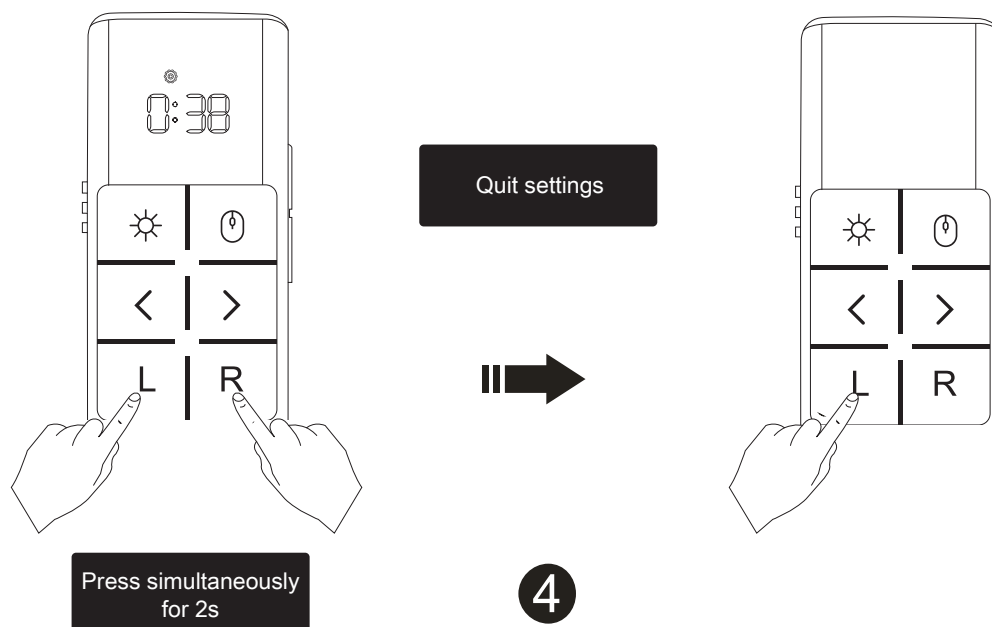

Operating Hints

1. Pull the Mini USB receiver out of presenter, and plug in USB Port that available on computer and power on then it works.
2. Upon the first installation on Mac, Keyboard Set Assistant may appear and prompt that the keyboard cannot be identified. Just click "Continue" to finish the installation, and then the presenter will work accordingly.
3. The receiving distance of USB-A receiver will be decreased by disturb of electronic devices around.
4. In PowerPoint full slideshow, when first use pen, there is only red dot but no marks, please try again.
5. If mouse cursor drift occurs, please recalibrate: Keep the product on the table horizontally, and then keep pressing 【 ⚙️ 】 and 【 R 】 till 【 📶 】 and 【 🖊️ 】 light on, which mean calibration is successful.
6. The product has 3 mouse speeds:
 - ① Fast speed: Keep pressing 【 ⚙️ 】 and 【 ⏏️ 】 till 【 📶 】 and 【 🖊️ 】 light on;
 - ② Normal speed: Keep pressing 【 ⚙️ 】 and 【 < 】 till 【 📶 】 and 【 🖊️ 】 light on;
 - ③ Slow speed: Keep pressing 【 ⚙️ 】 and 【 > 】 till 【 📶 】 and 【 🖊️ 】 light on.

Product Specifications

Model No.: JBWLP16
RF Frequency: RF 2.4GHz
Control Distance: 30M
Laser Distance: > 200M
Laser Power: <1mW
Wavelength: Green 500-530nm
Battery: 400mAh Lithium Battery
Working Voltage: 3.6V-4.2V
Charging Port: USB-C
Charging Voltage: 5V
Dimension: 128.1 x 31.4 x 13.8mm

Package Contents

Wireless presenter
USB-A receiver (stored inside the wireless presenter)
USB-A to USB-C charging cable (50cm)
Carry pouch
Instruction manual

Charging instructions

The product is built-in lithium battery, and can be charged by USB. Suggested charging time is 3-4 hours. When charging, battery icon blinks; when full charged, it stops blinking and goes off.

Note: Press the button, the battery icon  blinks, it means low battery, please charge in time.

Notes on the laser

The product is equipped with a class 2 laser.

LED light:

- Do not look directly at the LED light!
- Do not look into the beam directly or with optical instruments!

When operating the laser equipment, always make sure that the laser beam is directed so that no person is in the projection area and that unintentional reflected beams (e.g. from reflective objects) cannot be directed to areas where people are present.

Laser radiation can be dangerous if the laser beam or its reflection enters unprotected eyes. Before using the product, familiarise yourself with the statutory regulations and instructions for operating this type of laser device.

Never look into the laser beam and never point it at people or animals. Laser radiation can seriously damage your eyes.

If laser radiation enters your eyes, close your eyes immediately and move your head away from the beam.

Do not point the laser beam at mirrors or other reflective surfaces.

The uncontrolled, reflected beam may strike people or animals. If your eyes have been irritated by laser radiation, do not continue to carry out tasks with safety implications, such as working with machines, working from great heights or close to high voltage.

Also, do not operate any vehicles until the irritation has completely subsided.

Never open the device. Setting or maintenance tasks must only be executed by a trained specialist familiar with potential hazards.

Improperly executed adjustments might result in dangerous laser radiation.



Caution: if operation settings or procedures other than those described in these instructions are used, it could lead to exposure to dangerous radiation.

Windows® is a trademark of the Microsoft Corporation in the United States and other countries.

MacOS are trademarks of Apple Inc., registered in the U.S. and other countries.

USB Type-C® and USB-C® are registered trademarks of USB Implementers Forum.

OFFICEWORKS LTD

MADE IN CHINA