

J.BURROWS

INSTRUCTION MANUAL
Electric Pencil Sharpener
Model: JB8028BLK



Please read the following instructions carefully before using, and keep it for future use.

MADE IN CHINA
OFFICEWORKS LTD
238-262 EAST BOUNDARY RD
EAST BENTLEIGH VIC 3165 AUSTRALIA



Feature

- This sharpener can be used to sharpen 6.5-12mm lead/colour pencils.
- Fast speed. Auto-stop at the perfect point.
- Powered via: rechargeable batteries and USB cable.
- Portable and easy to use.
- Android charging port, which is more convenient.
- Large, easy to clean and well-sealed shavings receptacle.
- Auto smoothing function.
- Automatic ejection of broken lead.
- Take around 3 hours with USB cable to full charged.

Specification

- Description: Electric Pencil Sharpener
- Model No.: JB8028BLK
- Lithium Battery: 18650 Battery, 2000mAh 3.7V
- Rated Input: DC5V, 2A
- To be used with pencils of diameter 6.5-12mm
- Dimension: 90*90*176mm
- Weight: 526g

Part name

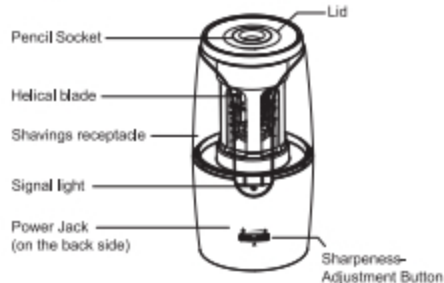

Attention



- Do not use an adaptor with output voltage more than 5V.

- It is available to be recharged by USB, or connect the mobile AC adaptor to recharge the battery, but the adaptor with the output above 5V is not allowed.
- This sharpener can be used to sharpen 6.5-12mm lead/colour pencils.
- This product is not suitable for sharpening wax pencils, chalks, crayons, soft charcoal pencil and eyebrow pencil.
- This product can not apply to over 10B sketching pencils, otherwise, the lead will be broken easily.

- Do not use alcohol or other irritating liquids to clean the machine.
- When cleaning up the waste, disconnect the power source.
- For optimum sharpening, exert 6N-10N force on the pencil.
- Children should use the sharpener under the supervision of an adult.

Operation

- Connect the sharpener to the power plug, use USB or plug the USB port into the AC adaptor to recharge the lithium battery. Blue signal lights are slowly flashing, charging is normal. Please unplug the power cord when the light becomes fixed blue, which means the charging is completed.
- When the battery is exhausted, the indicator light flashes, please charge the machine. It's available to work during charging.
- Insert the pencil and press lightly to start sharpening. Keep holding the pencil.



How to adjust the point size and lead core length

- The thickness of the lead can be adjusted with the adjustment knob.

The Switch button has 3 Grade:
Grade 1: 0.8mm
Grade 2: 0.75mm±0.15mm
Grade 3: 1.0mm±0.15mm

Solution of obstruction

- When the lead breaks and sticks the blade, please plug the pencil again and press with approximate 20N force to remove the lead core.
- When the blade jams due to improper use of chalk or crayon.
 - ① Open the lid and pull out the shavings receptacle.
 - ② Use steel wire or other similar tools to take out the block.
 - ③ Install the shavings receptacle and lid, then it can work.

Cleaning the shaving receptacle

- For your safety, unplug the power plug when cleaning the shavings.
- Grab the top, turn counterclockwise, and pull it up.
- Way 1. When the lid is open, pour the shavings, and clean

the receptacle.

- Way 2. When the lid is opened, pour the shavings, pull out and clean the receptacle and blade, clean the receptacle and blade, then install it back.



How to replace the blade

1. Twist the lid (pic ①) and take out the shaving receptacle (pic ②).



3. Take out the blade (including plastic carrier), and replace them.



4. After installing the blade, put the blade cover down and rotate it, left to tighten. When installing the blade cover, please notice that aim the buckle at the arrow position (pic ③) as shown below.

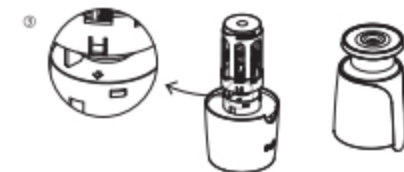

5. Install the shavings receptacle (pic ①), and then install the lid (pic ②).



Product Warranty— valid for Australian customers only

Officeworks Ltd warrants that this product will be free from defects and work as intended for 3 years from the date of purchase by the original customer.

If the product has any defects or does not work as intended during the Warranty Period, Officeworks will, at its election and at its expense, repair or replace the product.

This warranty does not apply:

- To cosmetic damage;
- To damage caused by consumables used in connection with the product (such as batteries);
- Where the product has not been used in accordance with all provided instructions;
- To damage arising from fair wear and tear;
- Where the product has not been subject to reasonable use;
- Where the product has been intentionally or negligently damaged; and/or if the customer has attempted to repair the product.
- To make a claim under this warranty, please return your product with your receipt or proof of purchase to your nearest Officeworks store or contact 1300 633 423.

This warranty is provided in addition to any rights you may be entitled to under the Competition & Consumer Act 2010.

Our goods come with guarantees that cannot be excluded under the Australian Consumer Law. You are entitled to a replacement or refund for a major failure and compensation for any other reasonably foreseeable loss or damage.

You are also entitled to have the goods repaired or replaced if the goods fail to be of acceptable quality and the failure does not amount to a major failure.