



GD 1600H

Caution: This instructions book is written for universal use and subject to specification variance of actual parts.

COMPONENT

①	②	③	④	⑤	⑥	⑦	⑧
X22	X12	X2	X14	X4	X4	X1	X1
P1	P2	P3	P4	P5	P6	P7	P8
X2	X1	X2	X2	X2	X1	X1	X1
P9	P10	P11	P12	P13	P14	P15	P16
X1	(Mousepad) X1	X2	X2	X2	X2	X1	X1
P17	P18	P19	P20	P21	P22	P23	P24
X1	X1	X1	X1	X1	X1	X1	X1

1

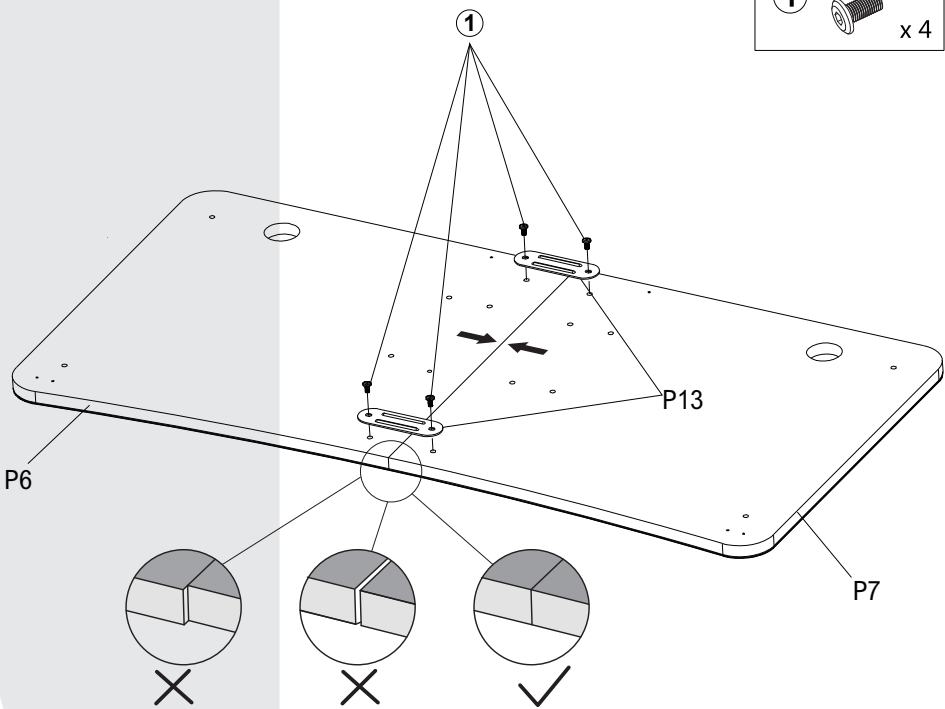

! Before tightening the screws, you must ensure that the two desktop pieces are aligned and flush against each other.

2

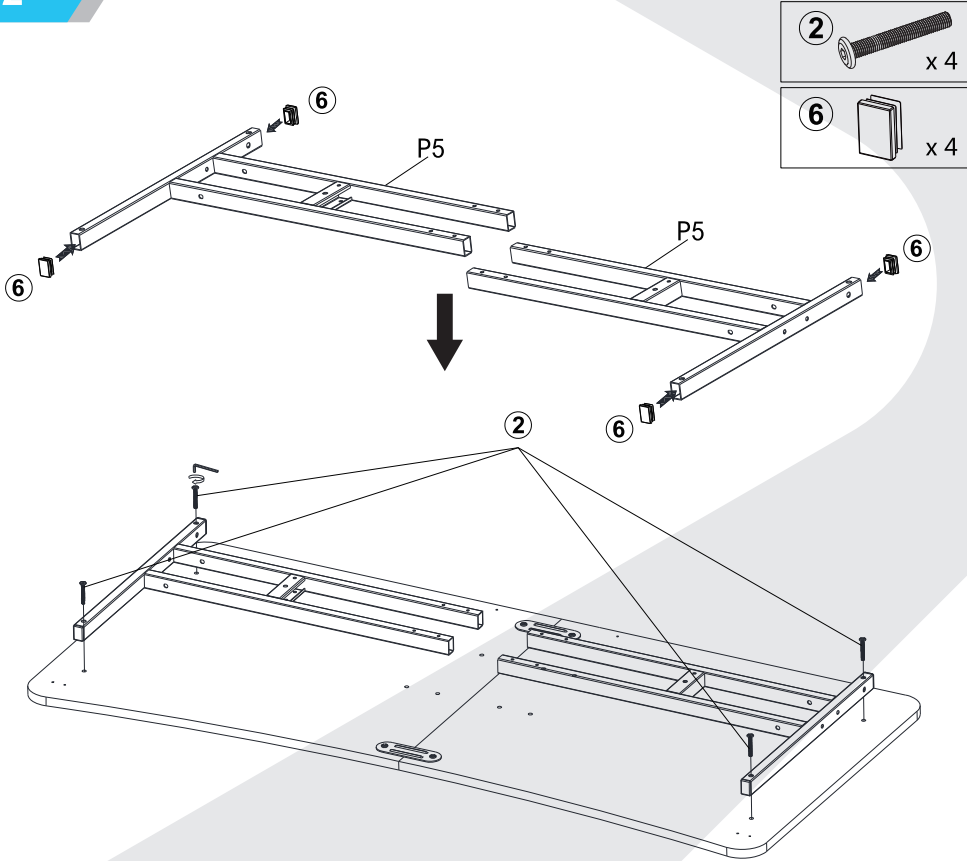

3

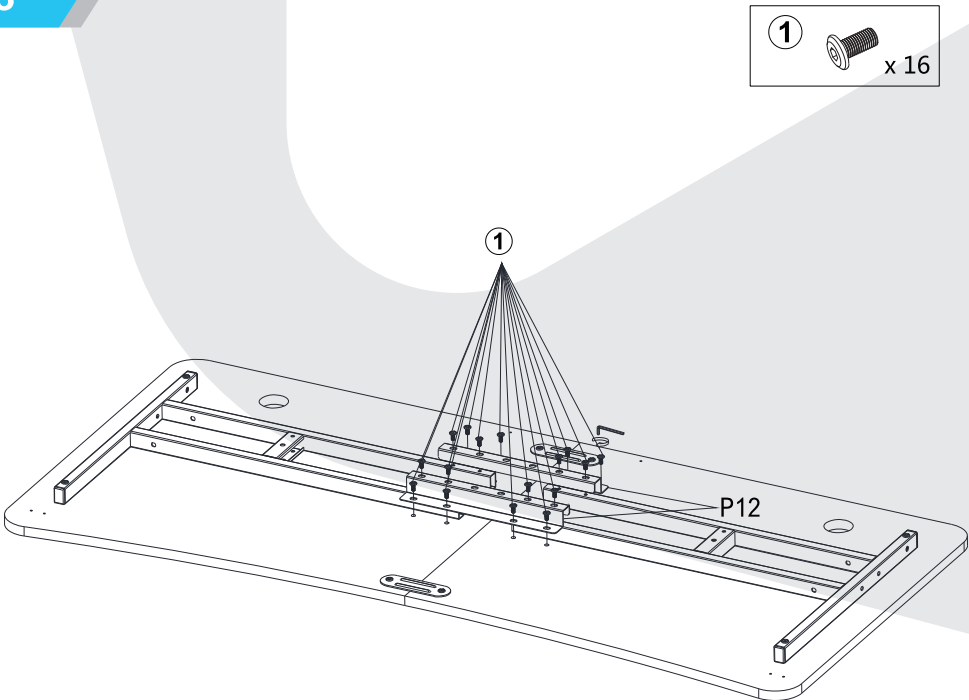

4

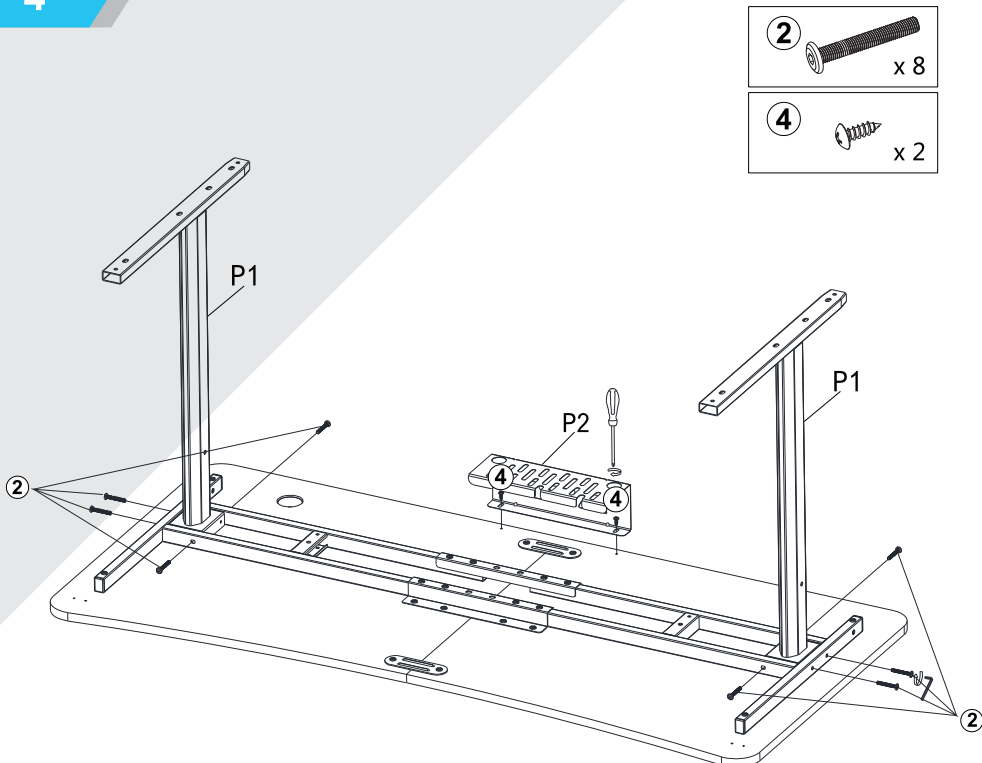

5

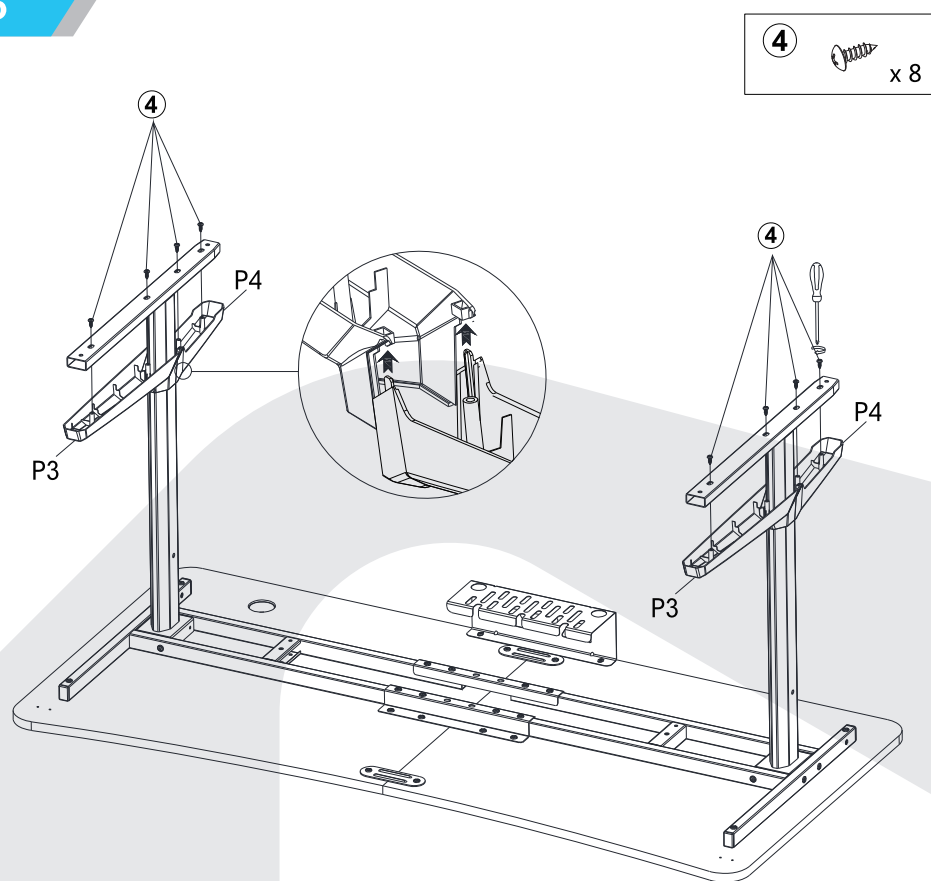

6

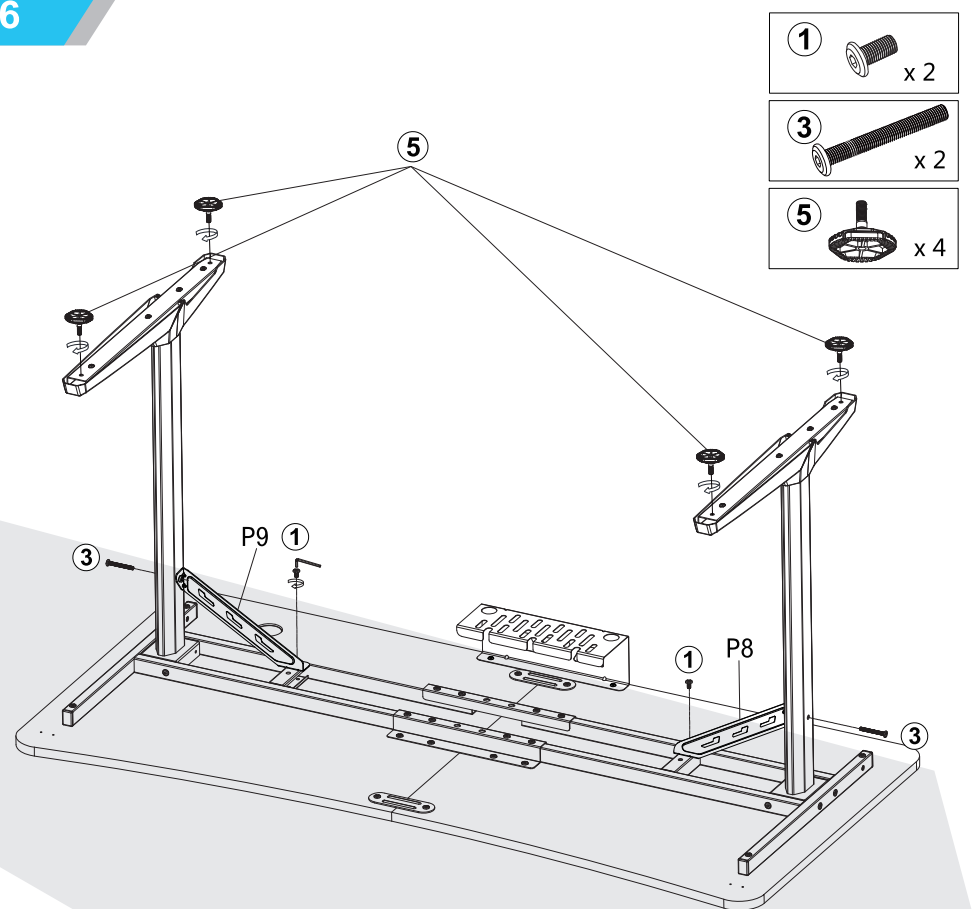

7

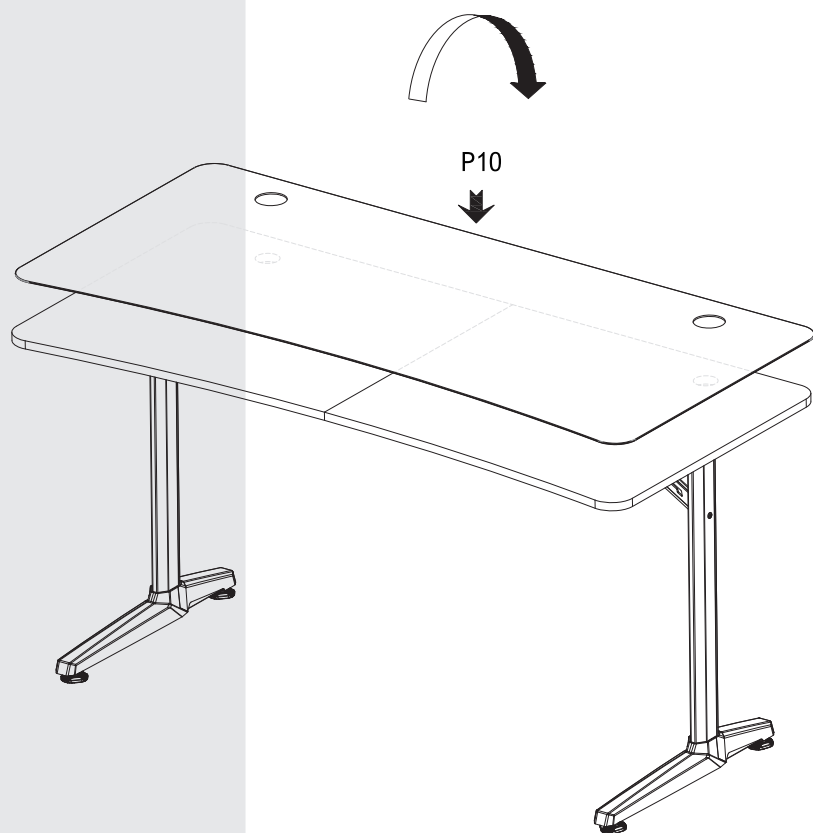

8

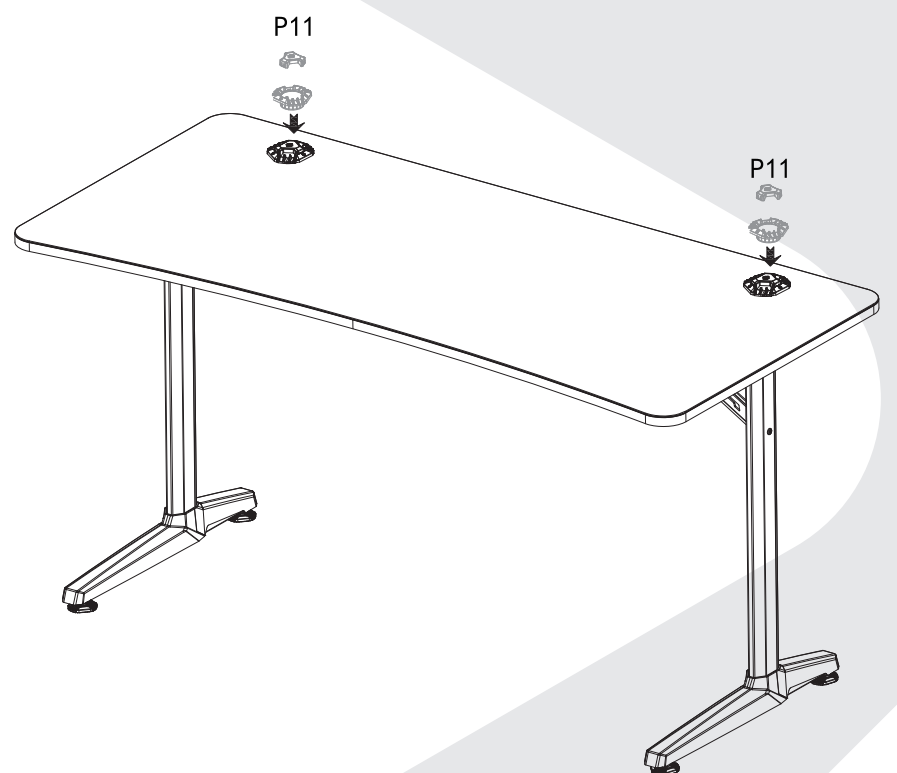

9

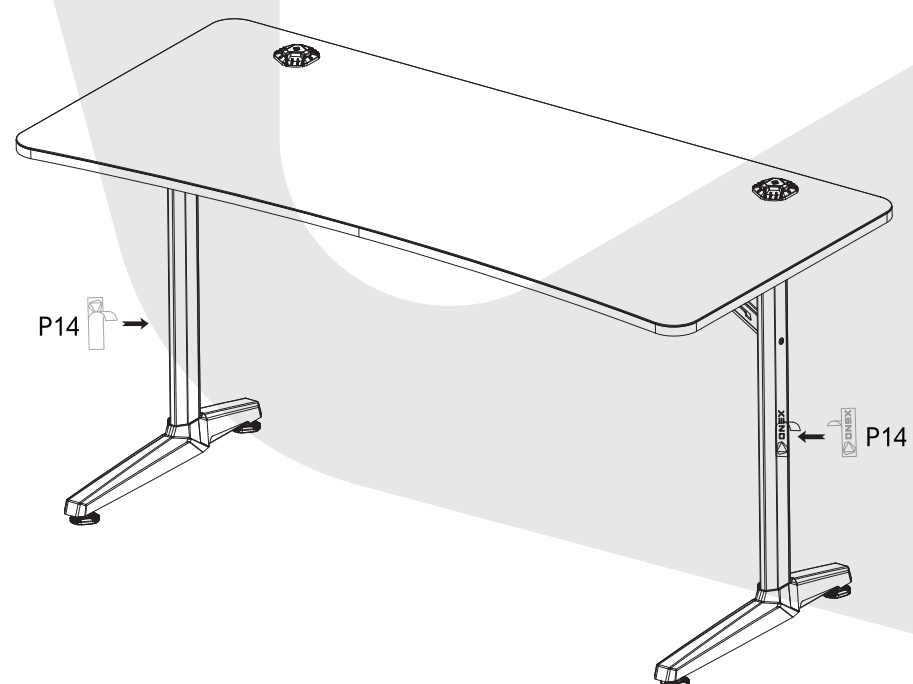

ACCESSORY

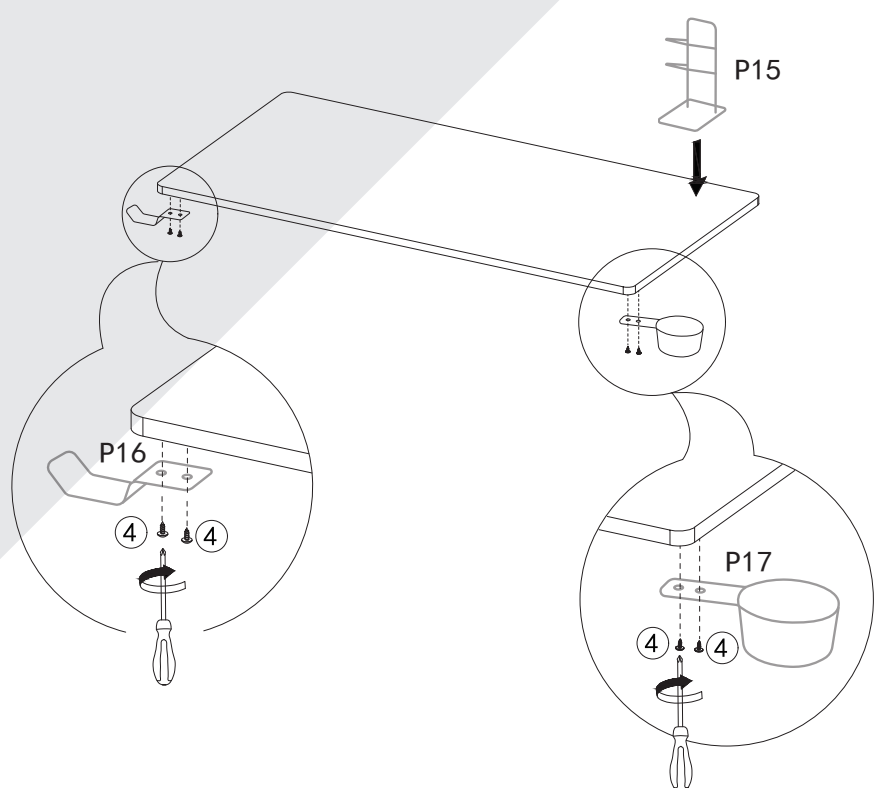

1. Peel off the white sticker label.
2. Placing the transparent logo sticker on the iron leg and press down hard.
3. then remove the transparent sticker, the logo will remain on the surface.