

MOBILE TROLLEY

TOOLS REQUIRED

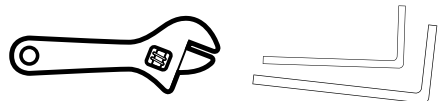

SCREW PACK:

Bolt x 12	
M6 Cap Nuts x 10	

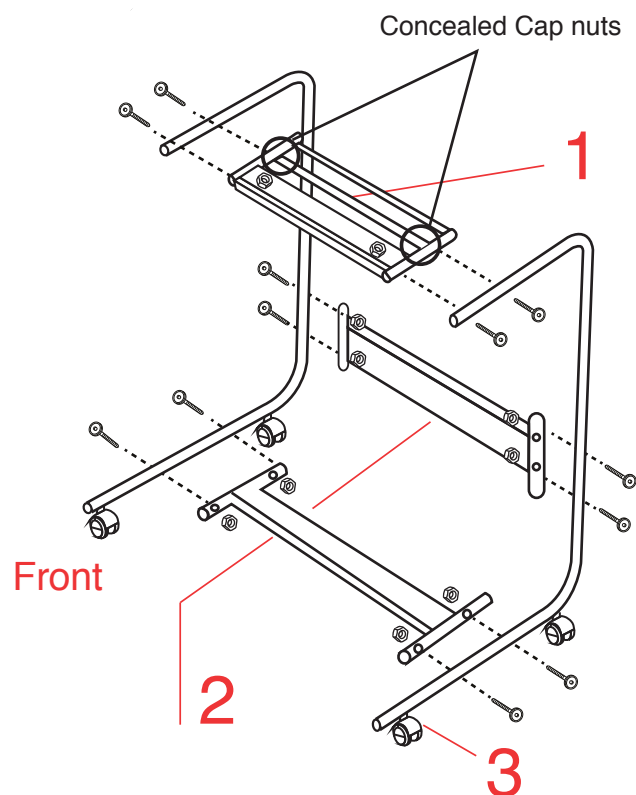

ASSEMBLY:

FOR EASY ASSEMBLY, FIRSTLY FIX ALL SCREWS AND NUTS FINGER TIGHT THEN TIGHTEN WITH TOOLS.

STEP 1

TOP MODULE
Insert 4 bolts through the outside of the tube frame and top module. Tighten the screws by fastening the bolts to the inside of the tube frame.

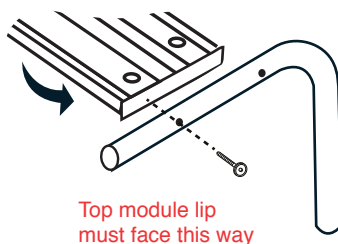

Top module lip
must face this way

STEP 2

BACK PANEL & BASE PANEL
Insert 4 bolts through the outside of the tube frame and back panel. Tighten the screws by fastening the bolts to the inside of the tube frame.

Repeat this step for the base panel.

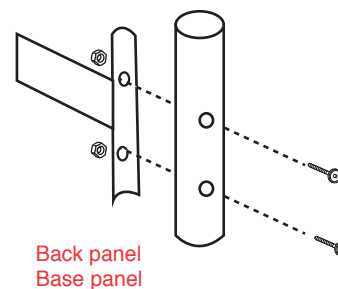

Back panel
Base panel

STEP 3

CASTORS
Screw Castors into the nuts set into the bottom of the tube frame.

Make sure locking castors are screwed in at the front of the mobile.