



ROBOTIKA

Pet *Grooming Kit*

VACBOT Series 8



INSTRUCTION MANUAL

Please read this manual carefully before using, and keep it for future reference.

CONTENTS

Safety Instructions	4
Product Overview	6
Items In The Box	6
Product Anatomy	6
Installation	8
Important Tips Before Use	8
1) Remove the vacuuming module	8
2) Connection and removal of the hose assembly	9
3) Connect the hose and the accessories	9
4) Install and remove the combs	9
Operation	10
Vacuuming Module	10
Pet Clipper	10
Versatile Handle	11
Cleaning Brush / Maintenance	13
Maintenance	14
Specifications	16
Customer Helpline	Last Page

SAFETY INSTRUCTIONS

- **Before using the product, please follow these basic safety precautions:**

Read all the contents of the manual carefully and follow the steps indicated in the manual to use the product.

- Any operation inconsistent with the instructions in the instruction manual may cause serious personal injury or damage to the product itself.
- Due to any accidents and losses caused by improper operation, our company is not responsible and will not bear any legal liability.
- The right to interpret and amend this statement belongs to our company.

IMPORTANT SAFETY INSTRUCTIONS

Use Restrictions

- This product is intended for use with pets only and should not be used for commercial or industrial purposes, nor should it be used outdoors or in damp locations.
- This device is intended for use with cats and dogs over 6 months old.
- This product should not be used by individuals with physical, sensory, mental, or intellectual disabilities, or by those without relevant experience and knowledge (including children), unless they are supervised or instructed by a guardian to ensure safe use of the product.
- The product may contain small parts and accessories; please keep the product and its accessories out of reach of children to prevent them from inadvertently disassembling or damaging the product or accessories, or from swallowing small parts leading to choking or other hazards.
- Do not let children treat the product as a toy, and do not use the product in the room where infants and toddlers sleep.
- Children should be prohibited from playing with the product's packaging bags to prevent the risk of suffocation.
- Exercise caution when using the product near children and pets, and ensure that children and pets do not play with the product.
- Do not insert objects into the opening parts or block them during use.
- Do not use or store the product outdoors, in bathrooms, or in any damp places, or places that are wet with water.
- Do not disassemble the product. Incorrect assembly may damage the parts. Contact the company for repairs when necessary.
- When using the product with a vacuum module, do not vacuum items that are on fire, smoking, or hot, such as cigarettes, matches, or hot ashes.
- When using the product with a vacuum module, do not vacuum flammable or combustible liquids like gasoline, and do not use in or near environments with flammable or combustible gases.
- When using the product with a vacuum module, be careful to prevent pets from chewing on electrical cords to avoid electric shock. Use the product correctly.
- Thinning combs and electric clippers have sharp edges due to their functionality. Please be cautious of the sharp angles and edges when using these tools.
- Before using, acclimate your pet to the sound and appearance of the device to prevent fright during use.

SAFETY INSTRUCTIONS (CONT.)

- Before actual use, conduct short adaptive training sessions to familiarize your pet with the device's sound and operation process, thereby reducing their anxiety and resistance.
- Learn how to quickly shut off the device and stop using it immediately if the pet or user feels discomfort.
- If the pet is injured, stop using the device immediately and seek veterinary assistance.

- **BATTERY AND CHARGING**

Do not use any third-party batteries; this product should only be used with the battery supplied with the unit, otherwise, it may cause damage to the product, electric shock, or fire due to high voltage.

- It is forbidden to disassemble, repair or modify the battery without permission.
- If the product will not be used for an extended period, please turn off after it is fully charged and store it in a cool and dry place. Charge it at least once every three months to avoid over discharge of the battery.
- In case of battery leakage, be careful not to let the liquid stick to the skin or clothes. Wipe it immediately with dry cloth and send it to the recycle bin or designated maintenance point. Do not discard it indiscriminately.
- The battery must be removed when scrapping this product. Please dispose of the old batteries properly, and do not discard the waste battery indiscriminately. Batteries contain harmful substances that are harmful to the environment. Please put them into the specified recycle bins according to the local environmental protection regulations.

PRODUCT OVERVIEW

ITEMS IN THE BOX



Pet Clipper (x1)

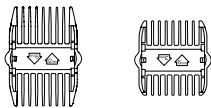

Hair Clipper Guards (x2)

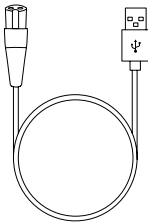

Charging Cable (x1)

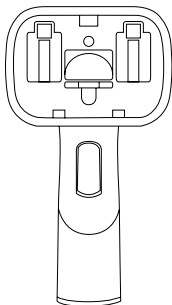

Versatile Handle (x1)

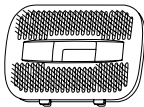

Pet Slicker Brush (x1)

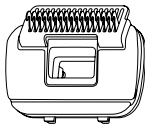

Detangling Comb (x1)

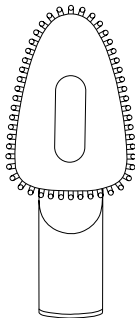

Cleaning Brush (x1)

PRODUCT OVERVIEW (CONT.)

PRODUCT ANATOMY

1) Pet Clipper

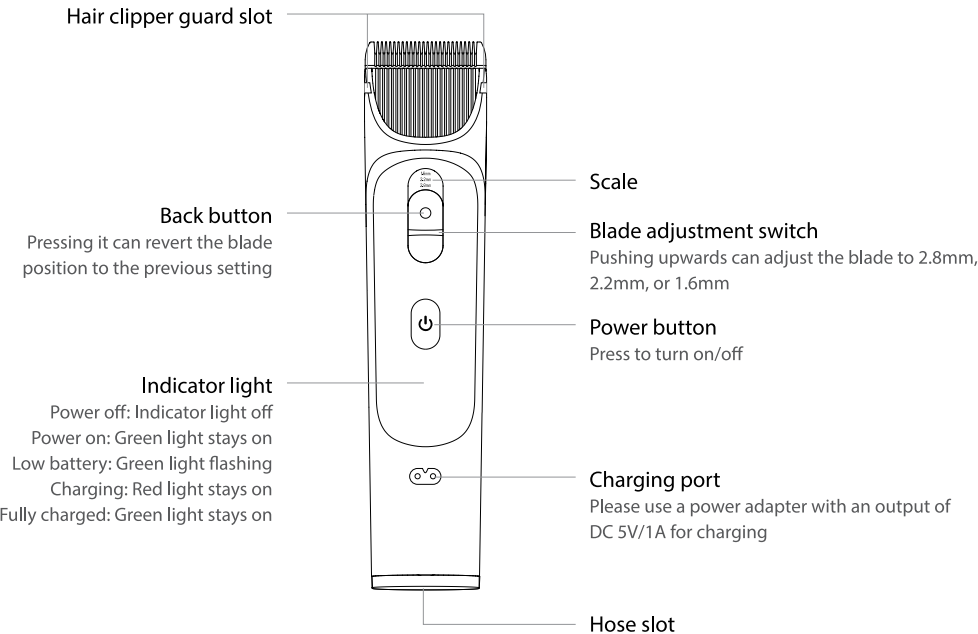

2) Versatile Handle

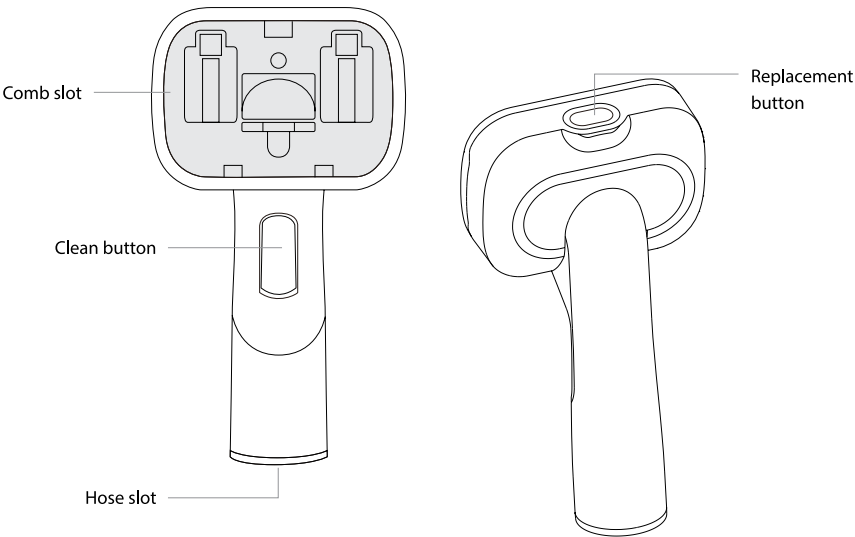

PRODUCT OVERVIEW (CONT.)

3) Cleaning Brush

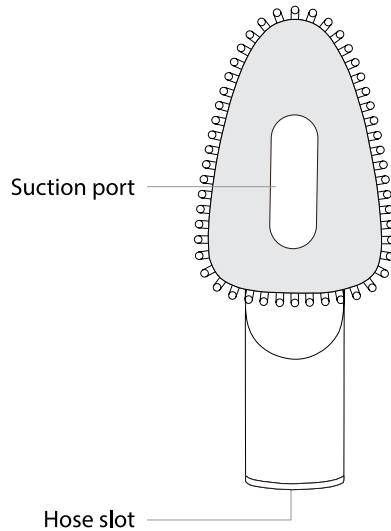

INSTALLATION

IMPORTANT TIPS BEFORE USE

1) Remove the vacuuming module

Remove the vacuuming module from the charging base using its handle.

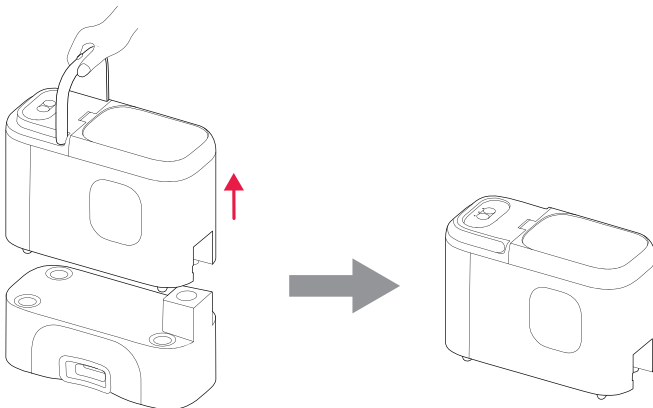

INSTALLATION (CONT.)

IMPORTANT TIPS BEFORE USE

2) Connection and removal of the hose assembly

Press the button on the hose assembly connector to connect it to the detachable vacuuming module. When the vacuuming task is finished or there is a need for auto-empty dirt, disconnect the hose assembly connector by pressing the button on it, and store the hose properly for future use.

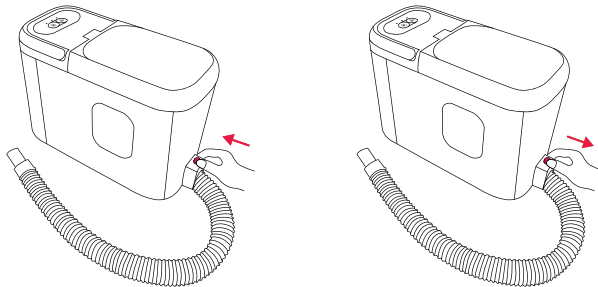

3) Connect the hose and the accessories (the following example uses a cleaning brush)

Connect the hose and cleaning brush as indicated in the diagram below.
To replace the part, simply pull it out.

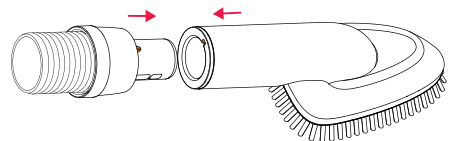

4) Install and remove the combs

Follow the instructions in the diagram below to install.
If you want to replace with another comb, press the replacement button on the top of the handle to remove the current comb and replace it with a new one.

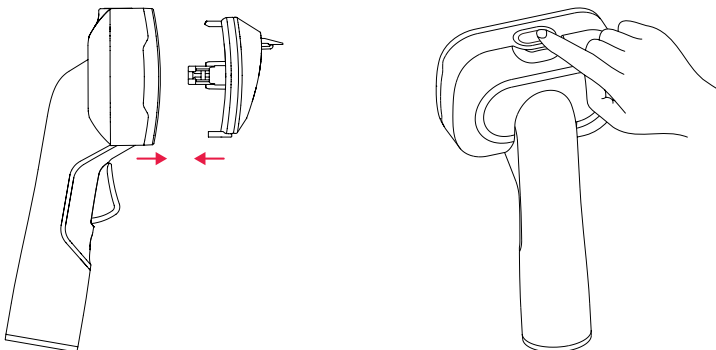

OPERATION

VACUUMING MODULE

1) Turn on

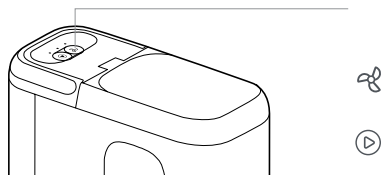

2) 3 levels switchable

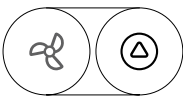

1 levels

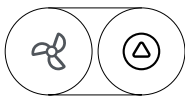

2 levels

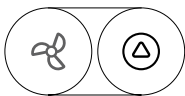

3 levels

PET CLIPPER

Function: The pet clipper can shave off and vacuum pet hair, suitable for daily pet hair grooming.

Note: Be careful with the soft parts of your pet's skin, do not apply excessive force to avoid causing skin cuts.

1) Hair Clipper Guards

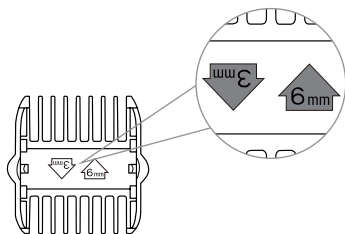
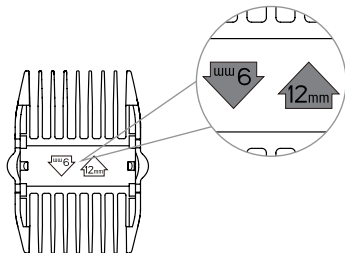

OPERATION (CONT.)

* Select hair clipper guards according to your hairstyle needs, which can leave hair lengths of 3mm, 6mm, 9mm, and 12mm.

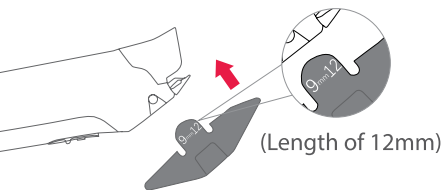

* Align with the slot and push in

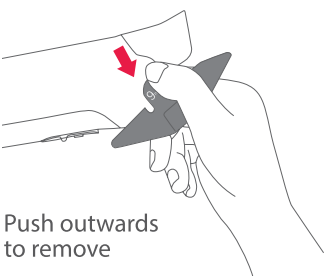

* Push outwards to remove

2) Start Trimming

Before shaving your pet, start the vacuum module first. It is recommended to start with the first suction setting, then adjust the gear according to the actual situation.

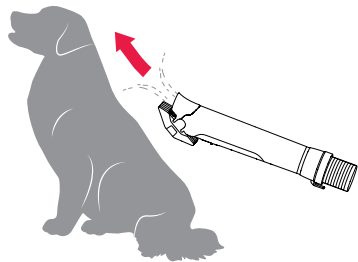

*Beginners are advised to use it with hair clipper guards. Be cautious as the blade is sharp.

VERSATILE HANDLE

1) Pet Slicker Brush

Function: Easily removes loose hair, shedding mats, tangled hair, dander, and dirt from your lovely pets.

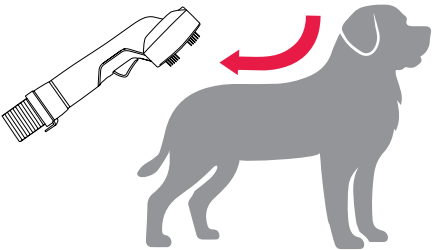

*Connect the hose and pet slicker brush, start the vacuuming module, you can comb in the direction of the pet's hair.

OPERATION (CONT.)

VERSATILE HANDLE

2) Detangling Comb

Function: Gently eliminates tangles, knots, dander, and trapped dirt.

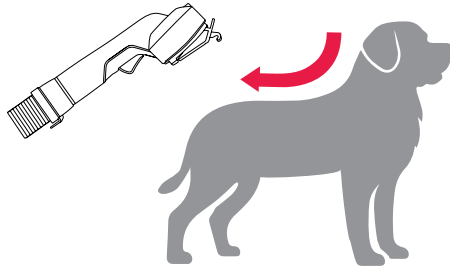

*Connect the hose and detangling comb, start the vacuuming module, you can comb through your pet's tangled hair.

3) Grooming Comb

Function: It can effectively remove loose hair and thin out hair.

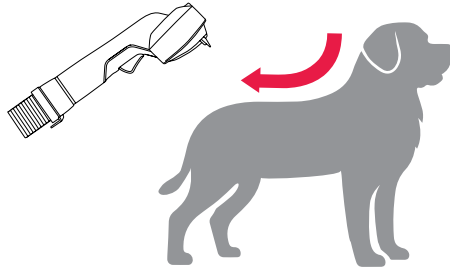

*Connect the hose and grooming comb, start the vacuuming module, you can comb in the direction of the pet's hair.

4) Vacuum Pet's Hair

Press the suction button on the versatile handle to vacuum the hair.
You can also repeatedly press the clean button until the hair is completely sucked in.

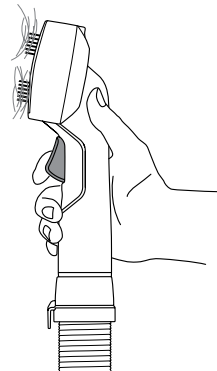

OPERATION (CONT.)

CLEANING BRUSH

Function: Clean pet hair from clothes or hair from places like sofas. Attach the cleaning brush to the hose, start the vacuuming module for cleaning, the Level 3 of suction is recommended, it can bring you better cleaning results.

Note: For areas like sofa crevices, please use the nozzle accessories for cleaning to achieve better cleaning results.

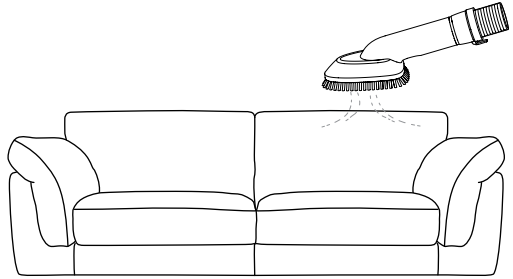

MAINTENANCE

CLEAN THE VACUUMING MODULE

After completing grooming, thinning, and detangling for pet's hair, it is recommended to check whether the dust bag is filled with hair and to replace the dust bag regularly.

CLEAN THE PET CLIPPER

1) Push outward to remove the blade.

Note: Before removing the blade, please make sure the clipper is turned off to avoid cutting your fingers.

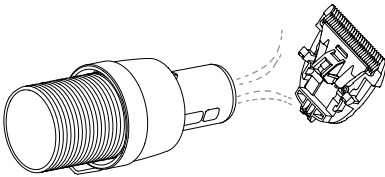
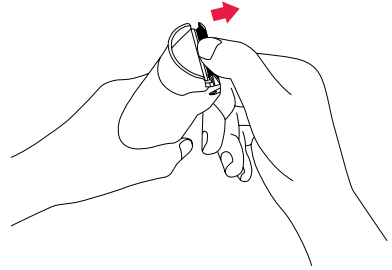

2) Suction the debris from the blade and clipper.

3) Align the bottom of the blade with the slot and press inside to install the blade.

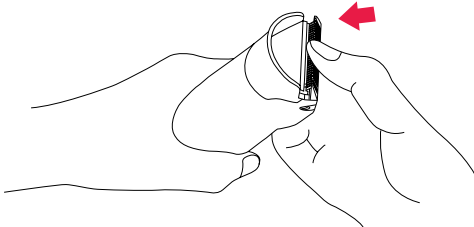

SPECIFICATIONS

Voltage	DC 5V 1A
Power	5W
Charge time	4 hrs
Usage time	3.5 hrs



ROBOTIKA

CUSTOMER SUPPORT: info@ayonz.com

DISTRIBUTED BY: Ayonz Pty Ltd