



Assembly Instructions
Velocity Hutch
900 Wide
2 CARTONS



MANUFACTURER CODE: VOH9
OW CODES: CPVELH5WH, CPVELH90BW,
CPVELH5GR, CPVELH90WI

manufactured by designtec
www.designtec.com.au

10
YEAR
WARRANTY

NOTE

Please check you have all hardware before assembling.

If you are missing any hardware, please contact the store of purchase.

Please ensure you have the name of the item, required hardware part and quantity.

Please retain your receipt as proof of purchase to validate your warranty.

CAUTION

Do not tighten screws before all screws are in the right place.

Do not use this product unless all bolts, screw and knobs are firmly secured.

Check that all bolt, screws and knobs are securely tightened at least every 4 months.

WARNING

If parts are missing, broken, damaged or worn stop using the product until all repairs are made using manufacturer authorised parts.

Failure to follow these warnings could result in serious injury.

TOOLS REQUIRED FOR ASSEMBLY

1 x Philips Head Screwdriver

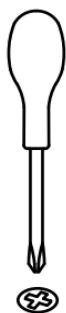

HARDWARE INCLUDED

Note - Individual hardware images are not to scale.

A - ARRET



x 4

B - PIN



x 12

C - 32mm SCREW



x 4

D - SHELF SUPPORT



x 8

PRE-INSERTED HARDWARE

CAM HOUSING

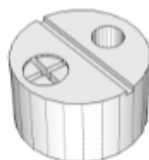

STEP 1

Fix eight (8) PINS (B) into the outer pre-drilled holes on your back panel with your screwdriver.

NOTE: these pre-drilled holes are slightly offset to the edge.

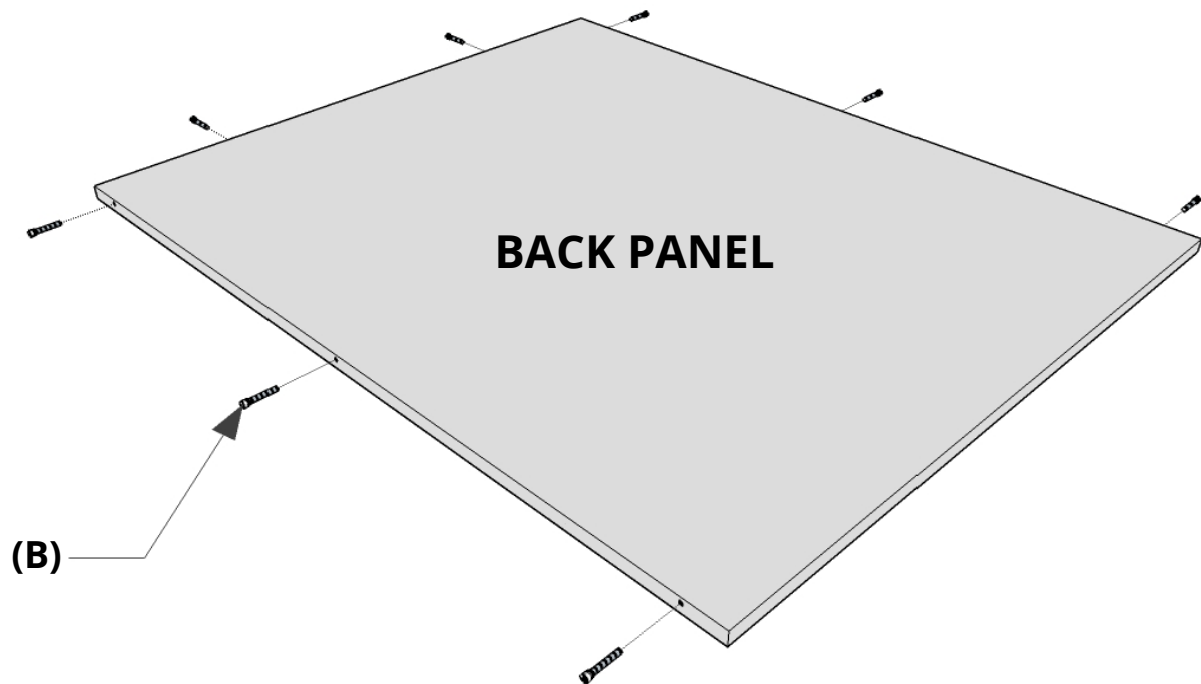

STEP 2

Fix four (4) PINS (B) into the outer pre-drilled holes at the tops of your end panels as shown

Knock in your ARRERTS (A) into the pre-drilled holes on the inside of your end panels.

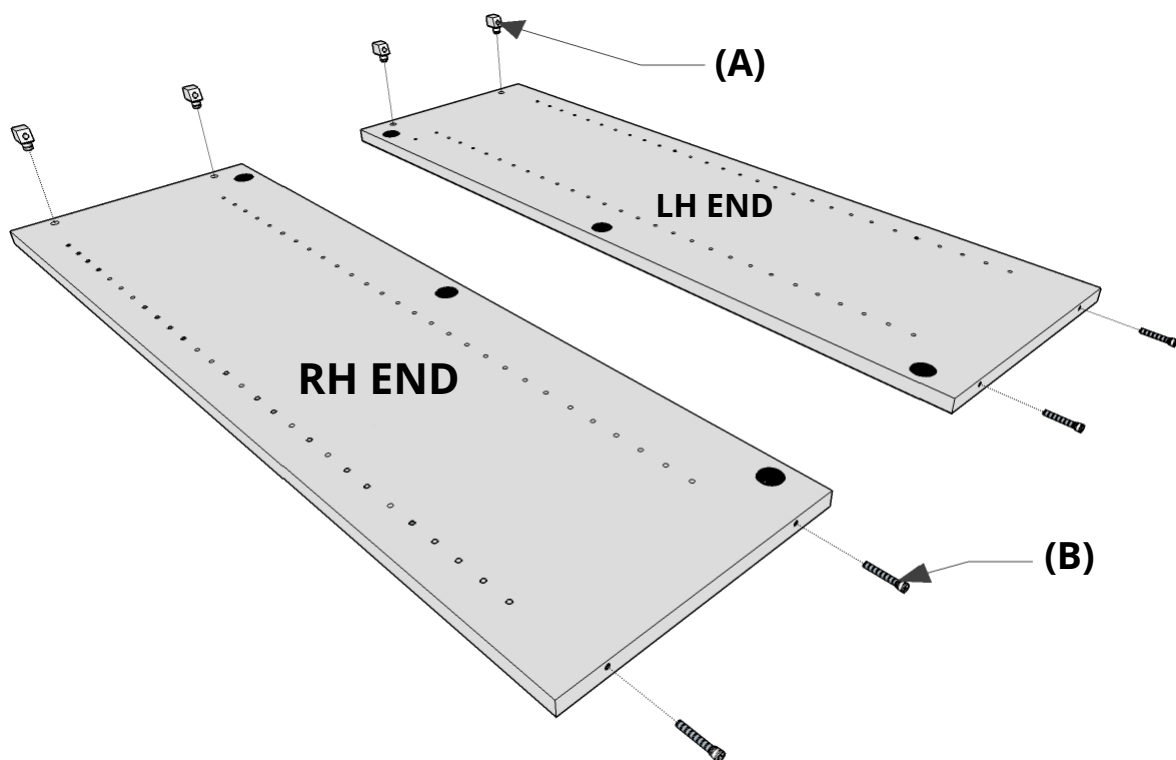

STEP 3

Align the CAM HOUSING on your end panels with your PINS (B) on your back panel. Tighten by rotating the screw to the RH. Repeat this step with your top panel.

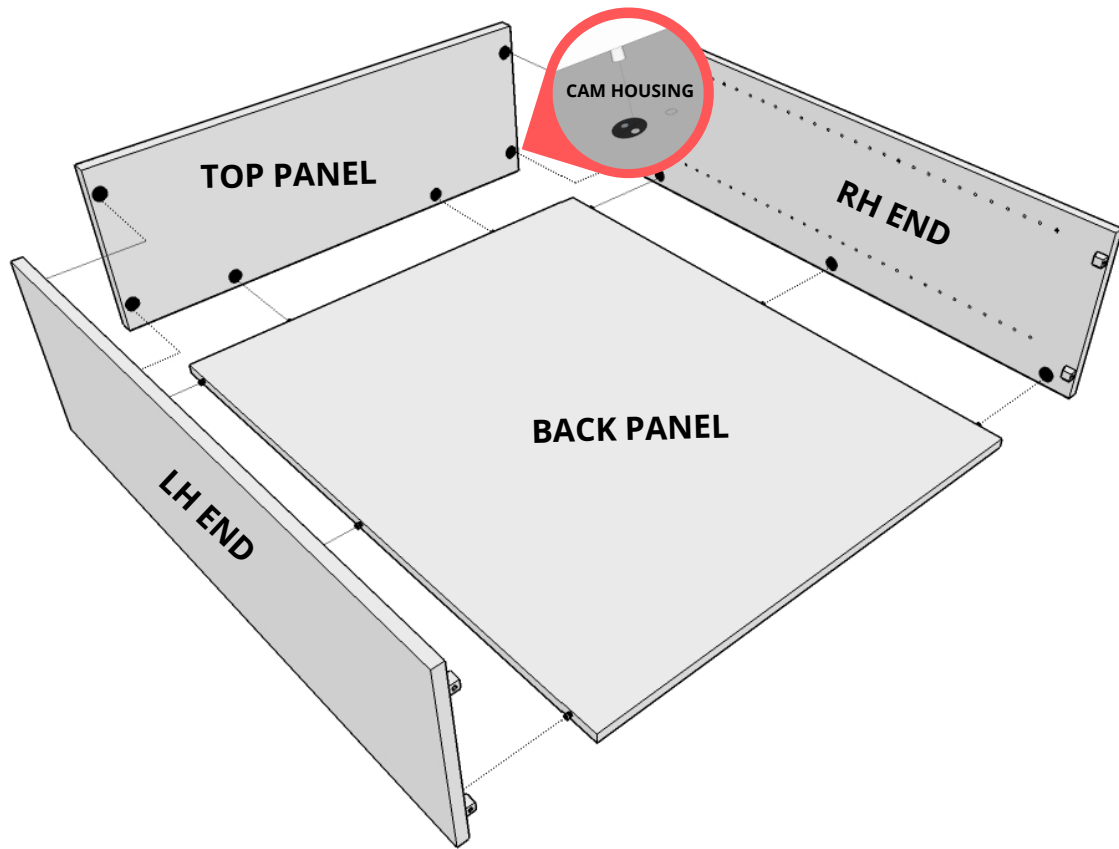

STEP 4

Place the assembled unit to its required position and insert SCREWS (C) into the top of your ARRET (A) and drive into top with force using your screw driver

NOTE: Be careful not to over tighten.

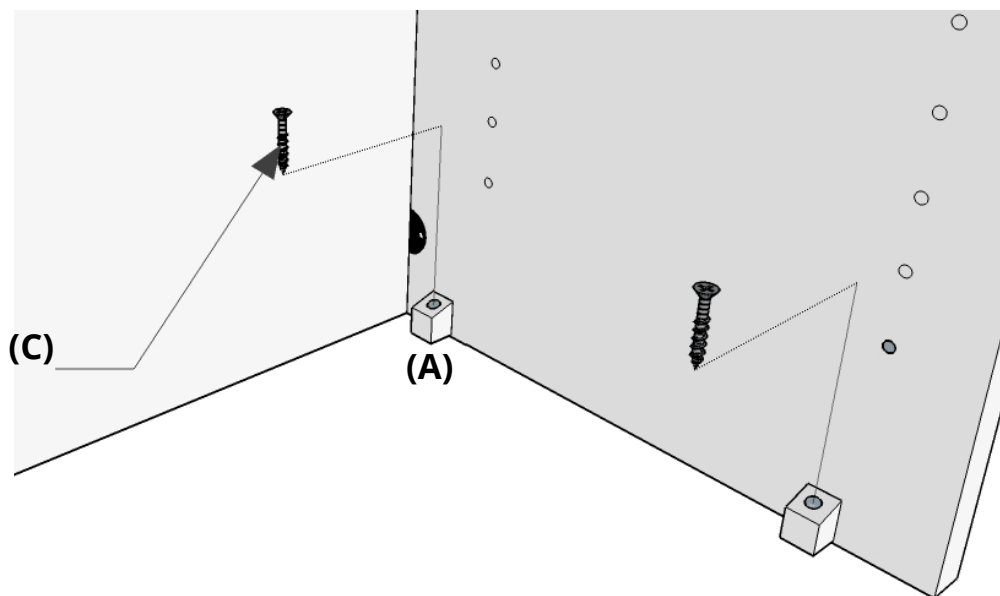

STEP 5

To insert shelves, place your SHELF SUPPORTS (D) in the holes on the end panels at the desired shelf height and the shelf sits on top

