

Contract for the sale and purchase of land 2019 edition

TERM	MEANING OF TERM	NSW DAN:
vendor's agent	Altitude Real Estate 68 Medcalf Street, Warners Bay, NSW 2282	Phone: 02 4903 8228 Fax: 02 4903 8233 Ref: Julie Beattie
co-agent		
vendor	Scott William Solomon and Sharna Marie Sanders 234 Newcastle Road, Jesmond, NSW 2299	
vendor's solicitor	 Evans & Wislang SOLICITORS & CONVEYANCERS PO Box 93, Kotara NSW 2289 Suite 6 Level 2 10 Bradford Close Kotara NSW 2289	Phone: 02 4952 5344 E: nicoleb@evansandwislang.com.au Ref: NB:JR:43260
date for completion land (address, plan details and title reference)	42nd day after the contract date 234 Newcastle Road, Jesmond, New South Wales 2299 Registered Plan: Lot 2 Plan DP 503329 Folio Identifier 2/503329	(clause 15)

improvements ☒ VACANT POSSESSION ☐ subject to existing tenancies

☒ HOUSE ☐ garage ☒ carport ☐ home unit ☐ carspace ☐ storage space

☐ none ☒ other: shed

attached copies ☒ documents in the List of Documents as marked or as numbered:
☐ other documents:

A real estate agent is permitted by legislation to fill up the items in this box in a sale of residential property.

inclusions	<input checked="" type="checkbox"/> blinds <input checked="" type="checkbox"/> dishwasher <input checked="" type="checkbox"/> light fittings <input checked="" type="checkbox"/> oven <input checked="" type="checkbox"/> built-in wardrobes <input checked="" type="checkbox"/> fixed floor coverings <input checked="" type="checkbox"/> range hood <input type="checkbox"/> pool equipment <input checked="" type="checkbox"/> clothes line <input checked="" type="checkbox"/> insect screens <input type="checkbox"/> solar panels <input checked="" type="checkbox"/> TV antenna <input checked="" type="checkbox"/> curtains <input checked="" type="checkbox"/> other: air conditioner, in built heater, 2 x wardrobes
exclusions	
purchaser	
purchaser's solicitor	
price	\$
deposit	\$ (10% of the price, unless otherwise stated)
balance	\$
contract date	(if not stated, the date this contract was made)

buyer's agent

vendor

GST AMOUNT (optional)

The price includes
 GST of: \$

witness

purchaser

☐ JOINT TENANTS ☐ tenants in common ☐ in unequal shares

witness

ChoicesVendor agrees to accept a **deposit-bond** (clause 3)☐ NO ☐ yes**Nominated Electronic Lodgment Network (ELN)** (clause 30):

PEXA

Electronic transaction (clause 30)☐ no ☒ YES(if no, vendor must provide further details, such as the proposed applicable waiver, in the space below, or serve *within* 14 days of the contract date):**Tax information (the parties promise this is correct as far as each party is aware)****Land tax** is adjustable☐ NO ☐ yes**GST:** Taxable supply☐ NO ☐ yes in full ☐ yes to an extent

Margin scheme will be used in making the taxable supply

☐ NO ☐ yes

This sale is not a taxable supply because (one or more of the following may apply) the sale is:

- ☐ not made in the course or furtherance of an enterprise that the vendor carries on (section 9-5(b))
- ☐ by a vendor who is neither registered nor required to be registered for GST (section 9-5(d))
- ☐ GST-free because the sale is the supply of a going concern under section 38-325
- ☐ GST-free because the sale is subdivided farm land or farm land supplied for farming under Subdivision 38-O
- ☐ input taxed because the sale is of eligible residential premises (sections 40-65, 40-75(2) and 195-1)

Purchaser must make a *GSTRW payment*
(GST residential withholding payment)☒ NO ☐ yes (if yes, vendor must provide further details)If the further details below are not fully completed at the contract date, the vendor must provide all these details in a separate notice *within* 14 days of the contract date.**GSTRW payment (GST residential withholding payment) – further details**

Frequently the supplier will be the vendor. However, sometimes further information will be required as to which entity is liable for GST, for example, if the supplier is a partnership, a trust, part of a GST group or a participant in a GST joint venture.

Supplier's name:

Supplier's ABN:

Supplier's GST branch address (if applicable):

Supplier's business address:

Supplier's email address:

Supplier's phone number:

Supplier's proportion of *GSTRW payment*:**If more than one supplier, provide the above details for each supplier.**Amount purchaser must pay – price multiplied by the *GSTRW rate* (residential withholding rate):Amount must be paid: ☐ AT COMPLETION ☐ at another time (specify):Is any of the consideration not expressed as an amount in money? ☐ NO ☐ yes

If "yes", the GST inclusive market value of the non-monetary consideration: \$

Other details (including those required by regulation or the ATO forms):

List of Documents

General	Strata or community title (clause 23 of the contract)
<input checked="" type="checkbox"/> 1 property certificate for the land	<input type="checkbox"/> 32 property certificate for strata common property
<input checked="" type="checkbox"/> 2 plan of the land	<input type="checkbox"/> 33 plan creating strata common property
<input type="checkbox"/> 3 unregistered plan of the land	<input type="checkbox"/> 34 strata by-laws
<input type="checkbox"/> 4 plan of land to be subdivided	<input type="checkbox"/> 35 strata development contract or statement
<input type="checkbox"/> 5 document that is to be lodged with a relevant plan	<input type="checkbox"/> 36 strata management statement
<input checked="" type="checkbox"/> 6 section 10.7(2) planning certificate under Environmental Planning and Assessment Act 1979	<input type="checkbox"/> 37 strata renewal proposal
<input type="checkbox"/> 7 additional information included in that certificate under section 10.7(5)	<input type="checkbox"/> 38 strata renewal plan
<input type="checkbox"/> 8 sewerage infrastructure location diagram (service location diagram)	<input type="checkbox"/> 39 leasehold strata - lease of lot and common property
<input checked="" type="checkbox"/> 9 sewer lines location diagram (sewerage service diagram)	<input type="checkbox"/> 40 property certificate for neighbourhood property
<input type="checkbox"/> 10 document that created or may have created an easement, profit à prendre, restriction on use or positive covenant disclosed in this contract	<input type="checkbox"/> 41 plan creating neighbourhood property
<input type="checkbox"/> 11 <i>planning agreement</i>	<input type="checkbox"/> 42 neighbourhood development contract
<input type="checkbox"/> 12 section 88G certificate (positive covenant)	<input type="checkbox"/> 43 neighbourhood management statement
<input type="checkbox"/> 13 survey report	<input type="checkbox"/> 44 property certificate for precinct property
<input type="checkbox"/> 14 building information certificate or building certificate given under <i>legislation</i>	<input type="checkbox"/> 45 plan creating precinct property
<input type="checkbox"/> 15 lease (with every relevant memorandum or variation)	<input type="checkbox"/> 46 precinct development contract
<input type="checkbox"/> 16 other document relevant to tenancies	<input type="checkbox"/> 47 precinct management statement
<input type="checkbox"/> 17 licence benefiting the land	<input type="checkbox"/> 48 property certificate for community property
<input type="checkbox"/> 18 old system document	<input type="checkbox"/> 49 plan creating community property
<input type="checkbox"/> 19 Crown purchase statement of account	<input type="checkbox"/> 50 community development contract
<input type="checkbox"/> 20 building management statement	<input type="checkbox"/> 51 community management statement
<input checked="" type="checkbox"/> 21 form of requisitions	<input type="checkbox"/> 52 document disclosing a change of by-laws
<input type="checkbox"/> 22 <i>clearance certificate</i>	<input type="checkbox"/> 53 document disclosing a change in a development or management contract or statement
<input type="checkbox"/> 23 land tax certificate	<input type="checkbox"/> 54 document disclosing a change in boundaries
Home Building Act 1989	<input type="checkbox"/> 55 information certificate under Strata Schemes Management Act 2015
<input type="checkbox"/> 24 insurance certificate	<input type="checkbox"/> 56 information certificate under Community Land Management Act 1989
<input type="checkbox"/> 25 brochure or warning	<input type="checkbox"/> 57 disclosure statement - off the plan contract
<input type="checkbox"/> 26 evidence of alternative indemnity cover	<input type="checkbox"/> 58 other document relevant to off the plan contract
Swimming Pools Act 1992	Other
<input type="checkbox"/> 27 certificate of compliance	<input type="checkbox"/> 59
<input type="checkbox"/> 28 evidence of registration	
<input type="checkbox"/> 29 relevant occupation certificate	
<input type="checkbox"/> 30 certificate of non-compliance	
<input type="checkbox"/> 31 detailed reasons of non-compliance	

HOLDER OF STRATA OR COMMUNITY TITLE RECORDS – Name, address, email address and telephone number

IMPORTANT NOTICE TO VENDORS AND PURCHASERS

Before signing this contract you should ensure that you understand your rights and obligations, some of which are not written in this contract but are implied by law.

WARNING—SMOKE ALARMS

The owners of certain types of buildings and strata lots must have smoke alarms (or in certain cases heat alarms) installed in the building or lot in accordance with regulations under the *Environmental Planning and Assessment Act 1979*. It is an offence not to comply. It is also an offence to remove or interfere with a smoke alarm or heat alarm. Penalties apply.

WARNING—LOOSE-FILL ASBESTOS INSULATION

Before purchasing land that includes any residential premises (within the meaning of Division 1A of Part 8 of the *Home Building Act 1989*) built before 1985, a purchaser is strongly advised to consider the possibility that the premises may contain loose-fill asbestos insulation (within the meaning of Division 1A of Part 8 of the *Home Building Act 1989*). In particular, a purchaser should:

- (a) search the Register required to be maintained under Division 1A of Part 8 of the *Home Building Act 1989*, and
- (b) ask the relevant local council whether it holds any records showing that the residential premises contain loose-fill asbestos insulation.

For further information about loose-fill asbestos insulation (including areas in which residential premises have been identified as containing loose-fill asbestos insulation), contact NSW Fair Trading.

COOLING OFF PERIOD (PURCHASER'S RIGHTS)

1. This is the statement required by section 66X of the *Conveyancing Act 1919* and applies to a contract for the sale of residential property.
2. **EXCEPT** in the circumstances listed in paragraph 3, the purchaser may rescind the contract at any time before 5 pm on—
 - (a) the tenth business day after the day on which the contract was made—in the case of an off the plan contract, or
 - (b) the fifth business day after the day on which the contract was made—in any other case.
3. There is **NO COOLING OFF PERIOD**:
 - (a) if, at or before the time the contract is made, the purchaser gives to the vendor (or the vendor's solicitor or agent) a certificate that complies with section 66W of the Act, or
 - (b) if the property is sold by public auction, or
 - (c) if the contract is made on the same day as the property was offered for sale by public auction but passed in, or
 - (d) if the contract is made in consequence of the exercise of an option to purchase the property, other than an option that is void under section 66ZG of the Act.
4. A purchaser exercising the right to cool off by rescinding the contract will forfeit to the vendor 0.25% of the purchase price of the property. The vendor is entitled to recover the amount forfeited from any amount paid by the purchaser as a deposit under the contract and the purchaser is entitled to a refund of any balance.

DISPUTES

If you get into a dispute with the other party, the Law Society and Real Estate Institute encourage you to use informal procedures such as negotiation, independent expert appraisal, the Law Society Conveyancing Dispute Resolution Scheme or mediation (for example mediation under the Law Society Mediation Program).

AUCTIONS

Regulations made under the Property, Stock and Business Agents Act 2002 prescribe a number of conditions applying to sales by auction.

WARNINGS

1. Various Acts of Parliament and other matters can affect the rights of the parties to this contract. Some important matters are actions, claims, decisions, licences, notices, orders, proposals or rights of way involving:

APA Group Australian Taxation Office Council County Council Department of Planning, Industry and Environment Department of Primary Industries Electricity and gas Land & Housing Corporation Local Land Services	NSW Department of Education NSW Fair Trading Owner of adjoining land Privacy Public Works Advisory Subsidence Advisory NSW Telecommunications Transport for NSW Water, sewerage or drainage authority
---	--

If you think that any of these matters affects the property, tell your solicitor.
2. A lease may be affected by the Agricultural Tenancies Act 1990, the Residential Tenancies Act 2010 or the Retail Leases Act 1994.
3. If any purchase money is owing to the Crown, it will become payable before obtaining consent, or if no consent is needed, when the transfer is registered.
4. If a consent to transfer is required under legislation, see clause 27 as to the obligations of the parties.
5. The vendor should continue the vendor's insurance until completion. If the vendor wants to give the purchaser possession before completion, the vendor should first ask the insurer to confirm this will not affect the insurance.
6. The purchaser will usually have to pay transfer duty (and sometimes surcharge purchaser duty) on this contract. If duty is not paid on time, a purchaser may incur penalties.
7. If the purchaser agrees to the release of deposit, the purchaser's right to recover the deposit may stand behind the rights of others (for example the vendor's mortgagee).
8. The purchaser should arrange insurance as appropriate.
9. Some transactions involving personal property may be affected by the Personal Property Securities Act 2009.
10. A purchaser should be satisfied that finance will be available at the time of completing the purchase.
11. Where the market value of the property is at or above a legislated amount, the purchaser may have to comply with a foreign resident capital gains withholding payment obligation (even if the vendor is not a foreign resident). If so, this will affect the amount available to the vendor on completion.
12. Purchasers of some residential properties may have to withhold part of the purchase price to be credited towards the GST liability of the vendor. If so, this will also affect the amount available to the vendor. More information is available from the ATO.

The vendor sells and the purchaser buys the *property* for the price under these provisions instead of Schedule 3 Conveyancing Act 1919, subject to any *legislation* that cannot be excluded.

1 Definitions (a term in *italics* is a defined term)

In this contract, these terms (in any form) mean –

<i>adjustment date</i>	the earlier of the giving of possession to the purchaser or completion;
<i>bank</i>	the Reserve Bank of Australia or an authorised deposit-taking institution which is a bank, a building society or a credit union;
<i>business day</i>	any day except a bank or public holiday throughout NSW or a Saturday or Sunday;
<i>cheque</i>	a cheque that is not postdated or stale;
<i>clearance certificate</i>	a certificate within the meaning of s14-220 of Schedule 1 to the <i>TA Act</i> , that covers one or more days falling within the period from and including the contract date to completion;
<i>deposit-bond</i>	a deposit bond or guarantee from an issuer, with an expiry date and for an amount each approved by the vendor;
<i>depositholder</i>	vendor's agent (or if no vendor's agent is named in this contract, the vendor's <i>solicitor</i> , or if no vendor's <i>solicitor</i> is named in this contract, the buyer's agent);
<i>document of title</i>	document relevant to the title or the passing of title;
<i>FRCGW percentage</i>	the percentage mentioned in s14-200(3)(a) of Schedule 1 to the <i>TA Act</i> (12.5% as at 1 July 2017);
<i>FRCGW remittance</i>	a remittance which the purchaser must make under s14-200 of Schedule 1 to the <i>TA Act</i> , being the lesser of the <i>FRCGW percentage</i> of the price (inclusive of GST, if any) and the amount specified in a <i>variation served by a party</i> ;
<i>GST Act</i>	A New Tax System (Goods and Services Tax) Act 1999;
<i>GST rate</i>	the rate mentioned in s4 of A New Tax System (Goods and Services Tax Imposition - General) Act 1999 (10% as at 1 July 2000);
<i>GSTRW payment</i>	a payment which the purchaser must make under s14-250 of Schedule 1 to the <i>TA Act</i> (the price multiplied by the <i>GSTRW rate</i>);
<i>GSTRW rate</i>	the rate determined under ss14-250(6), (8) or (9) of Schedule 1 to the <i>TA Act</i> (as at 1 July 2018, usually 7% of the price if the margin scheme applies, 1/11 th if not);
<i>legislation</i>	an Act or a by-law, ordinance, regulation or rule made under an Act;
<i>normally</i>	subject to any other provision of this contract;
<i>party</i>	each of the vendor and the purchaser;
<i>property</i>	the land, the improvements, all fixtures and the inclusions, but not the exclusions;
<i>planning agreement</i>	a valid voluntary agreement within the meaning of s7.4 of the Environmental Planning and Assessment Act 1979 entered into in relation to the <i>property</i> ;
<i>requisition</i>	an objection, question or requisition (but the term does not include a claim);
<i>rescind</i>	rescind this contract from the beginning;
<i>serve</i>	serve in writing on the other <i>party</i> ;
<i>settlement cheque</i>	an unendorsed <i>cheque</i> made payable to the person to be paid and – <ul style="list-style-type: none"> • issued by a <i>bank</i> and drawn on itself; or • if authorised in writing by the vendor or the vendor's <i>solicitor</i>, some other <i>cheque</i>;
<i>solicitor</i>	in relation to a <i>party</i> , the <i>party's</i> solicitor or licensed conveyancer named in this contract or in a notice <i>served by the party</i> ;
<i>TA Act</i>	Taxation Administration Act 1953;
<i>terminate</i>	terminate this contract for breach;
<i>variation</i>	a variation made under s14-235 of Schedule 1 to the <i>TA Act</i> ;
<i>within</i>	in relation to a period, at any time before or during the period; and
<i>work order</i>	a valid direction, notice or order that requires work to be done or money to be spent on or in relation to the <i>property</i> or any adjoining footpath or road (but the term does not include a notice under s22E of the Swimming Pools Act 1992 or clause 22 of the Swimming Pools Regulation 2018).

2 Deposit and other payments before completion

- 2.1 The purchaser must pay the deposit to the *depositholder* as stakeholder.
- 2.2 *Normally*, the purchaser must pay the deposit on the making of this contract, and this time is essential.
- 2.3 If this contract requires the purchaser to pay any of the deposit by a later time, that time is also essential.
- 2.4 The purchaser can pay any of the deposit by giving cash (up to \$2,000) or by unconditionally giving a *cheque* to the *depositholder* or to the vendor, vendor's agent or vendor's *solicitor* for sending to the *depositholder* or by payment by electronic funds transfer to the *depositholder*.
- 2.5 If any of the deposit is not paid on time or a *cheque* for any of the deposit is not honoured on presentation, the vendor can *terminate*. This right to *terminate* is lost as soon as the deposit is paid in full.
- 2.6 If the vendor accepts a bond or guarantee for the deposit, clauses 2.1 to 2.5 do not apply.

- 2.7 If the vendor accepts a bond or guarantee for part of the deposit, clauses 2.1 to 2.5 apply only to the balance.
- 2.8 If any of the deposit or of the balance of the price is paid before completion to the vendor or as the vendor directs, it is a charge on the land in favour of the purchaser until *termination* by the vendor or completion, subject to any existing right.
- 2.9 If each *party* tells the *depositholder* that the deposit is to be invested, the *depositholder* is to invest the deposit (at the risk of the *party* who becomes entitled to it) with a *bank*, in an interest-bearing account in NSW, payable at call, with interest to be reinvested, and pay the interest to the *parties* equally, after deduction of all proper government taxes and financial institution charges and other charges.

3 Deposit-bond

- 3.1 This clause applies only if this contract says the vendor has agreed to accept a *deposit-bond* for the deposit (or part of it).
- 3.2 The purchaser must provide the original *deposit-bond* to the vendor's *solicitor* (or if no *solicitor* the *depositholder*) at or before the making of this contract and this time is essential.
- 3.3 If the *deposit-bond* has an expiry date and completion does not occur by the date which is 14 days before the expiry date, the purchaser must *serve* a replacement *deposit-bond* at least 7 days before the expiry date. The time for service is essential.
- 3.4 The vendor must approve a replacement *deposit-bond* if –
- 3.4.1 it is from the same issuer and for the same amount as the earlier *deposit-bond*; and
 - 3.4.2 it has an expiry date at least three months after its date of issue.
- 3.5 A breach of clauses 3.2 or 3.3 entitles the vendor to *terminate*. The right to *terminate* is lost as soon as –
- 3.5.1 the purchaser *serves* a replacement *deposit-bond*; or
 - 3.5.2 the deposit is paid in full under clause 2.
- 3.6 Clauses 3.3 and 3.4 can operate more than once.
- 3.7 If the purchaser *serves* a replacement *deposit-bond*, the vendor must *serve* the earlier *deposit-bond*.
- 3.8 The amount of any *deposit-bond* does not form part of the price for the purposes of clause 16.7.
- 3.9 The vendor must give the purchaser the *deposit-bond* –
- 3.9.1 on completion; or
 - 3.9.2 if this contract is *rescinded*.
- 3.10 If this contract is *terminated* by the vendor –
- 3.10.1 *normally*, the vendor can immediately demand payment from the issuer of the *deposit-bond*; or
 - 3.10.2 if the purchaser *serves* prior to *termination* a notice disputing the vendor's right to *terminate*, the vendor must forward the *deposit-bond* (or its proceeds if called up) to the *depositholder* as stakeholder.
- 3.11 If this contract is *terminated* by the purchaser –
- 3.11.1 *normally*, the vendor must give the purchaser the *deposit-bond*; or
 - 3.11.2 if the vendor *serves* prior to *termination* a notice disputing the purchaser's right to *terminate*, the vendor must forward the *deposit-bond* (or its proceeds if called up) to the *depositholder* as stakeholder.

4 Transfer

- 4.1 *Normally*, the purchaser must *serve* at least 14 days before the date for completion –
- 4.1.1 the form of transfer; and
 - 4.1.2 particulars required to register any mortgage or other dealing to be lodged with the transfer by the purchaser or the purchaser's mortgagee.
- 4.2 If any information needed for the form of transfer is not disclosed in this contract, the vendor must *serve* it.
- 4.3 If the purchaser *serves* a form of transfer and the transferee is not the purchaser, the purchaser must give the vendor a *direction* signed by the purchaser personally for this form of transfer.
- 4.4 The vendor can require the purchaser to include a form of covenant or easement in the transfer only if this contract contains the wording of the proposed covenant or easement, and a description of the land benefited.

5 Requisitions

- 5.1 If a form of *requisitions* is attached to this contract, the purchaser is taken to have made those *requisitions*.
- 5.2 If the purchaser is or becomes entitled to make any other *requisition*, the purchaser can make it only by *serving* it –
- 5.2.1 if it arises out of this contract or it is a general question about the *property* or title - *within* 21 days after the contract date;
 - 5.2.2 if it arises out of anything *served* by the vendor - *within* 21 days after the later of the contract date and that *service*; and
 - 5.2.3 in any other case - *within* a reasonable time.

6 Error or misdescription

- 6.1 *Normally*, the purchaser can (but only before completion) claim compensation for an error or misdescription in this contract (as to the *property*, the title or anything else and whether substantial or not).
- 6.2 This clause applies even if the purchaser did not take notice of or rely on anything in this contract containing or giving rise to the error or misdescription.
- 6.3 However, this clause does not apply to the extent the purchaser knows the true position.

7 Claims by purchaser

Normally, the purchaser can make a claim (including a claim under clause 6) before completion only by *serving* it with a statement of the amount claimed, and if the purchaser makes one or more claims before completion –

- 7.1 the vendor can *rescind* if in the case of claims that are not claims for delay –
 - 7.1.1 the total amount claimed exceeds 5% of the price;
 - 7.1.2 the vendor *serves* notice of intention to *rescind*; and
 - 7.1.3 the purchaser does not *serve* notice waiving the claims *within* 14 days after that *service*; and
- 7.2 if the vendor does not *rescind*, the *parties* must complete and if this contract is completed –
 - 7.2.1 the lesser of the total amount claimed and 10% of the price must be paid out of the price to and held by the *depositholder* until the claims are finalised or lapse;
 - 7.2.2 the amount held is to be invested in accordance with clause 2.9;
 - 7.2.3 the claims must be finalised by an arbitrator appointed by the *parties* or, if an appointment is not made *within* 1 month of completion, by an arbitrator appointed by the President of the Law Society at the request of a *party* (in the latter case the *parties* are bound by the terms of the Conveyancing Arbitration Rules approved by the Law Society as at the date of the appointment);
 - 7.2.4 the purchaser is not entitled, in respect of the claims, to more than the total amount claimed and the costs of the purchaser;
 - 7.2.5 net interest on the amount held must be paid to the *parties* in the same proportion as the amount held is paid; and
 - 7.2.6 if the *parties* do not appoint an arbitrator and neither *party* requests the President to appoint an arbitrator *within* 3 months after completion, the claims lapse and the amount belongs to the vendor.

8 Vendor's rights and obligations

- 8.1 The vendor can *rescind* if –
 - 8.1.1 the vendor is, on reasonable grounds, unable or unwilling to comply with a *requisition*;
 - 8.1.2 the vendor *serves* a notice of intention to *rescind* that specifies the *requisition* and those grounds; and
 - 8.1.3 the purchaser does not *serve* a notice waiving the *requisition* *within* 14 days after that *service*.
- 8.2 If the vendor does not comply with this contract (or a notice under or relating to it) in an essential respect, the purchaser can *terminate* by *serving* a notice. After the *termination* –
 - 8.2.1 the purchaser can recover the deposit and any other money paid by the purchaser under this contract;
 - 8.2.2 the purchaser can sue the vendor to recover damages for breach of contract; and
 - 8.2.3 if the purchaser has been in possession a *party* can claim for a reasonable adjustment.

9 Purchaser's default

If the purchaser does not comply with this contract (or a notice under or relating to it) in an essential respect, the vendor can *terminate* by *serving* a notice. After the *termination* the vendor can –

- 9.1 keep or recover the deposit (to a maximum of 10% of the price);
- 9.2 hold any other money paid by the purchaser under this contract as security for anything recoverable under this clause –
 - 9.2.1 for 12 months after the *termination*; or
 - 9.2.2 if the vendor commences proceedings under this clause *within* 12 months, until those proceedings are concluded; and
- 9.3 sue the purchaser either –
 - 9.3.1 where the vendor has resold the *property* under a contract made *within* 12 months after the *termination*, to recover –
 - the deficiency on resale (with credit for any of the deposit kept or recovered and after allowance for any capital gains tax or goods and services tax payable on anything recovered under this clause); and
 - the reasonable costs and expenses arising out of the purchaser's non-compliance with this contract or the notice and of resale and any attempted resale; or
 - 9.3.2 to recover damages for breach of contract.

10 Restrictions on rights of purchaser

- 10.1 The purchaser cannot make a claim or *requisition* or *rescind* or *terminate* in respect of –
 - 10.1.1 the ownership or location of any fence as defined in the Dividing Fences Act 1991;
 - 10.1.2 a service for the *property* being a joint service or passing through another property, or any service for another property passing through the *property* ('service' includes air, communication, drainage, electricity, garbage, gas, oil, radio, sewerage, telephone, television or water service);
 - 10.1.3 a wall being or not being a party wall in any sense of that term or the *property* being affected by an easement for support or not having the benefit of an easement for support;
 - 10.1.4 any change in the *property* due to fair wear and tear before completion;
 - 10.1.5 a promise, representation or statement about this contract, the *property* or the title, not set out or referred to in this contract;
 - 10.1.6 a condition, exception, reservation or restriction in a Crown grant;

- 10.1.7 the existence of any authority or licence to explore or prospect for gas, minerals or petroleum;
- 10.1.8 any easement or restriction on use the substance of either of which is disclosed in this contract or any non-compliance with the easement or restriction on use; or
- 10.1.9 anything the substance of which is disclosed in this contract (except a caveat, charge, mortgage, priority notice or writ).

10.2 The purchaser cannot *rescind* or *terminate* only because of a defect in title to or quality of the inclusions.

10.3 *Normally*, the purchaser cannot make a claim or *requisition* or *rescind* or *terminate* or require the vendor to change the nature of the title disclosed in this contract (for example, to remove a caution evidencing qualified title, or to lodge a plan of survey as regards limited title).

11 Compliance with work orders

11.1 *Normally*, the vendor must by completion comply with a *work order* made on or before the contract date and if this contract is completed the purchaser must comply with any other *work order*.

11.2 If the purchaser complies with a *work order*, and this contract is *rescinded* or *terminated*, the vendor must pay the expense of compliance to the purchaser.

12 Certificates and inspections

The vendor must do everything reasonable to enable the purchaser, subject to the rights of any tenant –

12.1 to have the *property* inspected to obtain any certificate or report reasonably required;

12.2 to apply (if necessary in the name of the vendor) for –

12.2.1 any certificate that can be given in respect of the *property* under *legislation*; or

12.2.2 a copy of any approval, certificate, consent, direction, notice or order in respect of the *property* given under *legislation*, even if given after the contract date; and

12.3 to make 1 inspection of the *property* in the 3 days before a time appointed for completion.

13 Goods and services tax (GST)

13.1 Terms used in this clause which are not defined elsewhere in this contract and have a defined meaning in the *GST Act* have the same meaning in this clause.

13.2 *Normally*, if a *party* must pay the price or any other amount to the other *party* under this contract, GST is not to be added to the price or amount.

13.3 If under this contract a *party* must make an adjustment or payment for an expense of another party or pay an expense payable by or to a third party (for example, under clauses 14 or 20.7) –

13.3.1 the *party* must adjust or pay on completion any GST added to or included in the expense; but

13.3.2 the amount of the expense must be reduced to the extent the party receiving the adjustment or payment (or the representative member of a GST group of which that party is a member) is entitled to an input tax credit for the expense; and

13.3.3 if the adjustment or payment under this contract is consideration for a taxable supply, an amount for GST must be added at the *GST rate*.

13.4 If this contract says this sale is the supply of a going concern –

13.4.1 the *parties* agree the supply of the *property* is a supply of a going concern;

13.4.2 the vendor must, between the contract date and completion, carry on the enterprise conducted on the land in a proper and business-like way;

13.4.3 if the purchaser is not registered by the date for completion, the *parties* must complete and the purchaser must pay on completion, in addition to the price, an amount being the price multiplied by the *GST rate* ("the retention sum"). The retention sum is to be held by the *depositholder* and dealt with as follows –

- if *within* 3 months of completion the purchaser serves a letter from the Australian Taxation Office stating the purchaser is registered with a date of effect of registration on or before completion, the *depositholder* is to pay the retention sum to the purchaser; but
- if the purchaser does not serve that letter *within* 3 months of completion, the *depositholder* is to pay the retention sum to the vendor; and

13.4.4 if the vendor, despite clause 13.4.1, serves a letter from the Australian Taxation Office stating the vendor has to pay GST on the supply, the purchaser must pay to the vendor on demand the amount of GST assessed.

13.5 *Normally*, the vendor promises the margin scheme will not apply to the supply of the *property*.

13.6 If this contract says the margin scheme is to apply in making the taxable supply, the *parties* agree that the margin scheme is to apply to the sale of the *property*.

13.7 If this contract says the sale is not a taxable supply –

13.7.1 the purchaser promises that the *property* will not be used and represents that the purchaser does not intend the *property* (or any part of the *property*) to be used in a way that could make the sale a taxable supply to any extent; and

13.7.2 the purchaser must pay the vendor on completion in addition to the price an amount calculated by multiplying the price by the *GST rate* if this sale is a taxable supply to any extent because of –

- a breach of clause 13.7.1; or
- something else known to the purchaser but not the vendor.

13.8 If this contract says this sale is a taxable supply in full and does not say the margin scheme applies to the *property*, the vendor must pay the purchaser on completion an amount of one-eleventh of the price if –

- 13.8.1 this sale is not a taxable supply in full; or
- 13.8.2 the margin scheme applies to the *property* (or any part of the *property*).
- 13.9 If this contract says this sale is a taxable supply to an extent –
- 13.9.1 clause 13.7.1 does not apply to any part of the *property* which is identified as being a taxable supply; and
- 13.9.2 the payments mentioned in clauses 13.7 and 13.8 are to be recalculated by multiplying the relevant payment by the proportion of the price which represents the value of that part of the *property* to which the clause applies (the proportion to be expressed as a number between 0 and 1). Any evidence of value must be obtained at the expense of the vendor.
- 13.10 *Normally*, on completion the vendor must give the recipient of the supply a tax invoice for any taxable supply by the vendor by or under this contract.
- 13.11 The vendor does not have to give the purchaser a tax invoice if the margin scheme applies to a taxable supply.
- 13.12 If the vendor is liable for GST on rents or profits due to issuing an invoice or receiving consideration before completion, any adjustment of those amounts must exclude an amount equal to the vendor's GST liability.
- 13.13 If the purchaser must make a *GSTRW payment* the purchaser must –
- 13.13.1 at least 5 days before the date for completion, *serve* evidence of submission of a *GSTRW payment* notification form to the Australian Taxation Office by the purchaser or, if a direction under clause 4.3 has been *served*, by the transferee named in the transfer *served* with that direction;
- 13.13.2 produce on completion a *settlement cheque* for the *GSTRW payment* payable to the Deputy Commissioner of Taxation;
- 13.13.3 forward the *settlement cheque* to the payee immediately after completion; and
- 13.13.4 *serve* evidence of receipt of payment of the *GSTRW payment* and a copy of the settlement date confirmation form submitted to the Australian Taxation Office.

14 Adjustments

- 14.1 *Normally*, the vendor is entitled to the rents and profits and will be liable for all rates, water, sewerage and drainage service and usage charges, land tax, levies and all other periodic outgoings up to and including the *adjustment date* after which the purchaser will be entitled and liable.
- 14.2 The *parties* must make any necessary adjustment on completion.
- 14.3 If an amount that is adjustable under this contract has been reduced under *legislation*, the *parties* must on completion adjust the reduced amount.
- 14.4 The *parties* must not adjust surcharge land tax (as defined in the Land Tax Act 1956) but must adjust any other land tax for the year current at the *adjustment date* –
- 14.4.1 only if land tax has been paid or is payable for the year (whether by the vendor or by a predecessor in title) and this contract says that land tax is adjustable;
- 14.4.2 by adjusting the amount that would have been payable if at the start of the year –
- the person who owned the land owned no other land;
 - the land was not subject to a special trust or owned by a non-concessional company; and
 - if the land (or part of it) had no separate taxable value, by calculating its separate taxable value on a proportional area basis.
- 14.5 If any other amount that is adjustable under this contract relates partly to the land and partly to other land, the *parties* must adjust it on a proportional area basis.
- 14.6 *Normally*, the vendor can direct the purchaser to produce a *settlement cheque* on completion to pay an amount adjustable under this contract and if so –
- 14.6.1 the amount is to be treated as if it were paid; and
- 14.6.2 the *cheque* must be forwarded to the payee immediately after completion (by the purchaser if the *cheque* relates only to the *property* or by the vendor in any other case).
- 14.7 If on completion the last bill for a water, sewerage or drainage usage charge is for a period ending before the *adjustment date*, the vendor is liable for an amount calculated by dividing the bill by the number of days in the period then multiplying by the number of unbilled days up to and including the *adjustment date*.
- 14.8 The vendor is liable for any amount recoverable for work started on or before the contract date on the *property* or any adjoining footpath or road.

15 Date for completion

The *parties* must complete by the date for completion and, if they do not, a *party* can *serve* a notice to complete if that *party* is otherwise entitled to do so.

16 Completion

• Vendor

- 16.1 On completion the vendor must give the purchaser any *document of title* that relates only to the *property*.
- 16.2 If on completion the vendor has possession or control of a *document of title* that relates also to other property, the vendor must produce it as and where necessary.
- 16.3 *Normally*, on completion the vendor must cause the legal title to the *property* (being an estate in fee simple) to pass to the purchaser free of any mortgage or other interest, subject to any necessary registration.
- 16.4 The legal title to the *property* does not pass before completion.

- 16.5 If the vendor gives the purchaser a document (other than the transfer) that needs to be lodged for registration, the vendor must pay the lodgment fee to the purchaser.
- 16.6 If a *party serves* a land tax certificate showing a charge on any of the land, by completion the vendor must do all things and pay all money required so that the charge is no longer effective against the land.
- **Purchaser**
- 16.7 On completion the purchaser must pay to the vendor, by cash (up to \$2,000) or *settlement cheque* –
- 16.7.1 the price less any:
- deposit paid;
 - *FRCGW remittance* payable;
 - *GSTRW payment*; and
 - amount payable by the vendor to the purchaser under this contract; and
- 16.7.2 any other amount payable by the purchaser under this contract.
- 16.8 If the vendor requires more than 5 *settlement cheques*, the vendor must pay \$10 for each extra *cheque*.
- 16.9 If any of the deposit is not covered by a bond or guarantee, on completion the purchaser must give the vendor an order signed by the purchaser authorising the *depositholder* to account to the vendor for the deposit.
- 16.10 On completion the deposit belongs to the vendor.
- **Place for completion**
- 16.11 *Normally*, the *parties* must complete at the completion address, which is –
- 16.11.1 if a special completion address is stated in this contract - that address; or
- 16.11.2 if none is stated, but a first mortgagee is disclosed in this contract and the mortgagee would usually discharge the mortgage at a particular place - that place; or
- 16.11.3 in any other case - the vendor's *solicitor's* address stated in this contract.
- 16.12 The vendor by reasonable notice can require completion at another place, if it is in NSW, but the vendor must pay the purchaser's additional expenses, including any agency or mortgagee fee.
- 16.13 If the purchaser requests completion at a place that is not the completion address, and the vendor agrees, the purchaser must pay the vendor's additional expenses, including any agency or mortgagee fee.
- 17 Possession**
- 17.1 *Normally*, the vendor must give the purchaser vacant possession of the *property* on completion.
- 17.2 The vendor does not have to give vacant possession if –
- 17.2.1 this contract says that the sale is subject to existing tenancies; and
- 17.2.2 the contract discloses the provisions of the tenancy (for example, by attaching a copy of the lease and any relevant memorandum or variation).
- 17.3 *Normally*, the purchaser can claim compensation (before or after completion) or *rescind* if any of the land is affected by a protected tenancy (a tenancy affected by Schedule 2, Part 7 of the Residential Tenancies Act 2010).
- 18 Possession before completion**
- 18.1 This clause applies only if the vendor gives the purchaser possession of the *property* before completion.
- 18.2 The purchaser must not before completion –
- 18.2.1 let or part with possession of any of the *property*;
- 18.2.2 make any change or structural alteration or addition to the *property*; or
- 18.2.3 contravene any agreement between the *parties* or any direction, document, *legislation*, notice or order affecting the *property*.
- 18.3 The purchaser must until completion –
- 18.3.1 keep the *property* in good condition and repair having regard to its condition at the giving of possession; and
- 18.3.2 allow the vendor or the vendor's authorised representative to enter and inspect it at all reasonable times.
- 18.4 The risk as to damage to the *property* passes to the purchaser immediately after the purchaser enters into possession.
- 18.5 If the purchaser does not comply with this clause, then without affecting any other right of the vendor –
- 18.5.1 the vendor can before completion, without notice, remedy the non-compliance; and
- 18.5.2 if the vendor pays the expense of doing this, the purchaser must pay it to the vendor with interest at the rate prescribed under s101 Civil Procedure Act 2005.
- 18.6 If this contract is *rescinded* or *terminated* the purchaser must immediately vacate the *property*.
- 18.7 If the *parties* or their *solicitors* on their behalf do not agree in writing to a fee or rent, none is payable.
- 19 Rescission of contract**
- 19.1 If this contract expressly gives a *party* a right to *rescind*, the *party* can exercise the right –
- 19.1.1 only by *serving* a notice before completion; and
- 19.1.2 in spite of any making of a claim or *requisition*, any attempt to satisfy a claim or *requisition*, any arbitration, litigation, mediation or negotiation or any giving or taking of possession.
- 19.2 *Normally*, if a *party* exercises a right to *rescind* expressly given by this contract or any *legislation* –
- 19.2.1 the deposit and any other money paid by the purchaser under this contract must be refunded;
- 19.2.2 a *party* can claim for a reasonable adjustment if the purchaser has been in possession;
- 19.2.3 a *party* can claim for damages, costs or expenses arising out of a breach of this contract; and
- 19.2.4 a *party* will not otherwise be liable to pay the other *party* any damages, costs or expenses.

20 Miscellaneous

- 20.1 The *parties* acknowledge that anything stated in this contract to be attached was attached to this contract by the vendor before the purchaser signed it and is part of this contract.
- 20.2 Anything attached to this contract is part of this contract.
- 20.3 An area, bearing or dimension in this contract is only approximate.
- 20.4 If a *party* consists of 2 or more persons, this contract benefits and binds them separately and together.
- 20.5 A *party's solicitor* can receive any amount payable to the *party* under this contract or direct in writing that it is to be paid to another person.
- 20.6 A document under or relating to this contract is –
- 20.6.1 signed by a *party* if it is signed by the *party* or the *party's solicitor* (apart from a direction under clause 4.3);
- 20.6.2 served if it is served by the *party* or the *party's solicitor*;
- 20.6.3 served if it is served on the *party's solicitor*, even if the *party* has died or any of them has died;
- 20.6.4 served if it is served in any manner provided in s170 of the Conveyancing Act 1919;
- 20.6.5 served if it is sent by email or fax to the *party's solicitor*, unless in either case it is not received;
- 20.6.6 served on a person if it (or a copy of it) comes into the possession of the person; and
- 20.6.7 served at the earliest time it is served, if it is served more than once.
- 20.7 An obligation to pay an expense of another *party* of doing something is an obligation to pay –
- 20.7.1 if the *party* does the thing personally - the reasonable cost of getting someone else to do it; or
- 20.7.2 if the *party* pays someone else to do the thing - the amount paid, to the extent it is reasonable.
- 20.8 Rights under clauses 11, 13, 14, 17, 24, 30 and 31 continue after completion, whether or not other rights continue.
- 20.9 The vendor does not promise, represent or state that the purchaser has any cooling off rights.
- 20.10 The vendor does not promise, represent or state that any attached survey report is accurate or current.
- 20.11 A reference to any *legislation* (including any percentage or rate specified in *legislation*) is also a reference to any corresponding later *legislation*.
- 20.12 Each *party* must do whatever is necessary after completion to carry out the *party's* obligations under this contract.
- 20.13 Neither taking possession nor *serving* a transfer of itself implies acceptance of the *property* or the title.
- 20.14 The details and information provided in this contract (for example, on pages 1 - 3) are, to the extent of each *party's* knowledge, true, and are part of this contract.
- 20.15 Where this contract provides for choices, a choice in BLOCK CAPITALS applies unless a different choice is marked.

21 Time limits in these provisions

- 21.1 If the time for something to be done or to happen is not stated in these provisions, it is a reasonable time.
- 21.2 If there are conflicting times for something to be done or to happen, the latest of those times applies.
- 21.3 The time for one thing to be done or to happen does not extend the time for another thing to be done or to happen.
- 21.4 If the time for something to be done or to happen is the 29th, 30th or 31st day of a month, and the day does not exist, the time is instead the last day of the month.
- 21.5 If the time for something to be done or to happen is a day that is not a *business day*, the time is extended to the next *business day*, except in the case of clauses 2 and 3.2.
- 21.6 *Normally*, the time by which something must be done is fixed but not essential.

22 Foreign Acquisitions and Takeovers Act 1975

- 22.1 The purchaser promises that the Commonwealth Treasurer cannot prohibit and has not prohibited the transfer under the Foreign Acquisitions and Takeovers Act 1975.
- 22.2 This promise is essential and a breach of it entitles the vendor to *terminate*.

23 Strata or community title**• Definitions and modifications**

- 23.1 This clause applies only if the land (or part of it) is a lot in a strata, neighbourhood, precinct or community scheme (or on completion is to be a lot in a scheme of that kind).
- 23.2 In this contract –
- 23.2.1 'change', in relation to a scheme, means –
- a registered or registrable change from by-laws set out in this contract;
 - a change from a development or management contract or statement set out in this contract; or
 - a change in the boundaries of common property;
- 23.2.2 'common property' includes association property for the scheme or any higher scheme;
- 23.2.3 'contribution' includes an amount payable under a by-law;
- 23.2.4 'information certificate' includes a certificate under s184 Strata Schemes Management Act 2015 and s26 Community Land Management Act 1989;
- 23.2.5 'information notice' includes a strata information notice under s22 Strata Schemes Management Act 2015 and a notice under s47 Community Land Management Act 1989;

- 23.2.6 'normal expenses', in relation to an owners corporation for a scheme, means normal operating expenses usually payable from the administrative fund of an owners corporation for a scheme of the same kind;
- 23.2.7 'owners corporation' means the owners corporation or the association for the scheme or any higher scheme;
- 23.2.8 'the *property*' includes any interest in common property for the scheme associated with the lot; and
- 23.2.9 'special expenses', in relation to an owners corporation, means its actual, contingent or expected expenses, except to the extent they are –
- normal expenses;
 - due to fair wear and tear;
 - disclosed in this contract; or
 - covered by moneys held in the capital works fund.
- 23.3 Clauses 11, 14.8 and 18.4 do not apply to an obligation of the owners corporation, or to property insurable by it.
- 23.4 Clauses 14.4.2 and 14.5 apply but on a unit entitlement basis instead of an area basis.
- **Adjustments and liability for expenses**
- 23.5 The *parties* must adjust under clause 14.1 –
- 23.5.1 a regular periodic contribution;
- 23.5.2 a contribution which is not a regular periodic contribution but is disclosed in this contract; and
- 23.5.3 on a unit entitlement basis, any amount paid by the vendor for a normal expense of the owners corporation to the extent the owners corporation has not paid the amount to the vendor.
- 23.6 If a contribution is not a regular periodic contribution and is not disclosed in this contract –
- 23.6.1 the vendor is liable for it if it was determined on or before the contract date, even if it is payable by instalments; and
- 23.6.2 the purchaser is liable for all contributions determined after the contract date.
- 23.7 The vendor must pay or allow to the purchaser on completion the amount of any unpaid contributions for which the vendor is liable under clause 23.6.1.
- 23.8 *Normally*, the purchaser cannot make a claim or *requisition* or *rescind* or *terminate* in respect of –
- 23.8.1 an existing or future actual, contingent or expected expense of the owners corporation;
- 23.8.2 a proportional unit entitlement of the lot or a relevant lot or former lot, apart from a claim under clause 6; or
- 23.8.3 a past or future change in the scheme or a higher scheme.
- 23.9 However, the purchaser can *rescind* if –
- 23.9.1 the special expenses of the owners corporation at the later of the contract date and the creation of the owners corporation when calculated on a unit entitlement basis (and, if more than one lot or a higher scheme is involved, added together), less any contribution paid by the vendor, are more than 1% of the price;
- 23.9.2 in the case of the lot or a relevant lot or former lot in a higher scheme, a proportional unit entitlement for the lot is disclosed in this contract but the lot has a different proportional unit entitlement at the contract date or at any time before completion;
- 23.9.3 a change before the contract date or before completion in the scheme or a higher scheme materially prejudices the purchaser and is not disclosed in this contract; or
- 23.9.4 a resolution is passed by the owners corporation before the contract date or before completion to give to the owners in the scheme for their consideration a strata renewal plan that has not lapsed at the contract date and there is not attached to this contract a strata renewal proposal or the strata renewal plan.
- **Notices, certificates and inspections**
- 23.10 The purchaser must give the vendor 2 copies of an information notice addressed to the owners corporation and signed by the purchaser.
- 23.11 The vendor must complete and sign 1 copy of the notice and give it to the purchaser on completion.
- 23.12 Each *party* can sign and give the notice as agent for the other.
- 23.13 The vendor must serve an information certificate issued after the contract date in relation to the lot, the scheme or any higher scheme at least 7 days before the date for completion.
- 23.14 The purchaser does not have to complete earlier than 7 days after *service* of the certificate and clause 21.3 does not apply to this provision. On completion the purchaser must pay the vendor the prescribed fee for the certificate.
- 23.15 The vendor authorises the purchaser to apply for the purchaser's own certificate.
- 23.16 The vendor authorises the purchaser to apply for and make an inspection of any record or other document in the custody or control of the owners corporation or relating to the scheme or any higher scheme.
- **Meetings of the owners corporation**
- 23.17 If a general meeting of the owners corporation is convened before completion –
- 23.17.1 if the vendor receives notice of it, the vendor must immediately notify the purchaser of it; and
- 23.17.2 after the expiry of any cooling off period, the purchaser can require the vendor to appoint the purchaser (or the purchaser's nominee) to exercise any voting rights of the vendor in respect of the lot at the meeting.

24 Tenancies

- 24.1 If a tenant has not made a payment for a period preceding or current at the *adjustment date* –
- 24.1.1 for the purposes of clause 14.2, the amount is to be treated as if it were paid; and
- 24.1.2 the purchaser assigns the debt to the vendor on completion and will if required give a further assignment at the vendor's expense.
- 24.2 If a tenant has paid in advance of the *adjustment date* any periodic payment in addition to rent, it must be adjusted as if it were rent for the period to which it relates.
- 24.3 If the *property* is to be subject to a tenancy on completion or is subject to a tenancy on completion –
- 24.3.1 the vendor authorises the purchaser to have any accounting records relating to the tenancy inspected and audited and to have any other document relating to the tenancy inspected;
- 24.3.2 the vendor must *serve* any information about the tenancy reasonably requested by the purchaser before or after completion; and
- 24.3.3 *normally*, the purchaser can claim compensation (before or after completion) if –
- a disclosure statement required by the Retail Leases Act 1994 was not given when required;
 - such a statement contained information that was materially false or misleading;
 - a provision of the lease is not enforceable because of a non-disclosure in such a statement; or
 - the lease was entered into in contravention of the Retail Leases Act 1994.
- 24.4 If the *property* is subject to a tenancy on completion –
- 24.4.1 the vendor must allow or transfer –
- any remaining bond money or any other security against the tenant's default (to the extent the security is transferable);
 - any money in a fund established under the lease for a purpose and compensation for any money in the fund or interest earned by the fund that has been applied for any other purpose; and
 - any money paid by the tenant for a purpose that has not been applied for that purpose and compensation for any of the money that has been applied for any other purpose;
- 24.4.2 if the security is not transferable, each *party* must do everything reasonable to cause a replacement security to issue for the benefit of the purchaser and the vendor must hold the original security on trust for the benefit of the purchaser until the replacement security issues;
- 24.4.3 the vendor must give to the purchaser –
- a proper notice of the transfer (an attornment notice) addressed to the tenant;
 - any certificate given under the Retail Leases Act 1994 in relation to the tenancy;
 - a copy of any disclosure statement given under the Retail Leases Act 1994;
 - a copy of any document served on the tenant under the lease and written details of its service, if the document concerns the rights of the landlord or the tenant after completion; and
 - any document served by the tenant under the lease and written details of its service, if the document concerns the rights of the landlord or the tenant after completion;
- 24.4.4 the vendor must comply with any obligation to the tenant under the lease, to the extent it is to be complied with by completion; and
- 24.4.5 the purchaser must comply with any obligation to the tenant under the lease, to the extent that the obligation is disclosed in this contract and is to be complied with after completion.

25 Qualified title, limited title and old system title

- 25.1 This clause applies only if the land (or part of it) –
- 25.1.1 is under qualified, limited or old system title; or
- 25.1.2 on completion is to be under one of those titles.
- 25.2 The vendor must *serve* a proper abstract of title *within 7 days* after the contract date.
- 25.3 If an abstract of title or part of an abstract of title is attached to this contract or has been lent by the vendor to the purchaser before the contract date, the abstract or part is *served* on the contract date.
- 25.4 An abstract of title can be or include a list of documents, events and facts arranged (apart from a will or codicil) in date order, if the list in respect of each document –
- 25.4.1 shows its date, general nature, names of parties and any registration number; and
- 25.4.2 has attached a legible photocopy of it or of an official or registration copy of it.
- 25.5 An abstract of title –
- 25.5.1 must start with a good root of title (if the good root of title must be at least 30 years old, this means 30 years old at the contract date);
- 25.5.2 in the case of a leasehold interest, must include an abstract of the lease and any higher lease;
- 25.5.3 *normally*, need not include a Crown grant; and
- 25.5.4 need not include anything evidenced by the Register kept under the Real Property Act 1900.
- 25.6 In the case of land under old system title –
- 25.6.1 in this contract 'transfer' means conveyance;
- 25.6.2 the purchaser does not have to *serve* the form of transfer until after the vendor has *served* a proper abstract of title; and
- 25.6.3 each vendor must give proper covenants for title as regards that vendor's interest.
- 25.7 In the case of land under limited title but not under qualified title –

- 25.7.1 *normally*, the abstract of title need not include any document which does not show the location, area or dimensions of the land (for example, by including a metes and bounds description or a plan of the land);
- 25.7.2 clause 25.7.1 does not apply to a document which is the good root of title; and
- 25.7.3 the vendor does not have to provide an abstract if this contract contains a delimitation plan (whether in registrable form or not).

25.8 The vendor must give a proper covenant to produce where relevant.

25.9 The vendor does not have to produce or covenant to produce a document that is not in the possession of the vendor or a mortgagee.

25.10 If the vendor is unable to produce an original document in the chain of title, the purchaser will accept a photocopy from the Registrar-General of the registration copy of that document.

26 Crown purchase money

26.1 This clause applies only if purchase money is payable to the Crown, whether or not due for payment.

26.2 The vendor is liable for the money, except to the extent this contract says the purchaser is liable for it.

26.3 To the extent the vendor is liable for it, the vendor is liable for any interest until completion.

26.4 To the extent the purchaser is liable for it, the *parties* must adjust any interest under clause 14.1.

27 Consent to transfer

27.1 This clause applies only if the land (or part of it) cannot be transferred without consent under *legislation* or a *planning agreement*.

27.2 The purchaser must properly complete and then *serve* the purchaser's part of an application for consent to transfer of the land (or part of it) *within 7 days* after the contract date.

27.3 The vendor must apply for consent *within 7 days* after *service* of the purchaser's part.

27.4 If consent is refused, either *party* can *rescind*.

27.5 If consent is given subject to one or more conditions that will substantially disadvantage a *party*, then that *party* can *rescind within 7 days* after receipt by or *service* upon the *party* of written notice of the conditions.

27.6 If consent is not given or refused –

27.6.1 *within 42 days* after the purchaser *serves* the purchaser's part of the application, the purchaser can *rescind*; or

27.6.2 *within 30 days* after the application is made, either *party* can *rescind*.

27.7 Each period in clause 27.6 becomes 90 days if the land (or part of it) is –

27.7.1 under a *planning agreement*; or

27.7.2 in the Western Division.

27.8 If the land (or part of it) is described as a lot in an unregistered plan, each time in clause 27.6 becomes the later of the time and 35 days after creation of a separate folio for the lot.

27.9 The date for completion becomes the later of the date for completion and 14 days after *service* of the notice granting consent to transfer.

28 Unregistered plan

28.1 This clause applies only if some of the land is described as a lot in an unregistered plan.

28.2 The vendor must do everything reasonable to have the plan registered *within 6 months* after the contract date, with or without any minor alteration to the plan or any document to be lodged with the plan validly required or made under *legislation*.

28.3 If the plan is not registered *within* that time and in that manner –

28.3.1 the purchaser can *rescind*; and

28.3.2 the vendor can *rescind*, but only if the vendor has complied with clause 28.2 and with any *legislation* governing the rescission.

28.4 Either *party* can *serve* notice of the registration of the plan and every relevant lot and plan number.

28.5 The date for completion becomes the later of the date for completion and 21 days after *service* of the notice.

28.6 Clauses 28.2 and 28.3 apply to another plan that is to be registered before the plan is registered.

29 Conditional contract

29.1 This clause applies only if a provision says this contract or completion is conditional on an event.

29.2 If the time for the event to happen is not stated, the time is 42 days after the contract date.

29.3 If this contract says the provision is for the benefit of a *party*, then it benefits only that *party*.

29.4 If anything is necessary to make the event happen, each *party* must do whatever is reasonably necessary to cause the event to happen.

29.5 A *party* can *rescind* under this clause only if the *party* has substantially complied with clause 29.4.

29.6 If the event involves an approval and the approval is given subject to a condition that will substantially disadvantage a *party* who has the benefit of the provision, the *party* can *rescind within 7 days* after either *party* *serves* notice of the condition.

29.7 If the *parties* can lawfully complete without the event happening –

29.7.1 if the event does not happen *within* the time for it to happen, a *party* who has the benefit of the provision can *rescind within 7 days* after the end of that time;

29.7.2 if the event involves an approval and an application for the approval is refused, a *party* who has the benefit of the provision can *rescind within 7 days* after either *party* *serves* notice of the refusal; and

- 29.7.3 the date for completion becomes the later of the date for completion and 21 days after the earliest of –
- either *party* serving notice of the event happening;
 - every *party* who has the benefit of the provision serving notice waiving the provision; or
 - the end of the time for the event to happen.
- 29.8 If the *parties* cannot lawfully complete without the event happening –
- 29.8.1 if the event does not happen *within* the time for it to happen, either *party* can *rescind*;
- 29.8.2 if the event involves an approval and an application for the approval is refused, either *party* can *rescind*;
- 29.8.3 the date for completion becomes the later of the date for completion and 21 days after either *party* serves notice of the event happening.
- 29.9 A *party* cannot *rescind* under clauses 29.7 or 29.8 after the event happens.
- 30 Electronic transaction**
- 30.1 This *Conveyancing Transaction* is to be conducted as an *electronic transaction* if –
- 30.1.1 this contract says that it is an *electronic transaction*;
- 30.1.2 the *parties* otherwise agree that it is to be conducted as an *electronic transaction*; or
- 30.1.3 the *conveyancing rules* require it to be conducted as an *electronic transaction*.
- 30.2 However, this *Conveyancing Transaction* is not to be conducted as an *electronic transaction* –
- 30.2.1 if the land is not *electronically tradeable* or the transfer is not eligible to be lodged electronically; or
- 30.2.2 if, at any time after the *effective date*, but at least 14 days before the date for completion, a *party* serves a notice stating a valid reason why it cannot be conducted as an *electronic transaction*.
- 30.3 If, because of clause 30.2.2, this *Conveyancing Transaction* is not to be conducted as an *electronic transaction* –
- 30.3.1 each *party* must –
- bear equally any disbursements or fees; and
 - otherwise bear that *party's* own costs;
- incurred because this *Conveyancing Transaction* was to be conducted as an *electronic transaction*; and
- 30.3.2 if a *party* has paid all of a disbursement or fee which, by reason of this clause, is to be borne equally by the *parties*, that amount must be adjusted under clause 14.2.
- 30.4 If this *Conveyancing Transaction* is to be conducted as an *electronic transaction* –
- 30.4.1 to the extent that any other provision of this contract is inconsistent with this clause, the provisions of this clause prevail;
- 30.4.2 *normally*, words and phrases used in this clause 30 (italicised and in Title Case, such as *Electronic Workspace* and *Lodgment Case*) have the same meaning which they have in the *participation rules*;
- 30.4.3 the *parties* must conduct the *electronic transaction* –
- in accordance with the *participation rules* and the *ECNL*; and
 - using the nominated *ELN*, unless the *parties* otherwise agree;
- 30.4.4 a *party* must pay the fees and charges payable by that *party* to the *ELNO* and the *Land Registry* as a result of this transaction being an *electronic transaction*;
- 30.4.5 any communication from one *party* to another *party* in the *Electronic Workspace* made –
- after the *effective date*; and
 - before the receipt of a notice given under clause 30.2.2;
- is taken to have been received by that *party* at the time determined by s13A of the *Electronic Transactions Act 2000*; and
- 30.4.6 a document which is an *electronic document* is served as soon as it is first *Digitally Signed* in the *Electronic Workspace* on behalf of the *party* required to serve it.
- 30.5 *Normally*, the vendor must *within 7 days of the effective date* –
- 30.5.1 create an *Electronic Workspace*;
- 30.5.2 populate the *Electronic Workspace* with *title data*, the date for completion and, if applicable, mortgagee details; and
- 30.5.3 invite the purchaser and any *discharging mortgagee* to the *Electronic Workspace*.
- 30.6 If the vendor has not created an *Electronic Workspace* in accordance with clause 30.5, the purchaser may create an *Electronic Workspace*. If the purchaser creates the *Electronic Workspace* the purchaser must –
- 30.6.1 populate the *Electronic Workspace* with *title data*;
- 30.6.2 create and populate an *electronic transfer*;
- 30.6.3 populate the *Electronic Workspace* with the date for completion and a nominated *completion time*; and
- 30.6.4 invite the vendor and any *incoming mortgagee* to join the *Electronic Workspace*.
- 30.7 *Normally*, *within 7 days* of receiving an invitation from the vendor to join the *Electronic Workspace*, the purchaser must –
- 30.7.1 join the *Electronic Workspace*;
- 30.7.2 create and populate an *electronic transfer*;
- 30.7.3 invite any *incoming mortgagee* to join the *Electronic Workspace*; and
- 30.7.4 populate the *Electronic Workspace* with a nominated *completion time*.

- 30.8 If the purchaser has created the *Electronic Workspace* the vendor must *within* 7 days of being invited to the *Electronic Workspace* –
- 30.8.1 join the *Electronic Workspace*;
 - 30.8.2 *populate* the *Electronic Workspace* with *mortgagee details*, if applicable; and
 - 30.8.3 invite any *discharging mortgagee* to join the *Electronic Workspace*.
- 30.9 To complete the financial settlement schedule in the *Electronic Workspace* –
- 30.9.1 the purchaser must provide the vendor with *adjustment figures* at least 2 *business days* before the date for completion;
 - 30.9.2 the vendor must confirm the *adjustment figures* at least 1 *business day* before the date for completion; and
 - 30.9.3 if the purchaser must make a *GSTRW payment* or an *FRCGW remittance*, the purchaser must *populate* the *Electronic Workspace* with the payment details for the *GSTRW payment* or *FRCGW remittance* payable to the Deputy Commissioner of Taxation at least 2 *business days* before the date for completion.
- 30.10 Before completion, the *parties* must ensure that –
- 30.10.1 all *electronic documents* which a *party* must *Digitally Sign* to complete the *electronic transaction* are *populated* and *Digitally Signed*;
 - 30.10.2 all certifications required by the *ECNL* are properly given; and
 - 30.10.3 they do everything else in the *Electronic Workspace* which that *party* must do to enable the *electronic transaction* to proceed to completion.
- 30.11 If completion takes place in the *Electronic Workspace* –
- 30.11.1 payment electronically on completion of the price in accordance with clause 16.7 is taken to be payment by a single *settlement cheque*;
 - 30.11.2 the completion address in clause 16.11 is the *Electronic Workspace*; and
 - 30.11.3 clauses 13.13.2 to 13.13.4, 16.8, 16.12, 16.13 and 31.2.2 to 31.2.4 do not apply.
- 30.12 If the computer systems of any of the *Land Registry*, the *ELNO* or the Reserve Bank of Australia are inoperative for any reason at the *completion time* agreed by the *parties*, a failure to complete this contract for that reason is not a default under this contract on the part of either *party*.
- 30.13 If the computer systems of the *Land Registry* are inoperative for any reason at the *completion time* agreed by the *parties*, and the *parties* choose that financial settlement is to occur despite this, then on financial settlement occurring –
- 30.13.1 all *electronic documents Digitally Signed* by the vendor, the *certificate of title* and any discharge of mortgage, withdrawal of caveat or other *electronic document* forming part of the *Lodgment Case* for the *electronic transaction* shall be taken to have been unconditionally and irrevocably delivered to the purchaser or the purchaser's mortgagee at the time of financial settlement together with the right to deal with the land comprised in the *certificate of title*; and
 - 30.13.2 the vendor shall be taken to have no legal or equitable interest in the *property*.
- 30.14 A *party* who holds a *certificate of title* must act in accordance with any *Prescribed Requirement* in relation to the *certificate of title* but if there is no *Prescribed Requirement*, the vendor must serve the *certificate of title* after completion.
- 30.15 If the *parties* do not agree about the delivery before completion of one or more documents or things that cannot be delivered through the *Electronic Workspace*, the *party* required to deliver the documents or things –
- 30.15.1 holds them on completion in escrow for the benefit of; and
 - 30.15.2 must immediately after completion deliver the documents or things to, or as directed by; the *party* entitled to them.
- 30.16 In this clause 30, these terms (in any form) mean –
- | | |
|------------------------------|---|
| <i>adjustment figures</i> | details of the adjustments to be made to the price under clause 14; |
| <i>certificate of title</i> | the paper duplicate of the folio of the register for the land which exists immediately prior to completion and, if more than one, refers to each such paper duplicate; |
| <i>completion time</i> | the time of day on the date for completion when the <i>electronic transaction</i> is to be settled; |
| <i>conveyancing rules</i> | the rules made under s12E of the Real Property Act 1900; |
| <i>discharging mortgagee</i> | any discharging mortgagee, chargee, covenant chargee or caveator whose provision of a <i>Digitally Signed</i> discharge of mortgage, discharge of charge or withdrawal of caveat is required in order for unencumbered title to the <i>property</i> to be transferred to the purchaser; |
| <i>ECNL</i> | the Electronic Conveyancing National Law (NSW); |
| <i>effective date</i> | the date on which the <i>Conveyancing Transaction</i> is agreed to be an <i>electronic transaction</i> under clause 30.1.2 or, if clauses 30.1.1 or 30.1.3 apply, the contract date; |
| <i>electronic document</i> | a dealing as defined in the Real Property Act 1900 which may be created and <i>Digitally Signed</i> in an <i>Electronic Workspace</i> ; |
| <i>electronic transfer</i> | a transfer of land under the Real Property Act 1900 for the <i>property</i> to be prepared and <i>Digitally Signed</i> in the <i>Electronic Workspace</i> established for the purposes of the <i>parties'</i> <i>Conveyancing Transaction</i> ; |

<i>electronic transaction</i>	a <i>Conveyancing Transaction</i> to be conducted for the <i>parties</i> by their legal representatives as <i>Subscribers</i> using an <i>ELN</i> and in accordance with the <i>ECNL</i> and the <i>participation rules</i> ;
<i>electronically tradeable</i>	a land title that is Electronically Tradeable as that term is defined in the <i>conveyancing rules</i> ;
<i>incoming mortgagee</i>	any mortgagee who is to provide finance to the purchaser on the security of the <i>property</i> and to enable the purchaser to pay the whole or part of the price;
<i>mortgagee details</i>	the details which a <i>party</i> to the <i>electronic transaction</i> must provide about any <i>discharging mortgagee</i> of the <i>property</i> as at completion;
<i>participation rules</i>	the participation rules as determined by the <i>ECNL</i> ;
<i>populate</i>	to complete data fields in the <i>Electronic Workspace</i> ; and
<i>title data</i>	the details of the title to the <i>property</i> made available to the <i>Electronic Workspace</i> by the <i>Land Registry</i> .

31 Foreign Resident Capital Gains Withholding

- 31.1 This clause applies only if –
- 31.1.1 the sale is not an excluded transaction within the meaning of s14-215 of Schedule 1 to the *TA Act*; and
- 31.1.2 a *clearance certificate* in respect of every vendor is not attached to this contract.
- 31.2 The purchaser must –
- 31.2.1 at least 5 days before the date for completion, serve evidence of submission of a purchaser payment notification to the Australian Taxation Office by the purchaser or, if a direction under clause 4.3 has been *served*, by the transferee named in the transfer *served* with that direction;
- 31.2.2 produce on completion a *settlement cheque* for the *FRCGW remittance* payable to the Deputy Commissioner of Taxation;
- 31.2.3 forward the *settlement cheque* to the payee immediately after completion; and
- 31.2.4 serve evidence of receipt of payment of the *FRCGW remittance*.
- 31.3 The vendor cannot refuse to complete if the purchaser complies with clauses 31.2.1 and 31.2.2.
- 31.4 If the vendor *serves* any *clearance certificate* or *variation*, the purchaser does not have to complete earlier than 7 days after that *service* and clause 21.3 does not apply to this provision.
- 31.5 If the vendor *serves* in respect of every vendor either a *clearance certificate* or a *variation* to 0.00 percent, clauses 31.2 and 31.3 do not apply.

32 Residential off the plan contract

- 32.1 This clause applies if this contract is an off the plan contract within the meaning of Division 10 of Part 4 of the *Conveyancing Act 1919* (the *Division*).
- 32.2 No provision of this contract has the effect of excluding, modifying or restricting the operation of the *Division*.
- 32.3 If the purchaser makes a claim for compensation under the terms prescribed by clause 6A of the *Conveyancing (Sale of Land) Regulation 2017* –
- 32.3.1 the purchaser cannot make a claim under this contract about the same subject matter, including a claim under clauses 6 or 7; and
- 32.3.2 the claim for compensation is not a claim under this contract.
- 32.4 This clause does not apply to a contract made before the commencement of the amendments to the *Division* under the *Conveyancing Legislation Amendment Act 2018*.

1 Real Estate Agents

The Purchaser was not introduced to the property or the Vendor by any real estate agent or other person entitled to claim commission as a result of this sale (other than the vendors agent, if any, specified in this contract). The Purchaser will indemnify the Vendor against any claim for commission by any real estate agent or other person arising out of an introduction of the Purchaser and against all claims and expenses for the defence and determination of such a claim made against the Vendor. This right continues after completion

2 Notice to complete

- 2.1 Despite any rule of law or equity to the contrary, the Vendor and the Purchaser agree that any notice to complete under this contract will be reasonable as to time if a period of 14 days from the date of service of the notice is allowed for completion.
- 2.2 In the event that the Vendor issues a notice to complete pursuant to 2.1 then the Purchaser agrees to pay the sum of \$300.00 plus GST to the Vendor's solicitor on completion to reimburse the Vendor for the cost of issuing the notice to recover any other damages.
- 2.3 In the event that the vendor issues a notice to complete and such notice to complete requires settlement after 31 December, regardless of whether the Contract provides for land tax adjustment, the purchaser will pay on settlement in addition to the purchase price Land Tax adjusted on a daily basis for the year in which the matter settles.

3 Condition of property

The Purchaser accepts the property in its present condition and state of repair with all faults latent and patent subject to fair wear and tear as provided in clause 10.1.4 and the Purchaser cannot make a claim or requisition or rescind or terminate in this regard.

The purchaser accepts the improvements on the land in their location and condition at the date of the contract and agrees not to make any objection, requisition or claim for compensation in relation to any of the following:

- (a) The location and/or condition of the improvements;
- (b) Evidence of approvals in relation to the improvements;
- (c) Any encroachment by the improvements on adjoining land.

The vendor shall not be required to provide to the purchaser any information or documentation referred to in any written notice, letter or demand received by the purchaser from any relevant authority issued after the date of the contract and as a result of any application by the purchaser for a building certificate or any other certificate or enquiry in relation to the property.

For the purposes of this special condition the term "improvements" includes but is not limited to all manmade structures on the land including dwellings, outbuildings, swimming pools, fences and walls.

4 Capacity

Without in any way limiting, negating or restricting any rights or remedies which would have been available to either party at law or in equity had this clause not been included, if either party (and if more than one person comprises that first party then any one of them) prior to completion:

- 4.1 dies or becomes mentally ill, then the other party may rescind this contract by written notice to the first party's conveyancer and thereupon this contract will be at an end and the provisions of clause 19 apply; or
- 4.2 Being a company, has a summons or application for its winding up presented or has a liquidator, receiver or voluntary administrator of it appointed, or enters into any deed of company arrangement or scheme of arrangement with its creditors, then the first party will be in default under this contract.

5 Late completion

Provided that the Vendor is ready, willing and able to give title to the Purchaser, if this contract is not completed for any reason (other than the Vendor's default) on or before the completion date then in addition to any other right which the Vendor may have under this contract or otherwise the Purchaser will on completion of this contract pay to the Vendor interest on the balance of the purchase price at the rate of 10% per annum calculated on daily balances, commencing on the completion date and continuing until completion of this contract. This interest is a genuine pre-estimate of liquidated damages and will be deemed to be part of the balance of purchase money due and payable on completion.

6 GST

The Purchaser warrants that the property will be used predominately for residential accommodation. The Purchaser will indemnify the Vendor against any liability to pay GST arising from breach of this warranty. This right continues after completion.

7 Claims by the Purchaser

- 7.1 Notwithstanding the provisions of clauses 6 and 7 hereof, the parties expressly agree that any claim for compensation shall be deemed to be an objection or requisition for the purpose of clauses 7 and 8 hereto entitling the Vendor to rescind this contract.

8 Deposit Bond

In the event of the Vendor accepting the payment of the deposit by way of a bond, the following shall apply;

- (i) The expression "Bond" in this contract means a Deposit Guarantee Bond issued to the Vendor at the request of the Purchaser by a Guarantor (either named in this contract or otherwise agreed between the Vendor and the Purchaser).
- (ii) The delivery to the Vendor's Solicitor of a Bond which binds the Guarantor to the Vendor shall, subject to (a) and (b) of this sub-clause be deemed for the purposes of this contract to be payment of the guaranteed amount at the time of such delivery on account of the deposit to the person or persons nominated in the contract to receive the deposit, and the following provisions shall apply: -
 - (a) On completion of this Contract or at such other time as may be provided for the deposit to be accounted for to the Vendor, the Purchaser shall pay the amount stipulated in the Bond to the Vendor in cash or by unendorsed bank cheque; or
 - (b) If the Vendor serves on the Purchaser a notice in writing claiming to forfeit the deposit, then such service shall operate as a demand upon the Purchaser for payment forthwith of the deposit (or so much thereof as has not been paid) and upon failure of the Purchaser to pay the same within two (2) clear business days of service of such notice the Vendor shall be entitled to demand payment from the Guarantor in accordance with the provisions of the Bond, and the provisions of this Contract in relation to the deposit shall then apply as though this Contract had just been made and required payment of the deposit within two (2) clear business days of demand on the Guarantor.

9 Requisitions on Title

- 9.1 The Purchaser agrees that the only form of general Requisitions on the title the Purchaser may make pursuant to Clause 5 of the contract shall be in the form annexed hereto.
- 9.2 The Purchaser acknowledge that these Requisitions on title must be served on the Vendor in accordance with Clause 5 of the contract.

10 NOT USED.

- 11 Notwithstanding any other provision in this Contract for Sale, in the event that the title is Limited Title but not Qualified Title, the Vendor shall be under no obligation to provide to the Purchaser any Abstract of Title or Old System Documents in relation to the subject property.

12 Deposit

- 12.1 If the deposit is to be paid by instalments then the following applies:

Notwithstanding what might be stated to be the deposit on the front page of the Contract, the deposit is 10% of the price and it is to be paid as follows:

- (i) \$ to be paid on exchange;
- (ii) \$ is to be paid on or before the expiry of the cooling off period;
- (iii) The remaining balance of the ten percent (10%) on the first to occur of:
 - (a) Completion of this Contract; and
 - (b) The date upon which the Vendor terminates this Contract due to default by the Purchaser.

The Purchaser acknowledges that notwithstanding any correspondence issued from any person (including the agent or a representative of the agent) the deposit payable pursuant to this Contract is equivalent to 10% of the purchase price.

13. General Warranties

- 13.1 The provisions set out in this contract contain the entire agreement between the parties as at the date of this Contract notwithstanding and negotiations or discussions held, or any documents signed or brochures produced prior to the date of this contract.
- 13.2 The Purchaser agrees that in entering this Contract the Purchaser is relying upon his own enquiries relating to and inspection of the property.
- 13.3 The Purchaser agrees that in entering this Contract the Purchaser has not relied upon any conduct, warranty or representation made by or on behalf of the Vendor except those that are expressly provided in this Contract.
- 13.4 The Purchaser agrees that neither the Vendor nor any person on behalf of the Vendor, has made any representation or warranty upon which the Purchaser relies as to the fitness or suitability for any particular purpose of the property or of any financial return or income to be derived from the property.
- 14. The Vendor does not warrant that any swimming pool (including any swimming pool fencing) on the property complies with the requirements imposed by the Swimming Pools Act 1992 and the Regulations prescribed under that Act or any other Act or Regulations relating to swimming pools all of which are referred to as the "Swimming Pool Legislation".

The Purchaser shall not be entitled to make any objection, requisition or claim for compensation should it be established that the swimming pool and swimming pool fencing does not comply with the provision of the Swimming Pool Legislation.

Clause 11.1 of the Contract is amended to the extent that it is the Purchaser who shall comply with any Notice or Order made by the Local Council or other Statutory Authority relating the swimming pool and swimming pool fencing whether or not such Notice was given or Order was made prior to the date hereof.

15. The vendor and the purchaser agree that the clauses of the printed form of Contract are amended as follows:

15.1 Clause 7.1.1 – delete “5%” and insert “1%”.

15.2 Clause 18 is amended by adding the following clause 18.8: “The purchaser cannot make a claim or requisition or delay settlement after entering into possession of the property.”

15.3 Clause 23.9.1 shall be deleted.

15.4 Clause 23.13 – delete “7” and replace with “3”.

16. Electronic Exchange

The parties acknowledge and agree that the execution of this Contract by the parties may be effected by the use of either facsimile or photocopies signatures (hereinafter called “the manner of the parties execution of the Contract”).

The parties agree that they shall not make any requisition, objection or claim (whether for compensation or not), nor claim any right to terminate or rescind this Contract, or delay the completion of this Contract due to the manner of the parties execution of the Contract.

The purchaser agrees to provide to the vendors legal representative a counterpart of this Contract containing the original signatures of the parties (hereinafter called “the further counterpart of the Contract”) within ten (10) days after the date of this Contract.

The parties further acknowledge and agree that the further counterpart of the Contract shall bear the date of this Contract (hereinafter called “the date of the further counterpart of the Contract”).

The parties further agree that they shall not make any requisition, objection or claim (whether for compensation or not), nor claim any right to terminate or rescind this Contract, or delay the completion of this Contract due to the date of the further counterpart of the Contract.

17. Contract Alterations

The parties authorise their respective legal representatives to make alterations to this contract (including any attachments hereto) after execution by a party. Such alterations will be binding on the party as if the alterations were made prior to execution by that party.

18. Directors Guarantees

If the purchaser is a Company, the officers or persons who sign this Contract on behalf of the company or who attests the Seal of the company on this Contract;

- a. Jointly and separately guarantees all obligations of the purchaser under this Agreement including the payment of the purchase price; and
- b. Jointly and separately indemnifies the vendor's in respect of any default of the purchaser under this Agreement; and

This guarantee and indemnity is given by each guarantor as principal and is not discharged or released by any release or variation of this Agreement between the vendors and the purchaser.

19. The purchaser acknowledges that if there is currently a tenant in the property and this Contract requires vacant possession, in order for vacant possession of the property to be delivered to the purchaser, the vendor is required to give the tenant, in writing, 30 days notice that the tenant is required to vacate the property (“the Notice”). The vendor agrees to cause the real estate agent to serve the Notice on the tenant. In the event the tenant does not vacate the property within the 30 day period specified in the Notice, the Completion date is extended by a reasonable period of time to allow the vendor to deliver vacant possession of the property.

20. The parties acknowledge and agree that where the property is within the area serviced by Hunter Water Corporation (HWC), HWC does not make Sewer Lines Location Diagram available in the ordinary course of administration.

21. Parties Acceptance of executed by DocuSign

If either party elects to sign the Contract using DocuSign then the following provisions take effect:

21.1 The parties and their legal representative agree to accept a DocuSigned counterpart Contract for the purposes of exchange and settlement. The parties agree that their legal representative has no obligation to provide an original wet signed counterpart contract.

21.2 The parties and their legal representative have no obligation to provide an original wet signature counterpart Contract.

21.3 The parties agree that a Contract signed by DocuSign is legally binding on the party who signed via DocuSign as if the party had signed in original format.

21.4 The other party will not make any claim, rescind, terminate or delay settlement for any matter raised within this condition.

Sale subject to Finance

THIS CLAUSE FORMS PART OF THE CONTRACT FOR SALE OF LAND

Finance

- (a) It is a condition of this agreement that the Purchaser shall obtain approval of finance from a bank or financial institution for the purchase of the property in accordance with this clause and the Finance Schedule.
- (b) The Purchaser shall promptly, at the Purchaser's expense:
 - (i) apply for finance in accordance with the Finance Schedule within 24 hours of the date of this Contract;
 - (ii) make and pursue the finance application, pay all fees, supply all particulars, certificates and valuations and do all other things as may be reasonably required for the purpose of the application; and
 - (iii) inform the vendors regarding the progress of the finance application whenever reasonably requested to do so by or on behalf of the Vendor and provide such evidence in support as requested by the Vendor.
- (c) This clause is for the benefit of the Purchaser who may, prior to rescission of this Contract, waive the benefit thereof.
- (d) Should the purchaser fail to exercise their right of rescission by 5pm on the last day of the time limited in the Finance Schedule then this Contract will be deemed to be unconditional.
- (e) If without default on the part of the Purchaser the finance approval in writing has not been obtained in accordance with this clause within the time limited in the Schedule either party shall be entitled by notice served upon the other to rescind this Contract provided that if the Purchaser has obtained the finance approval in writing prior to service of such notice of rescission by either party, neither party shall thereafter be entitled to rescind this Contract for want of such approval.
- (f) Upon rescission pursuant to this clause the provisions of clause 19 shall apply except that the Vendor shall be entitled to an amount of 0.25% of the purchase price (which may at the option of the Vendor, be paid from the deposit) towards the Vendor's legal costs and disbursements.
- (g) Should the schedule below not be completed this clause does not apply.

FINANCE SCHEDULE

Lender:

Amount of Loan: \$

Security: Registered first mortgage over the land described as "land" in this Contract.

Time Limits: Number of days after the making of this Contract for obtaining written approval of finance is seven (7) days.



Evans & Wislang

SOLICITORS & CONVEYANCERS

PO BOX 93
KOTARA NSW 2289

SUITE 6, LEVEL 2, 10 BRADFORD CL
KOTARA NSW 2289

RE: Solomon & Sanders Proposed Sale

PROPERTY: 234 Newcastle Road, Jesmond

1.	In these requisitions "property" means land together with improvements and fixtures, "land" means land without improvements and fixtures, "improvements" means improvements and fixtures.
2.	When the transaction between our clients is a mortgage, these requisitions should apply by substituting "mortgagor" for "Vendor" and "mortgagee" for "Purchaser".
3.	The replies provided will be regarded as remaining correct and applicable up to the date of the completion of the transaction between our respective clients. If you become aware before completion that any of these replies are inaccurate, you will undertake to inform us of that fact before completion and to furnish in writing the reply considered by you to be appropriate.
4.	At the time of completion the Vendor is to be seised or registered as proprietor in fee simple free from all covenants, encumbrances and caveats except that all mortgages and charges (if any) to be discharged at or prior to completion.
5.	Rates, taxes and similar periodical payments are to be paid at the time of completion and apportionment made.
6.	If the Contract so provides vacant possession is to be given on completion, otherwise notices to Tenants under the Tenant and Landlord Act are to be handed over on completion.
7.	Searches, survey and inspections must result satisfactorily.
8.	If the land is under the Real Property Act, Section 57 of the Conveyancing Act must be complied with otherwise subsection 2(e) of Section 53 of the Conveyancing Act must be complied with and all deeds and documents relating solely to the subject land handed over on settlement.
9.	<p>Has the Vendor notice or is he aware of:</p> <ul style="list-style-type: none">a. Any resumption of compulsory acquisitions affecting the land or of any proposal to do so;b. Any liability or order under the Dividing Fences Act 1991 or any notice to or by the Vendor thereunder or application pending in respect thereof;c. Any requirements of or work performed or being performed or proposed by any Local Government, Water & Sewerage, Public Health, Pastures Protection Board or other component authority which would involve the performance of work or the expenditure of money in connection with the land sold;d. Any prohibition of or restrictions as to the use of the land by virtue of closing order statute, proclamation or otherwise;e. Any statutory charge or sum of money recoverable from the owner for the time being of the land (eg, for curbing and guttering);f. The proposed performance of any work or works which would give rise to any such charge of sum of money as is referred to in paragraph (e);g. Any easement, drain, profit, encumbrance or legal charge affecting the subject land and not disclosed by the Certificate or Abstract of Title;h. Any restrictive covenants affecting the subject land and not disclosed by the Certificate of Abstract of Title;i. Any Mining Authority or Mining Lease or application therefore affecting the subject land;j. Any realignment of the street to which the subject land has frontage;k. Any pending suit reacting to the title of the subject land or other claim adverse to that of the Vendor;l. Anything in the nature of a nuisance affecting the subject land;m. The land being affected by Section 40 of the Housing Act;n. Any adverse possession or occupation of the land or any part thereof;o. Any encroachments by or upon the subject land;p. Any notice or requirement of any statutory or public authority affecting the land or improvements thereon which have not been complied with.
10.	a. Is the Vendor liable to render a return for State Land Tax purpose? If so, has the last return

	due been rendered?
	b. Is the Vendor liable to pay State Land Tax? If so, has tax been assessed and paid in respect of land held at 31 December last?
11.	Is the Vendor under any disability by reason of infancy, bankruptcy or otherwise howsoever.
12.	When and where may the title deeds be inspected?
13.	Has the Vendor (1) a survey certificate and/or (2) Building Certificate that he will hand over on loan pending completion.
14.	Is the Vendor aware of any latent defect in the subject land which prevents or diminishes reasonable use thereof and in particular whether any covered drain sewer or water channel intersects the subject land?
15.	Has any relevant Plan of Subdivision been approved and registered?
16.	Is the Vendor aware of any agreement with or conditions imposed by any town or county planning authority providing for a building to be demolished wholly or partly without compensation or providing for restricted compensation for injury caused by any town or county planning scheme or in any way affecting the land or any improvements thereon or the user thereof?
17.	Are there any outstanding liabilities to the Water and Sewerage authority for sewerage connections or similar work?
18.	Are the water, sewerage, drainage and gas connections wholly within the boundaries of the subject land? If not, appropriate assignable rights to retain same in their existing position must be evidenced and assigned to the Purchaser.
19.	Are there any continuing breaches of Water and Sewerage By-laws (eg discharge of roof water into sewer) or of the Local Government Building Ordinances?
20.	Has the Vendor cause to be made, or is he aware, of any connections or installations, including water, sewerage, drainage, gas or electricity without the consent of the relevant authorities where such consent is required?
21.	<p>a. Does the property lie within a Mine Subsidence District under the provisions of the Mines Subsidence Compensation Act, 1961?</p> <p>b. Does the property form part of a subdivision of land with a Mine Subsidence District affected since 1 July 1961?</p> <p>c. Does the property form part of a subdivision of land affected prior to 1 July 1961, within a district proclaimed under the Mines Subsidence Act?</p> <p>d. If the property lies within a Mines Subsidence District have any improvements (whether or not requiring the consent of the Local Council) been erected since 1 July 1961?</p> <p>e. If the answer to b, c and/or d is in the affirmative we must be satisfied that the approval of the Mine Subsidence Board was obtained and that the owner complied with any conditions or requirements imposed by the Board or the relative Act.</p> <p>f. <ol style="list-style-type: none"> Was a conditional right to insure improvements erected prior to 1 July 1961, granted by the Mines Subsidence Board? If so, has the owner or his predecessor in title complied with the conditions imposed by the Board? </p> <p>g. Is the Vendor aware of any claim in respect of the subject property having been made under the Mine Subsidence Compensation Act, 1961?</p>
22.	Are there any goods, fittings or fixtures which are attached to the subject land sold which are subject to any hire purchase agreement, or not owned by the Vendor for any other reason?
23.	Is any wall a party wall? If so, the benefit of any agreement relating thereto must be assigned to the Purchaser.
24.	Was the dwelling built within the last seven (7) years, or have there been additions or alterations to the property within that time?
25.	Does the Vendor consider himself entitled to remove any of the fittings and fixtures in and about the property including stoves, copper, light fittings, shades, globes, fly-proof doors or windows, clothes lines, TV antenna or similar fittings?
26.	<p>If the subject property includes a swimming pool:</p> <p>a. Was its construction commenced before or after 1 August 1992?</p> <p>b. Has the construction of the swimming pool been approved under the Local Government Act 1919? If so, please supply details of such approval.</p> <p>c. Are the access requirements specified in the Swimming Pools Act, 1992 and the Regulations under such Act complied with in respect of the swimming pool?</p> <p>d. Is any safety fence of the swimming pool (under the Swimming Pools Act, 1992 and Regulations) also (in whole or in part) a dividing fence of the property under the Dividing Fences Act 1991?</p> <p>e. Has the Vendor a certificate under Section 30 of the Swimming Pools Act, 1992 in respect of the swimming pool that he will and over on loan pending completion?</p>

27	.a.	Was the property the subject of a registered Lease under Section 5A of the Landlord and Tenant (Amendment) Act, 1948 as at 1 January 1969?
	b.	What are the nature and extent of the rights of the person(s) in possession of the subject property?
	c.	If the Vendor asserts possession by the tenant then the following must be answered:
	I.	Who is the tenant and what are the rental and the terms of the tenancy?
	II.	If the premises comprise a residence or if a residence is the subject of a separate tenancy, has any "wealthy tenant" procedure been commenced against the tenant?
	III.	Who resides with the name tenant in the subject premises (particulars of relationship and age are to be given if known).
	IV.	Will the Vendor hand over his last Valuer General Valuation of the subject property?
	V.	Any 17A agreement relevant to the tenancy should be handed over on completion.
	VI.	Is the property affected by any order of or applicable to the Fair Rents Board? If so, give dates and details.
	VII.	What was the rent payable on 1 January 1969?
28.		Particulars of tenancies (including date of commencement) to be handed over and original handed over on settlement.
29.		Is the Vendor aware of any defects in any retaining walls.
30.		Has any order or any application for an order been made under the Trees (Disputes Between Neighbours) Act 2006 which requires work to be carried out in relation to any tree on the property?



LAND
REGISTRY
SERVICES

Title Search



NEW SOUTH WALES LAND REGISTRY SERVICES - TITLE SEARCH

FOLIO: 2/503329

SEARCH DATE	TIME	EDITION NO	DATE
-----	----	-----	----
30/7/2021	2:15 PM	3	30/10/2017

NO CERTIFICATE OF TITLE HAS ISSUED FOR THE CURRENT EDITION OF THIS FOLIO.
CONTROL OF THE RIGHT TO DEAL IS HELD BY WESTPAC BANKING CORPORATION.

LAND

LOT 2 IN DEPOSITED PLAN 503329
AT JESMOND
LOCAL GOVERNMENT AREA NEWCASTLE
PARISH OF NEWCASTLE COUNTY OF NORTHUMBERLAND
TITLE DIAGRAM DP503329

FIRST SCHEDULE

SHARNA MARIE SANDERS
SCOTT WILLIAM SOLOMON
AS JOINT TENANTS (T AM843983)

SECOND SCHEDULE (6 NOTIFICATIONS)

- 1 LAND EXCLUDES MINERALS AND IS SUBJECT TO RESERVATIONS AND
CONDITIONS IN FAVOUR OF THE CROWN - SEE CROWN GRANT(S)
- 2 K29986 EASEMENT FOR DRAINAGE AFFECTING THE PART(S) SHOWN
SO BURDENED IN THE TITLE DIAGRAM
- 3 G11308 COVENANT
- 4 M12755 EASEMENT FOR STORMWATER CHANNEL AFFECTING PART OF
THE LAND WITHIN DESCRIBED SHOWN AS EASEMENT 15' WIDE
FOR STORMWATER CHANNEL IN DP537437
- 5 LAND EXCLUDES MINERALS (S.141 PUBLIC WORKS ACT, 1912)
- 6 AM843984 MORTGAGE TO WESTPAC BANKING CORPORATION

NOTATIONS

UNREGISTERED DEALINGS: NIL

*** END OF SEARCH ***

43260

PRINTED ON 30/7/2021

* Any entries preceded by an asterisk do not appear on the current edition of the Certificate of Title. Warning: the information appearing under notations has not been formally recorded in the Register. InfoTrack an approved NSW Information Broker hereby certifies that the information contained in this document has been provided electronically by the Registrar General in accordance with Section 96B(2) of the Real Property Act 1900.

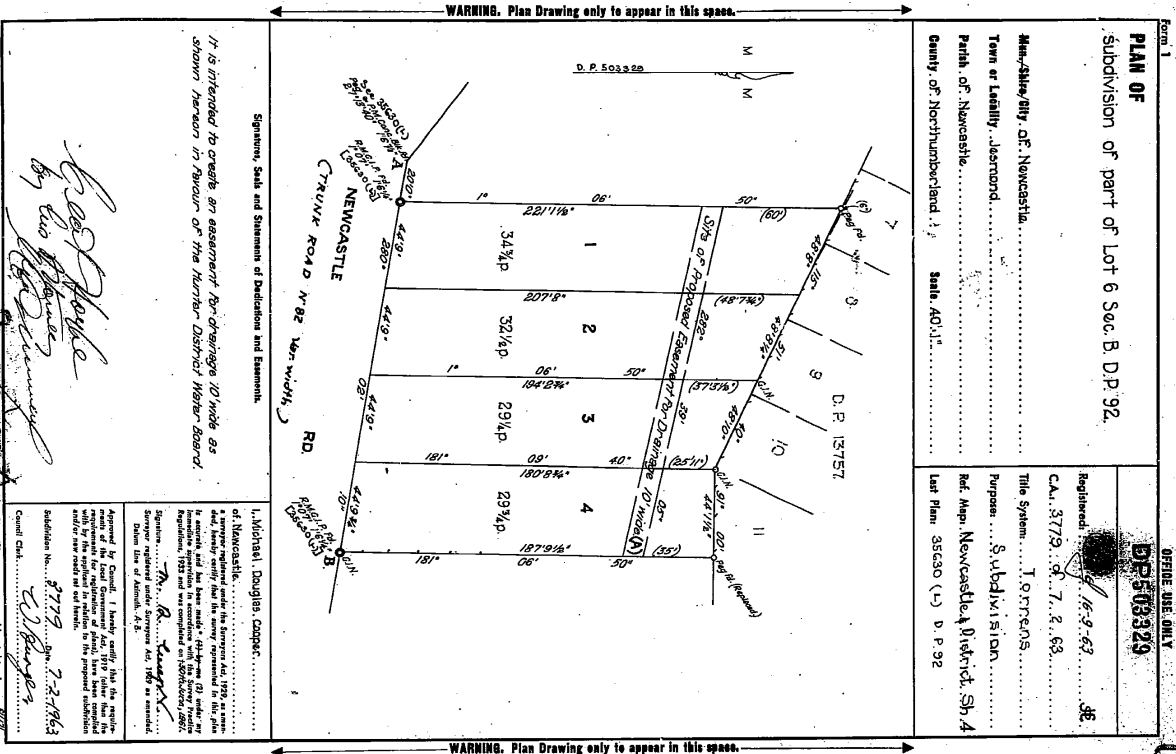
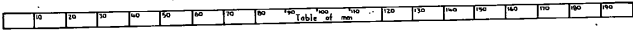

CONVERSION TABLE ADDED IN REGISTRAR GENERAL'S DEPARTMENT		
DP 503329		
FEET INCHES	METRES	
- 6 1/4	0.152	
1 6 1/4	0.464	
1 7/8	0.419	
5 6	1.372	
5 11	1.603	
10 -	3.048	
20 -	6.096	
30 -	7.620	
32 11	7.899	
37 3	10.458	
37 3 1/2	10.367	
44 1 1/2	13.449	
44 9 3/4	13.640	
44 9 3/4	13.659	
48 7 3/4	14.827	
48 13 3/4	14.833	
48 8 1/4	14.840	
48 10	14.604	
60 -	18.288	
80 8 3/4	24.506	
180 8 3/4	52.086	
180 9 3/4	52.086	
154 2 3/4	59.420	
207 8 3/4	63.297	
221 1 1/2	67.399	
AC RD P		
- 29 1/4	739.6	
- 29 3/4	752.5	
- 32 1/2	852	
- 34 3/4	878.9	
SM H		

THIS FORM MAY BE USED WHERE NEW RESTRICTIVE COVENANTS ARE IMPOSED OR EASEMENTS CREATED OR WHERE THE SIMPLE TRANSFER FORM IS UNSUITABLE.

Fees:— £ a d
 Lodgment : :
 Endorsement : :
 4/10 : :
 12:05 : :
 25.6.67

R.P. 13A. No. **K 29986**

New South Wales

MEMORANDUM OF TRANSFER

(REAL PROPERTY ACT, 1900.)



I, RONALD PETERSEN of 58 Moate Street, Georgetown
Boilermaker and DIANNE PETERSEN his wife

(herein called transferor)

being registered as the proprietor of an estate in fee simple in the land hereinafter described, subject, however, to such encumbrances, liens and interests as are notified hereunder, in consideration of

TEN SHILLINGS

(£ 0. 10. 0.) (the receipt whereof is hereby acknowledged) paid to us by

THE HUNTER DISTRICT WATER BOARD

and grant
 do hereby transfer/to

(Trusts must not be disclosed in the transfer.)

Typing or handwriting in this instrument should not extend into any margin. Handwriting should be clear and legible and in permanent black non-copying ink.

If a less estate, strike out "in fee simple" and interline the required alteration.

Show in BLOCK LETTERS the full name, postal address and description of the persons taking, and if more than one, whether they hold as joint tenants or tenants in common.

The description may refer to the defined residue of the land in a certificate or grant (e.g. "And being residue after transfer number ") or may refer to parcels shown in Town or Parish Maps issued by the Department of Lands or shown in plans filed in the Office of the Registrar General (e.g. "and being Lot section D.P. ").

Unless authorised by Reg. 63 Conveyancing Act, Regulations, 1961 a plan may not be annexed to or endorsed on this transfer form.

THE HUNTER DISTRICT WATER BOARD a body corporate
by act of the legislature of the State of New South
Wales and having its office at Hunter Street, Newcastle
 (herein called transferee)

out of ALL such our Estate and Interest in ALL THE land mentioned in the schedule following:—

County,	Parish,	Reference to Title.			Description of Land (if part only).
		Whole or Part.	Vol.	Fol.	
NORTHUMBERLAND	NEWCASTLE	WHOLE	9528	171	

2nd Edition
Al/De Stand 11/6

de And the transferee covenant(s) with the transferor^d

FULL AND FREE right title liberty and licence for the transferee
its successors and assigns TO CONSTRUCT lay maintain repair renew
cleanse inspect replace and divert or alter the position of a
stormwater drain or channel with the apparatus and appurtenances
thereof on or over and in or under the surface of such part of
the land described hereinbefore as is delineated in Deposited
Plan No. 503329 and therein marked "Site of proposed Easement for
drainage 10' wide" and TO CARRY AND CONVEY rain storm and surface
water through the said stormwater drain or channel and for the
purposes aforesaid or any of them by its officers servants and/
or contractors with or without motor or other vehicles horses
or other animals plant and machinery to enter upon and break
open the surface of the said strip of land so shown as aforesaid
and to deposit soil temporarily on the lands but subject to a
liability to replace the soil and to restore surface of the said
lands in a proper and workmanlike manner as soon as the operations
are completed AND IT IS HEREBY DECLARED that the said Easement is
intended to be an easement in gross under Section 88A of the
Conveyancing Act 1919-1954 and that the said easement may be
released varied or modified by the said Transferors their sequels
in title and the said Transferee its successors or assigns.

^d Strike out if unnecessary, or
suitably adjust,

- (i) if any easements are to
be created or any excep-
tions to be made; or
- (ii) if the statutory coven-
ants implied by the Act
are intended to be varied
or modified.

Covenants should comply with
the provisions of Section 88 of
the Conveyancing Act, 1919.

10/11/97 14:15 10/11/97 14:15 10/11/97 14:15
ENCUMBRANCES, &c., REFERRED TO.
COVENANT contained in Transfer G11308
Mortgage to Bank of New South Wales &

^e A very short note will suffice.

K 1165-1

Execution in New South Wales may be proved if this instrument is signed or acknowledged before the Registrar-General, or Deputy Registrar-General, or a Notary Public, a J.P., or Commissioner for Affidavits, to whom the Transferor is known, otherwise the attesting witnesses should appear before one of the above functionaries who having received an affirmative answer to each of the questions set out in Sec. 108 (1) (b) of the Real Property Act should sign the certificate at the foot of this page.

Execution may be proved where the parties are resident:—

(a) in any part of the British dominions outside the State of New South Wales by signing or acknowledging before the Registrar-General or Recorder of Titles of such Possession, or before any Judge, Notary Public, Justice of the Peace for New South Wales, or Commissioner for taking affidavits for New South Wales, or Mayor or Chief Officer of any municipal or local government corporation of such part, or Justice of the Peace for such part, or the Governor, Government Resident, or Chief Secretary of such part or a British Consular Officer or Australian Consular Officer exercising his or her consular jurisdiction in any other person as the Chief Justice of New South Wales may appoint.

(b) in the United Kingdom by signing or acknowledging before the Mayor or Chief Officer of any corporation or a Notary Public.

any *other* *foreign* place by signing or acknowledging before (i) a British Consular Officer (which includes a British Ambassador, Envoy, Minister, Chargé d'Affaires, Secretary of Embassy, or Legation, Consul-General, Acting Consul-General, Consul, Acting Consul, Vice-Consul, Acting Vice-Consul, Pro-Consul, Consular Agent and Acting Consular Agent), (ii) an Australian Consular Officer (which includes an Ambassador, High Commissioner, Minister, Head of Mission, Commissioner, Chargé d'Affaires, Counsellor or Secretary at an Embassy, High Commissioner's Office or Legation, Consul-General,

Consul, Vice-Consul, Trade Commissioner and Consular Agent and includes a person appointed to hold or act in the office of Counsellor, Official Secretary or Assistant Official Secretary at the Australian Commissioners' Office in Singapore or of Secretary at the Australian Military Mission in Berlin or of Agent General in London of the State of New South Wales or of Secretary, N.S.W. Government Office, London, who should affix his official stamp and the attesting witness may make a declaration of the due execution thereof before one of such persons (who should sign and affix his seal to such declaration), or such other person as the said Chief Justice may appoint.

Strike out unnecessary words.
Add any other matter necessary
to show that the power is
effective.

to be signed by Registrar-General, Deputy Registrar-General, a Notary Public, J.P., Commissioner for Affidavits, or other functionary before whom the attesting witness appears. Not required if the instrument itself be signed or acknowledged before one of these parties.

Mayfield

the

162

of *Struam* 19 65

Signed in my presence by the transferor
RONALD PETERSEN AND DIANNE PETERSEN
WHO IS PERSONALLY KNOWN TO ME

WHO IS PERSONALLY KNOWN TO ME

X R.R. Pedersen
X R.R. Pedersen

*Transferor.**

† Accepted, and I hereby certify this Transfer to be correct
for the purposes of the Real Property Act.

THE COMMON SEAL of THE HUNTER

DISTRICT WATER BOARD was hereunto

affixed by order of the Board in
the presence of

Walter Robert Arthur Kilpatrick
Alexander Stuart McDonald
Harry Taylor
Thomas Bleghorn

Transferee(s).

forming a quorum of the said
Board of whom Walter Robert Arthur Kilpatrick
and Alexander Stuart McDonald
by their respective signatures
attest hereto that such seal
was so hereunto affixed upon
the 18th day of May
1964

Secretary

to R. A. McFarlane
NYC Resident

A. S. V. McDonald

MEMORANDUM AS TO NON-REVOCATION OF POWER OF ATTORNEY

(To be signed at the time of executing the within instrument.)

Memorandum where by the undersigned states that he has no notice of the revocation of the Power of Attorney registered No. _____ Miscellaneous Register under the authority of which he has just executed the within transfer.

Signed at the day of 19 .
Signed in the presence of—

CERTIFICATE OF J.P., &c., TAKING DECLARATION OF ATTESTING WITNESS.*

Appeared before me at _____, the _____ day of _____, one thousand
 nine hundred and _____ the attesting witness to this instrument
 and declared that he personally knew _____ the person
 signing the same, and whose signature thereto he has attested; and that the name purporting to be such
 signature of the said _____ is _____ own handwriting, and
 that _____ he was of sound mind and freely and voluntarily signed the same.

* If signed by virtue of any power of attorney, the original power must be registered in the Miscellaneous Register, and produced with each dosing, and the memorandum of non-revocation on back of form signed by the attorney before a witness.

§ 11-B.-Section 117 requires that the above Certificate be signed by each Transferee or his Solicitor or Conveyancer, and renders any person who negligently certifying liable to a penalty of £50; also to damages recoverable by parties injured. Acceptances by the Solicitor or Conveyancer (who must sign his own name, and not that of his firm) is permitted only when the signature of the Transferee cannot be obtained without difficulty, and when the instrument does not impose a liability on the party taking under it. When the instrument contains some special covenant by the Transferee or is subject to a mortgage, encumbrance or lease, the Transferee must accept personally.

No alterations should be made by erasure. The words rejected should be scored through with the pen, and those substituted written over them, the alteration being verified by signature or initials in the margin, or noticed in the attestation.

No. **K 29986**

M. M. ALLEN & SONS
LODGED BY _____
77 KING STREET
SYDNEY

FEES.

The Fees, which are payable on lodgment, are as follows:—

- (a) £2 10s. 0d. where the memorandum of transfer is accompanied by the relevant Certificate of Title or Crown Grant, otherwise £3. Where such instrument is to be endorsed on more than one folium of the register, an additional charge of 5s. is made for every Certificate of Title or Crown Grant after the first.
- (b) A supplementary charge of 1s is made in each of the following:—
- (i) Where a restrictive covenant is imposed; or
 - (ii) A new easement is created; or
 - (iii) A partial discharge of mortgage is endorsed on the transfer.

DOCUMENTS LODGED HERewith.

To be filled in by person lodging dealing.

1 _____	} Received Docs. Nos. Receiving Clerk.
2 _____	
3 _____	
4 _____	
5 _____	
6 _____	

PARTIAL DISCHARGE OF MORTGAGE.
(N.B.—Before execution read marginal note.)

I, _____ mortgagee under Mortgage No. _____
release and discharge the land comprised in the within transfer from such mortgage and all claims thereunder but without prejudice to my rights and remedies as regards the balance of the land comprised in such mortgage.

Dated at _____ this _____ day of _____ 19 ____
Signed in my presence by _____

who is personally known to me, *M.D.D.* Mortgagee.

This discharge is appropriate to a transfer of part of the land in the mortgage. The mortgagee should execute a formal discharge where the land transferred is the whole of or the residue of the land in the Certificate of Title or Crown Grant or the whole of the land in the mortgage.

LEAVE THESE SPACES FOR DEPARTMENTAL USE.

INDEXED	MEMORANDUM OF TRANSFER <i>and grant of easement for drainage</i>
Checked by <i>[Signature]</i>	Particulars entered in Register Book.
Passed (in S.D.B.) by	
Signed by <i>[Signature]</i>	on <i>7.7.1965</i> at <i>12 Ann</i> <i>[Signature]</i> Registrar-General

PROGRESS RECORD.

	Initials.	Date.
Sent to Survey Branch		
Received from Records		
Draft written ...		
Draft examined ...		
Diagram prepared ...		
Diagram examined ...		
Draft forwarded ...		
Suppt. of Engrossers		
Cancellation Clerk ...		
Vol.		Fol.

K 1163



MEMORANDUM OF TRANSFERENCE

(REAL PROPERTY ACT, 1900)

M 26 1 54 F

Lodgment
Endorsement
Certificate
Plan 2
Cont. 10
£ 5

(Trusts must not be disclosed in the transfer.)

THE COMMISSIONER FOR MAIN ROADS in and for the State of New South Wales

Typing or handwriting in this instrument should not extend into any margin. Handwriting should be clear and legible and in permanent black or blue-black non-copying ink.

being registered as the proprietor of an estate in fee simple in the land hereinafter described, subject, however, to such encumbrances, liens and interests as are notified hereunder, in consideration of SEVEN HUNDRED AND SIXTEEN POUNDS

(£ 716) (the receipt whereof is hereby acknowledged) paid to him by

LESLIE PIERCE BULL of Robert Street Jesmond Market Gardener and EDITH BULL of the same place his wife

(herein called transferees)

do hereby transfer to the said transferees as Joint Tenants ALL such his Estate and Interest in ALL the land mentioned in the schedule following:—

County.	Parish.	Reference to Title (d)			Description of Land (if part only). (e)
		Whole or Part.	Vol.	Fol.	
Northumberland	Newcastle	Part	6526 5553	103 121	And being the land edged red on the plan annexed hereto and marked with the letter "A".

excepting thereout all mines or deposits of coal, ironstone, kerosene shale, limestone, slate or other minerals in and under the said land.

And the transferee covenants with the transferor for the benefit of the adjoining land that no fence shall be erected on the land hereby transferred to divide it from such adjoining land without the consent of the transferor but such consent shall not be withheld if such fence is erected without expense to the Transferor and in favour of any person dealing with the Transferees such consent shall be deemed to have been given in respect of every such fence for the time being erected and the land the subject of the burden of this covenant is the land hereby transferred AND the Transferees further covenant with the Transferor that they will not use or permit to be used the land hereby transferred in any manner or for any purpose which may affect or have a tendency to affect the stability of any adjoining road or street.

ENCUMBRANCES, &c., REFERRED TO:

Reservations and conditions contained in and noted upon the said Certificate of Title.

PLAN REFILED
PLAN ROOM AS F
438036

Signed at Sydney
Signed in my presence by the transferor
J. Howard Macdonald
WHO IS PERSONALLY KNOWN TO ME
Commissioner for Main Roads, have
hereby affixed the Official Seal
of the Commissioner for Main Roads
Signed
in the presence of: J. H. M. J.

the twenty fourth day of November 1953.

Leslie Pierce Bull
Transferor

h If executed within the State this instrument should be signed or acknowledged before the Registrar-General, or a Deputy Registrar-General, or a Notary Public, a J.P. or Commissioner for A.B. Davis, to whom the Transferor is known, otherwise the attesting witness should appear before one of the above functionaries who having questioned the witness should sign the certificate on the back of this form. As to instruments executed elsewhere, see back of form.

i Repeat attestation if necessary.

h If the Transferor or Transferee signs by a mark, the attestation must state "that the instrument was read over and explained to him, and that he appeared fully to understand the same."

Signed in my presence by the transferee
WHO IS PERSONALLY KNOWN TO ME

Edith Bull
Transferee(s).

Leslie P. Bull

Edith Bull

Transferee(s).

* If signed by virtue of any power of attorney, the original power must be registered, and produced with each dealing, and the memorandum of non-revocation on back of form signed by the attorney before a witness.

† N.B.—Section 117 requires that the above Certificate be signed by each Transferee or his Solicitor or Conveyancer, and renders any person falsely or negligently certifying liable to a penalty of £50; also to damages recoverable by parties injured. Acceptance by the Solicitor or Conveyancer (who must sign his own name, and not that of his firm) is permitted only when the signature of the Transferee cannot be obtained without difficulty, and when the instrument does not impose a liability on the party taking under it. When the instrument contains some special covenant by the Transferee or is subject to a mortgage, encumbrance or lease, the Transferee must accept personally.

No alterations should be made by erasure. The words rejected should be scored through with the pen, and those substituted written over them, the alteration being verified by signature or initials in the margin, or noticed in the attestation.

No. G 11308

CONSENT OF MORTGAGEE!
(N.B.—Before execution read marginal note.)

LODGED BY

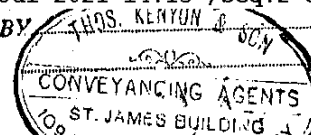

release and discharge the land comprised in the within transfer from such mortgage and all claims thereunder but without prejudice to my rights and remedies as regards the balance of the land comprised in such mortgage.

This consent is appropriate only to a transfer of part of the land in the Certificate of Title or Crown Grant. The mortgagee should execute a formal discharge where the land transferred is the whole of or the residue of the land in the Certificate of Title or Crown Grant or is the whole of the land in the mortgage.

Dated at this day of 19
Signed in my presence

who is personally known to me.

Mortgagee.

MEMORANDUM AS TO NON-REVOCATION OF POWER OF ATTORNEY.

(To be signed at the time of executing the within instrument.)

Memorandum whereby the undersigned states that he has no notice of the revocation of the Power of Attorney registered No. Miscellaneous Register under the authority of which he has just executed the within transfer.

Signed at the day of 19
Signed in the presence of—

Strike out unnecessary words. Add any other matter necessary to show that the power is effective.

CERTIFICATE OF J.P., &c., TAKING DECLARATION OF ATTESTING WITNESS!

Appeared before me at the day of one thousand nine hundred and and declared that he personally knew signing the same, and whose signature thereto he has attested; and that the name purporting to be such signature of the said is own handwriting and that he was of sound mind and freely and voluntarily signed the same.

To be signed by Registrar-General, Deputy Registrar-General, a Notary Public, J.P., Commissioner for Affidavits, or other functionary before whom the attesting witness appears. Not required if the instrument itself be signed or acknowledged before one of these parties.

INDEXED	MEMORANDUM OF TRANSFER	DOCUMENTS LODGED HEREWITH
	<i>Subject to Covenant</i>	To be filled in by person lodging dealing.
Checked by	Particulars entered in Register Book Volume <i>6525</i> Folio <i>103</i>	Received Docs. Nos. Receiving Clerk.
Passed (in S.D.B.) by	<i>10/11</i>	
Signed by	<i>10th day of November 1954 at</i> <i>minutes past 12 o'clock in the noon</i> <i>J. H. Pells</i> Registrar-General.	

LEAVE THESE SPACES FOR DEPARTMENTAL USE.

PROGRESS RECORD.

	Initials	Date
Sent to Survey Branch		
Received from Records		
Draft written ...	<i>[Signature]</i>	<i>2/11/54</i>
Draft examined ...	<i>[Signature]</i>	<i>20/10</i>
Diagram prepared ...	<i>[Signature]</i>	<i>21/10</i>
Diagram examined ...	<i>[Signature]</i>	
Draft forwarded ...	<i>[Signature]</i>	
Supt. of Engrossers ...	<i>[Signature]</i>	
Cancellation Clerk ...	<i>[Signature]</i>	
Vol. <i>6882</i> Fol. <i>117</i>		

EXECUTION OUTSIDE NEW SOUTH WALES.

If the parties be resident without the State, but in any other part of the British Dominions, the instrument must be signed or acknowledged before the Registrar-General or Recorder of Titles of such Possession, or before any Judge, Notary Public, Justice of the Peace for New South Wales, or Commissioner for taking affidavits for New South Wales, or the Mayor or Chief Officer of any municipal or local government corporation of such part, or Justice of the Peace for such part, or the Governor, Government Resident, or Ch of Secretary of such part or such other person as the Chief Justice of New South Wales may appoint.

If resident in the United Kingdom then before the Mayor or Chief Officer of any corporation or a Notary Public.

If resident at any foreign place, then the parties should sign or acknowledge before a British Minister, Ambassador, Envoy, Minister, Chargé d'Affaires, Secretary of the Embassy or Legation, Consul-General, Consul, Vice-Consul, Acting-Consul, Pro-Consul, or Consular Agent, who should affix his seal of office, or the attesting witness may make a declaration of the due execution thereof before one of such persons (who should sign and affix his seal to such declaration), or such other person as the said Chief Justice may appoint.

The fees are:—Upon lodgment (a) £1. If accompanied by the relevant title or evidence of production thereof, (b) £1. 5. 0 otherwise. This fee includes endorsement on the first Certificate. In addition the following fees are payable:—(a) 5/- for each additional Certificate included in the Transfer, (b) £1. 10. 0 for each new Certificate of Title issued, (c) 5/- where the Transfer contains a covenant purporting to affect the user of any land, (d) 10/- where the Transfer is expressed to be made together with an easement or expressed to reserve an easement or in any way creates an easement, (e) 2/6 where partial discharge of a mortgage is endorsed on the Transfer, (f) 2/6 for each additional folio where the Certificate exceeds ten folios, (g) as approved, in cases involving more than one simple diagram or any diagram other than a simple diagram.

Tenants in common must receive separate Certificates.

If part only of the land is transferred a new Certificate must issue for that part, and the old Certificate will be retained in the Office. A new Certificate may be taken out for the residue if desired.

921862 to follow.

M 12753

R.P. 13A



No. _____

10 SEP 29 PM 12 33

New South Wales

Fees:—

Lodgment

Endorsement

MEMORANDUM OF TRANSFER

(REAL PROPERTY ACT, 1900.)

2310-00

I, WE, RONALD RAYMOND PETERSEN Boiler and D'ANNE PETERSEN
 of Jesmond.

This form may be used where new restrictive covenants are imposed or easements created or where the single transfer form is unsuitable.

(Trusts must not be disclosed in the transfer.)

Typing or handwriting in this instrument should not extend into any margin. Handwriting should be clear and legible and in permanent black non-copying ink.

All blanks should be ruled up before signing.

a less estate, strike out "in fee simple" and interline the required alteration.

(herein called transferor)

being registered as the proprietor of an estate in fee simple* in the land hereinafter described, subject, however, to such encumbrances, liens and interests as are notified hereunder, in consideration of

TEN DOLLARS
 (\$10.00) (the receipt whereof is hereby acknowledged) paid to us by

and grant
 do hereby transfer/to

THE HUNTER DISTRICT WATER BOARD

b Show in BLOCK LETTERS the full name, postal address and description of the persons taking, and if more than one, whether they hold as joint tenants or tenants in common.

THE HUNTER DISTRICT WATER BOARD a body corporate by Act of the

legislature of the State of New South Wales and having its office

at Hunter Street, Newcastle.

(herein called transferee)

OUT OF OUR HANDS
 ALL such, Estate and Interest in ALL THE land mentioned in the schedule following:—

c description may refer to the defined residue of the land in a certificate or grant (e.g. "And being residue after transfer number ") or may refer to parcels shown in Town or Parish Maps issued by the Department of Lands or shown in plans filed in the Office of the Registrar General (e.g. "and being Lot section D.P. ").

Unless authorised by Reg. 53, Conveyancing Act Regulations, 1961, a plan may not be annexed to or endorsed on this transfer form.

County	Parish	Reference to Title			Description of Land (if part only)
		Whole or Part	Vol.	Fol.	
Northumberland	Newcastle	Part	9528	171	
		(2. & 3. & 4.)			

~~And the transferor covenants with the transferee~~^d

FULL AND FREE right title liberty and licence for the Transferee
its successors and assigns TO CONSTRUCT lay maintain repair renew
cleanse inspect replace and divert or alter the position of a
"stormwater drain" or channel with the apparatus and appurtenances
thereof in or under the surface of such part of the land described
hereinbefore as is delineated in Deposited Plan No. 537437 and therein
marked "proposed easement 15' wide for stormwater channel" and to carry
and convey rain storm and surface water through the said stormwater
drain or channel and for the purposes aforesaid or any of them by its
officers servants and/or contractors with or without motor or other
vehicles horses or other animals plant and machinery to enter upon and
break open the surface of the said strip of land so shown as aforesaid
and to deposit soil temporarily but subject to a liability to replace
the soil and to restore surface of the said lands in a proper and work-
manlike manner as soon as the operations are completed.

AND IT IS HEREBY DECLARED that the said Easement is intended to be
an Easement in gross under Section 88A of the Conveyancing Act 1919-1964
and that the said Easement may be released varied or modified by the said
Transferor his sequels in title and the said Transferee its successors or
assigns.

^d Strike out if unnecessary
suitably adjust.

(i) if any easements are to
be created or any
exceptions to be made:
or

(ii) if the statutory coven-
ants implied by the Act
are intended to be
varied or modified.

Covenants should comply with
the provisions of Section 88 of
the Conveyancing Act, 1919.

ENCUMBRANCES, &c., REFERRED TO:

Covenant created by Transfer No. G11308 Mortgage No. J693408 to
Bank of New South Wales Savings Bank Limited. Easement for
Drainage No. K29986.

^e A very short note will suffice.

1165-1 5c 437-1

If the Transferee or Transferee signs by a mark, the attestation must state that the instrument was read over and explained to him, and that he appeared fully to understand the same."

Execution in New South Wales may be proved if this instrument is signed or acknowledged before the Registrar General, or Deputy Registrar General, or a Notary Public, a J.P. or Commissioner for Affidavits, to whom the Transferee is known, otherwise the attesting witness should appear before one of the above functionaries who having received an affirmative answer to each of the questions set out in Sec. 108 (1) (a) of the Real Property Act should sign the certificate at the foot of this page.

Execution may be proved where the parties are resident:—

(a) in any part of the British dominions outside the State of New South Wales by signing or acknowledging, before the Registrar General or Recorder of Titles of such possession, or before any Justice, Notary Public, Justice of the Peace for New South Wales, or Commissioner for taking affidavits for New South Wales, or Mayor or Chief Officer of any municipal or local government corporation of such part, or Justice of the Peace for such part, or the Governor, Government Resident, or Chief Secretary of such part or a British Consular Officer or Australian Consular Officer exercising his functions in that part or such other person as the Chief Justice of New South Wales may appoint.

(b) in the United Kingdom by signing or acknowledging before the Mayor or Chief Officer of any corporation or a Notary Public.

(c) in any foreign place by signing or acknowledging before (i) a British Consular Officer (which includes a British Ambassador, Envoy, Minister, Chargé d'Affaires, Secretary of Embassy or Legation, Consul-General, Acting Consul-General, Consul, Acting Consul, Vice-Consul, Acting Vice-Consul, Pro-Consul, Consular Agent and Acting Consular Agent), (ii) an Australian Consular Officer (which includes an Ambassador, High Commissioner, Minister, Head of Mission, Commissioner, Chargé d'Affaires, Counsellor or Secretary at an Embassy, High Commissioner's Office or Legation, Consul-General, Consul, Vice-Consul, Trade Commissioner and Consular Agent and includes a person appointed to hold or act in the office of Counsellor, Official Secretary or Assistant Official Secretary at the Australian Commissioner's Office in Singapore or of Secretary at the Australian Military Mission in Berlin or of Agent General in London of the State of New South Wales or of Secretary, N.S.W. Government Offices, London), who should affix his seal of office, or the attesting witness may make a declaration of the due execution thereof before one of such persons (who should sign and affix his seal to such declaration), or such other person as the said Chief Justice may appoint.

g Strike out unnecessary words. Add any other matter necessary to show that the power is effective.

h To be signed by Registrar General, Deputy Registrar General, a Notary Public, J.P., Commissioner for Affidavits, or other functionary before whom the attesting witness appears. Not required if the instrument itself be signed or acknowledged before one of these parties.

Signed at Adelaide the 11th day of June 19 70
Signed in my presence by the transferor
RONALD RAYMOND PETERSEN & DIANNE PETERSEN
WHO IS PERSONALLY KNOWN TO ME

Michael Wallace
Justice of the Peace

W. Pedersen
Transferor.*

THE COMMON SEAL OF THE HUNTER DISTRICT
WATER BOARD was hereunto affixed by order
Signed in my presence by the transferor

~~XXXXXXXXXXXXXXXXXXXX~~
of the Board in the presence of
FREDERICK ERNEST COOKSEY
JACK WALLIS, DAVIES
ALD. A.E. EDDEN AND
CR. REGINALD LENAGHAN

forming a quorum of the said Board
of whom FREDERICK ERNEST COOKSEY
and JACK WALLIS, DAVIES
by their respective signatures attest
that such seal was so hereunto affixed
upon the 1st day of July 1970.

Frederick Ernest Cooksey
Secretary.

Accepted, and I hereby certify this Transfer to be correct
for the purposes of the Real Property Act.

Transferee(s).

Frederick Ernest Cooksey
PRESIDENT
Jack Wallis Davies
VICE PRESIDENT

MEMORANDUM AS TO NON-REVOCATION OF POWER OF ATTORNEY.

(To be signed at the time of executing the within instrument.)

Memorandum where by the undersigned states that he has no notice of the revocation of the Power of Attorney registered No. _____ Miscellaneous Register under the authority of which he has just executed the within transfer.*

Signed at _____ the _____ day of _____ 19 _____
Signed in the presence of—

CERTIFICATE OF J.P., &c., TAKING DECLARATION OF ATTESTING WITNESS.[†]

Appeared before me, at _____, the _____ day of _____, one thousand
nine hundred and _____ the attesting witness to this instrument,
and declared that he personally knew _____, the person
signing the same, and whose signature thereto he has attested, and that the name purporting to be such
signature of the said _____ is _____ own handwriting, and
that _____ he was of sound mind, and freely and voluntarily signed the same.

* If signed by virtue of any power of attorney, the original power must be registered in the Miscellaneous Register, and produced with each dealing, and the memorandum of non-revocation on back of form signed by the attorney before a witness.

† N.B.—Section 117 requires that the above Certificate be signed by each Transferee or his Solicitor or Conveyancer, and renders any person falsely or negligently certifying liable to a penalty; also to damages recoverable by parties injured. Acceptance by the Solicitor or Conveyancer (who must sign his own name, and not that of his firm) is permitted only when the signature of the Transferee cannot be obtained without difficulty, and when the instrument does not impose a liability on the party taking under it. When the instrument contains some special covenant by the Transferee or is subject to a mortgage, encumbrance or lease, the Transferee must accept personally.

No alterations should be made by erasure. The words rejected should be scored through with the pen, and those substituted written over them, the alteration being verified by signature or initials in the margin, or noticed in the attestation.

M 12755

No. _____

Lodged by

M. M. A. F. & CO.

Address

77 KING ST. SYDNEY

Phone No.

PHONE 29-3787

PARTIAL DISCHARGE OF MORTGAGE.

(N.B.—Before execution read marginal note.)

I, THE BANK OF NEW SOUTH WALES SAVINGS BANK LIMITED

mortgagee under Mortgage No. J693408

Am release and discharge the land comprised in the within transfer from such mortgage and all claims thereunder but without prejudice to my rights and remedies as regards the balance of the land comprised in such mortgage, consent to the within grant of easement but without prejudice to the rights powers and remedies under such mortgage against the Mortgagor personally and as regards the balance of the lands comprised therein.

Dated at Sydney this sixth day of August, 1970.
Signed for and on behalf of
BANK OF NEW SOUTH WALES

Re SAVINGS BANK LIMITED
Signed by its Attorney
by KENNETH STUART CRICK.

Am and its duly constituted Attorneys
who are personally known to me
are *Am* *Am*

BANK OF NEW SOUTH WALES SAVINGS BANK LIMITED

Am who hereby respectively state that at the time of their
executing this instrument they have no notice of the
revocation of the Power of Attorney Registered No. 64794
Miscellaneous Register under the authority of which they
have executed this instrument.

Am Assistant Chief Security Officer, and
of Bank of
New South Wales.

Am ACTING Joint State Manager, New South Wales.

This discharge is appropriate to a transfer of part of the land in the Mortgage. The mortgagee should execute a formal discharge where the land transferred is the whole of or the residue of the land in the Certificate of Title or Crown Grant or is the whole of the land in the mortgage.

DOCUMENTS LODGED HERewith
To be filled in by person lodging dealing

1. <i>Copy of M12755</i>	Received Docs.
2. _____	
3. _____	Nos.
4. _____	
5. _____	Receiving Clerk
6. _____	
7. _____	

LEAVE THESE SPACES FOR DEPARTMENTAL USE.

Indexed	MEMORANDUM OF TRANSFER <i>of Easement for Stormwater Channel</i>
Checked by	Particulars entered in Register Book 21.10.1970
Passed (in S.D.B.) by	<i>Am</i>
Signed by	<i>Am</i> Registrar General

C/S

PROGRESS RECORD

	Initials	Date
Sent to Survey Branch		
Received from Records		
Draft written		
Draft examined		
Diagram prepared		
Diagram examined		
Draft forwarded		
Supt. of Engrossers		
Cancellation Clerk		
Vol.		Fol.

M.P.D. 1974



City of
Newcastle

Planning Certificate

Section 10.7, Environmental Planning and Assessment Act 1979

To: Evans & Wislang
PO Box 93
KOTARA NSW 2289

Certificate No: PL2021/04360
Fees: \$53.00
Receipt No(s): D001987222

Your Reference: NB: 43260

Date of Issue: 02/08/2021

The Land: Lot 2 DP 503329 234 Newcastle Road Jesmond NSW 2299

Advice provided on this Certificate:

Advice under section 10.7(2): see items 1 – 21

IMPORTANT: Please read this certificate carefully

This certificate contains important information about the land.

Please check for any item which could be inconsistent with the proposed use or development of the land. If there is anything you do not understand, phone our **Customer Contact Centre** on (02) 4974 2000, or come in and see us.

The information provided in this certificate relates only to the land described above. If you need information about adjoining or nearby land, or about the City of Newcastle (CN) development policies for the general area, contact our **Customer Contact Centre**.

All information provided is correct as at 02/08/2021. However, it's possible for changes to occur within a short time. We recommend that you only rely upon a very recent certificate.

WARNING:

This certificate DOES NOT contain additional advice provided under section 10.7(5). We have not provided this additional advice because it was not requested or paid for by the applicant. We recommend that you obtain a full certificate.

City of Newcastle

PO Box 489
NEWCASTLE 2300

Phone: (02) 4974 2000
Facsimile: (02) 4974 2222

Customer Contact Centre

Ground floor,
12 Stewart Avenue
Newcastle West NSW 2300

Office hours:

Mondays to Fridays 8.30 am to 5.00 pm

Part 1:

Advice provided under section 10.7(2)

ATTENTION: The explanatory notes appearing in italic print within Part 1 are provided to assist understanding, but do not form part of the advice provided under section 10.7(2). These notes shall be taken as being advice provided under section 10.7(5).

1. Names of relevant planning instruments and DCPs

The following environmental planning instruments, proposed environmental planning instruments and development control plans apply to the land, either in full or in part.

State Environmental Planning Policy No. 1 - Development Standards

State Environmental Planning Policy No. 21 - Caravan Parks

State Environmental Planning Policy No. 33 - Hazardous and Offensive Development

State Environmental Planning Policy No. 36 - Manufactured Home Estates

State Environmental Planning Policy (Koala Habitat Protection) Amendment (Maps) 2020

State Environmental Planning Policy No. 50 - Canal Estate Development

State Environmental Planning Policy No. 55 - Remediation of Land

State Environmental Planning Policy No. 64 - Advertising and Signage

State Environmental Planning Policy No. 65 - Design Quality of Residential Flat Development

State Environmental Planning Policy No. 70 - Affordable Housing (Revised Schemes)

State Environmental Planning Policy (Housing For Seniors or People with a Disability) 2004

State Environmental Planning Policy (Building Sustainability Index:BASIX) 2004

State Environmental Planning Policy (State Significant Precincts) 2005

State Environmental Planning Policy (Mining, Petroleum Production and Extractive Industries) 2007

State Environmental Planning Policy (Infrastructure) 2007

State Environmental Planning Policy (Miscellaneous Consent Provisions) 2007

State Environmental Planning Policy (Exempt and Complying Development Codes) 2008

State Environmental Planning Policy (Affordable Rental Housing) 2009

State Environmental Planning Policy (Urban Renewal) 2010

State Environmental Planning Policy (State and Regional Development) 2011

State Environmental Planning Policy (Educational Establishments and Child Care Facilities) 2017

State Environmental Planning Policy (Vegetation in Non-Rural Areas) 2017

State Environmental Planning Policy (Concurrences) 2018

State Environmental Planning Policy (Primary Production and Rural Development) 2019

Newcastle Local Environmental Plan 2012

Newcastle Development Control Plan 2012

2. Zoning and land use under relevant LEPs

Newcastle Local Environmental Plan 2012

Zoning: The Newcastle Local Environmental Plan 2012 identifies the land as being within the following zone(s):

Zone R2 Low Density Residential

Note: Refer to www.newcastle.nsw.gov.au or www.legislation.nsw.gov.au website for LEP instrument and zoning maps.

The following is an extract from the zoning provisions contained in Newcastle Local Environmental Plan 2012:

Zone R2 Low Density Residential

- **Objectives of zone**

- To provide for the housing needs of the community within a low density residential environment.
- To enable other land uses that provide facilities or services to meet the day to day needs of residents.
- To accommodate a diversity of housing forms that respects the amenity, heritage and character of surrounding development and the quality of the environment.

- **Permitted without consent**

Environmental protection works; Home occupations

- **Permitted with consent**

Boarding houses; Centre-based child care facilities; Community facilities; Dwelling houses; Educational establishments; Emergency services facilities; Exhibition homes; Exhibition villages; Flood mitigation works; Group homes; Home-based child care; Hospitals; Neighbourhood shops; Oyster aquaculture; Pond based aquaculture; Recreation areas; Residential accommodation; Respite day care centres; Roads; Tank-based aquaculture; Tourist and visitor accommodation

- **Prohibited**

Backpackers' accommodation; Hostels; Rural workers' dwellings; Serviced apartments; Any other development not specified in, permitted without consent or permitted with consent

Minimum land dimensions for erection of a dwelling-house: The Newcastle Local Environmental Plan 2012 contains development standards relating to minimum land dimensions for the erection of a dwelling house. Refer to clause 4.1 Minimum subdivision lot size and Part 4 Principle development standards of the Newcastle LEP 2012 for provisions relating to minimum lot sizes for residential development.

Critical habitat: The Newcastle Local Environmental Plan 2012 does not identify the land as including or comprising critical habitat.

Heritage conservation area: The land is not within a heritage conservation area under the Newcastle Local Environmental Plan 2012.

Heritage items: There are no heritage items listed in the Newcastle Local Environmental Plan 2012 situated on the land.

3. Complying development

Note Other requirements: The advice below for all Complying Development Codes, is limited to identifying whether or not the **land**, the subject of the certificate, is land on which complying development may be carried out because of Clauses 1.17A(1)(c) to (e), (2), (3) & (4), 1.18 (1)(c3) and 1.19 of State Environmental Planning Policy (Exempt and Complying Development Codes) 2008 (the Codes SEPP).

To ascertain the extent to which the complying development may or may not be carried out on the land, maps are available on City of Newcastle (CN) web pages.

Housing Code

Complying development under the Housing Code MAY be carried out on this land.

Rural Housing Code

Complying development under the Rural Housing Code MAY be carried out on this land.

Low Rise Housing Diversity Code

Complying development under the Low Rise Housing Diversity Code MAY be carried out on this land.

Greenfield Housing Code

Complying development under the Greenfield Housing Code MAY be carried out on this land.

Inland Code

Complying development under the Inland Code MAY be carried out on this land.

Housing Alterations Code

Complying development under the Housing Alterations Code MAY be carried out on this land.

General Development Code

Complying development under the General Development Code MAY be carried out on this land.

Commercial and Industrial Alterations Code

Complying development under the Commercial and Industrial Code MAY be carried out on this land.

Commercial and Industrial (New Buildings and Additions) Code

Complying development under the Commercial and Industrial (New Buildings and Additions) Code MAY be carried out on this land.

Container Recycling Facilities Code

Complying development under the Container Recycling Facilities Code MAY be carried out on this land.

Subdivision Code

Complying development under the Subdivision Code MAY be carried out on this land.

Demolition Code

Complying development under the Demolition Code MAY be carried out on this land.

Fire Safety Code

Complying development under the Fire Safety Code MAY be carried out on this land.

4B. Annual charges under Local Government Act 1993 for coastal protection services that relate to existing coastal protection works

The land IS NOT subject to an agreement for annual charges under section 496B of the Local Government Act 1993 for coastal protection services (within the meaning of section 553B of that Act).

5. Coal Mine Subsidence Compensation Act 2017

The land IS NOT WITHIN a Mine Subsidence District declared under section 20 of the Coal Mine Subsidence Compensation Act 2017.

NOTE: The above advice is provided to the extent that City of Newcastle (CN) has been notified by Subsidence Advisory NSW.

6. Road widening or realignment

NOTE: The Roads and Maritime Services (RMS) may have proposals that are not referred to in this item. For advice about affectation by RMS proposals, contact the Roads and Maritime Services, Locked Mail Bag 30 Newcastle 2300. Ph: 131 782.

The land IS NOT AFFECTED by any road widening or road realignment under Division 2 of Part 3 of the Roads Act 1993.

The land IS NOT AFFECTED by any road widening or road realignment under an environmental planning instrument.

The land IS NOT AFFECTED by road widening or road realignment under a resolution of the Council.

7. Policies on hazard risk restrictions

Except as stated below, the land is not affected by a policy referred to in Item 7 of Schedule 4 of the Environmental Planning and Assessment Regulation 2000 that restricts the development of the land because of the likelihood of land slip, bushfire, tidal inundation, subsidence, acid sulphate soils or any other risk (other than flooding).

Potential acid sulfate soils: Works carried out on the land must be undertaken in accordance with Clause 6.1 Acid sulfate soils of the Newcastle Local Environmental Plan 2012.

Land Contamination: Council has adopted a policy of restricting development or imposing conditions on properties affected by Land Contamination. Refer to the Newcastle Development Control Plan 2012, which is available to view and download from City of Newcastle's website.

NOTE: The absence of a policy to restrict development of the land because of the likelihood of a particular risk does not imply that the land is free from that risk. City of Newcastle (CN) considers the likelihood of natural and man-made risks when determining development applications under section 4.15 of the Environmental Planning and Assessment Act 1979. Detailed investigation carried out in conjunction with the preparation or assessment of a development application may result in CN either refusing development consent or imposing conditions of consent on the basis of risks that are not identified above.

7A. Flood related development controls information

7A(1) Mapping information is not available and it is unknown if the land or part of the land is within the flood planning area.

7A(2) Mapping information is not available and it is unknown if the land or part of the land is between the flood planning area and the probable maximum flood.

Our information currently indicates that the property is, or contains, flood prone land as defined in the Floodplain Development Manual: the management of flood liable land, April 2005 published by the NSW Government.

Section 4.01 Flood Management of Newcastle Development Control Plan (DCP) 2012 provides guidelines with respect to all development of flood prone land. This includes development for the purpose of dwelling houses, dual occupancies, multi dwelling housing or residential flat buildings. The DCP may be viewed on our website, inspected or purchased at our Customer Contact Centre.

NOTE: More detailed flood information specific to the property is available on separate flooding certificate application through our Customer Contact Centre on (02) 4974 2000

8. Land reserved for acquisition

The land is not identified for acquisition by a public authority (as referred to in section 3.15 of the Act) by any environmental planning instrument or proposed environmental planning instrument applying to the land.

9. Contributions plans

The following contribution plan/s apply to the land.

Section 7.12 Newcastle Local Infrastructure Contributions Plan 2019: Effective 9 September 2019.

The Plan specifies section 7.12 contributions that may be imposed as a condition of development consent.

NOTE: Contributions plans are available on our website or may be inspected or purchased at our Customer Contact Centre.

9A. Biodiversity certified land

The land IS NOT biodiversity certified land under Part 8 of the Biodiversity Conservation Act 2016.

10. Biodiversity stewardship sites

The land IS NOT land (of which CN is aware) under a biodiversity stewardship agreement under Part 5 of the Biodiversity Conservation Act 2016.

10A. Native vegetation clearing set asides

The land IS NOT land (of which CN is aware) that contains a set aside area under section 60ZC of the Local Land Services Act 2013.

11. Bush fire prone land

The land IS NOT bush fire prone land for the purposes of the Environmental Planning and Assessment Act 1979.

12. Property vegetation plans

Not applicable. The Native Vegetation Act 2003 does not apply to the Newcastle local government area.

13. Orders under Trees (Disputes Between Neighbours) Act 2006

CN HAS NOT been notified that an order has been made under the Trees (Disputes between Neighbours) Act 2006 to carry out work in relation to a tree on the land.

14. Directions under Part 3A

The land IS NOT AFFECTED by a direction by the Minister in force under section 75P (2) (c1) of the Act.

15. Site compatibility certificates and conditions for seniors housing

(a) The land IS NOT AFFECTED by a current site compatibility certificate (of which CN is aware) issued under the State Environmental Planning Policy (Housing for Seniors and People with a Disability) 2004.

(b) The land IS NOT AFFECTED by any terms of kind referred to in clause 18(2) of the State Environmental Planning Policy (Housing for Seniors or People with a Disability) 2004, that have been imposed as a condition of consent to a development application granted after 11 October, 2007 in respect of the land.

16. Site compatibility certificates for infrastructure, schools or TAFE establishments

The land IS NOT AFFECTED by a valid site compatibility certificate (of which CN is aware) issued under the State Environmental Planning Policy (Infrastructure) 2007.

17. Site compatibility certificates and conditions for affordable rental housing

The land IS NOT AFFECTED by a valid site compatibility certificate (of which CN is aware) issued under the State Environmental Planning Policy (Affordable Rental Housing) 2009.

18. Paper subdivision information

The land IS NOT AFFECTED by any development plan that applies to the land or that is proposed to be subject to a consent ballot.

19. Site verification certificates

The land IS NOT AFFECTED by a current site verification certificate (of which CN is aware) issued under the State Environmental Planning Policy (Mining, Petroleum Production and Extractive Industries) 2007.

20. Loose-fill asbestos insulation

CN HAS NOT been notified that the land includes any residential premises (within the meaning of Division 1A of Part 8 of the Home Building Act 1989) that are listed on the register of loose-fill asbestos insulation, that is required to be maintained under that Division.

21. Affected building notices and building product rectification orders

The land IS NOT AFFECTED by any affected building notice of which CN is aware that is in force in respect of the land.

The land IS NOT AFFECTED by an outstanding notice of intention to make a building product rectification order of which CN is aware.

The land IS NOT AFFECTED by any building product rectification order that has not been fully complied with, of which CN is aware that is in force in respect of the land.

An affected building notice has the same meaning as in Part 4 of the Building Products (Safety) Act 2017.
Building product rectification order has the same meaning as in the Building Products (Safety) Act 2017.

Note: *There are no matters prescribed by section 59(2) of the Contaminated Land Management Act 1997 to be disclosed, however if other contamination information is held by the Council this may be provided under a section 10.7(5) certificate.*

Issued without alterations or additions, 02/08/21
Authorised by

JEREMY BATH
CHIEF EXECUTIVE OFFICER



HUNTER WATER CORPORATION

A.B.N. 46 228 513 446

SERVICE LOCATION PLAN

Enquiries: 1300 657 657

APPLICANT'S DETAILS

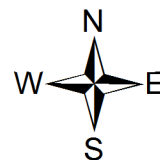

InfoTrack

234 NEWCASTLE

JESMOND NSW

APPLICATION NO.: 1466980

APPLICANT REF: M 43260

RATEABLE PREMISE NO.: 4256310526

PROPERTY ADDRESS: 234 NEWCASTLE RD JESMOND 2299

LOT/SECTION/DP:SP: 2//DP 503329

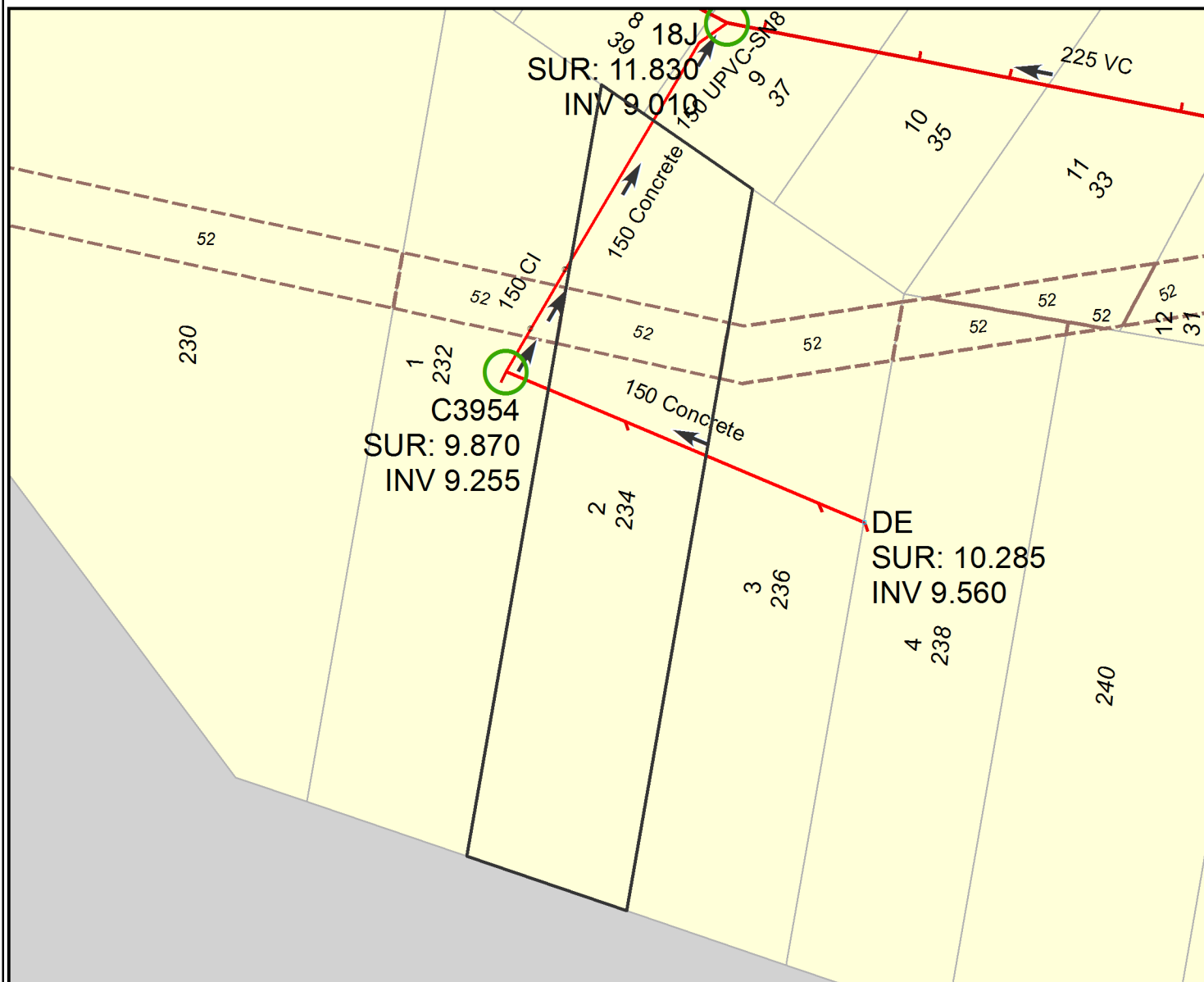

SEWER POSITION APPROXIMATE ONLY.
SUBJECT PROPERTY BOLDED.
ALL MEASUREMENTS ARE METRIC.

IF A SEWERMAIN IS LAID WITHIN THE BOUNDARIES OF THE LOT, SPECIAL REQUIREMENTS FOR THE PROTECTION OF THE SEWERMAIN APPLY IF DEVELOPMENT IS UNDERTAKEN. IN THESE CASES, IT IS RECOMMENDED THAT YOU SEEK ADVICE ON THE SPECIAL REQUIREMENTS PRIOR TO PURCHASE. PHONE 1300 657 657, FOR MORE INFORMATION.

IMPORTANT:

IF THIS PLAN INDICATES A SEWER CONNECTION IS AVAILABLE OR PROPOSED FOR THE SUBJECT PROPERTY, IT IS THE INTENDING OWNERS RESPONSIBILITY TO DETERMINE WHETHER IT IS PRACTICABLE TO DISCHARGE WASTEWATER FROM ALL PARTS OF THE PROPERTY TO THAT CONNECTION.

ANY INFORMATION ON THIS PLAN MAY NOT BE UP TO DATE AND THE CORPORATION ACCEPTS NO RESPONSIBILITY FOR ITS ACCURACY.

Date: 30/07/2021

Scale at A4: 1:500

CADASTRAL DATA © LPI OF NSW
CONTOUR DATA © AAMHatch
© Department of Planning

SEWER/WATER/RECYCLED WATER
UTILITY DATA
© HUNTER WATER CORPORATION